



* 0 0 B R E A K 0 0 *



**ADVANCED
IMAGING
SYSTEMS**

www.aisimc.com

An Information
Management Company

City of Charlotte – Planning Dept. Scanning Rezoning Files

Petition # _____

Document type:

- Applications
- Correspondence
- Department Comments
- Land Use Consistency
 - Mail Info
 - Mapping
 - Other
- Site Plans



* 0 0 B R E A K 0 0 *

TYPICAL SCHEMATIC PLAN FOR B-1 SHOPPING CENTER DISTRICT

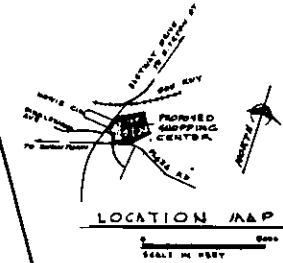
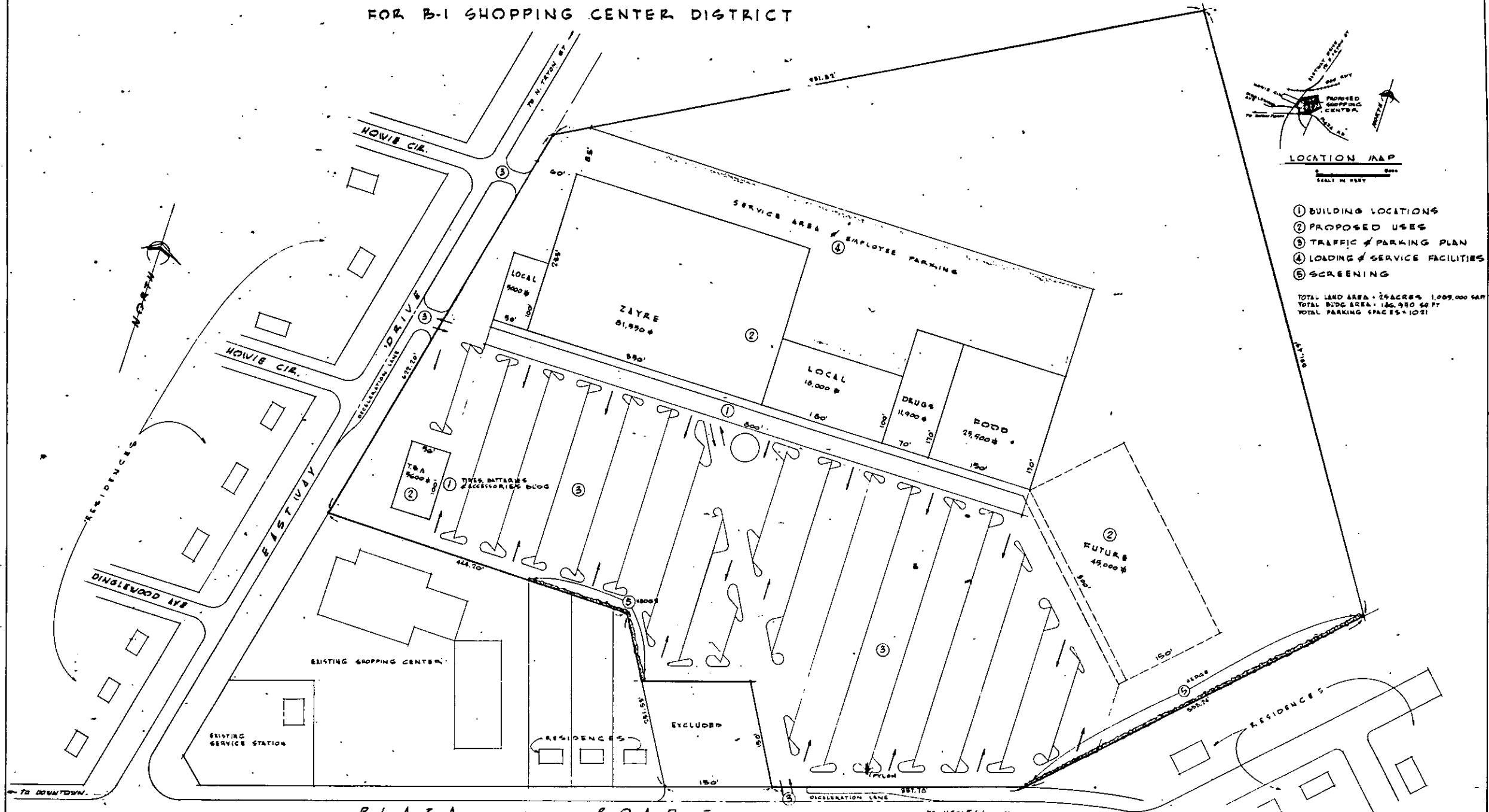

- ① BUILDING LOCATIONS
- ② PROPOSED USES
- ③ TRAFFIC / PARKING PLAN
- ④ LOADING / SERVICE FACILITIES
- ⑤ SCREENING

TOTAL LAND AREA - 29 ACRES ± 1,009,000 SQ. FT.
TOTAL BLDG AREA - 186,980 SQ. FT.
TOTAL PARKING SPACES - 1021

SITE PLAN
GRAPHIC SCALE 1" = 60'-0"

EASTWOOD GOLF CLUB INC.
CHARLOTTE-MECKLENBURG PLANNING COMMISSION

**ZAYRE EASTWAY
FOR
SHOPPING CENTERS
DEVELOPERS INC.,**

CHARLOTTE NORTH CAROLINA
P.O. Box 1110 FT. LAUDERDALE FLORIDA
D. E. MITT ASSOCIATES, INC. DATE 1/31/67
INCORPORATED BY THAYER
100 N. FEDERAL HIGHWAY FILE # 476