



TOWNHOUSES (FOR SALE)
R-20MF 27.6 ACRES

CARMEL COMMUNITY

FOR THE JOHN CROSLAND CO.

CHARLOTTE, NORTH CAROLINA
3 NOV, 1970 PROJ. NO. 541

REVISED 13 JAN, 1971
14 OCT, 1971
30 MAR, 1972
10 APRIL 1972

DESCRIPTION	ZONING	UNITS
SINGLE FAMILY RESIDENTIAL	R-15	62
TOWNHOUSES & GARDEN APTS.	R-20MF	238
TOWNHOUSES (FOR SALE)	R-20MF	150
TOTAL LIVING UNITS		450
SHOPPING CENTER	B-1SCD	50,000 SF
PARKING	B-1SCD	250 CARS

PLAN 'B'

FEREBEE, WALTERS, AND ASSOCIATES

ARCHITECTS / PLANNERS / ENGINEERS

CHARLOTTE, NORTH CAROLINA

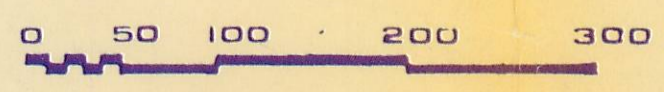

TOWNHOUSES & GARDEN APTS.
R-20MF 34.0 ACRES

SHOPPING CENTER
B-1SCD 4.86 ACRES

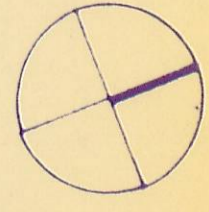

YTIUIMMOJ JEMRAC
THE JOHN CROGGARD CO.
CHICAGO, ILLINOIS

1972-08(c)

APPROVED BY COUNTY
COMMISSION 7-17-72
SUPERCEDES ALL PREVIOUS PLANS

- * This plan has been partially replaced by plans approved by County Comm. 1/4/77 under Crosland Pet # 76-34(c) & 76-35(c). The area south of Quail Hollow Rd is still approved as shown on this map. 1/4/77
- * The area south of Quail Hollow Rd. was amended by plan approved under petition # 79-4(c), Crosland Co.
- * The 5.7 ac. tract shown as open space on this plan has been amended under petition # 81-23, Crosland Co. as approved by City Council 6-8-81

72-08(c)

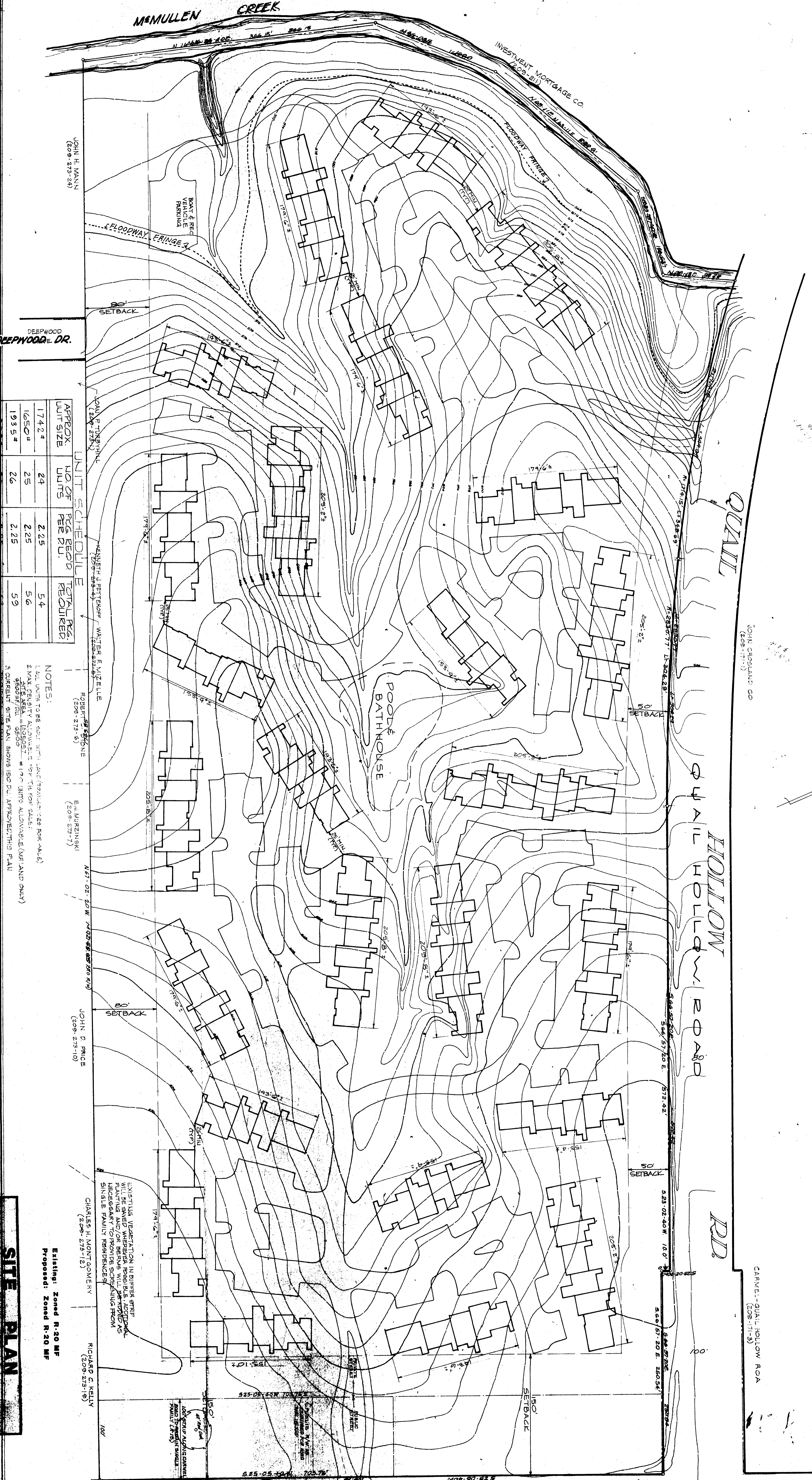

APPROX. UNIT SIZE	NO. OF UNITS	PGS. REQ'D PER RU.	TOTAL PGS. REQUIRED
1742 #	24	2.25	54
1650 #	25	2.25	56
1935 #	26	2.25	59
1975 #	28	2.25	63

NOTES:
 1. ALL UNITS TO BE BUILT WITH LANDSCAPING (25% FOR SALE)
 2. MAX. FERTILITY ALLOWABLE (SFP TR. FOR SALE)
 3. MAX. FERTILITY ALLOWABLE (SFP TR. FOR SALE)
 4. CURRENT SITE PLAN SHOWS 160 DU APPROXIMATE PLAN

ROBERT J. STONE (209-273-9)
 E.M. WURZINSKI (209-273-7)
 JOHN D. PRICE (209-273-10)
 CHARLES H. MONTGOMERY (209-273-12)
 RICHARD C. KELLY (209-273-13)

Existing: Zoned R-20 MF
 Proposed: Zoned R-20 MF

SITE PLAN
 Carmel and Quail Hollow Roads

DP
 DESIGN PLANNING RESEARCH ASSOCIATES
 1" = 40'
 12-7-78

Site Plan Attached to Petition 72-28
 As Approved 2/5/79
 By [Signature]