

ROADWAY EXPRESS, INC.
(NOW OR FORMERLY)
DEED: 2747 PAGE: 23

CONSOLIDATED FREIGHT WAYS
(NOW OR FORMERLY)
DEED: 3845 PAGE: 808

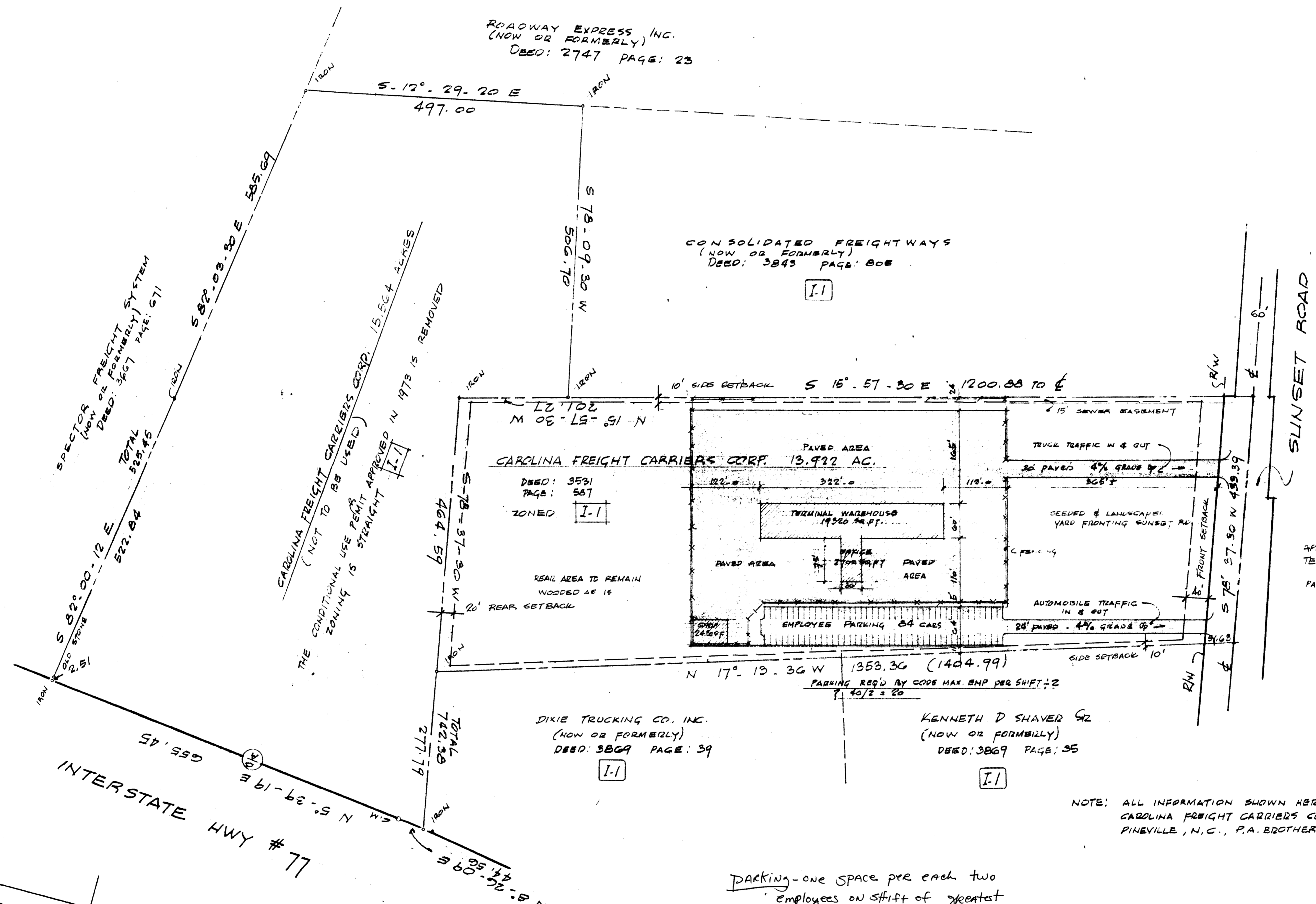

APPLICATION FOR CONDITIONAL USE TRUCK-FREIGHT TERMINAL INVOLVES THIS PARCEL
PARCEL NOT INVOLVED 100 YR FLOOD

DIXIE TRUCKING CO. INC.
(NOW OR FORMERLY)
DEED: 3869 PAGE: 39

KENNETH D SHAVER SR
(NOW OR FORMERLY)
DEED: 3869 PAGE: 35

NOTE: ALL INFORMATION SHOWN HEREON IS TAKEN FROM A SURVEY FOR CAROLINA FREIGHT CARRIERS CORP., PREPARED BY CAROLINA SURVEYORS INC. PINEVILLE, N.C., P.A. BROTHERTON, N.C.R.L.S & DATED MAY 2, 1978.

PARKING - one space per each two employees on shift of greatest employment.
84 spaces allows for 168 employees on shift of greatest employment.

All signs require permits

As Approved by
Co. Comm. 11/6/78

PROPERTY PLAT SCALE 1"=100'
CAROLINA FREIGHT CARRIERS CORP.
LONG CREEK TOWNSHIP
MECKLENBURG COUNTY, N.C.

Petition 78-18(c) Revised
site plan for I-1 Conditional
Freight Terminal

JAMES L. BEAM, JR., A. L. A. & ASSOCIATES ARCHITECTS
GASTONIA, NORTH CAROLINA

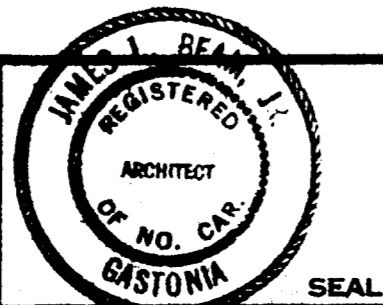

MISCELLANEOUS NOTES:

REVISIONS:	BY	DATE
△		
△		
△		

DRAWN BY	COMM. NO.
CHECKED BY	DATE

TERMINAL BLDG - CHARLOTTE, N.C.
CAROLINA FREIGHT CARRIERS CORP.
HOME OFFICES - CHERRYVILLE, N.C.
SUPPLEMENTARY PROPERTY PLAT

SHEET NO.	
TOTAL	