

ELIZA B. BUMGARDNER
1322-189

SITE INFORMATION

SITE AREA 62,460
BUILDING AREA 59,375 S.F.
PARKING SPACES 284

PAVING REQUIREMENT MAXIMUMS
 1. PERMANENT - 5% OF ONE SPACE FOR EACH 100 SQUARE FEET OF BUILDING AREA. 10% FOR SALES DEPARTMENT FOR NON-PAVED AREA.
 2. ONE SPACE REQUIRED FOR EACH TWO EMPLOYEES. TWENTY EMPLOYEES ESTIMATED PER SPACE.
 TOTAL = 120 SPACES
 * RESTAURANT - ACCO. SF
 1. ONE SPACE REQUIRED FOR EACH 100 SQUARE FEET OF BUILDING AREA. ESTIMATED EQUALS 59 SPACES. ONE SPACE REQUIRED FOR EACH 10 EMPLOYEES. 25 EMPLOYEES ESTIMATED EQUALS 5 SPACES.
 TOTAL = 37 SPACES
 * SHOPS - 1,375
 ONE SPACE REQUIRED FOR EACH 100 SQUARE FEET OF BUILDING AREA. ESTIMATED EQUALS 137 SPACES.
 1,375 - 1,375 = 0 SPACES
 ONE SPACE REQUIRED FOR EACH TWO EMPLOYEES. 25 EMPLOYEES ESTIMATED EQUALS 13 SPACES.
 TOTAL = 11 SPACES
 TOTAL SPACES REQUIRED
 SUPERMARKET 120
 RESTAURANT 37
 SHOPS 99
 TOTAL 256 SPACES REQUIRED
 * 284 SPACES PROVIDED

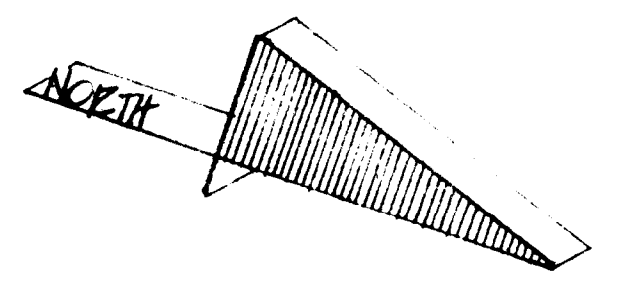

ELIZA B. BUMGARDNER
(NOW OR FORMERLY)
1322-189

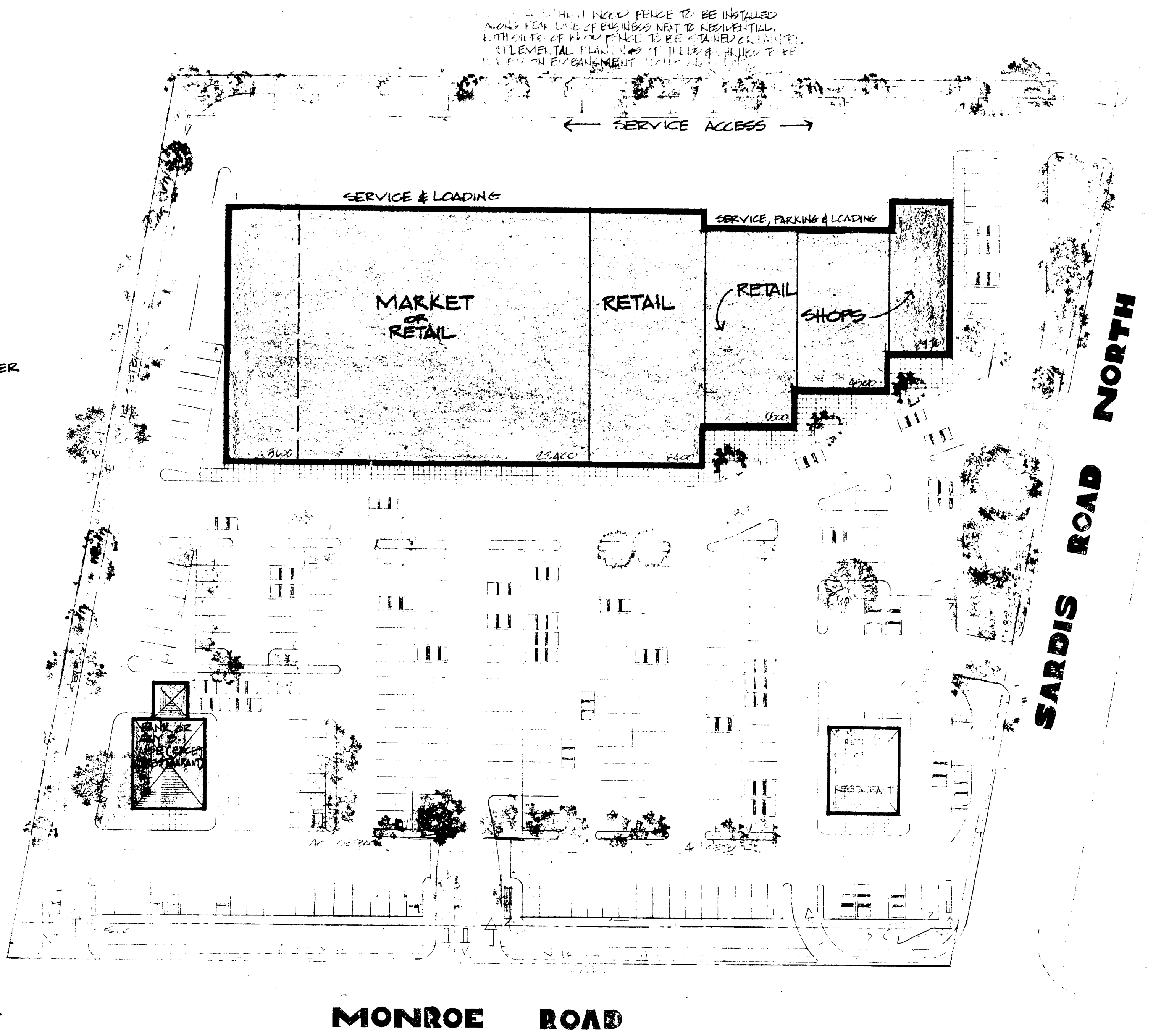

As approved by Co. Commission
7/14/79 79-24(C)

NOTE:
 BUILDING LINES SHOWN MAY BE MODIFIED DURING 180 DAYS FOLLOWING ZONING RESOLUTION TO ACCOMMODATE INDIVIDUAL SHOP TENANTS. TOTAL BUILDING AREA SHALL NOT EXCEED 59,375 SQUARE FEET.
 PARKING COUNT IS FOR PROPOSED USES AND IS IN COMPLIANCE WITH ORDINANCE REQUIREMENTS. THIS MAY BE MODIFIED BASED UPON INDIVIDUAL SHOP NEEDS DURING 180 DAYS FOLLOWING ZONING RESOLUTION, YET SHALL REMAIN IN COMPLIANCE WITH ORDINANCE REQUIREMENTS.

SARDIS PLAZA
CHARLOTTE, N.C.

SCALE 1"=40'

JAMES A. COATES & ASSOCIATES
800 PROVIDENCE ROAD
CHARLOTTE, NORTH CAROLINA 28207

JUNE 1979