

"I, ROBERT A. BURNS certify that on October 30, 1980, I surveyed the property shown on this plat, that the property lines and location of all structures are accurately shown hereon, that no structure located on this property encroaches on any adjacent street or property, and that no structure on adjacent property encroaches on the premises surveyed."

Robert A. Burns

Paul & Janetta Deavers
 1408 Standish Place
 Charlotte, N.C. 28216
 (704) 3995727

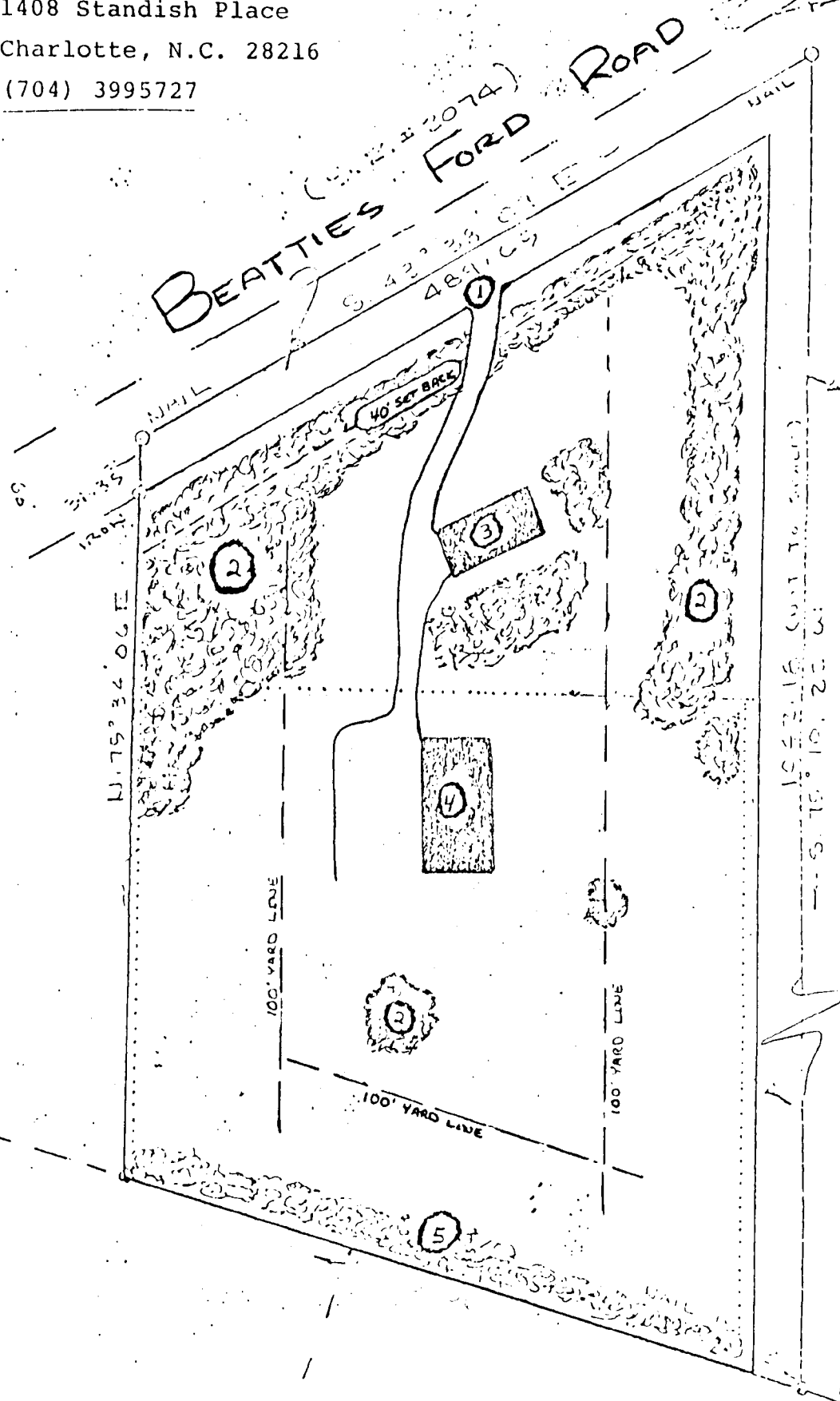

- ① APPROXIMATE LOCATION OF DRIVEWAY 200 FEET FROM EXISTING DRIVEWAY, (EASEMENT ROAD TO MIDAS SPRINGS) 260 FEET FROM PROPERTY LINE.
- ② APPROXIMATE LOCATION OF TREES TO REMAIN
- ③ APPROXIMATE LOCATION OF SINGLE FAMILY RESIDENCE.
- ④ APPROXIMATE LOCATION OF STABLE FOR A MAXIMUM OF 8 STALLS.
- ⑤ APPROXIMATE LOCATION OF EXISTING HEDGE ROW TO REMAIN.

*As Approved By
 County Commission
 11/18/82*

PROPERTY OF
PAUL S. DEAVERS & WIFE JANETTA A. DEAVERS

REQUEST FOR REZONING FROM R-15 TO RU (CD) FOR THE PURPOSE OF A PRIVATE RIDING ACADEMY, TO HOUSE OWNER'S EIGHT PERSONAL SHOW HORSES

Revised Copy - December 15, 1981

Began construction on single family residence on Friday December 11, 1981. Due to terrain conditions, it was necessary to relocate driveway (Item #1) to a position approximately 200 feet from existing driveway, and approximately 260 feet from the Deavers/Buchana property line.