

EXISTING WILLOW OAKS (10-18" CALIPER) TO BE SAVED

EARTH MOUNDS (TYP) HEIGHT VARIES FROM 2'-4'

GROUND COVER & SHRUB AREAS

FOOTBRIDGE OVER CREEK (TOTAL 4 OVER CREEK)

EXISTING CREEK BANK TO BE LINED WITH LARGE RIP RAP

EXISTING 6' ELLIPTICAL CORR. METAL PIPE

**ZONING CRITERIA**

DENSITY PROPOSED - 100 BED NURSING HOME - REST HOME + 42 BED SELF-CARE UNIT

**DENSITY ALLOWED**

213,620 SF LAND AREA  
 - 9,000 (FIRST FIVE PATIENTS)  
 204,620 SF. TOTAL

NOTE: FOR EVERY 5 PATIENTS NEED 25000 SF.  
 204,620 SF ÷ 2500 = 81.5 SF/5 PATIENTS  
 81.5 x 5 = 407 PATIENTS ALLOWED

222 PATIENTS PROPOSED

**PARKING**

1 SPACE/4 PATIENTS 222 ÷ 4 = 56

1 SPACE/2 EMPLOYEES 40 ÷ 2 = 20  
 76 SPACES REQUIRED  
 86 SPACES SHOWN

SEABOARD R.R. EXISTING THICK VEGETATION TO REMAIN AS VISUAL AND NOISE BARRIER TO RAILROAD

OUTDOOR RECREATION - BAR-B-QUE AREA TO BE SET UNDER EXISTING MATURE FOREST OF OAKS, MAPLES AND SWEETGUMS. (15"-24" CALIPER)

**ADJACENT PROPERTY OWNERS**

- 1 CRAIG, P.
- 2 CRAIG, D.
- 3 DILLARD, B.
- 4 DANNER, T.
- 5 DILLARD, B.
- 6 DILLARD, B.
- 7 ADRIAN, HM.
- 8 BAILEY (HUNTLEY)
- 9 CHAR.-MECK. BD. ED.

As Approved by City Council  
 2/22/82

Pet.# 81-68  
 David D. Little, III



SCALE 1"=40'

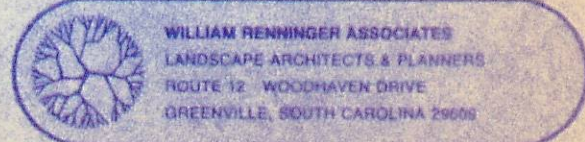

**ZONING REQUEST CHANGE FROM**  
 R9 MF CD (NURSING HOME, REST HOME & HOME FOR AGED) & R9 MF TO PLAN AMENDMENT AND R9 MF CD, R9 MF CD (NURSING HOME, REST HOME & HOME FOR AGED)  
 CRAIG AVENUE CHARLOTTE N.C.

**CECIL ASSOCIATES INC.**  
**ARCHITECTS-ENGINEERS**  
 SPARTANBURG, S. C.

DATE 11-25-80	SHEET NO.
REV. 9-16-81	
10-2-81	
12-11-81	
1-25-82	OF

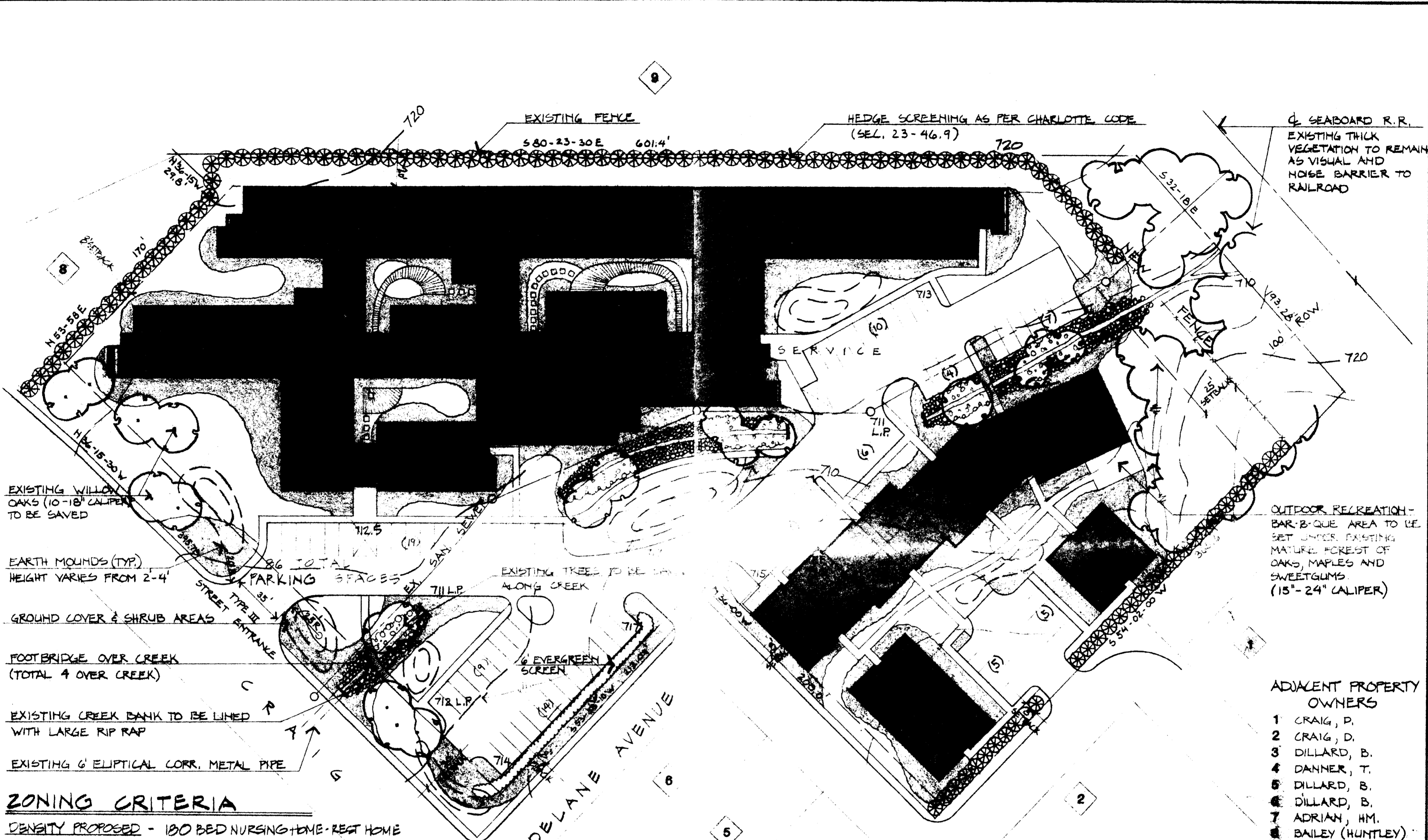

SEABOARD R.R.  
EXISTING THICK  
VEGETATION TO REMAIN  
AS VISUAL AND  
NOISE BARRIER TO  
RAILROAD

OUTDOOR RECREATION-  
BAR-B-QUE AREA TO BE  
SET UNDER EXISTING  
MATURE FOREST OF  
OAKS, MAPLES AND  
SWEETGUMS.  
(15"-24" CALIPER)

- ADJACENT PROPERTY OWNERS
- 1 CRAIG, P.
  - 2 CRAIG, D.
  - 3 DILLARD, B.
  - 4 DANNER, T.
  - 5 DILLARD, B.
  - 6 DILLARD, B.
  - 7 ADRIAN, HM.
  - 8 BAILEY (HUNTLEY)
  - 9 CHAR.-MECK. BD. ED.

EXISTING WILLOW  
OAKS (10-18" CALIPER)  
TO BE SAVED

EARTH MOUNDS (TYP.)  
HEIGHT VARIES FROM 2'-4'

GROUND COVER & SHRUB AREAS

FOOTBRIDGE OVER CREEK  
(TOTAL 4 OVER CREEK)

EXISTING CREEK BANK TO BE LINED  
WITH LARGE RIP RAP

EXISTING 6' ELLIPTICAL CORR. METAL PIPE

**ZONING CRITERIA**

DENSITY PROPOSED - 180 BED NURSING HOME-REST HOME  
+ 42 BED SELF-CARE UNIT

**DENSITY ALLOWED**

213,620 S.F. LAND AREA  
- 9,000 (FIRST FIVE PATIENTS)  
204,620 SF. TOTAL

NOTE: FOR EVERY 5 PATIENTS NEED 2500S.F.  
204,620 SF ÷ 2500 = 81.5 SF./5 PATIENTS  
81.5 x 5 = 407 PATIENTS ALLOWED

**PARKING**

1 SPACE/4 PATIENTS 222 ÷ 4 = 56

1 SPACE/2 EMPLOYEES 40 ÷ 2 = 20

76 SPACES REQUIRED  
86 SPACES SHOWN

As Approved by City Council  
2/22/82

Pet # 81-68  
David D. Little, III

SCALE 1"=40'

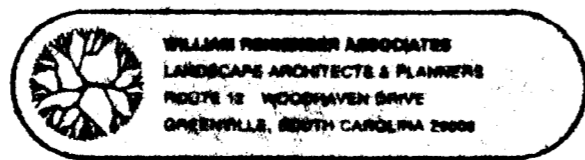

ZONING REQUEST CHANGE FROM  
R-9 MF TO R-9 MF CD (NURSING HOME, REST HOME & HOME FOR THE AGED)  
TO PLAN AMENDMENT AND  
REVISIONS TO R-9 MF CD (NURSING HOME, REST HOME & HOME FOR THE AGED)  
ON DELANE AVENUE CHARLOTTE N.C.

**CECIL ASSOCIATES INC.**  
**ARCHITECTS-ENGINEERS**  
SPARTANBURG, S. C.

DATE 11-25-80	SHEET NO.
REV. 9-16-81	
10-2-81	
12-11-81	
1-25-82	OF