

Maximum Housing Units 51
 Site Land Area 4.35 acres
 Parking Spaces 18
 Parking Spaces Required 13
 Project is for Elderly as defined by HUD Regulations

Housing Unit Tally
 UNIT TYPE A CONTAINS 4 ONE BEDROOM UNITS
 UNIT TYPE B CONTAINS 3 ONE BEDROOM UNITS
 1 COMMUNITY UNIT

Notes

1. REVIEW OF ALL UTILITIES ENTRY AND EXIT TO THE PROJECT AND UNIT IF APPROPRIATE DEVELOPMENT REQUIRED.
2. ALL UTILITIES AND PARKING AREAS ARE SHOWN IN THIS PLAN. LOCATIONS, SPECIFIC LOCATIONS MAY VARY DUE TO DETAIL STUDY.
3. ALL UTILITIES FROM NORTH SHARON AMITY ROAD TO THE PROJECT ARE SHOWN WITH TRUNK MAINS AND BRANCHES AND CONNECTIONS.
4. BUILDING UNIT ARE SHOWN IN COMPLIANCE WITH ALL LOCAL AND STATE BUILDING CODES. ALL BUILDING UNITS ARE TO BE CONSTRUCTED IN ACCORDANCE WITH ALL LOCAL AND STATE BUILDING CODES.
5. ALL BUILDING UNITS TO BE CONSTRUCTED IN ACCORDANCE WITH ALL LOCAL AND STATE BUILDING CODES.
6. ALL BUILDING UNITS TO BE CONSTRUCTED IN ACCORDANCE WITH ALL LOCAL AND STATE BUILDING CODES.
7. ALL BUILDING UNITS TO BE CONSTRUCTED IN ACCORDANCE WITH ALL LOCAL AND STATE BUILDING CODES.

RENTAL UNIT COUNT:	BLDG. NO.	ONE BEDROOM UNITS
	1	8
	2	8
	3	12
	4	8
	5	3
	6	12
TOTAL RENTAL UNITS		51

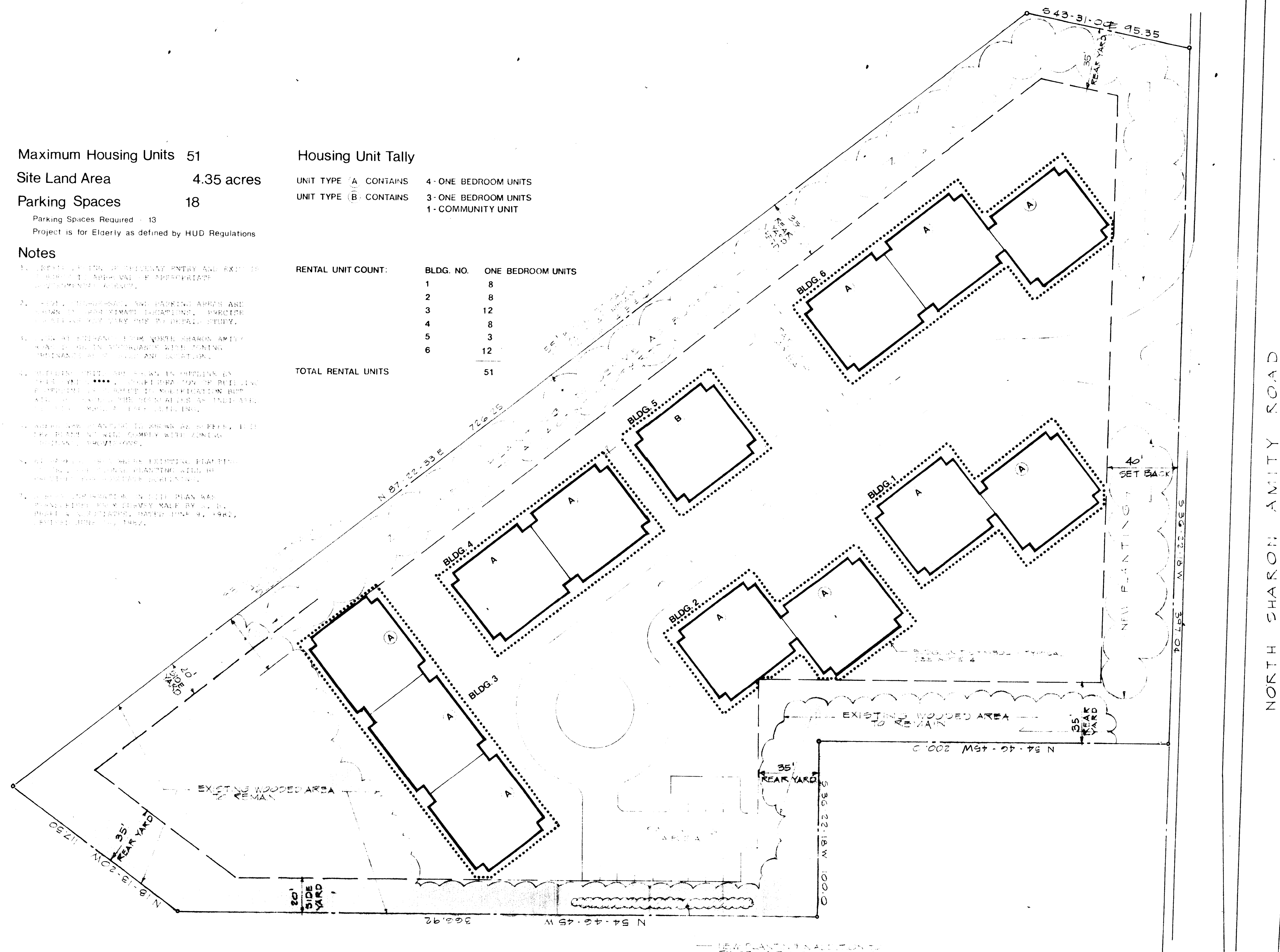

NORTH SHARON AMITY ROAD

Site Plan

1" = 30'

Gantt/Huberman Associates: Architects and Planners

Charlotte NC Project No. 239 Date 8/25/82

Sharon Amity Homes for Senior Citizens

Charlotte NC

Catawba Economic Development Association

Charlotte NC Petition 82 50 Application for R9 to R9MF-CD

Pet. # 82-50
 Catawba Economic Development
 Association Inc.

P.C. approval
 82-50
 Approved by City
 Council 10/18/82