

Maximum Housing Units 51
 Site Land Area 4.35 acres
 Parking Spaces 18
 Parking Spaces Required 13
 Project is for Elderly as defined by HUD Regulations

Housing Unit Tally
 UNIT TYPE (A) CONTAINS 4 - ONE BEDROOM UNITS
 UNIT TYPE (B) CONTAINS 3 - ONE BEDROOM UNITS
 1 - COMMUNITY UNIT

Notes

1. DETAIL DESIGN OF DRIVEWAY ENTRY AND EXIT IS SUBJECT TO APPROVAL OF APPROPRIATE GOVERNMENTAL AGENCY.
2. DRIVE, CUL-DE-SAC, AND PARKING AREAS ARE SHOWN IN APPROXIMATE LOCATIONS. PRECISE LOCATIONS MAY VARY DUE TO DETAIL STUDY.
3. SIGN AT ENTRANCE FROM NORTH SHARON AMITY ROAD TO BE IN ACCORDANCE WITH ZONING ORDINANCE AS TO SIZE AND LOCATION.
4. BUILDING UNITS ARE SHOWN IN OUTLINE BY THIS SYMBOL****. CONFIGURATION OF BUILDING FOOTPRINT IS SUBJECT TO MODIFICATION BUT WILL NOT EXCEED THE BOUNDARIES AS INDICATED BY THIS SYMBOL AT EACH BUILDING.
5. WHERE NEW PLANTING IS SHOWN AS BUFFER, THIS NEW PLANTING WILL COMPLY WITH ZONING ORDINANCE PROVISIONS.
6. AT PARKING AREA WHERE EXISTING PLANTING OCCURS, ADDITIONAL PLANTING WILL BE PROVIDED FOR ADEQUATE SCREENING.
7. SURVEY INFORMATION ON SITE PLAN WAS TRANSCRIBED FROM SURVEY MADE BY R. B. PHARR & ASSOCIATES, DATED JUNE 9, 1982, REVISED JUNE 14, 1982.

RENTAL UNIT COUNT:

BLDG. NO.	ONE BEDROOM UNITS
1	8
2	8
3	12
4	8
5	3
6	12
TOTAL RENTAL UNITS	51

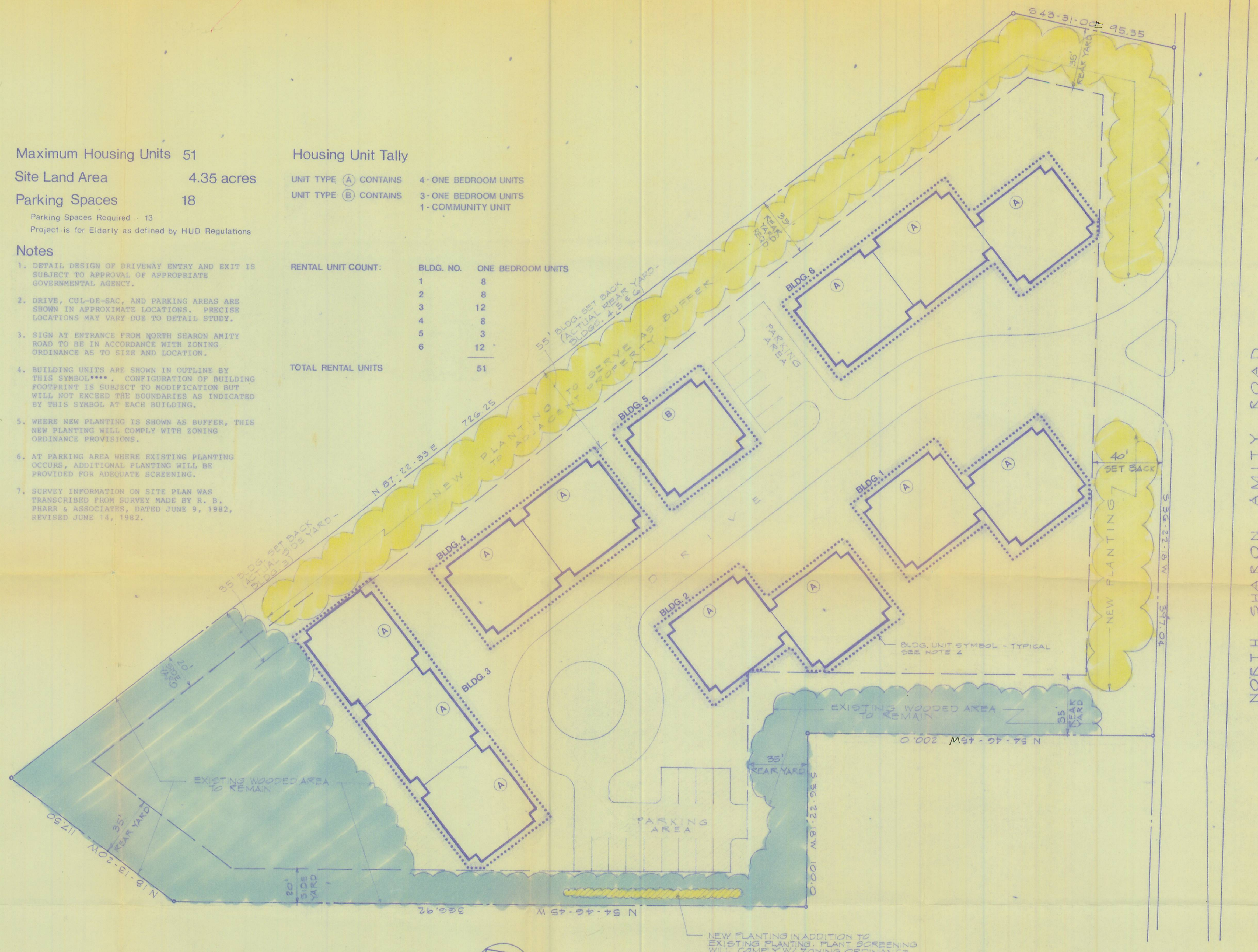

NORTH SHARON AMITY ROAD

Site Plan

1" = 30'

Gantt/Huberman Associates: Architects and Planners

Charlotte NC Project No. 239 Date 8/25/82

Sharon Amity Homes for Senior Citizens

Charlotte NC

Catawba Economic Development Association

Charlotte NC Petition 82 50 Application for R9 to R9MF-CD

Per. # 82-50

Catawba Economic Development
 Association Inc.

P.C. approval

82-50

Approved by City
 Council 10/18/82