



* 0 0 B R E A K 0 0 *



**ADVANCED
IMAGING
SYSTEMS**

www.aisimc.com

An Information
Management Company

City of Charlotte – Planning Dept. Scanning Rezoning Files

Petition # _____

Document type:

- Applications
- Correspondence
- Department Comments
- Land Use Consistency
 - Mail Info
 - Mapping
 - Other
- Site Plans



* 0 0 B R E A K 0 0 *

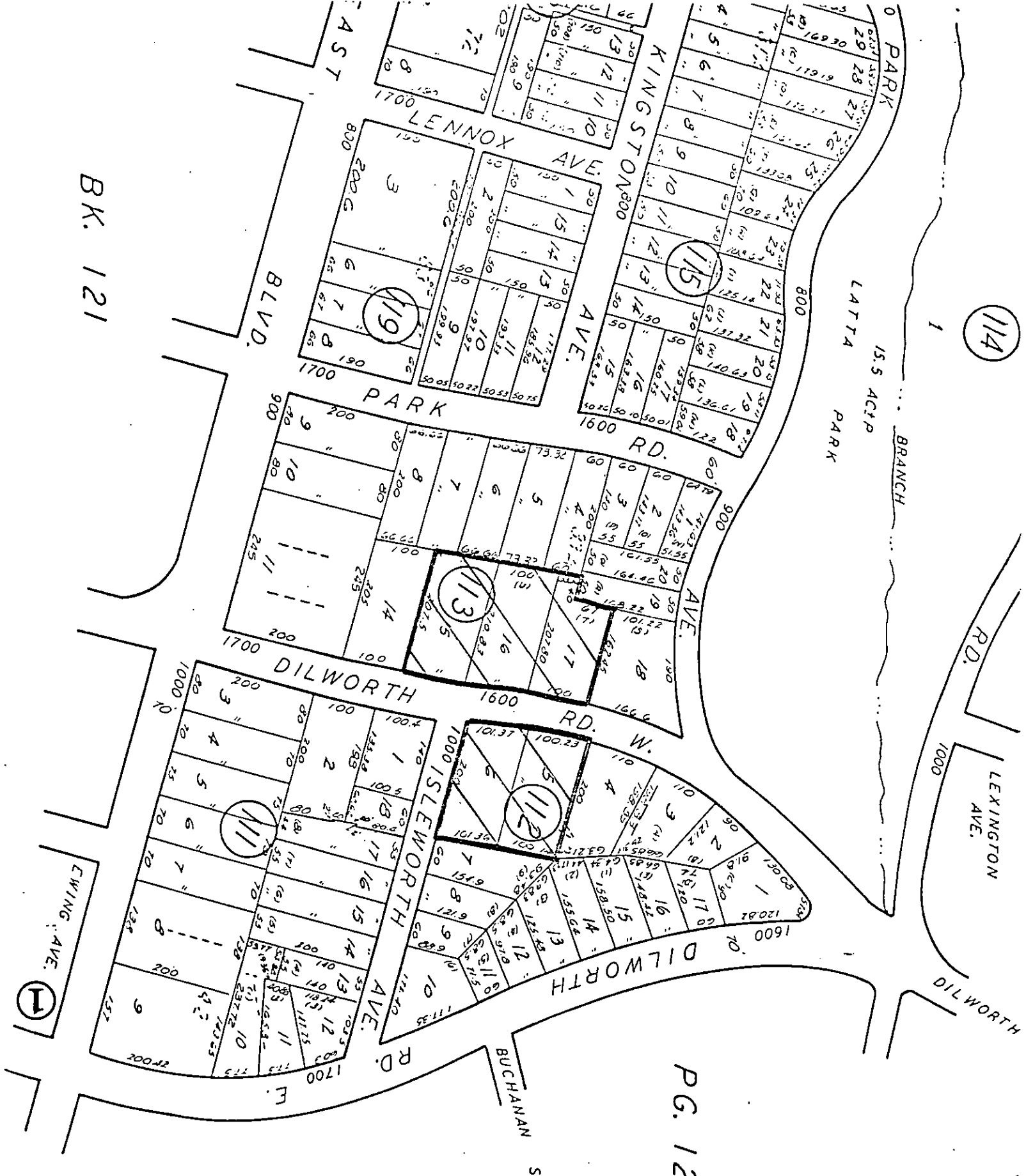

BK. 121

PG. 12

PROPERTY INFORMATION

PETITION NO. 82-84

123-112-05

BARNES BETTY B MRS P B
BY WILL \$43,460.
1627 DILWORTH RD W
CHARLOTTE, N.C. 28203

123-113-16

WITROW EARL CALVIN E
WIFE ELEANOR E \$39,660.
1660 DILWORTH RD W
CHARLOTTE, N.C. 28203

123-112-06

BARNES BETTY B MRS P B
BY ENTIRETY \$9,500.
1627 DILWORTH RD W
CHARLOTTE, N.C. 28203

123-113-17

MEYD PETER F & W F
DELORES H \$49,070.
1652 DILWORTH DR
CHARLOTTE, N.C. 28203

123-113-15

CRAWFORD JOHN A & W
ELIZABETH V
1700 DILWORTH RD W \$40,790.
CHARLOTTE, N.C. 28203

DILWORTH SMALL AREA PLAN

PETITIONS FOR ZONING CHANGES - JANUARY 18, 1983

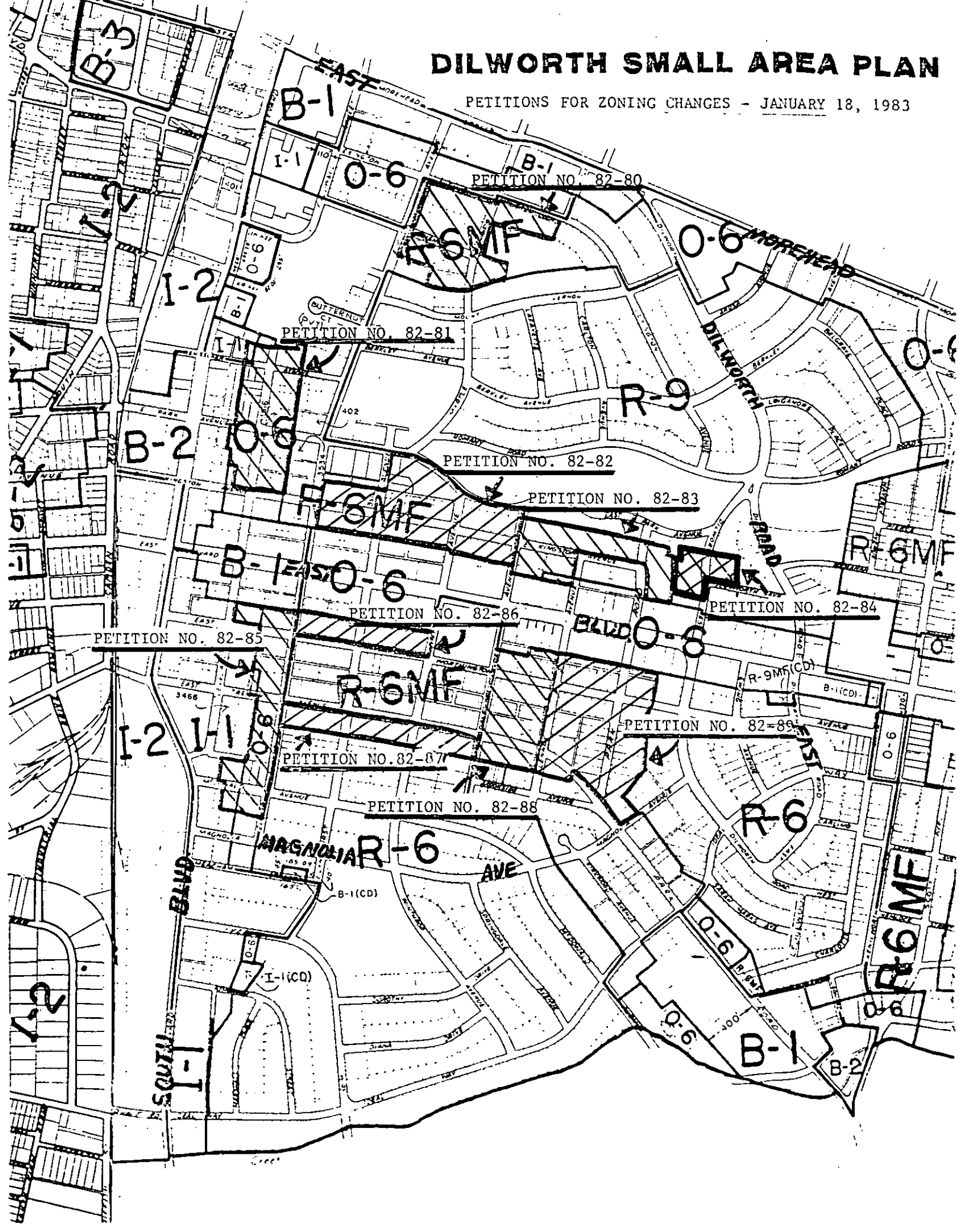

PETITIONER Charlotte-Mecklenburg Planning Commission

PETITION NO. 82-84 HEARING DATE 1/18/83

ZONING CLASSIFICATION, EXISTING R-6MF REQUESTED R-9

LOCATION An area including 5 parcels along Dilworth Road West just south of East Park Avenue in the Dilworth neighborhood.

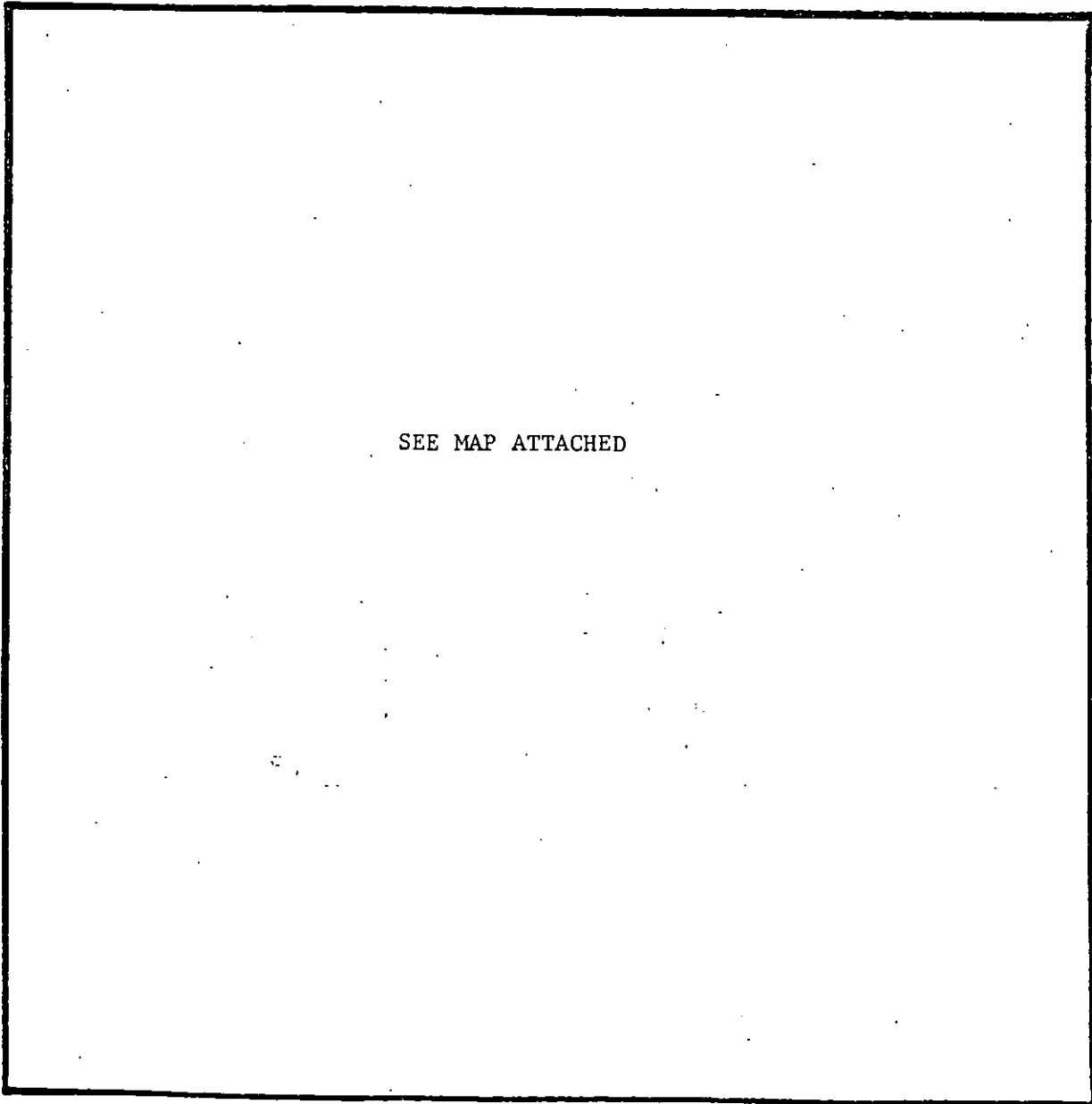

ZONING MAP NO. 9

SCALE 1" = 800'

PROPERTY PROPOSED FOR CHANGE



114

1

1

1

1

1

1

1

1

1

1

1

1

1

1

1

1

1

1

1

1

1

1

1

1

1

1

1

1

1

1

1

1

1

1

1

1

1

1

1

1

1

1

1

1

1

1

1

1

1

1

1

1

1

1

1

1

1

1

1

1

1

1

1

1

1

1

1

1

1

1

1

1

1

1

1

1

1

1

1

1

1

1

1

1

1

1

1

1

1

1

1

1

1

1

1

1

1

1

1

1

1

1

1

1

1

1

1

1

BK. 121

PG. 12

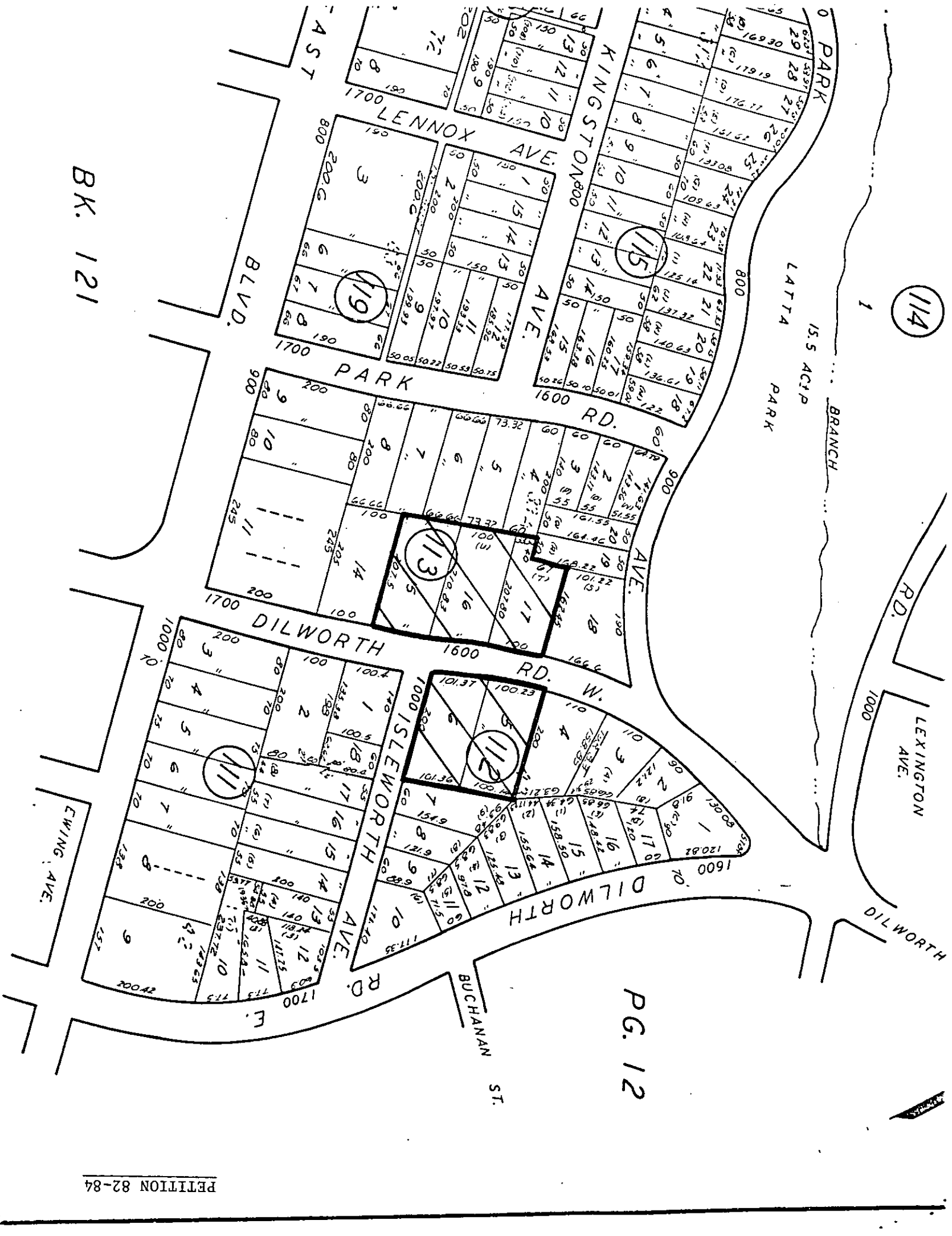

OFFICIAL REZONING APPLICATION

CITY OF CHARLOTTE

Ownership Information

Property Owner _____
See Attachment - 5 Parcels

Owner's Address _____

Date Property Acquired _____

Deed Reference _____

Tax Parcel Number _____

Location Of Property (address or description) _____
Along Dilworth Road West just south of E. Park Avenue in Dilworth.

Description Of Property

Size (Sq. Ft.-Acres) _____

Street Frontage (ft.) _____

Current Land Use _____

Zoning Request

Existing Zoning _____

R-6MF

Requested Zoning _____

R-9

Purpose of zoning change _____
Implement Dilworth Small Area Plan.

Name of Agent _____

Agent's Address _____

Telephone Number _____

Charlotte-Mecklenburg Planning Comm.
Name of Petitioner(s) _____
302 S. McDowell St., Charlotte, N.C.
Address of Petitioner(s) _____
374-2205 28204
Telephone Number _____

Signature _____

Signature of Property Owner if Other Than Petitioner _____

OFFICE USE ONLY

Received By Kenneth S. Davis

Date Filled December 9, 1982

Petition No. 82-84