

PROJECT SUMMARY

EXISTING ZONING	R-12 & R-GMF
PROPOSED ZONING	O-15(CD)
SITE AREA	±10.8 A. (GROSS)
BUILDING AREA	85,200 SF. (GROSS)
MAX. BLDG. HT.	2 STORIES (40 FT.)
PARKING SPACES REQ'D.	426
PARKING SPACES PROVIDED	±450
YARD & SETBACK REQ'MTS:	

FRONT = 40 FT. REAR = 40 SIDES = 8 FT.
 (SIGNAGE & SCREENING TO MEET ORDINANCE REQUIREMENTS.)
 (BUILDING & PARKING AREAS SHOWN REPRESENT DESIGN CONCEPT
 ONLY, AND MAY CHANGE WHEN ACCURATE SITE INFO. IS AVAILABLE.)

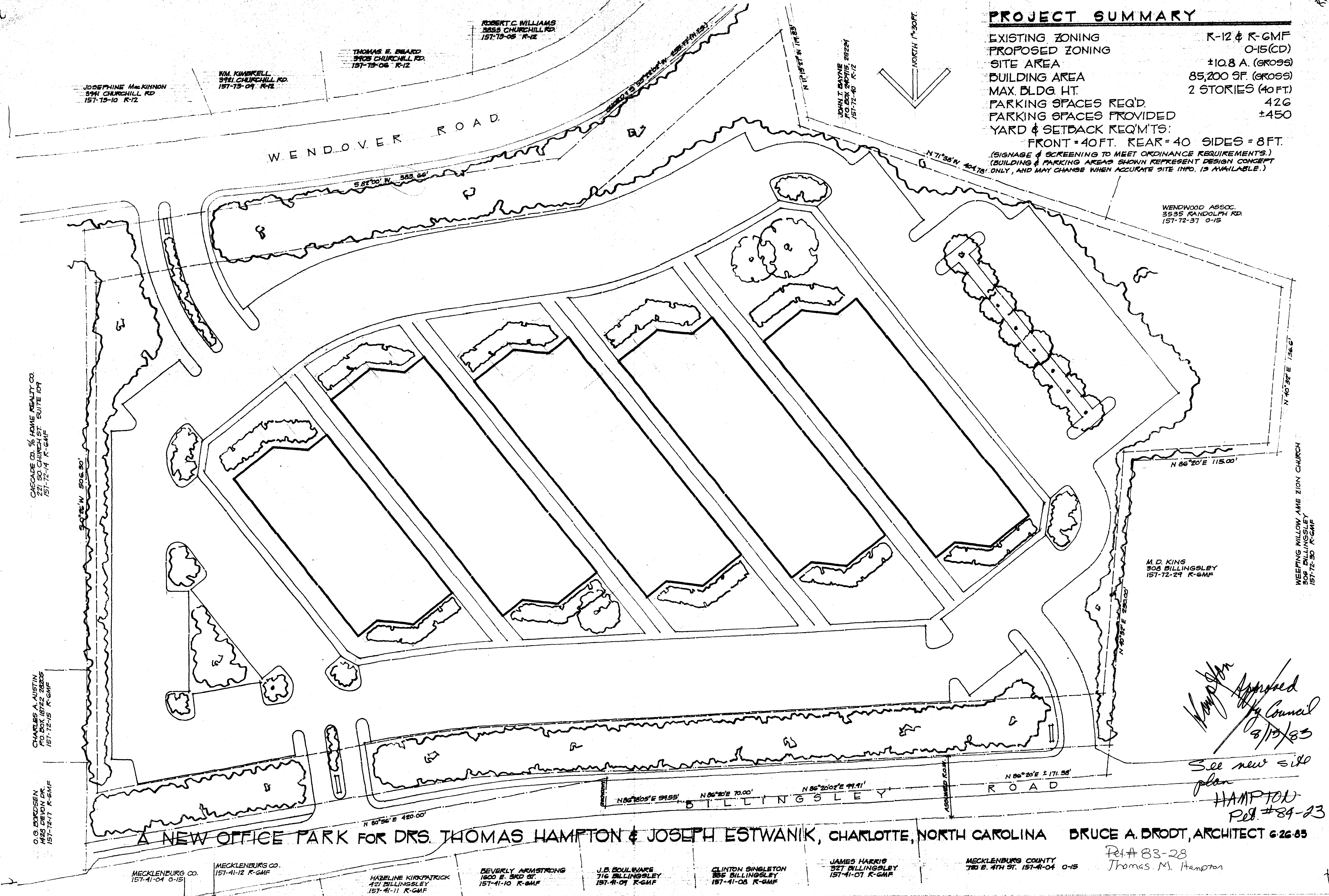

A NEW OFFICE PARK FOR DRS. THOMAS HAMPTON & JOSEPH ESTWANIK, CHARLOTTE, NORTH CAROLINA DRUCE A. BRODT, ARCHITECT 6-26-85

Approved by Council
 8/19/85

See new site plan
 HAMPTON
 Ref. #84-23

- MECKLENBURG CO. 157-41-04 O-15
- MECKLENBURG CO. 157-41-12 R-GMF
- HAZELINE KIRKPATRICK 421 BILLINGSLEY 157-41-11 R-GMF
- BEVERLY ARMSTRONG 1600 E. 3RD ST. 157-41-10 R-GMF
- J.B. BOULWARE 716 BILLINGSLEY 157-41-09 R-GMF
- CLINTON SINGLETON 385 BILLINGSLEY 157-41-08 R-GMF
- JAMES HARRIS 327 BILLINGSLEY 157-41-07 R-GMF
- MECKLENBURG COUNTY 780 E. 4TH ST. 157-41-04 O-15
- Ref. # 83-28 Thomas M. Hampton

CASCADE CO. 2/1 HOME REALTY CO. 221 SO. CHURCH ST. SUITE 104 157-72-14 R-GMF

CHARLES A. AUSTIN P.O. BOX 18722 28205 157-72-15 R-GMF

O.G. BORDEN 1428 DEVON DR. 157-72-17 R-GMF

JOSEPHINE MacKINNON 594 CHURCHILL RD. 157-75-10 R-12

WM. KIMMELL 3741 CHURCHILL RD. 157-75-09 R-12

THOMAS E. BEARD 3705 CHURCHILL RD. 157-75-06 R-12

ROBERT C. WILLIAMS 3853 CHURCHILL RD. 157-75-05 R-12

JOHN T. BAYNE P.O. BOX 240715, 28224 157-72-40 R-12

WENDWOOD ASSOC. 3535 RANDOLPH RD. 157-72-37 O-15

M.D. KING 308 BILLINGSLEY 157-72-29 R-GMF

WEEPING WILLOW AME ZION CHURCH 308 BILLINGSLEY 157-72-30 R-GMF