

APPROVED BY COUNTY COMMISSION
 DATE 4/5/84

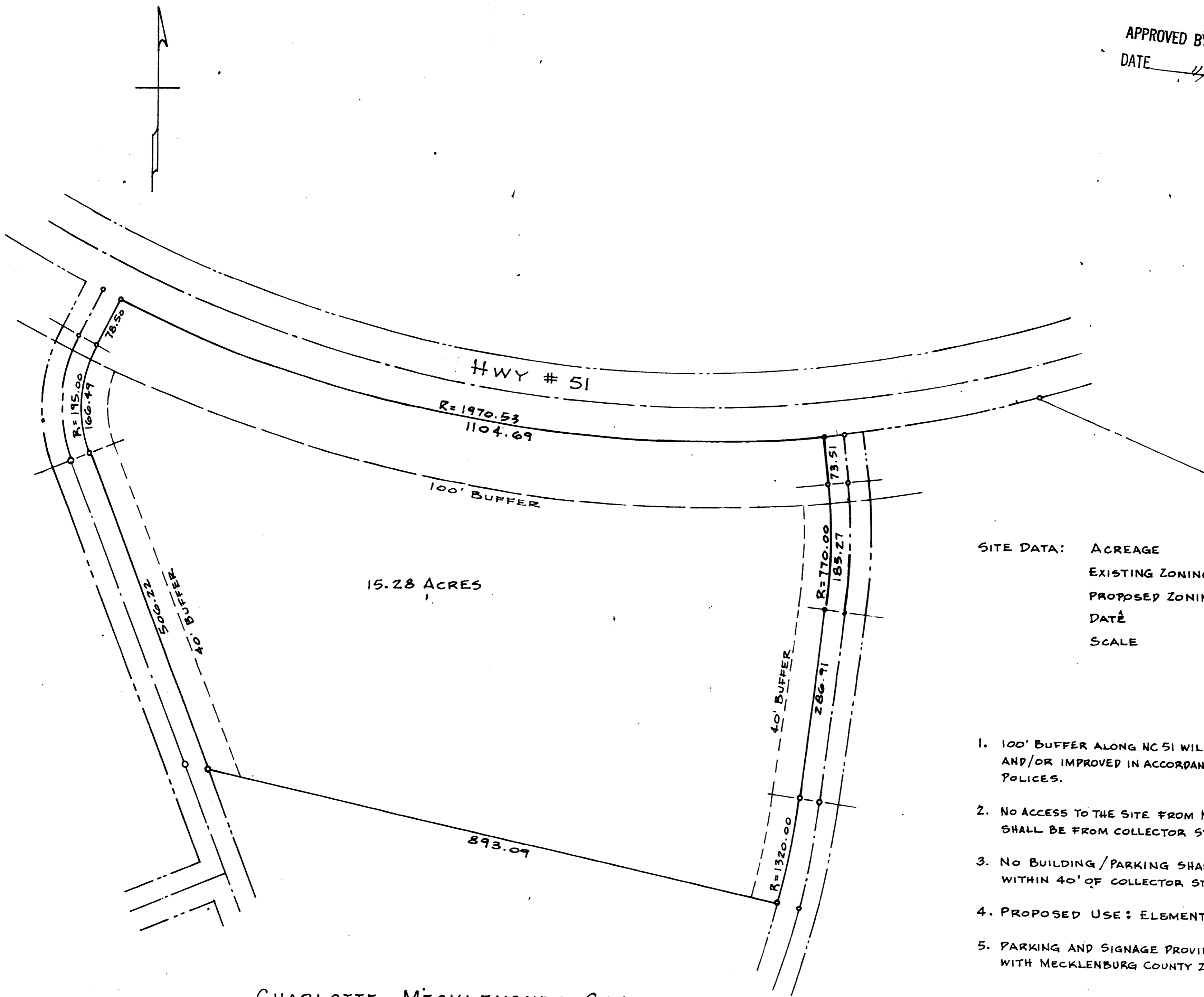

SITE DATA:	ACREAGE	- 15.28
	EXISTING ZONING	- R-20MF
	PROPOSED ZONING	- R-15 (CD)
	DATE	- OCT. 1, 1984
	SCALE	- 1" = 100'

1. 100' BUFFER ALONG NC 51 WILL BE MAINTAINED AND/OR IMPROVED IN ACCORDANCE WITH NC 51 POLICES.
2. NO ACCESS TO THE SITE FROM NC 51. ALL ACCESS SHALL BE FROM COLLECTOR STREETS.
3. NO BUILDING/PARKING SHALL BE PERMITTED WITHIN 40' OF COLLECTOR STREET R/W.
4. PROPOSED USE: ELEMENTARY SCHOOL.
5. PARKING AND SIGNAGE PROVIDED IN ACCORDANCE WITH MECKLENBURG COUNTY ZONING ORDINANCE.

CHARLOTTE - MECKLENBURG SCHOOLS
 PROPOSED ELEMENTARY SCHOOL
 SCALE: 1" = 100' OCT. 1, 1984