

28/06/85
 J. Sherrill
 J. Sherrill

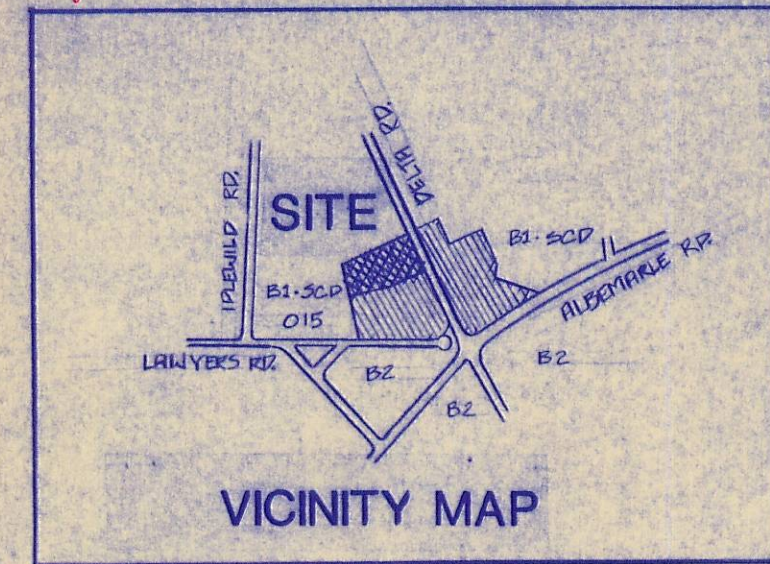

PROJECT INFORMATION

ORIGINAL PETITIONER- Jesse Waller, Delta 10 Group, Petition #85-40

ZONING- BI-SCD

PROPOSED USE- Miscellaneous Retail Shops

LAND AREA- 4.35 acre or 189,486 square feet

BUILDING AREAS

Building #1-	34,550 s.f.
Building #2-	11,760 s.f.
TOTAL AREA	46,310 S.F.

PARKING PROVIDED 238 Spaces (193 GENERAL, 45 EMPLOYEES)

PARKING REQUIRED 230 spaces (185 GENERAL, 45 EMPLOYEES)

SALES AREA 37,048 s.f.
80% of gross

Design Development
 JIM SHERRILL, JR., ARCHITECT
 1100 LOGGERS COURT, SUITE A103, RALEIGH, NC 27609
 (919) 978-3690



12AUG86

Delta Village Center
 DELTA ROAD AT ALBEMARLE ROAD
 CHARLOTTE, NORTH CAROLINA

SP-2

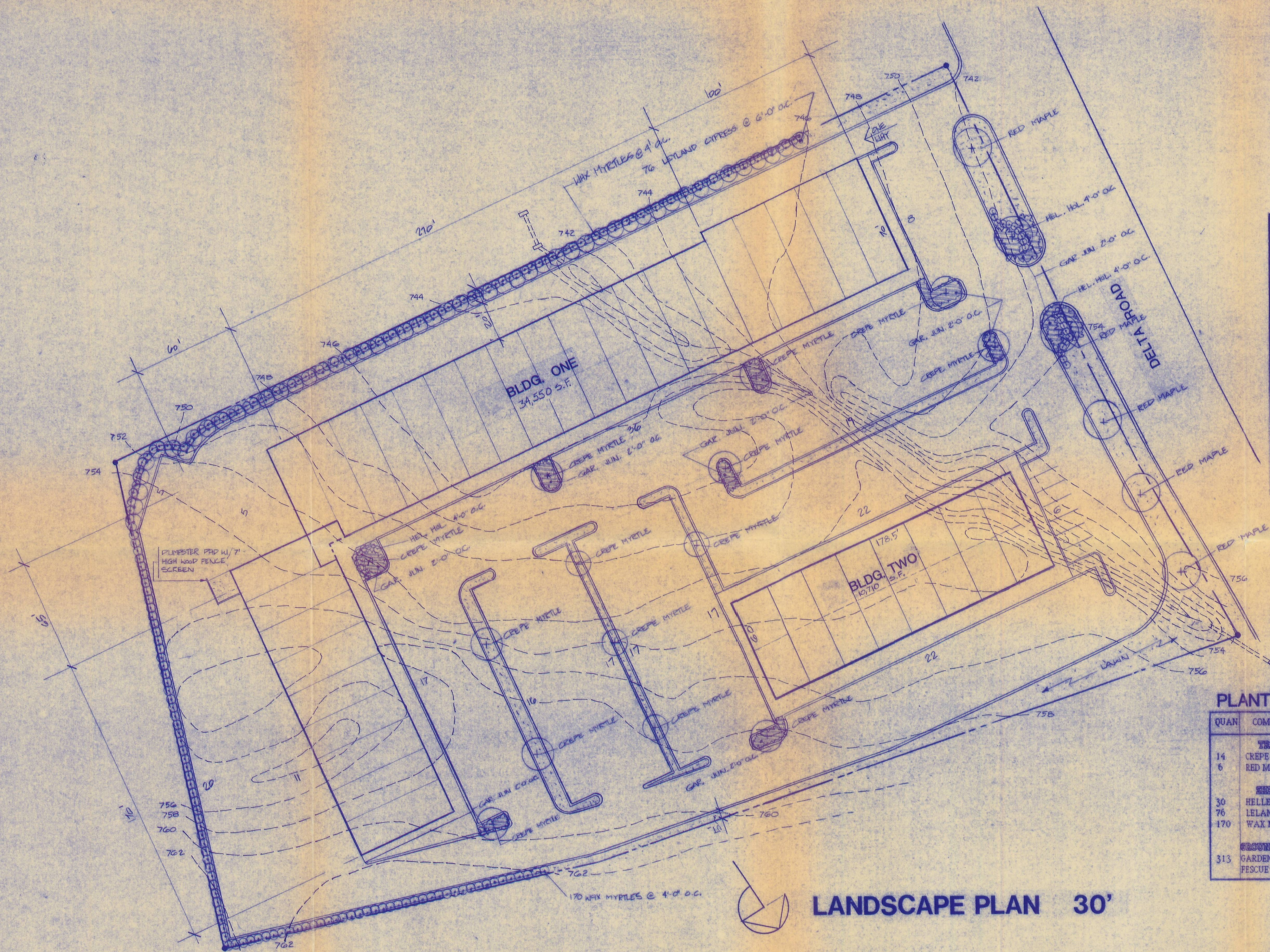

PLANT LIST

QUAN	COMMON	BOTANICAL	HT	SPR	ROOT	REMARKS
14	CREPE MYRTLE	LAGER. INDICA	6-8	3-4	BB	RED OR PINK
6	RED MAPLE	ACER RUBRUM	12'	5-6	BB	2" CALIPER
SHRUBS						
30	HELLER HOLLY	ILEX CRE. HELL.	8-12'	10-15"	3 GAL	
76	LELAND CYPRESS	CUPRESSOCYPARIS	6'-8'	8'-4'	2 GAL	
170	WAX MYRTLE	MYRICA CERIFERA	2-2.5'	1.5-2'	3 GAL	
GROUND COVERS						
313	GARDEN JUNIPER	JUN. HORIZ.	--	12-15"	1 GAL	
	FESCUE GRASS					

LANDSCAPE PLAN 30'

Jim Sherrer, Jr.

Design Development
JIM SHERRER, JR., ARCHITECT
 1100 LOGGERS COURT, SUITE 103, BALFOUR, NC 27609
 (919) 876-3690

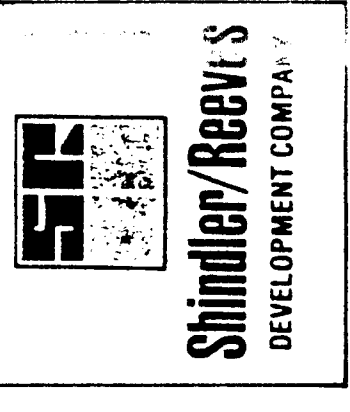
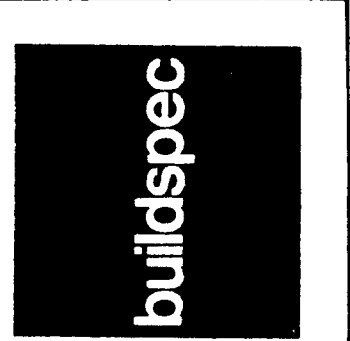

8SEPT86

Delta Village Center
 DELTA ROAD AT ALBEMARLE ROAD
 CHARLOTTE, NORTH CAROLINA

SP-2

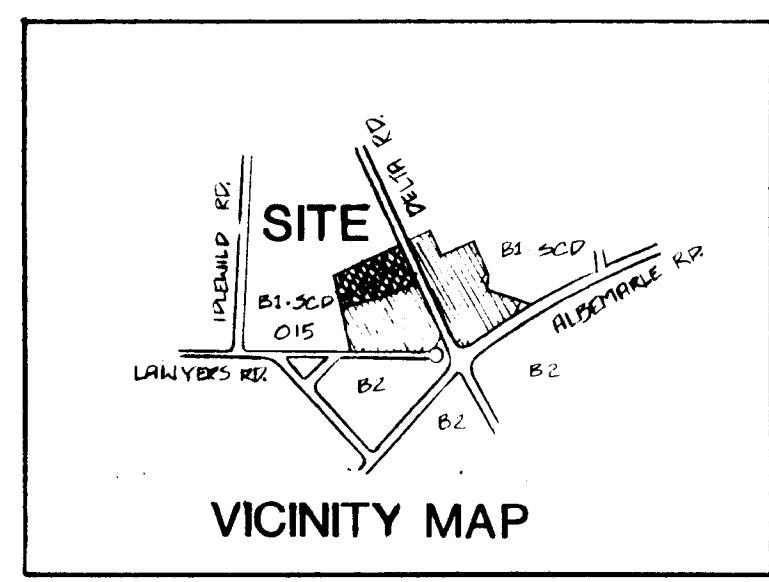

PROJECT INFORMATION

ORIGINAL PETITIONER- Jesse Waller, Delta IO Group, Petition #85-40

ZONING- BI-SCD

PROPOSED USE- Miscellaneous Retail Shops

LAND AREA- 4.35 acres or 189,486 square feet

BUILDING AREAS

Building #1-	34,550 s.f.
Building #2-	11,760 s.f.
TOTAL AREA	46,310 S.F.

PARKING PROVIDED 238 Spaces (193 GENERAL, 45 EMPLOYEES)

PARKING REQUIRED 230 spaces (185 GENERAL, 45 EMPLOYEES)

SALES AREA 37,048 s.f.
80% of gross

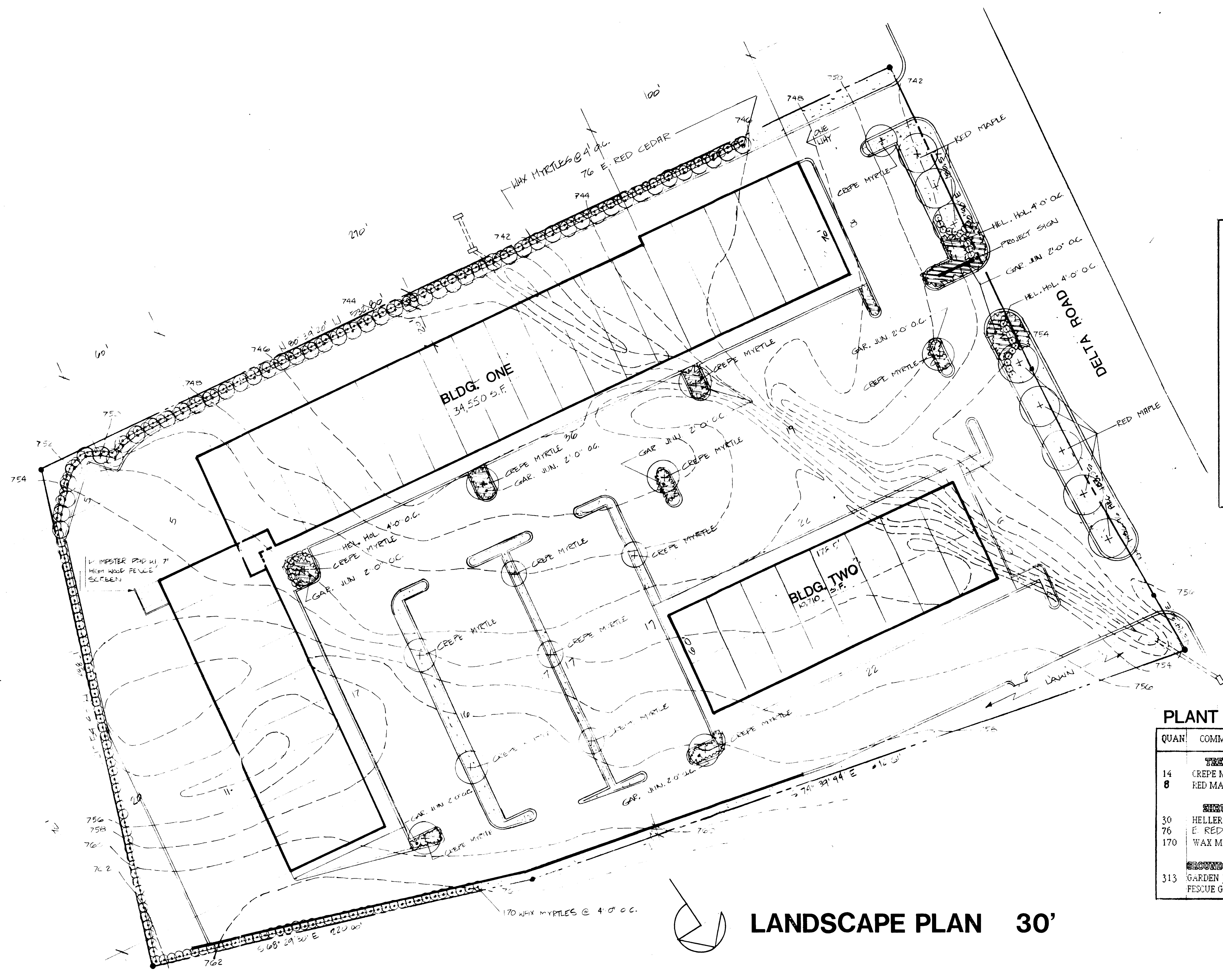

PLANT LIST

QUAN	COMMON	BOTANICAL	HT.	SPR	ROOT	REMARKS
TREES						
14	CREPE MYRTLE	LAGER INDICA	6-8	3-4	BB	RED OR PINK
8	RED MAPLE	ACER RUBRUM	12'	5-6	BB	2" CALIPER
SHRUBS						
30	HELLER HOLLY	ILEX CRE HELL	8-12'	10-15'	3 GAL	
76	E RED CEDAR	JUN. VIR. CANADENSIS	6-8'	8-4'	2 GAL	
170	WAX MYRTLE	MYRTICA CERIFERA	2-2.5'	1.5-2'	3 GAL	
GROUND COVERS						
313	GARDEN JUNIPER	JUN. HORIZ	--	12-15'	1 GAL	
	FESCUE GRASS					

LANDSCAPE PLAN 30'

*Administratively
 Approved
 5/29/87*

**CHARLOTTE-MECKLENBURG
 PLANNING COMMISSION**
 INTER-OFFICE COMMUNICATION

DATE: May 29, 1987
Martin R. Cranton, Jr.
 FROM: Martin R. Cranton, Jr. Planning Director

TO: Mr. Dale Long, Zoning Administrator

SUBJECT: Administrative Approval of Site Plan Amendment
 Petition No. 85-40
 Jesse M. Waller

Attached please find a revised site plan for the above-referenced petition. The revised site plan substitutes Eastern Red Cedars for Leland Cypress in the plant listing. All other conditions of the site plan remain unchanged. Pursuant to my authority as outlined in the zoning ordinance, I am administratively approving this plan. Please use it when evaluating requests for building permits.

MRCJR:LS:lk
 Attachment
 cc: Jim Sherrer, Jr.