

I-1 CD SITE PLAN AMENDMENT

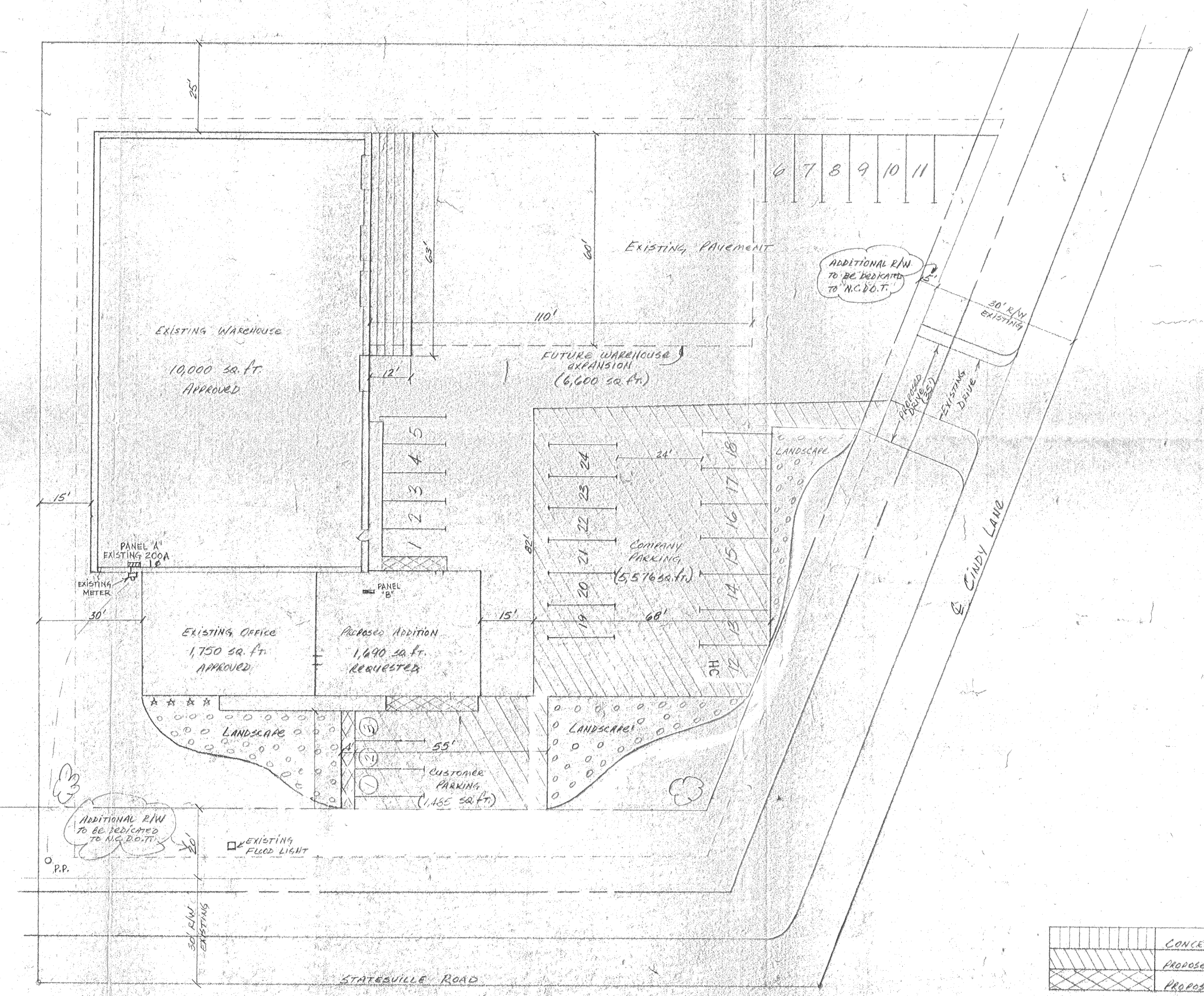

SITE PARKING:
 No. of Employees: 22
 Employee Parking Req'd: 11
 Employee Parking Provided: 24
 Customer Parking Provided: 3

REQUESTED WAREHOUSE SPACE:
 Existing Warehouse: 10,000 sq ft
 Future Additional W.H.S.: 6,600 sq ft
 Total: 16,600 sq ft

REQUESTED OFFICE SPACE:
 Existing Office: 1,750 sq ft
 Proposed Office: 1,690 sq ft
 Total: 3,440 sq ft

NOTE: LANDSCAPED AREAS TO BE OF LOW GROUND COVER (MULCH OR PINE STRAW), AND WILL BE EXEMPT FOR VISUAL BUFFERING. EVERGREEN SHRUBBERY IS PLANNED FOR CERTAIN BORDER AREAS AS WELL AS OCCASIONAL DECORATIVE TREES.

	CONCRETE LOADING DOCK
	PROPOSED ASPHALT PARKING
	PROPOSED SIDEWALK

LANDSCAPE LEGEND:
 * - HOLLY SHRUBS
 o - FLOWERS AND/OR JUNIPER
 (T) - TREE

NO.	DATE	REVISION
1	12-28-85	WIDEN EXISTING DRIVE
2	1-24-86	R/W RESERVED, PARKING SPACES
3	2-25-86	LANDSCAPING
4	3-10-86	LANDSCAPE/100' LOCATIONS & LEGEND
		ROADS

DRAWN BY: RDM
 DATE: NOV. 16, 1985
 SCALE: 1/4" = 1'

J. ALTON STEWART CONST., INC.
 SITE PLAN

APPROVED BY COUNTY COMMISSION
 DATE: 4/21/86

86-8(C)

MGKEE INSULATION
 2031 STATESVILLE RD.
 CHARLOTTE, N.C.
 OFFICE/PARKING ADDITION