

20 FT. LANDSCAPED
SETBACK. NO PARKING
PERMITTED IN SETBACK

ONE ACCESS DRIVE
PERMITTED PER LOT

GIBBON RD.

NEVINS RD.

RETAIN EXISTING
TREES

5 COLUMNAR RED
MAPLES 2 1/2" MIN.
DIAM. WHEN PLANTED

SCALE: 1" = 50'

NORTH

NOTES:

1. PLANT TREES AS INDICATED ON PLAN UNLESS OTHERWISE NOTED. TREE SPECIES MUST BE RED MAPLE, 2 1/2" MIN. DIAMETER WHEN PLANTED, AND PLANTED EVERY 10'.
2. PROPOSED ZONING: I-2(CD)
3. PROPOSED USES ARE ALL THOSE PERMITTED IN THE I-2 DISTRICT WITH THE EXCEPTION OF THE FOLLOWING:
 - A. COLLEGE & UNIVERSITY
 - B. OVERNIGHT TRAILER CAMPING
 - C. ANIMAL FARM
 - D. CATTLE FEEDER LOTS
 - E. SWINE PRODUCTION
 - F. FUR FINISHING
 - G. ABATTOIRS
 - H. JUNKYARDS

**STREETScape RECOMMENDATIONS
GIBBON ROAD PROPERTIES**

CHARLOTTE-MECKLENBURG PLANNING COMMISSION

JULY, 1986

86-20(c)

APPROVED BY COUNTY COMMISSION
DATE 10-20-86

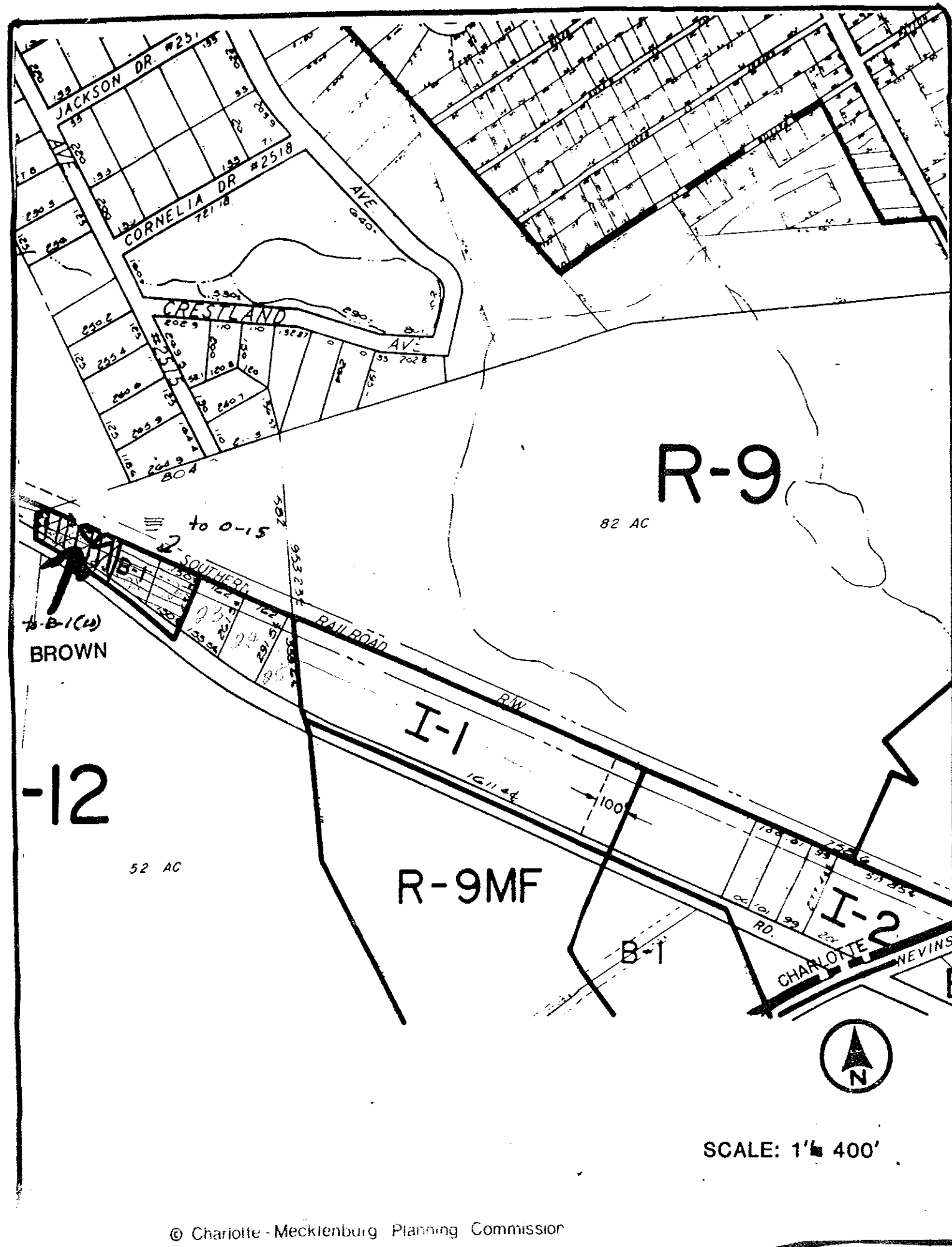

NOTES :

*Recommended
for approval
Dec 11/20/86*

1. REZONING REQUEST: B-1 TO B-1(CD)
2. CONDITIONS OF REZONING:
 - A.) SIGNS SHALL BE DESIGNED AND INSTALLED IN ACCORDANCE WITH ORDINANCE REQUIREMENTS
 - B.) PARKING SHALL BE IN ACCORDANCE WITH ORDINANCE REQUIREMENTS
 - C.) ALL B-1 USES WILL BE PERMITTED EXCEPT THE FOLLOWING:
 1. AUTOMOBILE REPAIR GARAGES, INCLUDING MINOR ADJUSTMENTS SUCH AS LUBRICATION TO ANY TYPE MOTOR VEHICLES
 2. GREENHOUSES, RETAIL
 3. LAUNDRY AND DRY CLEANERS UNDER 4,500 SQ. FT.
 4. MOTELS AND HOTELS
 5. TRAILERS, UTILITY OR HAULING, NOT TO EXCEED A LOADING CAPACITY OF 500 CUBIC FEET, RETAIL SALE OR RENTAL
 6. BOATS, RETAIL SALES WITHIN ENCLOSED BUILDINGS
 7. TRAILERS, OVERNIGHT CAMPING (STORED UNOCCUPIED ON A LOT)
 8. PARKING LOTS AND PARKING STRUCTURES (COMMERCIAL)
 9. THEATER, HOUSED WITHIN AN ENCLOSED STRUCTURE
 10. AUCTION SALES
 11. FENCES AND FENCE MATERIAL, RETAIL SALES
 12. FERTILIZER, PACKAGED RETAIL SALES
 13. PAWN SHOPS AND SECOND HAND GOODS, RETAIL SALES
 14. DORMITORIES FOR THE STUDENTS OF COLLEGES, COMMERCIAL SCHOOLS, SCHOOLS PROVIDING ADULT TRAINING AND FOR THE STAFFS OF HOSPITALS

APPROVED BY COUNTY COMMISSION

DATE 12-1-86