



\* 0 0 B R E A K 0 0 \*



**ADVANCED  
IMAGING  
SYSTEMS**

An Information  
Management Company

[www.aisimc.com](http://www.aisimc.com)

# City of Charlotte – Planning Dept. Scanning Rezoning Files

Petition # \_\_\_\_\_

## Document type:

- Applications
- Correspondence
- Department Comments
- Land Use Consistency
  - Mail Info
  - Mapping
  - Other
- Site Plans



\* 0 0 B R E A K 0 0 \*

PETITIONER Wilgrove Investments

PETITION NO. 86-38(c) HEARING DATE May 12, 1986

ZONING CLASSIFICATION, EXISTING R-9 REQUESTED I-2(CD)

LOCATION Approximately 52.56 acres located at 10525 Parkton Road.

\_\_\_\_\_  
\_\_\_\_\_

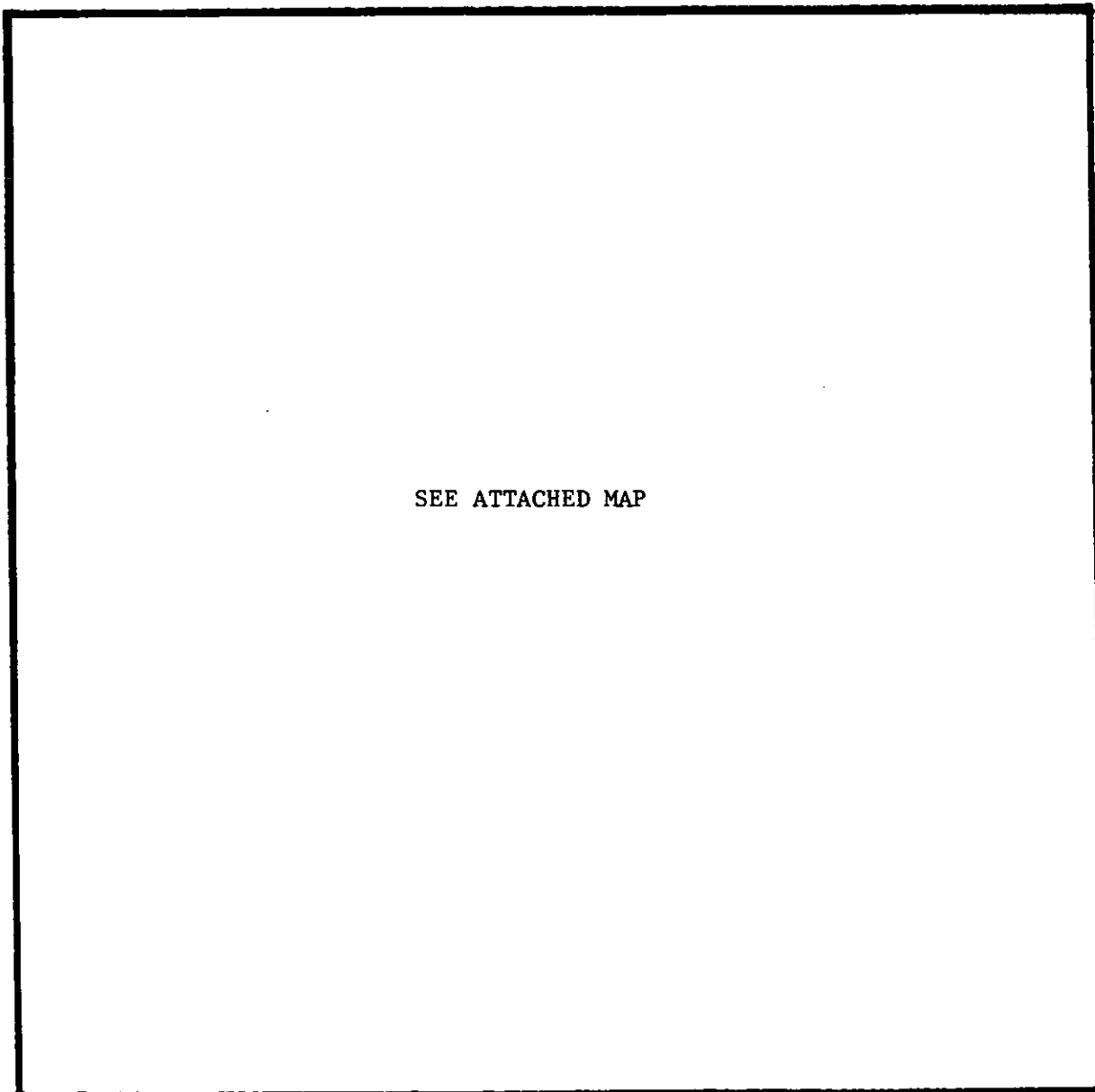

ZONING MAP NO. 98 & 115

SCALE 1" = 400'

PROPERTY PROPOSED FOR CHANGE



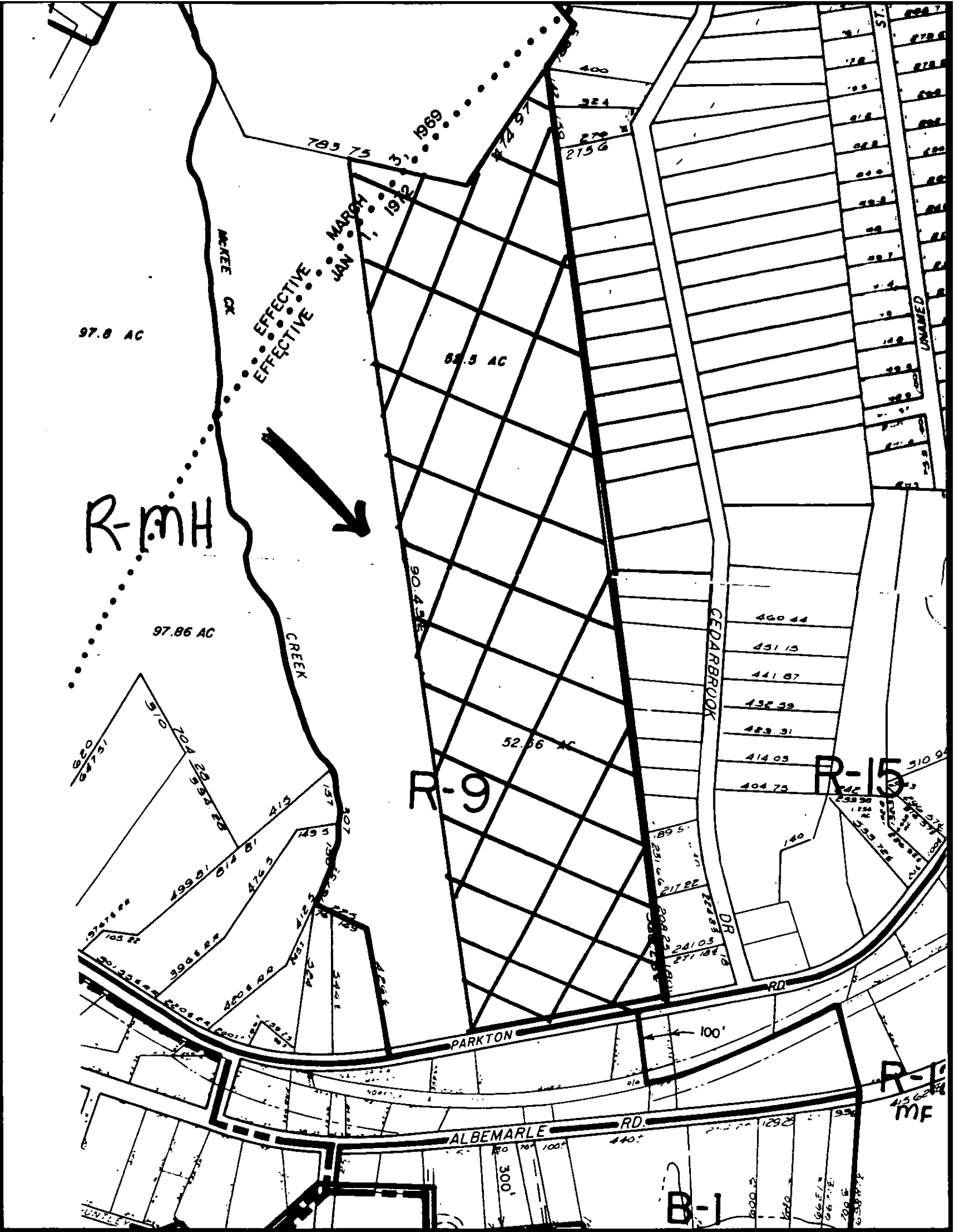

97.8 AC

R-MH

97.86 AC

EFFECTIVE  
EFFECTIVE

JAN 1, 1982  
MARCH 1, 1969

82.5 AC

R-9

52.56 AC

R-15

R-1  
MF

MAYE CR

CREEK

CEDARBROOK

PARKTON RD.

ALBEMARLE RD.

RD

DR

100'

783 75 3' 1969

472 97

270  
2156

400  
324

460 44

451 15

441 87

432 59

423 51

414 05

404 75

570  
704 52  
565 27

499 51  
512 81  
476 3

396 22  
420 8 22  
324

217 22  
223 35  
241 05  
271 12

510 94  
239 36  
128 4  
253 72  
100

300'

440'

128'

93'

66.5'  
66.5'  
200'

UNNAMED

UNNAMED ST.