

# B I S C D SITE PLAN AMENDMENT

1. Site Plan Amendment to allow reduction of required 100 ft. buffer to 30 ft. buffer along I-85.

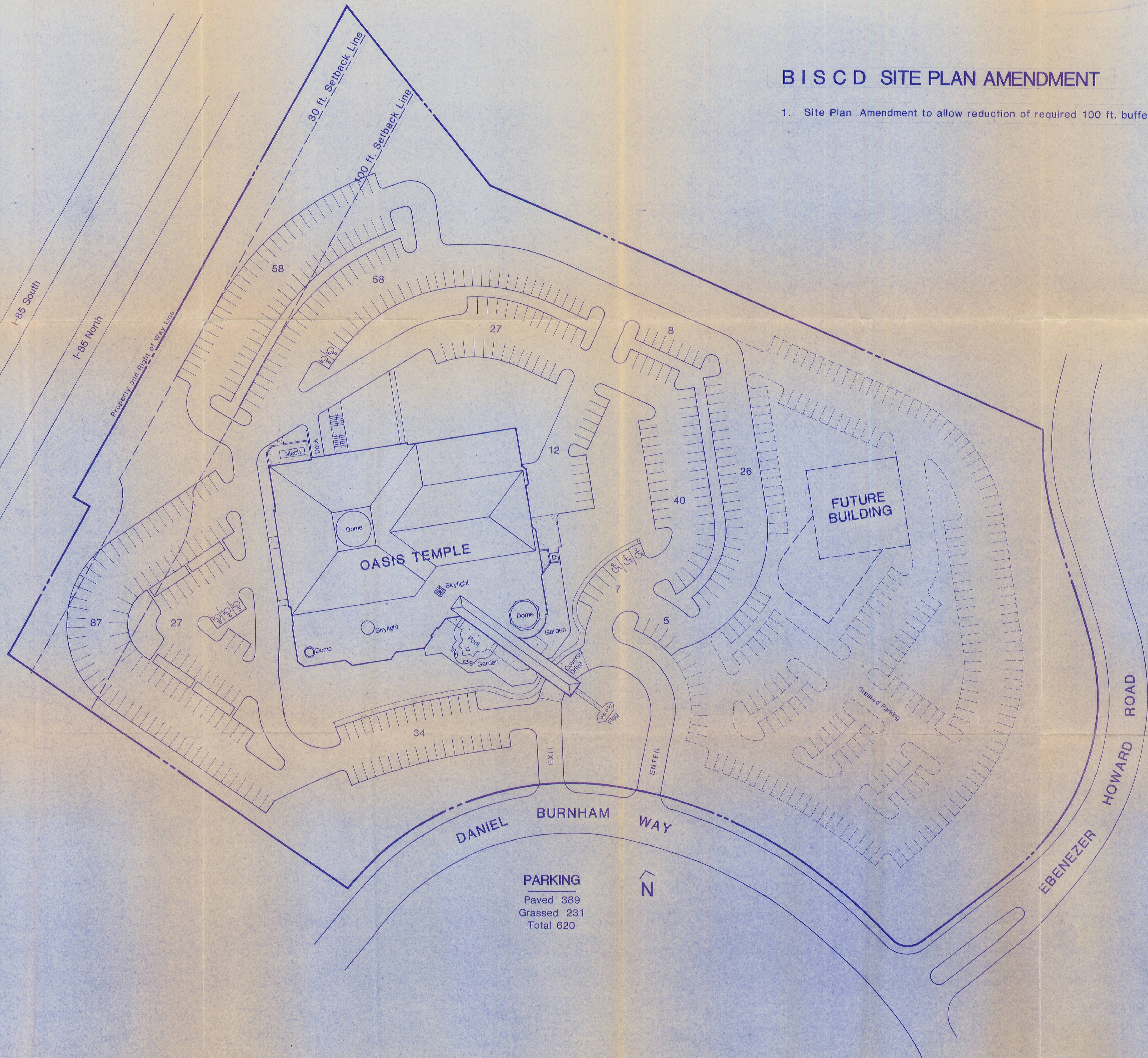

**PARKING**  
 Paved 389  
 Grassed 231  
 Total 620

APPROVED BY COUNTY COMMISSION  
 DATE 12-1-86  
 86-044(C)

JOB NO. 1350  
 SHEET OF

DATE	REVISIONS
7-25-1986	

THIS DRAWING AND THE DESIGN SHOWN ARE THE PROPERTY OF LITTLE AND ASSOCIATES. THE REPRODUCTION, COPYING OR USE OF THIS DRAWING WITHOUT THEIR WRITTEN CONSENT IS PROHIBITED AND ANY INFREEMENT WILL BE SUBJECT TO LEGAL ACTION.

**LITTLE & ASSOCIATES**  
 ARCHITECTS • ENGINEERS • PLANNERS  
 5815 WESTPARK DRIVE • CHARLOTTE, NORTH CAROLINA 28210 • (704) 525-6350

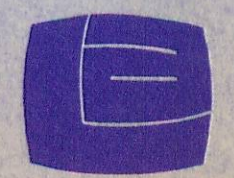

SHEET TITLE: **SITE PLAN** 1" = 40'

PROJECT: **OASIS TEMPLE**  
 CHARLOTTE N.C.