



\* 0 0 B R E A K 0 0 \*



ADVANCED  
IMAGING  
SYSTEMS

www.aisimc.com

An Information  
Management Company

# City of Charlotte – Planning Dept. Scanning Rezoning Files

Petition # \_\_\_\_\_

## Document type:

- Applications
- Correspondence
- Department Comments
- Land Use Consistency
  - Mail Info
  - Mapping
  - Other
- Site Plans



\* 0 0 B R E A K 0 0 \*

PETITIONER Edward F. Walsh and Donald W. Tibbs, Jr.

PETITION NO. 86-116 HEARING DATE 12-15-86

ZONING CLASSIFICATION, EXISTING R-MH REQUESTED R-12

LOCATION A 57.52 acre site located east of US 29 between Old Concord Road  
and Neal Drive



PLEASE SEE ATTACHED MAP

ZONING MAP NO. 77

SCALE 1" = 400'

PROPERTY PROPOSED FOR CHANGE



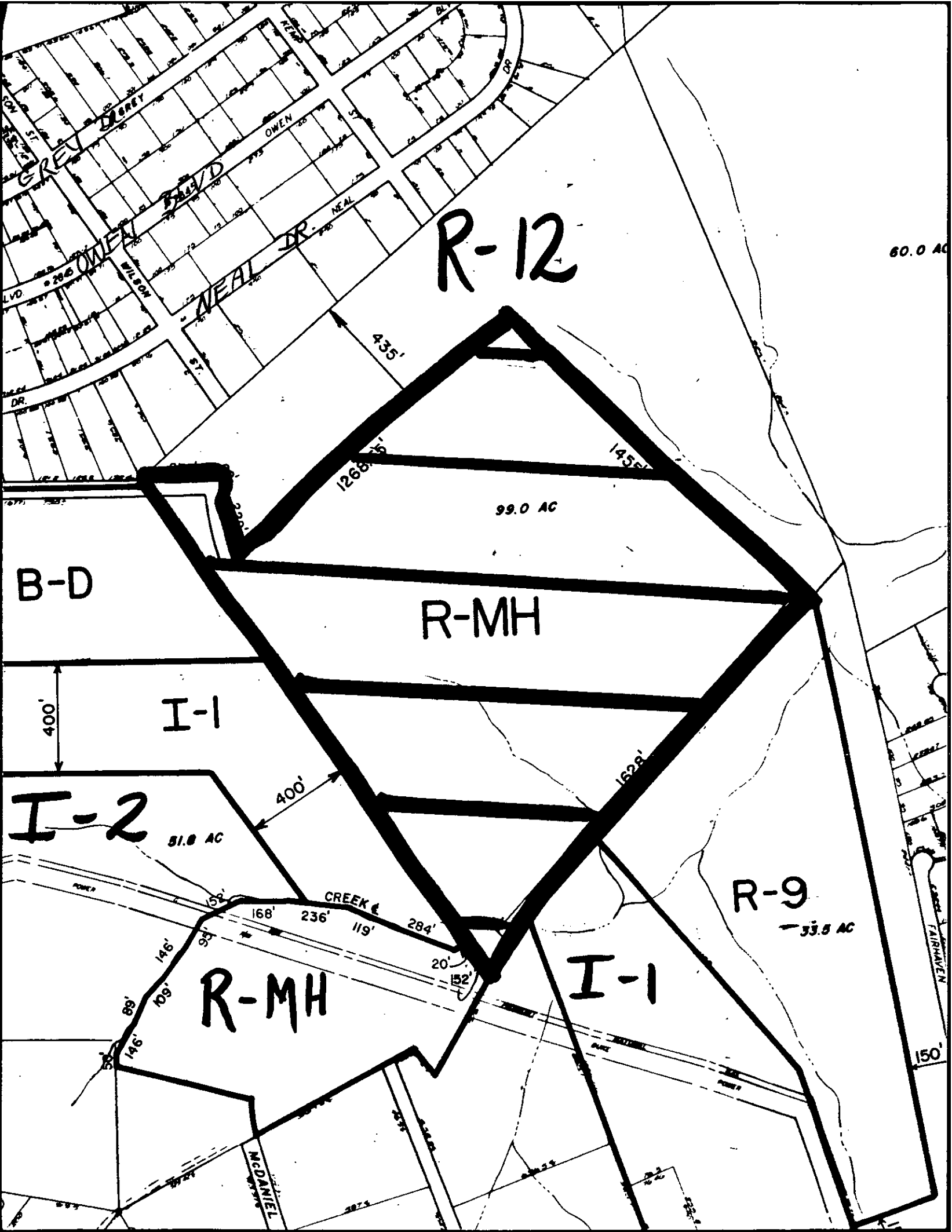

R-12

60.0 AC

99.0 AC

B-D

R-MH

I-1

I-2

51.8 AC

R-9

33.8 AC

R-MH

I-1

MCDANIEL

150'

86-116

S-I

D 01-20-87

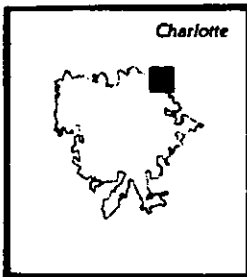
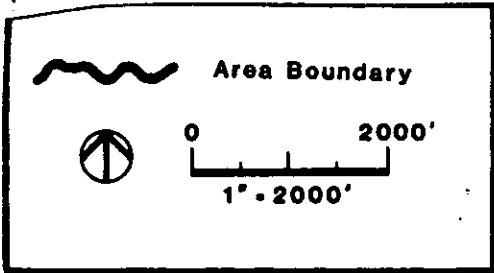

Group A  
Annexation Area **1**

# AUTUMNWOOD

