

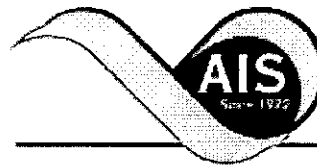

\* 0 0 B R E A K 0 0 \*



**ADVANCED  
IMAGING  
SYSTEMS**

www.aisinc.com

An Information  
Management Company

# City of Charlotte – Planning Dept. Scanning Rezoning Files

Petition # \_\_\_\_\_

## Document type:

- Applications
- Correspondence
- Department Comments
- Land Use Consistency
  - Mail Info
  - Mapping
  - Other
- Site Plans



\* 0 0 B R E A K 0 0 \*

*Finch Hoigats II*  
*R-6MF to R-12MF*

FOR TAX PURPOSES ONLY

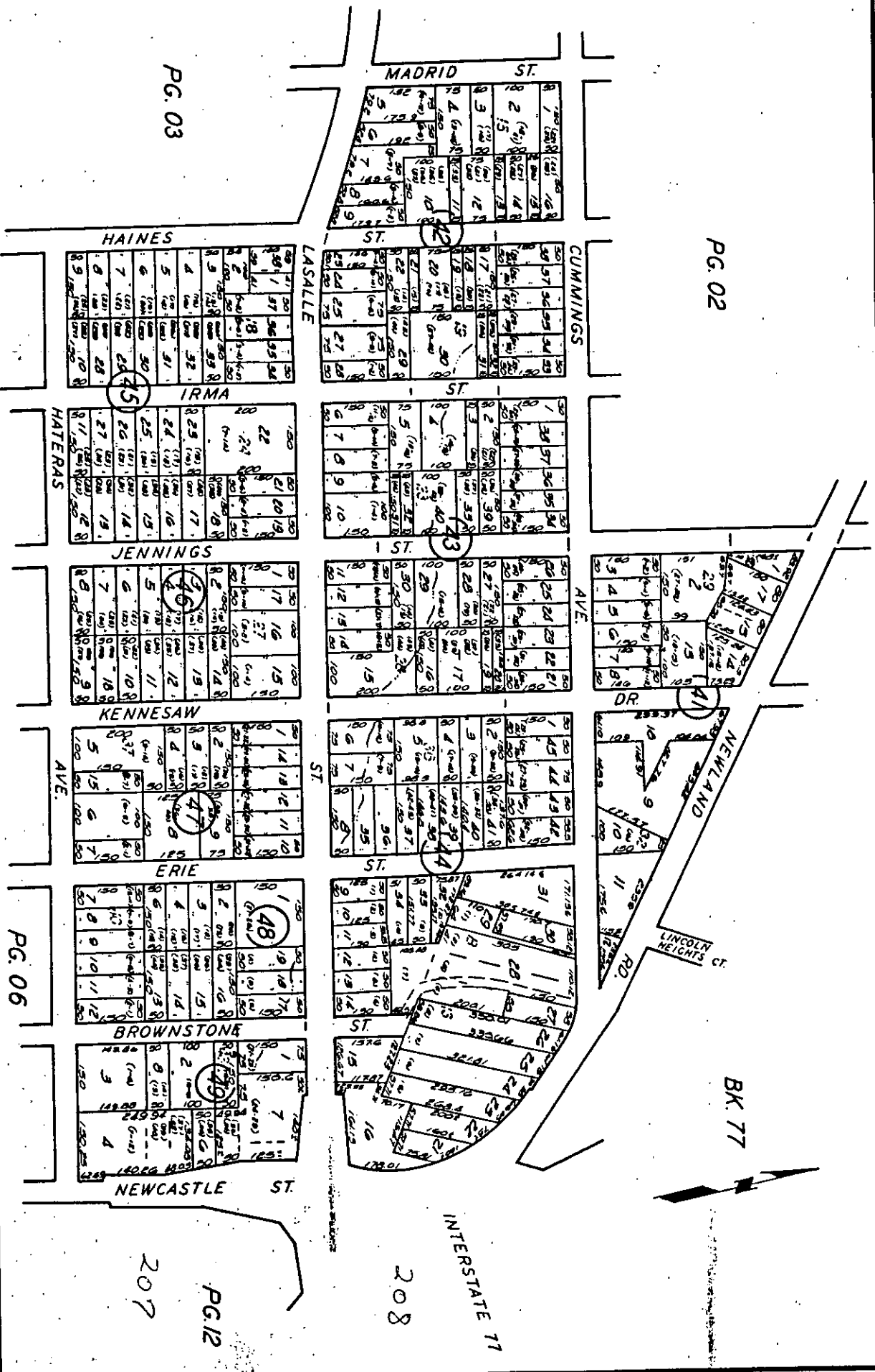

TAX LINE MAP	BOOK 75	PAGE 04
MECKLENBURG COUNTY, NORTH CAROLINA		
REVISED JUN 8 1965	SCALE	1" = 200'

207  
 PG. 12

208

INTERSTATE 71

BK. 77

Lincoln Heights II

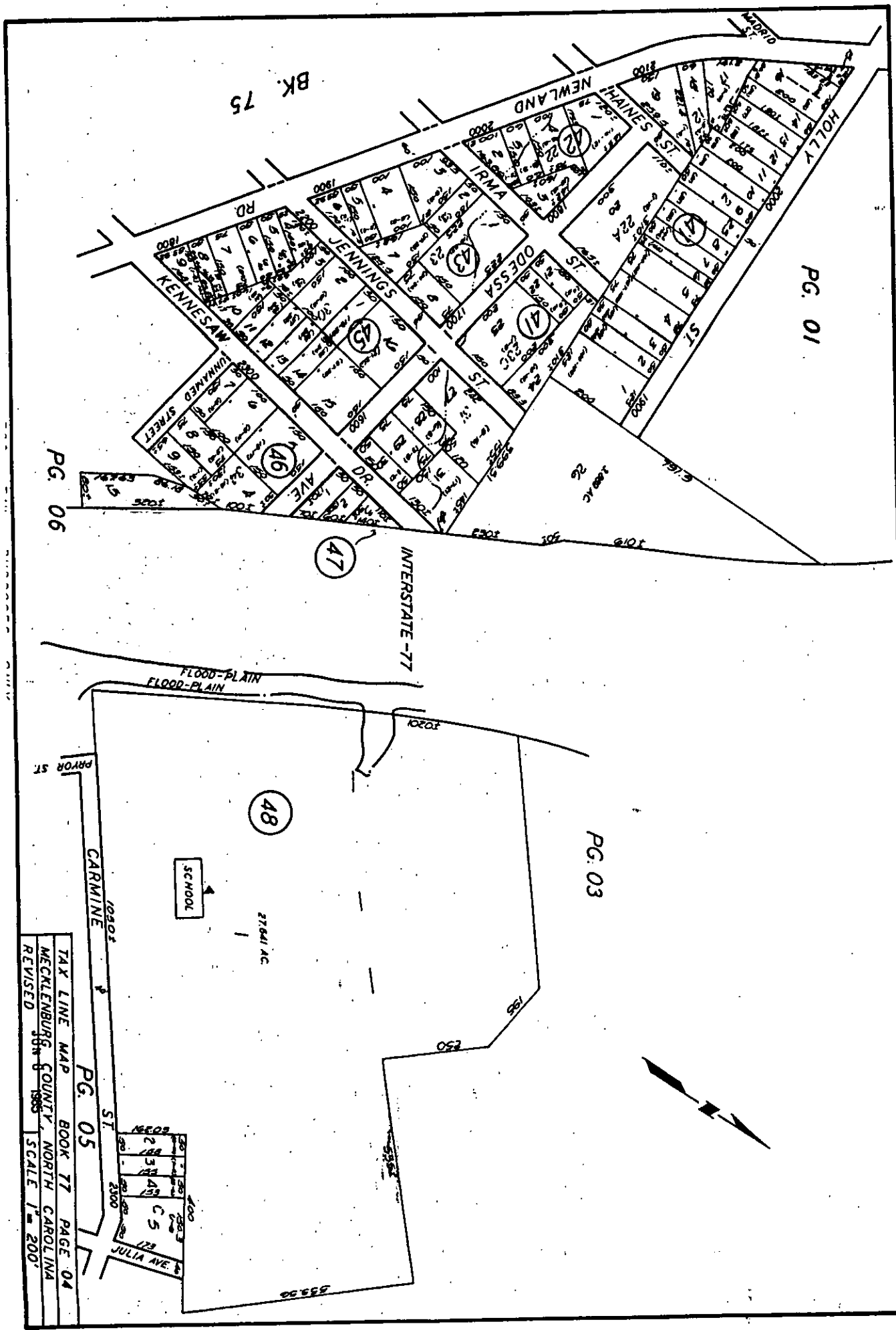

TAX LINE MAP BOOK 77 PAGE 04  
 MECKLENBURG COUNTY, NORTH CAROLINA  
 1985 SCALE 1" = 200'  
 REVISED

PG. 05

PG. 06

PG. 01

PG. 03

INTERSTATE-77

FLOOD-PLAIN  
FLOOD-PLAIN

SCHOOL

48

27,641 AC

47

46

45

43

41

123	124	125	126	127	128	129	130
131	132	133	134	135	136	137	138
139	140	141	142	143	144	145	146
147	148	149	150	151	152	153	154
155	156	157	158	159	160	161	162
163	164	165	166	167	168	169	170
171	172	173	174	175	176	177	178
179	180	181	182	183	184	185	186
187	188	189	190	191	192	193	194
195	196	197	198	199	200	201	202

*Lindale Heights II*

FOR TAX PURPOSES ONLY

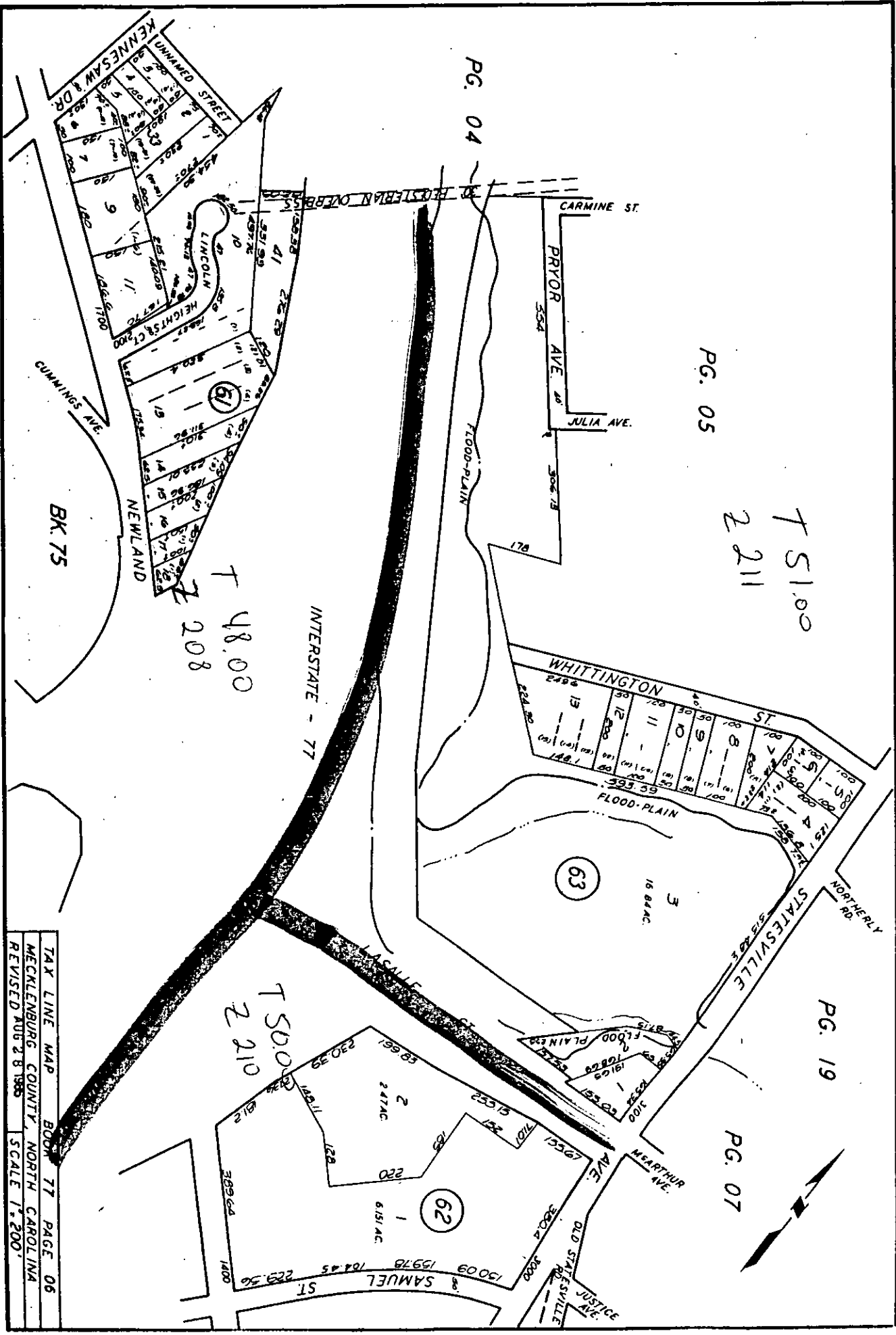

TAX LINE MAP BOOK 77 PAGE 06  
 MECKLENBURG COUNTY, NORTH CAROLINA  
 REVISED AUG 28 1985 SCALE 1" = 200'