



\* 0 0 B R E A K 0 0 \*



**ADVANCED  
IMAGING  
SYSTEMS**

www.aisimc.com

An Information  
Management Company

# City of Charlotte – Planning Dept. Scanning Rezoning Files

Petition # \_\_\_\_\_

## Document type:

- Applications
- Correspondence
- Department Comments
- Land Use Consistency
  - Mail Info
  - Mapping
  - Other
- Site Plans



\* 0 0 B R E A K 0 0 \*

PETITIONER Terry James

PETITION NO. 87-11(c)

HEARING DATE March 9, 1987

ZONING CLASSIFICATION, EXISTING R-R

REQUESTED B-2(CD)

LOCATION A 6.74 acre site located at the end of Pine Harbor Road

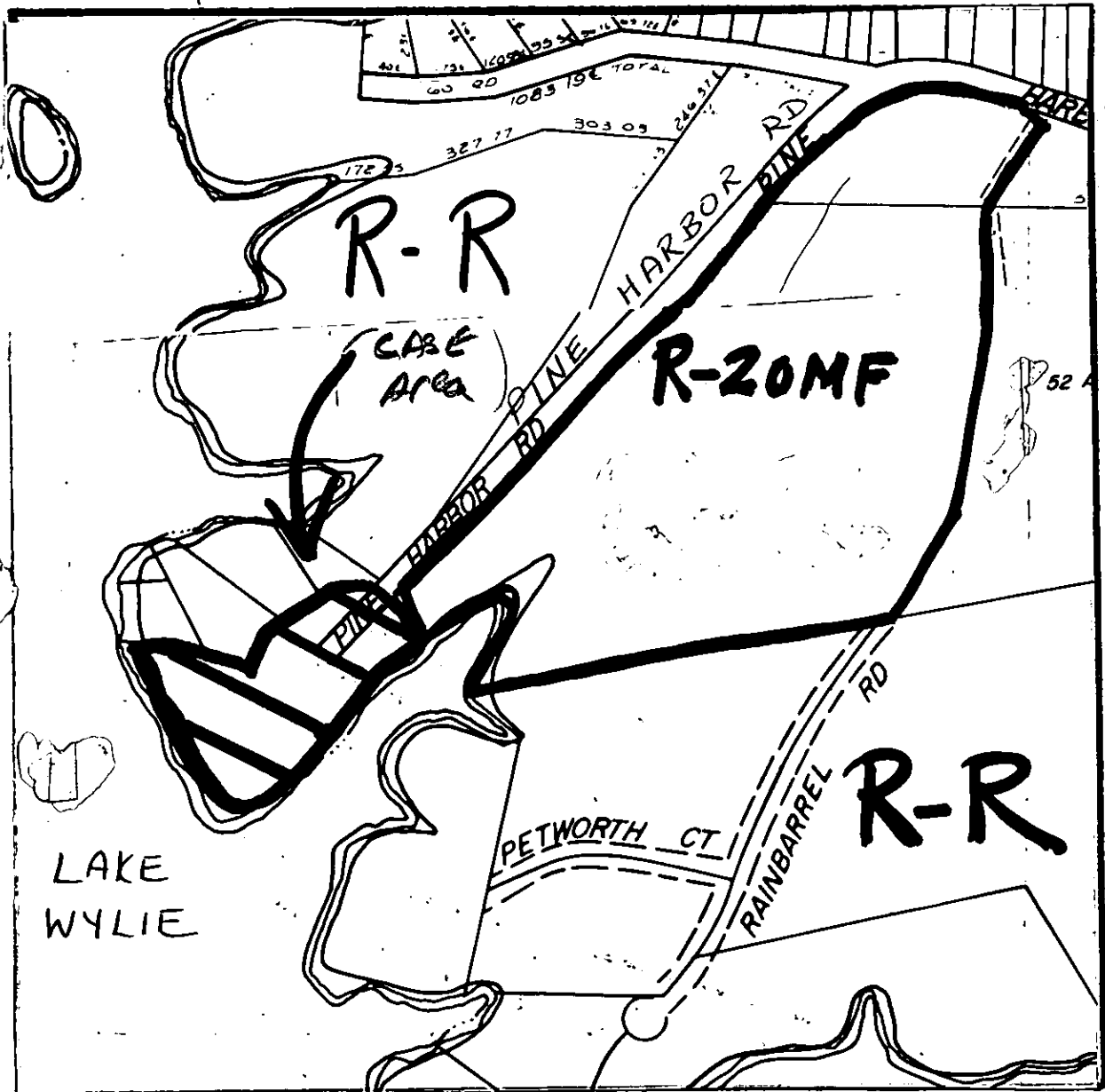

ZONING MAP NO. -153

SCALE 1" = 400'

PROPERTY PROPOSED FOR CHANGE



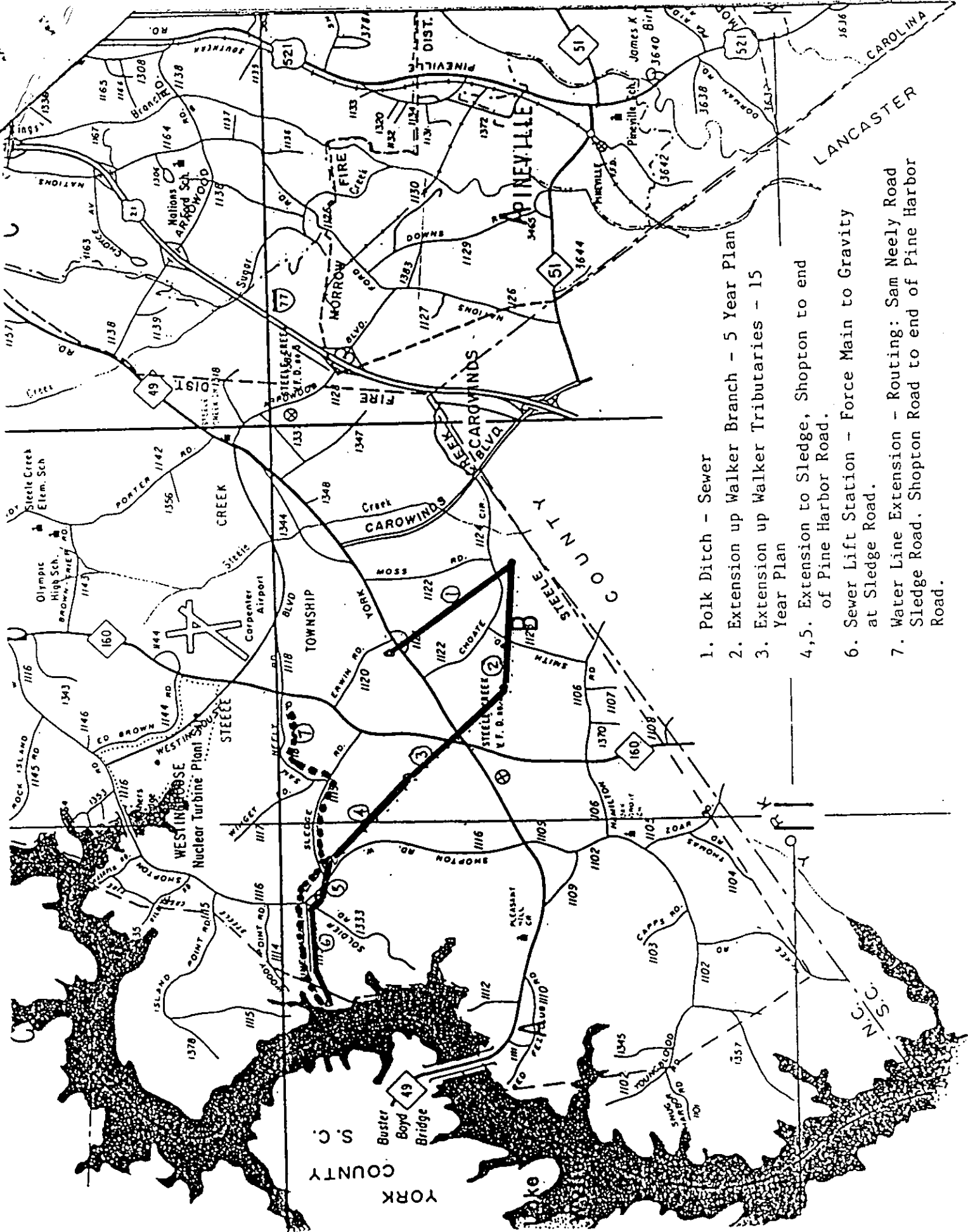

1. Polk Ditch - Sewer
2. Extension up Walker Branch - 5 Year Plan
3. Extension up Walker Tributaries - 15 Year Plan
- 4,5. Extension to Sledge, Shopton to end of Pine Harbor Road.
6. Sewer Lift Station - Force Main to Gravity at Sledge Road.
7. Water Line Extension - Routing: Sam Neely Road Sledge Road, Shopton Road to end of Pine Harbor Road.

PROPERTY DESCRIPTION

OWNER: Earl Terry James  
TAX PARCEL: 119-085-01  
ACRES: 6.74  
ADDRESS: 14131 Pine Harbor Road  
DEED NO.: 2446-269

Beginning at point in the centerline of a private road, in the line of the J.L. Milwee Estate said point being located S-30-21-10-E 17.11 feet from an old iron, the southwest corner of the J.L. Milwee estate land and runs thense with the Milwee line S-30-21-10-E 221.89 feet to a point in Lake Wylie, old cornerthense with eight lines in Lake Wylie (1) S-43-19-W 451.00 feet (2) S-46-50-W 118.07 feet (3) S-82-18-40-W 144.78 feet (4) N-34-56-W 115.14 feet (5) N-28-25-W 124.30 feet (6) N-25-16-30-W 113.55 feet (7) N-19-58-W 120.47 feet (8) N-6-24-10-W 131.92 feet Thense N-86-26-E with the line of Elton Taylor 211.6 feet to a point in the center of the private road. Thense with the centerline of the private road, five lines (1) S-60-10-40-E 152.02 feet (2) N-40-09-30-E 42.14 feet (3) N-55-06-50-E 110.37 feet (4) N-73-15-50-E 100 feet (5) N-85-48-50-E 100 feet to the point of the beginning, containing 6.74 acres.