

24 NEW BOAT SLIPS

LAKE WYLIE

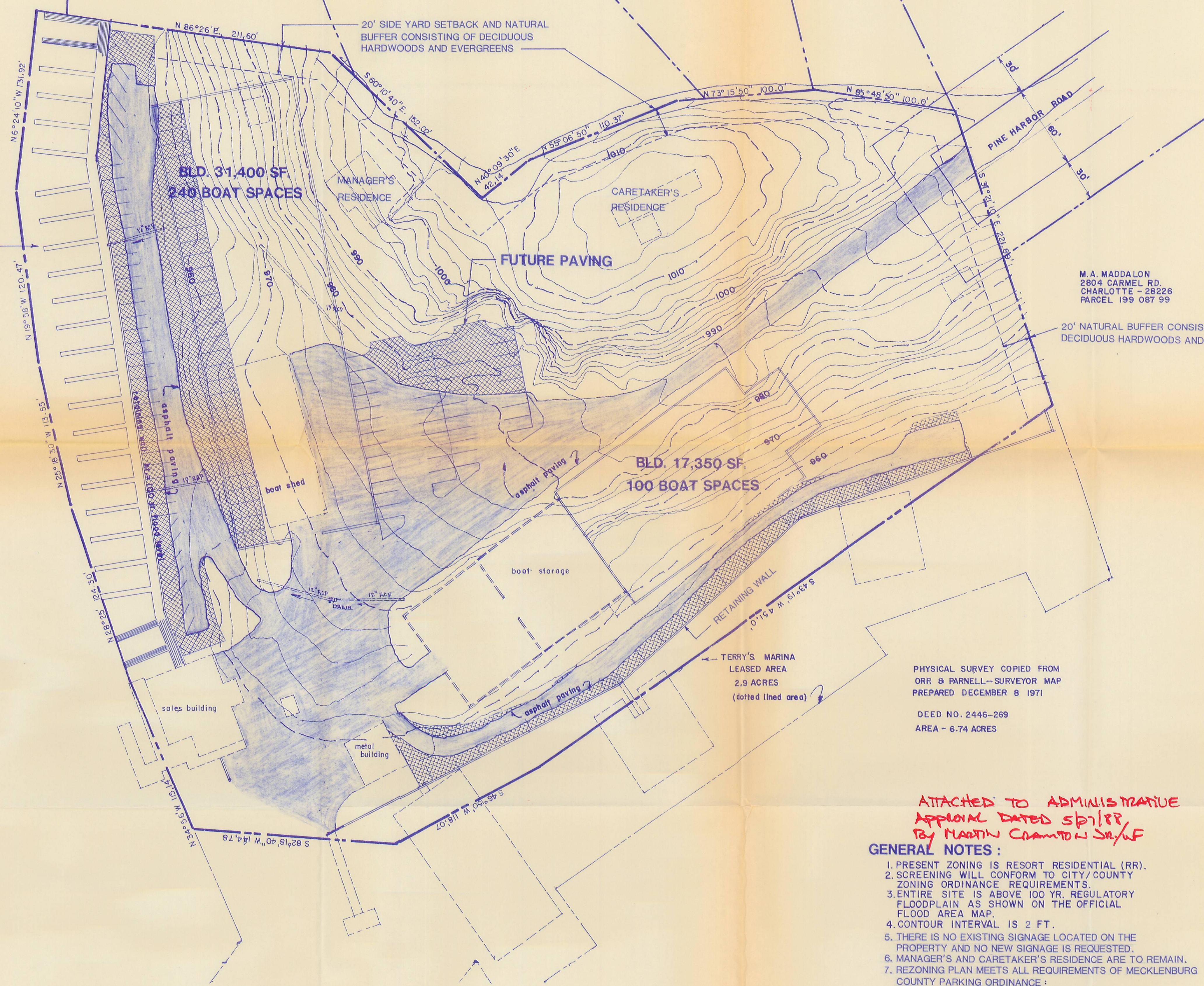

ATTACHED TO ADMINISTRATIVE APPROVAL DATED 5/11/88 BY MARTIN CRAMTON, JR./P

GENERAL NOTES:

1. PRESENT ZONING IS RESORT RESIDENTIAL (RR).
2. SCREENING WILL CONFORM TO CITY/COUNTY ZONING ORDINANCE REQUIREMENTS.
3. ENTIRE SITE IS ABOVE 100 YR. REGULATORY FLOODPLAIN AS SHOWN ON THE OFFICIAL FLOOD AREA MAP.
4. CONTOUR INTERVAL IS 2 FT.
5. THERE IS NO EXISTING SIGNAGE LOCATED ON THE PROPERTY AND NO NEW SIGNAGE IS REQUESTED.
6. MANAGER'S AND CARETAKER'S RESIDENCE ARE TO REMAIN.
7. REZONING PLAN MEETS ALL REQUIREMENTS OF MECKLENBURG COUNTY PARKING ORDINANCE:
TOTAL PARKING SPACES REQUIRED - 134
TOTAL PARKING SPACES AVAILABLE - 135
8. MAXIMUM BUILDING HEIGHT SHALL NOT EXCEED 41.5'

SCALE 1" = 40'

REV 03	5/26/88	REVISED BUILDINGS SQUARE FOOTAGE
REV 02	3/24/87	NOTE NUMBER 8 ADDED
REV 01	2/27/87	PARKING LAYOUT / NOTES ADDED

861004
DATE: 1/26/87
DRAWN BY: TCW
DESIGNED BY: TCW
CHECKED BY: TCW

TERRY'S MARINA
PROPOSED REZONING OF SITE FROM RR TO B-2 CD
MECKLENBURG COUNTY NORTH CAROLINA

Land Planning • Civil Design • Project Management
420 East 7th Street • Suite 300
Charlotte, North Carolina • (704) 334-8275
West Engineering, Inc.

CHARLOTTE-MECKLENBURG PLANNING COMMISSION
INTER-OFFICE COMMUNICATION

DATE: May 27, 1988
TO: Robert Brandon
Zoning Administrator
FROM: Martin R. Cramton, Jr.
Planning Director

SUBJECT: Administrative Approval for Petition #87-11(c)

Enclosed is a revised site plan for petition 87-11(c) by Terry James. The square footage for the two buildings is being adjusted. The square footage for the building to the south (15,750 sq. ft./100 boat spaces) is being increased by 1,600 sq. ft. to 17,350 sq. ft./100 boat spaces. This increase is necessary to allow maneuvering for a fork lift and storage of larger boats. In order to increase the square footage for this building the building to the north (33,000 sq. ft./240 boat spaces) is being reduced by 1,600 sq. ft. to 31,400 sq. ft.

Pursuant to my authority as outlined in the zoning ordinance, I am administratively approving this plan. Please use it when evaluating requests for building permits.

MRC/KDM:sls