

10/24/87

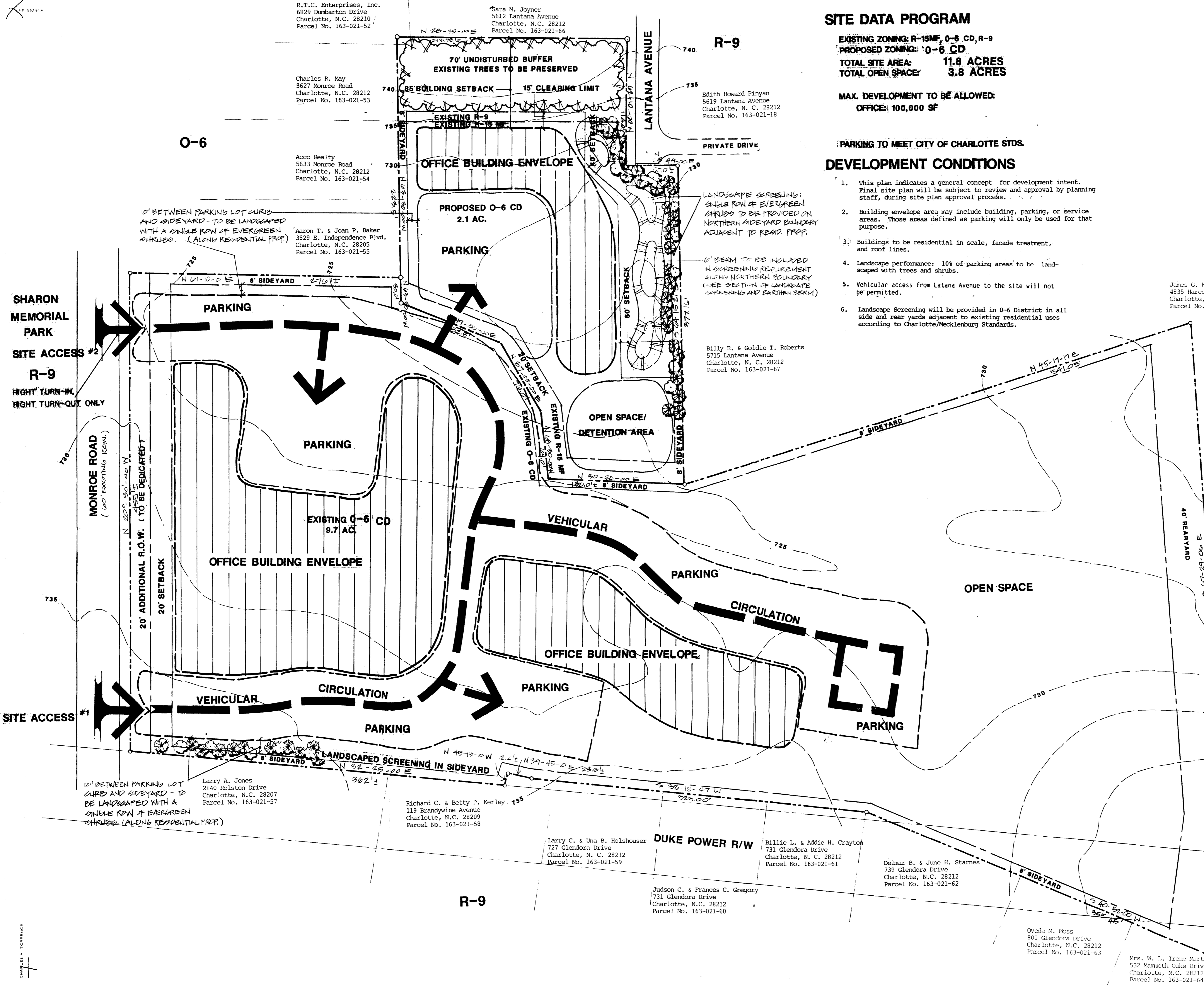

SITE DATA PROGRAM

EXISTING ZONING: R-15MF, O-6 CD, R-9
 PROPOSED ZONING: O-6 CD
 TOTAL SITE AREA: 11.8 ACRES
 TOTAL OPEN SPACE: 3.8 ACRES

MAX. DEVELOPMENT TO BE ALLOWED:
 OFFICE: 100,000 SF

PARKING TO MEET CITY OF CHARLOTTE STDS.

DEVELOPMENT CONDITIONS

1. This plan indicates a general concept for development intent. Final site plan will be subject to review and approval by planning staff, during site plan approval process.
2. Building envelope area may include building, parking, or service areas. Those areas defined as parking will only be used for that purpose.
3. Buildings to be residential in scale, facade treatment, and roof lines.
4. Landscape performance: 10% of parking areas to be landscaped with trees and shrubs.
5. Vehicular access from Lantana Avenue to the site will not be permitted.
6. Landscape Screening will be provided in O-6 District in all side and rear yards adjacent to existing residential uses according to Charlotte/Mecklenburg Standards.

MONROE RD. OFFICE PARK BY WINGATE COLLEGE

TECHNICAL DATA PLAN

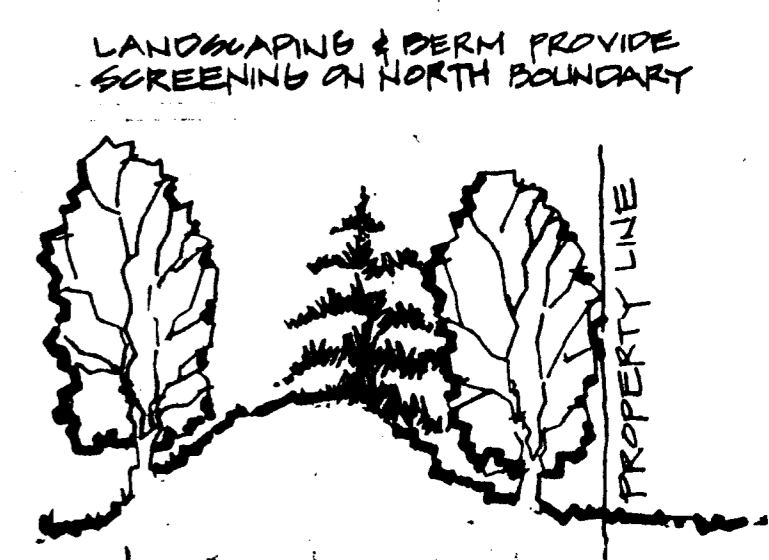

James G. Hartsough
 4835 Harcourt Lane
 Charlotte, N.C. 28212
 Parcel No. 163-012-21

Cheryl G. Hicks
 P.O. Box 34123
 Charlotte, N.C. 28234
 Parcel No. 163-012-01

Richard W. Strakeleather
 233 Kingsway Circle
 Charlotte, N.C. 28214
 Parcel No. 163-021-29

Larry A. Jones
 2140 Rolston Drive
 Charlotte, N.C. 28207
 Parcel No. 163-021-37

Richard C. & Betty J. Kerley
 119 Brandynne Avenue
 Charlotte, N.C. 28209
 Parcel No. 163-021-38

Larry C. & Una B. Holshouser
 727 Glendora Drive
 Charlotte, N.C. 28212
 Parcel No. 163-021-59

Billie L. & Addie H. Crayton
 731 Glendora Drive
 Charlotte, N.C. 28212
 Parcel No. 163-021-61

Delmar B. & June H. Starnes
 739 Glendora Drive
 Charlotte, N.C. 28212
 Parcel No. 163-021-62

Owda M. Hess
 803 Glendora Drive
 Charlotte, N.C. 28212
 Parcel No. 163-021-63

Mrs. M. L. Irene Martin, Jr.
 532 Mammoth Oaks Drive
 Charlotte, N.C. 28212
 Parcel No. 163-021-64

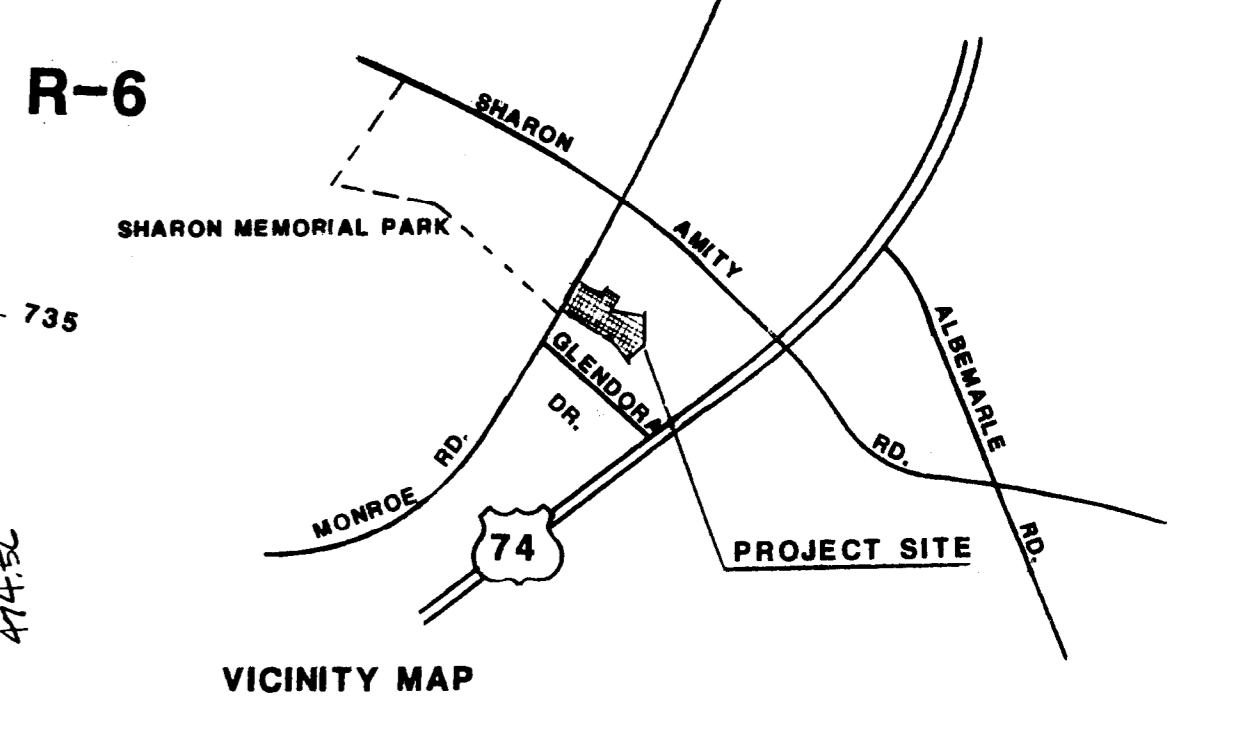

Fair Design
 DATE: AUGUST 26, 1987
 PROJECT NO. 87088
 REVISIONS: 1. 10/23/87 PLANNING DEPT. REVIEW.
 Recommended for approval
 10/23/87
 101 East Boulevard, Charlotte, NC 28203 704-933-0225
 126 Prince Street, Alexandria, VA 22314 703-549-7784

Land Design
 Landscape Architecture Land Planning
 APPROVED BY CITY COUNCIL
 DATE: 11/19/87
 1987-86

MONROE RD. OFFICE PARK

Charlotte, N.C.
 BY WINGATE COLLEGE

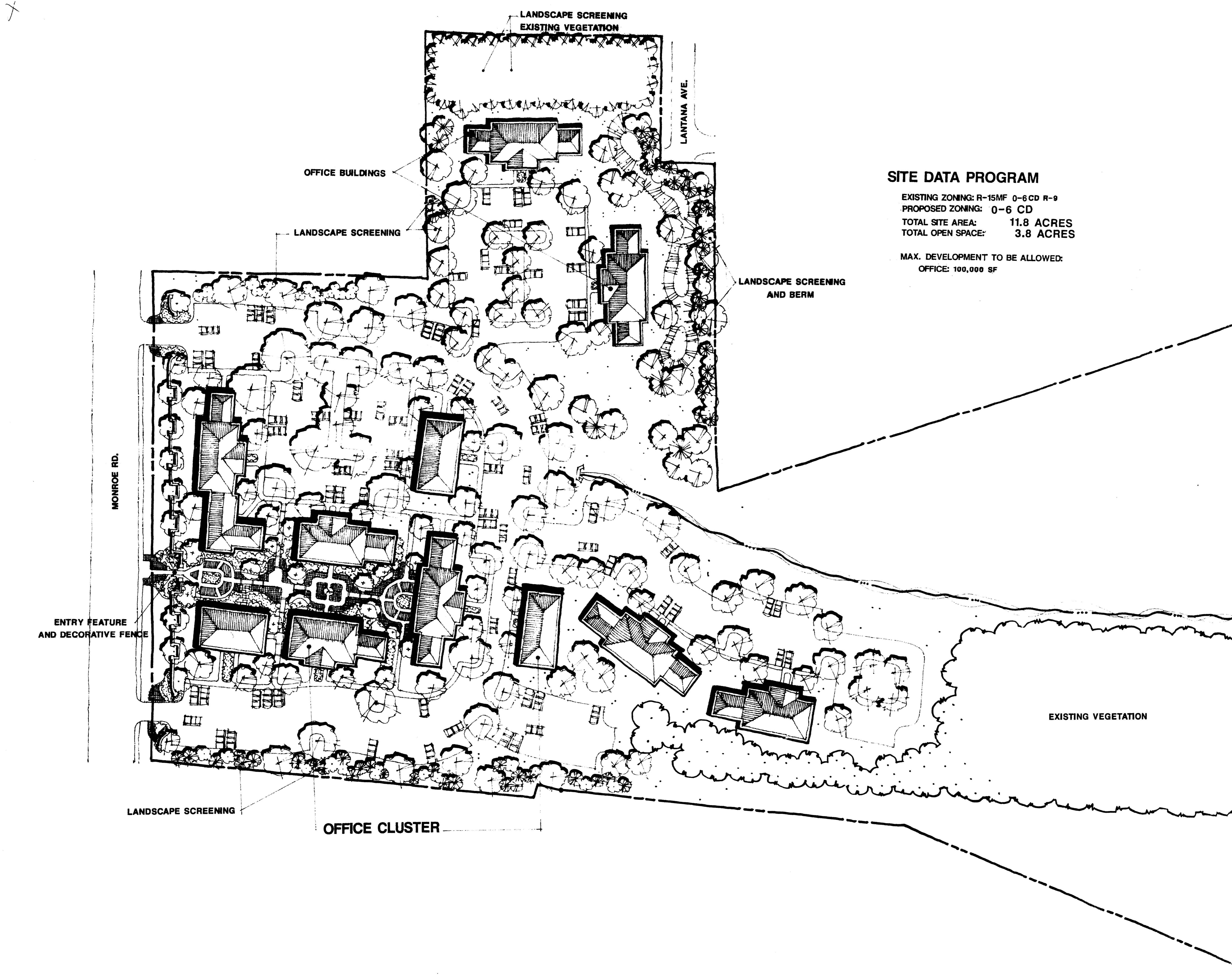

SITE DATA PROGRAM

EXISTING ZONING: R-15MF, O-6 CD, R-9
 PROPOSED ZONING: O-6 CD
 TOTAL SITE AREA: 11.8 ACRES
 TOTAL OPEN SPACE: 3.8 ACRES

MAX. DEVELOPMENT TO BE ALLOWED:
 OFFICE: 100,000 SF

SITE PLAN

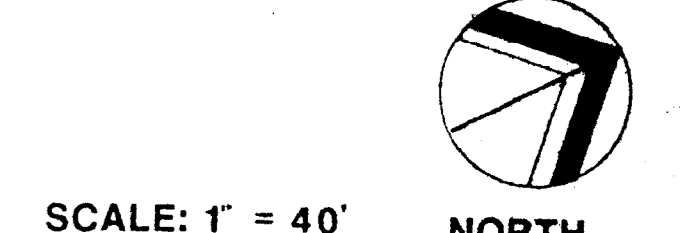

Fair Design
 DATE: AUGUST 26, 1987
 PROJECT NO. 87088
 REVISIONS:

1701 East Boulevard, Charlotte, NC 28203 704-933-0225
 126 Prince Street, Alexandria, VA 22314 703-549-7784
Land Design
 Landscape Architecture Land Planning

87-86