



* 0 0 B R E A K 0 0 *



**ADVANCED
IMAGING
SYSTEMS**

An Information
Management Company

www.aisimc.com

City of Charlotte – Planning Dept. Scanning Rezoning Files

Petition # _____

Document type:

- Applications
- Correspondence
- Department Comments
- Land Use Consistency
 - Mail Info
 - Mapping
 - Other
- Site Plans



* 0 0 B R E A K 0 0 *

PETITIONER Charlotte-Mecklenburg Planning Commission

PETITION NO. AA-1A(c)

HEARING DATE March 14, 1988

ZONING CLASSIFICATION, EXISTING Terminal

Conditional Truck

REQUESTED I-1

LOCATION U.S. Hwy 21 @ Reames Road

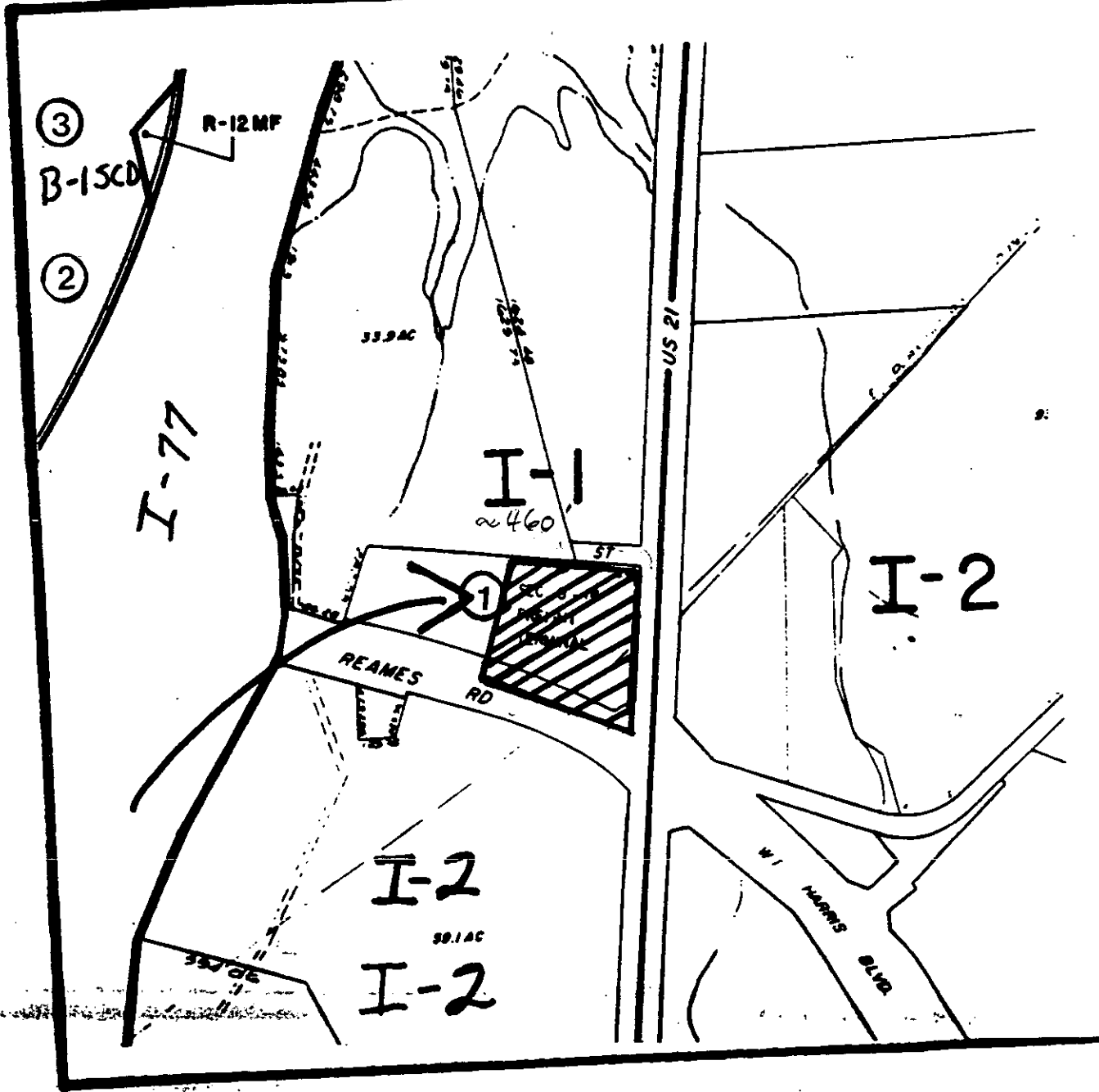

ZONING MAP NO. 44

SCALE 1" = 400'

PROPERTY PROPOSED FOR CHANGE



OFFICIAL REZONING APPLICATION MECKLENBURG COUNTY

Petition No. 88-14(C)

Date Filed 1/25/88

Received By AM

OFFICE USE ONLY

Ownership Information

Property Owner Gralock Associates

Owner's Address P.O. Box 240729

Charlotte, NC 28224

Date Property Acquired _____

Deed Reference _____

Tax Parcel Number 025-092-03

Location Of Property (address or description) NW corner U.S. Hwy 21 and
Reames Road.

Description Of Property

Size (Sq. Ft.-Acres) 8.090

Street Frontage (ft.) _____

Current Land Use Vacant

Zoning Request

Existing Zoning Conditional Truck Terminal

Requested Zoning I-1

Purpose of zoning change Keeping with the three year review of all Conditional rezonings.

N/A

Name of Agent

CHPC

Name of Petitioner(s)

N/A

Agent's Address

600 East 4th Street

Address of Petitioner(s)

N/A

Telephone Number

336-2205

Telephone Number

Signature of Property Owner if Other than Petitioner