

Vicinity Map

O-6(CD)

O-6

PERMIT USE OF THIS PLAN IS FOR HOSPITAL PURPOSES. THE SITE PLAN INDICATES THE EXISTING CONDITION WITH ONLY MINOR STRUCTURAL AND FINISHING. IT IS THE INTENT OF THIS REZONING TO ALLOWED BY THE O-6 CLASSIFICATION. EMBL FORMULE USES 30.

General Note

CAVONEL, LINDER & ASSOCIATES ARCHITECTS
2200 SANDHURST RD
CHARLOTTE, NC 28203
TEL: 770-438-1111
FAX: 770-438-1112

WILSON, GARDNER, L. WILSON
1500 RIVERCHASE PK
CHARLOTTE, NC 28203
TEL: 770-438-1111
FAX: 770-438-1112

ALDRIDGE, ROBERT R.
1701 RAYMUNTS RD
CHARLOTTE, NC 28211
TEL: 770-438-1111
FAX: 770-438-1112

WILSON, GARDNER, L. WILSON
1500 RIVERCHASE PK
CHARLOTTE, NC 28203
TEL: 770-438-1111
FAX: 770-438-1112

RESIDENTIAL, CARRIAGE & GARAGE
1522 E 31st STREET
1800 BALDWIN AVE
CHARLOTTE, NC 28204
TEL: 770-438-1111
FAX: 770-438-1112

THOMAS, JAMES
1800 BALDWIN AVE
CHARLOTTE, NC 28204
TEL: 770-438-1111
FAX: 770-438-1112

NOTE: REPAIRS HEIGHT OF BRICK WALL FROM 6'-6" TO 4'-1" FROM FRONT FACE OF ADJACENT RESIDENCE FORWARD TOWARD BALDWIN AVE

Existing Zoning Boundaries

BALDWIN AVENUE

EAST THIRD STREET

REVISIONS	
DRAWN BY:	
CHECKED BY:	
SEALS	
DATE	9/7/88
JOB NO.	
SHEET	Z-1

PRESBYTERIAN SPECIALTY HOSPITAL
Charlotte, North Carolina

REZONING PLAN

THE
FREEMAN
WHITE
ASSOCIATES
INC.
ARCHITECTS • ENGINEERS
CHARLOTTE • TAMPA

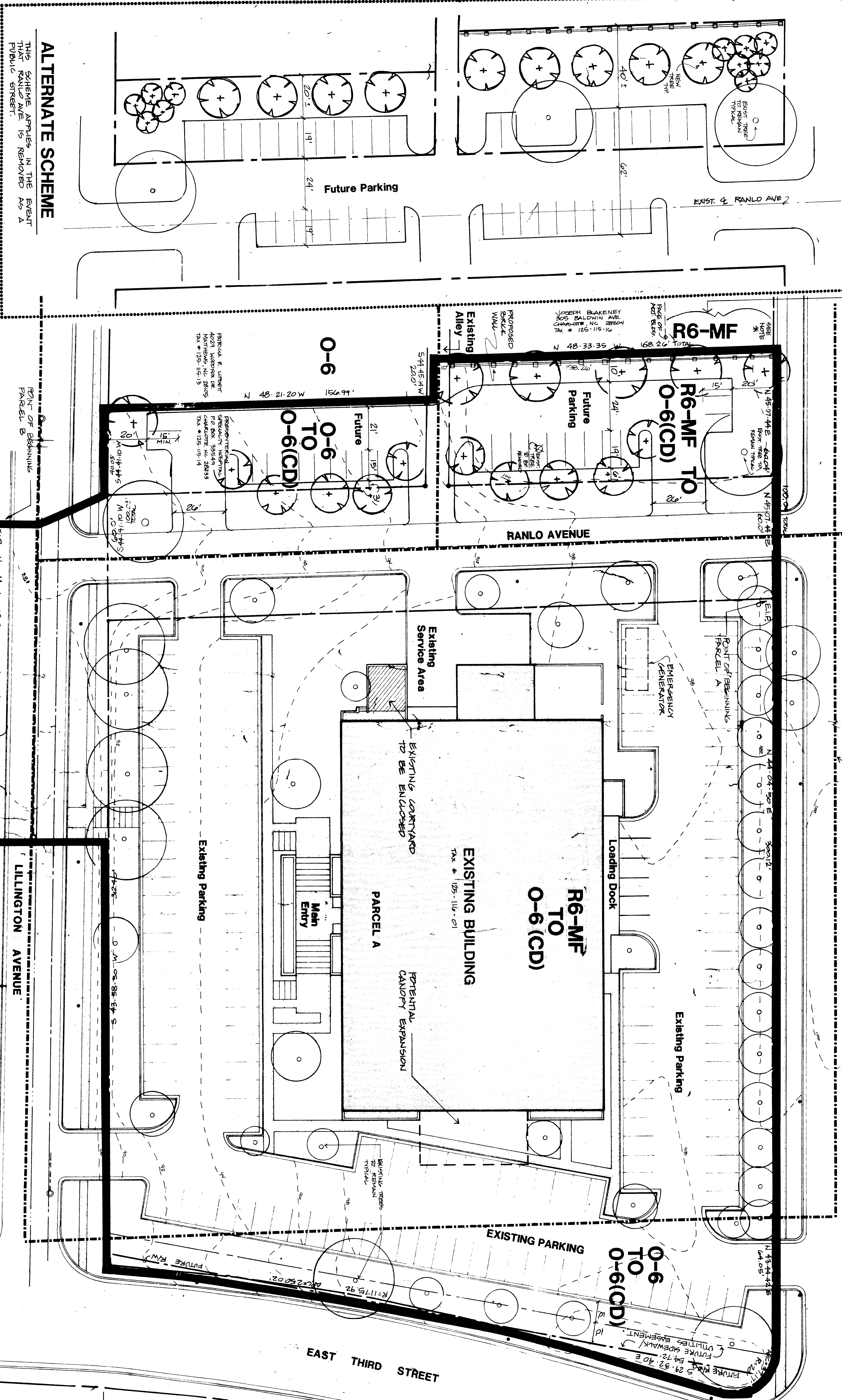

ALTERNATE SCHEME

THIS SCHEME APPLIES IN THE EVENT THIS PUBLIC STREET IS RELOCATED AS A PUBLIC STREET.

Legend

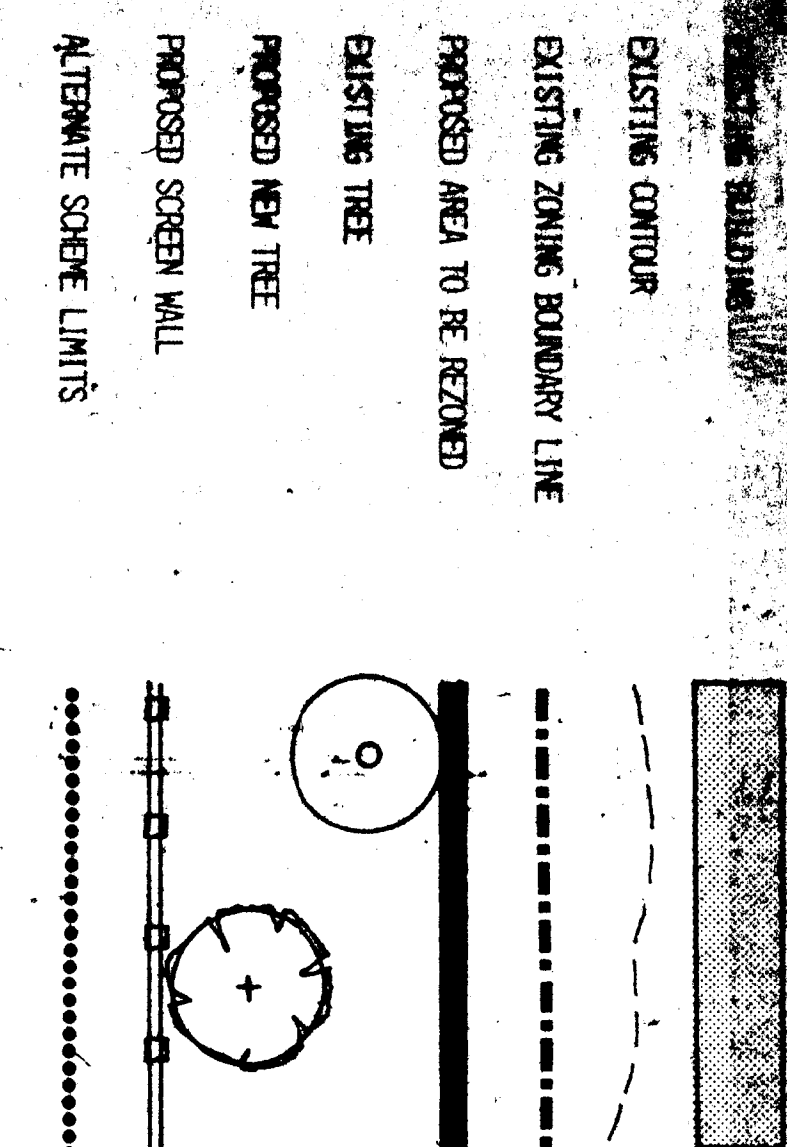

Site Summary

SITE SIZE: 3.47 ACRES (PARCELS A, PARCEL B EXCLUDING 3.39 ACRES [EAST END OF RANLO AVE. R/W])
EXISTING ZONING: P-RF AND O-6
PROPOSED ZONING: O-6(CD)
EXISTING USE: HOSPITAL
PROPOSED FUTURE USE: AS ALLOWED IN O-6
EXISTING BUILDING AREA: 73,362 SQ. FT. GROSS
MAXIMUM FUTURE BLDG. AREA: 84,000 SQ. FT.

O-6(CD)

R6-MF TO O6(CD)

R6-MF TO O-6(CD)

O-6 TO O-6(CD)

O-6

O-6

O-6

O-6

O-6

O-6

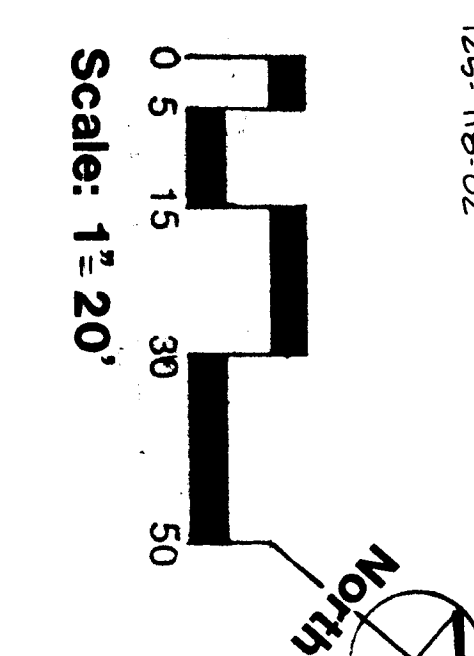

Notes

1. PRELIMINARY LAYOUT WAS REVISED FROM A 1" = 50' SCALE BY [Name] FROM [Date].
2. [Text regarding zoning and site plan requirements]
3. [Text regarding zoning and site plan requirements]
4. [Text regarding zoning and site plan requirements]
5. [Text regarding zoning and site plan requirements]
6. [Text regarding zoning and site plan requirements]
7. [Text regarding zoning and site plan requirements]
8. [Text regarding zoning and site plan requirements]
9. [Text regarding zoning and site plan requirements]
10. [Text regarding zoning and site plan requirements]
11. [Text regarding zoning and site plan requirements]

APPROVED BY CITY COUNCIL
DATE: 7/18/88
Recommended by [Name] 7/21/88