

Location Map

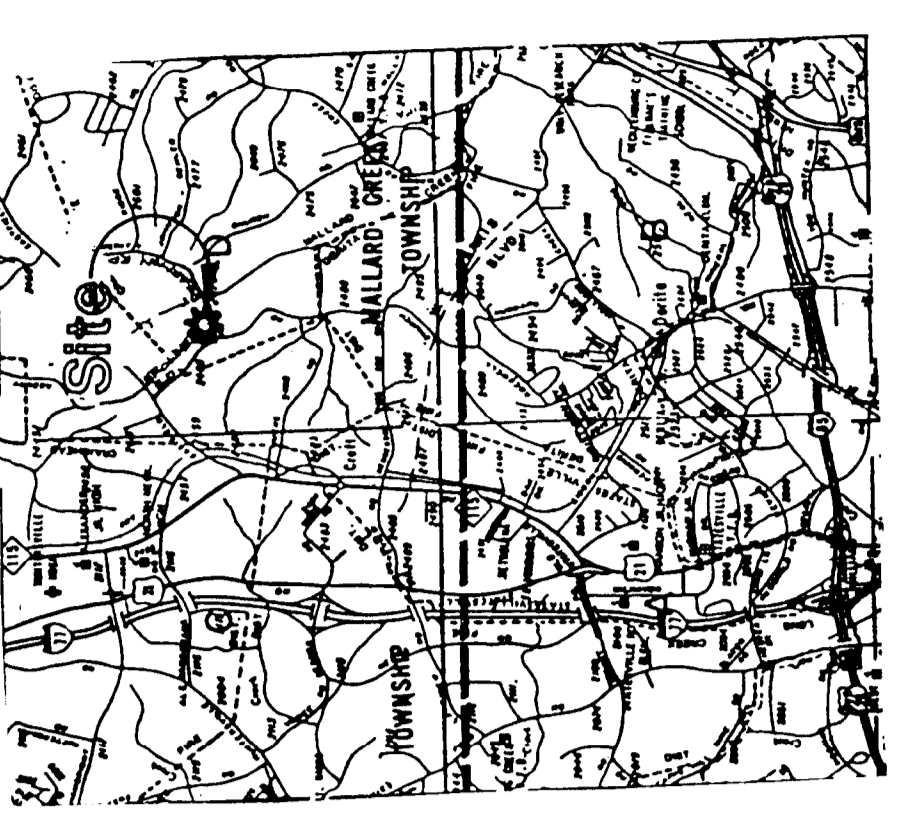

**Development Data**

Existing Zoning ..... R-15  
 Proposed Zoning ..... B-1 (SCD), O-15 (CD), R-15 MF (CD)

Site Acreage  
 B-1 (SCD) ..... 14.48 AC  
 O-15 (CD) ..... 13.93 AC  
 R-15 MF (CD) ..... 11.92 AC  
 Total ..... 40.33 AC

Building Area Distribution  
 Parcel A ..... 125,000 SF  
 Parcel B ..... 125,000 SF  
 Parcel C ..... 140 Units

**Adjoining Property Owners**

1	027-092-23	THE CROSSLAND GROUP, LLC 200 S. BROADWAY, SUITE 1000 CHARLOTTE, NC 28202
2	027-092-24	MR. ROBERT R. WALLINGRA 3245 WOODVIEW DR. CHARLOTTE, NC 28213
3	07-092-28	THE CROSSLAND GROUP, LLC 200 S. BROADWAY, SUITE 1000 CHARLOTTE, NC 28202
4	027-032-05	MR. & MRS. KAREN R. KENNEDY 200 S. BROADWAY, SUITE 1000 CHARLOTTE, NC 28202
5	027-092-21	MR. C. WALLINGRA 3245 WOODVIEW DR. CHARLOTTE, NC 28213
6	027-101-01	MR. & MRS. J. WALLINGRA 3245 WOODVIEW DR. CHARLOTTE, NC 28213
7	027-065-05	MR. & MRS. J. WALLINGRA 3245 WOODVIEW DR. CHARLOTTE, NC 28213
8	027-102-02	MR. & MRS. J. WALLINGRA 3245 WOODVIEW DR. CHARLOTTE, NC 28213
9	027-102-02	MR. & MRS. J. WALLINGRA 3245 WOODVIEW DR. CHARLOTTE, NC 28213
10	027-102-02	MR. & MRS. J. WALLINGRA 3245 WOODVIEW DR. CHARLOTTE, NC 28213
11	027-102-02	MR. & MRS. J. WALLINGRA 3245 WOODVIEW DR. CHARLOTTE, NC 28213
12	027-102-02	MR. & MRS. J. WALLINGRA 3245 WOODVIEW DR. CHARLOTTE, NC 28213
13	027-102-02	MR. & MRS. J. WALLINGRA 3245 WOODVIEW DR. CHARLOTTE, NC 28213
14	027-102-02	MR. & MRS. J. WALLINGRA 3245 WOODVIEW DR. CHARLOTTE, NC 28213
15	027-102-02	MR. & MRS. J. WALLINGRA 3245 WOODVIEW DR. CHARLOTTE, NC 28213
16	027-102-02	MR. & MRS. J. WALLINGRA 3245 WOODVIEW DR. CHARLOTTE, NC 28213

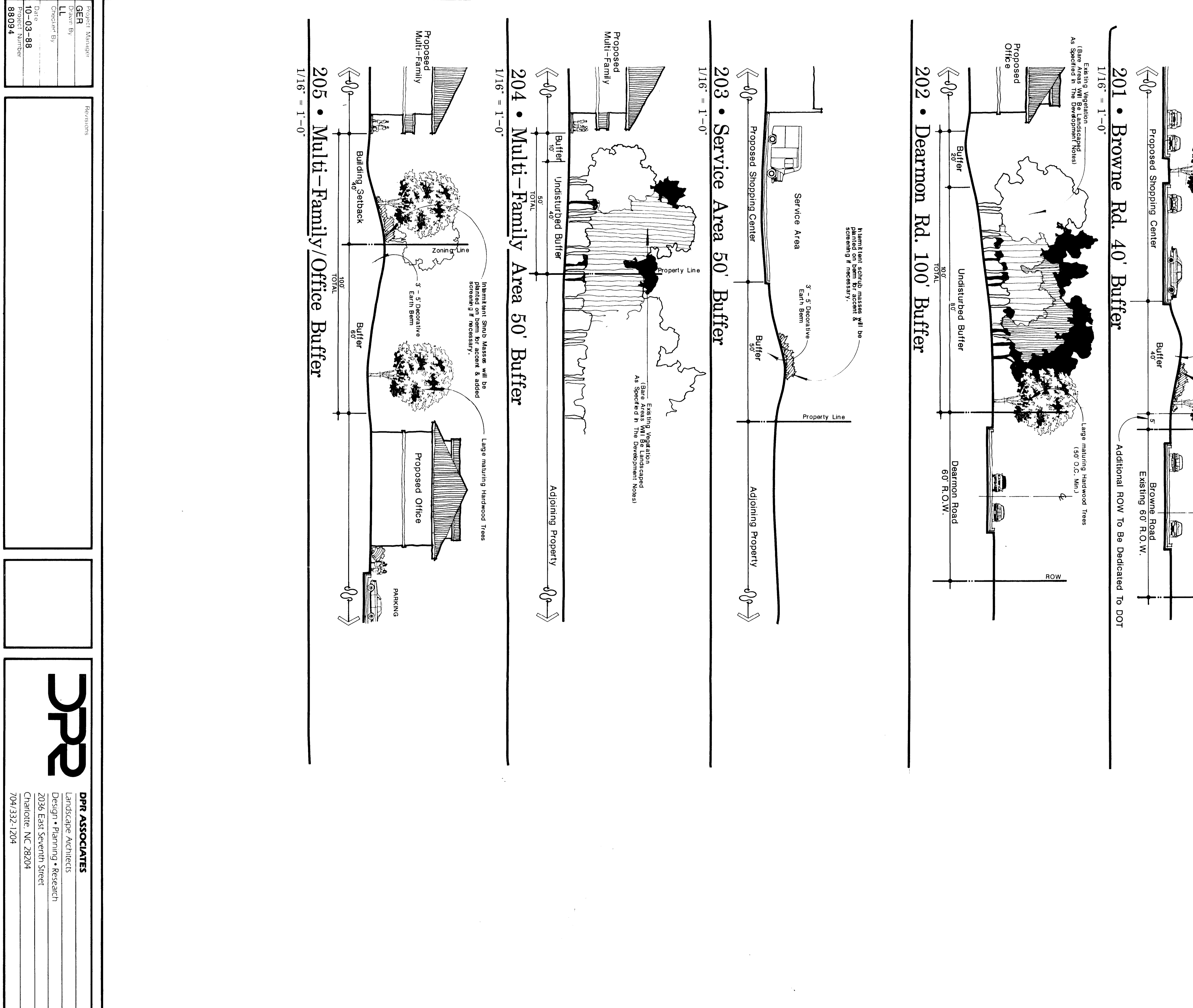
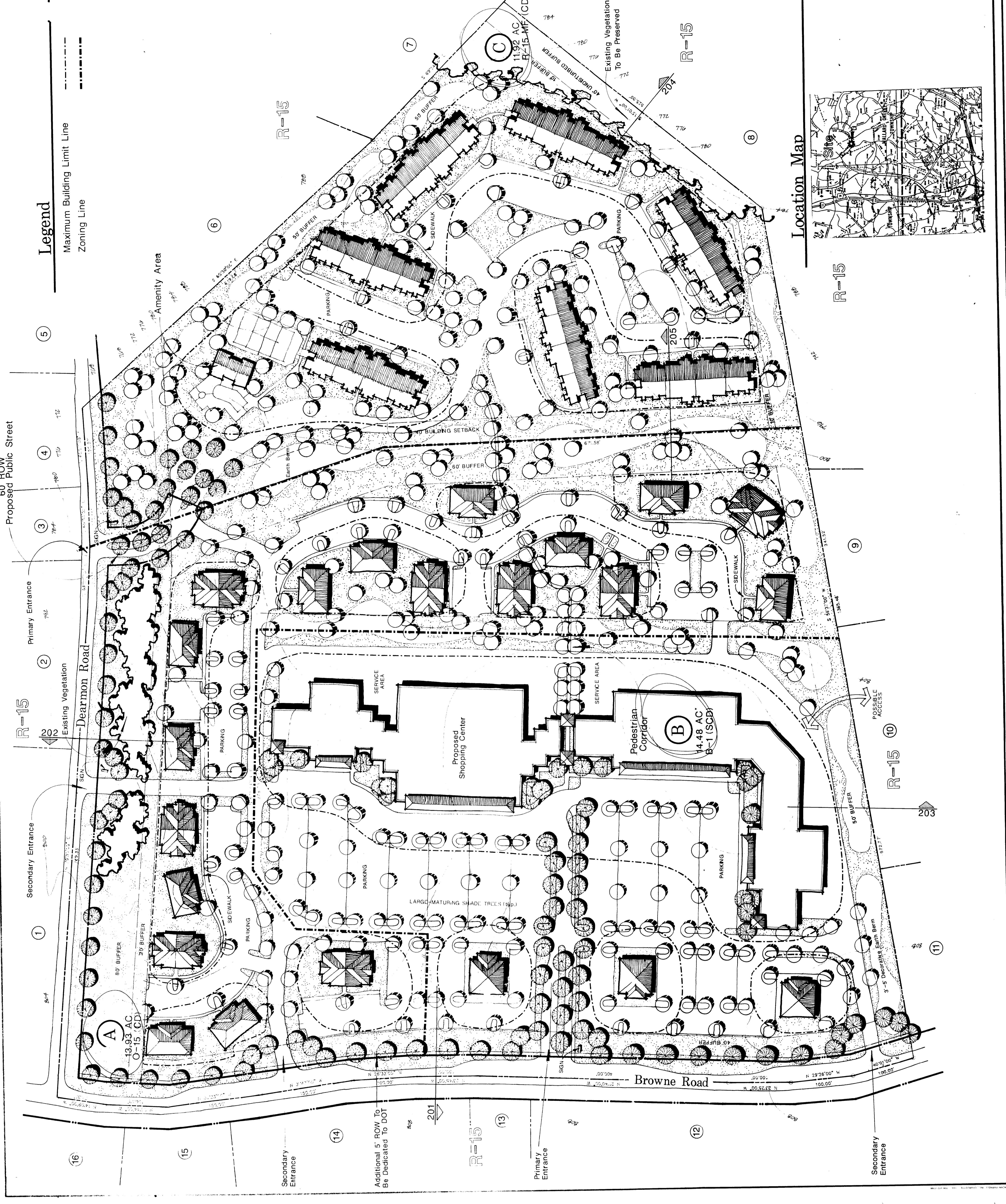

- Development Notes**
- All development in the B-1, O-15 (CD), and R-15 MF (CD) shall comply with the applicable provisions of the Metropolitan County Ordinance (MCO) and the applicable provisions of the Metropolitan County Ordinance (MCO) and the applicable provisions of the Metropolitan County Ordinance (MCO).
  - This site plan is intended to show the general character and building style and location, parking layout, and circulation pattern of the site. The site plan is not intended to show the exact location of the building, parking, and circulation pattern. All building and parking shall be designed to meet the requirements of the applicable provisions of the Metropolitan County Ordinance (MCO) and the applicable provisions of the Metropolitan County Ordinance (MCO).
  - Buffer and screening around the perimeter of the site shall be designed to meet the requirements of the applicable provisions of the Metropolitan County Ordinance (MCO) and the applicable provisions of the Metropolitan County Ordinance (MCO).
  - Landscaping shall be designed to meet the requirements of the applicable provisions of the Metropolitan County Ordinance (MCO) and the applicable provisions of the Metropolitan County Ordinance (MCO).
  - The site plan shall be designed to meet the requirements of the applicable provisions of the Metropolitan County Ordinance (MCO) and the applicable provisions of the Metropolitan County Ordinance (MCO).
  - The site plan shall be designed to meet the requirements of the applicable provisions of the Metropolitan County Ordinance (MCO) and the applicable provisions of the Metropolitan County Ordinance (MCO).
  - The site plan shall be designed to meet the requirements of the applicable provisions of the Metropolitan County Ordinance (MCO) and the applicable provisions of the Metropolitan County Ordinance (MCO).
  - The site plan shall be designed to meet the requirements of the applicable provisions of the Metropolitan County Ordinance (MCO) and the applicable provisions of the Metropolitan County Ordinance (MCO).
  - The site plan shall be designed to meet the requirements of the applicable provisions of the Metropolitan County Ordinance (MCO) and the applicable provisions of the Metropolitan County Ordinance (MCO).
  - The site plan shall be designed to meet the requirements of the applicable provisions of the Metropolitan County Ordinance (MCO) and the applicable provisions of the Metropolitan County Ordinance (MCO).
  - The site plan shall be designed to meet the requirements of the applicable provisions of the Metropolitan County Ordinance (MCO) and the applicable provisions of the Metropolitan County Ordinance (MCO).
  - The site plan shall be designed to meet the requirements of the applicable provisions of the Metropolitan County Ordinance (MCO) and the applicable provisions of the Metropolitan County Ordinance (MCO).
  - The site plan shall be designed to meet the requirements of the applicable provisions of the Metropolitan County Ordinance (MCO) and the applicable provisions of the Metropolitan County Ordinance (MCO).
  - The site plan shall be designed to meet the requirements of the applicable provisions of the Metropolitan County Ordinance (MCO) and the applicable provisions of the Metropolitan County Ordinance (MCO).
  - The site plan shall be designed to meet the requirements of the applicable provisions of the Metropolitan County Ordinance (MCO) and the applicable provisions of the Metropolitan County Ordinance (MCO).