

**H. ALLEN TATE, JR.  
OWNER**

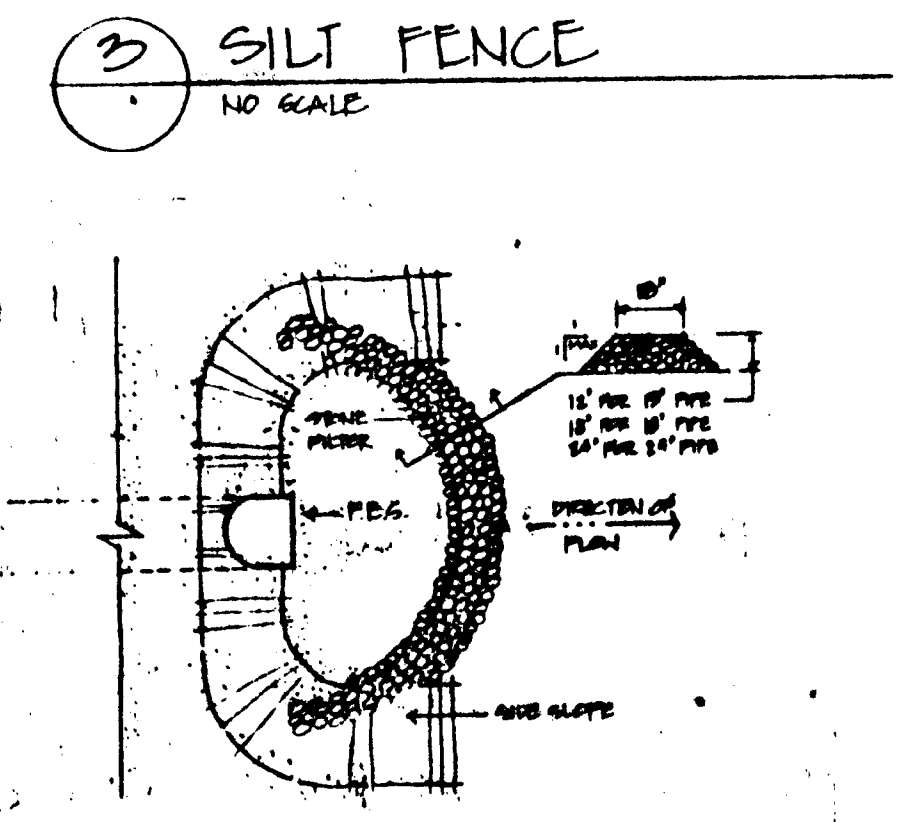

**LEGEND**

EXISTING CONTOUR	---
PROPOSED CONTOUR	---
PROPOSED SPOT ELEVATION	• 45.0
RETAINING WALL WITH TOP OF WALL ELEVATION	--- TW 40.0
FINISHED FLOOR ELEVATION	--- PFL 145.5
BREAK POINT	---
DIRECTION OF DRAINAGE	→
DROP INLET AND PIPE	---
SILT FENCE	---
DETAIL KEY	---

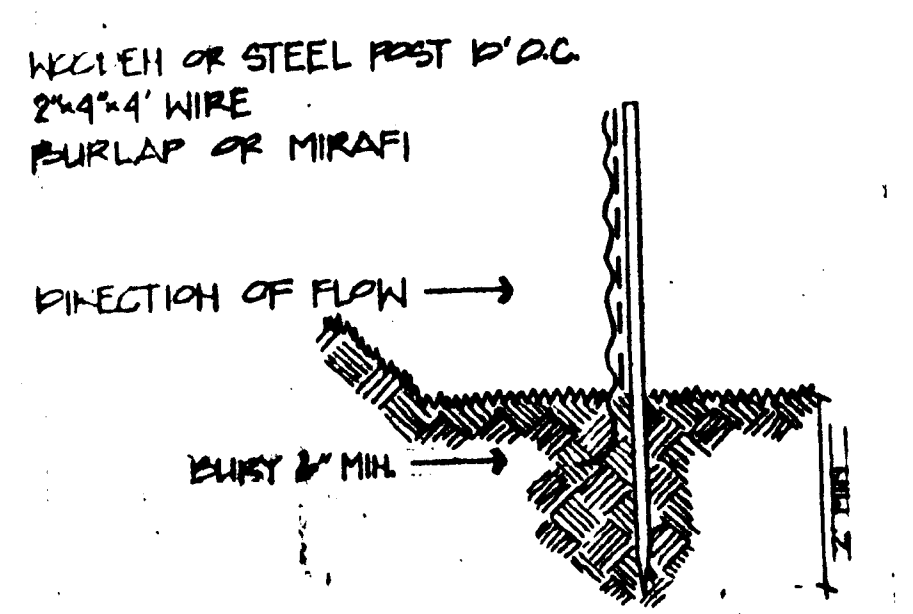
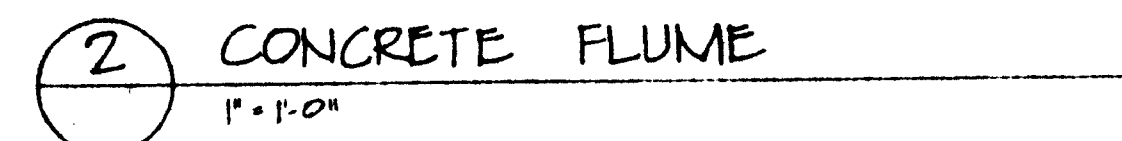
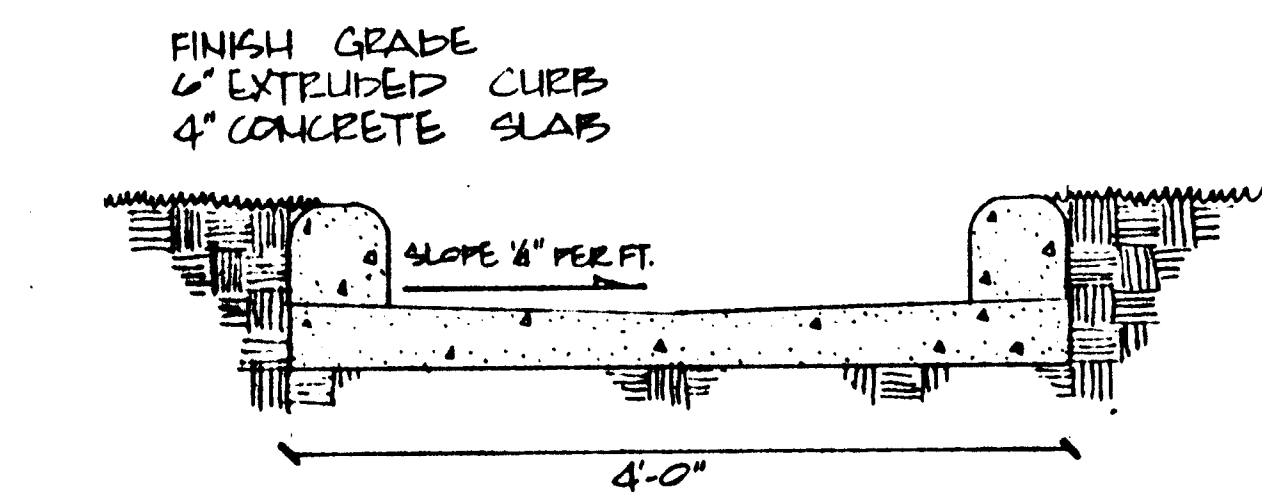
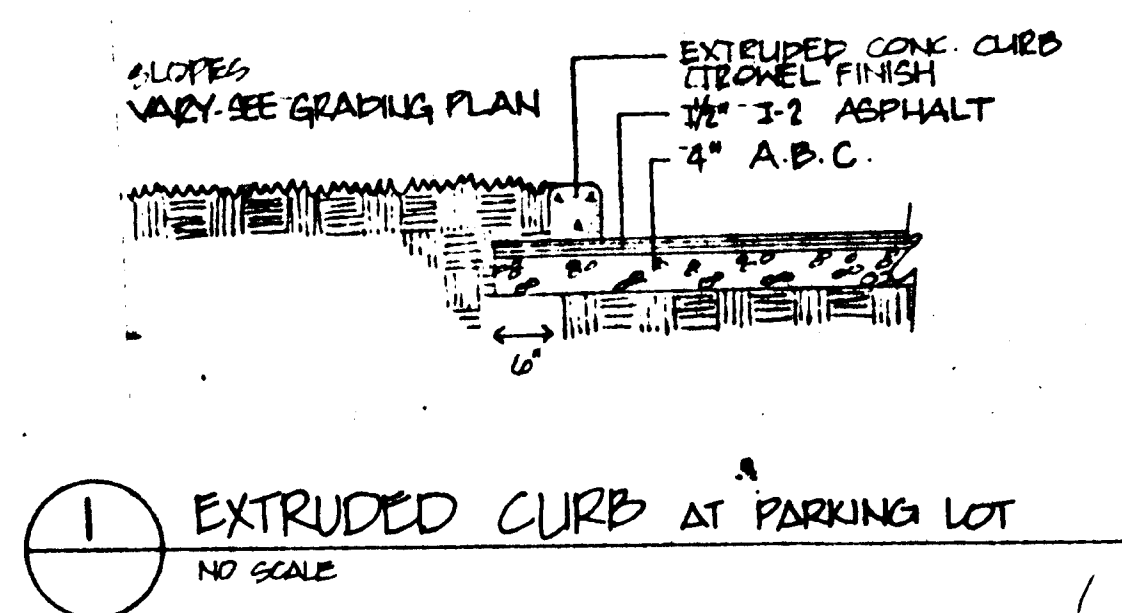
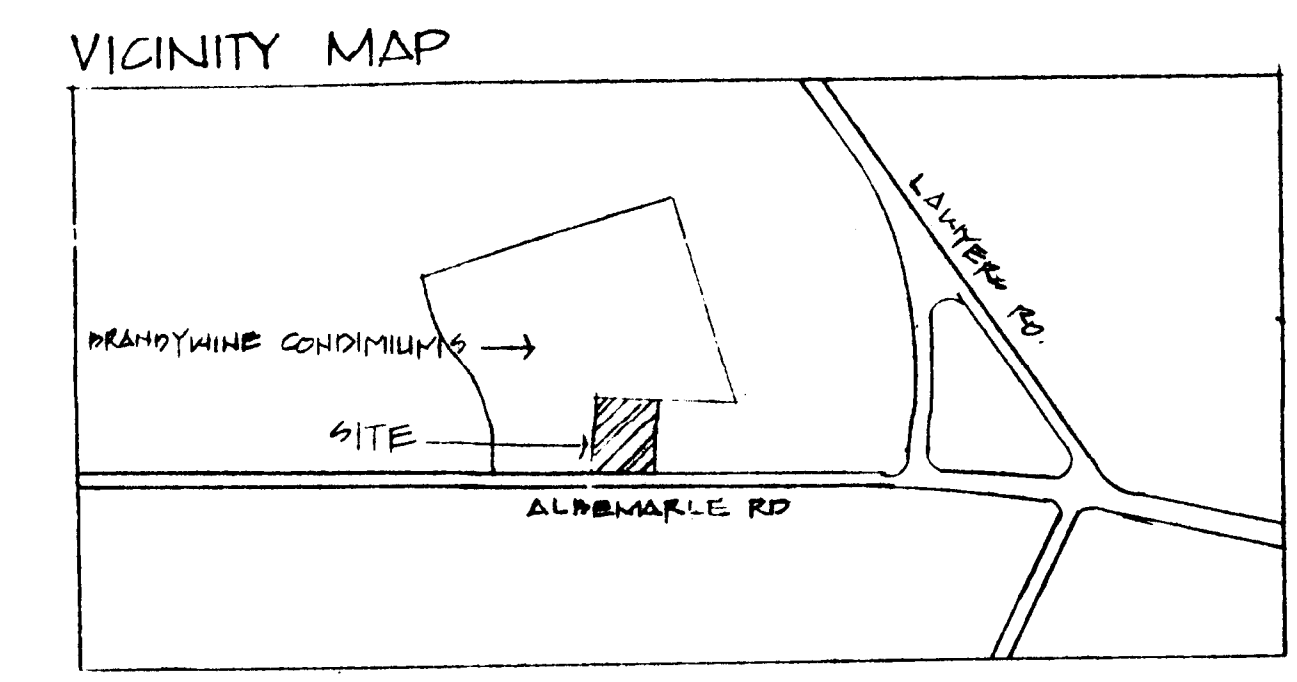

**SITE SEEDING SPECIFICATIONS**

PROTECTED AREA 0.7 AC.

**Construction Specifications:**

1. Install Silt Fence At Locations Shown On Plans
2. Inspection By County Engineer.
3. Grade Site To Subgrade. Maintain 8ft Fences And Stone Filter.
4. Install Storm Drainage Structure & Protect As Detailed. Maintain.
5. Areas Of The Site Not To Be Actively Constructed Open Shall Be Seeded Within 30 Days.
6. Construct Building And Pavement Areas.
7. Repair All Boded Areas, Maintain Silt Fences
8. Final Inspection By County Engineer.

**Site Seeding Specifications:**

1. Lime: Apply 4 Tons Per Acre. Disc.
2. Fertilizer: Apply 1000 Lbs./Acre 10-10-10 Apply 500 Lbs./Acre 20% Superphosphate
3. Seed: 80 Lbs./Acre Kentucky Fescue 3.
4. Mulch: Apply 1 1/2 Tons/Acre White Stone On All Seeded Areas.
5. Tack: All Slopes Exceeding 3:1 To Heavy Asphalt Tack Applied At The Rate of 2.5 Gallons/Acre

**SITE TABULATION**

EXISTING ZONING	O.U.C.D.
PROPOSED ZONING	O.G.C.D. SITE PLAN AMEND
BUILDING SQ. FT.	4015 SQ. FT.
PARKING REQUIRED	12.0 SPACES
PARKING PROVIDED	35.0 SPACES
SITE AREA APPROX (EXCLUDING NEW R.O.W.)	7.0 ACRE

**INLET CONTROL DATA**

Qw = 19.38 cfs.	REQUIRED FOR 10 YR. STORM:
Cw = 35	■ DROP INLET W/ CONCRETE TOP
h = 0.66'	■ HEIGHT OF OPENING = 5" (h)
L = 0.66'	■ TOTAL LENGTH OF OPENINGS = 125.6" (L)
h <sup>3/2</sup> = 0.53'	
b = Qw / Cw h <sup>3/2</sup>	
= 10.41'	
= 125.6"	

- GENERAL NOTES**
1. PARKING SPACES 9' x 18' TYP. HANDICAP SPACES 12.5' x 18' TYP.
  2. ALL DIMENSIONS ARE TO FACE OF CURB.
  3. SEE ARCHITECTURAL PLANS FOR BLDG DIMENSIONS.
  4. DRIVEWAY IS 90° TO EXISTING ALPEMARLE ROAD.
  5. ALL DIMENSIONS SHOWN ARE 90° OFF BASELINE. BASELINE IS E. OF PRINE.

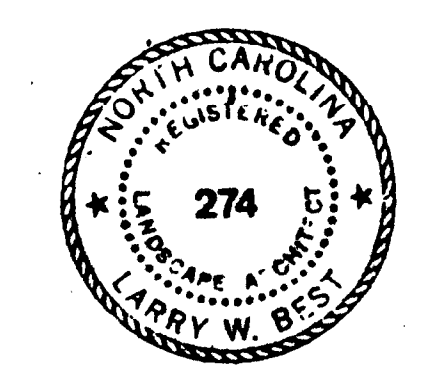
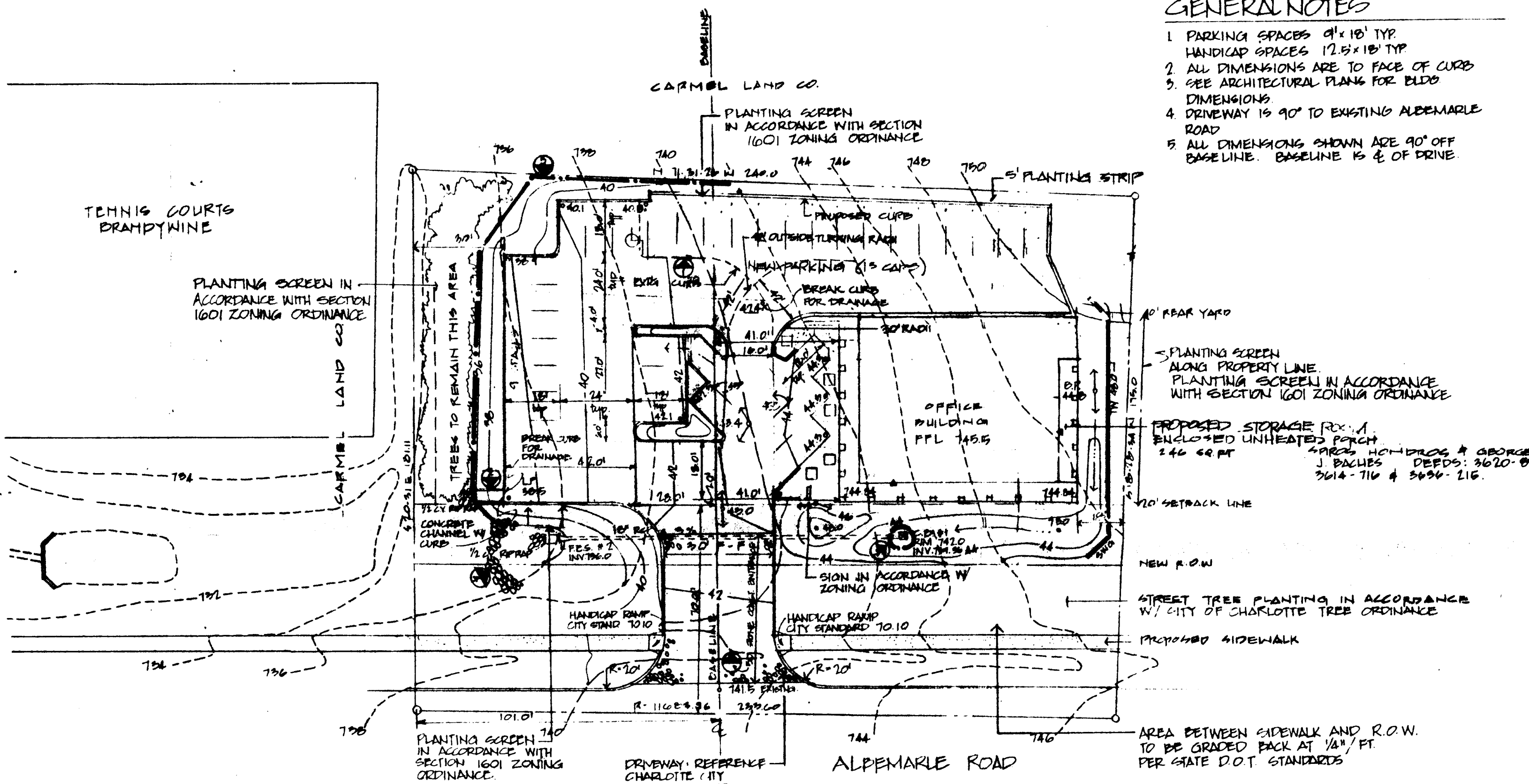

**DATE:** 12 July 82

**REVISIONS:**

6/19/82 DIMENSIONS & GENERAL NOTES ADDED

6 MAY 88 ADDITION ADDED

7 JULY 88 REVISION TO REAR PARKING TURNING RADII, STORM WATER CALCULATIONS REMOVED, SCREENING NOTE REVISED

**88-55**  
N. Allen Tate, Jr.  
**LAND DESIGN, INC.**

**Landscape Architects**

1701 East Boulevard  
Charlotte, NC 28203  
704 333-0325

8315  
APPROVED BY CITY COUNCIL  
DATE 8/15/88