



* 0 0 B R E A K 0 0 *



**ADVANCED
IMAGING
SYSTEMS**

www.aisimc.com

An Information
Management Company

City of Charlotte – Planning Dept. Scanning Rezoning Files

Petition # _____

Document type:

- Applications
- Correspondence
- Department Comments
- Land Use Consistency
 - Mail Info
 - Mapping
 - Other
- Site Plans



* 0 0 B R E A K 0 0 *

TRACT 1
087-057-52
CITY OF CHARLOTTE
DEED 4135-856

078-057-50
LINUS L. BANKER
DEED 1353-317

078-057-51
LINUS L. BANKER
DEED 1841-400

TRACT 2 (only)
LEASE LOT

SUGAR CREEK ROAD

+1107 TO CUSHMAN ST.

TOTAL AREA: 47,911 Sq. Ft. = 1.100 Ac.
AREA IN EXIST. R/W: 11,742 Sq. Ft. = 0.270 Ac.

NOTE:
PROPERTY CORNERS SHOWN AS OPEN CIRCLES
WERE LOCATED BY ACTUAL SURVEY. BEARINGS
AND DISTANCES SHOWN IN PARENTHESES ARE
BASED ON DEED INFORMATION. BEARINGS ARE
BASED ON DEED BOOK 1841 PAGE 400.

THIS PLAT DOES NOT MEET THE RECORDATION
STANDARDS OF GS 47-30.

THIS PLAT WAS PREPARED
UNDER MY SUPERVISION

N.C. REG. SURVEYOR NO. L-1482.



CHARLOTTE ENGINEERING DEPARTMENT		JOB NO. 018-00-030
PHYSICAL SURVEY FOR PROPERTY TO BE LEASED SUGAR CREEK ROAD		FILE NO.
PROPERTY OF CITY OF CHARLOTTE		SHEET 1
DATE MAY 23, 1988	SCALE 1"=60'	1

88-520

Survey

TREAT @ (on log)
~~ST~~ STAIN

087-061-05
CITY OF CHARLOTTE
DEED 3573-217

TRACT 1
087-057-52
CITY OF CHARLOTTE
DEED 4135-856

078-057-50
LINUS L. BANKER
DEED 1353-317

078-057-51
LINUS L. BANKER
DEED 1841-400

TRACT 1

TOTAL AREA: 99,996 Sq. Ft. = 2.296 Ac.
AREA IN EXIST. R/W: 12,578 Sq. Ft. = 0.289 Ac.

TRACT 2

TOTAL AREA: 47,911 Sq. Ft. = 1.100 Ac.
AREA IN EXIST. R/W: 11,742 Sq. Ft. = 0.270 Ac.

NOTE:

PROPERTY CORNERS SHOWN AS OPEN CIRCLES WERE LOCATED BY ACTUAL SURVEY. BEARINGS AND DISTANCES SHOWN IN PARENTHESES ARE BASED ON DEED INFORMATION. BEARINGS ARE BASED ON DEED BOOK 1841 PAGE 400.

THIS PLAT DOES NOT MEET THE RECORDATION STANDARDS OF GS 47-30.

THIS PLAT WAS PREPARED UNDER MY SUPERVISION

Radford Dennis Smith

N.C. REG. SURVEYGR NO. L-1482.

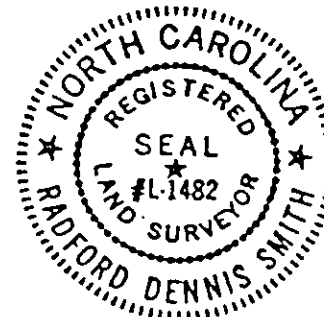

REVISIONS		BOUNDARY SURVEY FOR PROPERTY TO BE LEASED, SUGAR CREEK ROAD	JOB NO. 516-66-539
		PROPERTY OF CITY OF CHARLOTTE	FILE NO.
DRAWN BY R/JW/ACAD			SHEET 1
CHECKED BY <i>RLB</i>			OF 1
SURVEY SUPVR. <i>Radford Dennis Smith</i>		DATE MAY 4, 1988	SCALE 1"=100'

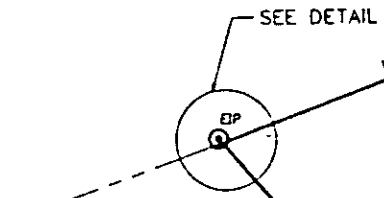

DETAIL
NO SCALE

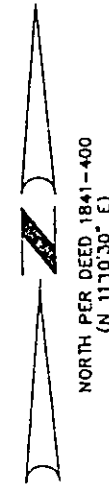

SUGAR CREEK ROAD

TO CUSHMAN ST.