

SCHEMATIC SITE PLAN
NORTH CAROLINA HWY 16 TRACT
 MECKLENBURG COUNTY, N.C.

PREPARED FOR
BRISTOL DEVELOPMENT CORPORATION
 REZONING PETITION NO.: 88-67(C)

FRANZMAN / DAVIS
 & Associates, Ltd.
 LAND PLANNERS • LANDSCAPE ARCHITECTS
 ATLANTA
 OCTOBER 24, 1988

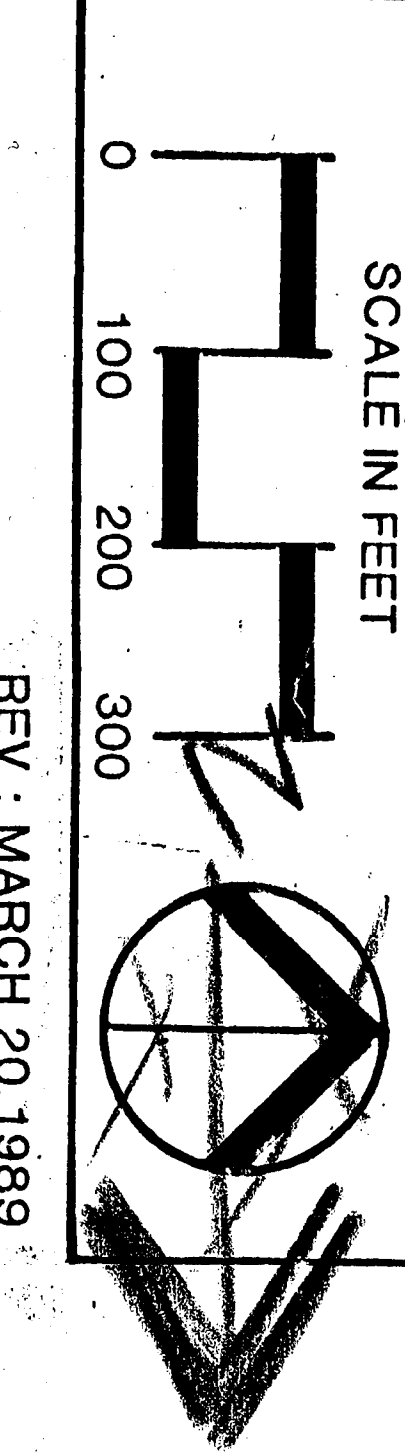

REV: MARCH 20, 1989

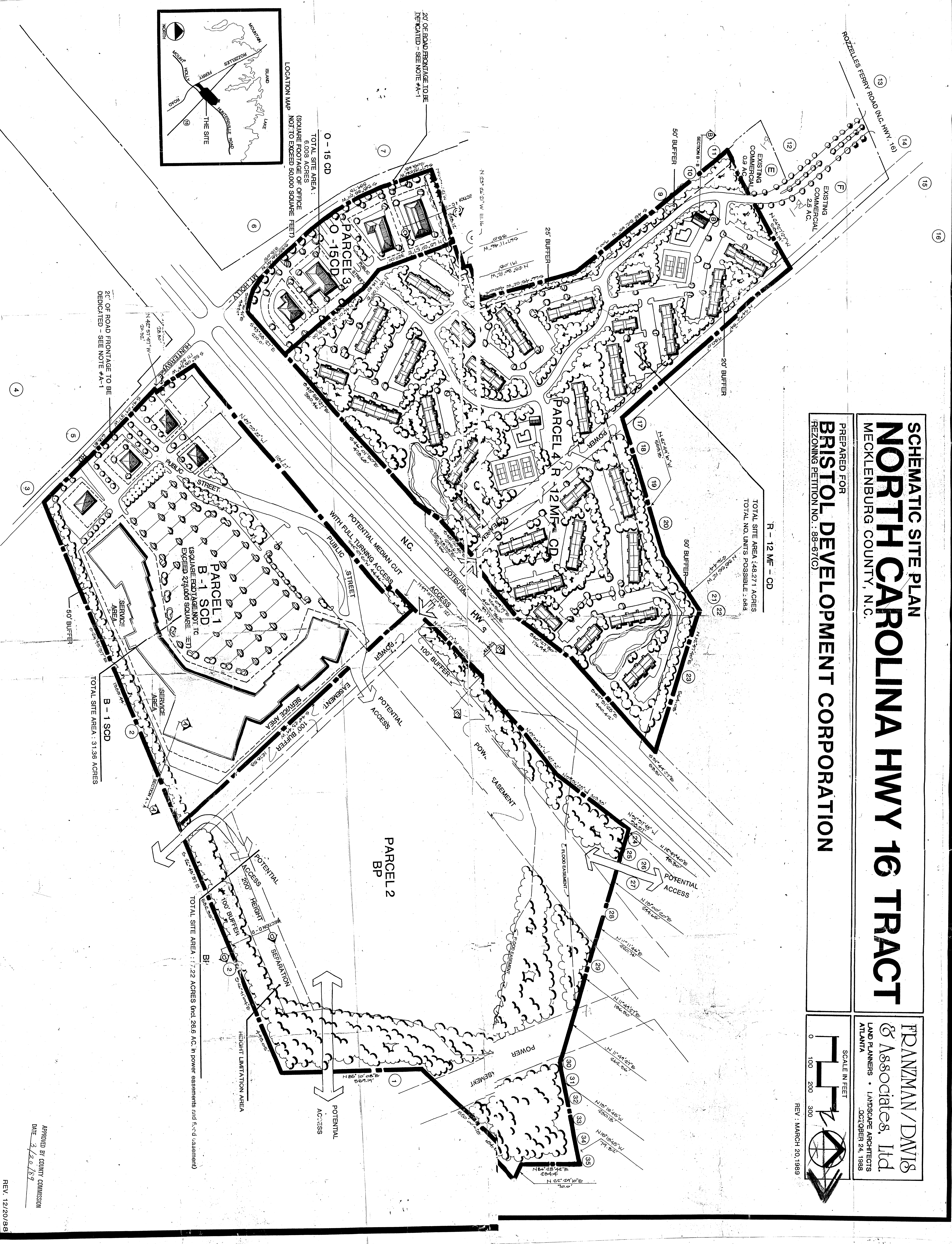

20' OF ROAD FRONTAGE TO BE DEDICATED - SEE NOTE #A-1

50' BUFFER

TOTAL SITE AREA: 17.22 ACRES (incl. 26.6 AC. in power easements and R.O.D. easement)

APPROVED BY COUNTY COMMISSION
 DATE: 3/20/89

REV. 12/20/88

88-67(C)

