

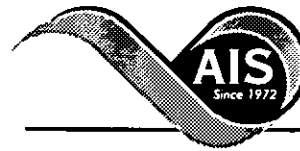

* 0 0 B R E A K 0 0 *



**ADVANCED
IMAGING
SYSTEMS**

An Information
Management Company

www.aisimc.com

City of Charlotte – Planning Dept. Scanning Rezoning Files

Petition # _____

Document type:

- Applications
- Correspondence
- Department Comments
- Land Use Consistency
 - Mail Info
 - Mapping
 - Other
- Site Plans



* 0 0 B R E A K 0 0 *

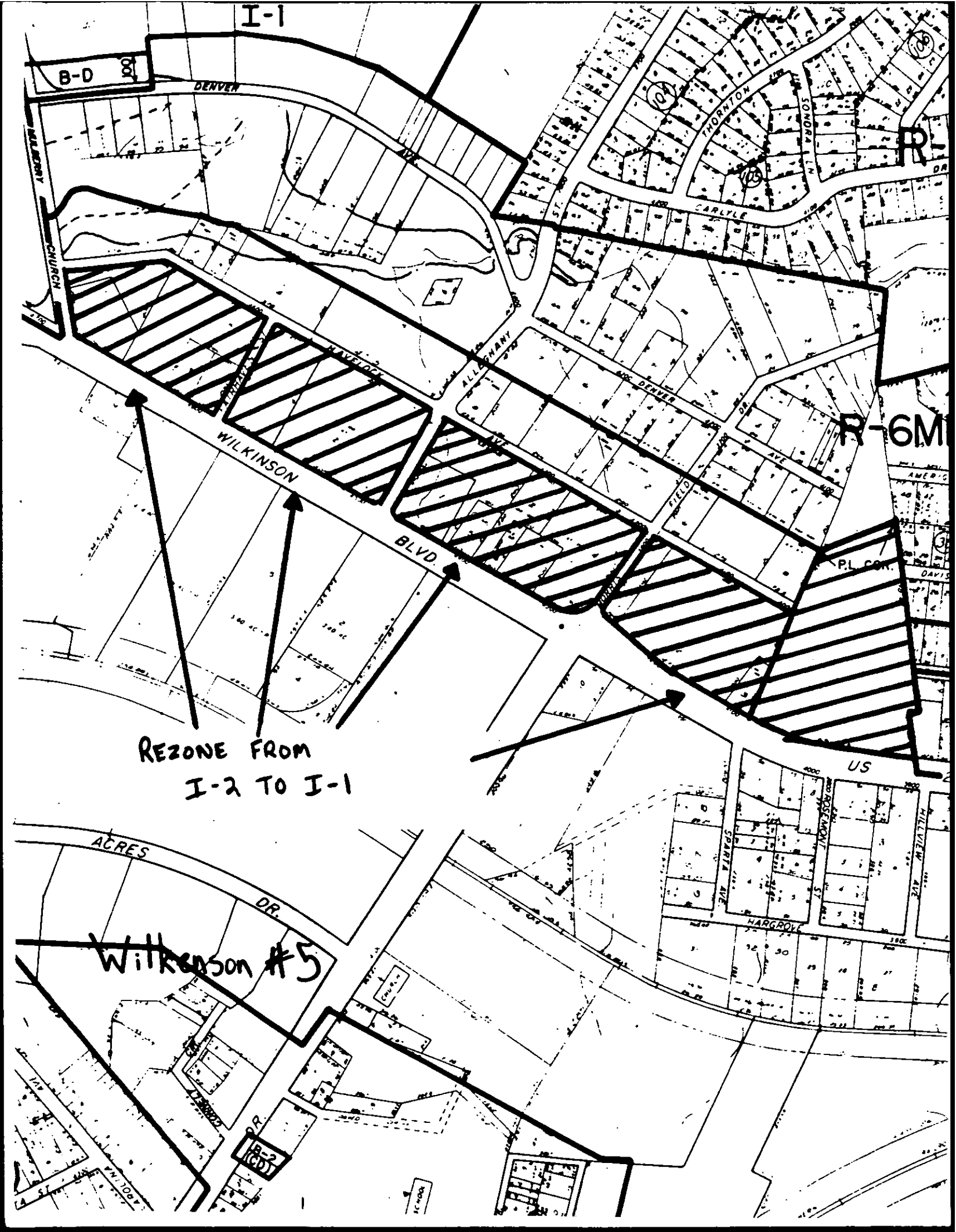

I-1

B-D

DENVER

WILKINSON CHURCH

CARLYLE

THORNTON

SONORA LN

R-6M

WILKINSON

BLVD.

R-6M

REZONE FROM
I-2 TO I-1

US

ACRES

DR.

Wilkinson #5

SARITA AVE

HARGROVE

HILLVIEW AVE

I-2

(CD)

1000

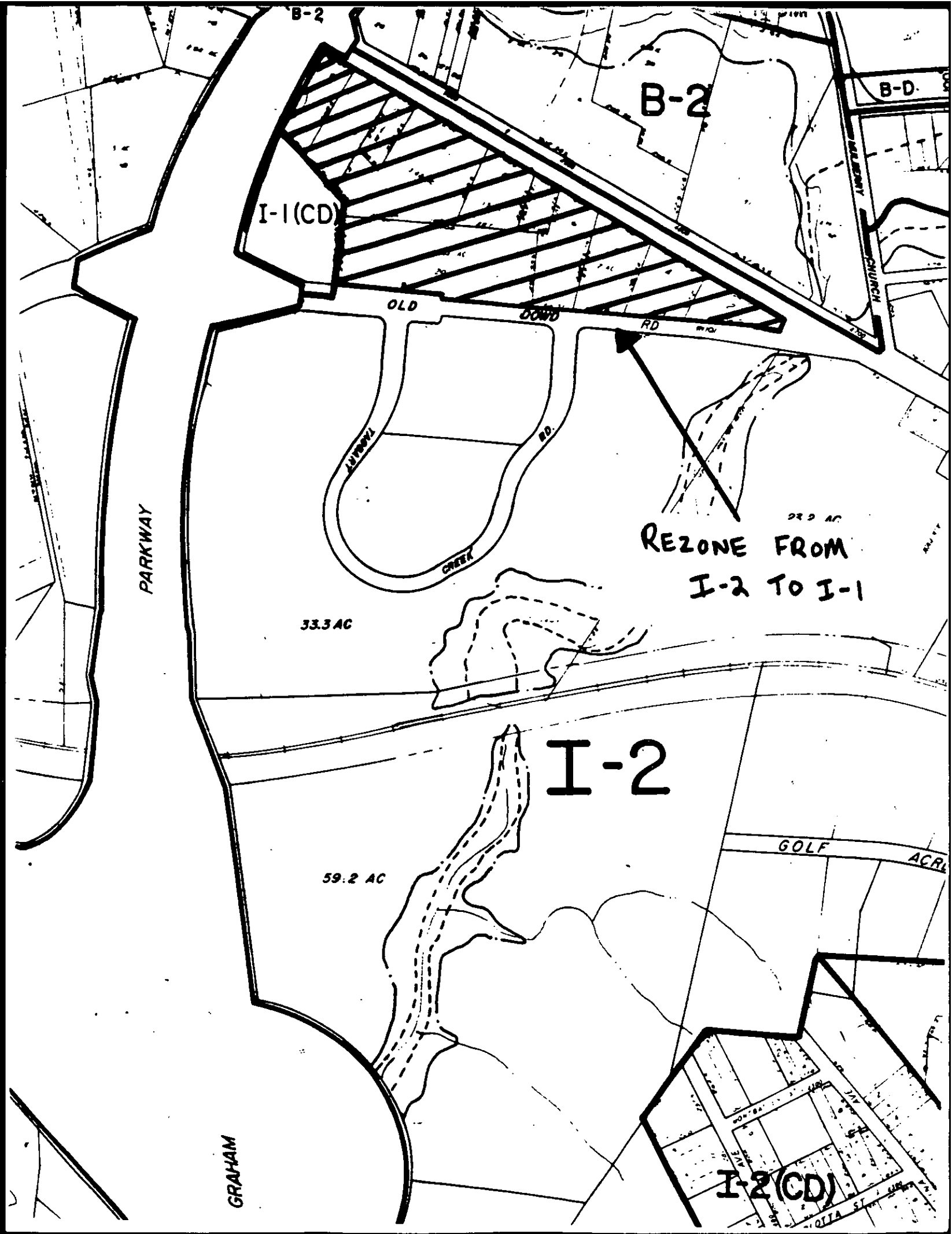

I-1(CD)

B-2

B-D

OLD

DOWD

RD

PARKWAY

33.3 AC

CREEK

I-2

59.2 AC

GOLF

ACRE

GRAHAM

REZONE FROM
I-2 TO I-1

I-2(CD)

22.2 AC

PETITIONER Charlotte-Mecklenburg Planning Commission

PETITION NO. 88-70 HEARING DATE August 29, 1988

ZONING CLASSIFICATION, EXISTING I-2 REQUESTED I-1

LOCATION Approximately 50.2 acres located east of Mulberry Church Road,
west of the intersection of Wilkinson Boulevard and Hillview
Avenue, south of Havelock Avenue, north of Wilkinson Boulevard.
Additional parcels are located east of Billy Graham Parkway,
south of Wilkinson Boulevard, and north of Old Dowd Road.

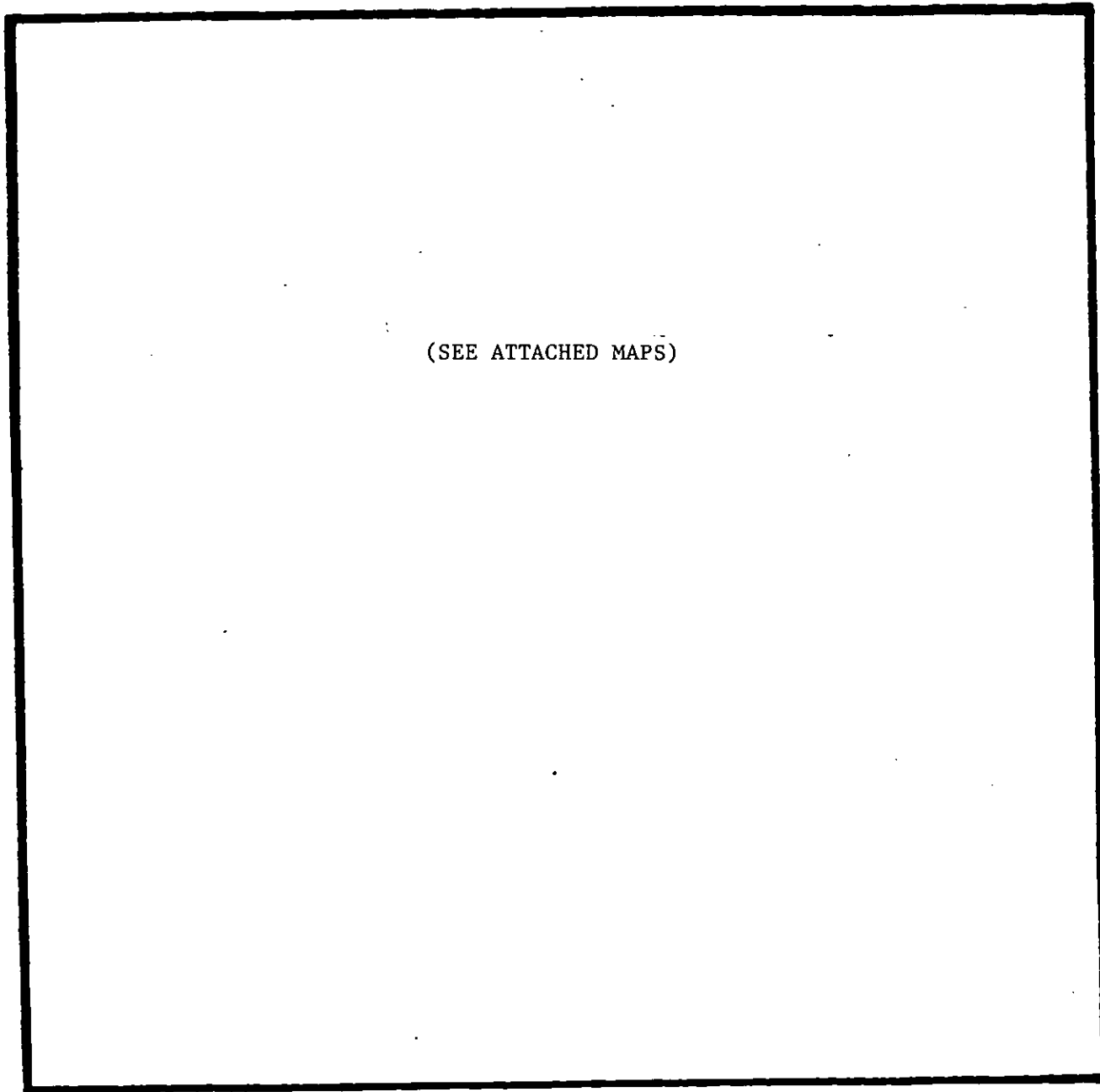

ZONING MAP NO. 104

SCALE 1" = 400'

PROPERTY PROPOSED FOR CHANGE

