

Matlox Parts Supply, Inc.  
(4105-304)

R-9 MF

**DEVELOPMENT DATA**

**SITE AREA** ————— 4.029 AC.  
**EXISTING ZONING** — I-2(CD) SITE PLAN AMENDMENT  
**PROPOSED ZONING** — I-2(CD)  
**PROPOSED USE:** Expand existing equipment manufacturing facility.  
**EXISTING BUILDING AREA** 15,800 S.F.  
**PROPOSED BUILDING AREA** 20,800 S.F.  
**TOTAL** 36,600 S.F.

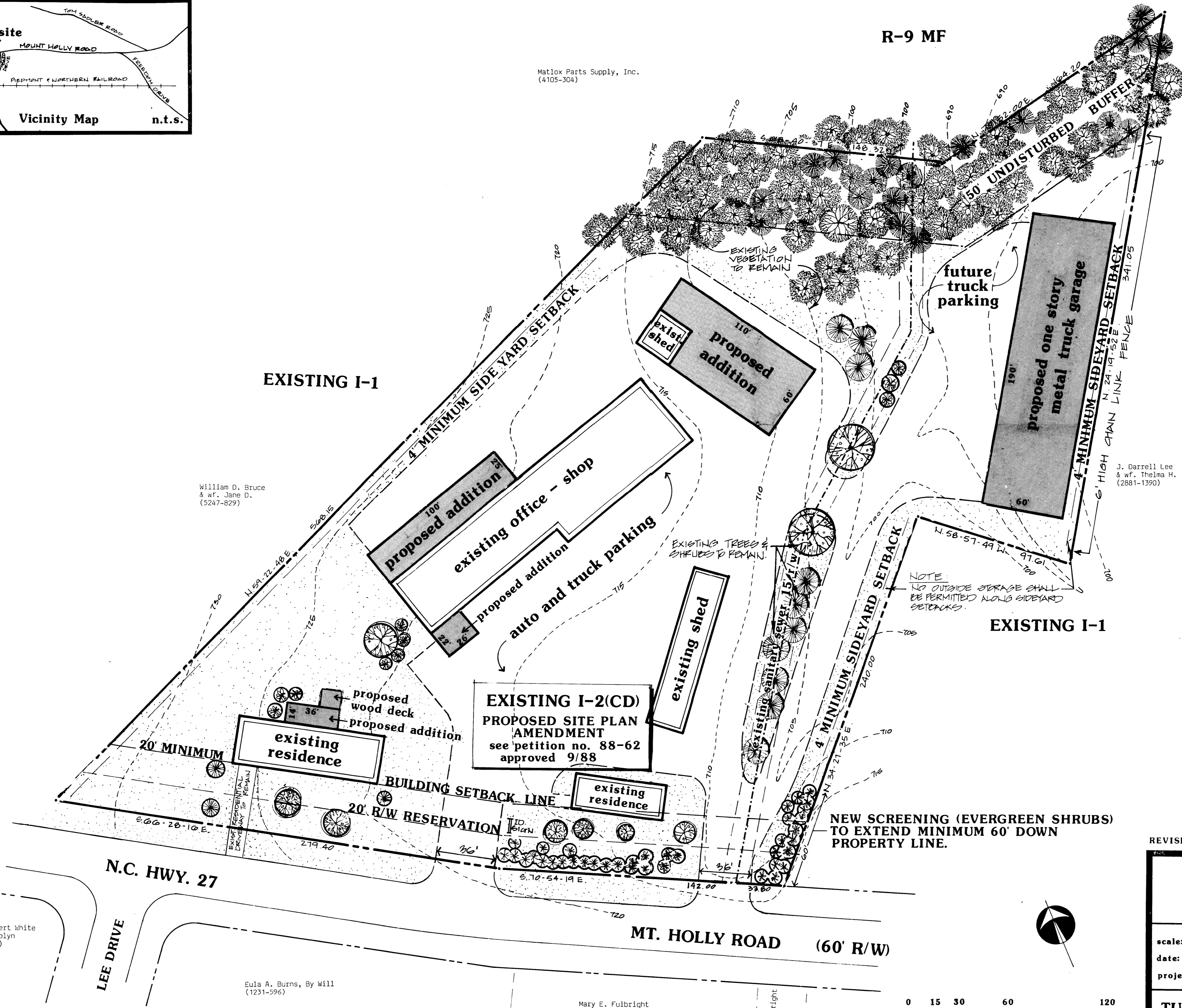

William D. Bruce  
& wf. Jane D.  
(5247-829)

J. Darrell Lee  
& wf. Thelma H.  
(2881-1390)

**EXISTING I-2(CD)**  
**PROPOSED SITE PLAN AMENDMENT**  
 see petition no. 88-62  
 approved 9/88

**NOTE**  
 NO OUTSIDE STORAGE SHALL BE PERMITTED ALONG SIDEYARD SETBACKS.

**GENERAL NOTES**

- Boundary information provided by Robert E. Burns, N.C.L.S., dated 2/9/88 and revised 2/17/88.
- Signage shall be provided in accordance with all applicable sections of the Charlotte Zoning Ordinance pertaining to I-2 zoning.
- If necessary, public or private fire hydrants shall be provided in order to satisfy Mecklenburg County Fire Department standards.
- Supplementary evergreen screening shall be provided in buffer areas where existing vegetation does not provide an adequate visual screen between this property and adjoining residentially-zoned land.
- A five foot landscaped buffer shall be provided along property lines where existing vegetation is insufficient to break up long expanses of parking.

APPROVED BY CITY COUNCIL  
 3/9/89-provide 20' r/w reservation  
 11/16/88 - deleted r/w dedication DATE March 27, 1989  
 8/5/88 - general, per staff comments  
 REVISIONS: 7/5/88 - proposed addition (to existing residence) *Roger R. Lee*

**Petition #88-62-87-1**  
**LEE PROPERTY REZONING**  
 PAW CREEK TOWNSHIP - MECKLENBURG COUNTY

scale: 1" = 30'  
 date: 6/16/88  
 project: 8812

**Proposed Zoning and Site Plan Amendment**

**TURNBULL DESIGN GROUP, P.A.**  
 1815 PARK DRIVE, SUITE 206  
 CHARLOTTE, NORTH CAROLINA 28204  
 (704)375-8154

**R-1**  
 - Plan superseded by

James Elbert White  
& wf. Carolyn  
(1795-108)

Eula A. Burns, By Will  
(1231-596)

Mary E. Fulbright  
(4567-660)

Donald S. Eaker  
& wf. Susan H.  
(3831-825)

Gailther Omaha Fulbright  
& wf. Mary  
(1293-596)

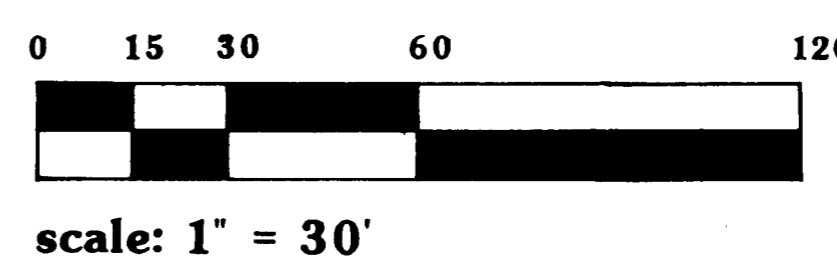

*See plan administered July approved 8/1/90 by Martin R. Cranberry, Jr.*