

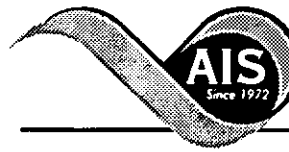

\* 0 0 B R E A K 0 0 \*



**ADVANCED  
IMAGING  
SYSTEMS**

www.aisimc.com

An Information  
Management Company

# City of Charlotte – Planning Dept. Scanning Rezoning Files

Petition # \_\_\_\_\_

## Document type:

- Applications
- Correspondence
- Department Comments
- Land Use Consistency
  - Mail Info
  - Mapping
  - Other
- Site Plans



\* 0 0 B R E A K 0 0 \*

CHANTILLY / COMMONWEALTH PETITION #3  
 Part 1: B-2 TO O-6 & B-2 TO B-1  
 Part 2: B-2 TO R-6 & O-6 TO R-6

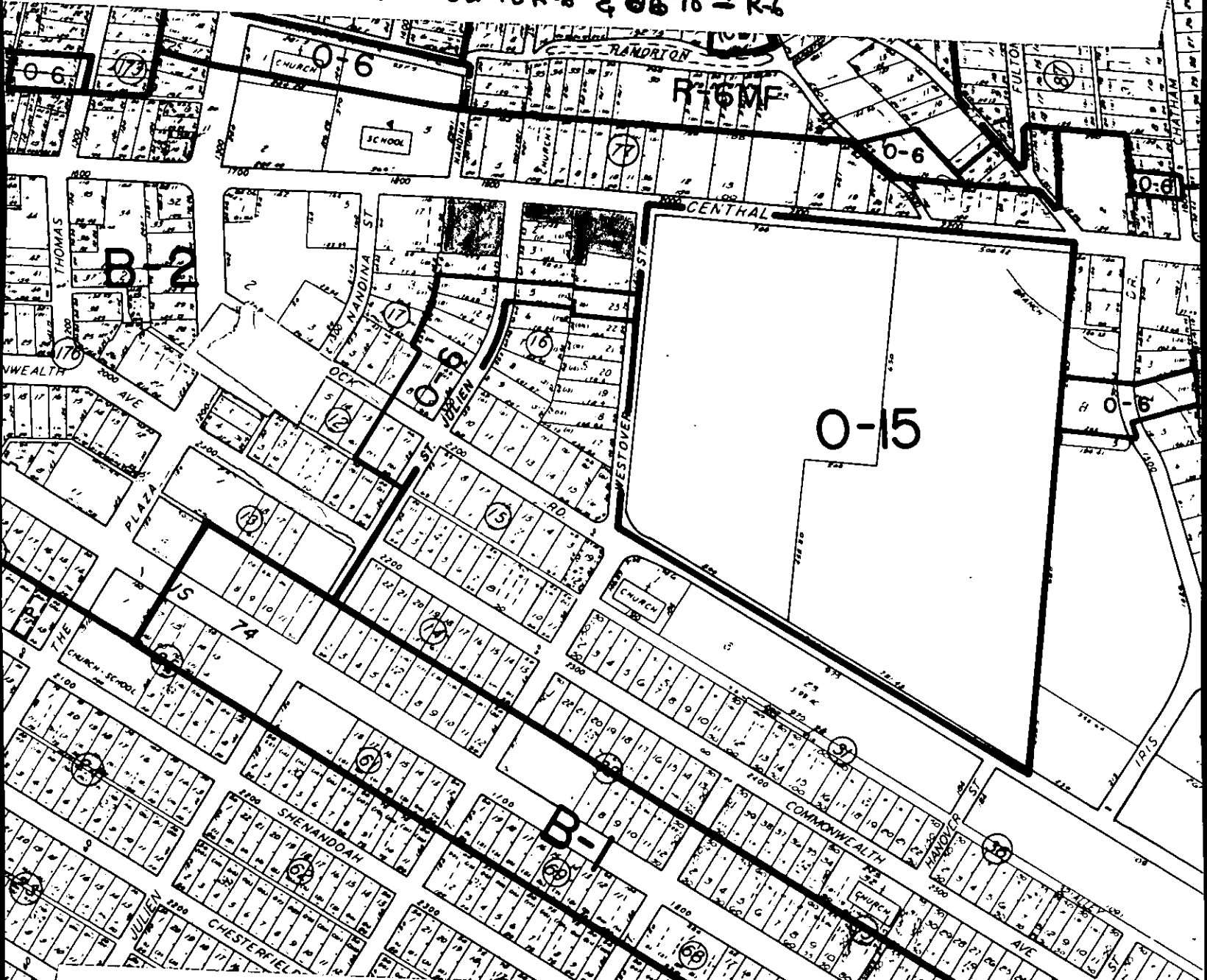

B-2 TO O-6  B-2 TO B-1  B-2 & O-6 TO R-6

- HISTORIC PROPERTIES COMMISSION INVENTORY
- 101 VAN LANDINGHAM HOUSE
  - 104 VICTORIA
  - 1506 MOORE- GOLDEN HOUSE
  - 1503 WALTER L. ALEXANDER HOUSE
  - 1507 HARRY ARTHUR ZEIM HOUSE

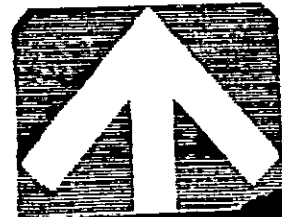

89-35

# CHARITILLY COMMONWEALTH #3 PART 1 B-2 TO 0-6 & B-D TO B-1 PART 2 B-2 & 0-6 TO R-6

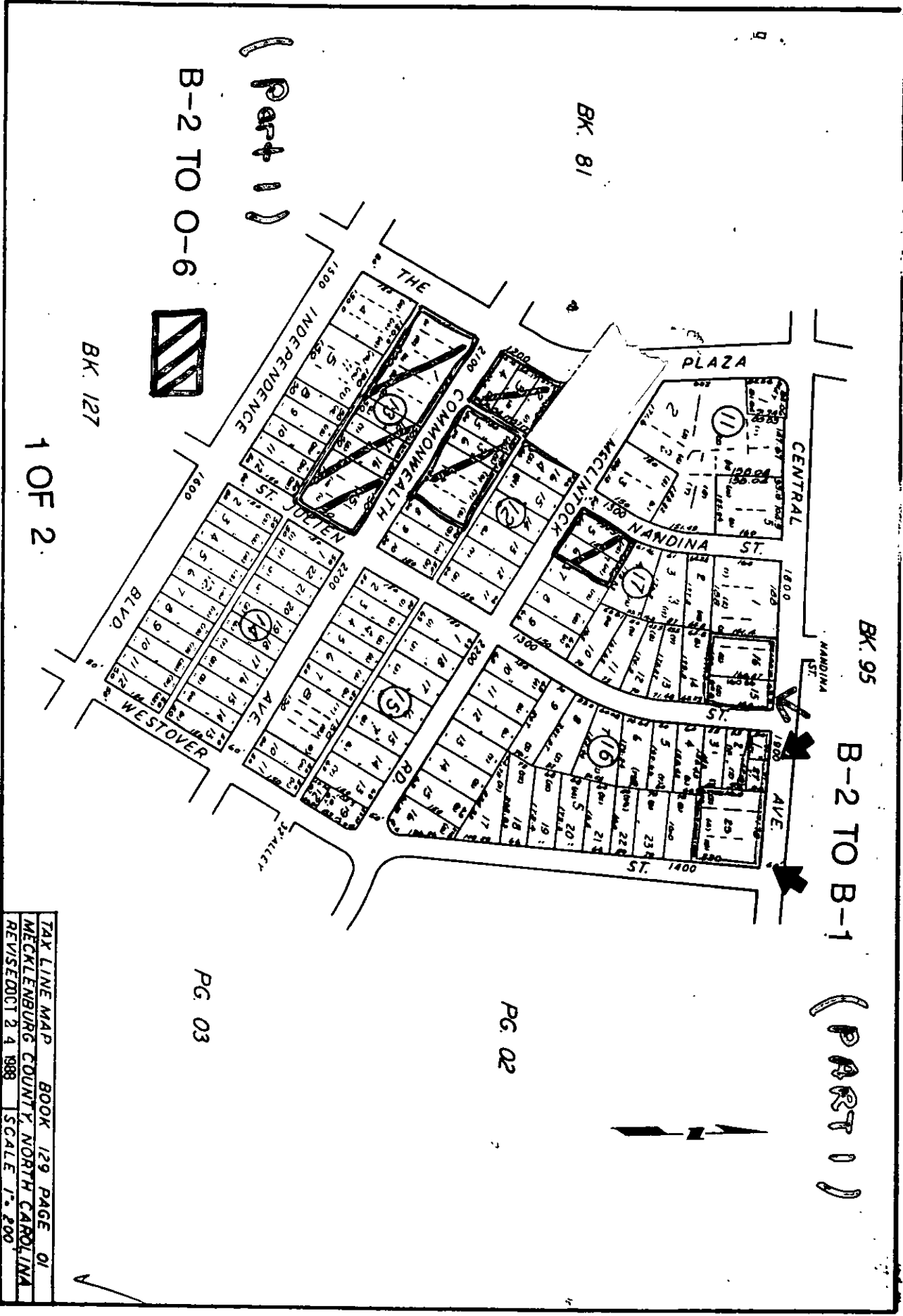

BK. 95 B-2 TO B-1 (PART 1)

BK. 81

B-2 TO 0-6



BK. 127

(Part 1)

1 OF 2

PG. 03

PG. 02

TAX LINE MAP	BOOK 129	PAGE 01
MECKLENBURG COUNTY, NORTH CAROLINA		
REVISED OCT 24 1988	SCALE 1" = 200'	

END TAX DIVISION CIV

CHAUTILLY / COMMONWEALTH #3  
 PART 1 B-2 TO O-6 & B-2 TO B-1  
 PART 2 B-2 AND O-6 TO R-6

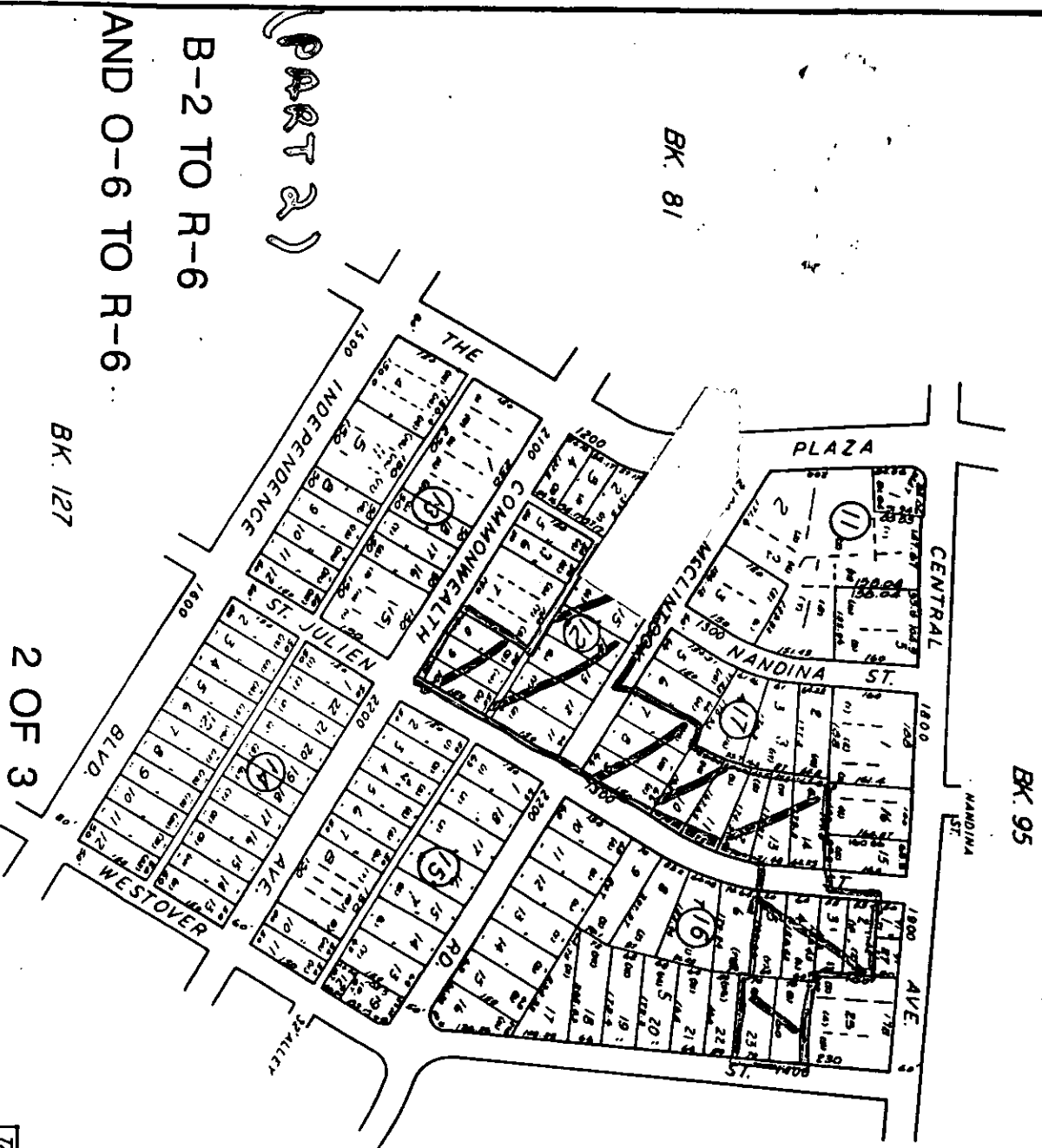

BK. 81

BK. 95

(PART 2)  
 B-2 TO R-6  
 AND O-6 TO R-6

BK. 127

2 OF 3

PG 02

PG 03