



* 0 0 B R E A K 0 0 *



**ADVANCED
IMAGING
SYSTEMS**

www.aisimc.com

An Information
Management Company

City of Charlotte – Planning Dept. Scanning Rezoning Files

Petition # _____

Document type:

- Applications
- Correspondence
- Department Comments
- Land Use Consistency
 - Mail Info
 - Mapping
 - Other
- Site Plans



* 0 0 B R E A K 0 0 *

PETITIONER Equity Ventures, Inc.

PETITION NO. 89-35(c) HEARING DATE September 11, 1989

ZONING CLASSIFICATION, EXISTING R-15 REQUESTED R-12 (CD)

LOCATION Approximately 20 acres located on the easterly side of Erwin Road north of York Road.

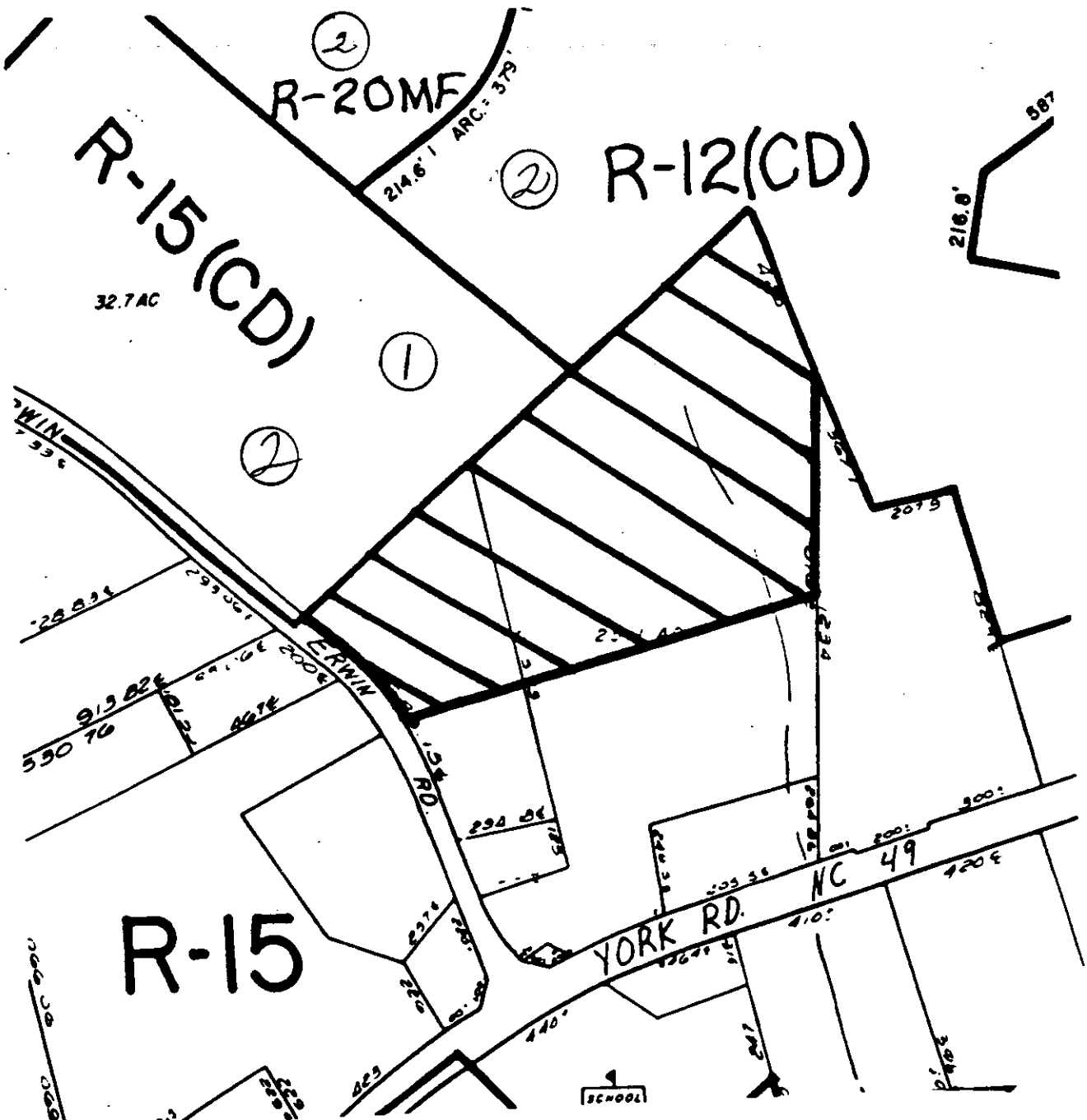

ZONING MAP NO. 150

SCALE 1" = 400'

PROPERTY PROPOSED FOR CHANGE



OFFICIAL REZONING APPLICATION MECKLENBURG COUNTY

Petition No. 89-35(C)
Date Filed July 10, 1989
Received By [Signature]

OFFICE USE ONLY

Ownership Information

Property Owner Equity Ventures, Inc.

Owner's Address 1433 Emerywood Drive

Charlotte, NC 28210

Date Property Acquired January 17, 1989

Deed Reference 5944-0933

Tax Parcel Number 201-121-007

Location Of Property (address or description) located on Erwin Road (S.R. 1120) just north of the intersection of Erwin Road and York Road (NC49)

Description Of Property

Size (Sq. Ft.-Acres) 20.00 Acres (871,200 S.F.) Street Frontage (ft.) 474.53

Current Land Use Vacant

Zoning Request

Existing Zoning R-15 Requested Zoning R-12

Purpose of Zoning Change To allow for smaller lots around a common open space network

Name Of Agent

Gifford Nielson Associates, Inc.

Agent's Address

428 E. 4th St., Suite 408
Charlotte, NC 28202

Telephone Number

704/373-1907

Name of Petitioner(s)

Equity Ventures, Inc.

Address of Petitioner(s)

1433 Emerywood Drive
Charlotte, NC 28210

Telephone Number

704/558-1490

[Signature]
Signature