



\* 0 0 B R E A K 0 0 \*



**ADVANCED  
IMAGING  
SYSTEMS**

www.aisimc.com

An Information  
Management Company

# City of Charlotte – Planning Dept. Scanning Rezoning Files

Petition # \_\_\_\_\_

## Document type:

- Applications
- Correspondence
- Department Comments
- Land Use Consistency
  - Mail Info
  - Mapping
  - Other
- Site Plans



\* 0 0 B R E A K 0 0 \*

STATE 85

I-1

Allegheny

200

44 AC

R-15MF

21.1 AC

I-2

20.6 AC

CONDITIONAL USE - OUTDOOR  
AMUSEMENT UNDER  
SEC. 23-40.02

COND.  
AMUSEMENT

I-1

R-9MF

R-9

R

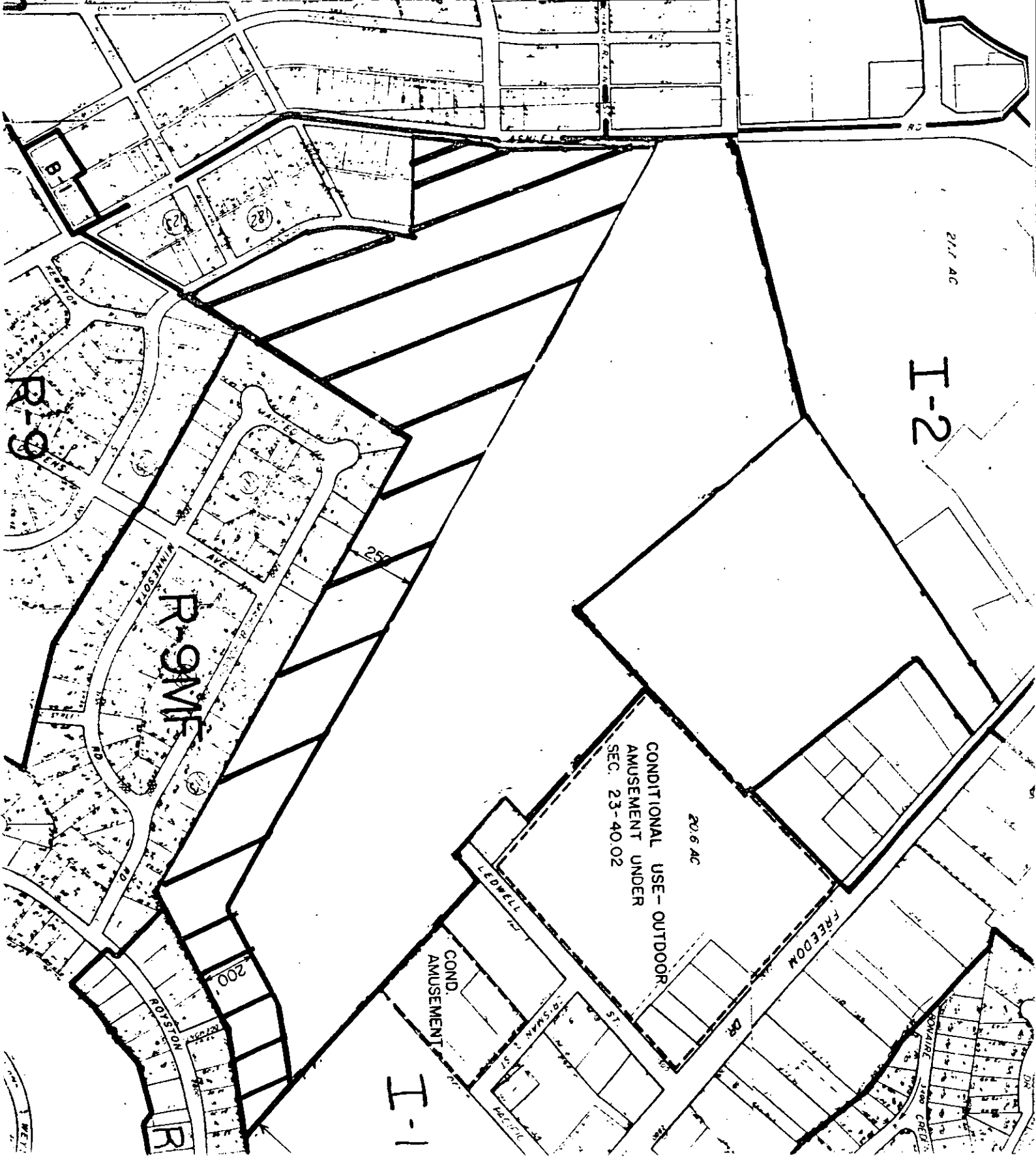

PETITIONER City View Development Corp.

PETITION NO. 89-95 HEARING DATE December 18, 1989

ZONING CLASSIFICATION, EXISTING R-9MF REQUESTED I-1(CD)

LOCATION Approximately 32.37 acres located on the east side of Ashley Road  
at Alleghany Street.

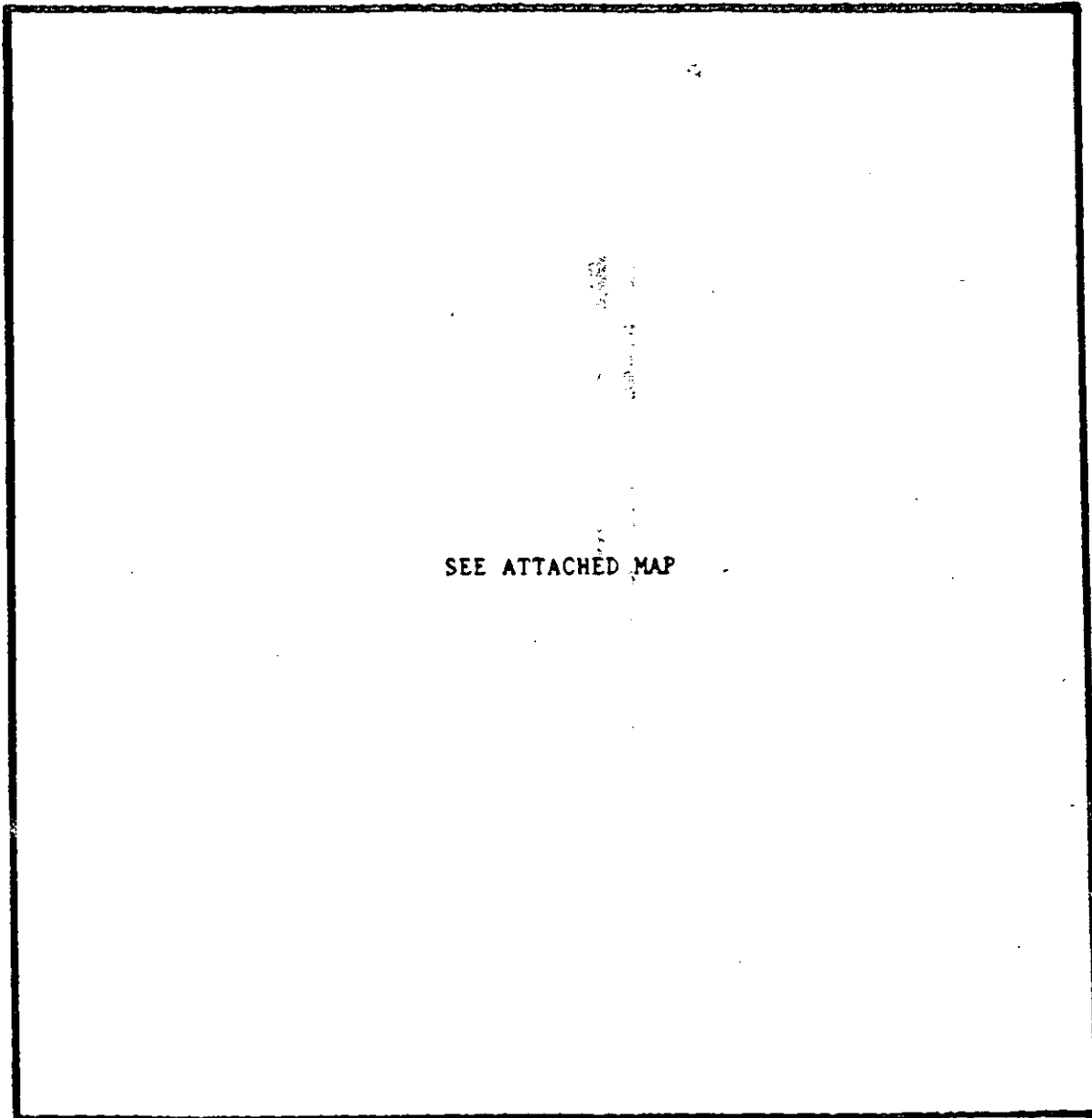

ZONING MAP NO. 87

SCALE 1" = 400'

PROPERTY PROPOSED FOR CHANGE

