



* 0 0 B R E A K 0 0 *



**ADVANCED
IMAGING
SYSTEMS**

www.aisimc.com

An Information
Management Company

City of Charlotte – Planning Dept. Scanning Rezoning Files

Petition # _____

Document type:

- Applications
- Correspondence
- Department Comments
- Land Use Consistency
 - Mail Info
 - Mapping
 - Other
- Site Plans



* 0 0 B R E A K 0 0 *

PETITIONER: Charlotte Inn, Inc.

PETITION NO.: 92-52

HEARING DATE: September 21, 1992

ZONING CLASSIFICATION, EXISTING: I-2

ZONING CLASSIFICATION, REQUESTED: I-1

LOCATION: Approximately 6.71 acres located on the east side of Little Rock Road south of I-85.

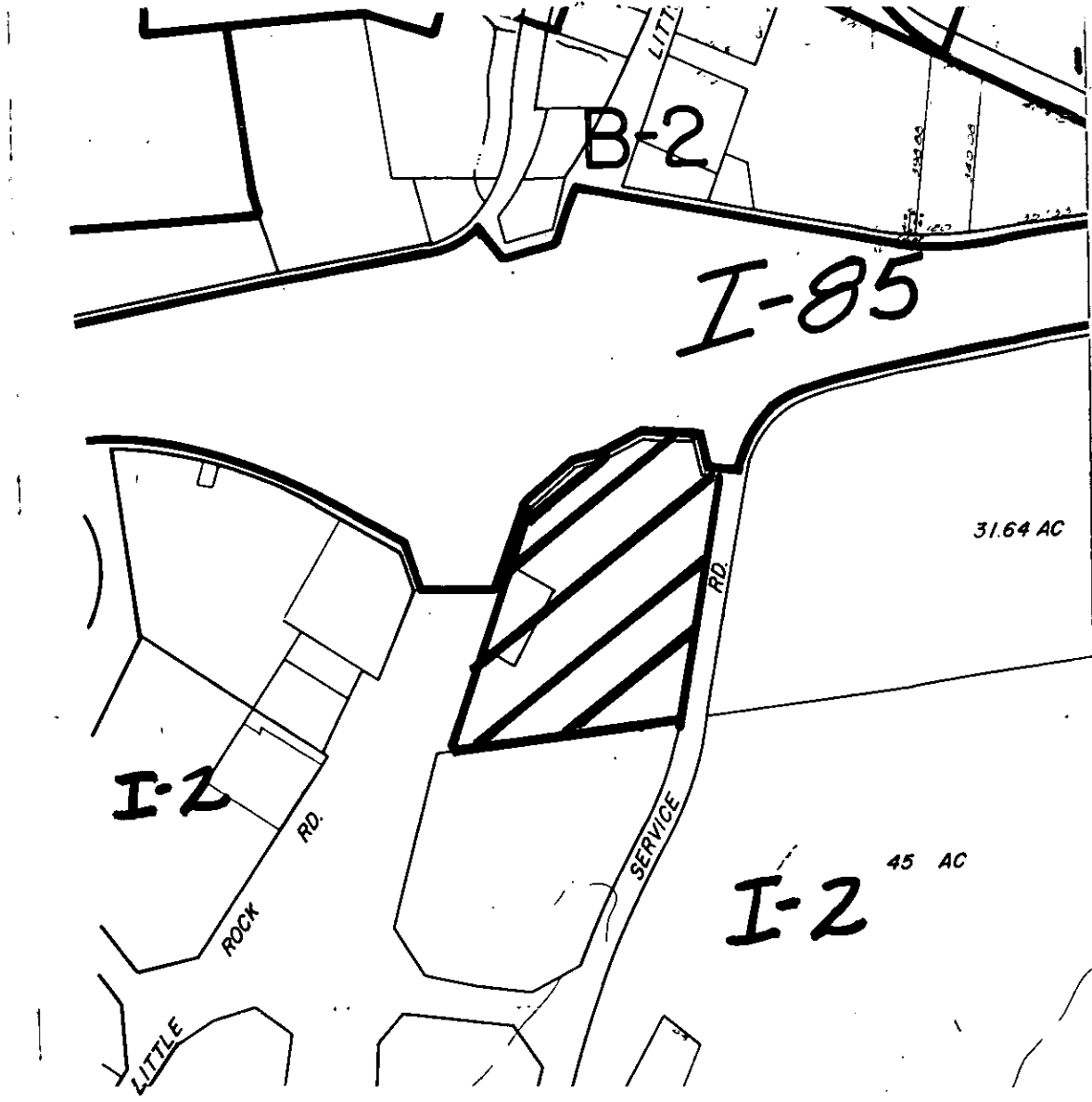

ZONING MAP NO(s): 86

SCALE 1" = 400'



PROPERTY PROPOSED FOR CHANGE

WMCW 8/21 OK

92-52

Legal Description

**2707 Little Rock Road
Charlotte, North Carolina**

BEGINNING at a point which is (a) the northeastern corner of the property, now or formerly, of Richard T. Meek, as Successor Trustee, said property being identified in the tax records of the City of Charlotte, Mecklenburg County, North Carolina as Tax Parcel #061-283-01, and (b) the southeastern corner of the property, now or formerly, of Charlotte Inn, Inc., said property being identified in the tax records of the City of Charlotte, Mecklenburg County, North Carolina as Tax Parcel #061-29-07; and proceeding thence from said point and place of BEGINNING N 12-40-30 E 553.49' to point; thence N 76-37-00 W 52.45' to a point; thence N 13-25-04 W 74.04' to a point; thence N 82-22-50 W 92.90' to a point; thence S 65-56-35 W 108.85' to a point; thence S 76-31-49 W 81.07' to a point; thence S 52-21-12 W 92.19' to a point; thence S 22-25-02 W 140.59' to a point; thence S 25-51-03 W 150.27' to a point; thence S 22-00-22 W 200.40' to a point; thence in a southwesterly direction with the arc of a circular curve to the left having a radius of 4,501.66' an arc length of 67.81' to a point which is the southwestern corner of the above-referenced property, now or formerly, of Charlotte Inn, Inc. and the northwestern corner of the above-referenced property, now or formerly, of Richard T. Meek, as Successor Trustee; thence with the common boundary of said two properties N 84-06-51 E 553.79' to the point and place of BEGINNING, said property containing in its entirety the properties, now or formerly, of Charlotte Inn, Inc., identified in the tax records of the City of Charlotte, Mecklenburg County, North Carolina as Tax Parcel #'s 061-291-02 and 061-291-08.

See deed descriptions attached hereto as (i) Exhibit A-1 for a separate description of Tax Parcel #061-291-02 (taken from the deed into Charlotte Inn, Inc. recorded in Book 3234 at Page 83, Mecklenburg County Public Registry), (ii) Exhibits A-2, A-3 and A-4 for separate descriptions of the three (3) portions of Tax Parcel #061-291-07 (taken from the deeds into Charlotte Inn, Inc. recorded in Book 5839 at Page 35, Book 5547 at Page 815 and Book 5880 at Page 320, Mecklenburg County Public Registry) and (iii) Exhibit A-5 for a separate description of Tax Parcel #061-291-08 (taken from the deed into Charlotte Inn, Inc. recorded in Book 4541 at Page 711, Mecklenburg County Public Registry).