

EXISTING ZONING: CC  
 PROPOSED ZONING: CC SITE PLAN AMEND.

MAXIMUM BUILDING AREA: 157,302 SF,  
 WHICH INCLUDES A ONE TIME 1000 SQ. FT.  
 ADDITION AS PER SECTION 6.206(2)  
 PERMITTED USES: ALL ALLOWED IN CC DISTRICT  
 SITE ACERAGE: 16.731 AC.

**LEGEND**  
 - - - - - BUILDING ENVELOPE  
 - - - - - PROPERTY BOUNDARY  
 - - - - - OUT PARCEL AREA  
 - - - - - SCREEN FENCE  
 - - - - - BUFFER LINE

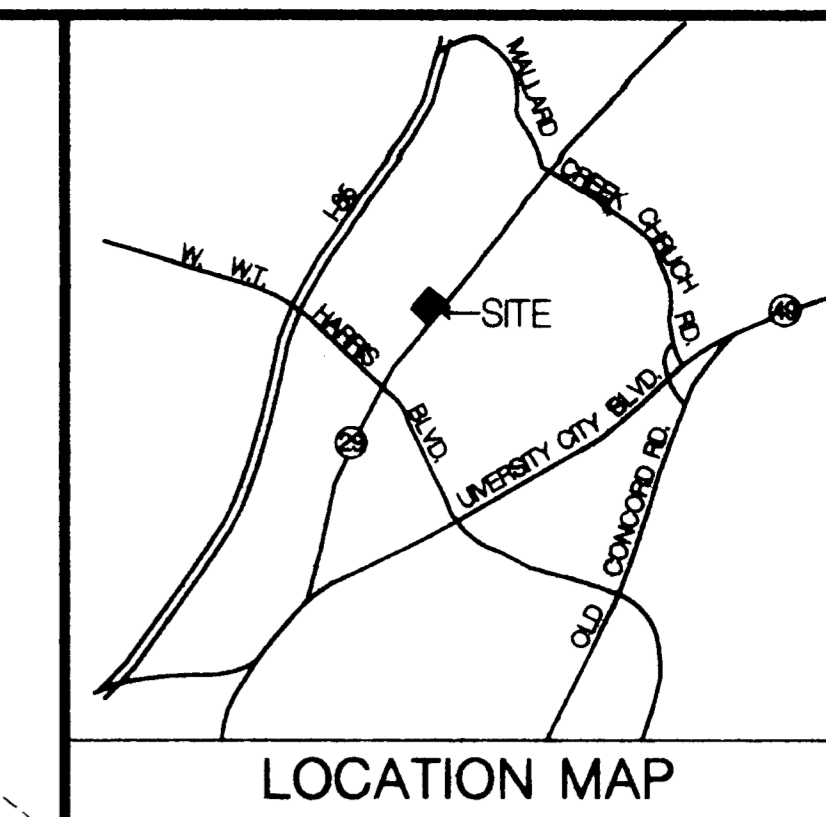

**Drafting & Design, Inc.**  
 1010 Park Center Dr.  
 Suite 104  
 Charlotte, N.C.  
 704-642-8866

**CAMBRIDGE PROPERTIES INCORPORATED**  
 2865 Providence Road  
 Suite 300  
 Charlotte, NC 28211  
 (704) 582-2222

FILE: **MALLARD POINTE AT UNIVERSITY PLACE**  
 LOCATION: **CHARLOTTE, N.C.**

REVISIONS: 03-16-94  
 05-01-95  
 05-11-95  
 05-28-95

**SITE PLAN AMENDMENT**

DRAWN BY:  
 DATE: 01-20-95

DWG. NO.  
**S1**

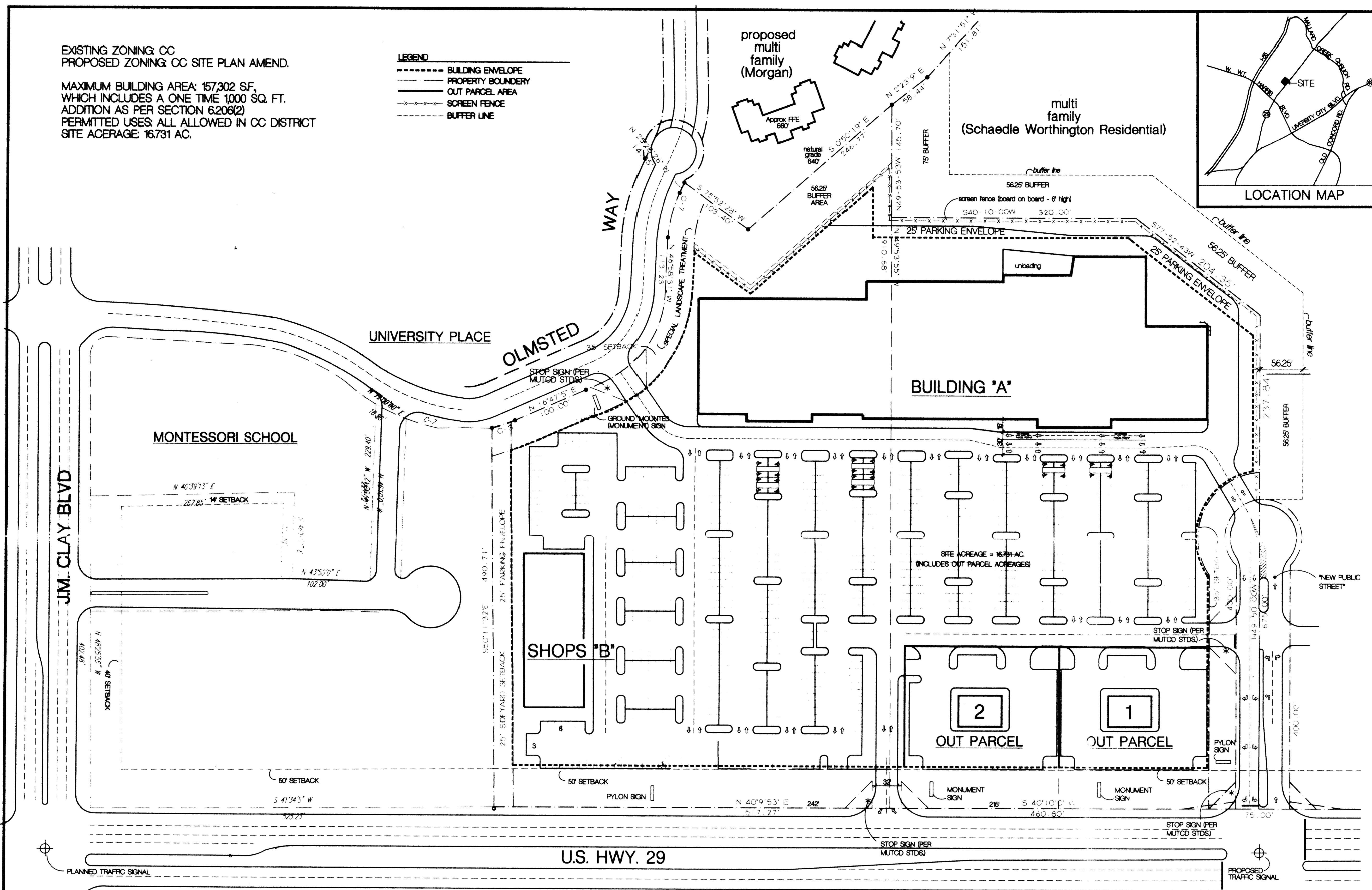

**ATTACHED TO ADMINISTRATIVE APPROVAL**  
 DATED: 06/12/95  
 BY: MARTIN R. CRAMTON, JR. 95-71

# SITE PLAN AMENDMENT

scale: 1" = 60'

**CHARLOTTE - MECKLENBURG PLANNING COMMISSION**  
 INTER - OFFICE COMMUNICATION

DATE: June 12, 1995  
 TO: Robert Brandon, Zoning Administrator  
 FROM: Martin R. Cramton, Jr., Planning Director

SUBJECT: Administrative Approval for Petition No. 92-71 by Cambridge Properties Tax Parcel # 047-191-05, 047-191-12, 047-201-33 and a portion of 047-201-31

Attached is a revised Master Plan for a portion of the above mentioned rezoning petition. The plan has been revised to show how the portion of the site not rezoned for multi-family through rezoning petition 94-54 will be developed. The attached plan establishes the development rights for parcel that is still zoned Commercial Center. Even though this does represent a change from the previously approved plan the changes do not reduce the yards at the exterior of the property or intensify the development. Therefore, we are administratively approving this revised plan. Please use this plan when evaluating requests for building permits and certificates of occupancy.

# DEVELOPMENT STANDARDS

Date: 5-31-95

## MALLARD POINTE AT UNIVERSITY PLACE

### DEVELOPMENT STANDARDS

Site Plan Amendment to Petition 92-71

#### GENERAL PROVISIONS

These Development Standards apply to the property depicted on the Site Plan Amendment (the "Site") and represent a development concept with regard to the arrangement of buildings, parking, and circulation. Except as otherwise provided in this Site Plan Amendment (the "Site Plan Amendment"), all development standards established under the City of Charlotte Zoning Ordinance (the "Ordinance") for the Commercial Center District Classification shall be followed in connection with development taking place on the Site. The building configurations, placements, and sizes shown on the Site Plan Amendment are schematic in nature and may be altered or modified during design, development, and construction phases so long as the maximum building envelopes are not violated by final building placement. Parking/aisle layouts and internal circulation may also be modified to accommodate final building locations, tenant needs, final designs, site constraints, etc. Parking and vehicular circulation may occur within building envelope areas.

#### PERMITTED USES

1. The total gross floor area of all structures placed on the Site (including detached buildings) cannot exceed 157,302 square feet.
2. The building noted as "B" on the Site Plan Amendment shall be a minimum of 10,000 SF in size, except that such restriction shall be eliminated if this building is one of the two outparcels listed under number 4 below.
3. Any use (including any accessory use) which is permitted by right or under prescribed conditions in a Commercial Center District (CC) under the Ordinance shall be permitted.
4. No more than two (2) outparcels may be developed along the US-29 road frontage on the Site.

#### SETBACKS

1. Building and parking setbacks shall be a minimum of 50 feet off of the existing right-of-way for US-29 and per the zoning regulations along other property lines.

2. Building and parking setbacks from all other streets shall be 35 feet.

#### BUFFERS/GREENWAYS

1. The landscaped setback depicted along US-29 is subject to the following regulations:
  - a. A landscaped setback extending 50 ft. from the existing US-29 right-of-way will be retained except to the extent necessary to accommodate: (i) pedestrian pathways, (ii) up to two (2) access point(s) along US-29 providing ingress/egress to the Site, (iii) two (2) outparcel monument signs, (iv) one (1) pylon center identification sign and temporary signs (as permitted by the City of Charlotte Sign Ordinance), (v) sidewalks, gateway entrance features and utilities necessary to serve the Site, (vi) the clearing of undergrowth (trees smaller than 1 inch in caliper), (vii) clearing and grading required to meet transportation site line and accel/decel lane requirements, and (viii) the placement of trees and other plant materials required by applicable ordinances and as provided for as part of these standards where the existing foliage does not create an adequate visual screen.
2. The buffer area between the Site and the adjoining multi-family zoned property (Schaefer Worthington Residential) located on the multi-family property and shall be constructed pursuant to the conditional zoning of that property:
  - a. The shopping center to be constructed on the Site may open for business only after all Buffer improvements pertaining to landscaping and fencing have been completed in accordance with Note 10 of Petition No. 94-95, as amended by letter from Bob Young dated September 27, 1994.
  - b. Those plans required to obtain building permits for the shopping center will show the location of the Buffer, the landscaping, and the fencing.
  - c. The shopping center proper area will remain in its natural state until such time as construction activity commences.
3. The remaining buffer area between the Site and the abutting Multi-Family parcel (Morgan), shall be 56.25 ft., provided a screening fence is installed as shown.

4. Special streetscape treatment of portions of the 35 foot setback along Olmstead Way, adjacent to the side of the shopping center as noted, shall include landscaping this area to meet class "C" planting standards.

#### LANDSCAPING

1. All landscaping will meet the requirements of the City of Charlotte's Tree Ordinance.
2. The landscape design within the landscaped setback established along US-29 will continue the pattern of landscaping, including type and spacing, which has been planted along US-29 in front of University Place and generally conform with the University Place Design Guidelines.
3. Landscaping within the parking areas of the Site shall be a minimum of 84 of such parking area.

#### PARKING

1. Each of the parking areas depicted on the Site Plan Amendment may vary in size and location, but in all events, off-street parking will meet the minimum standards established under the Ordinance.
2. Parking areas may be constructed inside and outside building envelopes.

#### LIGHTING

1. A lighting system will be employed uniformly throughout the Site.
2. All direct lighting within the Site shall be designed in such a manner as to eliminate direct illumination upon adjacent properties.
3. The maximum height of parking lot lights shall be 35 feet, including the mounting base.

#### SIGNS

1. All signs placed on the Site will be erected in accordance with the requirements of the City of Charlotte Sign Ordinance.
2. All outparcel building and tenant identification signs or graphics will be complementary in scale and appearance to the structures which they identify, and each sign affixed to a structure will be compatible with its architectural design.
3. Two (2) permanent pylon type project identification signs not to exceed 30 ft. in height and two (2) outparcel identification signs not to exceed 4 ft. in height and directional signs may be located on the Site. The sign located on Olmstead Way shall be a ground mounted sign.
4. Project identification signs and gateway entrance features may be located at the access points to the Site along US-29.
5. Temporary project signs may be located on the Site along US-29 within the setback established on the Site Plan Amendment, but must be removed no later than 60 days after issuance of the first certificate of occupancy for space within the parcel on which the project sign was erected.

#### ACCESS POINTS (Driveways) AND ROAD IMPROVEMENTS

1. The number of vehicular access points to the Site from US-29 shall be limited to two: namely, a right-in/right-out and a full access (median cut) for a new public street which will provide access to the northerly section of Site, as generally shown on the Site Plan Amendment. Access to the proposed Public Street will be allowed as shown on the Site Plan Amendment. The right-in/right-out entrance may be relocated along the US-29 road frontage subject to approval by the North Carolina Department of Transportation and the Charlotte Department of Transportation.
2. The existing Olmstead Drive in University Place will be connected with the Site at one (1) point as generally shown on the Site Plan Amendment to provide vehicular access between University Place and the Site.
3. The configurations of access points and driveways within the Site are subject to any minor modifications required to accommodate final site and architectural construction plans and designs and are further subject to approval by the North Carolina Department of Transportation, Charlotte Department of Transportation, and the City of Charlotte Engineering and Property Management Department.
4. A third southbound lane of US-29 will be constructed along the Site as follows: Owner shall install curb and gutter and sidewalk necessary for a third southbound lane along US-29 in front of the Site; the City of Charlotte Transportation

Department shall, as per City policy and practice, install the necessary paving of such third lane from the existing edge of pavement to the curb and gutter installed by Owner.

#### DEDICATION OF ADDITIONAL RIGHT-OF-WAY

1. Additional right-of-way required for accel/decel lanes to accommodate ingress/egress into and through the Site shall be dedicated at the time construction permits are issued.

#### FIRE PROTECTION

1. Adequate fire protection in the form of fire hydrants will be provided in accordance with the Fire Marshal's specifications. Plans for each building will be submitted to the Fire Marshal's office for approval before construction of the building involved commences.

#### ARCHITECTURAL CONTROLS RELATING TO SITE

1. The owners commit to design and construct the front, side, and rear elevations of the proposed shopping center buildings located on the Site such that their appearance will be compatible in quality with University Place.
2. The principal materials used for the front and side building elevations will consist of brick, split face block, stucco or stucco-appearing materials, or other materials customarily used in quality shopping centers. Any combination of these materials may be used.
3. The material selected for the rear of the buildings will be painted to match the color of the predominant material used in the construction of the front and side elevations, subject to note #1 above.
4. The designs of the buildings constructed within the Outparcels located on the Site will be generally compatible with the shopping center architectural design.
5. No building constructed on the Site may contain more than two (2) stories or exceed 40 feet in height.
6. All dumpster areas will be screened in accordance with the requirements of the Ordinance.
7. Petitioner will complete final architectural plans and landscape plans which will be presented to the Design Review Board for their review and comment. Petitioner will diligently consider incorporating the recommendations made by the Design Review Board.

#### STORMWATER MANAGEMENT

1. Stormwater runoff from the Site will be managed through a variety of proven techniques which satisfy the standards imposed by the City of Charlotte. This may include off-site detention.
2. The buffer area will not be used for storm water management.

Drafting & Design, Inc.

1010 Park Cedar Dr.  
Suite 104  
Charlotte, NC  
704-542-8858

CAMBRIDGE PROPERTIES  
INCORPORATED

2915 Providence Road  
Charlotte, North Carolina 28211  
(704) 364-2393

FILE MALLARD POINTE AT UNIVERSITY PLACE

LOCATION CHARLOTTE, N.C.

REVISIONS:

06-7-96

DEVELOPMENT STANDARDS

DRAWN BY:

11-08-94

11-30-94

DWG. NO.

S2