



\* 0 0 B R E A K 0 0 \*



**ADVANCED  
IMAGING  
SYSTEMS**

www.aisimc.com

An Information  
Management Company

# City of Charlotte – Planning Dept. Scanning Rezoning Files

Petition # \_\_\_\_\_

93-7

## Document type:

- Applications
- Correspondence
- Department Comments
- Land Use Consistency
  - Mail Info
  - Mapping
  - Other
- Site Plans



\* 0 0 B R E A K 0 0 \*

13-1

1

OFFICIAL REZONING APPLICATION  
CITY OF CHARLOTTE

Staff Review Tues. 1/26 @ 10:00 a.m.

MARCH 93'

|                 |                   |
|-----------------|-------------------|
| Petition No.    | 93-7              |
| Date Filed      | December 28, 1992 |
| Received By     | LS                |
| OFFICE USE ONLY |                   |

Ownership Information

Property Owner Allison Family Partnership

Owner's Address P. O. Box 35628, Charlotte, NC 28235

Date Property Acquired 1946, 1962 and 1986

Tax Parcel Number 103-111-17 and 103-111-02

Location of Property (address or description) 6100 - 6200 Wilora Lake Rd.

Description of Property

Size (Sq. Ft.-Acres) 17.33 A. Street Frontage (ft.) 3200

Current Land Use vacant - undeveloped - 6135 Wilora Lake Rd.  
single family residence

Zoning Request

Existing Zoning 015-CD Requested Zoning R12 (R3)

Purpose of Zoning Change Relief on tax valuation

C. W. Allison, Jr.

Name of Agent

P. O. Box 35628, Charlotte, NC 28235

Agent's Address

376-7535

Telephone Number

Name of Petitioner(s)

Address of Petitioner(s)

Telephone Number



Signature

Signature of Property Owner  
if Other Than Petitioner

PETITIONER: Allison Family Partnership

PETITION NO.: 93-7 HEARING DATE: March 15, 1993

ZONING CLASSIFICATION, EXISTING: O-15 (CD)

ZONING CLASSIFICATION, REQUESTED: R-3

LOCATION: Approximately 17.33 acres located on the east side of Wilora Lake Road north of Albemarle Road.

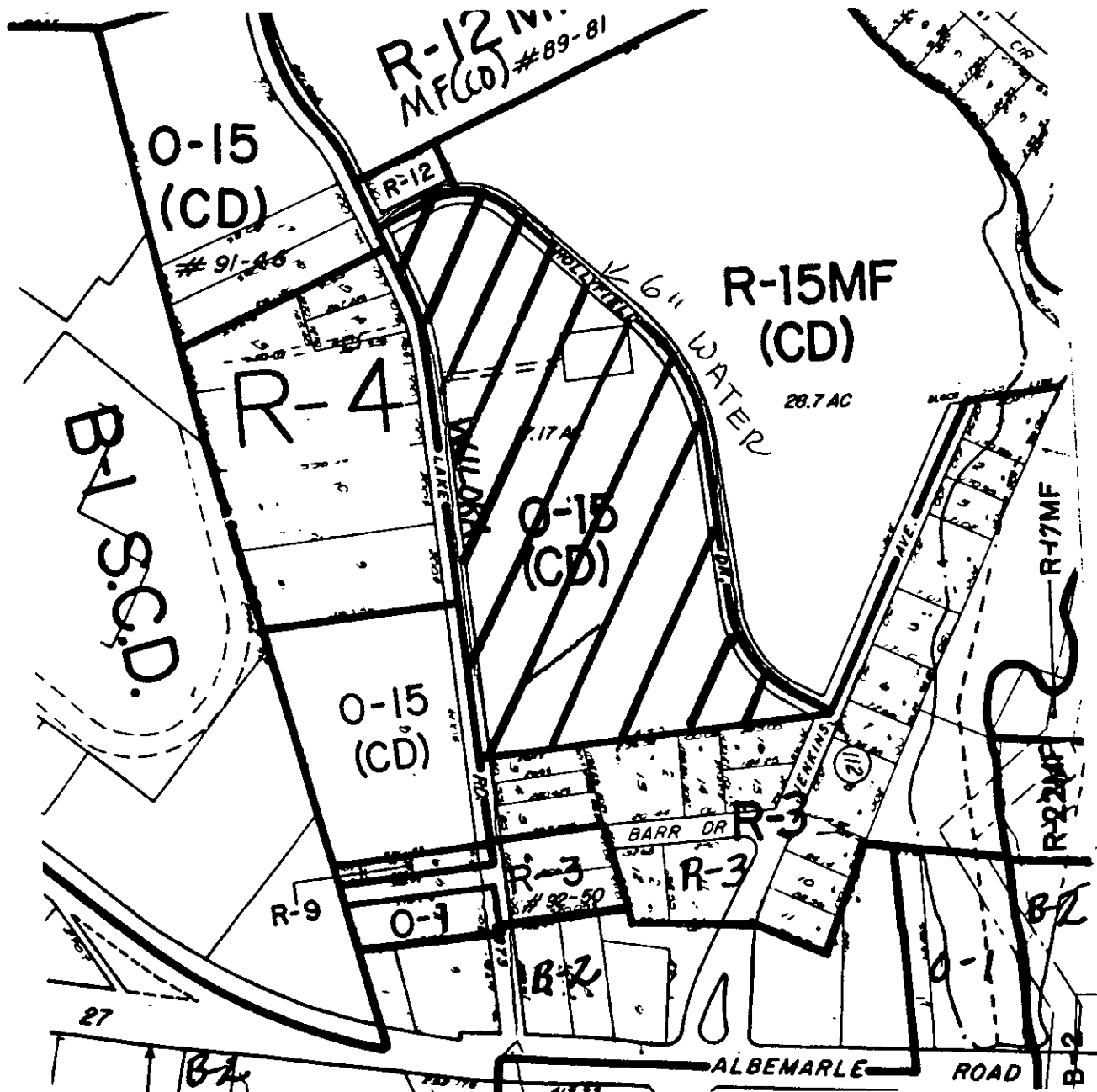

ZONING MAP NO(s): 113

SCALE 1" = 400'



PROPERTY PROPOSED FOR CHANGE

8" water

NO SEWER

E-78