



* 0 0 B R E A K 0 0 *



www.aisimc.com

**ADVANCED
IMAGING
SYSTEMS**

An Information
Management Company

City of Charlotte – Planning Dept. Scanning Rezoning Files

Petition # _____

Document type:

- Applications
- Correspondence
- Department Comments
- Land Use Consistency
 - Mail Info
 - Mapping
 - Other
- Site Plans



* 0 0 B R E A K 0 0 *

OFFICIAL REZONING APPLICATION
CITY OF CHARLOTTE

STAFF REVIEW: FEBRUARY 28,
@ 10:00 A.M.

| | |
|-----------------|------------------|
| Petition No. | 94-26 |
| Date Filed | January 31, 1994 |
| Received By | T. Phares |
| OFFICE USE ONLY | |

Ownership Information

Property Owner Maye B. Junker, Jeane Morris, Virginia Lynn Sender, Cynthia M. Rowe and Edward Eugene Morris
Owner's Address 1927 Queens Road, Charlotte, NC 28207
Date Property Acquired 1975
Tax Parcel Number Parts of 109-301-12 and 109-301-55

Location of Property (address or description) Fronting on the southern margin of Albemarle Road and situated east of the Olde Savannah Subdivision

Description of Property

Size (Sq. Ft.-Acres) 22.96 acres + Street Frontage (ft.) 1,124 feet+ - Albemarle Road
Current Land Use Predominately vacant, one single family residence

Zoning Request

Existing Zoning R-3 Requested Zoning CC
Purpose of Zoning Change To accommodate a mixed use development

| | | |
|--|---------------------------------|--|
| Bailey Patrick, Jr. | Fred E. Bryant | CK-Land Development, Inc. |
| Name of Agent <u>2200 The Carillon</u> | <u>1850 E. Third Street</u> | Name of Petitioner(s) <u>301 S. College St.</u> |
| <u>227 W. Trade, Charlotte, NC</u> | <u>Suite 216, Charlotte, NC</u> | <u>2800 One First Union, Charlotte, NC 28201</u> |
| Agent's Address <u>28202</u> | <u>28204</u> | Address of Petitioner(s) |
| <u>(704) 372-1120</u> | <u>(704) 333-1680</u> | <u>(704) 342-9000</u> |
| Telephone Number | | Telephone Number |

CK Land Development, Inc.
By: Bailey Patrick, Jr.
Signature Jeane E. Morris
Signature of Property Owner Jeane Morris, as if Other Than Petitioner owner and as agent for Maye B. Junker, Virginia Lynn Sender, Cynthia M. Rowe and Edward Eugene Morris her Mother and Children

Petition #: 94-26

Petitioner: CK-Land Development, Inc.

Hearing Date: April 18, 1994

Zoning Classification (Existing): R-3

Zoning Classification (Requested): CC

Location: Approximately 22.96 acres located on the south side of Albemarle Road east of Olde Savannah Road.

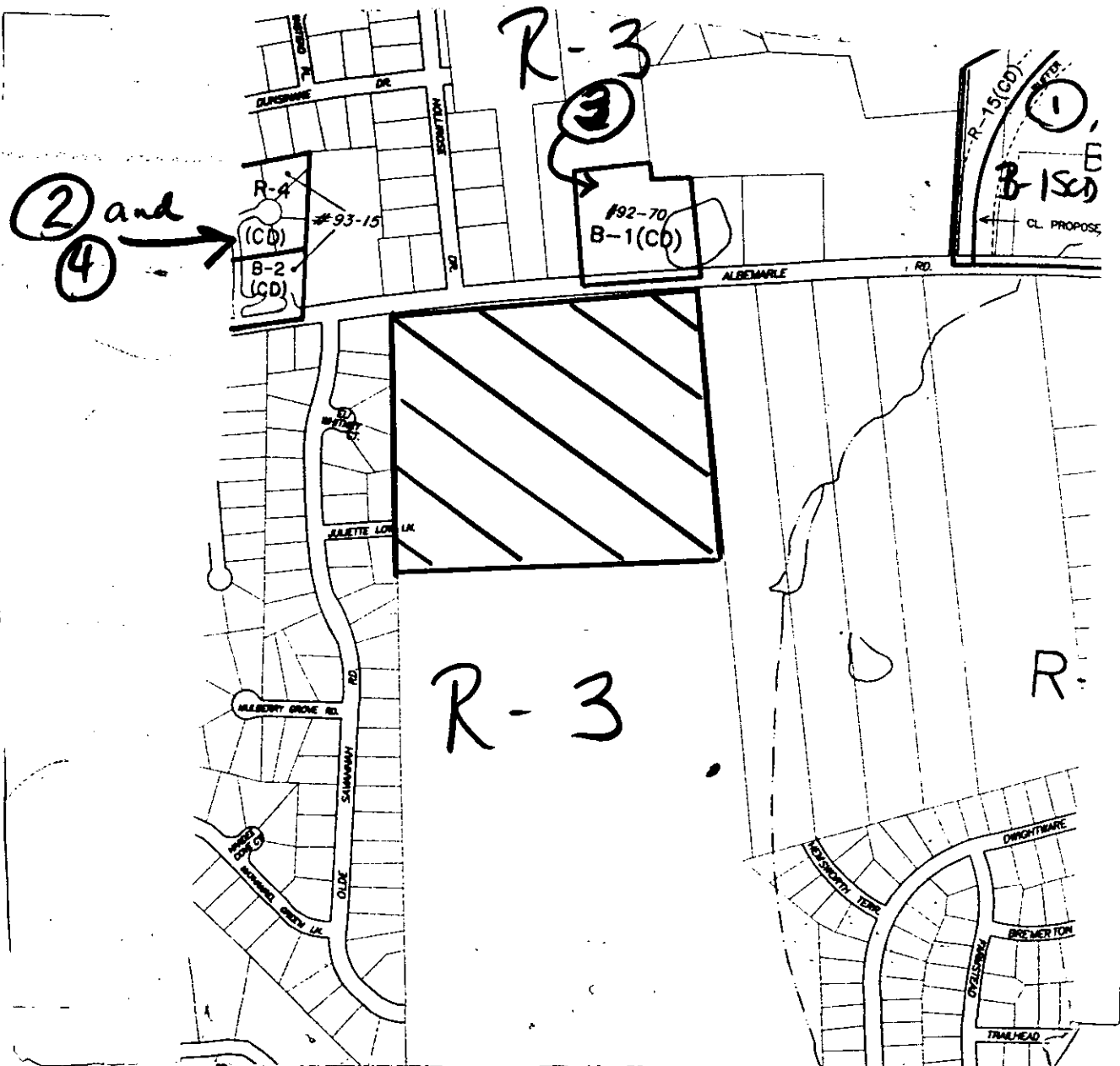

Zoning Map #(s): 115

Scale: Not to Scale