

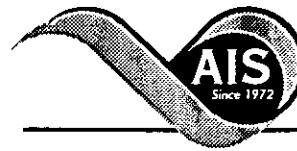

* 0 0 B R E A K 0 0 *



**ADVANCED
IMAGING
SYSTEMS**

An Information
Management Company

www.aisimc.com

City of Charlotte – Planning Dept. Scanning Rezoning Files

Petition # _____

Document type:

- Applications
- Correspondence
- Department Comments
- Land Use Consistency
 - Mail Info
 - Mapping
 - Other
- Site Plans



* 0 0 B R E A K 0 0 *

Petition #: 94-49

Petitioners: Zeneca

Hearing Date: June 20, 1994

Zoning Classification (Existing): I-1

Zoning Classification (Requested): I-2(CD)

Location: Approximately 4.968 acres located on the northeast corner of the intersection between US Highway 29 and I-85.

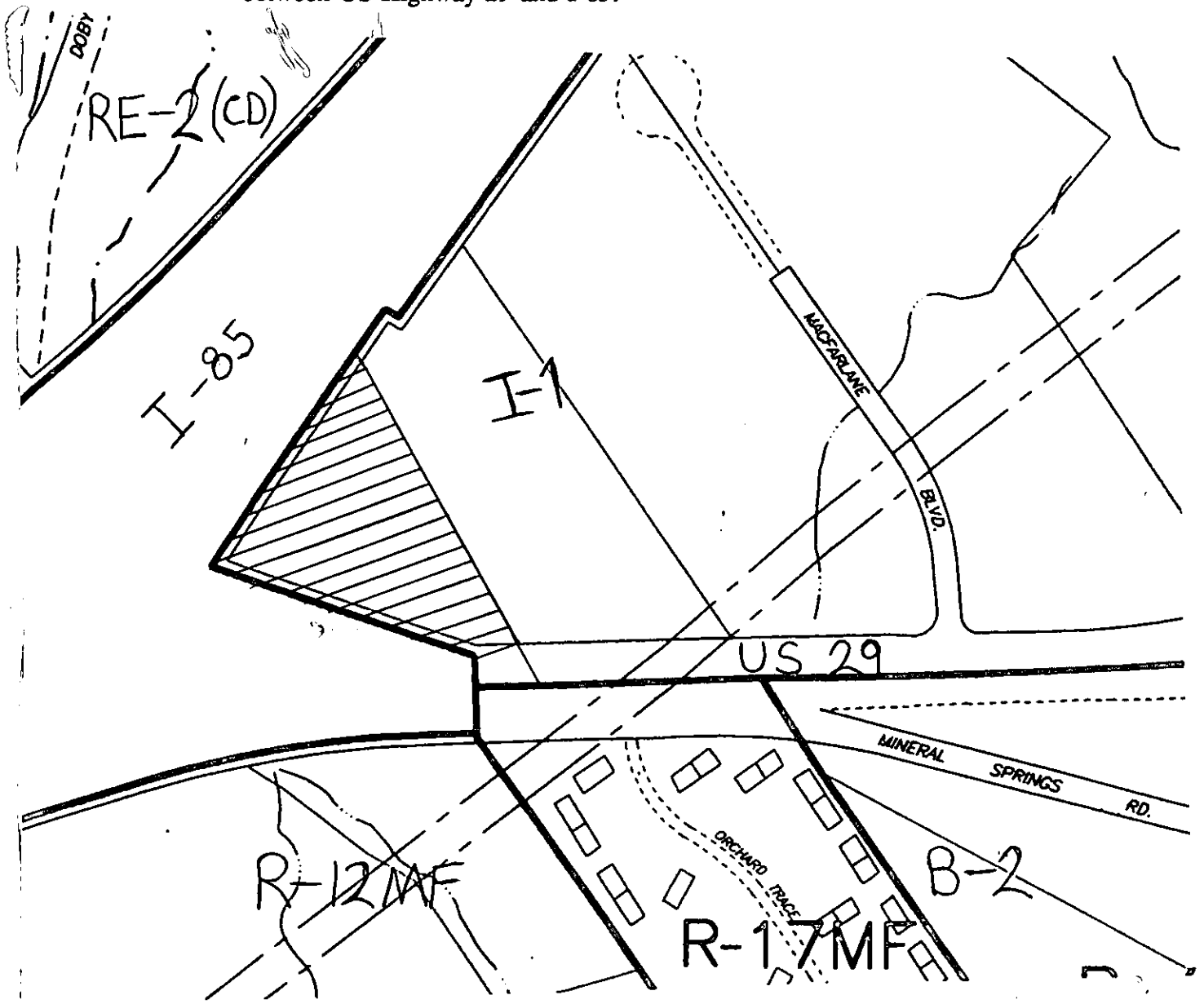

Zoning Map #(s): 71

Scale: 1" = 400'