

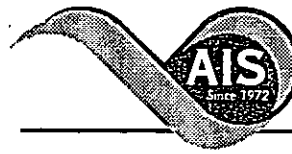

\* 0 0 B R E A K 0 0 \*



ADVANCED  
IMAGING  
SYSTEMS

www.aisimc.com

An Information  
Management Company

# City of Charlotte – Planning Dept. Scanning Rezoning Files

Petition # \_\_\_\_\_

## Document type:

- Applications
- Correspondence
- Department Comments
- Land Use Consistency
  - Mail Info
  - Mapping
  - Other
- Site Plans



\* 0 0 B R E A K 0 0 \*

**McMullen Creek Tributary  
Storm Water Run-off Along  
Emory Lane (Under R-3)**

- ❖
- ① N. Emory Lane: Persistent Flooding of Backyards
- ② Persistent Flooding: Trash and Debris from Creek in Backyards of Homes
- ③ Erosion Around Exposed Sewage Line - A Direct Result of Walker Site Runoff with 5% Impervious Soil and R-3 Zoning
- ④ Sharon Amity Road Culvert
- ⑤ Church Property Flooding
- ⑥ S. Emory Lane: Persistent Flooding After Only an Hour's Steady Rain  
**Flood Plain Begins.**

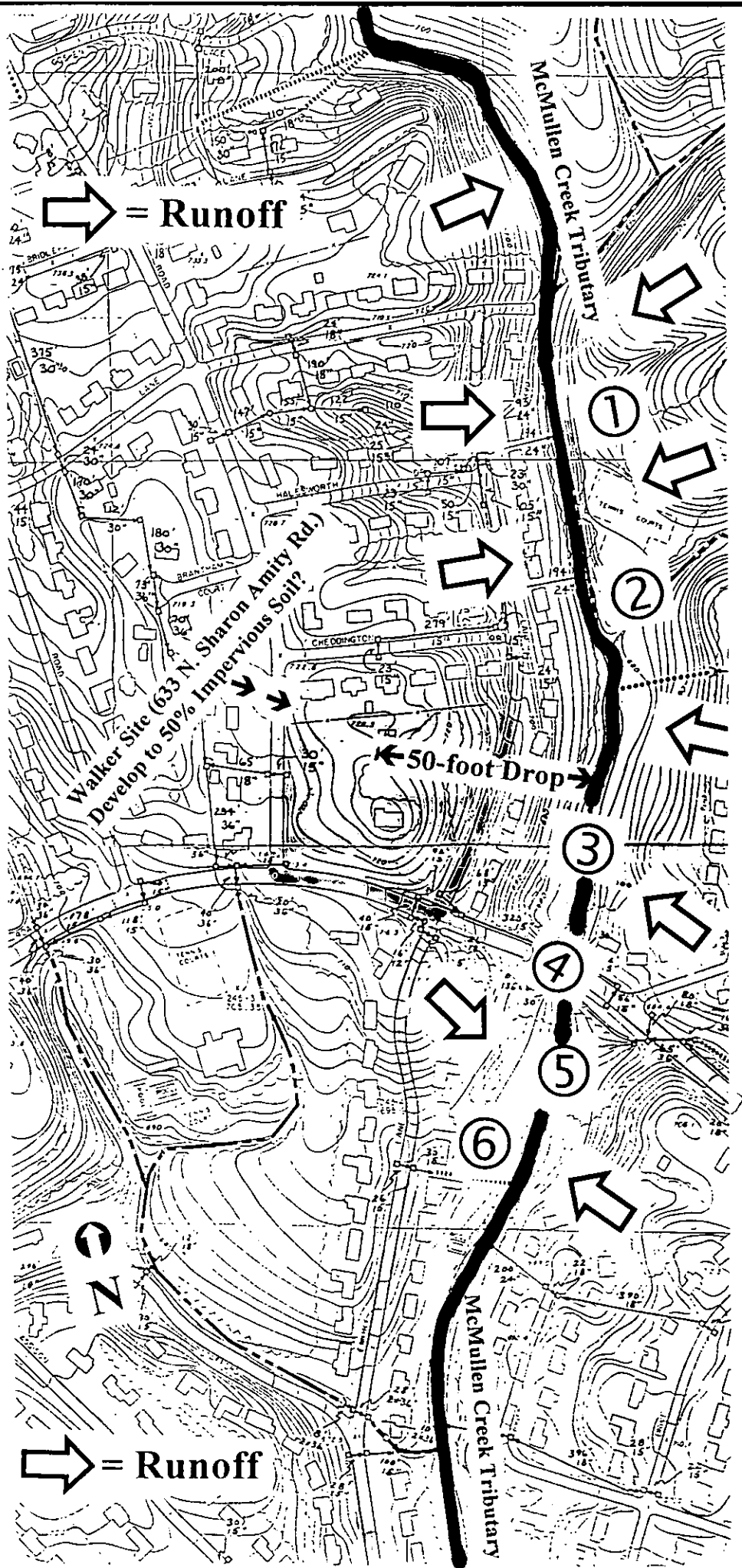



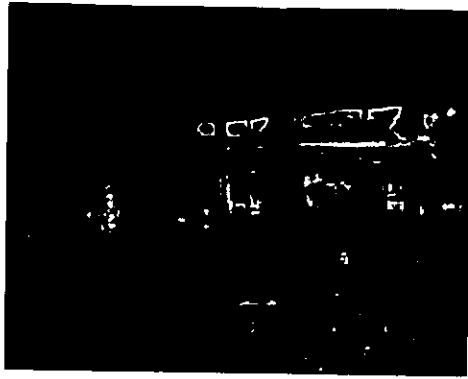

1991  
4307  
Emory  
Lane



1987  
4315  
Emory  
Lane

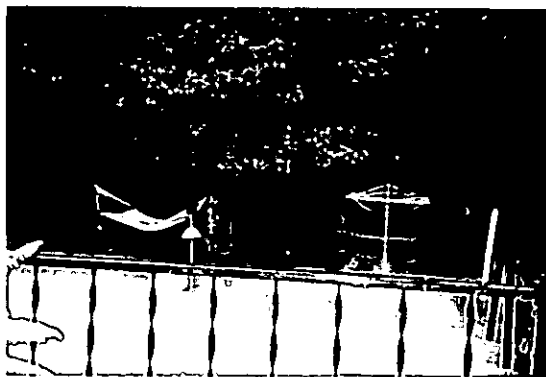

Phone: 364-0168  
4307 Emory Lane  
Charlotte, N. C. 28211  
March 12, 1983

Mr. Clark Readling, City Engineer  
Engineering Department  
Cameron-Brown Building  
301 South McDowell Street, Suite 400  
Charlotte, North Carolina 28204

Dear Mr. Readling:

We are working with Mr. Gary Wright of your Engineering Department on a severe erosion and flooding problem due to surface water coming down Linda Lane, Craig Avenue and surrounding high ground. After entering McMullen Creek it becomes a river causing serious damage to our properties.

When we purchased our properties fifteen years ago it was possible to jump across the creek. Due to erosion and flooding, it is today approximately 15 to 20 feet wide.

My neighbors' adjoining properties have a similar situation and we are very interested in finding a solution.

Charlotte's Storm Drainage Repair Policy Book states that a petition is needed for a study and estimate to qualify under policy requirements listed in above edition.

We, the undersigned, are presenting this petition requesting that a study and estimate be made of our properties with suggestions for a possible resolution to this problem.

The creek when flooded is 100 to 125 feet wide and is trying to cut a new bed eroding approximately one-third of our properties.

Mr. Richard Lowell's property at 4315 Emory Lane, my next door neighbor, has flooding into his crawl space.

We are located approximately one and one-half blocks north of a flood zone where McMullen Creek crosses Sharon Amity.

We wish to thank you in advance for your consideration of this matter.

Very truly yours,

Harry B. Brenizer

HBB/sdb

Mr. R. E. Brendle, 4301 Emory Lane, City 28211

Mr. Harry B. Brenizer, 4307 Emory Lane, City "

Mr. Richard Lowell, 4315 Emory Lane, City "

(over)

Mrs. Doris Hall, 4323 Emory Lane, City 28211

Doris P. Hall

Mr. Roy Johnson, 4407 Emory Lane, City "

[Signature]

Mr. Andrew D. Taylor, 1008 McAlway Rd., City "

Andrew D. Taylor, Jr.

Mr. John Tsoulos, 4401 Emory Lane, City "

STEVE TSOULOS

cc: Mr. Gary Wright, City Engineer  
The Undersigned

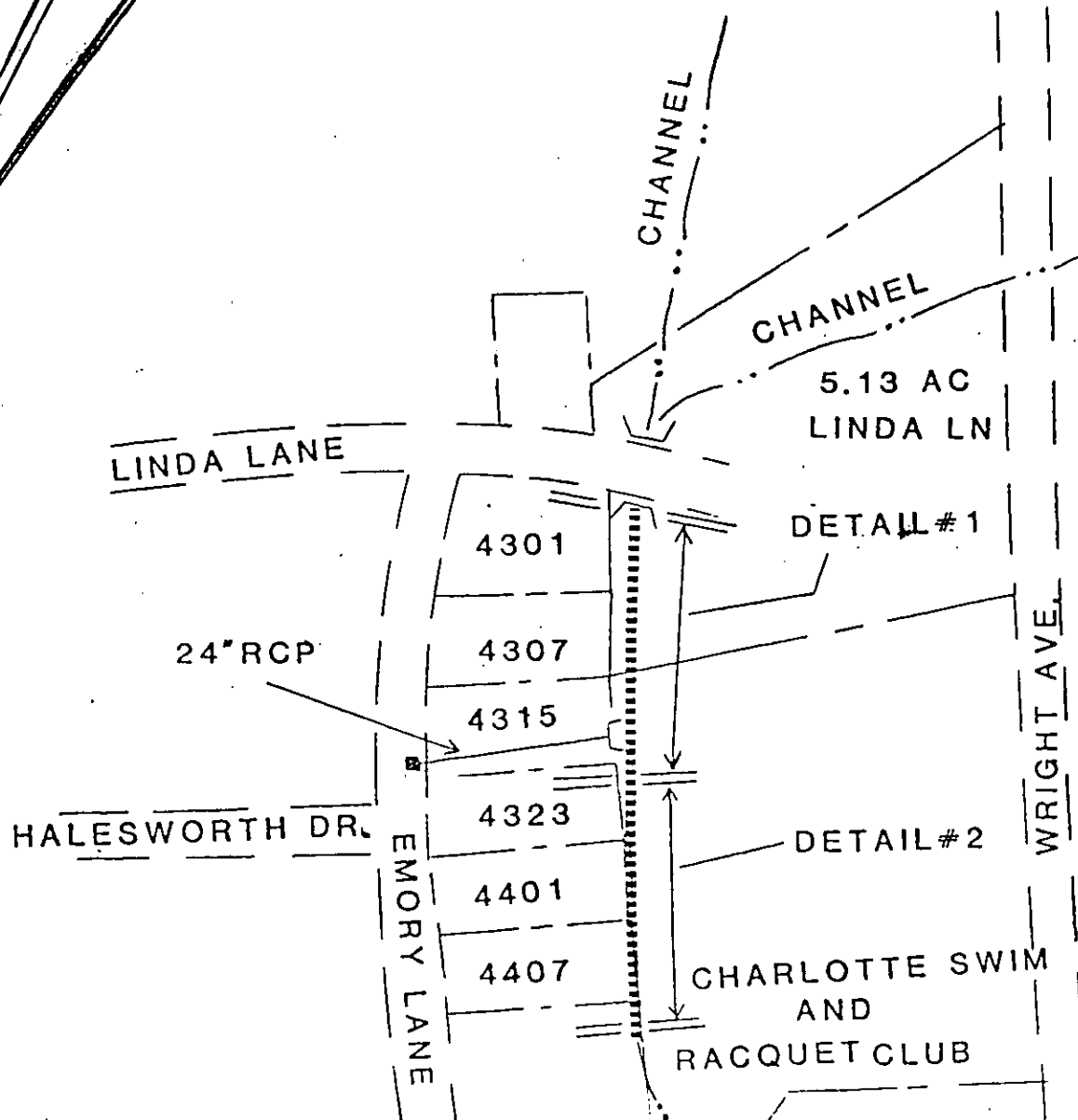

CROSS SECTION #1

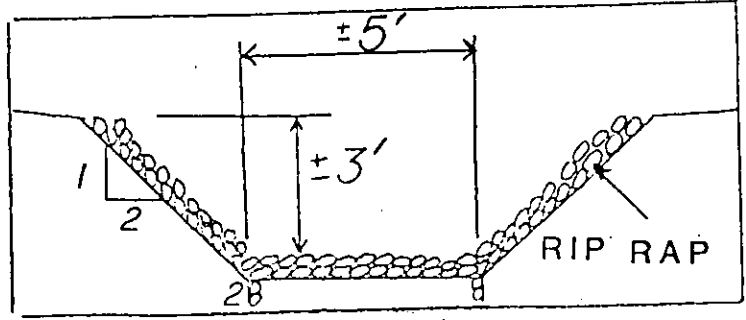

CROSS SECTION #2

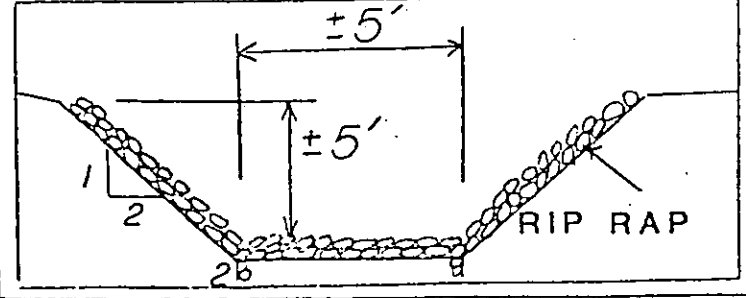

City of Charlotte  
 Engineering Dept.  
**EMORY LANE**



Charlotte-Mecklenburg  
**STORM  
WATER**  
Services

September 2, 1994

Mr. Jeffery Clear  
President - Greater Churchill Downs Homeowners Assoc.  
4539 Emory Lane  
Charlotte, NC 28211

Dear Mr. Clear:

I am writing to follow up on our telephone conversation of September 9, 1994. The channel behind your house does qualify for repairs through the Charlotte Stormwater Services program. This channel is currently classified as a capital repair project.

I am told by Julie McLeland, (the engineer in charge of capital projects in your area) that the channel behind your house is not currently ranked as a high priority project. At this time we cannot project a schedule for the work to be done on your channel.

If you would like further details about the capital projects program and the ranking system for this program, please contact Julie McLeland at 336-3640.

Sincerely,

Bruce Clodfelter

cc: Darlene Shrum  
Julie McLeland  
street file

Charlotte Storm Water Services 600 East Fourth Street Charlotte, North Carolina 28202-2844  
Telephone(704)336-3644 FAX(704)336-2291

To report drainage problems: 336-RAIN