



* 0 0 B R E A K 0 0 *



**ADVANCED
IMAGING
SYSTEMS**

www.aisimc.com

An Information
Management Company

City of Charlotte – Planning Dept. Scanning Rezoning Files

Petition # _____

Document type:

- Applications
- Correspondence
- Department Comments
- Land Use Consistency
 - Mail Info
 - Mapping
 - Other
- Site Plans



* 0 0 B R E A K 0 0 *

Petition #: 97-08(c)

Petitioner: John W. Wallace, Sr.

Hearing Date: March 11, 1997

Zoning Classification (Existing): R-3

Zoning Classification (Requested): R-5(CD)

Location: Approximately 41.21 acres located on the south side of Eastfield Road northeast of the Eastfield Road and Asbury Chapel Road intersection.

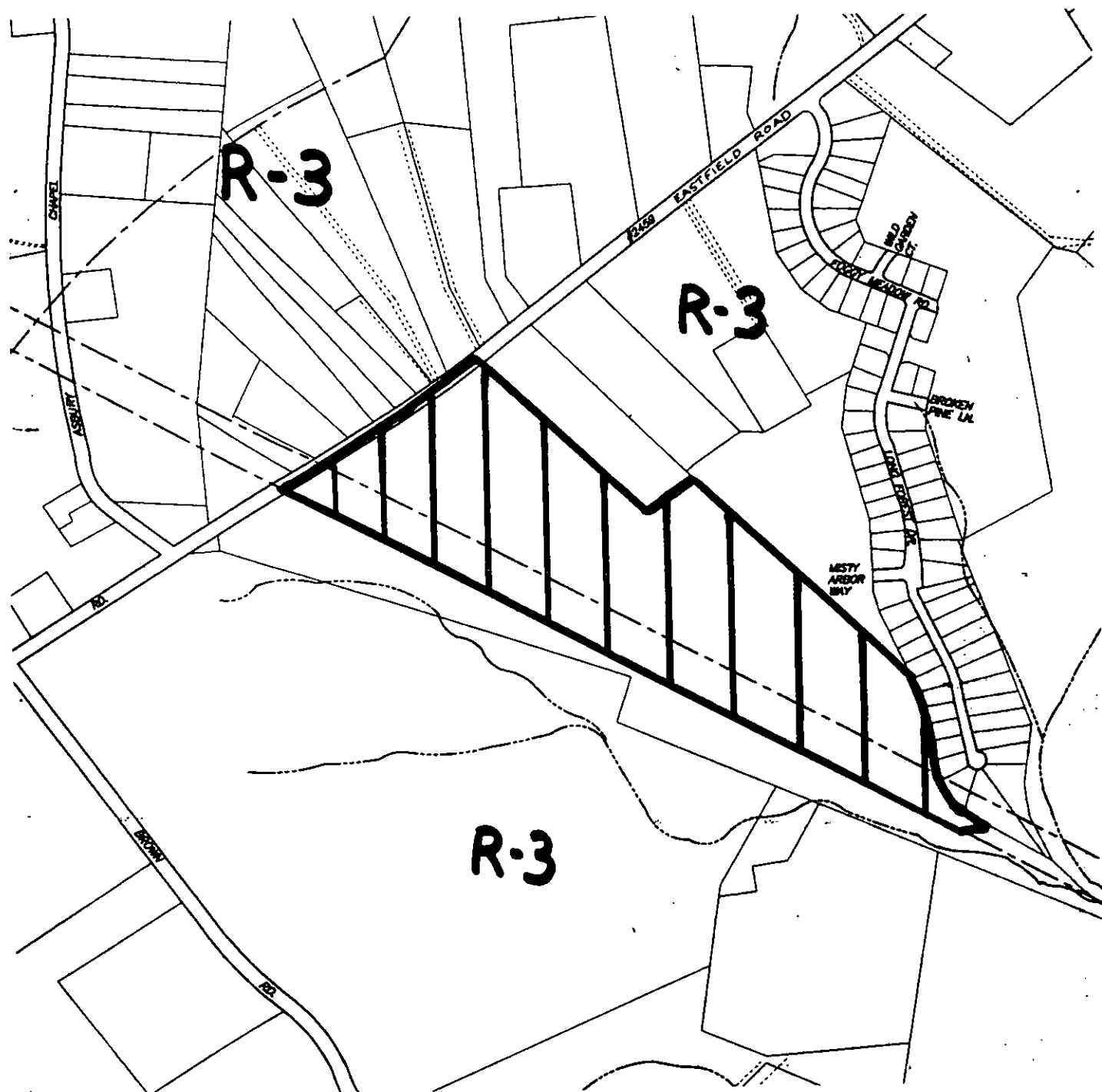

OFFICIAL REZONING APPLICATION MECKLENBURG COUNTY

MARCH PUBLIC HEARINGS

STAFF REVIEW : TUESDAY, JANUARY 21
AT 9:00 A.M.

Petition #: 97-8(c)

Date Filed: 12/24/96

Received By: SLS

OFFICE USE ONLY

OWNERSHIP INFORMATION:

Property Owner: John W. Wallace, Sr.

Owner's Address: 14324 Eastfield Rd., Huntersville, NC 28078

Date Property Acquired: 12-20-1979

Tax Parcel Number(s): 027-091-03 (P.O.)

LOCATION OF PROPERTY (Address or Description): Fronting ±920' on the south side of Eastfield Road, beginning at a point ±550' N.E. of Eastfield/Asbury Chapel Rd. intersection and at the end of Winter Pine Ln.

Size (Sq.Ft. or Acres): 41.21 Ac. Street Frontage (Ft.): ±920'

Current Land Use: Farm land and forest

ZONING REQUEST:

Existing Zoning: R-3 Proposed Zoning: R-5 (CD)

Purpose of Zoning Change: To provide for clustering of housing on buildable land;

leaving open space along power r/w.

Name of Agent

Agent's Address

Telephone Number

Fax Number

Signature of Property Owner
if other than Petitioner

John W. Wallace, Sr.
Name of Petitioner(s)

14324 Eastfield Rd., Huntersville NC 28078
Address of Petitioner(s)

704/875-2975
Telephone Number

Fax Number

John W. Wallace Sr.
Signature