



* 0 0 B R E A K 0 0 *



**ADVANCED
IMAGING
SYSTEMS**

www.aisimc.com

An Information
Management Company

City of Charlotte – Planning Dept. Scanning Rezoning Files

Petition # _____

Document type:

- Applications
- Correspondence
- Department Comments
- Land Use Consistency
 - Mail Info
 - Mapping
 - Other
- Site Plans



* 0 0 B R E A K 0 0 *

Petition #: 97-63

Petitioner: Schaedle Worthington Residential

Hearing Date: July 21, 1997

Zoning Classification (Existing): R-3

Zoning Classification (Requested): R-12MF

Location: Approximately 25.303 acres located on the east side of Rea Road, north of MacAndrew Drive and across from Rea Croft Drive.

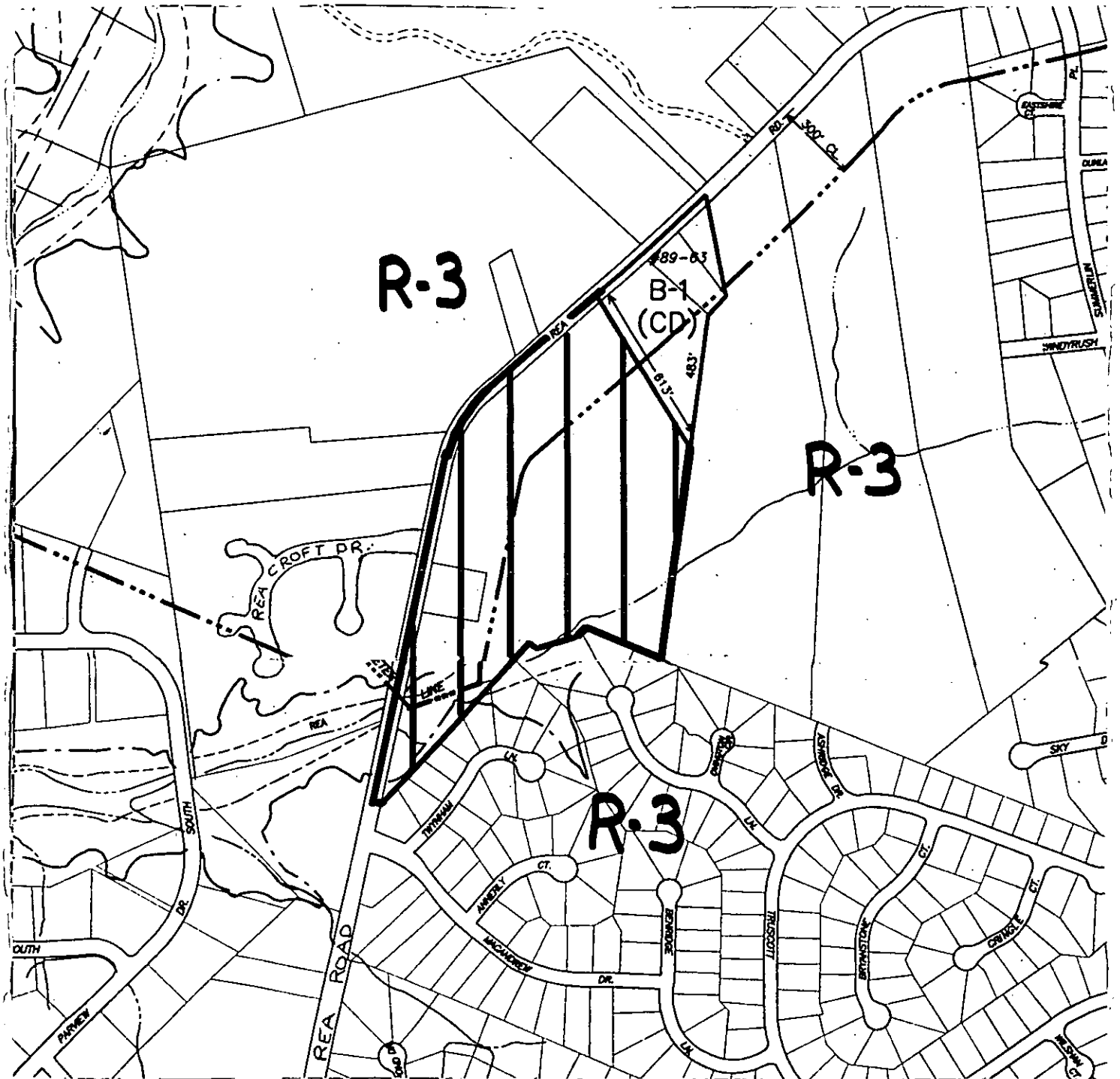

Zoning Map #(s): 159 & 166

Scale: No Scale

