

THERE SHALL BE NO FILLING OF ANY KIND WITHIN THE FLOODWAY FRINGE DISTRICT BOUNDARY. ANY CONSTRUCTION OR USE WITHIN THE AREAS DELINEATED AS FLOODWAY FRINGE DISTRICT BOUNDARY LINE AND FLOODWAY DISTRICT ENCRoACHMENT LINE IS SUBJECT TO THE RESTRICTIONS IMPOSED BY THE FLOODWAY REGULATIONS OF MECKLENBURG COUNTY.

APPROVED BY CITY COUNCIL
DATE 4-19-99
99-08
05137201PO

SITE DATA	
EXISTING ZONING	R-12(CD)
PROPOSED ZONING	R-4(CD)
ACREAGE	5.059 ACRES
PROPOSED USE	S. F. RESIDENTIAL
NOTES :	
1. THERE SHALL BE NO FILLING OF ANY KIND WITHIN THE FLOODWAY FRINGE DISTRICT BOUNDARY.	
2. NO INDIVIDUAL DRIVEWAYS SHALL BE ACCESSED TO LOTS 1-5 AND 11-13 FROM FAIRES FARM ROAD.	
3. OWNER RESERVES THE RIGHT TO CONVEY PORTIONS OF THE PROPERTY TO MECKLENBURG COUNTY FOR GREENWAY PARK EXPANSION.	

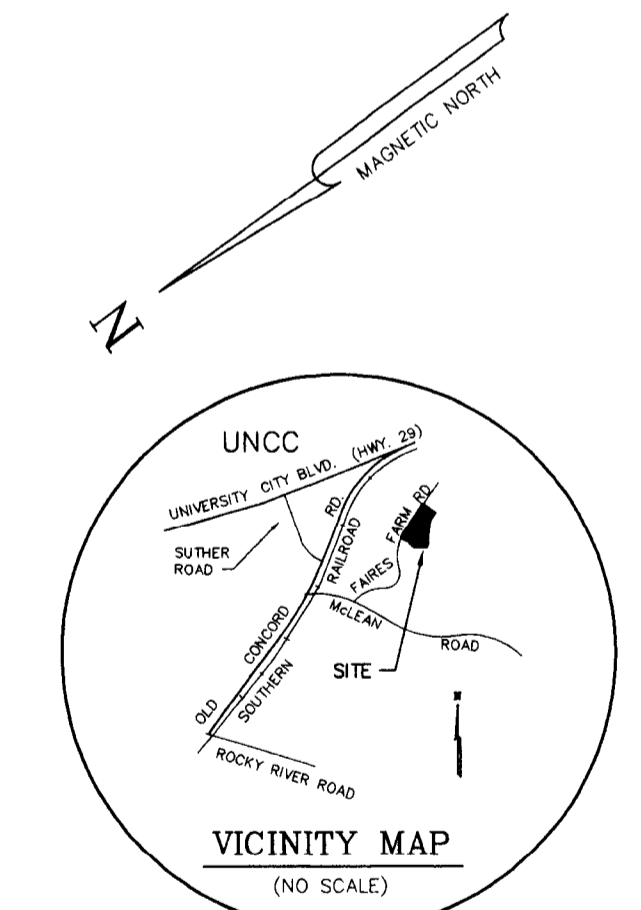
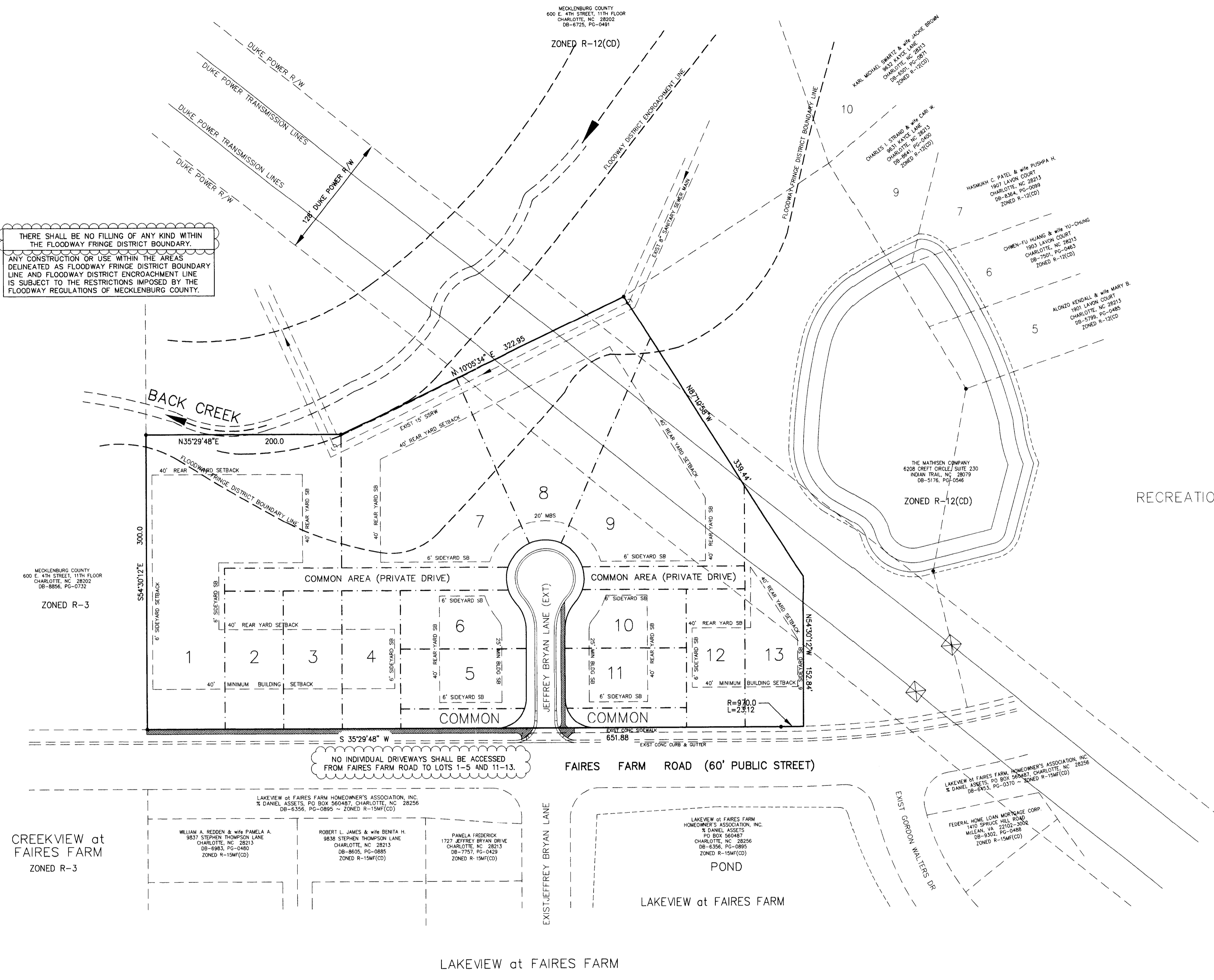

MECKLENBURG COUNTY
600 E. 4TH STREET, 11TH FLOOR
CHARLOTTE, NC 28202
DB-8856, PG-0732
ZONED R-3

LAKEVIEW at FAIRES FARM HOMEOWNER'S ASSOCIATION, INC.
% DANIEL ASSETS, PO BOX 560487, CHARLOTTE, NC 28256
DB-6356, PG-0895 - ZONED R-15MF(CD)

WILLIAM A. REDDEN & WIFE PAMELA A.
9837 STEPHEN THOMPSON LANE
CHARLOTTE, NC 28213
DB-6963, PG-0480
ZONED R-15MF(CD)

ROBERT L. JAMES & WIFE BENTHA H.
9838 STEPHEN THOMPSON LANE
CHARLOTTE, NC 28213
DB-8605, PG-0685
ZONED R-15MF(CD)

PAMELA FREDERICK
1727 JEFFREY BRYAN DRIVE
CHARLOTTE, NC 28213
DB-7757, PG-4429
ZONED R-15MF(CD)

LAKEVIEW at FAIRES FARM HOMEOWNER'S ASSOCIATION, INC.
% DANIEL ASSETS
PO BOX 560487
CHARLOTTE, NC 28256
DB-6356, PG-0895
ZONED R-15MF(CD)

LAKEVIEW at FAIRES FARM HOMEOWNER'S ASSOCIATION, INC.
% DANIEL ASSETS, PO BOX 560487, CHARLOTTE, NC 28256
DB-6356, PG-0895 - ZONED R-15MF(CD)

FEDERAL HOME LOAN MORTGAGE CORP.
1410 SPRUCE HILL ROAD
MCLEAN, VA 22102-3006
DB-9302, PG-0408
ZONED R-15MF(CD)

LAKEVIEW at FAIRES FARM

REV NO	BY	DATE	NATURE OF REVISIONS
1	C.M.	2-10-99	ADDED NOTES PROHIBITING FILLING WITHIN THE FLOOD FRINGE AND DRIVEWAY CONNECTIONS FROM FAIRES FARM ROAD. ADDED SITE DATA TABLE. AMENDED TITLE BLOCK. DELETED PROPOSED SEWER AND STORM DRAINAGE.

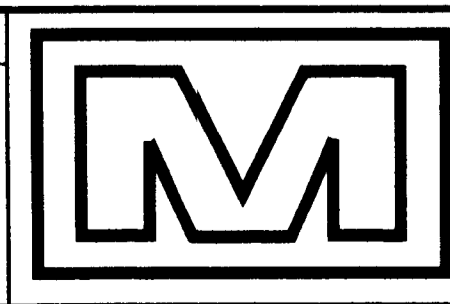

THE MATHISEN COMPANY
LAND PLANNING & DEVELOPMENT
6208 CREST CIRCLE, SUITE 230 • INDIAN TRAIL, NC 28079
TELE. (704) 882-1193 - FAX. (704) 882-1195

DRAWN BY:	C.M.
APPROVED BY:	N.A.M.
SCALE:	1" = 60'
FILE:	G:\FF\DWG\FFSC-REZ2
DATE:	JANUARY 25, 1999

REZONING SITE PLAN
FOR PUBLIC HEARING
PETITION NO. 99-08

Sheet 1
of 1