

**TREE INVENTORY**

1	14'	SWEET GUM	31	9'	SWEET GUM	106	10'	SWEET GUM
2	10'	DM	32	8'	SWEET GUM	107	8'	6' FORKED ELM
3	10'	SWEET GUM	33	7'	1/2" FORKED SWEET GUM	108	8'	ELM
4	10'	SWEET GUM	34	14'	DM	109	10'	ELM
5	10'	1/2" FORK SWEET GUM	35	12'	HICKORY	110	9'	ELM
6	10'	PINE	36	12'	SWEET GUM	111	8'	CELRAB
7	10'	SWEET GUM	37	8'	1/2" FORKED SWEET GUM	112	8'	WILD CHERRY
8	10'	PINE	38	8'	SWEET GUM	113	8'	SWEET GUM
9	10'	SWEET GUM	39	8'	DM	114	8'	SWEET GUM
10	10'	ELM	40	8'	ELM	115	8'	SWEET GUM
11	10'	LIVE OAK	41	8'	SWEET GUM	116	8'	SWEET GUM
12	10'	HICKORY	42	8'	SWEET GUM	117	8'	SWEET GUM
13	10'	DM	43	8'	SWEET GUM	118	8'	SWEET GUM
14	10'	SWEET GUM	44	8'	SWEET GUM	119	8'	SWEET GUM
15	10'	SWEET GUM	45	8'	SWEET GUM	120	8'	SWEET GUM
16	10'	SWEET GUM	46	8'	SWEET GUM	121	8'	SWEET GUM
17	10'	HICKORY	47	8'	PINE	122	8'	PINE
18	10'	CELRAB	48	8'	HICKORY	123	8'	HICKORY
19	10'	SWEET GUM	49	8'	HICKORY	124	8'	HICKORY
20	10'	VILLOW DM	50	8'	HICKORY	125	8'	HICKORY
21	10'	HICKORY	51	8'	ELM	126	8'	ELM
22	10'	PINE	52	8'	ELM	127	8'	ELM
23	10'	PINE	53	8'	ELM	128	8'	ELM
24	10'	SWEET GUM	54	8'	CELRAB	129	8'	CELRAB
25	10'	CELRAB	55	8'	ELM	130	8'	ELM
26	10'	PINE	56	8'	PINE	131	8'	PINE
27	10'	SWEET GUM	57	8'	SWEET GUM	132	8'	SWEET GUM
28	10'	VILLOW DM	58	8'	SWEET GUM	133	8'	SWEET GUM
29	10'	PINE	59	8'	ELM	134	8'	ELM
30	10'	VILLOW DM	60	8'	SWEET GUM	135	8'	SWEET GUM
31	10'	PINE	61	8'	ELM	136	8'	ELM
32	10'	PINE	62	8'	SWEET GUM	137	8'	SWEET GUM
33	10'	PINE	63	8'	SWEET GUM	138	8'	SWEET GUM
34	10'	PINE	64	8'	ELM	139	8'	ELM
35	10'	PINE	65	8'	ELM	140	8'	ELM
36	10'	PINE	66	8'	ELM	141	8'	ELM
37	10'	PINE	67	8'	ELM	142	8'	ELM
38	10'	PINE	68	8'	ELM	143	8'	ELM
39	10'	PINE	69	8'	ELM	144	8'	ELM
40	10'	PINE	70	8'	ELM	145	8'	ELM
41	10'	FORKED ELM	71	8'	ELM	146	8'	ELM
42	10'	PINE	72	8'	ELM	147	8'	ELM
43	10'	PINE	73	8'	ELM	148	8'	ELM
44	10'	PINE	74	8'	ELM	149	8'	ELM
45	10'	PINE	75	8'	ELM	150	8'	ELM
46	10'	PINE	76	8'	ELM	151	8'	ELM
47	10'	PINE	77	8'	ELM	152	8'	ELM
48	10'	PINE	78	8'	ELM	153	8'	ELM
49	10'	PINE	79	8'	ELM	154	8'	ELM
50	10'	PINE	80	8'	ELM	155	8'	ELM
51	10'	PINE	81	8'	ELM	156	8'	ELM
52	10'	PINE	82	8'	ELM	157	8'	ELM
53	10'	PINE	83	8'	ELM	158	8'	ELM
54	10'	PINE	84	8'	ELM	159	8'	ELM
55	10'	PINE	85	8'	ELM	160	8'	ELM
56	10'	PINE	86	8'	ELM	161	8'	ELM
57	10'	PINE	87	8'	ELM	162	8'	ELM
58	10'	PINE	88	8'	ELM	163	8'	ELM
59	10'	PINE	89	8'	ELM	164	8'	ELM
60	10'	PINE	90	8'	ELM	165	8'	ELM
61	10'	PINE	91	8'	ELM	166	8'	ELM
62	10'	PINE	92	8'	ELM	167	8'	ELM
63	10'	PINE	93	8'	ELM	168	8'	ELM
64	10'	PINE	94	8'	ELM	169	8'	ELM
65	10'	PINE	95	8'	ELM	170	8'	ELM
66	10'	PINE	96	8'	ELM	171	8'	ELM
67	10'	PINE	97	8'	ELM	172	8'	ELM
68	10'	PINE	98	8'	ELM	173	8'	ELM
69	10'	PINE	99	8'	ELM	174	8'	ELM
70	10'	PINE	100	8'	ELM	175	8'	ELM

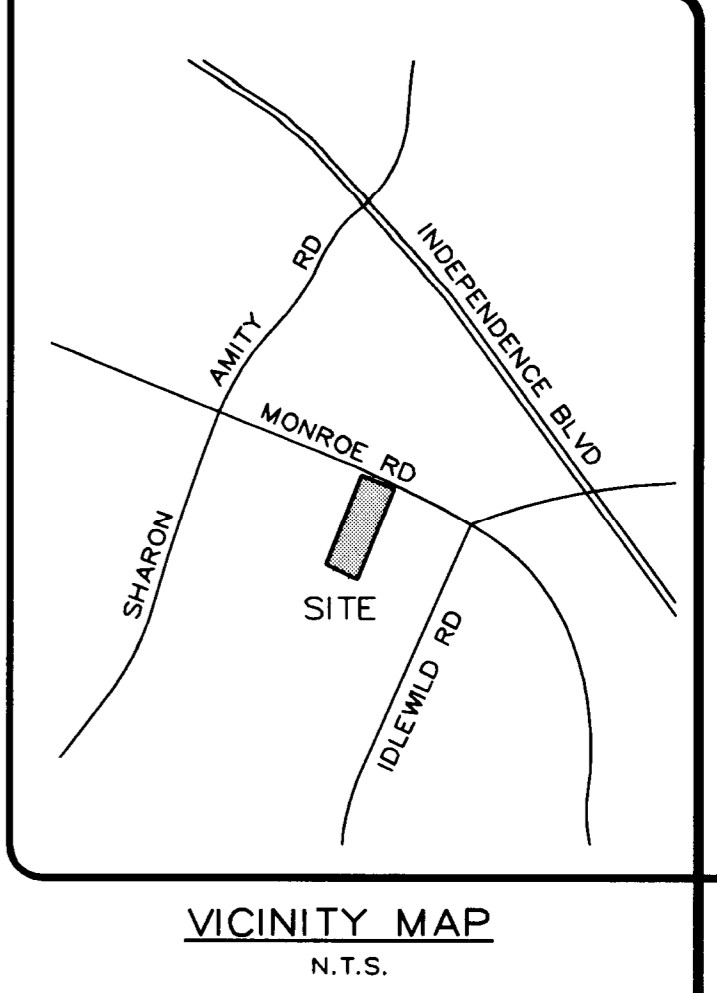

REVISIONS	BY
PER REZONING COMMENTS 1/11/99	R.H.
1/14/99	
NOTE FOR FUTURE RIGHT-OF-WAY 2/25/99	R.H.
REV. MALK PLANTING STRIP 5/27/02	DHC

PREPARED BY  
**POWER ENGINEERING COMPANY, INC.**  
ENGINEERS - PLANNERS - SURVEYORS  
COLUMBIA, SC CHARLOTTE, NC

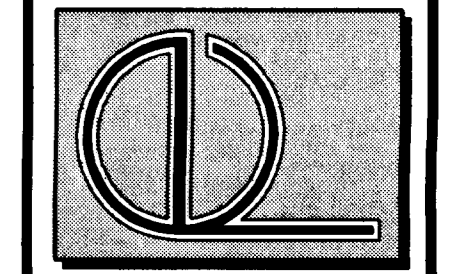

**SHARON MEMORIAL PARK**  
**SHARON FUNERAL HOME**  
**TECHNICAL DATA SHEET**  
CITY OF CHARLOTTE, MECKLENBURG COUNTY, NORTH CAROLINA

99-25

DRAWN	D.H.C.
CHECKED	D.K.R.
DATE	03-12-02
SCALE	1" = 30'
JOB NO.	5751
SHEET	2
OF	13 SHEETS

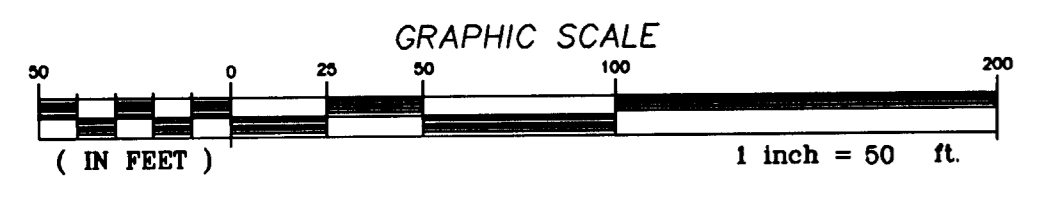
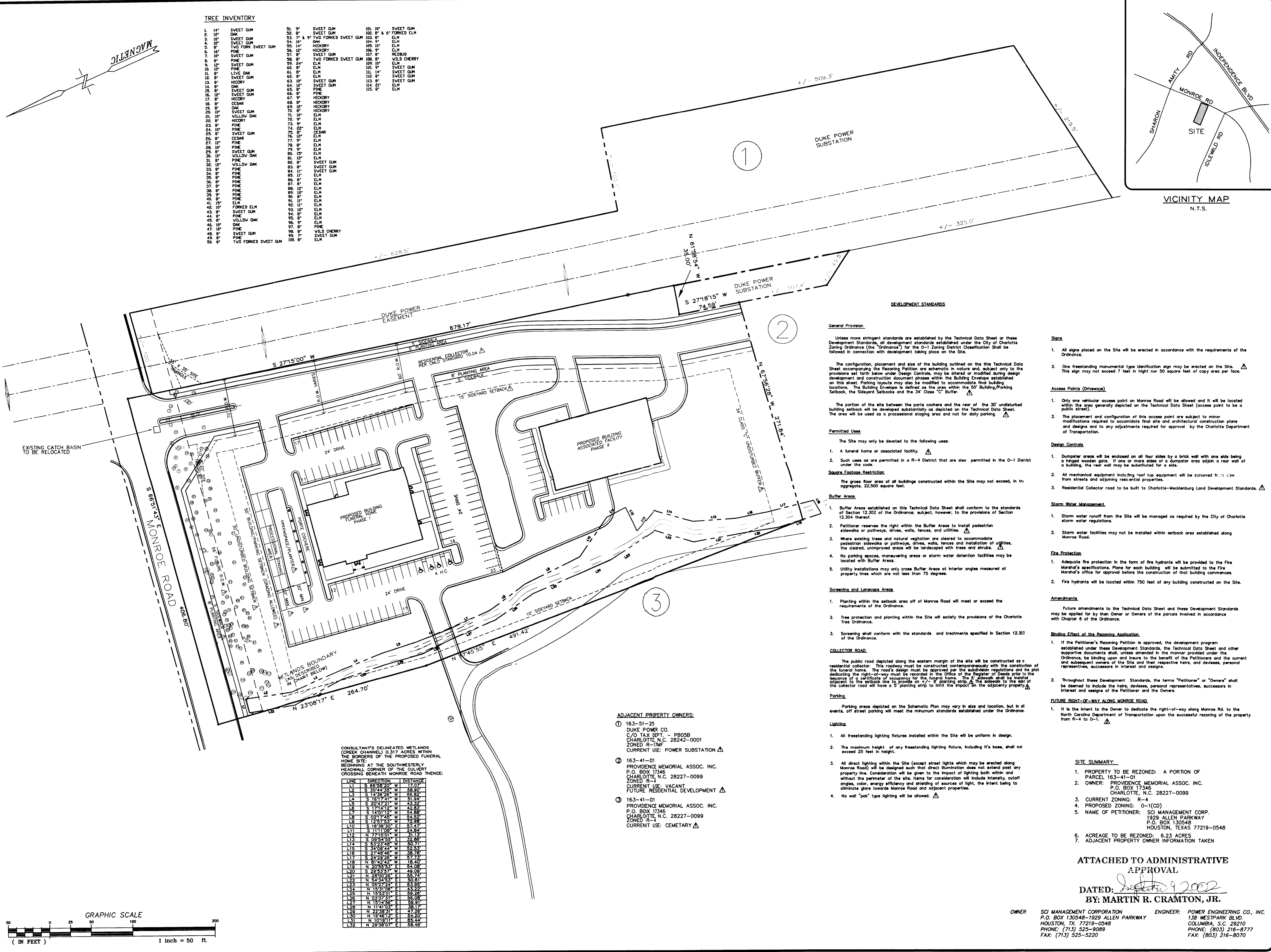

CONSULTANT'S DELINEATED METLANDS (ORISKAN CHANNEL) 0.377 ACRES WITHIN THE BORDERS OF THE PROPOSED FUNERAL HOME SITE AT THE SOUTHWESTLY CORNER OF THE CURRENT CROSSING BETWEEN MONROE ROAD (HENCE) BEGINNING

LINE	DIRECTION	DISTANCE
1	S 65°28'20" W	17.07
2	S 30°44'30" W	26.80
3	S 14°36'28" W	66.89
4	S 16°19'41" W	51.24
5	S 20°42'21" W	43.34
6	S 12°01'22" W	21.88
7	S 12°01'22" W	21.88
8	S 02°57'40" W	27.47
9	S 12°01'22" W	21.88
10	S 12°01'22" W	21.88
11	S 11°11'00" W	24.84
12	S 09°25'20" W	32.89
13	S 07°40'00" W	40.94
14	S 05°54'40" W	48.99
15	S 04°09'20" W	57.04
16	S 02°24'00" W	65.09
17	S 00°38'40" W	73.14
18	N 20°25'20" E	46.00
19	N 22°10'00" E	53.05
20	N 23°54'40" E	60.10
21	N 25°39'20" E	67.15
22	N 27°24'00" E	74.20
23	N 29°08'40" E	81.25
24	N 30°53'20" E	88.30
25	N 32°38'00" E	95.35
26	N 34°22'40" E	102.40
27	N 36°07'20" E	109.45
28	N 37°52'00" E	116.50
29	N 39°36'40" E	123.55
30	N 41°21'20" E	130.60
31	N 43°06'00" E	137.65
32	N 44°50'40" E	144.70
33	N 46°35'20" E	151.75
34	N 48°20'00" E	158.80
35	N 50°04'40" E	165.85

**ADJACENT PROPERTY OWNERS:**

① 163-51-25  
DUKE POWER CO.  
E/O TAX DIST. - PR05B  
CHARLOTTE, N.C. 28242-0001  
ZONED R-1MF  
CURRENT USE: POWER SUBSTATION

② 163-41-01  
PROVIDENCE MEMORIAL ASSOC. INC.  
P.O. BOX 1346  
CHARLOTTE, N.C. 28227-0099  
ZONED R-1  
CURRENT USE: VACANT  
FUTURE RESIDENTIAL DEVELOPMENT

③ 163-41-01  
PROVIDENCE MEMORIAL ASSOC. INC.  
P.O. BOX 1346  
CHARLOTTE, N.C. 28227-0099  
ZONED R-1  
CURRENT USE: CEMETARY

**CHARLOTTE - MECKLENBURG PLANNING COMMISSION**  
**INTER - OFFICE COMMUNICATION**

DATE: September 9, 2002

TO: Robert Brandon  
Zoning Administrator

FROM: Martin R. Cramton, Jr.  
Planning Director

SUBJECT: Administrative Approval for Petition No. 99-25 by David S. Reynolds.

Attached is the revised plan for the above petition. The plan has been revised to allow a 5-foot planting strip with a 5-foot sidewalk along the eastern side of the collector street. Since this change does not alter the intent of the development and meet the requirements of the Charlotte Zoning Ordinance Section 6.206(2) Alterations to Approval for minor changes, I am administratively approving this plan. Please use this plan when evaluating requests for building permits and certificates of occupancy.