



* 0 0 B R E A K 0 0 *



**ADVANCED
IMAGING
SYSTEMS**

www.aisimc.com

An Information
Management Company

City of Charlotte – Planning Dept. Scanning Rezoning Files

Petition # _____

Document type:

- Applications
- Correspondence
- Department Comments
- Land Use Consistency
 - Mail Info
 - Mapping
 - Other
- Site Plans



* 0 0 B R E A K 0 0 *

Appendum to Rezoning Application

Owner	Mailing Address	Location	Tax Parcel Number	Size	Current Use
Overcash, Harry J.	6125 Linda Vista Ln. Charlotte, N.C. 28216	6100 Linda Vista Ln.	Q3736114 ●	.87 Ac	Mobile Home
Overcash, Harry J.	Linda Vista Ln.		Q3731105 ●	2.8 Ac	Open
Overcash, Margaret	6201 Linda Vista Ln.		Q3731106 ●	1.01 Ac	Mobile Home
Overcash, Harry J.	6125 Linda Vista Ln.		Q3731116 ●	9.03 Ac	Open
Tyler, Jerry Keith	6212 Linda Vista Ln. Charlotte, N.C. 28216	6212 Linda Vista Ln.	Q3736112 ●	.531 Ac	Residence
Tyler, Jerry Keith		6200 Linda Vista Ln.	Q3736113 ●	.87 Ac	Mobile Home
Tyler, Jerry Keith		6219 Linda Vista Ln.	Q3731107 ●	.513 Ac	Mobile Home
Tyler, Jerry Keith		6211 Linda Vista Ln.	Q3731108 ●	.471 Ac	Mobile Home
Woods, Lewis & Wife Marlene	2004 Primm Rd. Charlotte, N.C. 28208	6293 Linda Vista Ln.	Q3731109 ●	.781 Ac	Mobile Home
		Trull Street	Q3731115 ●	3.68 Ac	Open
		Trull Street	Q3731113 ●	.321 Ac	Mobile Home
		Trull Street	Q3731114 ●	.918 Ac	Mobile Home
		Trull Street	Q3731112 ●	.314 Ac	Open
		6315 Linda Vista Ln.	Q3731111 ●	.976 Ac	Mobile Homes
Howell, Mona Poole	5919 Linda Vista Ln. Charlotte, N.C. 228216	Linda Vista Ln.	Q3731102 ●	3.0 Ac	Mobile home
		5925 Linda Vista Ln.	Q3731103 ●	10.19 Ac	Residence & Mobile Homes
Ferguson, Doris E.	5801 Linda Vista Ln. Charlotte, N.C. 28216	5801 Linda Vista Ln.	Q3731101 ●	3.18 Ac	Residence
Alexander, Roy Gene	6415 Old Plank Rd. #9 Charlotte, N.C. 28216	Linda Vista Ln.	Q3731104 ●	.482 Ac	Open
Gurley, Lenda J.	6309 Linda Vista Ln. Charlotte, N.C. 28216	6309 Linda Vista Ln	Q3731110 ●	.443 Ac	Mobile Home
Blakely, Paul D & Wf. Annette M.	3654 Trull Street Charlotte, N.C. 28216	3648 Trull Street	Q3736102 ●	.541 Ac	Open
		3640 Trull Street	Q3736103 ●	.551 Ac	Open
		3654 Trull Street	Q3736101 ●	.53 Ac	Mobile Home
Dixon, Howard T.	3630 Trull Street Charlotte, N.C. 28216	3630 Trull Street	Q3736104 ●	.682 Ac	Mobile Home
Johnson, Kathleen T.	3622 Trull Street Charlotte, N.C. 28216	3622 Trull Street	Q3736105 ●	1.054 Ac	Mobile Home
Flake, John David	3600 Trull Street Charlotte, N.C. 28216	3612 Trull Street	Q3736106 ●	.327 Ac	Mobile Home
Mowry, Mary E.	P.O. Box 422	3600 Trull Street	Q3736107 ●	3.55 Ac	Mobile Home

Addendum to Rezoning Application

Huntersville, N.C. 28078							
Bartlett, Nina W.	8209 Saddlehorse Lane Charlotte, N.C. 28216	6320 Linda Vista Ln.	03736108 *	.64 Ac	Mobile Home		
		6308 Linda Vista Ln.	03736109 *	.44 Ac	Mobile Home		
Byrd, James E. & Wife Marie B.	6300 Linda Vista Ln. Charlotte, N.C. 28216	6300 Linda Vista Ln.	03736110 *	.42 Ac	Mobile Home		
Skipper, Charles N. & Wife Cynthia E.	1908 Sunset Road Charlotte, N.C. 28216	Linda Vista Ln.	03736111 *	.531 Ac	Mobile Home		
		Linda Vista Ln.	03736115 *	2.12 Ac			
Phillips, Wade	5816 Linda Vista Ln. Charlotte, N.C. 28216	Linda Vista Ln.	03736116 *	8.53 Ac			
		Linda Vista Ln.	03711112 *	0.0 Ac	Mobile Homes		
Beshears, Henry Clay & Wife Louise H.	5816 Linda Vista Ln. Charlotte, N.C. 28216	5816 Linda Vista Ln.	03711112 *	9.26 Ac	Residence		
Stone, Dale Brian & wf. Holly Ann	5716 Linda Vista Ln. Charlotte, N.C. 28216	5716 Linda Vista Ln.	03711113	5.69 Ac	Residence		
Brown, William F. & Wf. Marilyn S.	5901 Preston Ln. Charlotte, N.C. 28211	Linda Vista Ln.	03711116 *	.195 Ac	Open		
Mullis, Harvey W. & Wf. Margaret S.	6344 Statesville Road Charlotte, N.C. 28213	6016 Linda Vista Ln.	03736117 *	5.094 Ac	Open		
		Linda Vista Ln.	03736119 *	1.261 Ac	Mobile home		
Mullis, Gene B. & Wf. Nancy L.	6000 Linda Vista Ln. Charlotte, N.C. 28216	6000 Linda Vista Ln.	03736118 *	1.456 Ac	Residence		

Adjoining Properties Owners List

Name	Mailing Address	Tax Parcel ID Number
J.P. Todd Jr.	111 Rock Pointe Lane Carey, N.C. 27513	O3711114 O3732118
Jerry L. Caton	5441 Beatties Ford Rd. Charlotte, N.C. 28216	O3711224
Pamela H. Francis	1501 Mt. Zion Church Rd. Iron Station, N.C. 28080	O3711401 O3711402 O3711403 O3711404
Donald R. Buchanan	5727 Thompson Road Charlotte, N.C. 28216	O3711413 O3711405
Barbara W. Wallace	5807 Thompson Road Charlotte, N.C. 28216	O3711407
Robert C. Kistler	5808 Thompson Road Charlotte, N.C. 28216	O3711408
John F. Locklear	6610 Riverview Dr. Charlotte, N.C. 28216	O3711410 O3711411 O3711412
Huey M. Rowe-Anderson	P.O. Box 34068 Charlotte, N.C. 28234	O3736121
University Park Baptist Church	2348 Keller Avenue Charlotte, N.C. 28216	O3736123 O3736125
B.V. Belk Investments	4400 Park Road #300 Charlotte, N.C. 28209	O3728399
Kelly McKee Carpenter	3141 Sunset Road Charlotte, N.C. 28216	O3732123
Norman D. Carpenter	3141 Sunset Road Charlotte, N.C. 28216	O3732122
Harold Watts McKee	2901 Sunset Road Charlotte, N.C. 28216	O3732121

Petition #: 99-50(c)

Petitioner: Beatties Ford/Sunset Road Coalition (3rd party petition)

Hearing Date: July 13, 1999

Zoning Classification (Existing): R-MH

Zoning Classification (Requested): R-3 and R-6(CD)

Location: Approximately 80 acres located on both the east and west sides of Linda Vista Lane, north of Sunset Road.

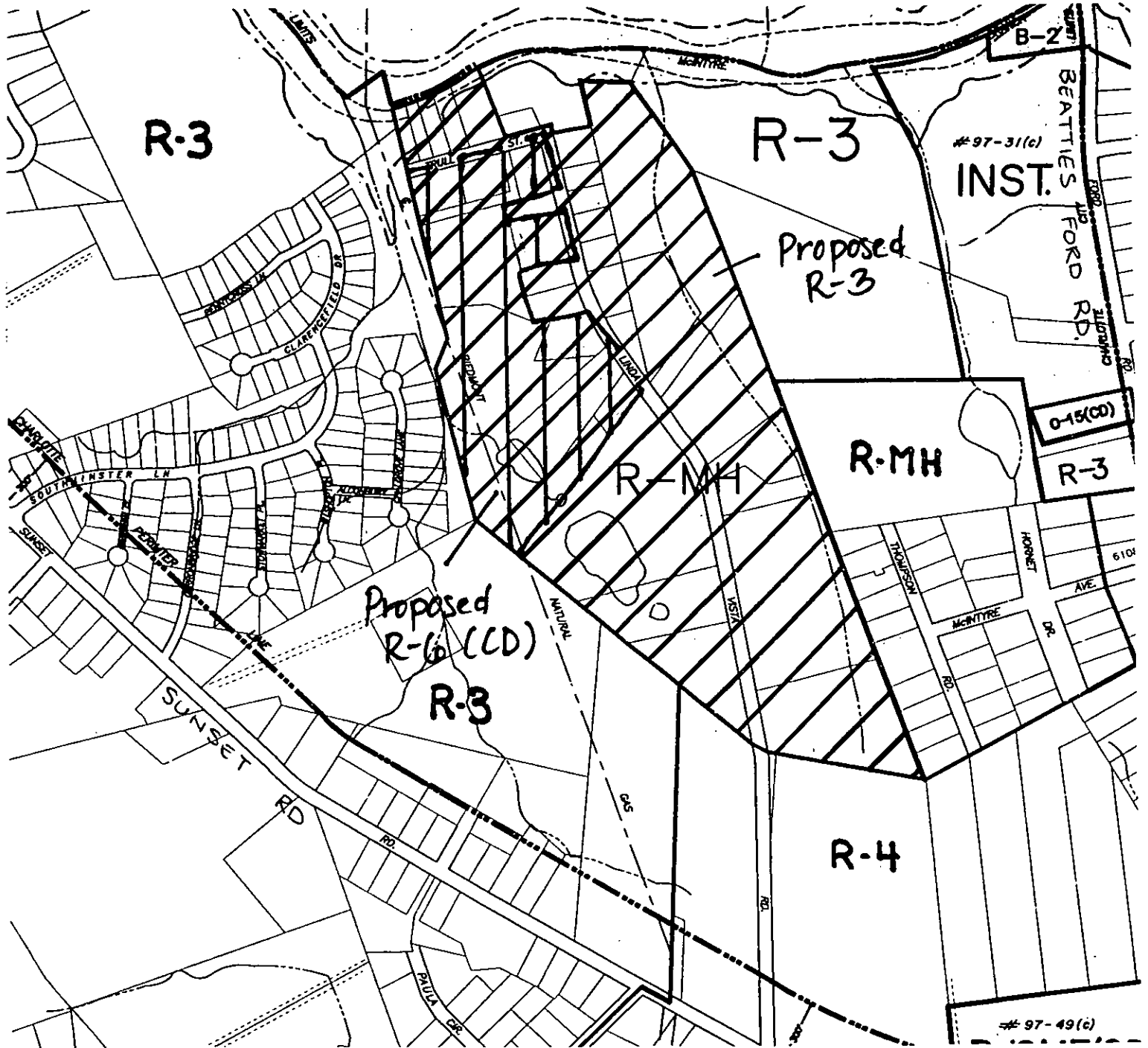



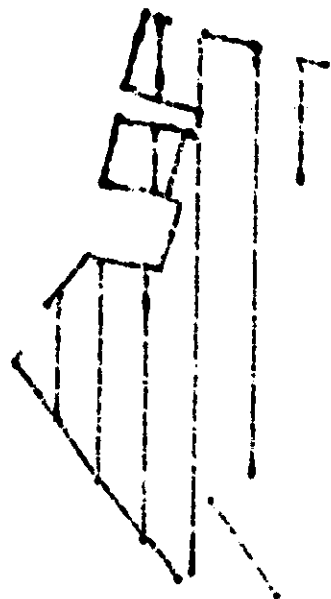

Proposed
R-3



Proposed
R-6 (CD)



Corridor

-  All Roads
-  1997 Aerial Photo
-  Tax Parcel Land Use
-  Planning Land Use

BUFFER: 200 FEET PID: 03736115 SUBJECT: SKIPPER CHARLES N &WF MADELINE S

<p>Date and Time Stamp 11/10/99 9:59:34 AM EST</p>	<p>This map is prepared for the inventory of real property within Mecklenburg County and is compiled from recorded deeds, plats, tax maps, surveys, planimetric maps, and other public records and data. Users of this map are hereby notified that the aforementioned public primary information sources should be consulted for verification. Mecklenburg County and its mapping contractors assume no legal responsibility for the information contained herein.</p>
--	---

[Click Here to Open Owner's List \(Comma-Delimited\)](#)

ADJOINING OWNER'S REPORT

Total Parcels Selected: 11

Total Tax Records Selected: 11

Record	MapId#	Parcel-Id#	Owner's Name	Mailing Address	Property Address	Deed Book	Deed Page	Acreege
1	1103	03731103	HOWELL MONA POOLE	5919 LINDA VISTA LN CHARLOTTE NC 28216	5925 LINDA VISTA LN	03717	206	10.19
2	1104	03731104	ALEXANDER ROY GENE	6415 OLD PLANK RD #9 CHARLOTTE NC 28216	LINDA VISTA LN	04086	303	0.482
3	1105	03731105	OVERCASH HARRY J &WF MARGARET F	6125 LINDA VISTA LN CHARLOTTE NC 28216	LINDA VISTA LN	03796	331	2.8
4	1106	03731106	OVERCASH MARGARET F	6125 LINDA VISTA LN CHARLOTTE NC 28216	6201 LINDA VISTA LN	04341	711	1.01
5	6111	03736111	BYRD JAMES E &WF MARIE B	6300 LINDA VISTA LN CHARLOTTE NC 28216	6300 LINDA VISTA LN	03897	071	0.531
6	6112	03736112	TYLER JERRY KEITH	6212 LINDA VISTA LN CHARLOTTE NC 28216	6212 LINDA VISTA LN	04947	897	0.531
7	6113	03736113	TYLER JERRY KEITH	6212 LINDA VISTA LN CHARLOTTE NC 28216	6200 LINDA VISTA LN	04947	897	0.87
8	6114	03736114	OVERCASH HARRY J	6125 LINDA VISTA LN CHARLOTTE NC 28216	6100 LINDA VISTA LN	03341	501	0.87
9	6115	03736115	SKIPPER CHARLES N &WF MADELINE S	6108 LINDA VISTA LN CHARLOTTE NC 28216	LINDA VISTA LN	02541	453	2.12
10	6116	03736116	SKIPPER CHARLES NEWELL JR &WF CYNTHIA E	1908 SUNSET RD CHARLOTTE NC 28216	LINDA VISTA LN	05066	685	8.53

11	6117	03736117	MULLIS HARVEY W & WF MARGARET S	6344 STATESVILLE RD CHARLOTTE NC 28213	6016 LINDA VISTA LN	04331	670	5.094
----	------	----------	------------------------------------	--	---------------------------	-------	-----	-------

This site is powered by



ESRI

MapObjects Internet Map Server



IIISTATS By



This site was developed by Todd Wilson of Mecklenburg County GIS and was last updated on 11/4/99 2:43:26 PM