

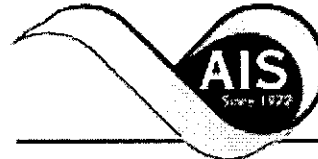

* 0 0 B R E A K 0 0 *



**ADVANCED
IMAGING
SYSTEMS**

www.aisinc.com

An Information
Management Company

City of Charlotte – Planning Dept. Scanning Rezoning Files

Petition # _____

Document type:

- Applications
- Correspondence
- Department Comments
- Land Use Consistency
 - Mail Info
 - Mapping
 - Other
- Site Plans



* 0 0 B R E A K 0 0 *

MECKLENBURG COUNTY, NC GIS PUBLIC ACCESS SYSTEM

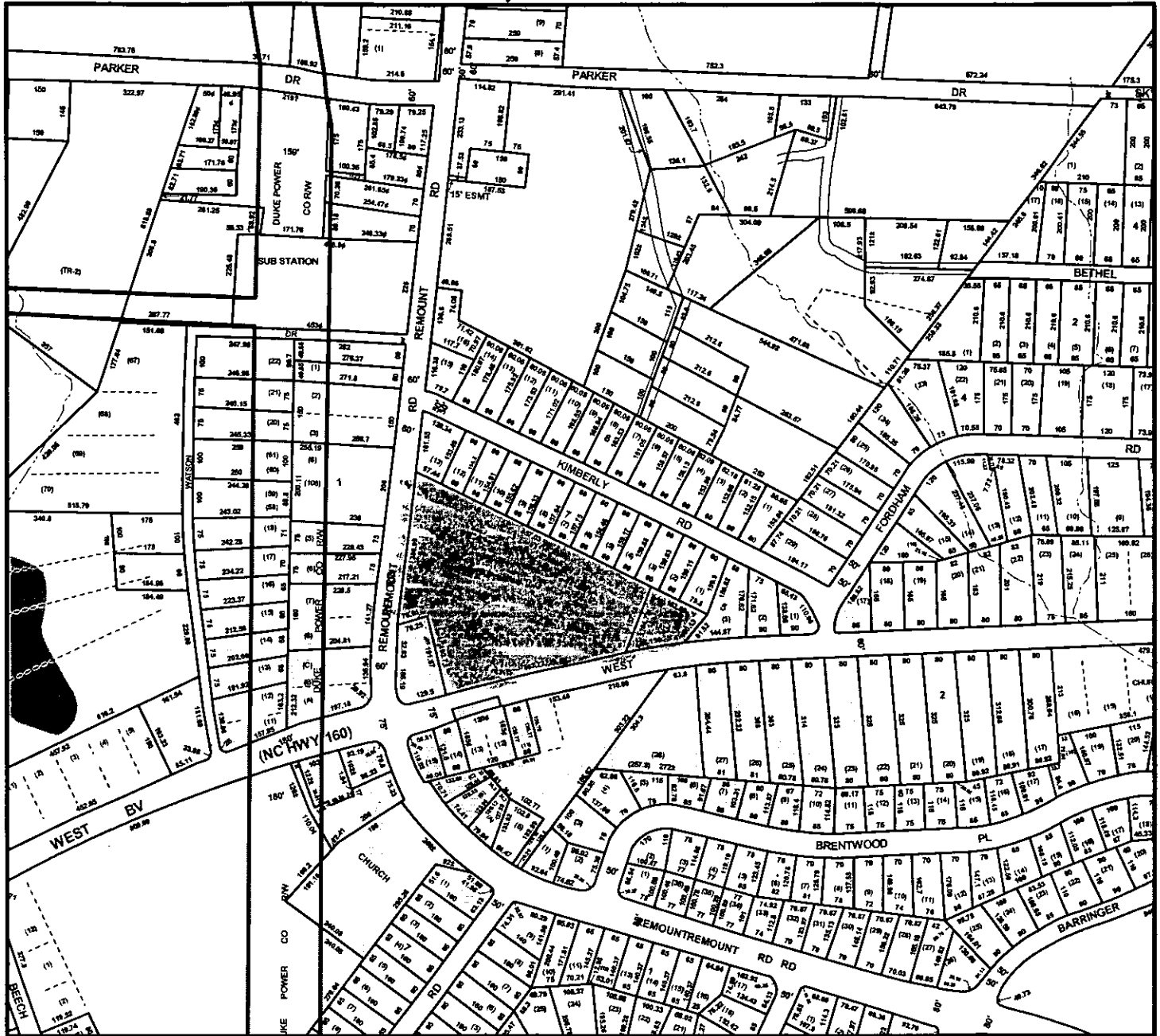

Tax Parcel-Id#s Selected: See Tax Information Report for List of Parcel-Id#s

Tax Book & Page Selected: N/A

2002-02

LEGEND

- County Boundary
- Rivers/Creeks/Streams
- Railroad ROW
- Water Bodies

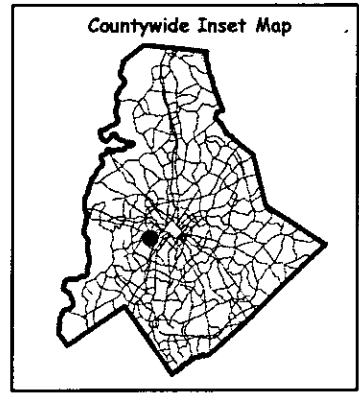
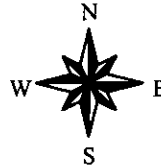

Scale : 1 Inch = 400 Feet
 Map Created on Friday, December 21, 2001 02:28 PM

This map is prepared for the inventory of real property within Mecklenburg County and is compiled from recorded deeds, plats, tax maps, surveys, planimetric maps, and other public records and data. Users of this map are hereby notified that the aforementioned public primary information sources should be consulted for verification. Mecklenburg County and its mapping contractors assume no legal responsibility for the information contained herein.

5005-05



MECKLENBURG COUNTY, NC
GIS PUBLIC ACCESS SYSTEM REPORT

DATE PRINTED 12/21/01

Note : Records are sorted in Parcel Number order.

PAGE : 1

Record No.: 1 **BUILDING KEY NUMBER :** 11702216 001
PARCEL-ID : 11702216 **NEIGHBORHOOD CODE :** 11701 **ZONING CLASS :** R22MF
OWNER'S NAME : DUKE POWER CO **ATTN:** TAX DEPT - PB05B
MAILING ADDRESS : 422 S CHURCH ST
CITY : CHARLOTTE **STATE :** NC **ZIP CODE :** 282420001

PROPERTY LOCATION : 2524 WATSON DR
LEGAL DESC. : 2524 WATSON DR **DEED BK,PG & DATE :** /
ACREAGE : 2.000 **SALE PRICE :** \$0 **QUALIFIED SALE (Y/N) :**
LAND VALUE : \$31,360 **IMPVMTS VALUE :** \$8,540 **TOTAL VALUE :** \$39,900

LAND-USE TYPE : WAREHOUSE/INDUSTRIAL **BUILDING TYPE :** WAREHOUSE
YEAR BUILT : 1,962 **SQUARE FEET :** 450 **STYLE CODE :** 1.0 STORY
BEDROOMS : 0 **BATHROOMS :** 0 **RESTROOMS :** 0 **BASEMENT :** N **GARAGE :** N
EXTERIOR TYPE : **QUALITY GRADE :** 5 **IMPVMT. VALUE :** \$5,310
A/C : NONE **FIREPLACE :** NONE

Record No.: 2 **BUILDING KEY NUMBER :** 11702301 001
PARCEL-ID : 11702301 **NEIGHBORHOOD CODE :** 11701 **ZONING CLASS :** B1
OWNER'S NAME : LUNN ENTERPRISE INC
MAILING ADDRESS : 1601 REMOUNT RD
CITY : CHARLOTTE **STATE :** NC **ZIP CODE :** 28208

PROPERTY LOCATION : 1601 REMOUNT RE
LEGAL DESC. : PT LA-C B1 M6-257 **DEED BK,PG & DATE :** 05332 /156 1986-10-06
ACREAGE : 1.000 **SALE PRICE :** \$0 **QUALIFIED SALE (Y/N) :** N
LAND VALUE : \$85,790 **IMPVMTS VALUE :** \$235,540 **TOTAL VALUE :** \$321,330

LAND-USE TYPE : COMMERCIAL **BUILDING TYPE :** CONVENIENCE STORE
YEAR BUILT : 1,971 **SQUARE FEET :** 4,014 **STYLE CODE :** 1.0 STORY
BEDROOMS : 0 **BATHROOMS :** 0 **RESTROOMS :** 0 **BASEMENT :** N **GARAGE :** N
EXTERIOR TYPE : FACE BRICK **QUALITY GRADE :** 3 **IMPVMT. VALUE :** \$200,520
A/C : CENTRAL **FIREPLACE :** NONE

Record No.: 3 **BUILDING KEY NUMBER :** 11702301 002
PARCEL-ID : 11702301 **NEIGHBORHOOD CODE :** 11701 **ZONING CLASS :** B1
OWNER'S NAME : LUNN ENTERPRISE INC
MAILING ADDRESS : 1601 REMOUNT RD
CITY : CHARLOTTE **STATE :** NC **ZIP CODE :** 28208

PROPERTY LOCATION : 1601 REMOUNT RE
LEGAL DESC. : PT LA-C B1 M6-257 **DEED BK,PG & DATE :** 05332 /156 1986-10-06
ACREAGE : 1.000 **SALE PRICE :** \$0 **QUALIFIED SALE (Y/N) :** N
LAND VALUE : \$85,790 **IMPVMTS VALUE :** \$235,540 **TOTAL VALUE :** \$321,330

LAND-USE TYPE : COMMERCIAL **BUILDING TYPE :** SERVICE STATION
YEAR BUILT : 1,987 **SQUARE FEET :** 1,752 **STYLE CODE :** 1.0 STORY
BEDROOMS : 0 **BATHROOMS :** 0 **RESTROOMS :** 0 **BASEMENT :** N **GARAGE :** N
EXTERIOR TYPE : SIDING MINIMUM/NONE **QUALITY GRADE :** 3 **IMPVMT. VALUE :** \$22,510
A/C : NONE **FIREPLACE :** NONE

NOTE: This data is prepared for the purposes of revaluation, assessing & determining ownership of real property & is compiled from recorded deeds, plats, tax maps & other public records & data. Users of this data are hereby notified that the aforementioned public information sources should be consulted for verification. Mecklenburg County assumes no legal responsibility for the information herein.



MECKLENBURG COUNTY, NC
GIS PUBLIC ACCESS SYSTEM REPORT

DATE PRINTED 12/21/01

Note : Records are sorted in Parcel Number order.

PAGE : 2

Record No.: 4 **BUILDING KEY NUMBER :** 11702304 001
PARCEL-ID : 11702304 **NEIGHBORHOOD CODE :** 11701 **ZONING CLASS :** B1
OWNER'S NAME : LUNN ENTERPRISE INC
MAILING ADDRESS : 1601 REMOUNT RD
CITY : CHARLOTTE **STATE :** NC **ZIP CODE :** 28208

PROPERTY LOCATION : 1621 REMOUNT RC
LEGAL DESC. : P7 & 8 B1 M4-549 **DEED BK,PG & DATE :** 05332 /156 1986-10-06
ACREAGE : 1.000 **SALE PRICE :** \$0 **QUALIFIED SALE (Y/N) :** N
LAND VALUE : \$56,810 **IMPVMTS VALUE :** \$69,280 **TOTAL VALUE :** \$126,090

LAND-USE TYPE : COMMERCIAL **BUILDING TYPE :** RESTAURANTS
YEAR BUILT : 1,977 **SQUARE FEET :** 1,188 **STYLE CODE :** 1.0 STORY
BEDROOMS : 0 **BATHROOMS :** 0 **RESTROOMS :** 0 **BASEMENT :** N **GARAGE :** N
EXTERIOR TYPE : UTILITY BRICK **QUALITY GRADE :** 3 **IMPVMT. VALUE :** \$60,280
A/C : CENTRAL **FIREPLACE :** NONE

Record No.: 5 **BUILDING KEY NUMBER :** 11702305 001
PARCEL-ID : 11702305 **NEIGHBORHOOD CODE :** 11701 **ZONING CLASS :** B1
OWNER'S NAME : LUNN ENTERPRISES INC
MAILING ADDRESS : 1621 REMOUNT RD
CITY : CHARLOTTE **STATE :** NC **ZIP CODE :** 28208

PROPERTY LOCATION : 1627 REMOUNT RC
LEGAL DESC. : P6B1M4-549 1627 REMOUNT RD **DEED BK,PG & DATE :** 06290 /635 1990-06-14
ACREAGE : 0.000 **SALE PRICE :** \$0 **QUALIFIED SALE (Y/N) :** N
LAND VALUE : \$30,240 **IMPVMTS VALUE :** \$0 **TOTAL VALUE :** \$30,240

LAND-USE TYPE : VACANT **BUILDING TYPE :** COMMERCIAL
YEAR BUILT : 0 **SQUARE FEET :** 0 **STYLE CODE :**
BEDROOMS : 0 **BATHROOMS :** 0 **RESTROOMS :** 0 **BASEMENT :** N **GARAGE :** N
EXTERIOR TYPE : **QUALITY GRADE :** 0 **IMPVMT. VALUE :** \$0
A/C : **FIREPLACE :**

Record No.: 6 **BUILDING KEY NUMBER :** 11702306 001
PARCEL-ID : 11702306 **NEIGHBORHOOD CODE :** 11701 **ZONING CLASS :** B1
OWNER'S NAME : LUNN ENTERPRISES INC
MAILING ADDRESS : 1621 REMOUNT RD
CITY : CHARLOTTE **STATE :** NC **ZIP CODE :** 28208

PROPERTY LOCATION : 1633 REMOUNT RC
LEGAL DESC. : L5 B1 M4 549 1633 REMOUNT RD **DEED BK,PG & DATE :** 06290 /635 1990-06-14
ACREAGE : 0.000 **SALE PRICE :** \$0 **QUALIFIED SALE (Y/N) :** N
LAND VALUE : \$31,320 **IMPVMTS VALUE :** \$0 **TOTAL VALUE :** \$31,320

LAND-USE TYPE : VACANT **BUILDING TYPE :** COMMERCIAL
YEAR BUILT : 0 **SQUARE FEET :** 0 **STYLE CODE :**
BEDROOMS : 0 **BATHROOMS :** 0 **RESTROOMS :** 0 **BASEMENT :** N **GARAGE :** N
EXTERIOR TYPE : **QUALITY GRADE :** 0 **IMPVMT. VALUE :** \$0
A/C : **FIREPLACE :**

NOTE: This data is prepared for the purposes of revaluation, assessing & determining ownership of real property & is compiled from recorded deeds, plats, tax maps & other public records & data. Users of this data are hereby notified that the aforementioned public information sources should be consulted for verification. Mecklenburg County assumes no legal responsibility for the information herein.



MECKLENBURG COUNTY, NC

DATE PRINTED 12/21/01

GIS PUBLIC ACCESS SYSTEM REPORT

Note : Records are sorted in Parcel Number order.

PAGE : 3

Record No.: 7 **BUILDING KEY NUMBER :** 11702307 001
PARCEL-ID : 11702307 **NEIGHBORHOOD CODE :** 11701 **ZONING CLASS :** R22MF
OWNER'S NAME : REMOUNT TWENTY LLC
MAILING ADDRESS : PO BOX 30425
CITY : CHARLOTTE **STATE :** NC **ZIP CODE :** 28230

PROPERTY LOCATION : 1701 REMOUNT RE
LEGAL DESC. : L106 &6 M4-441 **DEED BK,PG & DATE :** 11028 /891 2000-01-13
ACREAGE : 1.000 **SALE PRICE :** \$0 **QUALIFIED SALE (Y/N) :** Y
LAND VALUE : \$19,580 **IMPVMTS VALUE :** \$225,610 **TOTAL VALUE :** \$245,190

LAND-USE TYPE : APARTMENT **BUILDING TYPE :** GARDEN APARTMENT
YEAR BUILT : 1,966 **SQUARE FEET :** 11,024 **STYLE CODE :** 2.0 STORIES
BEDROOMS : 0 **BATHROOMS :** 0 **RESTROOMS :** 0 **BASEMENT :** N **GARAGE :** N
EXTERIOR TYPE : FACE BRICK **QUALITY GRADE :** 2 **IMPVMT. VALUE :** \$147,630
A/C : WALL UNIT **FIREPLACE :** NONE

Record No.: 8 **BUILDING KEY NUMBER :** 11702307 002
PARCEL-ID : 11702307 **NEIGHBORHOOD CODE :** 11701 **ZONING CLASS :** R22MF
OWNER'S NAME : REMOUNT TWENTY LLC
MAILING ADDRESS : PO BOX 30425
CITY : CHARLOTTE **STATE :** NC **ZIP CODE :** 28230

PROPERTY LOCATION : 1701 REMOUNT RE
LEGAL DESC. : L106 &6 M4-441 **DEED BK,PG & DATE :** 11028 /891 2000-01-13
ACREAGE : 1.000 **SALE PRICE :** \$0 **QUALIFIED SALE (Y/N) :** Y
LAND VALUE : \$19,580 **IMPVMTS VALUE :** \$225,610 **TOTAL VALUE :** \$245,190

LAND-USE TYPE : APARTMENT **BUILDING TYPE :** GARDEN APARTMENT
YEAR BUILT : 1,966 **SQUARE FEET :** 5,452 **STYLE CODE :** 2.0 STORIES
BEDROOMS : 0 **BATHROOMS :** 0 **RESTROOMS :** 0 **BASEMENT :** N **GARAGE :** N
EXTERIOR TYPE : FACE BRICK **QUALITY GRADE :** 2 **IMPVMT. VALUE :** \$74,580
A/C : WALL UNIT **FIREPLACE :** NONE

Record No.: 9 **BUILDING KEY NUMBER :** 11702308 001
PARCEL-ID : 11702308 **NEIGHBORHOOD CODE :** 11702 **ZONING CLASS :** R22MF
OWNER'S NAME : M & W COMPANY % MR. MORECOCK
MAILING ADDRESS : 7107 CYPRESS CREEK LN
CITY : CHARLOTTE **STATE :** NC **ZIP CODE :** 28210

PROPERTY LOCATION : 1719 REMOUNT RE
LEGAL DESC. : L2 &3 BL1 M4-549 **DEED BK,PG & DATE :** 02874 /025 1975-01-01
ACREAGE : 1.000 **SALE PRICE :** \$0 **QUALIFIED SALE (Y/N) :** N
LAND VALUE : \$15,780 **IMPVMTS VALUE :** \$50,650 **TOTAL VALUE :** \$66,430

LAND-USE TYPE : SINGLE FAMILY **BUILDING TYPE :** SINGLE FAMILY RESIDENTIAL
YEAR BUILT : 1,953 **SQUARE FEET :** 1,544 **STYLE CODE :** 1.0 STORY
BEDROOMS : 3 **BATHROOMS :** 2 **RESTROOMS :** 0 **BASEMENT :** N **GARAGE :** N
EXTERIOR TYPE : WOOD ON SHEATHING OR PLYWO **QUALITY GRADE :** 1 **IMPVMT. VALUE :** \$48,820
A/C : NONE **FIREPLACE :** 1 STY SINGLE

NOTE: This data is prepared for the purposes of revaluation, assessing & determining ownership of real property & is compiled from recorded deeds, plats, tax maps & other public records & data. Users of this data are hereby notified that the aforementioned public information sources should be consulted for verification. Mecklenburg County assumes no legal responsibility for the information herein.



MECKLENBURG COUNTY, NC

DATE PRINTED 12/21/01

GIS PUBLIC ACCESS SYSTEM REPORT

Note : Records are sorted in Parcel Number order.

PAGE : 4

Record No.: 10 **BUILDING KEY NUMBER :** 11702309 001
PARCEL-ID : 11702309 **NEIGHBORHOOD CODE :** 11702 **ZONING CLASS :** R22MF
OWNER'S NAME : M & W COMPANY % MR. MORECOCK
MAILING ADDRESS : 7107 CYPRESS CREEK LN
CITY : CHARLOTTE **STATE :** NC **ZIP CODE :** 28210

PROPERTY LOCATION : 1731 REMOUNT RC
LEGAL DESC. : PT1 B1 M4-549 **DEED BK,PG & DATE :** 03134 /274 1975-01-01
ACREAGE : 0.000 **SALE PRICE :** \$0 **QUALIFIED SALE (Y/N) :** N
LAND VALUE : \$5,350 **IMPVMTS VALUE :** \$29,070 **TOTAL VALUE :** \$34,420

LAND-USE TYPE : SINGLE FAMILY **BUILDING TYPE :** SINGLE FAMILY RESIDENTIAL
YEAR BUILT : 1,948 **SQUARE FEET :** 968 **STYLE CODE :** 1.0 STORY
BEDROOMS : 2 **BATHROOMS :** 1 **RESTROOMS :** 0 **BASEMENT :** N **GARAGE :** N
EXTERIOR TYPE : WOOD ON SHEATHING OR PLYWO **QUALITY GRADE :** 1 **IMPVMT. VALUE :** \$29,070
A/C : NONE **FIREPLACE :** NONE

Record No.: 11 **BUILDING KEY NUMBER :** 11702310 001
PARCEL-ID : 11702310 **NEIGHBORHOOD CODE :** 11701 **ZONING CLASS :** R22MF
OWNER'S NAME : M & W CO % MR. MORECOCK
MAILING ADDRESS : 7107 CYPRESS CREEK LN
CITY : CHARLOTTE **STATE :** NC **ZIP CODE :** 28210

PROPERTY LOCATION : 1735 REMOUNT RC
LEGAL DESC. : P1 B1 M4-549 **DEED BK,PG & DATE :** 03942 /845 1977-05-13
ACREAGE : 0.000 **SALE PRICE :** \$0 **QUALIFIED SALE (Y/N) :** N
LAND VALUE : \$5,470 **IMPVMTS VALUE :** \$29,170 **TOTAL VALUE :** \$34,640

LAND-USE TYPE : SINGLE FAMILY **BUILDING TYPE :** SINGLE FAMILY RESIDENTIAL
YEAR BUILT : 1,948 **SQUARE FEET :** 960 **STYLE CODE :** 1.0 STORY
BEDROOMS : 2 **BATHROOMS :** 1 **RESTROOMS :** 0 **BASEMENT :** N **GARAGE :** N
EXTERIOR TYPE : WOOD ON SHEATHING OR PLYWO **QUALITY GRADE :** 2 **IMPVMT. VALUE :** \$28,830
A/C : NONE **FIREPLACE :** NONE

Record No.: 12 **BUILDING KEY NUMBER :** 11702311 001
PARCEL-ID : 11702311 **NEIGHBORHOOD CODE :** 11701 **ZONING CLASS :** R22MF
OWNER'S NAME : SYNCON LTD
MAILING ADDRESS : 2815 GLENDALE RD
CITY : CHARLOTTE **STATE :** NC **ZIP CODE :** 282091744

PROPERTY LOCATION : 2601 WATSON DR
LEGAL DESC. : L22 B1 M4 549 2601 WATSON DR **DEED BK,PG & DATE :** 04177 /312 1979-04-07
ACREAGE : 1.000 **SALE PRICE :** \$0 **QUALIFIED SALE (Y/N) :** N
LAND VALUE : \$4,940 **IMPVMTS VALUE :** \$25,990 **TOTAL VALUE :** \$30,930

LAND-USE TYPE : SINGLE FAMILY **BUILDING TYPE :** DUPLEX/TRIPLEX
YEAR BUILT : 1,952 **SQUARE FEET :** 1,680 **STYLE CODE :** 1.0 STORY
BEDROOMS : 0 **BATHROOMS :** 2 **RESTROOMS :** 0 **BASEMENT :** N **GARAGE :** N
EXTERIOR TYPE : SIDING AVERAGE **QUALITY GRADE :** 2 **IMPVMT. VALUE :** \$25,990
A/C : NONE **FIREPLACE :** NONE

NOTE: This data is prepared for the purposes of revaluation, assessing & determining ownership of real property & is compiled from recorded deeds, plats, tax maps & other public records & data. Users of this data are hereby notified that the aforementioned public information sources should be consulted for verification. Mecklenburg County assumes no legal responsibility for the information herein.



MECKLENBURG COUNTY, NC
GIS PUBLIC ACCESS SYSTEM REPORT

DATE PRINTED 12/21/01

Note : Records are sorted in Parcel Number order.

PAGE : 5

Record No.: 13 **BUILDING KEY NUMBER :** 11702312 001
PARCEL-ID : 11702312 **NEIGHBORHOOD CODE :** 11701 **ZONING CLASS :** R22MF
OWNER'S NAME : MORELAND MARGARET T **BY WILL**
MAILING ADDRESS : 1801 PATTON AVE
CITY : CHARLOTTE **STATE :** NC **ZIP CODE :** 28216

PROPERTY LOCATION : 2611 WATSON DR
LEGAL DESC. : L21 B1 M4 549 2611 WATSON DR **DEED BK,PG & DATE :** 03664 /945 1974-07-25
ACREAGE : 0.000 **SALE PRICE :** \$0 **QUALIFIED SALE (Y/N) :** N
LAND VALUE : \$3,680 **IMPVMTS VALUE :** \$26,200 **TOTAL VALUE :** \$29,880

LAND-USE TYPE : SINGLE FAMILY **BUILDING TYPE :** DUPLEX/TRIPLEX
YEAR BUILT : 1,952 **SQUARE FEET :** 1,600 **STYLE CODE :** 1.0 STORY
BEDROOMS : 0 **BATHROOMS :** 2 **RESTROOMS :** 0 **BASEMENT :** N **GARAGE :** N
EXTERIOR TYPE : FACE BRICK **QUALITY GRADE :** 2 **IMPVMT. VALUE :** \$26,200
A/C : NONE **FIREPLACE :** NONE

Record No.: 14 **BUILDING KEY NUMBER :** 11702313 001
PARCEL-ID : 11702313 **NEIGHBORHOOD CODE :** 11701 **ZONING CLASS :** R22MF
OWNER'S NAME : CLAPHAM BRADLEY LOUIS
MAILING ADDRESS : 14600 MAJESTIC OAK DR
CITY : CHARLOTTE **STATE :** NC **ZIP CODE :** 28278

PROPERTY LOCATION : 2617 WATSON DR
LEGAL DESC. : L20 B1 M4-549 **DEED BK,PG & DATE :** 09525 /115 1998-02-27
ACREAGE : 0.000 **SALE PRICE :** \$0 **QUALIFIED SALE (Y/N) :** N
LAND VALUE : \$3,680 **IMPVMTS VALUE :** \$39,130 **TOTAL VALUE :** \$42,810

LAND-USE TYPE : SINGLE FAMILY **BUILDING TYPE :** DUPLEX/TRIPLEX
YEAR BUILT : 1,954 **SQUARE FEET :** 1,944 **STYLE CODE :** 1.0 STORY
BEDROOMS : 0 **BATHROOMS :** 2 **RESTROOMS :** 0 **BASEMENT :** N **GARAGE :** N
EXTERIOR TYPE : FACE BRICK **QUALITY GRADE :** 2 **IMPVMT. VALUE :** \$39,130
A/C : NONE **FIREPLACE :** NONE

Record No.: 15 **BUILDING KEY NUMBER :** 11702314 001
PARCEL-ID : 11702314 **NEIGHBORHOOD CODE :** 11701 **ZONING CLASS :** R22MF
OWNER'S NAME : SELECT BUSINESS EQUIPMENT **OF CHARLOTTE INC**
MAILING ADDRESS : 4311 KUYKENDALL RD
CITY : CHARLOTTE **STATE :** NC **ZIP CODE :** 28270

PROPERTY LOCATION : 2623 WATSON DR
LEGAL DESC. : L60&61M4 441 2623 WATSON DR **DEED BK,PG & DATE :** 06899 /049 1992-06-03
ACREAGE : 1.000 **SALE PRICE :** \$34,000 **QUALIFIED SALE (Y/N) :** Y
LAND VALUE : \$5,000 **IMPVMTS VALUE :** \$30,010 **TOTAL VALUE :** \$35,010

LAND-USE TYPE : SINGLE FAMILY **BUILDING TYPE :** DUPLEX/TRIPLEX
YEAR BUILT : 1,952 **SQUARE FEET :** 1,480 **STYLE CODE :** 1.0 STORY
BEDROOMS : 4 **BATHROOMS :** 2 **RESTROOMS :** 0 **BASEMENT :** N **GARAGE :** N
EXTERIOR TYPE : FACE BRICK **QUALITY GRADE :** 2 **IMPVMT. VALUE :** \$30,010
A/C : NONE **FIREPLACE :** NONE

NOTE: This data is prepared for the purposes of revaluation, assessing & determining ownership of real property & is compiled from recorded deeds, plats, tax maps & other public records & data. Users of this data are hereby notified that the aforementioned public information sources should be consulted for verification. Mecklenburg County assumes no legal responsibility for the information herein.



MECKLENBURG COUNTY, NC
GIS PUBLIC ACCESS SYSTEM REPORT

DATE PRINTED 12/21/01

Note : Records are sorted in Parcel Number order.

PAGE : 6

Record No.: 16 **BUILDING KEY NUMBER :** 11702315 001
PARCEL-ID : 11702315 **NEIGHBORHOOD CODE :** 11701 **ZONING CLASS :** R22MF
OWNER'S NAME : CLAPHAM BRADLEY LOUIS
MAILING ADDRESS : 14600 MAJESTIC OAK DR
CITY : CHARLOTTE **STATE :** NC **ZIP CODE :** 28278

PROPERTY LOCATION : 2629 WATSON DR
LEGAL DESC. : L59 &P58 M4-441 **DEED BK,PG & DATE :** 09525 /115 1998-02-27
ACREAGE : 1.000 **SALE PRICE :** \$0 **QUALIFIED SALE (Y/N) :** N
LAND VALUE : \$4,750 **IMPVMTS VALUE :** \$39,740 **TOTAL VALUE :** \$44,490

LAND-USE TYPE : SINGLE FAMILY **BUILDING TYPE :** DUPLEX/TRIPLEX
YEAR BUILT : 1,954 **SQUARE FEET :** 1,944 **STYLE CODE :** 1.0 STORY
BEDROOMS : 0 **BATHROOMS :** 2 **RESTROOMS :** 0 **BASEMENT :** N **GARAGE :** N
EXTERIOR TYPE : FACE BRICK **QUALITY GRADE :** 2 **IMPVMT. VALUE :** \$39,130
A/C : NONE **FIREPLACE :** NONE

Record No.: 17 **BUILDING KEY NUMBER :** 11702316 001
PARCEL-ID : 11702316 **NEIGHBORHOOD CODE :** 11701 **ZONING CLASS :** R22MF
OWNER'S NAME : MORELAND MARGARET T BY WILL
MAILING ADDRESS : 1801 PATTON AVE
CITY : CHARLOTTE **STATE :** NC **ZIP CODE :** 28216

PROPERTY LOCATION : 2637 WATSON DR
LEGAL DESC. : P18B1M4-549 2637 WATSON DR **DEED BK,PG & DATE :** 03664 /945 1974-07-25
ACREAGE : 0.000 **SALE PRICE :** \$0 **QUALIFIED SALE (Y/N) :** N
LAND VALUE : \$3,650 **IMPVMTS VALUE :** \$29,620 **TOTAL VALUE :** \$33,270

LAND-USE TYPE : SINGLE FAMILY **BUILDING TYPE :** DUPLEX/TRIPLEX
YEAR BUILT : 1,952 **SQUARE FEET :** 1,600 **STYLE CODE :** 1.0 STORY
BEDROOMS : 0 **BATHROOMS :** 2 **RESTROOMS :** 0 **BASEMENT :** N **GARAGE :** N
EXTERIOR TYPE : FACE BRICK **QUALITY GRADE :** 2 **IMPVMT. VALUE :** \$29,620
A/C : NONE **FIREPLACE :** NONE

Record No.: 18 **BUILDING KEY NUMBER :** 11702317 001
PARCEL-ID : 11702317 **NEIGHBORHOOD CODE :** 11701 **ZONING CLASS :** R22MF
OWNER'S NAME : GRIER EARL M
MAILING ADDRESS : 1429 MORETZ AV
CITY : CHARLOTTE **STATE :** NC **ZIP CODE :** 28206

PROPERTY LOCATION : 2701 WATSON DR
LEGAL DESC. : L17 &P18 B1 M4-549 **DEED BK,PG & DATE :** 12042 /679 2001-03-23
ACREAGE : 0.000 **SALE PRICE :** \$50,000 **QUALIFIED SALE (Y/N) :** Y
LAND VALUE : \$3,570 **IMPVMTS VALUE :** \$30,840 **TOTAL VALUE :** \$34,410

LAND-USE TYPE : SINGLE FAMILY **BUILDING TYPE :** DUPLEX/TRIPLEX
YEAR BUILT : 1,952 **SQUARE FEET :** 1,500 **STYLE CODE :** 1.0 STORY
BEDROOMS : 0 **BATHROOMS :** 2 **RESTROOMS :** 0 **BASEMENT :** N **GARAGE :** N
EXTERIOR TYPE : FACE BRICK **QUALITY GRADE :** 2 **IMPVMT. VALUE :** \$30,840
A/C : CENTRAL **FIREPLACE :** NONE

NOTE: This data is prepared for the purposes of revaluation, assessing & determining ownership of real property & is compiled from recorded deeds, plats, tax maps & other public records & data. Users of this data are hereby notified that the aforementioned public information sources should be consulted for verification. Mecklenburg County assumes no legal responsibility for the information herein.



MECKLENBURG COUNTY, NC
GIS PUBLIC ACCESS SYSTEM REPORT

DATE PRINTED 12/21/01

Note : Records are sorted in Parcel Number order.

PAGE : 7

Record No.: 19 **BUILDING KEY NUMBER :** 11702318 001
PARCEL-ID : 11702318 **NEIGHBORHOOD CODE :** 11701 **ZONING CLASS :** R22MF
OWNER'S NAME : MORELAND MARGARET T **BY WILL**
MAILING ADDRESS : 1801 PATTON AVE
CITY : CHARLOTTE **STATE :** NC **ZIP CODE :** 28216

PROPERTY LOCATION : 2709 WATSON DR
LEGAL DESC. : L16 B1 M4 549 2709 WATSON SR **DEED BK,PG & DATE :** 03664 /945 1974-07-25
ACREAGE : 0.000 **SALE PRICE :** \$0 **QUALIFIED SALE (Y/N) :** N
LAND VALUE : \$3,240 **IMPVMTS VALUE :** \$29,040 **TOTAL VALUE :** \$32,280

LAND-USE TYPE : SINGLE FAMILY **BUILDING TYPE :** DUPLEX/TRIPLEX
YEAR BUILT : 1,952 **SQUARE FEET :** 1,615 **STYLE CODE :** 1.0 STORY
BEDROOMS : 0 **BATHROOMS :** 2 **RESTROOMS :** 0 **BASEMENT :** N **GARAGE :** N
EXTERIOR TYPE : FACE BRICK **QUALITY GRADE :** 2 **IMPVMT. VALUE :** \$29,040
A/C : NONE **FIREPLACE :** NONE

Record No.: 20 **BUILDING KEY NUMBER :** 11702319 001
PARCEL-ID : 11702319 **NEIGHBORHOOD CODE :** 11701 **ZONING CLASS :** R22MF
OWNER'S NAME : JOHNSON CAROLYN W & NEFERTARI NICOLE BENTON
MAILING ADDRESS : 2715 WATSON DR # 17
CITY : CHARLOTTE **STATE :** NC **ZIP CODE :** 282086255

PROPERTY LOCATION : 2715 WATSON DR
LEGAL DESC. : L15 B1 M4-549 **DEED BK,PG & DATE :** 09967 /848 1998-10-09
ACREAGE : 0.000 **SALE PRICE :** \$0 **QUALIFIED SALE (Y/N) :** N
LAND VALUE : \$3,080 **IMPVMTS VALUE :** \$29,490 **TOTAL VALUE :** \$32,570

LAND-USE TYPE : SINGLE FAMILY **BUILDING TYPE :** DUPLEX/TRIPLEX
YEAR BUILT : 1,952 **SQUARE FEET :** 1,480 **STYLE CODE :** 1.0 STORY
BEDROOMS : 0 **BATHROOMS :** 2 **RESTROOMS :** 0 **BASEMENT :** N **GARAGE :** N
EXTERIOR TYPE : FACE BRICK **QUALITY GRADE :** 2 **IMPVMT. VALUE :** \$29,490
A/C : NONE **FIREPLACE :** NONE

Record No.: 21 **BUILDING KEY NUMBER :** 11702320 001
PARCEL-ID : 11702320 **NEIGHBORHOOD CODE :** 11701 **ZONING CLASS :** R22MF
OWNER'S NAME : BYNUM RALEIGH W & WF THELMEIA A
MAILING ADDRESS : 6426 HEATHERBROOK AVE
CITY : CHARLOTTE **STATE :** NC **ZIP CODE :** 28213

PROPERTY LOCATION : 2721 WATSON DR
LEGAL DESC. : L14B1M4 549 2721 WATSON DR **DEED BK,PG & DATE :** 03897 /133 1976-11-18
ACREAGE : 0.000 **SALE PRICE :** \$0 **QUALIFIED SALE (Y/N) :** N
LAND VALUE : \$3,020 **IMPVMTS VALUE :** \$0 **TOTAL VALUE :** \$3,020

LAND-USE TYPE : VACANT **BUILDING TYPE :** SINGLE FAMILY RESIDENTIAL
YEAR BUILT : 0 **SQUARE FEET :** 0 **STYLE CODE :**
BEDROOMS : 0 **BATHROOMS :** 0 **RESTROOMS :** 0 **BASEMENT :** N **GARAGE :** N
EXTERIOR TYPE : **QUALITY GRADE :** 0 **IMPVMT. VALUE :** \$0
A/C : **FIREPLACE :**

NOTE: This data is prepared for the purposes of revaluation, assessing & determining ownership of real property & is compiled from recorded deeds, plats, tax maps & other public records & data. Users of this data are hereby notified that the aforementioned public information sources should be consulted for verification. Mecklenburg County assumes no legal responsibility for the information herein.



MECKLENBURG COUNTY, NC
GIS PUBLIC ACCESS SYSTEM REPORT

DATE PRINTED 12/21/01

Note : Records are sorted in Parcel Number order.

PAGE : 8

Record No.: 22 **BUILDING KEY NUMBER :** 11702321 001
PARCEL-ID : 11702321 **NEIGHBORHOOD CODE :** 11701 **ZONING CLASS :** R22MF
OWNER'S NAME : MORELAND MARGARET T **BY WILL**
MAILING ADDRESS : 1801 PATTON AVE
CITY : CHARLOTTE **STATE :** NC **ZIP CODE :** 28216

PROPERTY LOCATION : 2727 WATSON DR
LEGAL DESC. : L13 B1 M4 549 2727 WATSON DR **DEED BK,PG & DATE :** 03664 /945 1974-07-25
ACREAGE : 0.000 **SALE PRICE :** \$0 **QUALIFIED SALE (Y/N) :** N
LAND VALUE : \$2,780 **IMPVMTS VALUE :** \$27,560 **TOTAL VALUE :** \$30,340

LAND-USE TYPE : SINGLE FAMILY **BUILDING TYPE :** DUPLEX/TRIPLEX
YEAR BUILT : 1,952 **SQUARE FEET :** 1,480 **STYLE CODE :** 1.0 STORY
BEDROOMS : 0 **BATHROOMS :** 2 **RESTROOMS :** 0 **BASEMENT :** N **GARAGE :** N
EXTERIOR TYPE : FACE BRICK **QUALITY GRADE :** 2 **IMPVMT. VALUE :** \$27,560
A/C : NONE **FIREPLACE :** NONE

Record No.: 23 **BUILDING KEY NUMBER :** 11702322 001
PARCEL-ID : 11702322 **NEIGHBORHOOD CODE :** 11701 **ZONING CLASS :** O2
OWNER'S NAME : LUNN ROBERT **&WF NOVELLA**
MAILING ADDRESS : 3619 DAVIDSON HWY
CITY : CONCORD **STATE :** NC **ZIP CODE :** 28027

PROPERTY LOCATION : 2741 WATSON DR
LEGAL DESC. : L11 & 12 B1 M4-549 **DEED BK,PG & DATE :** 08021 /648 1995-01-04
ACREAGE : 1.000 **SALE PRICE :** \$55,000 **QUALIFIED SALE (Y/N) :** Y
LAND VALUE : \$6,010 **IMPVMTS VALUE :** \$54,890 **TOTAL VALUE :** \$60,900

LAND-USE TYPE : APARTMENT **BUILDING TYPE :** GARDEN APARTMENT
YEAR BUILT : 1,962 **SQUARE FEET :** 3,126 **STYLE CODE :** 1.0 STORY
BEDROOMS : 0 **BATHROOMS :** 0 **RESTROOMS :** 0 **BASEMENT :** N **GARAGE :** N
EXTERIOR TYPE : FACE BRICK **QUALITY GRADE :** 2 **IMPVMT. VALUE :** \$54,890
A/C : NONE **FIREPLACE :** NONE

Record No.: 24 **BUILDING KEY NUMBER :** 11902101 001
PARCEL-ID : 11902101 **NEIGHBORHOOD CODE :** 11901 **ZONING CLASS :** R4
OWNER'S NAME : LEMMOND MICHAEL H **&WF BRENDA P**
MAILING ADDRESS : PO BOX 18465
CITY : CHARLOTTE **STATE :** NC **ZIP CODE :** 28218

PROPERTY LOCATION : 1416 KIMBERLY RC
LEGAL DESC. : L1 B6 M6-305 1416 KIMBERLY RD **DEED BK,PG & DATE :** 05736 /289 1988-04-11
ACREAGE : 0.000 **SALE PRICE :** \$0 **QUALIFIED SALE (Y/N) :** N
LAND VALUE : \$8,000 **IMPVMTS VALUE :** \$36,680 **TOTAL VALUE :** \$44,680

LAND-USE TYPE : SINGLE FAMILY **BUILDING TYPE :** SINGLE FAMILY RESIDENTIAL
YEAR BUILT : 1,948 **SQUARE FEET :** 930 **STYLE CODE :** 1.0 STORY
BEDROOMS : 2 **BATHROOMS :** 1 **RESTROOMS :** 0 **BASEMENT :** N **GARAGE :** N
EXTERIOR TYPE : ASBESTOS SHINGLE **QUALITY GRADE :** 2 **IMPVMT. VALUE :** \$36,620
A/C : CENTRAL **FIREPLACE :** 1 STY SINGLE

NOTE: This data is prepared for the purposes of revaluation, assessing & determining ownership of real property & is compiled from recorded deeds, plats, tax maps & other public records & data. Users of this data are hereby notified that the aforementioned public information sources should be consulted for verification. Mecklenburg County assumes no legal responsibility for the information herein.



MECKLENBURG COUNTY, NC

GIS PUBLIC ACCESS SYSTEM REPORT

DATE PRINTED 12/21/01

Note : Records are sorted in Parcel Number order.

PAGE : 9

Record No.: 25 **BUILDING KEY NUMBER :** 11902102 001
PARCEL-ID : 11902102 **NEIGHBORHOOD CODE :** 11901 **ZONING CLASS :** R4
OWNER'S NAME : LIVINGSTON CLARENCE &WF MAY BELLE
MAILING ADDRESS : 1420 KIMBERLY RD
CITY : CHARLOTTE **STATE :** NC **ZIP CODE :** 28208

PROPERTY LOCATION : 1420 KIMBERLY RC
LEGAL DESC. : L2 B6 M6 305 1420 KIMBERLY RD **DEED BK,PG & DATE :** 03976 /618 1977-08-15
ACREAGE : 0.000 **SALE PRICE :** \$0 **QUALIFIED SALE (Y/N) :** N
LAND VALUE : \$8,000 **IMPVMTS VALUE :** \$38,770 **TOTAL VALUE :** \$46,770

LAND-USE TYPE : SINGLE FAMILY **BUILDING TYPE :** SINGLE FAMILY RESIDENTIAL
YEAR BUILT : 1,948 **SQUARE FEET :** 928 **STYLE CODE :** 1.0 STORY
BEDROOMS : 2 **BATHROOMS :** 1 **RESTROOMS :** 0 **BASEMENT :** N **GARAGE :** N
EXTERIOR TYPE : MASONITE ON SHEATHING **QUALITY GRADE :** 2 **IMPVMT. VALUE :** \$37,380
A/C : CENTRAL **FIREPLACE :** 1 STY SINGLE

Record No.: 26 **BUILDING KEY NUMBER :** 11902103 001
PARCEL-ID : 11902103 **NEIGHBORHOOD CODE :** 11901 **ZONING CLASS :** R4
OWNER'S NAME : HUNTLEY JAMES M &WF GLORIA M
MAILING ADDRESS : 1424 KIMBERLY RD
CITY : CHARLOTTE **STATE :** NC **ZIP CODE :** 28208

PROPERTY LOCATION : 1424 KIMBERLY RC
LEGAL DESC. : L3 B6 M6-305 **DEED BK,PG & DATE :** 08814 /039 1996-11-08
ACREAGE : 0.000 **SALE PRICE :** \$42,000 **QUALIFIED SALE (Y/N) :** Y
LAND VALUE : \$8,000 **IMPVMTS VALUE :** \$38,420 **TOTAL VALUE :** \$46,420

LAND-USE TYPE : SINGLE FAMILY **BUILDING TYPE :** SINGLE FAMILY RESIDENTIAL
YEAR BUILT : 1,948 **SQUARE FEET :** 870 **STYLE CODE :** 1.0 STORY
BEDROOMS : 2 **BATHROOMS :** 1 **RESTROOMS :** 0 **BASEMENT :** N **GARAGE :** N
EXTERIOR TYPE : FACE BRICK **QUALITY GRADE :** 2 **IMPVMT. VALUE :** \$35,120
A/C : NONE **FIREPLACE :** 1 STY SINGLE

Record No.: 27 **BUILDING KEY NUMBER :** 11902104 001
PARCEL-ID : 11902104 **NEIGHBORHOOD CODE :** 11901 **ZONING CLASS :** R4
OWNER'S NAME : LAMONS LAKESHA ANN
MAILING ADDRESS : 1428 KIMBERLY RD
CITY : CHARLOTTE **STATE :** NC **ZIP CODE :** 28208

PROPERTY LOCATION : 1428 KIMBERLY RC
LEGAL DESC. : L4 B6 M6-305 **DEED BK,PG & DATE :** 10070 /510 1998-11-25
ACREAGE : 0.000 **SALE PRICE :** \$45,000 **QUALIFIED SALE (Y/N) :** Y
LAND VALUE : \$8,000 **IMPVMTS VALUE :** \$33,950 **TOTAL VALUE :** \$41,950

LAND-USE TYPE : SINGLE FAMILY **BUILDING TYPE :** SINGLE FAMILY RESIDENTIAL
YEAR BUILT : 1,948 **SQUARE FEET :** 870 **STYLE CODE :** 1.0 STORY
BEDROOMS : 2 **BATHROOMS :** 1 **RESTROOMS :** 0 **BASEMENT :** N **GARAGE :** N
EXTERIOR TYPE : ASBESTOS SHINGLE **QUALITY GRADE :** 2 **IMPVMT. VALUE :** \$33,890
A/C : NONE **FIREPLACE :** 1 STY SINGLE

NOTE: This data is prepared for the purposes of revaluation, assessing & determining ownership of real property & is compiled from recorded deeds, plats, tax maps & other public records & data. Users of this data are hereby notified that the aforementioned public information sources should be consulted for verification. Mecklenburg County assumes no legal responsibility for the information herein.



MECKLENBURG COUNTY, NC
GIS PUBLIC ACCESS SYSTEM REPORT

DATE PRINTED 12/21/01

Note : Records are sorted in Parcel Number order.

PAGE : 10

Record No.: 28 **BUILDING KEY NUMBER :** 11902105 001
PARCEL-ID : 11902105 **NEIGHBORHOOD CODE :** 11901 **ZONING CLASS :** R4
OWNER'S NAME : STIKELEATHER RICHARD W
MAILING ADDRESS : 2824 THE PLZ
CITY : CHARLOTTE **STATE :** NC **ZIP CODE :** 282052414

PROPERTY LOCATION : 1432 KIMBERLY RC
LEGAL DESC. : L5 B6 M6-305 **DEED BK,PG & DATE :** 08044 /419 1995-01-31
ACREAGE : 0.000 **SALE PRICE :** \$14,500 **QUALIFIED SALE (Y/N) :** N
LAND VALUE : \$8,000 **IMPVMTS VALUE :** \$34,210 **TOTAL VALUE :** \$42,210

LAND-USE TYPE : SINGLE FAMILY **BUILDING TYPE :** SINGLE FAMILY RESIDENTIAL
YEAR BUILT : 1,948 **SQUARE FEET :** 1,087 **STYLE CODE :** 1.0 STORY
BEDROOMS : 3 **BATHROOMS :** 1 **RESTROOMS :** 0 **BASEMENT :** N **GARAGE :** N
EXTERIOR TYPE : ALUMINUM/VINYL SIDING **QUALITY GRADE :** 2 **IMPVMT. VALUE :** \$34,160
A/C : NONE **FIREPLACE :** 1 STY SINGLE

Record No.: 29 **BUILDING KEY NUMBER :** 11902106 001
PARCEL-ID : 11902106 **NEIGHBORHOOD CODE :** 11901 **ZONING CLASS :** R4
OWNER'S NAME : HAWKINS MATTHEW T
MAILING ADDRESS : 4632 LAKESHORE RD NORTH
CITY : DENVER **STATE :** NC **ZIP CODE :** 28037

PROPERTY LOCATION : 1436 KIMBERLY RC
LEGAL DESC. : L6 B6 M6-305 **DEED BK,PG & DATE :** 10382 /327 1999-04-07
ACREAGE : 0.000 **SALE PRICE :** \$39,000 **QUALIFIED SALE (Y/N) :** Y
LAND VALUE : \$8,000 **IMPVMTS VALUE :** \$33,760 **TOTAL VALUE :** \$41,760

LAND-USE TYPE : SINGLE FAMILY **BUILDING TYPE :** SINGLE FAMILY RESIDENTIAL
YEAR BUILT : 1,948 **SQUARE FEET :** 870 **STYLE CODE :** 1.0 STORY
BEDROOMS : 2 **BATHROOMS :** 1 **RESTROOMS :** 0 **BASEMENT :** N **GARAGE :** N
EXTERIOR TYPE : ALUMINUM/VINYL SIDING **QUALITY GRADE :** 2 **IMPVMT. VALUE :** \$33,710
A/C : NONE **FIREPLACE :** 1 STY SINGLE

Record No.: 30 **BUILDING KEY NUMBER :** 11902107 001
PARCEL-ID : 11902107 **NEIGHBORHOOD CODE :** 11901 **ZONING CLASS :** R4
OWNER'S NAME : BENNETT LITTLE JOHN & LEROY & WILLIAM BENNETT
MAILING ADDRESS : 1500 KIMBERLY RD
CITY : CHARLOTTE **STATE :** NC **ZIP CODE :** 28208

PROPERTY LOCATION : 1500 KIMBERLY RC
LEGAL DESC. : L7 B6 M6-305 **DEED BK,PG & DATE :** 08289 /377 1995-09-14
ACREAGE : 0.000 **SALE PRICE :** \$0 **QUALIFIED SALE (Y/N) :** N
LAND VALUE : \$8,000 **IMPVMTS VALUE :** \$38,290 **TOTAL VALUE :** \$46,290

LAND-USE TYPE : SINGLE FAMILY **BUILDING TYPE :** SINGLE FAMILY RESIDENTIAL
YEAR BUILT : 1,948 **SQUARE FEET :** 928 **STYLE CODE :** 1.0 STORY
BEDROOMS : 2 **BATHROOMS :** 1 **RESTROOMS :** 0 **BASEMENT :** N **GARAGE :** N
EXTERIOR TYPE : FACE BRICK **QUALITY GRADE :** 2 **IMPVMT. VALUE :** \$36,370
A/C : NONE **FIREPLACE :** 1 STY SINGLE

NOTE: This data is prepared for the purposes of revaluation, assessing & determining ownership of real property & is compiled from recorded deeds, plats, tax maps & other public records & data. Users of this data are hereby notified that the aforementioned public information sources should be consulted for verification. Mecklenburg County assumes no legal responsibility for the information herein.



MECKLENBURG COUNTY, NC
GIS PUBLIC ACCESS SYSTEM REPORT

DATE PRINTED 12/21/01

Note : Records are sorted in Parcel Number order.

PAGE : 11

Record No.:	31	BUILDING KEY NUMBER :	11902108 001
PARCEL-ID :	11902108	NEIGHBORHOOD CODE :	11901
OWNER'S NAME :	CRAWFORD LABORN L	ZONING CLASS :	R4
MAILING ADDRESS :	1504 KIMBERLY RD		&WF HELEN R
CITY :	CHARLOTTE	STATE :	NC
		ZIP CODE :	28208
PROPERTY LOCATION :	1504 KIMBERLY		RC
LEGAL DESC. :	L8 B6 M6-305	DEED BK,PG & DATE :	08938 /924 1997-02-21
ACREAGE :	0.000	SALE PRICE :	\$49,000
		QUALIFIED SALE (Y/N) :	N
LAND VALUE :	\$8,000	IMPVMTS VALUE :	\$37,530
		TOTAL VALUE :	\$45,530
LAND-USE TYPE :	SINGLE FAMILY	BUILDING TYPE :	SINGLE FAMILY RESIDENTIAL
YEAR BUILT :	1,948	SQUARE FEET :	1,047
		STYLE CODE :	1.0 STORY
BEDROOMS :	3	BATHROOMS :	1
		RESTROOMS :	0
		BASEMENT :	N
		GARAGE :	N
EXTERIOR TYPE :	ASBESTOS SHINGLE	QUALITY GRADE :	2
		IMPVMT. VALUE :	\$37,290
A/C :	CENTRAL	FIREPLACE :	1 STY SINGLE
Record No.:	32	BUILDING KEY NUMBER :	11902109 001
PARCEL-ID :	11902109	NEIGHBORHOOD CODE :	11901
OWNER'S NAME :	STITT ROBERT J & WF	ZONING CLASS :	R4
MAILING ADDRESS :	1508 KIMBERLY RD		ODESSA R
CITY :	CHARLOTTE	STATE :	NC
		ZIP CODE :	28208
PROPERTY LOCATION :	1508 KIMBERLY		RC
LEGAL DESC. :	L9 B6 M6 305 1508 KIMBERLY RD	DEED BK,PG & DATE :	03172 /091 1970-12-01
ACREAGE :	0.000	SALE PRICE :	\$0
		QUALIFIED SALE (Y/N) :	N
LAND VALUE :	\$8,000	IMPVMTS VALUE :	\$33,810
		TOTAL VALUE :	\$41,810
LAND-USE TYPE :	SINGLE FAMILY	BUILDING TYPE :	SINGLE FAMILY RESIDENTIAL
YEAR BUILT :	1,948	SQUARE FEET :	936
		STYLE CODE :	1.0 STORY
BEDROOMS :	2	BATHROOMS :	1
		RESTROOMS :	0
		BASEMENT :	N
		GARAGE :	N
EXTERIOR TYPE :	ASBESTOS SHINGLE	QUALITY GRADE :	2
		IMPVMT. VALUE :	\$33,690
A/C :	NONE	FIREPLACE :	1 STY SINGLE
Record No.:	33	BUILDING KEY NUMBER :	11902110 001
PARCEL-ID :	11902110	NEIGHBORHOOD CODE :	11901
OWNER'S NAME :	SIMPSON JAMES T & WF	ZONING CLASS :	R4
MAILING ADDRESS :	1512 KIMBERLY RD		DORIS W
CITY :	CHARLOTTE	STATE :	NC
		ZIP CODE :	28208
PROPERTY LOCATION :	1512 KIMBERLY		RC
LEGAL DESC. :	L10 B6 M6 305 1512 KIMBERLY RD	DEED BK,PG & DATE :	03988 /954 1977-09-28
ACREAGE :	0.000	SALE PRICE :	\$0
		QUALIFIED SALE (Y/N) :	N
LAND VALUE :	\$8,000	IMPVMTS VALUE :	\$37,210
		TOTAL VALUE :	\$45,210
LAND-USE TYPE :	SINGLE FAMILY	BUILDING TYPE :	SINGLE FAMILY RESIDENTIAL
YEAR BUILT :	1,948	SQUARE FEET :	995
		STYLE CODE :	1.0 STORY
BEDROOMS :	2	BATHROOMS :	1
		RESTROOMS :	0
		BASEMENT :	N
		GARAGE :	N
EXTERIOR TYPE :	FACE BRICK	QUALITY GRADE :	2
		IMPVMT. VALUE :	\$37,090
A/C :	NONE	FIREPLACE :	1 STY SINGLE



MECKLENBURG COUNTY, NC
GIS PUBLIC ACCESS SYSTEM REPORT

DATE PRINTED 12/21/01

Note : Records are sorted in Parcel Number order.

PAGE : 12

Record No.: 34 **BUILDING KEY NUMBER :** 11902111 001
PARCEL-ID : 11902111 **NEIGHBORHOOD CODE :** 11901 **ZONING CLASS :** R4
OWNER'S NAME : EAGLE JOHN S &WF BESSIE BROWN
MAILING ADDRESS : 1516 KIMBERLY RD
CITY : CHARLOTTE **STATE :** NC **ZIP CODE :** 28208

PROPERTY LOCATION : 1516 KIMBERLY RC
LEGAL DESC. : L11B6M6 305 1516 KIMBERLY RD **DEED BK,PG & DATE :** 04555 /091 1982-07-09
ACREAGE : 0.000 **SALE PRICE :** \$0 **QUALIFIED SALE (Y/N) :** N
LAND VALUE : \$8,000 **IMPVMTS VALUE :** \$53,800 **TOTAL VALUE :** \$61,800

LAND-USE TYPE : SINGLE FAMILY **BUILDING TYPE :** SINGLE FAMILY RESIDENTIAL
YEAR BUILT : 1,948 **SQUARE FEET :** 1,242 **STYLE CODE :** 2.0 STORIES
BEDROOMS : 3 **BATHROOMS :** 1 **RESTROOMS :** 0 **BASEMENT :** N **GARAGE :** N
EXTERIOR TYPE : MASONITE ON SHEATHING **QUALITY GRADE :** 2 **IMPVMT. VALUE :** \$53,800
A/C : NONE **FIREPLACE :** 1 STY SINGLE

Record No.: 35 **BUILDING KEY NUMBER :** 11902112 001
PARCEL-ID : 11902112 **NEIGHBORHOOD CODE :** 11901 **ZONING CLASS :** R4
OWNER'S NAME : PORTER WILLIE JAMES
MAILING ADDRESS : 3815 BLANDWOOD DR
CITY : CHARLOTTE **STATE :** NC **ZIP CODE :** 282171203

PROPERTY LOCATION : 1520 KIMBERLY RC
LEGAL DESC. : L12 B6 M6-305 **DEED BK,PG & DATE :** 08044 /150 1995-01-31
ACREAGE : 0.000 **SALE PRICE :** \$0 **QUALIFIED SALE (Y/N) :** N
LAND VALUE : \$8,000 **IMPVMTS VALUE :** \$40,260 **TOTAL VALUE :** \$48,260

LAND-USE TYPE : SINGLE FAMILY **BUILDING TYPE :** SINGLE FAMILY RESIDENTIAL
YEAR BUILT : 1,948 **SQUARE FEET :** 1,185 **STYLE CODE :** 1.0 STORY
BEDROOMS : 3 **BATHROOMS :** 1 **RESTROOMS :** 0 **BASEMENT :** N **GARAGE :** N
EXTERIOR TYPE : SIDING AVERAGE **QUALITY GRADE :** 2 **IMPVMT. VALUE :** \$40,160
A/C : CENTRAL **FIREPLACE :** 1 STY SINGLE

Record No.: 36 **BUILDING KEY NUMBER :** 11902113 001
PARCEL-ID : 11902113 **NEIGHBORHOOD CODE :** 11901 **ZONING CLASS :** R4
OWNER'S NAME : PETERSON LEROY &MARY PETERSON &JANE PETERSON
MAILING ADDRESS : 1524 KIMBERLY RD
CITY : CHARLOTTE **STATE :** NC **ZIP CODE :** 28208

PROPERTY LOCATION : 1524 KIMBERLY RC
LEGAL DESC. : L13 B6 M6 305 1524 KIMBERLY RD **DEED BK,PG & DATE :** 10359 /748 1999-03-30
ACREAGE : 0.000 **SALE PRICE :** \$0 **QUALIFIED SALE (Y/N) :** N
LAND VALUE : \$8,000 **IMPVMTS VALUE :** \$44,420 **TOTAL VALUE :** \$52,420

LAND-USE TYPE : SINGLE FAMILY **BUILDING TYPE :** SINGLE FAMILY RESIDENTIAL
YEAR BUILT : 1,948 **SQUARE FEET :** 1,224 **STYLE CODE :** 1.0 STORY
BEDROOMS : 2 **BATHROOMS :** 1 **RESTROOMS :** 0 **BASEMENT :** N **GARAGE :** N
EXTERIOR TYPE : FACE BRICK **QUALITY GRADE :** 2 **IMPVMT. VALUE :** \$42,490
A/C : CENTRAL **FIREPLACE :** 1 STY SINGLE

NOTE: This data is prepared for the purposes of revaluation, assessing & determining ownership of real property & is compiled from recorded deeds, plats, tax maps & other public records & data. Users of this data are hereby notified that the aforementioned public information sources should be consulted for verification. Mecklenburg County assumes no legal responsibility for the information herein.



MECKLENBURG COUNTY, NC
GIS PUBLIC ACCESS SYSTEM REPORT

DATE PRINTED 12/21/01

Note : Records are sorted in Parcel Number order.

PAGE : 13

Record No.:	37	BUILDING KEY NUMBER :	11902114 001
PARCEL-ID :	11902114	NEIGHBORHOOD CODE :	11901
OWNER'S NAME :	MOTLEY DAVID M	ZONING CLASS :	O2
MAILING ADDRESS :	2338 BARN BOARD LN		
CITY :	CHARLOTTE	STATE :	NC
		ZIP CODE :	28262
PROPERTY LOCATION :	1528	KIMBERLY	RE
LEGAL DESC. :	L14 B6 M6-305	DEED BK,PG & DATE :	08148 /070 1995-05-17
ACREAGE :	0.000	SALE PRICE :	\$0
		QUALIFIED SALE (Y/N) :	N
LAND VALUE :	\$12,890	IMPVMTS VALUE :	\$33,870
		TOTAL VALUE :	\$46,760
LAND-USE TYPE :	SINGLE FAMILY	BUILDING TYPE :	SINGLE FAMILY RESIDENTIAL
YEAR BUILT :	1,948	SQUARE FEET :	840
		STYLE CODE :	1.0 STORY
BEDROOMS :	2	BATHROOMS :	1
		RESTROOMS :	0
		BASEMENT :	N
		GARAGE :	N
EXTERIOR TYPE :	ALUMINUM/VINYL SIDING	QUALITY GRADE :	2
		IMPVMT. VALUE :	\$33,870
A/C :	CENTRAL	FIREPLACE :	1 STY SINGLE.
Record No.:	38	BUILDING KEY NUMBER :	11902115 001
PARCEL-ID :	11902115	NEIGHBORHOOD CODE :	11901
OWNER'S NAME :	CLAY JOHNNIE LEE	ZONING CLASS :	R4
MAILING ADDRESS :	925 BANNISTER PL		
CITY :	CHARLOTTE	STATE :	NC
		ZIP CODE :	28213
PROPERTY LOCATION :	1532	KIMBERLY	RE
LEGAL DESC. :	L15 B6 M6 305 1532 KIMBERLY RD	DEED BK,PG & DATE :	05086 /396 1985-09-12
ACREAGE :	0.000	SALE PRICE :	\$0
		QUALIFIED SALE (Y/N) :	N
LAND VALUE :	\$7,130	IMPVMTS VALUE :	\$31,830
		TOTAL VALUE :	\$38,960
LAND-USE TYPE :	SINGLE FAMILY	BUILDING TYPE :	SINGLE FAMILY RESIDENTIAL
YEAR BUILT :	1,948	SQUARE FEET :	915
		STYLE CODE :	1.0 STORY
BEDROOMS :	2	BATHROOMS :	1
		RESTROOMS :	0
		BASEMENT :	N
		GARAGE :	N
EXTERIOR TYPE :	CORRUGATED ASBESTOS	QUALITY GRADE :	2
		IMPVMT. VALUE :	\$31,770
A/C :	NONE	FIREPLACE :	1 STY SINGLE
Record No.:	39	BUILDING KEY NUMBER :	11902116 001
PARCEL-ID :	11902116	NEIGHBORHOOD CODE :	11901
OWNER'S NAME :	MARSH BETTY H	ZONING CLASS :	R4
MAILING ADDRESS :	PO BOX 35329		
CITY :	CHARLOTTE	STATE :	NC
		ZIP CODE :	28235
PROPERTY LOCATION :	2601	REMOUNT	RE
LEGAL DESC. :	L16 B6 M6-305 & STRIP	DEED BK,PG & DATE :	02299 /466 1975-01-01
ACREAGE :	0.000	SALE PRICE :	\$0
		QUALIFIED SALE (Y/N) :	N
LAND VALUE :	\$7,600	IMPVMTS VALUE :	\$0
		TOTAL VALUE :	\$7,600
LAND-USE TYPE :	VACANT	BUILDING TYPE :	OFFICE
YEAR BUILT :	0	SQUARE FEET :	0
		STYLE CODE :	
BEDROOMS :	0	BATHROOMS :	0
		RESTROOMS :	0
		BASEMENT :	N
		GARAGE :	N
EXTERIOR TYPE :		QUALITY GRADE :	0
		IMPVMT. VALUE :	\$0
A/C :		FIREPLACE :	

NOTE: This data is prepared for the purposes of revaluation, assessing & determining ownership of real property & is compiled from recorded deeds, plats, tax maps & other public records & data. Users of this data are hereby notified that the aforementioned public information sources should be consulted for verification. Mecklenburg County assumes no legal responsibility for the information herein.



MECKLENBURG COUNTY, NC
GIS PUBLIC ACCESS SYSTEM REPORT

DATE PRINTED 12/21/01

Note : Records are sorted in Parcel Number order.

PAGE : 14

Record No.: 40 **BUILDING KEY NUMBER :** 11902117 001
PARCEL-ID : 11902117 **NEIGHBORHOOD CODE :** 11901 **ZONING CLASS :** R22MF
OWNER'S NAME : REMOUNT PROPERTIES
MAILING ADDRESS : PO BOX 37288
CITY : CHARLOTTE **STATE :** NC **ZIP CODE :** 282377288
PROPERTY LOCATION : 1818 REMOUNT RC
LEGAL DESC. : N/A **DEED BK,PG & DATE :** 05552 /039 1987-07-10
ACREAGE : 6.000 **SALE PRICE :** \$0 **QUALIFIED SALE (Y/N) :** N
LAND VALUE : \$130,680 **IMPVMTS VALUE :** \$1,602,280 **TOTAL VALUE :** \$1,732,960

LAND-USE TYPE : APARTMENT **BUILDING TYPE :** GARDEN APARTMENT
YEAR BUILT : 1,969 **SQUARE FEET :** 6,786 **STYLE CODE :** 2.0 STORIES
BEDROOMS : 0 **BATHROOMS :** 0 **RESTROOMS :** 0 **BASEMENT :** N **GARAGE :** N
EXTERIOR TYPE : ALUMINUM/VINYL SIDING **QUALITY GRADE :** 2 **IMPVMT. VALUE :** \$114,390
A/C : CENTRAL **FIREPLACE :** NONE

Record No.: 41 **BUILDING KEY NUMBER :** 11902117 002
PARCEL-ID : 11902117 **NEIGHBORHOOD CODE :** 11901 **ZONING CLASS :** R22MF
OWNER'S NAME : REMOUNT PROPERTIES
MAILING ADDRESS : PO BOX 37288
CITY : CHARLOTTE **STATE :** NC **ZIP CODE :** 282377288
PROPERTY LOCATION : 1822 REMOUNT RD
LEGAL DESC. : N/A **DEED BK,PG & DATE :** 05552 /039 1987-07-10
ACREAGE : 6.000 **SALE PRICE :** \$0 **QUALIFIED SALE (Y/N) :** N
LAND VALUE : \$130,680 **IMPVMTS VALUE :** \$1,602,280 **TOTAL VALUE :** \$1,732,960

LAND-USE TYPE : APARTMENT **BUILDING TYPE :** GARDEN APARTMENT
YEAR BUILT : 1,969 **SQUARE FEET :** 8,004 **STYLE CODE :** 2.0 STORIES
BEDROOMS : 0 **BATHROOMS :** 0 **RESTROOMS :** 0 **BASEMENT :** N **GARAGE :** N
EXTERIOR TYPE : ALUMINUM/VINYL SIDING **QUALITY GRADE :** 2 **IMPVMT. VALUE :** \$130,210
A/C : CENTRAL **FIREPLACE :** NONE

Record No.: 42 **BUILDING KEY NUMBER :** 11902117 003
PARCEL-ID : 11902117 **NEIGHBORHOOD CODE :** 11901 **ZONING CLASS :** R22MF
OWNER'S NAME : REMOUNT PROPERTIES
MAILING ADDRESS : PO BOX 37288
CITY : CHARLOTTE **STATE :** NC **ZIP CODE :** 282377288
PROPERTY LOCATION : 1806 REMOUNT RD
LEGAL DESC. : N/A **DEED BK,PG & DATE :** 05552 /039 1987-07-10
ACREAGE : 6.000 **SALE PRICE :** \$0 **QUALIFIED SALE (Y/N) :** N
LAND VALUE : \$130,680 **IMPVMTS VALUE :** \$1,602,280 **TOTAL VALUE :** \$1,732,960

LAND-USE TYPE : APARTMENT **BUILDING TYPE :** GARDEN APARTMENT
YEAR BUILT : 1,969 **SQUARE FEET :** 8,004 **STYLE CODE :** 2.0 STORIES
BEDROOMS : 0 **BATHROOMS :** 0 **RESTROOMS :** 0 **BASEMENT :** N **GARAGE :** N
EXTERIOR TYPE : ALUMINUM/VINYL SIDING **QUALITY GRADE :** 2 **IMPVMT. VALUE :** \$130,210
A/C : CENTRAL **FIREPLACE :** NONE

NOTE: This data is prepared for the purposes of revaluation, assessing & determining ownership of real property & is compiled from recorded deeds, plats, tax maps & other public records & data. Users of this data are hereby notified that the aforementioned public information sources should be consulted for verification. Mecklenburg County assumes no legal responsibility for the information herein.



MECKLENBURG COUNTY, NC
GIS PUBLIC ACCESS SYSTEM REPORT

DATE PRINTED 12/21/01

Note : Records are sorted in Parcel Number order.

PAGE : 15

Record No.: 43 **BUILDING KEY NUMBER :** 11902117 004
PARCEL-ID : 11902117 **NEIGHBORHOOD CODE :** 11901 **ZONING CLASS :** R22MF
OWNER'S NAME : REMOUNT PROPERTIES
MAILING ADDRESS : PO BOX 37288
CITY : CHARLOTTE **STATE :** NC **ZIP CODE :** 282377288

PROPERTY LOCATION : 1814 REMOUNT RD
LEGAL DESC. : N/A **DEED BK,PG & DATE :** 05552 /039 1987-07-10
ACREAGE : 6.000 **SALE PRICE :** \$0 **QUALIFIED SALE (Y/N) :** N
LAND VALUE : \$130,680 **IMPVMTS VALUE :** \$1,602,280 **TOTAL VALUE :** \$1,732,960

LAND-USE TYPE : APARTMENT **BUILDING TYPE :** GARDEN APARTMENT
YEAR BUILT : 1,969 **SQUARE FEET :** 8,004 **STYLE CODE :** 2.0 STORIES
BEDROOMS : 0 **BATHROOMS :** 0 **RESTROOMS :** 0 **BASEMENT :** N **GARAGE :** N
EXTERIOR TYPE : ALUMINUM/VINYL SIDING **QUALITY GRADE :** 2 **IMPVMT. VALUE :** \$130,210
A/C : CENTRAL **FIREPLACE :** NONE

Record No.: 44 **BUILDING KEY NUMBER :** 11902117 005
PARCEL-ID : 11902117 **NEIGHBORHOOD CODE :** 11901 **ZONING CLASS :** R22MF
OWNER'S NAME : REMOUNT PROPERTIES
MAILING ADDRESS : PO BOX 37288
CITY : CHARLOTTE **STATE :** NC **ZIP CODE :** 282377288

PROPERTY LOCATION : 1507 PARKER DR
LEGAL DESC. : N/A **DEED BK,PG & DATE :** 05552 /039 1987-07-10
ACREAGE : 6.000 **SALE PRICE :** \$0 **QUALIFIED SALE (Y/N) :** N
LAND VALUE : \$130,680 **IMPVMTS VALUE :** \$1,602,280 **TOTAL VALUE :** \$1,732,960

LAND-USE TYPE : APARTMENT **BUILDING TYPE :** GARDEN APARTMENT
YEAR BUILT : 1,969 **SQUARE FEET :** 8,004 **STYLE CODE :** 2.0 STORIES
BEDROOMS : 0 **BATHROOMS :** 0 **RESTROOMS :** 0 **BASEMENT :** N **GARAGE :** N
EXTERIOR TYPE : UTILITY BRICK **QUALITY GRADE :** 2 **IMPVMT. VALUE :** \$130,210
A/C : CENTRAL **FIREPLACE :** NONE

Record No.: 45 **BUILDING KEY NUMBER :** 11902117 006
PARCEL-ID : 11902117 **NEIGHBORHOOD CODE :** 11901 **ZONING CLASS :** R22MF
OWNER'S NAME : REMOUNT PROPERTIES
MAILING ADDRESS : PO BOX 37288
CITY : CHARLOTTE **STATE :** NC **ZIP CODE :** 282377288

PROPERTY LOCATION : 1810 REMOUNT RD
LEGAL DESC. : N/A **DEED BK,PG & DATE :** 05552 /039 1987-07-10
ACREAGE : 6.000 **SALE PRICE :** \$0 **QUALIFIED SALE (Y/N) :** N
LAND VALUE : \$130,680 **IMPVMTS VALUE :** \$1,602,280 **TOTAL VALUE :** \$1,732,960

LAND-USE TYPE : APARTMENT **BUILDING TYPE :** GARDEN APARTMENT
YEAR BUILT : 1,969 **SQUARE FEET :** 4,524 **STYLE CODE :** 2.0 STORIES
BEDROOMS : 0 **BATHROOMS :** 0 **RESTROOMS :** 0 **BASEMENT :** N **GARAGE :** N
EXTERIOR TYPE : ALUMINUM/VINYL SIDING **QUALITY GRADE :** 2 **IMPVMT. VALUE :** \$72,710
A/C : CENTRAL **FIREPLACE :** NONE

NOTE: This data is prepared for the purposes of revaluation, assessing & determining ownership of real property & is compiled from recorded deeds, plats, tax maps & other public records & data. Users of this data are hereby notified that the aforementioned public information sources should be consulted for verification. Mecklenburg County assumes no legal responsibility for the information herein.



MECKLENBURG COUNTY, NC
GIS PUBLIC ACCESS SYSTEM REPORT

DATE PRINTED 12/21/01

Note : Records are sorted in Parcel Number order.

PAGE : 16

Record No.: 46 **BUILDING KEY NUMBER :** 11902117 007
PARCEL-ID : 11902117 **NEIGHBORHOOD CODE :** 11901 **ZONING CLASS :** R22MF
OWNER'S NAME : REMOUNT PROPERTIES
MAILING ADDRESS : PO BOX 37288
CITY : CHARLOTTE **STATE :** NC **ZIP CODE :** 282377288
PROPERTY LOCATION : 1816 REMOUNT RD
LEGAL DESC. : N/A **DEED BK,PG & DATE :** 05552 /039 1987-07-10
ACREAGE : 6.000 **SALE PRICE :** \$0 **QUALIFIED SALE (Y/N) :** N
LAND VALUE : \$130,680 **IMPVMTS VALUE :** \$1,602,280 **TOTAL VALUE :** \$1,732,960

LAND-USE TYPE : APARTMENT **BUILDING TYPE :** GARDEN APARTMENT
YEAR BUILT : 1,969 **SQUARE FEET :** 4,524 **STYLE CODE :** 2.0 STORIES
BEDROOMS : 0 **BATHROOMS :** 0 **RESTROOMS :** 0 **BASEMENT :** N **GARAGE :** N
EXTERIOR TYPE : ALUMINUM/VINYL SIDING **QUALITY GRADE :** 2 **IMPVMT. VALUE :** \$72,710
A/C : CENTRAL **FIREPLACE :** NONE

Record No.: 47 **BUILDING KEY NUMBER :** 11902117 008
PARCEL-ID : 11902117 **NEIGHBORHOOD CODE :** 11901 **ZONING CLASS :** R22MF
OWNER'S NAME : REMOUNT PROPERTIES
MAILING ADDRESS : PO BOX 37288
CITY : CHARLOTTE **STATE :** NC **ZIP CODE :** 282377288
PROPERTY LOCATION : 1515 PARKER DR
LEGAL DESC. : N/A **DEED BK,PG & DATE :** 05552 /039 1987-07-10
ACREAGE : 6.000 **SALE PRICE :** \$0 **QUALIFIED SALE (Y/N) :** N
LAND VALUE : \$130,680 **IMPVMTS VALUE :** \$1,602,280 **TOTAL VALUE :** \$1,732,960

LAND-USE TYPE : APARTMENT **BUILDING TYPE :** GARDEN APARTMENT
YEAR BUILT : 1,969 **SQUARE FEET :** 4,524 **STYLE CODE :** 2.0 STORIES
BEDROOMS : 0 **BATHROOMS :** 0 **RESTROOMS :** 0 **BASEMENT :** N **GARAGE :** N
EXTERIOR TYPE : ALUMINUM/VINYL SIDING **QUALITY GRADE :** 2 **IMPVMT. VALUE :** \$72,710
A/C : CENTRAL **FIREPLACE :** NONE

Record No.: 48 **BUILDING KEY NUMBER :** 11902117 009
PARCEL-ID : 11902117 **NEIGHBORHOOD CODE :** 11901 **ZONING CLASS :** R22MF
OWNER'S NAME : REMOUNT PROPERTIES
MAILING ADDRESS : PO BOX 37288
CITY : CHARLOTTE **STATE :** NC **ZIP CODE :** 282377288
PROPERTY LOCATION : 1818 REMOUNT RD
LEGAL DESC. : N/A **DEED BK,PG & DATE :** 05552 /039 1987-07-10
ACREAGE : 6.000 **SALE PRICE :** \$0 **QUALIFIED SALE (Y/N) :** N
LAND VALUE : \$130,680 **IMPVMTS VALUE :** \$1,602,280 **TOTAL VALUE :** \$1,732,960

LAND-USE TYPE : APARTMENT **BUILDING TYPE :** GARDEN APARTMENT
YEAR BUILT : 1,969 **SQUARE FEET :** 8,410 **STYLE CODE :** 2.0 STORIES
BEDROOMS : 0 **BATHROOMS :** 0 **RESTROOMS :** 0 **BASEMENT :** N **GARAGE :** N
EXTERIOR TYPE : ALUMINUM/VINYL SIDING **QUALITY GRADE :** 2 **IMPVMT. VALUE :** \$141,760
A/C : CENTRAL **FIREPLACE :** NONE

NOTE: This data is prepared for the purposes of revaluation, assessing & determining ownership of real property & is compiled from recorded deeds, plats, tax maps & other public records & data. Users of this data are hereby notified that the aforementioned public information sources should be consulted for verification. Mecklenburg County assumes no legal responsibility for the information herein.



MECKLENBURG COUNTY, NC
GIS PUBLIC ACCESS SYSTEM REPORT

DATE PRINTED 12/21/01

Note : Records are sorted in Parcel Number order.

PAGE : 17

Record No.: 49 **BUILDING KEY NUMBER :** 11902117 010
PARCEL-ID : 11902117 **NEIGHBORHOOD CODE :** 11901 **ZONING CLASS :** R22MF
OWNER'S NAME : REMOUNT PROPERTIES
MAILING ADDRESS : PO BOX 37288
CITY : CHARLOTTE **STATE :** NC **ZIP CODE :** 282377288
PROPERTY LOCATION : 1826 REMOUNT RD
LEGAL DESC. : N/A **DEED BK,PG & DATE :** 05552 /039 1987-07-10
ACREAGE : 6.000 **SALE PRICE :** \$0 **QUALIFIED SALE (Y/N) :** N
LAND VALUE : \$130,680 **IMPVMTS VALUE :** \$1,602,280 **TOTAL VALUE :** \$1,732,960
LAND-USE TYPE : APARTMENT **BUILDING TYPE :** GARDEN APARTMENT
YEAR BUILT : 1,969 **SQUARE FEET :** 4,488 **STYLE CODE :** 2.0 STORIES
BEDROOMS : 0 **BATHROOMS :** 0 **RESTROOMS :** 0 **BASEMENT :** N **GARAGE :** N
EXTERIOR TYPE : ALUMINUM/VINYL SIDING **QUALITY GRADE :** 2 **IMPVMT. VALUE :** \$87,090
A/C : CENTRAL **FIREPLACE :** NONE

Record No.: 50 **BUILDING KEY NUMBER :** 11902117 011
PARCEL-ID : 11902117 **NEIGHBORHOOD CODE :** 11901 **ZONING CLASS :** R22MF
OWNER'S NAME : REMOUNT PROPERTIES
MAILING ADDRESS : PO BOX 37288
CITY : CHARLOTTE **STATE :** NC **ZIP CODE :** 282377288
PROPERTY LOCATION : 1802 REMOUNT RD
LEGAL DESC. : N/A **DEED BK,PG & DATE :** 05552 /039 1987-07-10
ACREAGE : 6.000 **SALE PRICE :** \$0 **QUALIFIED SALE (Y/N) :** N
LAND VALUE : \$130,680 **IMPVMTS VALUE :** \$1,602,280 **TOTAL VALUE :** \$1,732,960
LAND-USE TYPE : APARTMENT **BUILDING TYPE :** GARDEN APARTMENT
YEAR BUILT : 1,969 **SQUARE FEET :** 5,874 **STYLE CODE :** 2.0 STORIES
BEDROOMS : 0 **BATHROOMS :** 0 **RESTROOMS :** 0 **BASEMENT :** N **GARAGE :** N
EXTERIOR TYPE : ALUMINUM/VINYL SIDING **QUALITY GRADE :** 2 **IMPVMT. VALUE :** \$104,770
A/C : CENTRAL **FIREPLACE :** NONE

Record No.: 51 **BUILDING KEY NUMBER :** 11902117 012
PARCEL-ID : 11902117 **NEIGHBORHOOD CODE :** 11901 **ZONING CLASS :** R22MF
OWNER'S NAME : REMOUNT PROPERTIES
MAILING ADDRESS : PO BOX 37288
CITY : CHARLOTTE **STATE :** NC **ZIP CODE :** 282377288
PROPERTY LOCATION : 1519 PARKER DR
LEGAL DESC. : N/A **DEED BK,PG & DATE :** 05552 /039 1987-07-10
ACREAGE : 6.000 **SALE PRICE :** \$0 **QUALIFIED SALE (Y/N) :** N
LAND VALUE : \$130,680 **IMPVMTS VALUE :** \$1,602,280 **TOTAL VALUE :** \$1,732,960
LAND-USE TYPE : APARTMENT **BUILDING TYPE :** GARDEN APARTMENT
YEAR BUILT : 1,969 **SQUARE FEET :** 6,786 **STYLE CODE :** 2.0 STORIES
BEDROOMS : 0 **BATHROOMS :** 0 **RESTROOMS :** 0 **BASEMENT :** N **GARAGE :** N
EXTERIOR TYPE : ALUMINUM/VINYL SIDING **QUALITY GRADE :** 2 **IMPVMT. VALUE :** \$109,060
A/C : CENTRAL **FIREPLACE :** NONE

NOTE: This data is prepared for the purposes of revaluation, assessing & determining ownership of real property & is compiled from recorded deeds, plats, tax maps & other public records & data. Users of this data are hereby notified that the aforementioned public information sources should be consulted for verification. Mecklenburg County assumes no legal responsibility for the information herein.



MECKLENBURG COUNTY, NC

DATE PRINTED 12/21/01

GIS PUBLIC ACCESS SYSTEM REPORT

Note : Records are sorted in Parcel Number order.

PAGE : 18

Record No.: <u>52</u>	BUILDING KEY NUMBER: 11902117 013
PARCEL-ID: 11902117	NEIGHBORHOOD CODE: 11901 ZONING CLASS: R22MF
OWNER'S NAME: REMOUNT PROPERTIES	
MAILING ADDRESS: PO BOX 37288	
CITY: CHARLOTTE	STATE: NC ZIP CODE: 282377288
PROPERTY LOCATION: 1523 PARKER DR	
LEGAL DESC.: N/A	DEED BK,PG & DATE: 05552 /039 1987-07-10
ACREAGE: 6.000	SALE PRICE: \$0 QUALIFIED SALE (Y/N): N
LAND VALUE: \$130,680	IMPVMTS VALUE: \$1,602,280 TOTAL VALUE: \$1,732,960
LAND-USE TYPE: APARTMENT	BUILDING TYPE: GARDEN APARTMENT
YEAR BUILT: 1,969	SQUARE FEET: 9,048 STYLE CODE: 2.0 STORIES
BEDROOMS: 0	BATHROOMS: 0 RESTROOMS: 0 BASEMENT: N GARAGE: N
EXTERIOR TYPE: ALUMINUM/VINYL SIDING	QUALITY GRADE: 2 IMPVMT. VALUE: \$145,420
A/C: CENTRAL	FIREPLACE: NONE
Record No.: <u>53</u>	BUILDING KEY NUMBER: 11902117 014
PARCEL-ID: 11902117	NEIGHBORHOOD CODE: 11901 ZONING CLASS: R22MF
OWNER'S NAME: REMOUNT PROPERTIES	
MAILING ADDRESS: PO BOX 37288	
CITY: CHARLOTTE	STATE: NC ZIP CODE: 282377288
PROPERTY LOCATION: 1511 PARKER DR	
LEGAL DESC.: N/A	DEED BK,PG & DATE: 05552 /039 1987-07-10
ACREAGE: 6.000	SALE PRICE: \$0 QUALIFIED SALE (Y/N): N
LAND VALUE: \$130,680	IMPVMTS VALUE: \$1,602,280 TOTAL VALUE: \$1,732,960
LAND-USE TYPE: APARTMENT	BUILDING TYPE: GARDEN APARTMENT
YEAR BUILT: 1,969	SQUARE FEET: 8,526 STYLE CODE: 2.0 STORIES
BEDROOMS: 0	BATHROOMS: 0 RESTROOMS: 0 BASEMENT: N GARAGE: N
EXTERIOR TYPE: ALUMINUM/VINYL SIDING	QUALITY GRADE: 2 IMPVMT. VALUE: \$137,030
A/C: CENTRAL	FIREPLACE: NONE
Record No.: <u>54</u>	BUILDING KEY NUMBER: 11902117 015
PARCEL-ID: 11902117	NEIGHBORHOOD CODE: 11901 ZONING CLASS: R22MF
OWNER'S NAME: REMOUNT PROPERTIES	
MAILING ADDRESS: PO BOX 37288	
CITY: CHARLOTTE	STATE: NC ZIP CODE: 282377288
PROPERTY LOCATION: 2601 REMOUNT RD	
LEGAL DESC.: N/A	DEED BK,PG & DATE: 05552 /039 1987-07-10
ACREAGE: 6.000	SALE PRICE: \$0 QUALIFIED SALE (Y/N): N
LAND VALUE: \$130,680	IMPVMTS VALUE: \$1,602,280 TOTAL VALUE: \$1,732,960
LAND-USE TYPE: COMMERCIAL	BUILDING TYPE: CLUB-LODGE
YEAR BUILT: 1,969	SQUARE FEET: 441 STYLE CODE: 1.0 STORY
BEDROOMS: 0	BATHROOMS: 0 RESTROOMS: 0 BASEMENT: N GARAGE: N
EXTERIOR TYPE: ALUMINUM/VINYL SIDING	QUALITY GRADE: 2 IMPVMT. VALUE: \$15,390
A/C: NONE	FIREPLACE: NONE

NOTE: This data is prepared for the purposes of revaluation, assessing & determining ownership of real property & is compiled from recorded deeds, plats, tax maps & other public records & data. Users of this data are hereby notified that the aforementioned public information sources should be consulted for verification. Mecklenburg County assumes no legal responsibility for the information herein.



MECKLENBURG COUNTY, NC
GIS PUBLIC ACCESS SYSTEM REPORT

DATE PRINTED 12/21/01

Note : Records are sorted in Parcel Number order.

PAGE : 19

Record No.: 55 **BUILDING KEY NUMBER :** 11902136 001
PARCEL-ID : 11902136 **NEIGHBORHOOD CODE :** 11901 **ZONING CLASS :** R4
OWNER'S NAME : DAVIS CECIL LEON
MAILING ADDRESS : RFD 2 BOX 706
CITY : DALLAS **STATE :** NC **ZIP CODE :** 28034

PROPERTY LOCATION : REMOUNT RC
LEGAL DESC. : OFF REMOUNT RD **DEED BK,PG & DATE :** 03020 /588 1975-01-01
ACREAGE : 1.000 **SALE PRICE :** \$0 **QUALIFIED SALE (Y/N) :** N
LAND VALUE : \$7,250 **IMPVMTS VALUE :** \$0 **TOTAL VALUE :** \$7,250

LAND-USE TYPE : VACANT **BUILDING TYPE :** SINGLE FAMILY RESIDENTIAL
YEAR BUILT : 0 **SQUARE FEET :** 0 **STYLE CODE :**
BEDROOMS : 0 **BATHROOMS :** 0 **RESTROOMS :** 0 **BASEMENT :** N **GARAGE :** N
EXTERIOR TYPE : **QUALITY GRADE :** 0 **IMPVMT. VALUE :** \$0
A/C : **FIREPLACE :**

Record No.: 56 **BUILDING KEY NUMBER :** 11902301 001
PARCEL-ID : 11902301 **NEIGHBORHOOD CODE :** 11901 **ZONING CLASS :** R4
OWNER'S NAME : CALDWELL ALFRED JR
MAILING ADDRESS : 1332 FORDHAM RD
CITY : CHARLOTTE **STATE :** NC **ZIP CODE :** 28208

PROPERTY LOCATION : 1332 FORDHAM RC
LEGAL DESC. : L29B4M1166 461 1332 FORDHAM RD **DEED BK,PG & DATE :** 03822 /169 1976-02-12
ACREAGE : 0.000 **SALE PRICE :** \$0 **QUALIFIED SALE (Y/N) :** N
LAND VALUE : \$8,500 **IMPVMTS VALUE :** \$33,870 **TOTAL VALUE :** \$42,370

LAND-USE TYPE : SINGLE FAMILY **BUILDING TYPE :** SINGLE FAMILY RESIDENTIAL
YEAR BUILT : 1,948 **SQUARE FEET :** 1,164 **STYLE CODE :** 1.0 STORY
BEDROOMS : 3 **BATHROOMS :** 1 **RESTROOMS :** 0 **BASEMENT :** N **GARAGE :** N
EXTERIOR TYPE : ALUMINUM/VINYL SIDING **QUALITY GRADE :** 2 **IMPVMT. VALUE :** \$33,860
A/C : NONE **FIREPLACE :** NONE

Record No.: 57 **BUILDING KEY NUMBER :** 11902302 001
PARCEL-ID : 11902302 **NEIGHBORHOOD CODE :** 11901 **ZONING CLASS :** R4
OWNER'S NAME : BORDEN PANSY J
MAILING ADDRESS : 3930 DUNWOODY DR
CITY : CHARLOTTE **STATE :** NC **ZIP CODE :** 28215

PROPERTY LOCATION : 1326 FORDHAM RC
LEGAL DESC. : L28 B4 M1166-461 **DEED BK,PG & DATE :** 05936 /112 1988-12-30
ACREAGE : 0.000 **SALE PRICE :** \$0 **QUALIFIED SALE (Y/N) :** N
LAND VALUE : \$8,500 **IMPVMTS VALUE :** \$28,620 **TOTAL VALUE :** \$37,120

LAND-USE TYPE : SINGLE FAMILY **BUILDING TYPE :** SINGLE FAMILY RESIDENTIAL
YEAR BUILT : 1,948 **SQUARE FEET :** 784 **STYLE CODE :** 1.0 STORY
BEDROOMS : 2 **BATHROOMS :** 1 **RESTROOMS :** 0 **BASEMENT :** N **GARAGE :** N
EXTERIOR TYPE : ASBESTOS SHINGLE **QUALITY GRADE :** 2 **IMPVMT. VALUE :** \$28,570
A/C : NONE **FIREPLACE :** NONE

NOTE: This data is prepared for the purposes of revaluation, assessing & determining ownership of real property & is compiled from recorded deeds, plats, tax maps & other public records & data. Users of this data are hereby notified that the aforementioned public information sources should be consulted for verification. Mecklenburg County assumes no legal responsibility for the information herein.



MECKLENBURG COUNTY, NC
GIS PUBLIC ACCESS SYSTEM REPORT

DATE PRINTED 12/21/01

Note : Records are sorted in Parcel Number order.

PAGE : 20

Record No.: 58 **BUILDING KEY NUMBER :** 11902303 001
PARCEL-ID : 11902303 **NEIGHBORHOOD CODE :** 11901 **ZONING CLASS :** R4
OWNER'S NAME : BELL GOLDIE
MAILING ADDRESS : 1901 CLIFFWOOD PL
CITY : CHARLOTTE **STATE :** NC **ZIP CODE :** 28203
PROPERTY LOCATION : 1320 FORDHAM RE
LEGAL DESC. : L27 B4 M1166-461 **DEED BK,PG & DATE :** 11448 /047 2000-07-25
ACREAGE : 0.000 **SALE PRICE :** \$0 **QUALIFIED SALE (Y/N) :** Y
LAND VALUE : \$8,500 **IMPVMTS VALUE :** \$30,190 **TOTAL VALUE :** \$38,690

LAND-USE TYPE : SINGLE FAMILY **BUILDING TYPE :** SINGLE FAMILY RESIDENTIAL
YEAR BUILT : 1,948 **SQUARE FEET :** 850 **STYLE CODE :** 1.0 STORY
BEDROOMS : 2 **BATHROOMS :** 1 **RESTROOMS :** 0 **BASEMENT :** N **GARAGE :** N
EXTERIOR TYPE : ASBESTOS SHINGLE **QUALITY GRADE :** 2 **IMPVMT. VALUE :** \$28,650
A/C : NONE **FIREPLACE :** NONE

Record No.: 59 **BUILDING KEY NUMBER :** 11902304 001
PARCEL-ID : 11902304 **NEIGHBORHOOD CODE :** 11901 **ZONING CLASS :** R4
OWNER'S NAME : STEINBERGER NORMAN F
MAILING ADDRESS : PO BOX 221473
CITY : CHARLOTTE **STATE :** NC **ZIP CODE :** 282221473
PROPERTY LOCATION : 1314 FORDHAM RE
LEGAL DESC. : L26B4M1166-461 1314 FORDHAM RD **DEED BK,PG & DATE :** 07144 /187 1992-12-21
ACREAGE : 0.000 **SALE PRICE :** \$14,000 **QUALIFIED SALE (Y/N) :** N
LAND VALUE : \$8,500 **IMPVMTS VALUE :** \$29,560 **TOTAL VALUE :** \$38,060

LAND-USE TYPE : SINGLE FAMILY **BUILDING TYPE :** SINGLE FAMILY RESIDENTIAL
YEAR BUILT : 1,948 **SQUARE FEET :** 850 **STYLE CODE :** 1.0 STORY
BEDROOMS : 2 **BATHROOMS :** 1 **RESTROOMS :** 0 **BASEMENT :** N **GARAGE :** N
EXTERIOR TYPE : MASONITE ON SHEATHING **QUALITY GRADE :** 2 **IMPVMT. VALUE :** \$29,560
A/C : NONE **FIREPLACE :** NONE

Record No.: 60 **BUILDING KEY NUMBER :** 11903101 001
PARCEL-ID : 11903101 **NEIGHBORHOOD CODE :** 11901 **ZONING CLASS :** B1
OWNER'S NAME : KFC NATIONAL MANAGEMENT **CO % KFC TAX #X825012**
MAILING ADDRESS : PO BOX 35370
CITY : LOUISVILLE **STATE :** KY **ZIP CODE :** 402325370
PROPERTY LOCATION : 1600 REMOUNT RE
LEGAL DESC. : 1600 REMOUNT AVE **DEED BK,PG & DATE :** 04614 /390 1982-12-30
ACREAGE : 0.000 **SALE PRICE :** \$0 **QUALIFIED SALE (Y/N) :** N
LAND VALUE : \$60,110 **IMPVMTS VALUE :** \$152,510 **TOTAL VALUE :** \$212,620

LAND-USE TYPE : COMMERCIAL **BUILDING TYPE :** FAST FOODS
YEAR BUILT : 1,983 **SQUARE FEET :** 1,678 **STYLE CODE :** 1.0 STORY
BEDROOMS : 0 **BATHROOMS :** 0 **RESTROOMS :** 0 **BASEMENT :** N **GARAGE :** N
EXTERIOR TYPE : STUCCO ON CONCRETE BLOCK **QUALITY GRADE :** 5 **IMPVMT. VALUE :** \$146,930
A/C : CENTRAL **FIREPLACE :** NONE

NOTE: This data is prepared for the purposes of revaluation, assessing & determining ownership of real property & is compiled from recorded deeds, plats, tax maps & other public records & data. Users of this data are hereby notified that the aforementioned public information sources should be consulted for verification. Mecklenburg County assumes no legal responsibility for the information herein.



MECKLENBURG COUNTY, NC

GIS PUBLIC ACCESS SYSTEM REPORT

DATE PRINTED 12/21/01

Note : Records are sorted in Parcel Number order.

PAGE : 21

Record No.:	<u>61</u>	BUILDING KEY NUMBER :	11903102 001
PARCEL-ID :	11903102	NEIGHBORHOOD CODE :	11901
OWNER'S NAME :	CLARK SAM	ZONING CLASS :	B1
MAILING ADDRESS :	2312 LUDLOW DR		
CITY :	CHARLOTTE	STATE :	NC
		ZIP CODE :	28216
PROPERTY LOCATION :	1500 WEST		BV
LEGAL DESC. :	1500 W BLVD	DEED BK,PG & DATE :	05257 /349 1986-06-30
ACREAGE :	0.000	SALE PRICE :	\$80,000
		QUALIFIED SALE (Y/N) :	Y
LAND VALUE :	\$34,160	IMPVMTS VALUE :	\$30,700
		TOTAL VALUE :	\$64,860
LAND-USE TYPE :	COMMERCIAL	BUILDING TYPE :	SERVICE STATION
YEAR BUILT :	1,958	SQUARE FEET :	1,711
		STYLE CODE :	1.0 STORY
BEDROOMS :	0	BATHROOMS :	0
		RESTROOMS :	0
		BASEMENT :	N
		GARAGE :	N
EXTERIOR TYPE :	CONCRETE BLOCK	QUALITY GRADE :	2
		IMPVMT. VALUE :	\$24,850
A/C :	CENTRAL	FIREPLACE :	NONE
Record No.:	<u>62</u>	BUILDING KEY NUMBER :	11903103 001
PARCEL-ID :	11903103	NEIGHBORHOOD CODE :	11901
OWNER'S NAME :	GADDY CLYDE JR &WF	ZONING CLASS :	R5
MAILING ADDRESS :	1600 WEST BLVD		
CITY :	CHARLOTTE	STATE :	NC
		ZIP CODE :	282086908
PROPERTY LOCATION :	1600 WEST		BV
LEGAL DESC. :	L1 B5 M967-511	DEED BK,PG & DATE :	03247 /158 1971-01-13
ACREAGE :	0.000	SALE PRICE :	\$0
		QUALIFIED SALE (Y/N) :	N
LAND VALUE :	\$7,600	IMPVMTS VALUE :	\$38,360
		TOTAL VALUE :	\$45,960
LAND-USE TYPE :	SINGLE FAMILY	BUILDING TYPE :	SINGLE FAMILY RESIDENTIAL
YEAR BUILT :	1,948	SQUARE FEET :	1,032
		STYLE CODE :	1.0 STORY
BEDROOMS :	3	BATHROOMS :	1
		RESTROOMS :	0
		BASEMENT :	N
		GARAGE :	N
EXTERIOR TYPE :	ALUMINUM/VINYL SIDING	QUALITY GRADE :	2
		IMPVMT. VALUE :	\$38,360
A/C :	NONE	FIREPLACE :	1 STY SINGLE
Record No.:	<u>63</u>	BUILDING KEY NUMBER :	11903104 001
PARCEL-ID :	11903104	NEIGHBORHOOD CODE :	11901
OWNER'S NAME :	PUGH ALBERTA ROBERTSON	ZONING CLASS :	R4
MAILING ADDRESS :	1410 WEST BLVD		
CITY :	CHARLOTTE	STATE :	NC
		ZIP CODE :	28208
PROPERTY LOCATION :	1410 WEST		BV
LEGAL DESC. :	L2 B5 M967-511	DEED BK,PG & DATE :	03681 /549 1974-07-25
ACREAGE :	0.000	SALE PRICE :	\$0
		QUALIFIED SALE (Y/N) :	N
LAND VALUE :	\$7,600	IMPVMTS VALUE :	\$43,490
		TOTAL VALUE :	\$51,090
LAND-USE TYPE :	SINGLE FAMILY	BUILDING TYPE :	SINGLE FAMILY RESIDENTIAL
YEAR BUILT :	1,948	SQUARE FEET :	1,150
		STYLE CODE :	1.0 STORY
BEDROOMS :	3	BATHROOMS :	1
		RESTROOMS :	0
		BASEMENT :	N
		GARAGE :	N
EXTERIOR TYPE :	ASBESTOS SHINGLE	QUALITY GRADE :	2
		IMPVMT. VALUE :	\$43,330
A/C :	NONE	FIREPLACE :	1 STY SINGLE

NOTE: This data is prepared for the purposes of revaluation, assessing & determining ownership of real property & is compiled from recorded deeds, plats, tax maps & other public records & data. Users of this data are hereby notified that the aforementioned public information sources should be consulted for verification. Mecklenburg County assumes no legal responsibility for the information herein.



MECKLENBURG COUNTY, NC
GIS PUBLIC ACCESS SYSTEM REPORT

DATE PRINTED 12/21/01

Note : Records are sorted in Parcel Number order.

PAGE : 22

Record No.: 64 **BUILDING KEY NUMBER :** 11903105 001
PARCEL-ID : 11903105 **NEIGHBORHOOD CODE :** 11901 **ZONING CLASS :** R4
OWNER'S NAME : TPM PROPERTIES LP
MAILING ADDRESS : 3816 MOORELAND FARMS RD
CITY : CHARLOTTE **STATE :** NC **ZIP CODE :** 28226

PROPERTY LOCATION : 1416 WEST BV
LEGAL DESC. : L3 B5 M967-511 **DEED BK,PG & DATE :** 11630 /745 2000-10-06
ACREAGE : 1.000 **SALE PRICE :** \$35,000 **QUALIFIED SALE (Y/N) :** Y
LAND VALUE : \$8,080 **IMPVMTS VALUE :** \$47,470 **TOTAL VALUE :** \$55,550

LAND-USE TYPE : SINGLE FAMILY **BUILDING TYPE :** SINGLE FAMILY RESIDENTIAL
YEAR BUILT : 1,948 **SQUARE FEET :** 1,139 **STYLE CODE :** 1.0 STORY
BEDROOMS : 3 **BATHROOMS :** 1 **RESTROOMS :** 0 **BASEMENT :** N **GARAGE :** N
EXTERIOR TYPE : ALUMINUM/VINYL SIDING **QUALITY GRADE :** 2 **IMPVMT. VALUE :** \$43,320
A/C : CENTRAL **FIREPLACE :** 1 STY SINGLE

Record No.: 65 **BUILDING KEY NUMBER :** 11903106 001
PARCEL-ID : 11903106 **NEIGHBORHOOD CODE :** 11901 **ZONING CLASS :** R4
OWNER'S NAME : PATTERSON J C & WF FLORA BETH
MAILING ADDRESS : 1012 EAST BLVD
CITY : CHARLOTTE **STATE :** NC **ZIP CODE :** 28203

PROPERTY LOCATION : 1417 KIMBERLY RE
LEGAL DESC. : L1 B7 M6 305 1417 KIMBERLY RD **DEED BK,PG & DATE :** 06163 /191 1989-06-06
ACREAGE : 0.000 **SALE PRICE :** \$40,000 **QUALIFIED SALE (Y/N) :** Y
LAND VALUE : \$8,000 **IMPVMTS VALUE :** \$34,970 **TOTAL VALUE :** \$42,970

LAND-USE TYPE : SINGLE FAMILY **BUILDING TYPE :** SINGLE FAMILY RESIDENTIAL
YEAR BUILT : 1,948 **SQUARE FEET :** 910 **STYLE CODE :** 1.0 STORY
BEDROOMS : 2 **BATHROOMS :** 1 **RESTROOMS :** 0 **BASEMENT :** N **GARAGE :** N
EXTERIOR TYPE : WOOD ON SHEATHING OR PLYWO **QUALITY GRADE :** 2 **IMPVMT. VALUE :** \$34,890
A/C : NONE **FIREPLACE :** 1 STY SINGLE

Record No.: 66 **BUILDING KEY NUMBER :** 11903107 001
PARCEL-ID : 11903107 **NEIGHBORHOOD CODE :** 11901 **ZONING CLASS :** R4
OWNER'S NAME : WORTHAM MARY & LEONARD WORTHAM
MAILING ADDRESS : 1421 KIMBERLY RD
CITY : CHARLOTTE **STATE :** NC **ZIP CODE :** 28208

PROPERTY LOCATION : 1421 KIMBERLY RE
LEGAL DESC. : L2 B7 M6-305 **DEED BK,PG & DATE :** 09612 /958 1998-04-13
ACREAGE : 0.000 **SALE PRICE :** \$39,000 **QUALIFIED SALE (Y/N) :** Y
LAND VALUE : \$8,000 **IMPVMTS VALUE :** \$36,760 **TOTAL VALUE :** \$44,760

LAND-USE TYPE : SINGLE FAMILY **BUILDING TYPE :** SINGLE FAMILY RESIDENTIAL
YEAR BUILT : 1,948 **SQUARE FEET :** 868 **STYLE CODE :** 1.0 STORY
BEDROOMS : 2 **BATHROOMS :** 1 **RESTROOMS :** 0 **BASEMENT :** N **GARAGE :** N
EXTERIOR TYPE : FACE BRICK **QUALITY GRADE :** 2 **IMPVMT. VALUE :** \$36,710
A/C : CENTRAL **FIREPLACE :** 1 STY SINGLE

NOTE: This data is prepared for the purposes of revaluation, assessing & determining ownership of real property & is compiled from recorded deeds, plats, tax maps & other public records & data. Users of this data are hereby notified that the aforementioned public information sources should be consulted for verification. Mecklenburg County assumes no legal responsibility for the information herein.



MECKLENBURG COUNTY, NC
GIS PUBLIC ACCESS SYSTEM REPORT

DATE PRINTED 12/21/01

Note : Records are sorted in Parcel Number order.

PAGE : 23

Record No.: <u>67</u>	BUILDING KEY NUMBER: 11903108 001
PARCEL-ID: 11903108	NEIGHBORHOOD CODE: 11901 ZONING CLASS: R4
OWNER'S NAME: WRIGHT ESTELLA A	(BY ENTIRETY)
MAILING ADDRESS: 1425 KIMBERLY RD	
CITY: CHARLOTTE	STATE: NC ZIP CODE: 28208
PROPERTY LOCATION: 1425 KIMBERLY RE	
LEGAL DESC.: L3 B7 M6 305 1425 KIMBERLY RD	DEED BK,PG & DATE: 03465 /423 1972-09-11
ACREAGE: 0.000	SALE PRICE: \$0 QUALIFIED SALE (Y/N): N
LAND VALUE: \$8,000	IMPVMTS VALUE: \$33,900 TOTAL VALUE: \$41,900
LAND-USE TYPE: SINGLE FAMILY	BUILDING TYPE: SINGLE FAMILY RESIDENTIAL
YEAR BUILT: 1,948	SQUARE FEET: 840 STYLE CODE: 1.0 STORY
BEDROOMS: 2	BATHROOMS: 1 RESTROOMS: 0 BASEMENT: N GARAGE: N
EXTERIOR TYPE: MASONITE ON SHEATHING	QUALITY GRADE: 2 IMPVMT. VALUE: \$33,850
A/C: NONE	FIREPLACE: 1 STY SINGLE
Record No.: <u>68</u>	BUILDING KEY NUMBER: 11903109 001
PARCEL-ID: 11903109	NEIGHBORHOOD CODE: 11901 ZONING CLASS: R4
OWNER'S NAME: HEGE HELEN LOUISE	(BY ENTIRETY)
MAILING ADDRESS: 1429 KIMBERLY RD	
CITY: CHARLOTTE	STATE: NC ZIP CODE: 28208
PROPERTY LOCATION: 1429 KIMBERLY RE	
LEGAL DESC.: L4 B7 M6 305 1429 KIMBERLY RD	DEED BK,PG & DATE: 01466 /040 1975-01-01
ACREAGE: 0.000	SALE PRICE: \$0 QUALIFIED SALE (Y/N): N
LAND VALUE: \$8,000	IMPVMTS VALUE: \$35,440 TOTAL VALUE: \$43,440
LAND-USE TYPE: SINGLE FAMILY	BUILDING TYPE: SINGLE FAMILY RESIDENTIAL
YEAR BUILT: 1,948	SQUARE FEET: 840 STYLE CODE: 1.0 STORY
BEDROOMS: 2	BATHROOMS: 1 RESTROOMS: 0 BASEMENT: N GARAGE: N
EXTERIOR TYPE: FACE BRICK	QUALITY GRADE: 2 IMPVMT. VALUE: \$34,440
A/C: NONE	FIREPLACE: 1 STY SINGLE
Record No.: <u>69</u>	BUILDING KEY NUMBER: 11903110 001
PARCEL-ID: 11903110	NEIGHBORHOOD CODE: 11901 ZONING CLASS: R4
OWNER'S NAME: HEAD ULYSSES JR	& ROSA LEE
MAILING ADDRESS: 1433 KIMBERLY RD	
CITY: CHARLOTTE	STATE: NC ZIP CODE: 28208
PROPERTY LOCATION: 1433 KIMBERLY RE	
LEGAL DESC.: L5 B7 M6-305	DEED BK,PG & DATE: 08428 /701 1996-01-16
ACREAGE: 0.000	SALE PRICE: \$0 QUALIFIED SALE (Y/N): N
LAND VALUE: \$8,000	IMPVMTS VALUE: \$35,370 TOTAL VALUE: \$43,370
LAND-USE TYPE: SINGLE FAMILY	BUILDING TYPE: SINGLE FAMILY RESIDENTIAL
YEAR BUILT: 1,948	SQUARE FEET: 840 STYLE CODE: 1.0 STORY
BEDROOMS: 2	BATHROOMS: 1 RESTROOMS: 0 BASEMENT: N GARAGE: N
EXTERIOR TYPE: ALUMINUM/VINYL SIDING	QUALITY GRADE: 2 IMPVMT. VALUE: \$32,700
A/C: NONE	FIREPLACE: 1 STY SINGLE

NOTE: This data is prepared for the purposes of revaluation, assessing & determining ownership of real property & is compiled from recorded deeds, plats, tax maps & other public records & data. Users of this data are hereby notified that the aforementioned public information sources should be consulted for verification. Mecklenburg County assumes no legal responsibility for the information herein.



MECKLENBURG COUNTY, NC
GIS PUBLIC ACCESS SYSTEM REPORT

DATE PRINTED 12/21/01

Note : Records are sorted in Parcel Number order.

PAGE : 24

Record No.: 70 **BUILDING KEY NUMBER:** 11903111 001
PARCEL-ID: 11903111 **NEIGHBORHOOD CODE:** 11901 **ZONING CLASS:** R4
OWNER'S NAME: SMITH WILLARD CROWDER & &WF EITHEL D
MAILING ADDRESS: 1501 KIMBERLY RD
CITY: CHARLOTTE **STATE:** NC **ZIP CODE:** 28208

PROPERTY LOCATION: 1501 KIMBERLY RC
LEGAL DESC.: L6B7M6-305 1501 KIMBERLY RD **DEED BK,PG & DATE:** 02040 /126 1975-01-01
ACREAGE: 0.000 **SALE PRICE:** \$0 **QUALIFIED SALE (Y/N):** N
LAND VALUE: \$8,000 **IMPVMTS VALUE:** \$37,510 **TOTAL VALUE:** \$45,510

LAND-USE TYPE: SINGLE FAMILY **BUILDING TYPE:** SINGLE FAMILY RESIDENTIAL
YEAR BUILT: 1,948 **SQUARE FEET:** 1,057 **STYLE CODE:** 1.0 STORY
BEDROOMS: 3 **BATHROOMS:** 1 **RESTROOMS:** 0 **BASEMENT:** N **GARAGE:** N
EXTERIOR TYPE: ASBESTOS SHINGLE **QUALITY GRADE:** 2 **IMPVMT. VALUE:** \$37,420
A/C: NONE **FIREPLACE:** 1 STY SINGLE

Record No.: 71 **BUILDING KEY NUMBER:** 11903112 001
PARCEL-ID: 11903112 **NEIGHBORHOOD CODE:** 11901 **ZONING CLASS:** R4
OWNER'S NAME: MCMOORE SHIRLEY
MAILING ADDRESS: 1505 KIMBERLY RD
CITY: CHARLOTTE **STATE:** NC **ZIP CODE:** 28208

PROPERTY LOCATION: 1505 KIMBERLY RC
LEGAL DESC.: L7 B7 M6-305 **DEED BK,PG & DATE:** 63311 /576 1990-05-10
ACREAGE: 0.000 **SALE PRICE:** \$0 **QUALIFIED SALE (Y/N):**
LAND VALUE: \$8,000 **IMPVMTS VALUE:** \$37,140 **TOTAL VALUE:** \$45,140

LAND-USE TYPE: SINGLE FAMILY **BUILDING TYPE:** SINGLE FAMILY RESIDENTIAL
YEAR BUILT: 1,948 **SQUARE FEET:** 900 **STYLE CODE:** 1.0 STORY
BEDROOMS: 2 **BATHROOMS:** 1 **RESTROOMS:** 0 **BASEMENT:** N **GARAGE:** N
EXTERIOR TYPE: ALUMINUM/VINYL SIDING **QUALITY GRADE:** 2 **IMPVMT. VALUE:** \$35,580
A/C: CENTRAL **FIREPLACE:** 1 STY SINGLE

Record No.: 72 **BUILDING KEY NUMBER:** 11903113 001
PARCEL-ID: 11903113 **NEIGHBORHOOD CODE:** 11901 **ZONING CLASS:** R4
OWNER'S NAME: YOUNG WILMA (BY ENTIRETY)
MAILING ADDRESS: 1509 KIMBERLY RD
CITY: CHARLOTTE **STATE:** NC **ZIP CODE:** 28208

PROPERTY LOCATION: 1509 KIMBERLY RC
LEGAL DESC.: L8 B7 M6-305 **DEED BK,PG & DATE:** 03917 /676 1977-02-15
ACREAGE: 0.000 **SALE PRICE:** \$0 **QUALIFIED SALE (Y/N):** N
LAND VALUE: \$8,000 **IMPVMTS VALUE:** \$38,380 **TOTAL VALUE:** \$46,380

LAND-USE TYPE: SINGLE FAMILY **BUILDING TYPE:** SINGLE FAMILY RESIDENTIAL
YEAR BUILT: 1,948 **SQUARE FEET:** 1,121 **STYLE CODE:** 1.0 STORY
BEDROOMS: 2 **BATHROOMS:** 1 **RESTROOMS:** 0 **BASEMENT:** N **GARAGE:** N
EXTERIOR TYPE: FACE BRICK **QUALITY GRADE:** 2 **IMPVMT. VALUE:** \$38,240
A/C: CENTRAL **FIREPLACE:** 1 STY SINGLE

NOTE: This data is prepared for the purposes of revaluation, assessing & determining ownership of real property & is compiled from recorded deeds, plats, tax maps & other public records & data. Users of this data are hereby notified that the aforementioned public information sources should be consulted for verification. Mecklenburg County assumes no legal responsibility for the information herein.



MECKLENBURG COUNTY, NC
GIS PUBLIC ACCESS SYSTEM REPORT

DATE PRINTED 12/21/01

Note : Records are sorted in Parcel Number order.

PAGE : 25

Record No.: 73 **BUILDING KEY NUMBER:** 11903114 001
PARCEL-ID: 11903114 **NEIGHBORHOOD CODE:** 11901 **ZONING CLASS:** R4
OWNER'S NAME: PATTERSON J C & WF **FLORA BETH**
MAILING ADDRESS: 1012 EAST BLVD
CITY: CHARLOTTE **STATE:** NC **ZIP CODE:** 28203

PROPERTY LOCATION: 1513 KIMBERLY RE
LEGAL DESC.: L9 B7 M6 305 1513 KIMBERLY RD **DEED BK,PG & DATE:** 06163 /191 1989-06-06
ACREAGE: 0.000 **SALE PRICE:** \$0 **QUALIFIED SALE (Y/N):** N
LAND VALUE: \$8,000 **IMPVMTS VALUE:** \$33,940 **TOTAL VALUE: .** \$41,940

LAND-USE TYPE: SINGLE FAMILY **BUILDING TYPE:** SINGLE FAMILY RESIDENTIAL
YEAR BUILT: 1,948 **SQUARE FEET:** 895 **STYLE CODE:** 1.0 STORY
BEDROOMS: 2 **BATHROOMS:** 1 **RESTROOMS:** 0 **BASEMENT:** N **GARAGE:** N
EXTERIOR TYPE: ASBESTOS SHINGLE **QUALITY GRADE:** 2 **IMPVMT. VALUE:** \$33,810
A/C: CENTRAL **FIREPLACE:** 1 STY SINGLE

Record No.: 74 **BUILDING KEY NUMBER:** 11903115 001
PARCEL-ID: 11903115 **NEIGHBORHOOD CODE:** 11901 **ZONING CLASS:** R4
OWNER'S NAME: COVINGTON CHARLES EARL
MAILING ADDRESS: 1517 KIMBERLY RD
CITY: CHARLOTTE **STATE:** NC **ZIP CODE:** 28208

PROPERTY LOCATION: 1517 KIMBERLY RE
LEGAL DESC.: L10 B7 M6 305 1517 KIMBERLY R **DEED BK,PG & DATE:** 03233 /430 1970-12-18
ACREAGE: 0.000 **SALE PRICE:** \$0 **QUALIFIED SALE (Y/N):** N
LAND VALUE: \$8,000 **IMPVMTS VALUE:** \$42,170 **TOTAL VALUE:** \$50,170

LAND-USE TYPE: SINGLE FAMILY **BUILDING TYPE:** SINGLE FAMILY RESIDENTIAL
YEAR BUILT: 1,948 **SQUARE FEET:** 1,161 **STYLE CODE:** 1.0 STORY
BEDROOMS: 2 **BATHROOMS:** 1 **RESTROOMS:** 0 **BASEMENT:** N **GARAGE:** N
EXTERIOR TYPE: FACE BRICK **QUALITY GRADE:** 2 **IMPVMT. VALUE:** \$42,160
A/C: NONE **FIREPLACE:** 1 STY SINGLE

Record No.: 75 **BUILDING KEY NUMBER:** 11903116 001
PARCEL-ID: 11903116 **NEIGHBORHOOD CODE:** 11901 **ZONING CLASS:** R4
OWNER'S NAME: KEY REALTY OF CHARLOTTE INC
MAILING ADDRESS: PO BOX 37288
CITY: CHARLOTTE **STATE:** NC **ZIP CODE:** 28237

PROPERTY LOCATION: 1521 KIMBERLY RE
LEGAL DESC.: L11B7M6-305 1521 KIMBERLY RD **DEED BK,PG & DATE:** 07310 /660 1993-05-25
ACREAGE: 0.000 **SALE PRICE:** \$0 **QUALIFIED SALE (Y/N):** N
LAND VALUE: \$8,000 **IMPVMTS VALUE:** \$36,240 **TOTAL VALUE:** \$44,240

LAND-USE TYPE: SINGLE FAMILY **BUILDING TYPE:** SINGLE FAMILY RESIDENTIAL
YEAR BUILT: 1,948 **SQUARE FEET:** 915 **STYLE CODE:** 1.0 STORY
BEDROOMS: 2 **BATHROOMS:** 1 **RESTROOMS:** 0 **BASEMENT:** N **GARAGE:** N
EXTERIOR TYPE: WOOD ON SHEATHING OR PLYWO **QUALITY GRADE:** 2 **IMPVMT. VALUE:** \$36,160
A/C: CENTRAL **FIREPLACE:** 1 STY SINGLE

NOTE: This data is prepared for the purposes of revaluation, assessing & determining ownership of real property & is compiled from recorded deeds, plats, tax maps & other public records & data. Users of this data are hereby notified that the aforementioned public information sources should be consulted for verification. Mecklenburg County assumes no legal responsibility for the information herein.



MECKLENBURG COUNTY, NC
GIS PUBLIC ACCESS SYSTEM REPORT

DATE PRINTED 12/21/01

Note : Records are sorted in Parcel Number order.

PAGE : 26

Record No.: 76 **BUILDING KEY NUMBER :** 11903117 001
PARCEL-ID : 11903117 **NEIGHBORHOOD CODE :** 11901 **ZONING CLASS :** R4
OWNER'S NAME : MOBLEY LILLIE P MRS GLENN BY ENT
MAILING ADDRESS : 3101 WYNMORE PL
CITY : CHARLOTTE **STATE :** NC **ZIP CODE :** 28208

PROPERTY LOCATION : 1525 KIMBERLY RC
LEGAL DESC. : L12B7M6 305 1525 KIMBERLY RD **DEED BK,PG & DATE :** 03238 /028 1971-09-27
ACREAGE : 0.000 **SALE PRICE :** \$0 **QUALIFIED SALE (Y/N) :** N
LAND VALUE : \$8,000 **IMPVMTS VALUE :** \$0 **TOTAL VALUE :** \$8,000

LAND-USE TYPE : VACANT **BUILDING TYPE :** SINGLE FAMILY RESIDENTIAL
YEAR BUILT : 0 **SQUARE FEET :** 0 **STYLE CODE :**
BEDROOMS : 0 **BATHROOMS :** 0 **RESTROOMS :** 0 **BASEMENT :** N **GARAGE :** N
EXTERIOR TYPE : **QUALITY GRADE :** 0 **IMPVMT. VALUE :** \$0
A/C : **FIREPLACE :**

Record No.: 77 **BUILDING KEY NUMBER :** 11903118 001
PARCEL-ID : 11903118 **NEIGHBORHOOD CODE :** 11901 **ZONING CLASS :** R4
OWNER'S NAME : KINARD GENEVIEVE L
MAILING ADDRESS : 1529 KIMBERLY RD
CITY : CHARLOTTE **STATE :** NC **ZIP CODE :** 28208

PROPERTY LOCATION : 1529 KIMBERLY RC
LEGAL DESC. : L13 B7 M6 305 1529 KIMBERLY RD **DEED BK,PG & DATE :** 03214 /584 1970-12-01
ACREAGE : 0.000 **SALE PRICE :** \$0 **QUALIFIED SALE (Y/N) :** N
LAND VALUE : \$9,030 **IMPVMTS VALUE :** \$45,220 **TOTAL VALUE :** \$54,250

LAND-USE TYPE : SINGLE FAMILY **BUILDING TYPE :** SINGLE FAMILY RESIDENTIAL
YEAR BUILT : 1,948 **SQUARE FEET :** 1,140 **STYLE CODE :** 1.0 STORY
BEDROOMS : 3 **BATHROOMS :** 1 **RESTROOMS :** 0 **BASEMENT :** N **GARAGE :** N
EXTERIOR TYPE : SIDING AVERAGE **QUALITY GRADE :** 2 **IMPVMT. VALUE :** \$45,080
A/C : CENTRAL **FIREPLACE :** 1 STY SINGLE

Record No.: 78 **BUILDING KEY NUMBER :** 11903119 001
PARCEL-ID : 11903119 **NEIGHBORHOOD CODE :** 11901 **ZONING CLASS :** B1
OWNER'S NAME : CMDC WESTOVER NO 1 2000 LLC
MAILING ADDRESS : 3623 LATROBE DR #122
CITY : CHARLOTTE **STATE :** NC **ZIP CODE :** 28211

PROPERTY LOCATION : 1506 WEST BV
LEGAL DESC. : NA **DEED BK,PG & DATE :** 11988 /223 2001-03-02
ACREAGE : 5.000 **SALE PRICE :** \$0 **QUALIFIED SALE (Y/N) :** N
LAND VALUE : \$279,800 **IMPVMTS VALUE :** \$539,170 **TOTAL VALUE :** \$818,970

LAND-USE TYPE : COMMERCIAL **BUILDING TYPE :** SHOPPING CENTER-STRIP
YEAR BUILT : 1,959 **SQUARE FEET :** 40,520 **STYLE CODE :** 1.0 STORY
BEDROOMS : 0 **BATHROOMS :** 0 **RESTROOMS :** 0 **BASEMENT :** N **GARAGE :** N
EXTERIOR TYPE : COMMON BRICK **QUALITY GRADE :** 2 **IMPVMT. VALUE :** \$353,880
A/C : CENTRAL **FIREPLACE :** NONE

NOTE: This data is prepared for the purposes of revaluation, assessing & determining ownership of real property & is compiled from recorded deeds, plats, tax maps & other public records & data. Users of this data are hereby notified that the aforementioned public information sources should be consulted for verification. Mecklenburg County assumes no legal responsibility for the information herein.



MECKLENBURG COUNTY, NC

DATE PRINTED 12/21/01

GIS PUBLIC ACCESS SYSTEM REPORT

Note : Records are sorted in Parcel Number order.

PAGE : 27

Record No.: 79 **BUILDING KEY NUMBER :** 11903119 002
PARCEL-ID : 11903119 **NEIGHBORHOOD CODE :** 11901 **ZONING CLASS :** B1
OWNER'S NAME : CMDC WESTOVER NO 1 2000 LLC
MAILING ADDRESS : 3623 LATROBE DR #122
CITY : CHARLOTTE **STATE :** NC **ZIP CODE :** 28211

PROPERTY LOCATION : WILMNT REMNT RD
LEGAL DESC. : NA **DEED BK,PG & DATE :** 11988 /223 2001-03-02
ACREAGE : 5.000 **SALE PRICE :** \$0 **QUALIFIED SALE (Y/N) :** N
LAND VALUE : \$279,800 **IMPVMTS VALUE :** \$539,170 **TOTAL VALUE :** \$818,970

LAND-USE TYPE : COMMERCIAL **BUILDING TYPE :** COMMERCIAL
YEAR BUILT : 1,964 **SQUARE FEET :** 6,000 **STYLE CODE :** 1.0 STORY
BEDROOMS : 0 **BATHROOMS :** 0 **RESTROOMS :** 0 **BASEMENT :** N **GARAGE :** N
EXTERIOR TYPE : COMMON BRICK **QUALITY GRADE :** 2 **IMPVMT. VALUE :** \$108,670
A/C : CENTRAL **FIREPLACE :** NONE

Record No.: 80 **BUILDING KEY NUMBER :** 11903119 003
PARCEL-ID : 11903119 **NEIGHBORHOOD CODE :** 11901 **ZONING CLASS :** B1
OWNER'S NAME : CMDC WESTOVER NO 1 2000 LLC
MAILING ADDRESS : 3623 LATROBE DR #122
CITY : CHARLOTTE **STATE :** NC **ZIP CODE :** 28211

PROPERTY LOCATION : 1540
LEGAL DESC. : NA **DEED BK,PG & DATE :** 11988 /223 2001-03-02
ACREAGE : 5.000 **SALE PRICE :** \$0 **QUALIFIED SALE (Y/N) :** N
LAND VALUE : \$279,800 **IMPVMTS VALUE :** \$539,170 **TOTAL VALUE :** \$818,970

LAND-USE TYPE : COMMERCIAL **BUILDING TYPE :** COMMERCIAL
YEAR BUILT : 1,959 **SQUARE FEET :** 2,865 **STYLE CODE :** 1.0 STORY
BEDROOMS : 0 **BATHROOMS :** 0 **RESTROOMS :** 0 **BASEMENT :** N **GARAGE :** N
EXTERIOR TYPE : FACE BRICK **QUALITY GRADE :** 2 **IMPVMT. VALUE :** \$41,530
A/C : CENTRAL **FIREPLACE :** NONE

Record No.: 81 **BUILDING KEY NUMBER :** 11903201 001
PARCEL-ID : 11903201 **NEIGHBORHOOD CODE :** 11901 **ZONING CLASS :** R4
OWNER'S NAME : SHIPP NELLIE ELIZABETH
MAILING ADDRESS : 1338 WEST BLVD
CITY : CHARLOTTE **STATE :** NC **ZIP CODE :** 282087044

PROPERTY LOCATION : 1338 WEST BV
LEGAL DESC. : L17 B3 M4-409 **DEED BK,PG & DATE :** 08734 /899 1996-09-11
ACREAGE : 0.000 **SALE PRICE :** \$39,000 **QUALIFIED SALE (Y/N) :** Y
LAND VALUE : \$7,600 **IMPVMTS VALUE :** \$34,060 **TOTAL VALUE :** \$41,660

LAND-USE TYPE : SINGLE FAMILY **BUILDING TYPE :** SINGLE FAMILY RESIDENTIAL
YEAR BUILT : 1,948 **SQUARE FEET :** 1,312 **STYLE CODE :** 1.0 STORY
BEDROOMS : 3 **BATHROOMS :** 1 **RESTROOMS :** 0 **BASEMENT :** N **GARAGE :** N
EXTERIOR TYPE : ALUMINUM/VINYL SIDING **QUALITY GRADE :** 2 **IMPVMT. VALUE :** \$34,060
A/C : CENTRAL **FIREPLACE :** 1 STY SINGLE

NOTE: This data is prepared for the purposes of revaluation, assessing & determining ownership of real property & is compiled from recorded deeds, plats, tax maps & other public records & data. Users of this data are hereby notified that the aforementioned public information sources should be consulted for verification. Mecklenburg County assumes no legal responsibility for the information herein.



MECKLENBURG COUNTY, NC

DATE PRINTED 12/21/01

GIS PUBLIC ACCESS SYSTEM REPORT

Note : Records are sorted in Parcel Number order.

PAGE : 28

Record No.: 82 **BUILDING KEY NUMBER :** 11903202 001
PARCEL-ID : 11903202 **NEIGHBORHOOD CODE :** 11901 **ZONING CLASS :** R4
OWNER'S NAME : ARTIBEE BLANCHE S (BY ENTIRETY)
MAILING ADDRESS : 606 E MAIN ST
CITY : BENNETTSVILLE **STATE :** SC **ZIP CODE :** 295123218

PROPERTY LOCATION : 1332 WEST BV
LEGAL DESC. : L18 B3 M4-409 **DEED BK,PG & DATE :** 02094 /321 1975-01-01
ACREAGE : 0.000 **SALE PRICE :** \$0 **QUALIFIED SALE (Y/N) :** N
LAND VALUE : \$8,080 **IMPVMTS VALUE :** \$37,250 **TOTAL VALUE :** \$45,330

LAND-USE TYPE : SINGLE FAMILY **BUILDING TYPE :** SINGLE FAMILY RESIDENTIAL
YEAR BUILT : 1,948 **SQUARE FEET :** 1,065 **STYLE CODE :** 1.0 STORY
BEDROOMS : 3 **BATHROOMS :** 1 **RESTROOMS :** 0 **BASEMENT :** N **GARAGE :** N
EXTERIOR TYPE : ALUMINUM/VINYL SIDING **QUALITY GRADE :** 2 **IMPVMT. VALUE :** \$36,180
A/C : NONE **FIREPLACE :** 1 STY SINGLE

Record No.: 83 **BUILDING KEY NUMBER :** 11903230 001
PARCEL-ID : 11903230 **NEIGHBORHOOD CODE :** 11901 **ZONING CLASS :** R4
OWNER'S NAME : THOMPSON MARY ALICE
MAILING ADDRESS : 1311 FORDHAM RD
CITY : CHARLOTTE **STATE :** NC **ZIP CODE :** 28208

PROPERTY LOCATION : 1311 FORDHAM RE
LEGAL DESC. : L15 B3 M1166-461 **DEED BK,PG & DATE :** 11691 /114 2000-11-01
ACREAGE : 0.000 **SALE PRICE :** \$64,500 **QUALIFIED SALE (Y/N) :** Y
LAND VALUE : \$8,500 **IMPVMTS VALUE :** \$30,860 **TOTAL VALUE :** \$39,360

LAND-USE TYPE : SINGLE FAMILY **BUILDING TYPE :** SINGLE FAMILY RESIDENTIAL
YEAR BUILT : 1,948 **SQUARE FEET :** 857 **STYLE CODE :** 1.0 STORY
BEDROOMS : 2 **BATHROOMS :** 1 **RESTROOMS :** 0 **BASEMENT :** N **GARAGE :** N
EXTERIOR TYPE : SIDING AVERAGE **QUALITY GRADE :** 2 **IMPVMT. VALUE :** \$30,810
A/C : NONE **FIREPLACE :** NONE

Record No.: 84 **BUILDING KEY NUMBER :** 11903231 001
PARCEL-ID : 11903231 **NEIGHBORHOOD CODE :** 11901 **ZONING CLASS :** R4
OWNER'S NAME : TPM PROPERTIES LIMITED PARTNERSHIP
MAILING ADDRESS : 3816 MOORELAND FARMS RD
CITY : CHARLOTTE **STATE :** NC **ZIP CODE :** 28226

PROPERTY LOCATION : 1319 FORDHAM RE
LEGAL DESC. : L16 B3 M1166-461 **DEED BK,PG & DATE :** 10650 /030 1999-07-29
ACREAGE : 0.000 **SALE PRICE :** \$32,000 **QUALIFIED SALE (Y/N) :** N
LAND VALUE : \$8,000 **IMPVMTS VALUE :** \$40,130 **TOTAL VALUE :** \$48,130

LAND-USE TYPE : SINGLE FAMILY **BUILDING TYPE :** SINGLE FAMILY RESIDENTIAL
YEAR BUILT : 1,948 **SQUARE FEET :** 784 **STYLE CODE :** 1.0 STORY
BEDROOMS : 2 **BATHROOMS :** 1 **RESTROOMS :** 0 **BASEMENT :** N **GARAGE :** Y
EXTERIOR TYPE : ALUMINUM/VINYL SIDING **QUALITY GRADE :** 2 **IMPVMT. VALUE :** \$40,070
A/C : CENTRAL **FIREPLACE :** NONE

NOTE: This data is prepared for the purposes of revaluation, assessing & determining ownership of real property & is compiled from recorded deeds, plats, tax maps & other public records & data. Users of this data are hereby notified that the aforementioned public information sources should be consulted for verification. Mecklenburg County assumes no legal responsibility for the information herein.



MECKLENBURG COUNTY, NC

DATE PRINTED 12/21/01

GIS PUBLIC ACCESS SYSTEM REPORT

Note : Records are sorted in Parcel Number order.

PAGE : 29

Record No.: 85 **BUILDING KEY NUMBER :** 11903332 001
PARCEL-ID : 11903332 **NEIGHBORHOOD CODE :** 11901 **ZONING CLASS :** R4
OWNER'S NAME : BRITTON MARY C (BY WILL)
MAILING ADDRESS : 1339 WEST BLVD
CITY : CHARLOTTE **STATE :** NC **ZIP CODE :** 28208

PROPERTY LOCATION : 1339 WEST BV
LEGAL DESC. : P23 B2 M4-409 **DEED BK,PG & DATE :** 03673 /358 1974-07-25
ACREAGE : 1.000 **SALE PRICE :** \$0 **QUALIFIED SALE (Y/N) :** N
LAND VALUE : \$9,500 **IMPVMTS VALUE :** \$34,050 **TOTAL VALUE :** \$43,550

LAND-USE TYPE : SINGLE FAMILY **BUILDING TYPE :** SINGLE FAMILY RESIDENTIAL
YEAR BUILT : 1,946 **SQUARE FEET :** 930 **STYLE CODE :** 1.0 STORY
BEDROOMS : 2 **BATHROOMS :** 1 **RESTROOMS :** 0 **BASEMENT :** N **GARAGE :** Y
EXTERIOR TYPE : ALUMINUM/VINYL SIDING **QUALITY GRADE :** 2 **IMPVMT. VALUE :** \$33,620
A/C : NONE **FIREPLACE :** 1 STY SINGLE

Record No.: 86 **BUILDING KEY NUMBER :** 11903333 001
PARCEL-ID : 11903333 **NEIGHBORHOOD CODE :** 11901 **ZONING CLASS :** R4
OWNER'S NAME : SANDERS ISABELL H (BY ENTIRETY)
MAILING ADDRESS : 1401 WEST BLVD
CITY : CHARLOTTE **STATE :** NC **ZIP CODE :** 28208

PROPERTY LOCATION : 1401 WEST BV
LEGAL DESC. : L24 B2 M4-409 **DEED BK,PG & DATE :** 03225 /066 1970-12-01
ACREAGE : 1.000 **SALE PRICE :** \$0 **QUALIFIED SALE (Y/N) :** N
LAND VALUE : \$9,500 **IMPVMTS VALUE :** \$41,500 **TOTAL VALUE :** \$51,000

LAND-USE TYPE : SINGLE FAMILY **BUILDING TYPE :** SINGLE FAMILY RESIDENTIAL
YEAR BUILT : 1,945 **SQUARE FEET :** 1,427 **STYLE CODE :** 1.0 STORY
BEDROOMS : 3 **BATHROOMS :** 1 **RESTROOMS :** 0 **BASEMENT :** N **GARAGE :** N
EXTERIOR TYPE : ALUMINUM/VINYL SIDING **QUALITY GRADE :** 2 **IMPVMT. VALUE :** \$39,820
A/C : NONE **FIREPLACE :** NONE

Record No.: 87 **BUILDING KEY NUMBER :** 11903334 001
PARCEL-ID : 11903334 **NEIGHBORHOOD CODE :** 11901 **ZONING CLASS :** R4
OWNER'S NAME : KEY REALTY OF CHARLOTTE INC
MAILING ADDRESS : PO BOX 37288
CITY : CHARLOTTE **STATE :** NC **ZIP CODE :** 28237

PROPERTY LOCATION : 1409 WEST BV
LEGAL DESC. : L25 B2 M967-511 **DEED BK,PG & DATE :** 07210 /162 1993-02-26
ACREAGE : 1.000 **SALE PRICE :** \$14,000 **QUALIFIED SALE (Y/N) :** N
LAND VALUE : \$9,500 **IMPVMTS VALUE :** \$48,390 **TOTAL VALUE :** \$57,890

LAND-USE TYPE : SINGLE FAMILY **BUILDING TYPE :** SINGLE FAMILY RESIDENTIAL
YEAR BUILT : 1,945 **SQUARE FEET :** 1,295 **STYLE CODE :** 1.0 STORY
BEDROOMS : 3 **BATHROOMS :** 1 **RESTROOMS :** 0 **BASEMENT :** N **GARAGE :** N
EXTERIOR TYPE : ALUMINUM/VINYL SIDING **QUALITY GRADE :** 2 **IMPVMT. VALUE :** \$48,010
A/C : NONE **FIREPLACE :** 1 STY SINGLE

NOTE: This data is prepared for the purposes of revaluation, assessing & determining ownership of real property & is compiled from recorded deeds, plats, tax maps & other public records & data. Users of this data are hereby notified that the aforementioned public information sources should be consulted for verification. Mecklenburg County assumes no legal responsibility for the information herein.



MECKLENBURG COUNTY, NC
GIS PUBLIC ACCESS SYSTEM REPORT

DATE PRINTED 12/21/01

Note : Records are sorted in Parcel Number order.

PAGE : 30

Record No.: 88 **BUILDING KEY NUMBER :** 11903335 001
PARCEL-ID : 11903335 **NEIGHBORHOOD CODE :** 11901 **ZONING CLASS :** R4
OWNER'S NAME : MOFFETT ERNEST JR &WF BARBARA ANN
MAILING ADDRESS : 1415 WEST BLVD
CITY : CHARLOTTE **STATE :** NC **ZIP CODE :** 282087045

PROPERTY LOCATION : 1415 WEST BV
LEGAL DESC. : L26 B2 M967-511 **DEED BK,PG & DATE :** 10644 /785 1999-07-28
ACREAGE : 1.000 **SALE PRICE :** \$0 **QUALIFIED SALE (Y/N) :** N
LAND VALUE : \$9,500 **IMPVMTS VALUE :** \$39,320 **TOTAL VALUE :** \$48,820

LAND-USE TYPE : SINGLE FAMILY **BUILDING TYPE :** SINGLE FAMILY RESIDENTIAL
YEAR BUILT : 1,945 **SQUARE FEET :** 1,409 **STYLE CODE :** 1.0 STORY
BEDROOMS : 3 **BATHROOMS :** 1 **RESTROOMS :** 0 **BASEMENT :** N **GARAGE :** N
EXTERIOR TYPE : ALUMINUM/VINYL SIDING **QUALITY GRADE :** 2 **IMPVMT. VALUE :** \$39,320
A/C : NONE **FIREPLACE :** NONE

Record No.: 89 **BUILDING KEY NUMBER :** 11903336 001
PARCEL-ID : 11903336 **NEIGHBORHOOD CODE :** 11901 **ZONING CLASS :** R4
OWNER'S NAME : CLAY JOHNNIE LEE
MAILING ADDRESS : 925 BANNISTER PL
CITY : CHARLOTTE **STATE :** NC **ZIP CODE :** 28213

PROPERTY LOCATION : 1421 WEST BV
LEGAL DESC. : L27 B2 M967-511 **DEED BK,PG & DATE :** 03988 /689 1977-09-23
ACREAGE : 1.000 **SALE PRICE :** \$0 **QUALIFIED SALE (Y/N) :** N
LAND VALUE : \$9,500 **IMPVMTS VALUE :** \$35,780 **TOTAL VALUE :** \$45,280

LAND-USE TYPE : SINGLE FAMILY **BUILDING TYPE :** SINGLE FAMILY RESIDENTIAL
YEAR BUILT : 1,946 **SQUARE FEET :** 963 **STYLE CODE :** 1.0 STORY
BEDROOMS : 2 **BATHROOMS :** 1 **RESTROOMS :** 0 **BASEMENT :** N **GARAGE :** N
EXTERIOR TYPE : ASBESTOS SHINGLE **QUALITY GRADE :** 2 **IMPVMT. VALUE :** \$34,900
A/C : NONE **FIREPLACE :** 1 STY SINGLE

Record No.: 90 **BUILDING KEY NUMBER :** 11903337 001
PARCEL-ID : 11903337 **NEIGHBORHOOD CODE :** 11901 **ZONING CLASS :** O2
OWNER'S NAME : AZIZY HAIM
MAILING ADDRESS : PO BOX 221932
CITY : CHARLOTTE **STATE :** NC **ZIP CODE :** 282221932

PROPERTY LOCATION : 1427 WEST BV
LEGAL DESC. : L28 B2 M967-511 **DEED BK,PG & DATE :** 12676 /505 2001-09-20
ACREAGE : 1.000 **SALE PRICE :** \$71,000 **QUALIFIED SALE (Y/N) :** Y
LAND VALUE : \$28,180 **IMPVMTS VALUE :** \$28,730 **TOTAL VALUE :** \$56,910

LAND-USE TYPE : SINGLE FAMILY **BUILDING TYPE :** SINGLE FAMILY RESIDENTIAL
YEAR BUILT : 1,946 **SQUARE FEET :** 1,027 **STYLE CODE :** 1.0 STORY
BEDROOMS : 3 **BATHROOMS :** 1 **RESTROOMS :** 0 **BASEMENT :** N **GARAGE :** Y
EXTERIOR TYPE : WOOD ON SHEATHING OR PLYWO **QUALITY GRADE :** 2 **IMPVMT. VALUE :** \$28,730
A/C : CENTRAL **FIREPLACE :** 1 STY SINGLE

NOTE: This data is prepared for the purposes of revaluation, assessing & determining ownership of real property & is compiled from recorded deeds, plats, tax maps & other public records & data. Users of this data are hereby notified that the aforementioned public information sources should be consulted for verification. Mecklenburg County assumes no legal responsibility for the information herein.



MECKLENBURG COUNTY, NC

DATE PRINTED 12/21/01

GIS PUBLIC ACCESS SYSTEM REPORT

Note : Records are sorted in Parcel Number order.

PAGE : 31

Record No.: 91 **BUILDING KEY NUMBER :** 11903338 001
PARCEL-ID : 11903338 **NEIGHBORHOOD CODE :** 11901 **ZONING CLASS :** B1
OWNER'S NAME : KIM KYONG SU
MAILING ADDRESS : 6217 WHITEWATER DR
CITY : CHARLOTTE **STATE :** NC **ZIP CODE :** 28214

PROPERTY LOCATION : 1501 WEST BV
LEGAL DESC. : NA **DEED BK,PG & DATE :** 11030 /795 2000-01-14
ACREAGE : 2.000 **SALE PRICE :** \$0 **QUALIFIED SALE (Y/N) :** Y
LAND VALUE : \$67,410 **IMPVMTS VALUE :** \$275,110 **TOTAL VALUE :** \$342,520

LAND-USE TYPE : COMMERCIAL **BUILDING TYPE :** SHOPPING CENTER-STRIP
YEAR BUILT : 1,986 **SQUARE FEET :** 7,154 **STYLE CODE :** 1.0 STORY
BEDROOMS : 0 **BATHROOMS :** 0 **RESTROOMS :** 0 **BASEMENT :** N **GARAGE :** N
EXTERIOR TYPE : CONCRETE BLOCK **QUALITY GRADE :** 2 **IMPVMT. VALUE :** \$272,140
A/C : CENTRAL **FIREPLACE :** NONE

Record No.: 92 **BUILDING KEY NUMBER :** 11903340 001
PARCEL-ID : 11903340 **NEIGHBORHOOD CODE :** 11901 **ZONING CLASS :** B1
OWNER'S NAME : CAYCO REALTY & INVESTMENTS INC
MAILING ADDRESS : PO BOX 12060
CITY : CHARLOTTE **STATE :** NC **ZIP CODE :** 28220

PROPERTY LOCATION : 1529 WEST BV
LEGAL DESC. : L11 & P10 U/M **DEED BK,PG & DATE :** 12422 /430 2001-07-06
ACREAGE : 0.000 **SALE PRICE :** \$0 **QUALIFIED SALE (Y/N) :** Y
LAND VALUE : \$15,240 **IMPVMTS VALUE :** \$85,310 **TOTAL VALUE :** \$100,550

LAND-USE TYPE : COMMERCIAL **BUILDING TYPE :** LOUNGE/NIGHTCLUB
YEAR BUILT : 1,952 **SQUARE FEET :** 6,060 **STYLE CODE :** 1.0 STORY
BEDROOMS : 0 **BATHROOMS :** 0 **RESTROOMS :** 0 **BASEMENT :** Y **GARAGE :** N
EXTERIOR TYPE : WOOD ON SHEATHING OR PLYWO **QUALITY GRADE :** 2 **IMPVMT. VALUE :** \$84,610
A/C : CENTRAL **FIREPLACE :** NONE

Record No.: 93 **BUILDING KEY NUMBER :** 11903341 001
PARCEL-ID : 11903341 **NEIGHBORHOOD CODE :** 11901 **ZONING CLASS :** B1
OWNER'S NAME : HARTFORD CLAY
MAILING ADDRESS : 3200 WAMATH DR
CITY : CHARLOTTE **STATE :** NC **ZIP CODE :** 282104861

PROPERTY LOCATION : 1537 WEST BV
LEGAL DESC. : P12 & 13 U/M **DEED BK,PG & DATE :** 07059 /082 1992-10-16
ACREAGE : 0.000 **SALE PRICE :** \$65,000 **QUALIFIED SALE (Y/N) :** N
LAND VALUE : \$31,500 **IMPVMTS VALUE :** \$60,300 **TOTAL VALUE :** \$91,800

LAND-USE TYPE : COMMERCIAL **BUILDING TYPE :** COMMERCIAL
YEAR BUILT : 1,950 **SQUARE FEET :** 4,633 **STYLE CODE :** 1.0 STORY
BEDROOMS : 0 **BATHROOMS :** 0 **RESTROOMS :** 0 **BASEMENT :** N **GARAGE :** N
EXTERIOR TYPE : WOOD ON SHEATHING OR PLYWO **QUALITY GRADE :** 2 **IMPVMT. VALUE :** \$58,170
A/C : CENTRAL **FIREPLACE :** NONE

NOTE: This data is prepared for the purposes of revaluation, assessing & determining ownership of real property & is compiled from recorded deeds, plats, tax maps & other public records & data. Users of this data are hereby notified that the aforementioned public information sources should be consulted for verification. Mecklenburg County assumes no legal responsibility for the information herein.



MECKLENBURG COUNTY, NC

DATE PRINTED 12/21/01

GIS PUBLIC ACCESS SYSTEM REPORT

Note : Records are sorted in Parcel Number order.

PAGE : 32

Record No.: 94 **BUILDING KEY NUMBER :** 11903342 001
PARCEL-ID : 11903342 **NEIGHBORHOOD CODE :** 11901 **ZONING CLASS :** B1
OWNER'S NAME : PARKS MARTHA H **(BY ENTIRETY)**
MAILING ADDRESS : 4310 CASTLEWOOD RD
CITY : CHARLOTTE **STATE :** NC **ZIP CODE :** 28209

PROPERTY LOCATION : 1541 WEST BV
LEGAL DESC. : L14 WEST BLVD **DEED BK,PG & DATE :** 01577 /283 1975-01-01
ACREAGE : 0.000 **SALE PRICE :** \$0 **QUALIFIED SALE (Y/N) :** N
LAND VALUE : \$16,100 **IMPVMTS VALUE :** \$19,100 **TOTAL VALUE :** \$35,200

LAND-USE TYPE : COMMERCIAL **BUILDING TYPE :** COMMERCIAL
YEAR BUILT : 1,950 **SQUARE FEET :** 1,040 **STYLE CODE :** 1.0 STORY
BEDROOMS : 0 **BATHROOMS :** 0 **RESTROOMS :** 0 **BASEMENT :** N **GARAGE :** N
EXTERIOR TYPE : CONCRETE BLOCK **QUALITY GRADE :** 2 **IMPVMT. VALUE :** \$18,040
A/C : NONE **FIREPLACE :** NONE

Record No.: 95 **BUILDING KEY NUMBER :** 11903343 001
PARCEL-ID : 11903343 **NEIGHBORHOOD CODE :** 11901 **ZONING CLASS :** B1
OWNER'S NAME : ADAMS BARBARA THROWER R/T **(BARBARA THROWER ADAMS TST)**
MAILING ADDRESS : 8237 PENINSULA LN
CITY : SHERRILLS FORD **STATE :** NC **ZIP CODE :** 286739250

PROPERTY LOCATION : 1536 REMOUNT RC
LEGAL DESC. : P15 &STRIP **DEED BK,PG & DATE :** 10768 /049 1999-09-17
ACREAGE : 0.000 **SALE PRICE :** \$0 **QUALIFIED SALE (Y/N) :** N
LAND VALUE : \$23,720 **IMPVMTS VALUE :** \$24,470 **TOTAL VALUE :** \$48,190

LAND-USE TYPE : OFFICE **BUILDING TYPE :** OFFICE
YEAR BUILT : 1,950 **SQUARE FEET :** 1,372 **STYLE CODE :** 1.0 STORY
BEDROOMS : 0 **BATHROOMS :** 0 **RESTROOMS :** 0 **BASEMENT :** N **GARAGE :** N
EXTERIOR TYPE : STUCCO ON CONCRETE BLOCK **QUALITY GRADE :** 1 **IMPVMT. VALUE :** \$22,470
A/C : CENTRAL **FIREPLACE :** NONE

Record No.: 96 **BUILDING KEY NUMBER :** 11903344 001
PARCEL-ID : 11903344 **NEIGHBORHOOD CODE :** 11901 **ZONING CLASS :** O2
OWNER'S NAME : BEACHEM JOHN A
MAILING ADDRESS : 1518 REMOUNT RD
CITY : CHARLOTTE **STATE :** NC **ZIP CODE :** 28208

PROPERTY LOCATION : 1518 REMOUNT RC
LEGAL DESC. : PC U/M **DEED BK,PG & DATE :** 08756 /164 1996-09-27
ACREAGE : 0.000 **SALE PRICE :** \$23,500 **QUALIFIED SALE (Y/N) :** N
LAND VALUE : \$8,820 **IMPVMTS VALUE :** \$30,620 **TOTAL VALUE :** \$39,440

LAND-USE TYPE : SINGLE FAMILY **BUILDING TYPE :** SINGLE FAMILY RESIDENTIAL
YEAR BUILT : 1,950 **SQUARE FEET :** 888 **STYLE CODE :** 1.0 STORY
BEDROOMS : 2 **BATHROOMS :** 1 **RESTROOMS :** 0 **BASEMENT :** N **GARAGE :** N
EXTERIOR TYPE : ALUMINUM/VINYL SIDING **QUALITY GRADE :** 2 **IMPVMT. VALUE :** \$30,620
A/C : NONE **FIREPLACE :** 1 STY SINGLE

NOTE: This data is prepared for the purposes of revaluation, assessing & determining ownership of real property & is compiled from recorded deeds, plats, tax maps & other public records & data. Users of this data are hereby notified that the aforementioned public information sources should be consulted for verification. Mecklenburg County assumes no legal responsibility for the information herein.



MECKLENBURG COUNTY, NC

DATE PRINTED 12/21/01

GIS PUBLIC ACCESS SYSTEM REPORT

Note : Records are sorted in Parcel Number order.

PAGE : 33

Record No.: 97 **BUILDING KEY NUMBER :** 11903345 001
PARCEL-ID : 11903345 **NEIGHBORHOOD CODE :** 11901 **ZONING CLASS :** O2
OWNER'S NAME : PARKS JANICE L & NANCY P DAVIS
MAILING ADDRESS : 4310 CASTLEWOOD RD
CITY : CHARLOTTE **STATE :** NC **ZIP CODE :** 28209

PROPERTY LOCATION : 1512 REMOUNT RC
LEGAL DESC. : LB U/M **DEED BK,PG & DATE :** 09811 /883 1998-07-23
ACREAGE : 0.000 **SALE PRICE :** \$0 **QUALIFIED SALE (Y/N) :** N
LAND VALUE : \$9,450 **IMPVMTS VALUE :** \$46,470 **TOTAL VALUE :** \$55,920

LAND-USE TYPE : SINGLE FAMILY **BUILDING TYPE :** SINGLE FAMILY RESIDENTIAL
YEAR BUILT : 1,948 **SQUARE FEET :** 1,529 **STYLE CODE :** 1.0 STORY
BEDROOMS : 3 **BATHROOMS :** 1 **RESTROOMS :** 0 **BASEMENT :** N **GARAGE :** N
EXTERIOR TYPE : FACE BRICK **QUALITY GRADE :** 2 **IMPVMT. VALUE :** \$46,470
A/C : CENTRAL **FIREPLACE :** 1 STY SINGLE

Record No.: 98 **BUILDING KEY NUMBER :** 11903346 001
PARCEL-ID : 11903346 **NEIGHBORHOOD CODE :** 11901 **ZONING CLASS :** O2
OWNER'S NAME : BENNETT LUCIUS M
MAILING ADDRESS : 1508 REMOUNT RD
CITY : CHARLOTTE **STATE :** NC **ZIP CODE :** 282087060

PROPERTY LOCATION : 1508 REMOUNT RC
LEGAL DESC. : PA U/M **DEED BK,PG & DATE :** 06393 /117 1990-10-30
ACREAGE : 0.000 **SALE PRICE :** \$0 **QUALIFIED SALE (Y/N) :** N
LAND VALUE : \$9,500 **IMPVMTS VALUE :** \$38,610 **TOTAL VALUE :** \$48,110

LAND-USE TYPE : SINGLE FAMILY **BUILDING TYPE :** SINGLE FAMILY RESIDENTIAL
YEAR BUILT : 1,940 **SQUARE FEET :** 1,080 **STYLE CODE :** 1.0 STORY
BEDROOMS : 3 **BATHROOMS :** 1 **RESTROOMS :** 0 **BASEMENT :** N **GARAGE :** N
EXTERIOR TYPE : FACE BRICK **QUALITY GRADE :** 2 **IMPVMT. VALUE :** \$38,610
A/C : NONE **FIREPLACE :** NONE

Record No.: 99 **BUILDING KEY NUMBER :** 11903347 001
PARCEL-ID : 11903347 **NEIGHBORHOOD CODE :** 11901 **ZONING CLASS :** R4
OWNER'S NAME : MCPHAUL ELIZABETH
MAILING ADDRESS : 1500 REMOUNT RD
CITY : CHARLOTTE **STATE :** NC **ZIP CODE :** 28208

PROPERTY LOCATION : 1500 REMOUNT RC
LEGAL DESC. : P5 U/M **DEED BK,PG & DATE :** 11272 /375 2000-05-09
ACREAGE : 0.000 **SALE PRICE :** \$58,000 **QUALIFIED SALE (Y/N) :** Y
LAND VALUE : \$8,000 **IMPVMTS VALUE :** \$46,570 **TOTAL VALUE :** \$54,570

LAND-USE TYPE : SINGLE FAMILY **BUILDING TYPE :** DUPLEX/TRIPLEX
YEAR BUILT : 1,952 **SQUARE FEET :** 1,820 **STYLE CODE :** 1.0 STORY
BEDROOMS : 0 **BATHROOMS :** 2 **RESTROOMS :** 0 **BASEMENT :** N **GARAGE :** N
EXTERIOR TYPE : FACE BRICK **QUALITY GRADE :** 2 **IMPVMT. VALUE :** \$43,750
A/C : NONE **FIREPLACE :** NONE

NOTE: This data is prepared for the purposes of revaluation, assessing & determining ownership of real property & is compiled from recorded deeds, plats, tax maps & other public records & data. Users of this data are hereby notified that the aforementioned public information sources should be consulted for verification. Mecklenburg County assumes no legal responsibility for the information herein.



MECKLENBURG COUNTY, NC

DATE PRINTED 12/21/01

GIS PUBLIC ACCESS SYSTEM REPORT

Note : Records are sorted in Parcel Number order.

PAGE : 34

Record No.: 100 **BUILDING KEY NUMBER :** 11903350 001
PARCEL-ID : 11903350 **NEIGHBORHOOD CODE :** 11901 **ZONING CLASS :** R4
OWNER'S NAME : TPM PROPERTIES (LTD F/P) % THOMAS P MOORE III
MAILING ADDRESS : 3816 MOORELAND FARMS RD
CITY : CHARLOTTE **STATE :** NC **ZIP CODE :** 28226

PROPERTY LOCATION : 2650 BRENTWOOD PL
LEGAL DESC. : L3 B8 M6-243 **DEED BK,PG & DATE :** 07214 /377 1993-03-03
ACREAGE : 0.000 **SALE PRICE :** \$0 **QUALIFIED SALE (Y/N) :** N
LAND VALUE : \$8,000 **IMPVMTS VALUE :** \$35,940 **TOTAL VALUE :** \$43,940

LAND-USE TYPE : SINGLE FAMILY **BUILDING TYPE :** SINGLE FAMILY RESIDENTIAL
YEAR BUILT : 1,948 **SQUARE FEET :** 934 **STYLE CODE :** 1.0 STORY
BEDROOMS : 2 **BATHROOMS :** 1 **RESTROOMS :** 0 **BASEMENT :** N **GARAGE :** N
EXTERIOR TYPE : ASBESTOS SHINGLE **QUALITY GRADE :** 2 **IMPVMT. VALUE :** \$34,130
A/C : NONE **FIREPLACE :** 1 STY SINGLE

Record No.: 101 **BUILDING KEY NUMBER :** 11903351 001
PARCEL-ID : 11903351 **NEIGHBORHOOD CODE :** 11901 **ZONING CLASS :** R4
OWNER'S NAME : TUCKER MILTON G &WF GLORIA H
MAILING ADDRESS : 9493 ROCKY RIVER RD
CITY : HARRISBURG **STATE :** NC **ZIP CODE :** 28075

PROPERTY LOCATION : 2644 BRENTWOOD PL
LEGAL DESC. : L4 B8 M6-243 **DEED BK,PG & DATE :** 06412 /725 1990-12-04
ACREAGE : 0.000 **SALE PRICE :** \$0 **QUALIFIED SALE (Y/N) :** N
LAND VALUE : \$8,000 **IMPVMTS VALUE :** \$45,870 **TOTAL VALUE :** \$53,870

LAND-USE TYPE : SINGLE FAMILY **BUILDING TYPE :** SINGLE FAMILY RESIDENTIAL
YEAR BUILT : 1,948 **SQUARE FEET :** 1,258 **STYLE CODE :** 1.0 STORY
BEDROOMS : 3 **BATHROOMS :** 2 **RESTROOMS :** 0 **BASEMENT :** N **GARAGE :** N
EXTERIOR TYPE : MASONITE ON SHEATHING **QUALITY GRADE :** 2 **IMPVMT. VALUE :** \$45,290
A/C : NONE **FIREPLACE :** 1 STY SINGLE

Record No.: 102 **BUILDING KEY NUMBER :** 11903352 001
PARCEL-ID : 11903352 **NEIGHBORHOOD CODE :** 11901 **ZONING CLASS :** R4
OWNER'S NAME : WELCH BEATRICE (BY ENTIRETY)
MAILING ADDRESS : 2638 BRENTWOOD PL
CITY : CHARLOTTE **STATE :** NC **ZIP CODE :** 28208

PROPERTY LOCATION : 2638 BRENTWOOD PL
LEGAL DESC. : L5 B8 M6-243 **DEED BK,PG & DATE :** 03012 /191 1975-01-01
ACREAGE : 0.000 **SALE PRICE :** \$0 **QUALIFIED SALE (Y/N) :** N
LAND VALUE : \$8,000 **IMPVMTS VALUE :** \$43,010 **TOTAL VALUE :** \$51,010

LAND-USE TYPE : SINGLE FAMILY **BUILDING TYPE :** SINGLE FAMILY RESIDENTIAL
YEAR BUILT : 1,949 **SQUARE FEET :** 1,095 **STYLE CODE :** 1.0 STORY
BEDROOMS : 2 **BATHROOMS :** 1 **RESTROOMS :** 0 **BASEMENT :** N **GARAGE :** N
EXTERIOR TYPE : WOOD ON SHEATHING OR PLYWO **QUALITY GRADE :** 2 **IMPVMT. VALUE :** \$42,960
A/C : NONE **FIREPLACE :** 1 STY SINGLE

NOTE: This data is prepared for the purposes of revaluation, assessing & determining ownership of real property & is compiled from recorded deeds, plats, tax maps & other public records & data. Users of this data are hereby notified that the aforementioned public information sources should be consulted for verification. Mecklenburg County assumes no legal responsibility for the information herein.



MECKLENBURG COUNTY, NC

DATE PRINTED 12/21/01

GIS PUBLIC ACCESS SYSTEM REPORT

Note : Records are sorted in Parcel Number order.

PAGE : 35

Record No.:	103	BUILDING KEY NUMBER :	11903353 001			
PARCEL-ID :	11903353	NEIGHBORHOOD CODE :	11901	ZONING CLASS :	R4	
OWNER'S NAME :	TPM PROPERTIES		% THOMAS P MOORE III			
MAILING ADDRESS :	3816 MOORELAND FARMS RD					
CITY :	CHARLOTTE	STATE :	NC	ZIP CODE :	28226	
PROPERTY LOCATION :	2632	BRENTWOOD	PL			
LEGAL DESC. :	L6 B8 M6-243	DEED BK,PG & DATE : 09168 /863 1997-07-24				
ACREAGE :	0.000	SALE PRICE :	\$20,000	QUALIFIED SALE (Y/N) :	N	
LAND VALUE :	\$8,000	IMPVMTS VALUE :	\$50,000	TOTAL VALUE :	\$58,000	
LAND-USE TYPE :	SINGLE FAMILY		BUILDING TYPE :	SINGLE FAMILY RESIDENTIAL		
YEAR BUILT :	1,949	SQUARE FEET :	1,191	STYLE CODE :	1.0 STORY	
BEDROOMS :	3	BATHROOMS :	1	RESTROOMS :	0	
				BASEMENT :	N	
				GARAGE :	N	
EXTERIOR TYPE :	ALUMINUM/VINYL SIDING		QUALITY GRADE :	2	IMPVMT. VALUE :	\$49,730
A/C :	CENTRAL		FIREPLACE :	1 STY SINGLE		
Record No.:	104	BUILDING KEY NUMBER :	11903354 001			
PARCEL-ID :	11903354	NEIGHBORHOOD CODE :	11901	ZONING CLASS :	R4	
OWNER'S NAME :	FAULCON PROPERTIES LLC					
MAILING ADDRESS :	3424 DONOVAN PL					
CITY :	CHARLOTTE	STATE :	NC	ZIP CODE :	282153100	
PROPERTY LOCATION :	2626	BRENTWOOD	PL			
LEGAL DESC. :	L7 B8 M6-243	DEED BK,PG & DATE : 10433 /782 1999-04-29				
ACREAGE :	0.000	SALE PRICE :	\$0	QUALIFIED SALE (Y/N) :	N	
LAND VALUE :	\$8,000	IMPVMTS VALUE :	\$36,680	TOTAL VALUE :	\$44,680	
LAND-USE TYPE :	SINGLE FAMILY		BUILDING TYPE :	SINGLE FAMILY RESIDENTIAL		
YEAR BUILT :	1,948	SQUARE FEET :	951	STYLE CODE :	1.0 STORY	
BEDROOMS :	2	BATHROOMS :	1	RESTROOMS :	0	
				BASEMENT :	N	
				GARAGE :	N	
EXTERIOR TYPE :	WOOD ON SHEATHING OR PLYWO		QUALITY GRADE :	2	IMPVMT. VALUE :	\$35,200
A/C :	NONE		FIREPLACE :	1 STY SINGLE		
Record No.:	105	BUILDING KEY NUMBER :	11903355 001			
PARCEL-ID :	11903355	NEIGHBORHOOD CODE :	11901	ZONING CLASS :	R4	
OWNER'S NAME :	WILLIAMS WILLIE A		IDA R HATCHER			
MAILING ADDRESS :	2620 BRENTWOOD PL					
CITY :	CHARLOTTE	STATE :	NC	ZIP CODE :	28208	
PROPERTY LOCATION :	2620	BRENTWOOD	PL			
LEGAL DESC. :	L8 B8 M6-243	DEED BK,PG & DATE : 11453 /668 2000-07-27				
ACREAGE :	0.000	SALE PRICE :	\$58,000	QUALIFIED SALE (Y/N) :	Y	
LAND VALUE :	\$8,000	IMPVMTS VALUE :	\$39,480	TOTAL VALUE :	\$47,480	
LAND-USE TYPE :	SINGLE FAMILY		BUILDING TYPE :	SINGLE FAMILY RESIDENTIAL		
YEAR BUILT :	1,949	SQUARE FEET :	946	STYLE CODE :	1.0 STORY	
BEDROOMS :	2	BATHROOMS :	1	RESTROOMS :	0	
				BASEMENT :	N	
				GARAGE :	N	
EXTERIOR TYPE :	SIDING AVERAGE		QUALITY GRADE :	2	IMPVMT. VALUE :	\$38,160
A/C :	CENTRAL		FIREPLACE :	1 STY SINGLE		

NOTE: This data is prepared for the purposes of revaluation, assessing & determining ownership of real property & is compiled from recorded deeds, plats, tax maps & other public records & data. Users of this data are hereby notified that the aforementioned public information sources should be consulted for verification. Mecklenburg County assumes no legal responsibility for the information herein.



MECKLENBURG COUNTY, NC

DATE PRINTED 12/21/01

GIS PUBLIC ACCESS SYSTEM REPORT

Note : Records are sorted in Parcel Number order.

PAGE : 36

Record No.: 106 **BUILDING KEY NUMBER :** 11903356 001
PARCEL-ID : 11903356 **NEIGHBORHOOD CODE :** 11901 **ZONING CLASS :** R4
OWNER'S NAME : MILLER VERLIE &WF ANNIE S
MAILING ADDRESS : 2614 BRENTWOOD PL
CITY : CHARLOTTE **STATE :** NC **ZIP CODE :** 28214

PROPERTY LOCATION : 2614 BRENTWOOD PL
LEGAL DESC. : L9 B8 M6-243 **DEED BK,PG & DATE :** 03914 /355 1977-01-28
ACREAGE : 0.000 **SALE PRICE :** \$0 **QUALIFIED SALE (Y/N) :** N
LAND VALUE : \$8,000 **IMPVMTS VALUE :** \$41,660 **TOTAL VALUE :** \$49,660

LAND-USE TYPE : SINGLE FAMILY **BUILDING TYPE :** SINGLE FAMILY RESIDENTIAL
YEAR BUILT : 1,949 **SQUARE FEET :** 888 **STYLE CODE :** 1.0 STORY
BEDROOMS : 2 **BATHROOMS :** 1 **RESTROOMS :** 0 **BASEMENT :** N **GARAGE :** Y
EXTERIOR TYPE : ASBESTOS SHINGLE **QUALITY GRADE :** 2 **IMPVMT. VALUE :** \$41,660
A/C : NONE **FIREPLACE :** 1 STY SINGLE

Record No.: 107 **BUILDING KEY NUMBER :** 14504120 001
PARCEL-ID : 14504120 **NEIGHBORHOOD CODE :** 14510 **ZONING CLASS :** O2
OWNER'S NAME : FIRST MT ZION BAPTIST CHURCH OF CHARLOTTE THE
MAILING ADDRESS : 1515 REMOUNT RD
CITY : CHARLOTTE **STATE :** NC **ZIP CODE :** 28208

PROPERTY LOCATION : 1515 REMOUNT RC
LEGAL DESC. : P12&14&15B3M4-549 1515 REMOUNT **DEED BK,PG & DATE :** 03257 /353 1971-02-08
ACREAGE : 2.000 **SALE PRICE :** \$0 **QUALIFIED SALE (Y/N) :** N
LAND VALUE : \$95,830 **IMPVMTS VALUE :** \$1,247,610 **TOTAL VALUE :** \$1,343,440

LAND-USE TYPE : OFFICE **BUILDING TYPE :** CHURCH
YEAR BUILT : 1,982 **SQUARE FEET :** 10,563 **STYLE CODE :** 2.0 STORIES
BEDROOMS : 0 **BATHROOMS :** 0 **RESTROOMS :** 0 **BASEMENT :** N **GARAGE :** N
EXTERIOR TYPE : FACE BRICK **QUALITY GRADE :** 2 **IMPVMT. VALUE :** \$610,570
A/C : CENTRAL **FIREPLACE :** NONE

Record No.: 108 **BUILDING KEY NUMBER :** 14504120 002
PARCEL-ID : 14504120 **NEIGHBORHOOD CODE :** 14510 **ZONING CLASS :** O2
OWNER'S NAME : FIRST MT ZION BAPTIST CHURCH OF CHARLOTTE THE
MAILING ADDRESS : 1515 REMOUNT RD
CITY : CHARLOTTE **STATE :** NC **ZIP CODE :** 28208

PROPERTY LOCATION : 1515 REMONT RC
LEGAL DESC. : P12&14&15B3M4-549 1515 REMOUNT **DEED BK,PG & DATE :** 03257 /353 1971-02-08
ACREAGE : 2.000 **SALE PRICE :** \$0 **QUALIFIED SALE (Y/N) :** N
LAND VALUE : \$95,830 **IMPVMTS VALUE :** \$1,247,610 **TOTAL VALUE :** \$1,343,440

LAND-USE TYPE : OFFICE **BUILDING TYPE :** CHURCH
YEAR BUILT : 1,995 **SQUARE FEET :** 7,598 **STYLE CODE :** 1.0 STORY
BEDROOMS : 0 **BATHROOMS :** 0 **RESTROOMS :** 2 **BASEMENT :** N **GARAGE :** N
EXTERIOR TYPE : FACE BRICK **QUALITY GRADE :** 3 **IMPVMT. VALUE :** \$591,650
A/C : CENTRAL **FIREPLACE :** NONE

NOTE: This data is prepared for the purposes of revaluation, assessing & determining ownership of real property & is compiled from recorded deeds, plats, tax maps & other public records & data. Users of this data are hereby notified that the aforementioned public information sources should be consulted for verification. Mecklenburg County assumes no legal responsibility for the information herein.



MECKLENBURG COUNTY, NC

DATE PRINTED 12/21/01

GIS PUBLIC ACCESS SYSTEM REPORT

Note : Records are sorted in Parcel Number order.

PAGE : 37

Record No.: 109 **BUILDING KEY NUMBER :** 14504121 001
PARCEL-ID : 14504121 **NEIGHBORHOOD CODE :** 14510 **ZONING CLASS :** B1
OWNER'S NAME : STRAWN MILDRED E MRS H G
MAILING ADDRESS : 2217 ORTON ST
CITY : CHARLOTTE **STATE :** NC **ZIP CODE :** 28208

PROPERTY LOCATION : 1531 REMOUNT RE
LEGAL DESC. : P16 &19 B3 M4-549 **DEED BK,PG & DATE :** 02276 /490 1975-01-01
ACREAGE : 0.000 **SALE PRICE :** \$0 **QUALIFIED SALE (Y/N) :** N
LAND VALUE : \$21,750 **IMPVMTS VALUE :** \$30,870 **TOTAL VALUE :** \$52,620

LAND-USE TYPE : COMMERCIAL **BUILDING TYPE :** COMMERCIAL
YEAR BUILT : 1,955 **SQUARE FEET :** 3,000 **STYLE CODE :** 1.0 STORY
BEDROOMS : 0 **BATHROOMS :** 0 **RESTROOMS :** 0 **BASEMENT :** N **GARAGE :** N
EXTERIOR TYPE : CONCRETE BLOCK **QUALITY GRADE :** 2 **IMPVMT. VALUE :** \$29,660
A/C : NONE **FIREPLACE :** NONE

Record No.: 110 **BUILDING KEY NUMBER :** 14504122 001
PARCEL-ID : 14504122 **NEIGHBORHOOD CODE :** 14510 **ZONING CLASS :** B1
OWNER'S NAME : CHAN WAI CHI
MAILING ADDRESS : 1535 REMOUNT RD
CITY : CHARLOTTE **STATE :** NC **ZIP CODE :** 28208

PROPERTY LOCATION : 1535 REMOUNT RE
LEGAL DESC. : PT17&18 B3 M4-549 1535 REMOUNT **DEED BK,PG & DATE :** 04563 /296 1982-08-02
ACREAGE : 0.000 **SALE PRICE :** \$0 **QUALIFIED SALE (Y/N) :** N
LAND VALUE : \$36,940 **IMPVMTS VALUE :** \$44,390 **TOTAL VALUE :** \$81,330

LAND-USE TYPE : COMMERCIAL **BUILDING TYPE :** FAST FOODS
YEAR BUILT : 1,972 **SQUARE FEET :** 1,170 **STYLE CODE :** 1.0 STORY
BEDROOMS : 0 **BATHROOMS :** 0 **RESTROOMS :** 0 **BASEMENT :** N **GARAGE :** N
EXTERIOR TYPE : MASONITE ON SHEATHING **QUALITY GRADE :** 2 **IMPVMT. VALUE :** \$40,770
A/C : CENTRAL **FIREPLACE :** NONE

Record No.: 111 **BUILDING KEY NUMBER :** 14504123 001
PARCEL-ID : 14504123 **NEIGHBORHOOD CODE :** 14510 **ZONING CLASS :** B1
OWNER'S NAME : EXCLUSIVELY YOURS HAIR DESIGN INC
MAILING ADDRESS : 1603 WEST BLVD
CITY : CHARLOTTE **STATE :** NC **ZIP CODE :** 282086907

PROPERTY LOCATION : 1603 WEST BV
LEGAL DESC. : P16-19 B3 M4-549 **DEED BK,PG & DATE :** 05388 /451 1986-12-19
ACREAGE : 0.000 **SALE PRICE :** \$72,000 **QUALIFIED SALE (Y/N) :** Y
LAND VALUE : \$29,310 **IMPVMTS VALUE :** \$59,110 **TOTAL VALUE :** \$88,420

LAND-USE TYPE : COMMERCIAL **BUILDING TYPE :** COMMERCIAL
YEAR BUILT : 1,962 **SQUARE FEET :** 2,232 **STYLE CODE :** 1.0 STORY
BEDROOMS : 0 **BATHROOMS :** 0 **RESTROOMS :** 0 **BASEMENT :** N **GARAGE :** N
EXTERIOR TYPE : STUCCO ON TILE OR WOOD FRAM. **QUALITY GRADE :** 3 **IMPVMT. VALUE :** \$55,540
A/C : CENTRAL **FIREPLACE :** NONE

NOTE: This data is prepared for the purposes of revaluation, assessing & determining ownership of real property & is compiled from recorded deeds, plats, tax maps & other public records & data. Users of this data are hereby notified that the aforementioned public information sources should be consulted for verification. Mecklenburg County assumes no legal responsibility for the information herein.



MECKLENBURG COUNTY, NC
GIS PUBLIC ACCESS SYSTEM REPORT

DATE PRINTED 12/21/01

Note : Records are sorted in Parcel Number order.

PAGE : 38

Record No.:	<u>112</u>	BUILDING KEY NUMBER :	14504125 001		
PARCEL-ID :	14504125	NEIGHBORHOOD CODE :	14510	ZONING CLASS :	R4
OWNER'S NAME :	FIRST MT ZION BAPTIST		CHURCH OF CHARLOTTE THE		
MAILING ADDRESS :	1515 REMOUNT RD				
CITY :	CHARLOTTE	STATE :	NC	ZIP CODE :	28208
PROPERTY LOCATION :	2700	COWLES	RE		
LEGAL DESC. :	PTL1M6-3 2700 COWLES RD		DEED BK,PG & DATE : 03257 /357 1974-03-29		
ACREAGE :	0.000	SALE PRICE :	\$0	QUALIFIED SALE (Y/N) :	N
LAND VALUE :	\$7,500	IMPVMTS VALUE:	\$9,120	TOTAL VALUE :	\$16,620
LAND-USE TYPE :	VACANT		BUILDING TYPE :	SINGLE FAMILY RESIDENTIAL	
YEAR BUILT :	0	SQUARE FEET :	0	STYLE CODE :	
BEDROOMS :	0	BATHROOMS :	0	RESTROOMS :	0
EXTERIOR TYPE :				BASEMENT :	N
A/C :				GARAGE :	N
				QUALITY GRADE :	0
				IMPVMT. VALUE :	\$0
				FIREPLACE :	