



* 0 0 B R E A K 0 0 *



**ADVANCED
IMAGING
SYSTEMS**

www.aisimc.com

An Information
Management Company

City of Charlotte – Planning Dept. Scanning Rezoning Files

Petition # _____

Document type:

- Applications
- Correspondence
- Department Comments
- Land Use Consistency
 - Mail Info
 - Mapping
 - Other
- Site Plans



* 0 0 B R E A K 0 0 *

MECKLENBURG COUNTY, NC GIS PUBLIC ACCESS SYSTEM

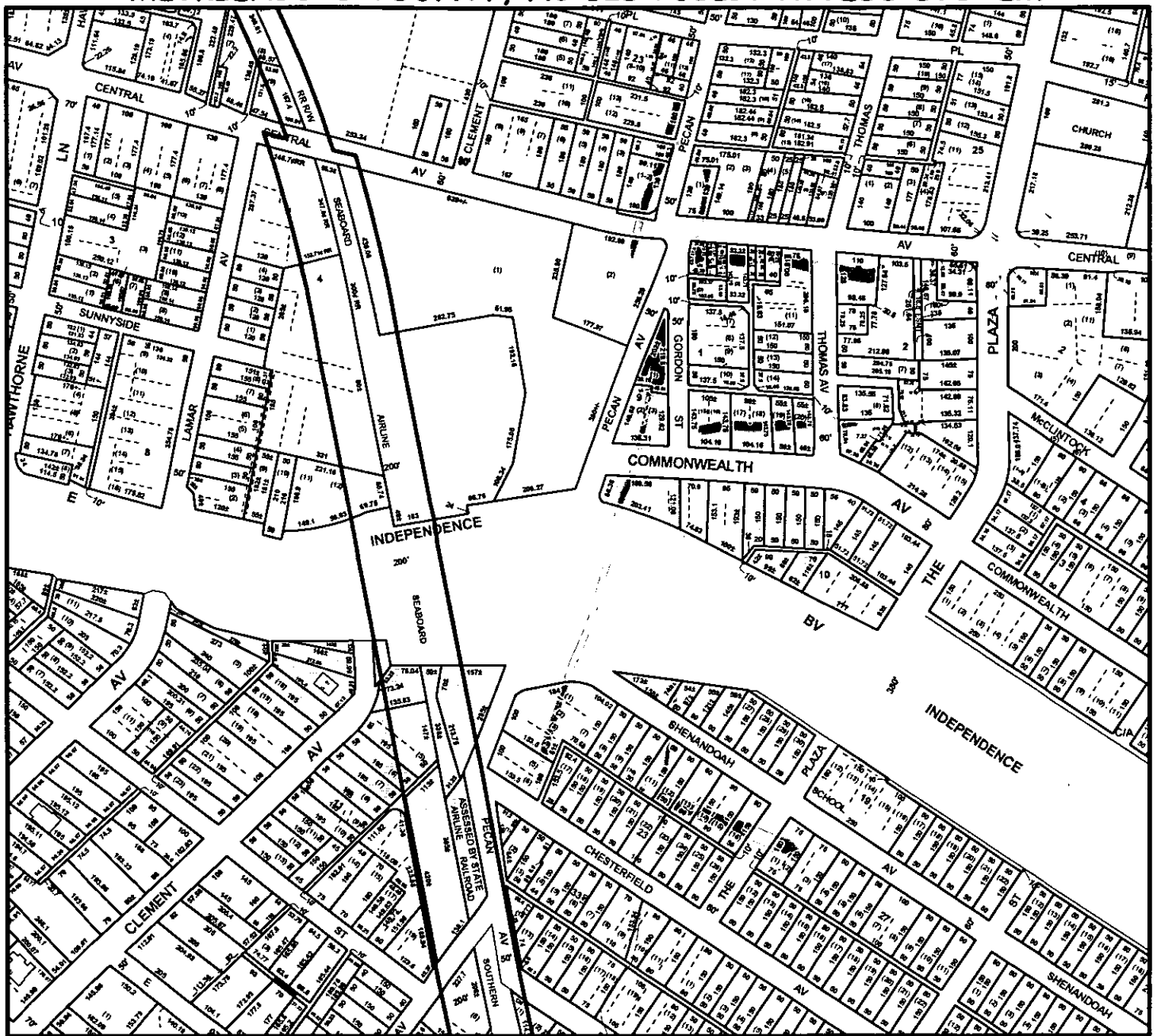

Tax Parcel-Id#s Selected: See Tax Information Report for List of Parcel-Id#s

Tax Book & Page Selected: N/A

LEGEND

- County Boundary
- Rivers/Creeks/Streams
- Railroad ROW
- Water Bodies



02-25

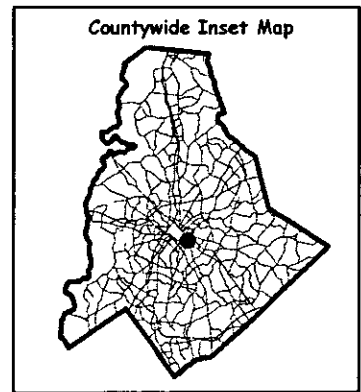
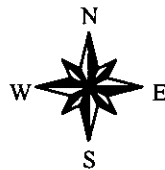

Scale : 1 Inch = 400 Feet
 Map Created on Friday, February 22, 2002 01:29 PM

This map is prepared for the inventory of real property within Mecklenburg County and is compiled from recorded deeds, plats, tax maps, surveys, planimetric maps, and other public records and data. Users of this map are hereby notified that the aforementioned public primary information sources should be consulted for verification. Mecklenburg County and its mapping contractors assume no legal responsibility for the information contained herein.



MECKLENBURG COUNTY, NC

DATE PRINTED 2/22/02

GIS PUBLIC ACCESS SYSTEM REPORT

Note : Records are sorted in Parcel Number order.

PAGE : 1

Record No.: 1 **BUILDING KEY NUMBER :** 08117303 001
PARCEL-ID : 08117303 **NEIGHBORHOOD CODE :** 09511 **ZONING CLASS :** R22MF
OWNER'S NAME : CIRCIO JULIE ANN
MAILING ADDRESS : 1324 THOMAS AVE
CITY : CHARLOTTE **STATE :** NC **ZIP CODE :** 282053442

PROPERTY LOCATION : 1324 THOMAS AV
LEGAL DESC. : L8 B25 M3-2 **DEED BK,PG & DATE :** 11436 /855 2000-07-20
ACREAGE : 0.000 **SALE PRICE :** \$157,000 **QUALIFIED SALE (Y/N) :** Y
LAND VALUE : \$45,000 **IMPVMTS VALUE :** \$61,120 **TOTAL VALUE :** \$106,120

LAND-USE TYPE : SINGLE FAMILY **BUILDING TYPE :** SINGLE FAMILY RESIDENTIAL
YEAR BUILT : 1,919 **SQUARE FEET :** 1,056 **STYLE CODE :** 1.0 STORY
BEDROOMS : 3 **BATHROOMS :** 1 **RESTROOMS :** 0 **BASEMENT :** N **GARAGE :** N
EXTERIOR TYPE : WOOD ON SHEATHING OR PLYWO **QUALITY GRADE :** 2 **IMPVMT. VALUE :** \$61,120
A/C : CENTRAL **FIREPLACE :** 1 STY SINGLE

Record No.: 2 **BUILDING KEY NUMBER :** 08117304 001
PARCEL-ID : 08117304 **NEIGHBORHOOD CODE :** 09511 **ZONING CLASS :** R22MF
OWNER'S NAME : CURETON LELA M (BY ENTIRETY)
MAILING ADDRESS : 1320 THOMAS AVE
CITY : CHARLOTTE **STATE :** NC **ZIP CODE :** 28205

PROPERTY LOCATION : 1320 THOMAS AV
LEGAL DESC. : L7 B25 M3-2 **DEED BK,PG & DATE :** 03855 /777 1976-06-24
ACREAGE : 0.000 **SALE PRICE :** \$0 **QUALIFIED SALE (Y/N) :** N
LAND VALUE : \$45,000 **IMPVMTS VALUE :** \$76,090 **TOTAL VALUE :** \$121,090

LAND-USE TYPE : SINGLE FAMILY **BUILDING TYPE :** SINGLE FAMILY RESIDENTIAL
YEAR BUILT : 1,920 **SQUARE FEET :** 1,503 **STYLE CODE :** 1.0 STORY
BEDROOMS : 3 **BATHROOMS :** 1 **RESTROOMS :** 0 **BASEMENT :** N **GARAGE :** N
EXTERIOR TYPE : FACE BRICK **QUALITY GRADE :** 2 **IMPVMT. VALUE :** \$76,090
A/C : NONE **FIREPLACE :** 1 STY SINGLE

Record No.: 3 **BUILDING KEY NUMBER :** 08117305 001
PARCEL-ID : 08117305 **NEIGHBORHOOD CODE :** 09511 **ZONING CLASS :** R22MF
OWNER'S NAME : NURI HOLLY NASEEM
MAILING ADDRESS : 5851 AMITY SPRINGS DR
CITY : CHARLOTTE **STATE :** NC **ZIP CODE :** 28212

PROPERTY LOCATION : 1316 THOMAS AV
LEGAL DESC. : L6 B25 M195-28 **DEED BK,PG & DATE :** 08756 /349 1996-09-30
ACREAGE : 0.000 **SALE PRICE :** \$0 **QUALIFIED SALE (Y/N) :** N
LAND VALUE : \$45,000 **IMPVMTS VALUE :** \$0 **TOTAL VALUE :** \$45,000

LAND-USE TYPE : VACANT **BUILDING TYPE :** SINGLE FAMILY RESIDENTIAL
YEAR BUILT : 0 **SQUARE FEET :** 0 **STYLE CODE :**
BEDROOMS : 0 **BATHROOMS :** 0 **RESTROOMS :** 0 **BASEMENT :** N **GARAGE :** N
EXTERIOR TYPE : **QUALITY GRADE :** 0 **IMPVMT. VALUE :** \$0
A/C : **FIREPLACE :**

NOTE: This data is prepared for the purposes of revaluation, assessing & determining ownership of real property & is compiled from recorded deeds, plats, tax maps & other public records & data. Users of this data are hereby notified that the aforementioned public information sources should be consulted for verification. Mecklenburg County assumes no legal responsibility for the information herein.



MECKLENBURG COUNTY, NC

DATE PRINTED 2/22/02

GIS PUBLIC ACCESS SYSTEM REPORT

Note : Records are sorted in Parcel Number order.

PAGE : 2

Record No.: 4 BUILDING KEY NUMBER : 08117306 001
PARCEL-ID: 08117306 NEIGHBORHOOD CODE : 09511 ZONING CLASS : B2
OWNER'S NAME: NURI HOLLY NASEEM
MAILING ADDRESS: 5851 AMITY SPRINGS DR
CITY: CHARLOTTE STATE : NC ZIP CODE : 28212

PROPERTY LOCATION: 1312 THOMAS AV
LEGAL DESC.: PT1 & 2 B25 M195-28 DEED BK,PG & DATE : 08756 /349 1996-09-30
ACREAGE: 0.000 SALE PRICE : \$0 QUALIFIED SALE (Y/N) : N
LAND VALUE: \$12,800 IMPVMTS VALUE: \$56,510 TOTAL VALUE : \$69,310

LAND-USE TYPE: SINGLE FAMILY BUILDING TYPE : OFFICE
YEAR BUILT: 1,932 SQUARE FEET : 1,452 STYLE CODE : 1.0 STORY
BEDROOMS: 1 BATHROOMS : 0 RESTROOMS : 0 BASEMENT : N GARAGE : N
EXTERIOR TYPE: WOOD ON SHEATHING OR PLYWO QUALITY GRADE : 2 IMPVMT. VALUE : \$56,510
A/C: CENTRAL FIREPLACE : NONE

Record No.: 5 BUILDING KEY NUMBER : 08117307 001
PARCEL-ID: 08117307 NEIGHBORHOOD CODE : 09511 ZONING CLASS : B2
OWNER'S NAME: HEATH LAND COMPANY LLC
MAILING ADDRESS: 2755 ROLLING HILLS DR
CITY: MONROE STATE : NC ZIP CODE : 28110

PROPERTY LOCATION: 1601 CENTRAL AV
LEGAL DESC.: P1 & 2 B25 M195-28 DEED BK,PG & DATE : 07784 /411 1994-05-20
ACREAGE: 0.000 SALE PRICE : \$0 QUALIFIED SALE (Y/N) : N
LAND VALUE: \$92,400 IMPVMTS VALUE: \$28,530 TOTAL VALUE : \$120,930

LAND-USE TYPE: COMMERCIAL BUILDING TYPE : COMMERCIAL
YEAR BUILT: 1,937 SQUARE FEET : 2,058 STYLE CODE : 1.0 STORY
BEDROOMS: 0 BATHROOMS : 0 RESTROOMS : 0 BASEMENT : N GARAGE : N
EXTERIOR TYPE: CONCRETE BLOCK QUALITY GRADE : 2 IMPVMT. VALUE : \$24,310
A/C: NONE FIREPLACE : NONE

Record No.: 6 BUILDING KEY NUMBER : 08117404 001
PARCEL-ID: 08117404 NEIGHBORHOOD CODE : 09511 ZONING CLASS : R22MF
OWNER'S NAME: NOVAKOVIC VLADO & WF SLADJANA
MAILING ADDRESS: 1314 PECAN AVE
CITY: CHARLOTTE STATE : NC ZIP CODE : 282053412

PROPERTY LOCATION: 1322 PECAN AV
LEGAL DESC.: L10 B24 M195-28 & 29 DEED BK,PG & DATE : 11086 /049 2000-02-15
ACREAGE: 0.000 SALE PRICE : \$0 QUALIFIED SALE (Y/N) : Y
LAND VALUE: \$30,000 IMPVMTS VALUE: \$0 TOTAL VALUE : \$30,000

LAND-USE TYPE: VACANT BUILDING TYPE : SINGLE FAMILY RESIDENTIAL
YEAR BUILT: 0 SQUARE FEET : 0 STYLE CODE :
BEDROOMS: 0 BATHROOMS : 0 RESTROOMS : 0 BASEMENT : N GARAGE : N
EXTERIOR TYPE: QUALITY GRADE : 0 IMPVMT. VALUE : \$0
A/C: FIREPLACE :

NOTE: This data is prepared for the purposes of revaluation, assessing & determining ownership of real property & is compiled from recorded deeds, plats, tax maps & other public records & data. Users of this data are hereby notified that the aforementioned public information sources should be consulted for verification. Mecklenburg County assumes no legal responsibility for the information herein.



MECKLENBURG COUNTY, NC

DATE PRINTED 2/22/02

GIS PUBLIC ACCESS SYSTEM REPORT

Note : Records are sorted in Parcel Number order.

PAGE : 3

Record No.: 7 **BUILDING KEY NUMBER:** 08117405 001
PARCEL-ID: 08117405 **NEIGHBORHOOD CODE:** 09511 **ZONING CLASS:** B2
OWNER'S NAME: NOVAKOVIC VLADO &WF SLADJANA
MAILING ADDRESS: 1314 PECAN AVE
CITY: CHARLOTTE **STATE:** NC **ZIP CODE:** 282053412

PROPERTY LOCATION: 1318 PECAN AV
LEGAL DESC.: L9 B24 M195-709 **DEED BK,PG & DATE:** 11086 /048 2000-02-15
ACREAGE: 0.000 **SALE PRICE:** \$0 **QUALIFIED SALE (Y/N):** Y
LAND VALUE: \$28,540 **IMPVMTS VALUE:** \$610 **TOTAL VALUE:** \$29,150

LAND-USE TYPE: VACANT **BUILDING TYPE:** OFFICE
YEAR BUILT: 0 **SQUARE FEET:** 0 **STYLE CODE:**
BEDROOMS: 0 **BATHROOMS:** 0 **RESTROOMS:** 0 **BASEMENT:** N **GARAGE:** N
EXTERIOR TYPE: **QUALITY GRADE:** 0 **IMPVMT. VALUE:** \$0
A/C: **FIREPLACE:**

Record No.: 8 **BUILDING KEY NUMBER:** 08117406 001
PARCEL-ID: 08117406 **NEIGHBORHOOD CODE:** 09511 **ZONING CLASS:** B2
OWNER'S NAME: NOVAKOVIC VLADO &WF SLADJANA
MAILING ADDRESS: 1314 PECAN AVE
CITY: CHARLOTTE **STATE:** NC **ZIP CODE:** 282053412

PROPERTY LOCATION: 1314 PECAN AV
LEGAL DESC.: L8 B24 M195-28 &29 **DEED BK,PG & DATE:** 11086 /052 2000-02-15
ACREAGE: 0.000 **SALE PRICE:** \$175,000 **QUALIFIED SALE (Y/N):** Y
LAND VALUE: \$28,540 **IMPVMTS VALUE:** \$30,990 **TOTAL VALUE:** \$59,530

LAND-USE TYPE: SINGLE FAMILY **BUILDING TYPE:** OFFICE
YEAR BUILT: 1,920 **SQUARE FEET:** 1,627 **STYLE CODE:** 1.0 STORY
BEDROOMS: 3 **BATHROOMS:** 1 **RESTROOMS:** 0 **BASEMENT:** N **GARAGE:** N
EXTERIOR TYPE: WOOD ON SHEATHING OR PLYWO **QUALITY GRADE:** 1 **IMPVMT. VALUE:** \$30,990
A/C: CENTRAL **FIREPLACE:** NONE

Record No.: 9 **BUILDING KEY NUMBER:** 08117408 001
PARCEL-ID: 08117408 **NEIGHBORHOOD CODE:** 09511 **ZONING CLASS:** B2
OWNER'S NAME: GARMON DAVID E SHIRLEY B GARMON (H/W)
MAILING ADDRESS: PO BOX 16651
CITY: SURFSIDE BEACH **STATE:** SC **ZIP CODE:** 29587

PROPERTY LOCATION: 1501 CENTRAL AV
LEGAL DESC.: P1 B24 M195-28 **DEED BK,PG & DATE:** 04251 /842 1979-09-28
ACREAGE: 0.000 **SALE PRICE:** \$0 **QUALIFIED SALE (Y/N):** N
LAND VALUE: \$64,350 **IMPVMTS VALUE:** \$37,750 **TOTAL VALUE:** \$102,100

LAND-USE TYPE: COMMERCIAL **BUILDING TYPE:** FAST FOODS
YEAR BUILT: 1,930 **SQUARE FEET:** 1,148 **STYLE CODE:** 1.0 STORY
BEDROOMS: 0 **BATHROOMS:** 0 **RESTROOMS:** 0 **BASEMENT:** N **GARAGE:** N
EXTERIOR TYPE: WOOD ON SHEATHING OR PLYWO **QUALITY GRADE:** 2 **IMPVMT. VALUE:** \$34,830
A/C: CENTRAL **FIREPLACE:** NONE

NOTE: This data is prepared for the purposes of revaluation, assessing & determining ownership of real property & is compiled from recorded deeds, plats, tax maps & other public records & data. Users of this data are hereby notified that the aforementioned public information sources should be consulted for verification. Mecklenburg County assumes no legal responsibility for the information herein.



MECKLENBURG COUNTY, NC

DATE PRINTED 2/22/02

GIS PUBLIC ACCESS SYSTEM REPORT

Note : Records are sorted in Parcel Number order.

PAGE : 4

Record No.: 10 **BUILDING KEY NUMBER:** 08117410 001
PARCEL-ID: 08117410 **NEIGHBORHOOD CODE:** 09511 **ZONING CLASS:** B2
OWNER'S NAME: NOVAKOVIC VLADO &WF SLADJANA
MAILING ADDRESS: 609 IDEAL WAY
CITY: CHARLOTTE **STATE:** NC **ZIP CODE:** 282035624

PROPERTY LOCATION: 1511 CENTRAL AV
LEGAL DESC.: L2 &3 &P1 B24 M195-28 &9 **DEED BK,PG & DATE:** 09775 /510 1998-07-02
ACREAGE: 1.000 **SALE PRICE:** \$420,000 **QUALIFIED SALE (Y/N):** N
LAND VALUE: \$117,990 **IMPVMTS VALUE:** \$146,900 **TOTAL VALUE:** \$264,890

LAND-USE TYPE: COMMERCIAL **BUILDING TYPE:** COMMERCIAL
YEAR BUILT: 1,946 **SQUARE FEET:** 3,740 **STYLE CODE:** 1.0 STORY
BEDROOMS: 0 **BATHROOMS:** 0 **RESTROOMS:** 0 **BASEMENT:** N **GARAGE:** N
EXTERIOR TYPE: FACE BRICK **QUALITY GRADE:** 2 **IMPVMT. VALUE:** \$144,860
A/C: CENTRAL **FIREPLACE:** NONE

Record No.: 11 **BUILDING KEY NUMBER:** 08117411 001
PARCEL-ID: 08117411 **NEIGHBORHOOD CODE:** 09511 **ZONING CLASS:** B2
OWNER'S NAME: TRIANTIS PATRICIA K
MAILING ADDRESS: 1111 BEVIS DR
CITY: CHARLOTTE **STATE:** NC **ZIP CODE:** 28209

PROPERTY LOCATION: 1515 CENTRAL AV
LEGAL DESC.: P4 B24 M195-28 **DEED BK,PG & DATE:** 12569 /222 2001-08-17
ACREAGE: 0.000 **SALE PRICE:** \$0 **QUALIFIED SALE (Y/N):** Y
LAND VALUE: \$8,160 **IMPVMTS VALUE:** \$24,680 **TOTAL VALUE:** \$32,840

LAND-USE TYPE: COMMERCIAL **BUILDING TYPE:** COMMERCIAL
YEAR BUILT: 1,946 **SQUARE FEET:** 1,326 **STYLE CODE:** 1.0 STORY
BEDROOMS: 0 **BATHROOMS:** 0 **RESTROOMS:** 0 **BASEMENT:** N **GARAGE:** N
EXTERIOR TYPE: FACE BRICK **QUALITY GRADE:** 2 **IMPVMT. VALUE:** \$24,680
A/C: CENTRAL **FIREPLACE:** NONE

Record No.: 12 **BUILDING KEY NUMBER:** 08117412 001
PARCEL-ID: 08117412 **NEIGHBORHOOD CODE:** 09511 **ZONING CLASS:** B2
OWNER'S NAME: TRIANTIS PATRICIA K
MAILING ADDRESS: 1111 BEVIS DR
CITY: CHARLOTTE **STATE:** NC **ZIP CODE:** 28209

PROPERTY LOCATION: 1517 CENTRAL AV
LEGAL DESC.: P4 B24 M195-28 **DEED BK,PG & DATE:** 12569 /226 2001-08-17
ACREAGE: 0.000 **SALE PRICE:** \$0 **QUALIFIED SALE (Y/N):** Y
LAND VALUE: \$45,840 **IMPVMTS VALUE:** \$35,240 **TOTAL VALUE:** \$81,080

LAND-USE TYPE: COMMERCIAL **BUILDING TYPE:** COMMERCIAL
YEAR BUILT: 1,946 **SQUARE FEET:** 2,928 **STYLE CODE:** 1.0 STORY
BEDROOMS: 0 **BATHROOMS:** 0 **RESTROOMS:** 0 **BASEMENT:** N **GARAGE:** N
EXTERIOR TYPE: FACE BRICK **QUALITY GRADE:** 2 **IMPVMT. VALUE:** \$35,240
A/C: CENTRAL **FIREPLACE:** NONE

NOTE: This data is prepared for the purposes of revaluation, assessing & determining ownership of real property & is compiled from recorded deeds, plats, tax maps & other public records & data. Users of this data are hereby notified that the aforementioned public information sources should be consulted for verification. Mecklenburg County assumes no legal responsibility for the information herein.



MECKLENBURG COUNTY, NC

DATE PRINTED 2/22/02

GIS PUBLIC ACCESS SYSTEM REPORT

Note : Records are sorted in Parcel Number order.

PAGE : 5

Record No.: 13 **BUILDING KEY NUMBER :** 08117413 001
PARCEL-ID : 08117413 **NEIGHBORHOOD CODE :** 09511 **ZONING CLASS :** B2
OWNER'S NAME : JAFFA MICHAEL I (ET-AL)
MAILING ADDRESS : PO BOX 31873
CITY : CHARLOTTE **STATE :** NC **ZIP CODE :** 28231

PROPERTY LOCATION : 1519 CENTRAL AV
LEGAL DESC. : P5 B24 M195-28 &9 **DEED BK,PG & DATE :** 12030 /728 2001-03-20
ACREAGE : 0.000 **SALE PRICE :** \$0 **QUALIFIED SALE (Y/N) :** N
LAND VALUE : \$27,000 **IMPVMTS VALUE :** \$41,620 **TOTAL VALUE :** \$68,620

LAND-USE TYPE : COMMERCIAL **BUILDING TYPE :** COMMERCIAL
YEAR BUILT : 1,946 **SQUARE FEET :** 3,246 **STYLE CODE :** 1.0 STORY
BEDROOMS : 0 **BATHROOMS :** 0 **RESTROOMS :** 0 **BASEMENT :** N **GARAGE :** N
EXTERIOR TYPE : FACE BRICK **QUALITY GRADE :** 2 **IMPVMT. VALUE :** \$41,620
A/C : CENTRAL **FIREPLACE :** NONE

Record No.: 14 **BUILDING KEY NUMBER :** 08117414 001
PARCEL-ID : 08117414 **NEIGHBORHOOD CODE :** 09511 **ZONING CLASS :** B2
OWNER'S NAME : LMH INVESTMENTS LLC
MAILING ADDRESS : 2100 RADCLIFFE AV
CITY : CHARLOTTE **STATE :** NC **ZIP CODE :** 28207

PROPERTY LOCATION : 1521 CENTRAL AV
LEGAL DESC. : P5 B24 M195-28 **DEED BK,PG & DATE :** 11878 /506 2001-01-24
ACREAGE : 0.000 **SALE PRICE :** \$180,000 **QUALIFIED SALE (Y/N) :** Y
LAND VALUE : \$27,000 **IMPVMTS VALUE :** \$43,020 **TOTAL VALUE :** \$70,020

LAND-USE TYPE : WAREHOUSE/INDUSTRIAL **BUILDING TYPE :** WAREHOUSE
YEAR BUILT : 1,946 **SQUARE FEET :** 2,748 **STYLE CODE :** 1.0 STORY
BEDROOMS : 0 **BATHROOMS :** 0 **RESTROOMS :** 0 **BASEMENT :** N **GARAGE :** N
EXTERIOR TYPE : FACE BRICK **QUALITY GRADE :** 2 **IMPVMT. VALUE :** \$43,020
A/C : NONE **FIREPLACE :** NONE

Record No.: 15 **BUILDING KEY NUMBER :** 08117415 001
PARCEL-ID : 08117415 **NEIGHBORHOOD CODE :** 09511 **ZONING CLASS :** B2
OWNER'S NAME : HUGHES NICHOLAS VAHNI HUGHES (H/W)
MAILING ADDRESS : 1525 CENTRAL AV
CITY : CHARLOTTE **STATE :** NC **ZIP CODE :** 28205

PROPERTY LOCATION : 1523 CENTRAL AV
LEGAL DESC. : L6 B24 M7-283 **DEED BK,PG & DATE :** 11703 /214 2000-11-06
ACREAGE : 0.000 **SALE PRICE :** \$130,000 **QUALIFIED SALE (Y/N) :** Y
LAND VALUE : \$36,990 **IMPVMTS VALUE :** \$41,880 **TOTAL VALUE :** \$78,870

LAND-USE TYPE : COMMERCIAL **BUILDING TYPE :** COMMERCIAL
YEAR BUILT : 1,927 **SQUARE FEET :** 2,484 **STYLE CODE :** 2.0 STORIES
BEDROOMS : 0 **BATHROOMS :** 0 **RESTROOMS :** 0 **BASEMENT :** Y **GARAGE :** N
EXTERIOR TYPE : FACE BRICK **QUALITY GRADE :** 2 **IMPVMT. VALUE :** \$41,880
A/C : NONE **FIREPLACE :** NONE

NOTE: This data is prepared for the purposes of revaluation, assessing & determining ownership of real property & is compiled from recorded deeds, plats, tax maps & other public records & data. Users of this data are hereby notified that the aforementioned public information sources should be consulted for verification. Mecklenburg County assumes no legal responsibility for the information herein.



MECKLENBURG COUNTY, NC

DATE PRINTED 2/22/02

GIS PUBLIC ACCESS SYSTEM REPORT

Note : Records are sorted in Parcel Number order.

PAGE : 6

Record No.:	<u>16</u>	BUILDING KEY NUMBER :	08117416 001
PARCEL-ID :	08117416	NEIGHBORHOOD CODE :	09511
OWNER'S NAME :	BARBRE C B	ZONING CLASS :	B2
MAILING ADDRESS :	2300 WHILDEN CT		
CITY :	CHARLOTTE	STATE :	NC
		ZIP CODE :	28211
PROPERTY LOCATION :	1531	CENTRAL	AV
LEGAL DESC. :	L7 & P6 B24 M7-283	DEED BK,PG & DATE :	07621 /743 1994-01-06
ACREAGE :	0.000	SALE PRICE :	\$65,000
		QUALIFIED SALE (Y/N) :	N
LAND VALUE :	\$45,420	IMPVMTS VALUE :	\$86,720
		TOTAL VALUE :	\$132,140
LAND-USE TYPE :	COMMERCIAL	BUILDING TYPE :	COMMERCIAL
YEAR BUILT :	1,947	SQUARE FEET :	5,532
		STYLE CODE :	1.0 STORY
BEDROOMS :	0	BATHROOMS :	0
		RESTROOMS :	0
		BASEMENT :	N
		GARAGE :	N
EXTERIOR TYPE :	FACE BRICK	QUALITY GRADE :	2
		IMPVMT. VALUE :	\$86,720
A/C :	CENTRAL	FIREPLACE :	NONE
Record No.:	<u>17</u>	BUILDING KEY NUMBER :	08117417 001
PARCEL-ID :	08117417	NEIGHBORHOOD CODE :	09511
OWNER'S NAME :	BARBRE C B JR	ZONING CLASS :	B2
MAILING ADDRESS :	2300 WHILDEN CT		
CITY :	CHARLOTTE	STATE :	NC
		ZIP CODE :	28211
PROPERTY LOCATION :	1311	THOMAS	AV
LEGAL DESC. :	1311 THOMAS AVE	DEED BK,PG & DATE :	06588 /346 1987-12-01
ACREAGE :	0.000	SALE PRICE :	\$0
		QUALIFIED SALE (Y/N) :	N
LAND VALUE :	\$14,260	IMPVMTS VALUE :	\$0
		TOTAL VALUE :	\$14,260
LAND-USE TYPE :	VACANT	BUILDING TYPE :	COMMERCIAL
YEAR BUILT :	0	SQUARE FEET :	0
		STYLE CODE :	
BEDROOMS :	0	BATHROOMS :	0
		RESTROOMS :	0
		BASEMENT :	N
		GARAGE :	N
EXTERIOR TYPE :		QUALITY GRADE :	0
		IMPVMT. VALUE :	\$0
A/C :		FIREPLACE :	
Record No.:	<u>18</u>	BUILDING KEY NUMBER :	08117418 001
PARCEL-ID :	08117418	NEIGHBORHOOD CODE :	09511
OWNER'S NAME :	BARBRE C B JR	ZONING CLASS :	R22MF
MAILING ADDRESS :	2300 WHILDEN CT		
CITY :	CHARLOTTE	STATE :	NC
		ZIP CODE :	28211
PROPERTY LOCATION :	1315	THOMAS	AV
LEGAL DESC. :	1315 THOMAS AVE	DEED BK,PG & DATE :	06588 /346 1987-12-01
ACREAGE :	0.000	SALE PRICE :	\$0
		QUALIFIED SALE (Y/N) :	N
LAND VALUE :	\$40,500	IMPVMTS VALUE :	\$0
		TOTAL VALUE :	\$40,500
LAND-USE TYPE :	VACANT	BUILDING TYPE :	SINGLE FAMILY RESIDENTIAL
YEAR BUILT :	0	SQUARE FEET :	0
		STYLE CODE :	
BEDROOMS :	0	BATHROOMS :	0
		RESTROOMS :	0
		BASEMENT :	N
		GARAGE :	N
EXTERIOR TYPE :		QUALITY GRADE :	0
		IMPVMT. VALUE :	\$0
A/C :		FIREPLACE :	

NOTE: This data is prepared for the purposes of revaluation, assessing & determining ownership of real property & is compiled from recorded deeds, plats, tax maps & other public records & data. Users of this data are hereby notified that the aforementioned public information sources should be consulted for verification. Mecklenburg County assumes no legal responsibility for the information herein.



MECKLENBURG COUNTY, NC

DATE PRINTED 2/22/02

GIS PUBLIC ACCESS SYSTEM REPORT

Note : Records are sorted in Parcel Number order.

PAGE : 7

Record No.: 19 **BUILDING KEY NUMBER:** 08117419 001
PARCEL-ID: 08117419 **NEIGHBORHOOD CODE:** 09511 **ZONING CLASS:** R22MF
OWNER'S NAME: BARBEE A C & W JOSIE K
MAILING ADDRESS: 13610 MCCORD RD
CITY: HUNTERSVILLE **STATE:** NC **ZIP CODE:** 28078

PROPERTY LOCATION: 1319 THOMAS AV
LEGAL DESC.: L14PT13 B24 M195 28 1319 THOMA **DEED BK,PG & DATE:** 02897 /128 1975-01-01
ACREAGE: 0.000 **SALE PRICE:** \$0 **QUALIFIED SALE (Y/N):** N
LAND VALUE: \$45,000 **IMPVMTS VALUE:** \$51,120 **TOTAL VALUE:** \$96,120

LAND-USE TYPE: SINGLE FAMILY **BUILDING TYPE:** SINGLE FAMILY RESIDENTIAL
YEAR BUILT: 1,920 **SQUARE FEET:** 1,389 **STYLE CODE:** 1.0 STORY
BEDROOMS: 3 **BATHROOMS:** 1 **RESTROOMS:** 0 **BASEMENT:** N **GARAGE:** N
EXTERIOR TYPE: WOOD ON SHEATHING OR PLYWO **QUALITY GRADE:** 2 **IMPVMT. VALUE:** \$48,860
A/C: NONE **FIREPLACE:** NONE

Record No.: 20 **BUILDING KEY NUMBER:** 08117420 001
PARCEL-ID: 08117420 **NEIGHBORHOOD CODE:** 09511 **ZONING CLASS:** R22MF
OWNER'S NAME: BARBEE A C & W JOSIE K
MAILING ADDRESS: 13610 MCCORD RD
CITY: HUNTERSVILLE **STATE:** NC **ZIP CODE:** 28078

PROPERTY LOCATION: 1323 THOMAS AV
LEGAL DESC.: L15 B24 M195-28 1323 THOMAS AV **DEED BK,PG & DATE:** 03057 /108 1975-01-01
ACREAGE: 0.000 **SALE PRICE:** \$0 **QUALIFIED SALE (Y/N):** N
LAND VALUE: \$45,000 **IMPVMTS VALUE:** \$71,760 **TOTAL VALUE:** \$116,760

LAND-USE TYPE: SINGLE FAMILY **BUILDING TYPE:** SINGLE FAMILY RESIDENTIAL
YEAR BUILT: 1,940 **SQUARE FEET:** 540 **STYLE CODE:** 1.0 STORY
BEDROOMS: 1 **BATHROOMS:** 1 **RESTROOMS:** 0 **BASEMENT:** N **GARAGE:** Y
EXTERIOR TYPE: WOOD ON SHEATHING OR PLYWO **QUALITY GRADE:** 2 **IMPVMT. VALUE:** \$31,580
A/C: NONE **FIREPLACE:** NONE

Record No.: 21 **BUILDING KEY NUMBER:** 08117420 002
PARCEL-ID: 08117420 **NEIGHBORHOOD CODE:** 09511 **ZONING CLASS:** R22MF
OWNER'S NAME: BARBEE A C & W JOSIE K
MAILING ADDRESS: 13610 MCCORD RD
CITY: HUNTERSVILLE **STATE:** NC **ZIP CODE:** 28078

PROPERTY LOCATION: 1323 THOMAS AVE
LEGAL DESC.: L15 B24 M195-28 1323 THOMAS AV **DEED BK,PG & DATE:** 03057 /108 1975-01-01
ACREAGE: 0.000 **SALE PRICE:** \$0 **QUALIFIED SALE (Y/N):** N
LAND VALUE: \$45,000 **IMPVMTS VALUE:** \$71,760 **TOTAL VALUE:** \$116,760

LAND-USE TYPE: SINGLE FAMILY **BUILDING TYPE:** SINGLE FAMILY RESIDENTIAL
YEAR BUILT: 1,925 **SQUARE FEET:** 1,442 **STYLE CODE:** 1.0 STORY
BEDROOMS: 3 **BATHROOMS:** 1 **RESTROOMS:** 0 **BASEMENT:** N **GARAGE:** N
EXTERIOR TYPE: WOOD ON SHEATHING OR PLYWO **QUALITY GRADE:** 1 **IMPVMT. VALUE:** \$40,180
A/C: NONE **FIREPLACE:** NONE

NOTE: This data is prepared for the purposes of revaluation, assessing & determining ownership of real property & is compiled from recorded deeds, plats, tax maps & other public records & data. Users of this data are hereby notified that the aforementioned public information sources should be consulted for verification. Mecklenburg County assumes no legal responsibility for the information herein.



MECKLENBURG COUNTY, NC

DATE PRINTED 2/22/02

GIS PUBLIC ACCESS SYSTEM REPORT

Note : Records are sorted in Parcel Number order.

PAGE : 8

Record No.: 22 **BUILDING KEY NUMBER :** 08117507 001
PARCEL-ID : 08117507 **NEIGHBORHOOD CODE :** 09511 **ZONING CLASS :** B2
OWNER'S NAME : CHOW THOMAS A &WF ZUET CHI LEE (EST)% SING CHOW
MAILING ADDRESS : 3379 AZTEC RD # 23E
CITY : ATLANTA **STATE :** GA **ZIP CODE :** 303403253

PROPERTY LOCATION : 1415 CENTRAL AV
LEGAL DESC. : 1415 CENTRAL AVE **DEED BK,PG & DATE :** 03469 /149 1972-10-26
ACREAGE : 0.000 **SALE PRICE :** \$0 **QUALIFIED SALE (Y/N) :** N
LAND VALUE : \$59,400 **IMPVMTS VALUE :** \$85,800 **TOTAL VALUE :** \$145,200

LAND-USE TYPE : COMMERCIAL **BUILDING TYPE :** COMMERCIAL
YEAR BUILT : 1,955 **SQUARE FEET :** 3,066 **STYLE CODE :** 1.0 STORY
BEDROOMS : 0 **BATHROOMS :** 0 **RESTROOMS :** 0 **BASEMENT :** N **GARAGE :** N
EXTERIOR TYPE : FACE BRICK **QUALITY GRADE :** 2 **IMPVMT. VALUE :** \$41,720
A/C : NONE **FIREPLACE :** NONE

Record No.: 23 **BUILDING KEY NUMBER :** 08117507 002
PARCEL-ID : 08117507 **NEIGHBORHOOD CODE :** 09511 **ZONING CLASS :** B2
OWNER'S NAME : CHOW THOMAS A &WF ZUET CHI LEE (EST)% SING CHOW
MAILING ADDRESS : 3379 AZTEC RD # 23E
CITY : ATLANTA **STATE :** GA **ZIP CODE :** 303403253

PROPERTY LOCATION : CENTRAL AV
LEGAL DESC. : 1415 CENTRAL AVE **DEED BK,PG & DATE :** 03469 /149 1972-10-26
ACREAGE : 0.000 **SALE PRICE :** \$0 **QUALIFIED SALE (Y/N) :** N
LAND VALUE : \$59,400 **IMPVMTS VALUE :** \$85,800 **TOTAL VALUE :** \$145,200

LAND-USE TYPE : SINGLE FAMILY **BUILDING TYPE :** SINGLE FAMILY RESIDENTIAL
YEAR BUILT : 1,935 **SQUARE FEET :** 1,376 **STYLE CODE :** 1.0 STORY
BEDROOMS : 3 **BATHROOMS :** 1 **RESTROOMS :** 0 **BASEMENT :** N **GARAGE :** N
EXTERIOR TYPE : SIDING AVERAGE **QUALITY GRADE :** 2 **IMPVMT. VALUE :** \$42,270
A/C : NONE **FIREPLACE :** 1 STY SINGLE

Record No.: 24 **BUILDING KEY NUMBER :** 08117508 001
PARCEL-ID : 08117508 **NEIGHBORHOOD CODE :** 09511 **ZONING CLASS :** B2
OWNER'S NAME : PUTNAM ORRI JÁY PLAZA BEAUTY SCHOOL %SEGREST I
MAILING ADDRESS : PO BOX 30563
CITY : CHARLOTTE **STATE :** NC **ZIP CODE :** 28230

PROPERTY LOCATION : 1419 CENTRAL AV
LEGAL DESC. : L5 B23 M332-10 **DEED BK,PG & DATE :** 05975 /732 1989-02-22
ACREAGE : 0.000 **SALE PRICE :** \$160,000 **QUALIFIED SALE (Y/N) :** Y
LAND VALUE : \$54,000 **IMPVMTS VALUE :** \$109,340 **TOTAL VALUE :** \$163,340

LAND-USE TYPE : COMMERCIAL **BUILDING TYPE :** COMMERCIAL
YEAR BUILT : 1,956 **SQUARE FEET :** 5,760 **STYLE CODE :** 2.0 STORIES
BEDROOMS : 0 **BATHROOMS :** 0 **RESTROOMS :** 0 **BASEMENT :** N **GARAGE :** N
EXTERIOR TYPE : FACE BRICK **QUALITY GRADE :** 2 **IMPVMT. VALUE :** \$109,340
A/C : CENTRAL **FIREPLACE :** NONE

NOTE: This data is prepared for the purposes of revaluation, assessing & determining ownership of real property & is compiled from recorded deeds, plats, tax maps & other public records & data. Users of this data are hereby notified that the aforementioned public information sources should be consulted for verification. Mecklenburg County assumes no legal responsibility for the information herein.



MECKLENBURG COUNTY, NC

DATE PRINTED 2/22/02

GIS PUBLIC ACCESS SYSTEM REPORT

Note : Records are sorted in Parcel Number order.

PAGE : 9

Record No.: 25 **BUILDING KEY NUMBER:** 08117509 001
PARCEL-ID: 08117509 **NEIGHBORHOOD CODE:** 09511 **ZONING CLASS:** B2
OWNER'S NAME: SQUIRES REALTY INC % TBC TAX #016730
MAILING ADDRESS: PO BOX 35370
CITY: LOUISVILLE **STATE:** KY **ZIP CODE:** 402325370

PROPERTY LOCATION: 1421 **CENTRAL** **AV**
LEGAL DESC.: L4 B23 M332-10 **DEED BK,PG & DATE:** 03010 /164 1975-01-01
ACREAGE: 0.000 **SALE PRICE:** \$0 **QUALIFIED SALE (Y/N):** N
LAND VALUE: \$54,000 **IMPVMTS VALUE:** \$3,470 **TOTAL VALUE:** \$57,470

LAND-USE TYPE: VACANT **BUILDING TYPE:** COMMERCIAL
YEAR BUILT: 0 **SQUARE FEET:** 0 **STYLE CODE:**
BEDROOMS: 0 **BATHROOMS:** 0 **RESTROOMS:** 0 **BASEMENT:** N **GARAGE:** N
EXTERIOR TYPE: **QUALITY GRADE:** 0 **IMPVMT. VALUE:** \$0
A/C: **FIREPLACE:**

Record No.: 26 **BUILDING KEY NUMBER:** 08117510 001
PARCEL-ID: 08117510 **NEIGHBORHOOD CODE:** 09511 **ZONING CLASS:** B2
OWNER'S NAME: SQUIRES REALTY INC % TBC TAX #016730
MAILING ADDRESS: PO BOX 35370
CITY: LOUISVILLE **STATE:** KY **ZIP CODE:** 402325370

PROPERTY LOCATION: 1425 **CENTRAL** **AV**
LEGAL DESC.: L3 B23 M332-10 **DEED BK,PG & DATE:** 03010 /171 1975-01-01
ACREAGE: 0.000 **SALE PRICE:** \$0 **QUALIFIED SALE (Y/N):** N
LAND VALUE: \$54,000 **IMPVMTS VALUE:** \$74,590 **TOTAL VALUE:** \$128,590

LAND-USE TYPE: WAREHOUSE/INDUSTRIAL **BUILDING TYPE:** CAR WASH
YEAR BUILT: 2,000 **SQUARE FEET:** 1,496 **STYLE CODE:** 1.0 STORY
BEDROOMS: 0 **BATHROOMS:** 0 **RESTROOMS:** 0 **BASEMENT:** N **GARAGE:** N
EXTERIOR TYPE: FACE BRICK **QUALITY GRADE:** 2 **IMPVMT. VALUE:** \$67,440
A/C: NONE **FIREPLACE:** NONE

Record No.: 27 **BUILDING KEY NUMBER:** 08117511A001
PARCEL-ID: 08117511 **NEIGHBORHOOD CODE:** 09511 **ZONING CLASS:** B2
OWNER'S NAME: ELMORE WALTER R & SES PROPERTIES LLC
MAILING ADDRESS: 4800 WORTHFORD CT
CITY: CHARLOTTE **STATE:** NC **ZIP CODE:** 28226

PROPERTY LOCATION: 1429 **CENTRAL** **AV**
LEGAL DESC.: NA **DEED BK,PG & DATE:** 07192 /556 1993-02-08
ACREAGE: 0.000 **SALE PRICE:** \$0 **QUALIFIED SALE (Y/N):** N
LAND VALUE: \$87,380 **IMPVMTS VALUE:** \$0 **TOTAL VALUE:** \$87,380

LAND-USE TYPE: VACANT **BUILDING TYPE:** COMMERCIAL
YEAR BUILT: 0 **SQUARE FEET:** 0 **STYLE CODE:**
BEDROOMS: 0 **BATHROOMS:** 0 **RESTROOMS:** 0 **BASEMENT:** N **GARAGE:** N
EXTERIOR TYPE: **QUALITY GRADE:** 0 **IMPVMT. VALUE:** \$0
A/C: **FIREPLACE:**

NOTE: This data is prepared for the purposes of reevaluation, assessing & determining ownership of real property & is compiled from recorded deeds, plats, tax maps & other public records & data. Users of this data are hereby notified that the aforementioned public information sources should be consulted for verification. Mecklenburg County assumes no legal responsibility for the information herein.



MECKLENBURG COUNTY, NC

DATE PRINTED 2/22/02

GIS PUBLIC ACCESS SYSTEM REPORT

Note : Records are sorted in Parcel Number order.

PAGE : 10

Record No.: 28 **BUILDING KEY NUMBER:** 08117511B001
PARCEL-ID: 08117511 **NEIGHBORHOOD CODE:** 09511 **ZONING CLASS:**
OWNER'S NAME: WALTERS LACY
MAILING ADDRESS: 1817 WOODLEA RD
CITY: CHARLOTTE **STATE:** NC **ZIP CODE:** 28211

PROPERTY LOCATION: 1429 CENTRAL AV
LEGAL DESC.: BLDG LSD LD 1429 CENTRAL AVE **DEED BK,PG & DATE:** 07192 /562 1993-02-08
ACREAGE: 0.000 **SALE PRICE:** \$0 **QUALIFIED SALE (Y/N):** N
LAND VALUE: \$0 **IMPVMTS VALUE:** \$25,520 **TOTAL VALUE:** \$25,520

LAND-USE TYPE: COMMERCIAL **BUILDING TYPE:** FAST FOODS
YEAR BUILT: 1,950 **SQUARE FEET:** 668 **STYLE CODE:** 1.0 STORY
BEDROOMS: 0 **BATHROOMS:** 0 **RESTROOMS:** 0 **BASEMENT:** N **GARAGE:** N
EXTERIOR TYPE: STUCCO ON CONCRETE BLOCK **QUALITY GRADE:** 3 **IMPVMT. VALUE:** \$20,820
A/C: NONE **FIREPLACE:** NONE

Record No.: 29 **BUILDING KEY NUMBER:** 08117512 001
PARCEL-ID: 08117512 **NEIGHBORHOOD CODE:** 09511 **ZONING CLASS:** B2
OWNER'S NAME: SQUIRES REALTY INC
MAILING ADDRESS: 916 PECAN AVE
CITY: CHARLOTTE **STATE:** NC **ZIP CODE:** 282055032

PROPERTY LOCATION: 1311 PECAN AV
LEGAL DESC.: NA **DEED BK,PG & DATE:** 02489 /377 1975-01-01
ACREAGE: 0.000 **SALE PRICE:** \$0 **QUALIFIED SALE (Y/N):** N
LAND VALUE: \$14,400 **IMPVMTS VALUE:** \$35,970 **TOTAL VALUE:** \$50,370

LAND-USE TYPE: COMMERCIAL **BUILDING TYPE:** COMMERCIAL
YEAR BUILT: 1,930 **SQUARE FEET:** 1,470 **STYLE CODE:** 1.0 STORY
BEDROOMS: 0 **BATHROOMS:** 0 **RESTROOMS:** 0 **BASEMENT:** N **GARAGE:** N
EXTERIOR TYPE: WOOD ON SHEATHING OR PLYWO **QUALITY GRADE:** 2 **IMPVMT. VALUE:** \$35,010
A/C: CENTRAL **FIREPLACE:** NONE

Record No.: 30 **BUILDING KEY NUMBER:** 08117513 001
PARCEL-ID: 08117513 **NEIGHBORHOOD CODE:** 09511 **ZONING CLASS:** B2
OWNER'S NAME: SQUIRES REALTY INC
MAILING ADDRESS: 1315 PECAN AVE
CITY: CHARLOTTE **STATE:** NC **ZIP CODE:** 28205

PROPERTY LOCATION: 1321 PECAN AV
LEGAL DESC.: L12 & 13 B23 M332-10 **DEED BK,PG & DATE:** 02489 /377 1975-01-01
ACREAGE: 1.000 **SALE PRICE:** \$0 **QUALIFIED SALE (Y/N):** N
LAND VALUE: \$73,760 **IMPVMTS VALUE:** \$239,510 **TOTAL VALUE:** \$313,270

LAND-USE TYPE: WAREHOUSE/INDUSTRIAL **BUILDING TYPE:** PREFAB WAREHOUSE
YEAR BUILT: 1,982 **SQUARE FEET:** 10,495 **STYLE CODE:** 1.0 STORY
BEDROOMS: 0 **BATHROOMS:** 0 **RESTROOMS:** 0 **BASEMENT:** N **GARAGE:** N
EXTERIOR TYPE: CONCRETE BLOCK **QUALITY GRADE:** 2 **IMPVMT. VALUE:** \$231,110
A/C: NONE **FIREPLACE:** NONE

NOTE: This data is prepared for the purposes of revaluation, assessing & determining ownership of real property & is compiled from recorded deeds, plats, tax maps & other public records & data. Users of this data are hereby notified that the aforementioned public information sources should be consulted for verification. Mecklenburg County assumes no legal responsibility for the information herein.



MECKLENBURG COUNTY, NC

DATE PRINTED 2/22/02

GIS PUBLIC ACCESS SYSTEM REPORT

Note : Records are sorted in Parcel Number order.

PAGE : 11

Record No.: 31 **BUILDING KEY NUMBER :** 08117601 001
PARCEL-ID : 08117601 **NEIGHBORHOOD CODE :** 08105 **ZONING CLASS :** B2
OWNER'S NAME : RUSS-MAR PROPERTIES
MAILING ADDRESS : 1506-A CENTRAL AV
CITY : CHARLOTTE **STATE :** NC **ZIP CODE :** 28205

PROPERTY LOCATION : 1212 PECAN AV
LEGAL DESC. : L1 &P3 B9 M230-248 **DEED BK,PG & DATE :** 11610 /685 2000-09-29
ACREAGE : 0.000 **SALE PRICE :** \$200,000 **QUALIFIED SALE (Y/N) :** N
LAND VALUE : \$30,660 **IMPVMTS VALUE :** \$44,070 **TOTAL VALUE :** \$74,730

LAND-USE TYPE : COMMERCIAL **BUILDING TYPE :** COMMERCIAL
YEAR BUILT : 1,935 **SQUARE FEET :** 3,868 **STYLE CODE :** 2.0 STORIES
BEDROOMS : 0 **BATHROOMS :** 0 **RESTROOMS :** 0 **BASEMENT :** Y **GARAGE :** N
EXTERIOR TYPE : FACE BRICK **QUALITY GRADE :** 2 **IMPVMT. VALUE :** \$43,730
A/C : CENTRAL **FIREPLACE :** NONE

Record No.: 32 **BUILDING KEY NUMBER :** 08117602 001
PARCEL-ID : 08117602 **NEIGHBORHOOD CODE :** 08105 **ZONING CLASS :** B2
OWNER'S NAME : KING JACK N &WF KATHERINE M
MAILING ADDRESS : 1809 COMMONWEALTH AVE
CITY : CHARLOTTE **STATE :** NC **ZIP CODE :** 28205

PROPERTY LOCATION : 1801 COMMONWEALTH AV
LEGAL DESC. : L2 & 3 B9 M230-248 **DEED BK,PG & DATE :** 08303 /682 1995-09-27
ACREAGE : 0.000 **SALE PRICE :** \$0 **QUALIFIED SALE (Y/N) :** N
LAND VALUE : \$90,590 **IMPVMTS VALUE :** \$126,290 **TOTAL VALUE :** \$216,880

LAND-USE TYPE : COMMERCIAL **BUILDING TYPE :** COMMERCIAL
YEAR BUILT : 1,946 **SQUARE FEET :** 7,020 **STYLE CODE :** 2.0 STORIES
BEDROOMS : 0 **BATHROOMS :** 0 **RESTROOMS :** 0 **BASEMENT :** N **GARAGE :** N
EXTERIOR TYPE : CONCRETE BLOCK **QUALITY GRADE :** 2 **IMPVMT. VALUE :** \$118,360
A/C : CENTRAL **FIREPLACE :** NONE

Record No.: 33 **BUILDING KEY NUMBER :** 08117604 001
PARCEL-ID : 08117604 **NEIGHBORHOOD CODE :** 08105 **ZONING CLASS :** B2
OWNER'S NAME : BAKER MICHAEL F &WF PATTIE SUE D
MAILING ADDRESS : 11217 WINDY GROVE RD
CITY : CHARLOTTE **STATE :** NC **ZIP CODE :** 28208

PROPERTY LOCATION : 1800 COMMONWEALTH AV
LEGAL DESC. : NA **DEED BK,PG & DATE :** 04393 /552 1981-01-23
ACREAGE : 0.000 **SALE PRICE :** \$0 **QUALIFIED SALE (Y/N) :** N
LAND VALUE : \$107,580 **IMPVMTS VALUE :** \$29,500 **TOTAL VALUE :** \$137,080

LAND-USE TYPE : WAREHOUSE/INDUSTRIAL **BUILDING TYPE :** SERVICE GARAGE
YEAR BUILT : 1,953 **SQUARE FEET :** 1,798 **STYLE CODE :** 1.0 STORY
BEDROOMS : 0 **BATHROOMS :** 0 **RESTROOMS :** 0 **BASEMENT :** N **GARAGE :** N
EXTERIOR TYPE : **QUALITY GRADE :** 2 **IMPVMT. VALUE :** \$20,300
A/C : NONE **FIREPLACE :** NONE

NOTE: This data is prepared for the purposes of revaluation, assessing & determining ownership of real property & is compiled from recorded deeds, plats, tax maps & other public records & data. Users of this data are hereby notified that the aforementioned public information sources should be consulted for verification. Mecklenburg County assumes no legal responsibility for the information herein.



MECKLENBURG COUNTY, NC

DATE PRINTED 2/22/02

GIS PUBLIC ACCESS SYSTEM REPORT

Note : Records are sorted in Parcel Number order.

PAGE : 12

Record No.: 34 **BUILDING KEY NUMBER :** 08117605 001
PARCEL-ID : 08117605 **NEIGHBORHOOD CODE :** 08105 **ZONING CLASS :** B2
OWNER'S NAME : VANDEVERE J C &WF PATRICIA D
MAILING ADDRESS : PO BOX 37288
CITY : CHARLOTTE **STATE :** NC **ZIP CODE :** 28237

PROPERTY LOCATION : 1401 E INDEPENDENCE BV
LEGAL DESC. : L1P2STR M230-248 1401 E INDEP **DEED BK,PG & DATE :** 03954 /383 1977-06-15
ACREAGE : 0.000 **SALE PRICE :** \$0 **QUALIFIED SALE (Y/N) :** N
LAND VALUE : \$48,690 **IMPVMTS VALUE :** \$47,310 **TOTAL VALUE :** \$96,000

LAND-USE TYPE : SINGLE FAMILY **BUILDING TYPE :** MEDICAL BUILDING
YEAR BUILT : 1,954 **SQUARE FEET :** 1,208 **STYLE CODE :** 1.0 STORY
BEDROOMS : 0 **BATHROOMS :** 0 **RESTROOMS :** 0 **BASEMENT :** N **GARAGE :** N
EXTERIOR TYPE : FACE BRICK **QUALITY GRADE :** 2 **IMPVMT. VALUE :** \$27,720
A/C : CENTRAL **FIREPLACE :** NONE

Record No.: 35 **BUILDING KEY NUMBER :** 08117605 002
PARCEL-ID : 08117605 **NEIGHBORHOOD CODE :** 08105 **ZONING CLASS :** B2
OWNER'S NAME : VANDEVERE J C &WF PATRICIA D
MAILING ADDRESS : PO BOX 37288
CITY : CHARLOTTE **STATE :** NC **ZIP CODE :** 28237

PROPERTY LOCATION : 1900 COMMONWEALTH AVE
LEGAL DESC. : L1P2STR M230-248 1401 E INDEP **DEED BK,PG & DATE :** 03954 /383 1977-06-15
ACREAGE : 0.000 **SALE PRICE :** \$0 **QUALIFIED SALE (Y/N) :** N
LAND VALUE : \$48,690 **IMPVMTS VALUE :** \$47,310 **TOTAL VALUE :** \$96,000

LAND-USE TYPE : SINGLE FAMILY **BUILDING TYPE :** OFFICE
YEAR BUILT : 1,940 **SQUARE FEET :** 1,040 **STYLE CODE :** 1.0 STORY
BEDROOMS : 0 **BATHROOMS :** 0 **RESTROOMS :** 0 **BASEMENT :** Y **GARAGE :** N
EXTERIOR TYPE : WOOD ON SHEATHING OR PLYWO **QUALITY GRADE :** 1 **IMPVMT. VALUE :** \$19,590
A/C : NONE **FIREPLACE :** NONE

Record No.: 36 **BUILDING KEY NUMBER :** 08117606 001
PARCEL-ID : 08117606 **NEIGHBORHOOD CODE :** 08105 **ZONING CLASS :** B2
OWNER'S NAME : BRODT MUSIC CO INC
MAILING ADDRESS : PO BOX 9345
CITY : CHARLOTTE **STATE :** NC **ZIP CODE :** 28299

PROPERTY LOCATION : 1409 E INDEPENDENCE BV
LEGAL DESC. : P3 P2 B10 M230-248 **DEED BK,PG & DATE :** 06793 /329 1992-03-05
ACREAGE : 0.000 **SALE PRICE :** \$0 **QUALIFIED SALE (Y/N) :** N
LAND VALUE : \$81,460 **IMPVMTS VALUE :** \$172,400 **TOTAL VALUE :** \$253,860

LAND-USE TYPE : COMMERCIAL **BUILDING TYPE :** COMMERCIAL
YEAR BUILT : 1,954 **SQUARE FEET :** 10,280 **STYLE CODE :** 2.0 STORIES
BEDROOMS : 0 **BATHROOMS :** 0 **RESTROOMS :** 0 **BASEMENT :** N **GARAGE :** N
EXTERIOR TYPE : FACE BRICK **QUALITY GRADE :** 2 **IMPVMT. VALUE :** \$169,860
A/C : CENTRAL **FIREPLACE :** NONE

NOTE: This data is prepared for the purposes of revaluation, assessing & determining ownership of real property & is compiled from recorded deeds, plats, tax maps & other public records & data. Users of this data are hereby notified that the aforementioned public information sources should be consulted for verification. Mecklenburg County assumes no legal responsibility for the information herein.



MECKLENBURG COUNTY, NC

DATE PRINTED 2/22/02

GIS PUBLIC ACCESS SYSTEM REPORT

Note : Records are sorted in Parcel Number order.

PAGE : 13

Record No.: 37 **BUILDING KEY NUMBER :** 08117607 001
PARCEL-ID : 08117607 **NEIGHBORHOOD CODE :** 08105 **ZONING CLASS :** B2
OWNER'S NAME : BELK BASCOM V JR & WF HARRIETT
MAILING ADDRESS : 4508 E INDEPENDENCE BLVD STE 207
CITY : CHARLOTTE **STATE :** NC **ZIP CODE :** 282057486

PROPERTY LOCATION : 1415 E INDEPENDENCE BV
LEGAL DESC. : P13 B10 M230-248&249 **DEED BK,PG & DATE :** 03873 /050 1976-08-20
ACREAGE : 0.000 **SALE PRICE :** \$0 **QUALIFIED SALE (Y/N) :** N
LAND VALUE : \$7,460 **IMPVMTS VALUE :** \$0 **TOTAL VALUE :** \$7,460

LAND-USE TYPE : VACANT **BUILDING TYPE :** COMMERCIAL
YEAR BUILT : 0 **SQUARE FEET :** 0 **STYLE CODE :**
BEDROOMS : 0 **BATHROOMS :** 0 **RESTROOMS :** 0 **BASEMENT :** N **GARAGE :** N
EXTERIOR TYPE : **QUALITY GRADE :** 0 **IMPVMT. VALUE :** \$0
A/C : **FIREPLACE :**

Record No.: 38 **BUILDING KEY NUMBER :** 08117608 001
PARCEL-ID : 08117608 **NEIGHBORHOOD CODE :** 08105 **ZONING CLASS :** B2
OWNER'S NAME : MURPHY ROBERT W &WF TAMARA& NATALIE BELK SMITH
MAILING ADDRESS : 4400 PARK RD STE 300
CITY : CHARLOTTE **STATE :** NC **ZIP CODE :** 282093139

PROPERTY LOCATION : 1103 THE PLAZA
LEGAL DESC. : P14 B10 M230-248 **DEED BK,PG & DATE :** 08936 /776 1997-02-19
ACREAGE : 0.000 **SALE PRICE :** \$0 **QUALIFIED SALE (Y/N) :** N
LAND VALUE : \$6,530 **IMPVMTS VALUE :** \$17,130 **TOTAL VALUE :** \$23,660

LAND-USE TYPE : OFFICE **BUILDING TYPE :** UTILITY
YEAR BUILT : 1,997 **SQUARE FEET :** 192 **STYLE CODE :** 1.0 STORY
BEDROOMS : 0 **BATHROOMS :** 0 **RESTROOMS :** 0 **BASEMENT :** N **GARAGE :** N
EXTERIOR TYPE : **QUALITY GRADE :** 5 **IMPVMT. VALUE :** \$15,630
A/C : WALL UNIT **FIREPLACE :** NONE

Record No.: 39 **BUILDING KEY NUMBER :** 08117611 001
PARCEL-ID : 08117611 **NEIGHBORHOOD CODE :** 08105 **ZONING CLASS :** B2
OWNER'S NAME : EXXON CORPORATION BY MERGER
MAILING ADDRESS : PO BOX 53
CITY : HOUSTON **STATE :** TX **ZIP CODE :** 77001

PROPERTY LOCATION : 1431 E INDEPENDENCE BV
LEGAL DESC. : P15-18 B10 M230-248 **DEED BK,PG & DATE :** 02826 /597 1975-01-01
ACREAGE : 0.000 **SALE PRICE :** \$0 **QUALIFIED SALE (Y/N) :** N
LAND VALUE : \$73,180 **IMPVMTS VALUE :** \$0 **TOTAL VALUE :** \$73,180

LAND-USE TYPE : VACANT **BUILDING TYPE :** COMMERCIAL
YEAR BUILT : 0 **SQUARE FEET :** 0 **STYLE CODE :**
BEDROOMS : 0 **BATHROOMS :** 0 **RESTROOMS :** 0 **BASEMENT :** N **GARAGE :** N
EXTERIOR TYPE : **QUALITY GRADE :** 0 **IMPVMT. VALUE :** \$0
A/C : **FIREPLACE :**



MECKLENBURG COUNTY, NC

DATE PRINTED 2/22/02

GIS PUBLIC ACCESS SYSTEM REPORT

Note : Records are sorted in Parcel Number order.

PAGE : 14

Record No.: 40 **BUILDING KEY NUMBER:** 08117615 001
PARCEL-ID: 08117615 **NEIGHBORHOOD CODE:** 08105 **ZONING CLASS:** B2
OWNER'S NAME: SIPLON LAZARO D
MAILING ADDRESS: 2000 COMMONWEALTH AVE
CITY: CHARLOTTE **STATE:** NC **ZIP CODE:** 28205

PROPERTY LOCATION: 2000 COMMONWEALTH AV
LEGAL DESC.: L8B10M230-248 2000 COMMONWEALT **DEED BK,PG & DATE:** 04422 /635 1981-03-27
ACREAGE: 0.000 **SALE PRICE:** \$0 **QUALIFIED SALE (Y/N):** N
LAND VALUE: \$44,840 **IMPVMTS VALUE:** \$61,440 **TOTAL VALUE:** \$106,280

LAND-USE TYPE: SINGLE FAMILY **BUILDING TYPE:** DUPLEX/TRIPLEX
YEAR BUILT: 1,920 **SQUARE FEET:** 1,870 **STYLE CODE:** 2.0 STORIES
BEDROOMS: 0 **BATHROOMS:** 2 **RESTROOMS:** 0 **BASEMENT:** N **GARAGE:** Y
EXTERIOR TYPE: SIDING AVERAGE **QUALITY GRADE:** 2 **IMPVMT. VALUE:** \$61,440
A/C: CENTRAL **FIREPLACE:** 1 STY SINGLE

Record No.: 41 **BUILDING KEY NUMBER:** 08117616 001
PARCEL-ID: 08117616 **NEIGHBORHOOD CODE:** 08105 **ZONING CLASS:** B2
OWNER'S NAME: HINSON BETTY RANKIN & FRANCES FOWLER
MAILING ADDRESS: 5319 MILFORD RD
CITY: CHARLOTTE **STATE:** NC **ZIP CODE:** 28210

PROPERTY LOCATION: 1924 COMMONWEALTH AV
LEGAL DESC.: L7 B10 M230-248 & 9 **DEED BK,PG & DATE:** 08151 /162 1995-05-22
ACREAGE: 0.000 **SALE PRICE:** \$0 **QUALIFIED SALE (Y/N):** N
LAND VALUE: \$37,500 **IMPVMTS VALUE:** \$48,140 **TOTAL VALUE:** \$85,640

LAND-USE TYPE: SINGLE FAMILY **BUILDING TYPE:** DUPLEX/TRIPLEX
YEAR BUILT: 1,935 **SQUARE FEET:** 2,606 **STYLE CODE:** 2.0 STORIES
BEDROOMS: 0 **BATHROOMS:** 3 **RESTROOMS:** 0 **BASEMENT:** N **GARAGE:** N
EXTERIOR TYPE: SIDING AVERAGE **QUALITY GRADE:** 2 **IMPVMT. VALUE:** \$46,730
A/C: NONE **FIREPLACE:** NONE

Record No.: 42 **BUILDING KEY NUMBER:** 08117617 001
PARCEL-ID: 08117617 **NEIGHBORHOOD CODE:** 08105 **ZONING CLASS:** B2
OWNER'S NAME: SYKES DOROTHY L & WILLIAM R SYKES JR
MAILING ADDRESS: 1920 COMMONWEALTH AVE
CITY: CHARLOTTE **STATE:** NC **ZIP CODE:** 282055020

PROPERTY LOCATION: 1920 COMMONWEALTH AV
LEGAL DESC.: L6 B10 M230-248 **DEED BK,PG & DATE:** 09608 /748 1998-04-08
ACREAGE: 0.000 **SALE PRICE:** \$0 **QUALIFIED SALE (Y/N):** N
LAND VALUE: \$37,500 **IMPVMTS VALUE:** \$24,680 **TOTAL VALUE:** \$62,180

LAND-USE TYPE: SINGLE FAMILY **BUILDING TYPE:** SINGLE FAMILY RESIDENTIAL
YEAR BUILT: 1,939 **SQUARE FEET:** 1,324 **STYLE CODE:** 1.0 STORY
BEDROOMS: 4 **BATHROOMS:** 2 **RESTROOMS:** 0 **BASEMENT:** N **GARAGE:** N
EXTERIOR TYPE: FACE BRICK **QUALITY GRADE:** 2 **IMPVMT. VALUE:** \$23,650
A/C: CENTRAL **FIREPLACE:** 1 STY SINGLE

NOTE: This data is prepared for the purposes of revaluation, assessing & determining ownership of real property & is compiled from recorded deeds, plats, tax maps & other public records & data. Users of this data are hereby notified that the aforementioned public information sources should be consulted for verification. Mecklenburg County assumes no legal responsibility for the information herein.



MECKLENBURG COUNTY, NC

DATE PRINTED 2/22/02

GIS PUBLIC ACCESS SYSTEM REPORT

Note : Records are sorted in Parcel Number order.

PAGE : 15

Record No.: 43 **BUILDING KEY NUMBER:** 08117618 001
PARCEL-ID: 08117618 **NEIGHBORHOOD CODE:** 08105 **ZONING CLASS:** B2
OWNER'S NAME: BEAUCHEMIN RICHARD A & WF PATRICIA M
MAILING ADDRESS: 2237 GREENBROOK PKWY
CITY: MATTHEWS **STATE:** NC **ZIP CODE:** 28105

PROPERTY LOCATION: 1916 COMMONWEALTH AV
LEGAL DESC.: L5B10M230-248 1916 COMMONWLTH **DEED BK,PG & DATE:** 06756 /850 1992-02-03
ACREAGE: 0.000 **SALE PRICE:** \$76,500 **QUALIFIED SALE (Y/N):** Y
LAND VALUE: \$37,500 **IMPVMTS VALUE:** \$31,290 **TOTAL VALUE:** \$68,790

LAND-USE TYPE: SINGLE FAMILY **BUILDING TYPE:** OFFICE
YEAR BUILT: 1,939 **SQUARE FEET:** 1,294 **STYLE CODE:** 1.0 STORY
BEDROOMS: 3 **BATHROOMS:** 1 **RESTROOMS:** 0 **BASEMENT:** N **GARAGE:** N
EXTERIOR TYPE: FACE BRICK **QUALITY GRADE:** 2 **IMPVMT. VALUE:** \$30,210
A/C: CENTRAL **FIREPLACE:** 1 STY SINGLE

Record No.: 44 **BUILDING KEY NUMBER:** 08117619 001
PARCEL-ID: 08117619 **NEIGHBORHOOD CODE:** 08105 **ZONING CLASS:** B2
OWNER'S NAME: GATES GINA F & HSB FREDERICK F
MAILING ADDRESS: 1912 COMMONWEALTH AVE
CITY: CHARLOTTE **STATE:** NC **ZIP CODE:** 282055020

PROPERTY LOCATION: 1912 COMMONWEALTH AV
LEGAL DESC.: P4 B10 M230-248&9 **DEED BK,PG & DATE:** 10426 /516 1999-04-27
ACREAGE: 0.000 **SALE PRICE:** \$85,000 **QUALIFIED SALE (Y/N):** Y
LAND VALUE: \$40,730 **IMPVMTS VALUE:** \$49,690 **TOTAL VALUE:** \$90,420

LAND-USE TYPE: COMMERCIAL **BUILDING TYPE:** COMMERCIAL
YEAR BUILT: 1,948 **SQUARE FEET:** 2,339 **STYLE CODE:** 1.0 STORY
BEDROOMS: 0 **BATHROOMS:** 0 **RESTROOMS:** 0 **BASEMENT:** Y **GARAGE:** N
EXTERIOR TYPE: CONCRETE BLOCK **QUALITY GRADE:** 2 **IMPVMT. VALUE:** \$49,190
A/C: CENTRAL **FIREPLACE:** NONE

Record No.: 45 **BUILDING KEY NUMBER:** 08117620 001
PARCEL-ID: 08117620 **NEIGHBORHOOD CODE:** 08105 **ZONING CLASS:** B2
OWNER'S NAME: PISTIOLIS GERASIMOS & WF TULA
MAILING ADDRESS: 5701 LINFORD DR
CITY: CHARLOTTE **STATE:** NC **ZIP CODE:** 28210

PROPERTY LOCATION: 1901 COMMONWEALTH AV
LEGAL DESC.: L15&16B1M230-248 1901 COMMONWL **DEED BK,PG & DATE:** 04578 /726 1982-09-29
ACREAGE: 0.000 **SALE PRICE:** \$0 **QUALIFIED SALE (Y/N):** N
LAND VALUE: \$89,980 **IMPVMTS VALUE:** \$71,260 **TOTAL VALUE:** \$161,240

LAND-USE TYPE: COMMERCIAL **BUILDING TYPE:** RESTAURANTS
YEAR BUILT: 1,944 **SQUARE FEET:** 1,881 **STYLE CODE:** 2.0 STORIES
BEDROOMS: 0 **BATHROOMS:** 0 **RESTROOMS:** 0 **BASEMENT:** N **GARAGE:** N
EXTERIOR TYPE: FACE BRICK **QUALITY GRADE:** 2 **IMPVMT. VALUE:** \$65,140
A/C: CENTRAL **FIREPLACE:** NONE

NOTE: This data is prepared for the purposes of revaluation, assessing & determining ownership of real property & is compiled from recorded deeds, plats, tax maps & other public records & data. Users of this data are hereby notified that the aforementioned public information sources should be consulted for verification. Mecklenburg County assumes no legal responsibility for the information herein.



MECKLENBURG COUNTY, NC

DATE PRINTED 2/22/02

GIS PUBLIC ACCESS SYSTEM REPORT

Note : Records are sorted in Parcel Number order.

PAGE : 16

Record No.: 46 **BUILDING KEY NUMBER :** 08117621 001
PARCEL-ID : 08117621 **NEIGHBORHOOD CODE :** 08105 **ZONING CLASS :** B2
OWNER'S NAME : SCHACHT JAMES E CLAYTON C WATKINS
MAILING ADDRESS : 1909 COMMONWEALTH AV
CITY : CHARLOTTE **STATE :** NC **ZIP CODE :** 28205

PROPERTY LOCATION : 1909 COMMONWEALTH AV
LEGAL DESC. : L17 & 18 B1 M230-248 **DEED BK,PG & DATE :** 12703 /311 2001-09-27
ACREAGE : 0.000 **SALE PRICE :** \$740,000 **QUALIFIED SALE (Y/N) :** Y
LAND VALUE : \$74,360 **IMPVMTS VALUE :** \$301,880 **TOTAL VALUE :** \$376,240

LAND-USE TYPE : OFFICE **BUILDING TYPE :** OFFICE
YEAR BUILT : 1,950 **SQUARE FEET :** 6,624 **STYLE CODE :** 1.0 STORY
BEDROOMS : 0 **BATHROOMS :** 0 **RESTROOMS :** 0 **BASEMENT :** N **GARAGE :** N
EXTERIOR TYPE : STUCCO ON CONCRETE BLOCK **QUALITY GRADE :** 3 **IMPVMT. VALUE :** \$300,760
A/C : CENTRAL **FIREPLACE :** NONE

Record No.: 47 **BUILDING KEY NUMBER :** 08117623 001
PARCEL-ID : 08117623 **NEIGHBORHOOD CODE :** 08105 **ZONING CLASS :** B2
OWNER'S NAME : J & C REALTY CO
MAILING ADDRESS : PO BXO 9406
CITY : CHARLOTTE **STATE :** NC **ZIP CODE :** 28289

PROPERTY LOCATION : 1917 COMMONWEALTH AV
LEGAL DESC. : L19 B1 M230-248 **DEED BK,PG & DATE :** 11468 /093 2000-08-01
ACREAGE : 0.000 **SALE PRICE :** \$175,000 **QUALIFIED SALE (Y/N) :** Y
LAND VALUE : \$37,180 **IMPVMTS VALUE :** \$73,890 **TOTAL VALUE :** \$111,070

LAND-USE TYPE : COMMERCIAL **BUILDING TYPE :** COMMERCIAL
YEAR BUILT : 1,950 **SQUARE FEET :** 2,499 **STYLE CODE :** 1.0 STORY
BEDROOMS : 0 **BATHROOMS :** 0 **RESTROOMS :** 0 **BASEMENT :** N **GARAGE :** N
EXTERIOR TYPE : FACE BRICK **QUALITY GRADE :** 2 **IMPVMT. VALUE :** \$71,400
A/C : CENTRAL **FIREPLACE :** NONE

Record No.: 48 **BUILDING KEY NUMBER :** 08117624 001
PARCEL-ID : 08117624 **NEIGHBORHOOD CODE :** 08105 **ZONING CLASS :** B2
OWNER'S NAME : BALLENTINE JEAN A
MAILING ADDRESS : 2315 E 5TH ST
CITY : CHARLOTTE **STATE :** NC **ZIP CODE :** 282044338

PROPERTY LOCATION : 1921 COMMONWEALTH AV
LEGAL DESC. : L20 B1 M230-248 **DEED BK,PG & DATE :** 10879 /668 1999-11-03
ACREAGE : 0.000 **SALE PRICE :** \$0 **QUALIFIED SALE (Y/N) :** N
LAND VALUE : \$37,180 **IMPVMTS VALUE :** \$43,200 **TOTAL VALUE :** \$80,380

LAND-USE TYPE : COMMERCIAL **BUILDING TYPE :** RESTAURANTS
YEAR BUILT : 1,942 **SQUARE FEET :** 2,010 **STYLE CODE :** 1.0 STORY
BEDROOMS : 0 **BATHROOMS :** 0 **RESTROOMS :** 0 **BASEMENT :** N **GARAGE :** N
EXTERIOR TYPE : STONE **QUALITY GRADE :** 2 **IMPVMT. VALUE :** \$41,270
A/C : CENTRAL **FIREPLACE :** NONE

NOTE: This data is prepared for the purposes of revaluation, assessing & determining ownership of real property & is compiled from recorded deeds, plats, tax maps & other public records & data. Users of this data are hereby notified that the aforementioned public information sources should be consulted for verification. Mecklenburg County assumes no legal responsibility for the information herein.



MECKLENBURG COUNTY, NC

DATE PRINTED 2/22/02

GIS PUBLIC ACCESS SYSTEM REPORT

Note : Records are sorted in Parcel Number order.

PAGE : 17

Record No.: 49 **BUILDING KEY NUMBER :** 08117625 001
PARCEL-ID : 08117625 **NEIGHBORHOOD CODE :** 08105 **ZONING CLASS :** B2
OWNER'S NAME : SQUIRES REALTY INC
MAILING ADDRESS : PO BOX 9038
CITY : CHARLOTTE **STATE :** NC **ZIP CODE :** 28299

PROPERTY LOCATION : 2001 **COMMONWEALTH** **AV**
LEGAL DESC. : NA **DEED BK,PG & DATE :** 08071 /118 1995-03-01
ACREAGE : 0.000 **SALE PRICE :** \$0 **QUALIFIED SALE (Y/N) :** N
LAND VALUE : \$48,600 **IMPVMTS VALUE :** \$116,920 **TOTAL VALUE :** \$165,520

LAND-USE TYPE : OFFICE **BUILDING TYPE :** OFFICE
YEAR BUILT : 1,958 **SQUARE FEET :** 3,534 **STYLE CODE :** 1.0 STORY
BEDROOMS : 0 **BATHROOMS :** 0 **RESTROOMS :** 0 **BASEMENT :** N **GARAGE :** N
EXTERIOR TYPE : FACE BRICK **QUALITY GRADE :** 2 **IMPVMT. VALUE :** \$116,920
A/C : CENTRAL **FIREPLACE :** NONE

Record No.: 50 **BUILDING KEY NUMBER :** 08117634 001
PARCEL-ID : 08117634 **NEIGHBORHOOD CODE :** 08105 **ZONING CLASS :** B2
OWNER'S NAME : FIRST UNION NATIONAL BANK **OF NC%CORP RE CONS-1 #25**
MAILING ADDRESS : 1420 1ST UNION PLAZA
CITY : CHARLOTTE **STATE :** NC **ZIP CODE :** 28288

PROPERTY LOCATION : 1608 **CENTRAL** **AV**
LEGAL DESC. : 1608 CENTRAL AVE **DEED BK,PG & DATE :** 05597 /733 1987-09-18
ACREAGE : 1.000 **SALE PRICE :** \$240,000 **QUALIFIED SALE (Y/N) :** Y
LAND VALUE : \$208,390 **IMPVMTS VALUE :** \$0 **TOTAL VALUE :** \$208,390

LAND-USE TYPE : VACANT **BUILDING TYPE :** COMMERCIAL
YEAR BUILT : 0 **SQUARE FEET :** 0 **STYLE CODE :**
BEDROOMS : 0 **BATHROOMS :** 0 **RESTROOMS :** 0 **BASEMENT :** N **GARAGE :** N
EXTERIOR TYPE : **QUALITY GRADE :** 0 **IMPVMT. VALUE :** \$0
A/C : **FIREPLACE :**

Record No.: 51 **BUILDING KEY NUMBER :** 08117635 001
PARCEL-ID : 08117635 **NEIGHBORHOOD CODE :** 08105 **ZONING CLASS :** B2
OWNER'S NAME : TROUTMAN BOYCE GENE
MAILING ADDRESS : 1600 EASTCREST DR APT RR
CITY : CHARLOTTE **STATE :** NC **ZIP CODE :** 282054446

PROPERTY LOCATION : 1600 **CENTRAL** **AV**
LEGAL DESC. : 1600-06 CENTRAL AVE **DEED BK,PG & DATE :** 04990 /808 1985-03-28
ACREAGE : 0.000 **SALE PRICE :** \$75,000 **QUALIFIED SALE (Y/N) :** Y
LAND VALUE : \$87,330 **IMPVMTS VALUE :** \$27,360 **TOTAL VALUE :** \$114,690

LAND-USE TYPE : COMMERCIAL **BUILDING TYPE :** SERVICE STATION
YEAR BUILT : 1,956 **SQUARE FEET :** 1,827 **STYLE CODE :** 1.0 STORY
BEDROOMS : 0 **BATHROOMS :** 0 **RESTROOMS :** 0 **BASEMENT :** N **GARAGE :** N
EXTERIOR TYPE : CONCRETE BLOCK **QUALITY GRADE :** 2 **IMPVMT. VALUE :** \$22,740
A/C : NONE **FIREPLACE :** NONE

NOTE: This data is prepared for the purposes of revaluation, assessing & determining ownership of real property & is compiled from recorded deeds, plats, tax maps & other public records & data. Users of this data are hereby notified that the aforementioned public information sources should be consulted for verification. Mecklenburg County assumes no legal responsibility for the information herein.



MECKLENBURG COUNTY, NC

DATE PRINTED 2/22/02

GIS PUBLIC ACCESS SYSTEM REPORT

Note : Records are sorted in Parcel Number order.

PAGE : 18

Record No.: 52 BUILDING KEY NUMBER : 08117636 001
PARCEL-ID : 08117636 NEIGHBORHOOD CODE : 08105 ZONING CLASS : B2
OWNER'S NAME : ORIENTAL ENTERPRISES INC
MAILING ADDRESS : 5812 PORTBURN RD
CITY : CHARLOTTE STATE : NC ZIP CODE : 28211

PROPERTY LOCATION : 1220 THOMAS AV
LEGAL DESC. : PT1&2 B2 M230 248 1220 THOMAS DEED BK,PG & DATE : 04590 /062 1982-10-26
ACREAGE : 0.000 SALE PRICE : \$0 QUALIFIED SALE (Y/N) : N
LAND VALUE : \$30,300 IMPVMTS VALUE: \$80,360 TOTAL VALUE: \$110,660

LAND-USE TYPE : COMMERCIAL BUILDING TYPE : RESTAURANTS
YEAR BUILT : 1,948 SQUARE FEET : 2,942 STYLE CODE : 1.0 STORY
BEDROOMS : 0 BATHROOMS : 0 RESTROOMS : 0 BASEMENT : N GARAGE : N
EXTERIOR TYPE : CONCRETE BLOCK QUALITY GRADE : 2 IMPVMT. VALUE : \$80,360
A/C : CENTRAL FIREPLACE : NONE

Record No.: 53 BUILDING KEY NUMBER : 08117637 001
PARCEL-ID : 08117637 NEIGHBORHOOD CODE : 08105 ZONING CLASS : B2
OWNER'S NAME : PLAZA INDUSTRIES INC
MAILING ADDRESS : 1318 CENTRAL AVE STE F
CITY : CHARLOTTE STATE : NC ZIP CODE : 282055052

PROPERTY LOCATION : 1218 THOMAS AV
LEGAL DESC. : NA DEED BK,PG & DATE : 08825 /290 1996-11-19
ACREAGE : 0.000 SALE PRICE : \$130,000 QUALIFIED SALE (Y/N) : Y
LAND VALUE : \$51,190 IMPVMTS VALUE: \$88,070 TOTAL VALUE: \$139,260

LAND-USE TYPE : COMMERCIAL BUILDING TYPE : LOUNGE/NIGHTCLUB
YEAR BUILT : 1,950 SQUARE FEET : 2,940 STYLE CODE : 1.0 STORY
BEDROOMS : 0 BATHROOMS : 0 RESTROOMS : 0 BASEMENT : N GARAGE : N
EXTERIOR TYPE : CONCRETE BLOCK QUALITY GRADE : 3 IMPVMT. VALUE : \$85,690
A/C : CENTRAL FIREPLACE : NONE

Record No.: 54 BUILDING KEY NUMBER : 08117638 001
PARCEL-ID : 08117638 NEIGHBORHOOD CODE : 08105 ZONING CLASS : B2
OWNER'S NAME : DRUM EZRA B & WF JESSIE
MAILING ADDRESS : 214 HILLSIDE LN
CITY : NEWTON STATE : NC ZIP CODE : 28658

PROPERTY LOCATION : 1214 THOMAS AV
LEGAL DESC. : P8 &9 B2 M230-248 DEED BK,PG & DATE : 10531 /894 1999-06-09
ACREAGE : 0.000 SALE PRICE : \$75,000 QUALIFIED SALE (Y/N) : N
LAND VALUE : \$51,980 IMPVMTS VALUE: \$54,920 TOTAL VALUE: \$106,900

LAND-USE TYPE : COMMERCIAL BUILDING TYPE : COMMERCIAL
YEAR BUILT : 1,959 SQUARE FEET : 2,599 STYLE CODE : 1.0 STORY
BEDROOMS : 0 BATHROOMS : 0 RESTROOMS : 0 BASEMENT : N GARAGE : N
EXTERIOR TYPE : COMMON BRICK QUALITY GRADE : 2 IMPVMT. VALUE : \$53,480
A/C : CENTRAL FIREPLACE : NONE

NOTE: This data is prepared for the purposes of revaluation, assessing & determining ownership of real property & is compiled from recorded deeds, plats, tax maps & other public records & data. Users of this data are hereby notified that the aforementioned public information sources should be consulted for verification. Mecklenburg County assumes no legal responsibility for the information herein.



MECKLENBURG COUNTY, NC

DATE PRINTED 2/22/02

GIS PUBLIC ACCESS SYSTEM REPORT

Note : Records are sorted in Parcel Number order.

PAGE : 19

Record No.: 55 **BUILDING KEY NUMBER:** 08117640 001
PARCEL-ID: 08117640 **NEIGHBORHOOD CODE:** 08105 **ZONING CLASS:** B2
OWNER'S NAME: BROWN THOMAS LEWIS
MAILING ADDRESS: 909 CENTRAL AVE STE 3
CITY: CHARLOTTE **STATE:** NC **ZIP CODE:** 282042013

PROPERTY LOCATION: 1213 THOMAS AV
LEGAL DESC.: L14 B1 M230-248 & 9 **DEED BK,PG & DATE:** 08841 /995 1996-12-02
ACREAGE: 0.000 **SALE PRICE:** \$0 **QUALIFIED SALE (Y/N):** N
LAND VALUE: \$37,500 **IMPVMTS VALUE:** \$80,190 **TOTAL VALUE:** \$117,690

LAND-USE TYPE: COMMERCIAL **BUILDING TYPE:** COMMERCIAL
YEAR BUILT: 1,948 **SQUARE FEET:** 4,000 **STYLE CODE:** 1.0 STORY
BEDROOMS: 0 **BATHROOMS:** 0 **RESTROOMS:** 0 **BASEMENT:** N **GARAGE:** N
EXTERIOR TYPE: FACE BRICK **QUALITY GRADE:** 2 **IMPVMT. VALUE:** \$80,190
A/C: CENTRAL **FIREPLACE:** NONE

Record No.: 56 **BUILDING KEY NUMBER:** 08117641 001
PARCEL-ID: 08117641 **NEIGHBORHOOD CODE:** 08105 **ZONING CLASS:** B2
OWNER'S NAME: BROWN THOMAS LEWIS
MAILING ADDRESS: 909 CENTRAL AVE STE 3
CITY: CHARLOTTE **STATE:** NC **ZIP CODE:** 282042013

PROPERTY LOCATION: 1217 THOMAS AV
LEGAL DESC.: L13 B1 M230-248 **DEED BK,PG & DATE:** 08841 /995 1996-12-02
ACREAGE: 0.000 **SALE PRICE:** \$0 **QUALIFIED SALE (Y/N):** N
LAND VALUE: \$37,500 **IMPVMTS VALUE:** \$33,870 **TOTAL VALUE:** \$71,370

LAND-USE TYPE: COMMERCIAL **BUILDING TYPE:** COMMERCIAL
YEAR BUILT: 1,948 **SQUARE FEET:** 1,296 **STYLE CODE:** 1.0 STORY
BEDROOMS: 0 **BATHROOMS:** 0 **RESTROOMS:** 0 **BASEMENT:** N **GARAGE:** N
EXTERIOR TYPE: FACE BRICK **QUALITY GRADE:** 2 **IMPVMT. VALUE:** \$26,240
A/C: NONE **FIREPLACE:** NONE

Record No.: 57 **BUILDING KEY NUMBER:** 08117641 002
PARCEL-ID: 08117641 **NEIGHBORHOOD CODE:** 08105 **ZONING CLASS:** B2
OWNER'S NAME: BROWN THOMAS LEWIS
MAILING ADDRESS: 909 CENTRAL AVE STE 3
CITY: CHARLOTTE **STATE:** NC **ZIP CODE:** 282042013

PROPERTY LOCATION: 1217 THOMAS AVE
LEGAL DESC.: L13 B1 M230-248 **DEED BK,PG & DATE:** 08841 /995 1996-12-02
ACREAGE: 0.000 **SALE PRICE:** \$0 **QUALIFIED SALE (Y/N):** N
LAND VALUE: \$37,500 **IMPVMTS VALUE:** \$33,870 **TOTAL VALUE:** \$71,370

LAND-USE TYPE: WAREHOUSE/INDUSTRIAL **BUILDING TYPE:** WAREHOUSE
YEAR BUILT: 1,948 **SQUARE FEET:** 1,250 **STYLE CODE:** 1.0 STORY
BEDROOMS: 0 **BATHROOMS:** 0 **RESTROOMS:** 0 **BASEMENT:** N **GARAGE:** N
EXTERIOR TYPE: SINGLE SIDING (NO SHEATHING) **QUALITY GRADE:** 1 **IMPVMT. VALUE:** \$7,630
A/C: NONE **FIREPLACE:** NONE

NOTE: This data is prepared for the purposes of revaluation, assessing & determining ownership of real property & is compiled from recorded deeds, plats, tax maps & other public records & data. Users of this data are hereby notified that the aforementioned public information sources should be consulted for verification. Mecklenburg County assumes no legal responsibility for the information herein.



MECKLENBURG COUNTY, NC

DATE PRINTED 2/22/02

GIS PUBLIC ACCESS SYSTEM REPORT

Note : Records are sorted in Parcel Number order.

PAGE : 20

Record No.: 58 **BUILDING KEY NUMBER :** 08117642 001
PARCEL-ID : 08117642 **NEIGHBORHOOD CODE :** 08105 **ZONING CLASS :** B2
OWNER'S NAME : CHAPPLE MURRAY D &WF DEBORAH B
MAILING ADDRESS : 3029 STONEYBROOK RD
CITY : CHARLOTTE **STATE :** NC **ZIP CODE :** 282053149

PROPERTY LOCATION : 1221 THOMAS AV
LEGAL DESC. : L12 B1 M230-248 **DEED BK,PG & DATE :** 08766 /396 1996-10-02
ACREAGE : 0.000 **SALE PRICE :** \$105,000 **QUALIFIED SALE (Y/N) :** N
LAND VALUE : \$37,500 **IMPVMTS VALUE :** \$46,430 **TOTAL VALUE :** \$83,930

LAND-USE TYPE : WAREHOUSE/INDUSTRIAL **BUILDING TYPE :** WAREHOUSE
YEAR BUILT : 1,948 **SQUARE FEET :** 3,732 **STYLE CODE :** 1.0 STORY
BEDROOMS : 0 **BATHROOMS :** 0 **RESTROOMS :** 0 **BASEMENT :** N **GARAGE :** N
EXTERIOR TYPE : CONCRETE BLOCK **QUALITY GRADE :** 2 **IMPVMT. VALUE :** \$46,430
A/C : NONE **FIREPLACE :** NONE

Record No.: 59 **BUILDING KEY NUMBER :** 08117643 001
PARCEL-ID : 08117643 **NEIGHBORHOOD CODE :** 08105 **ZONING CLASS :** B2
OWNER'S NAME : CITY OF CHARLOTTE
MAILING ADDRESS : 600 E 4TH ST
CITY : CHARLOTTE **STATE :** NC **ZIP CODE :** 282022816

PROPERTY LOCATION : 1225 THOMAS AV
LEGAL DESC. : L11P4-6&STR B1M230-248THOMAS A **DEED BK,PG & DATE :** 04544 /293 1982-05-31
ACREAGE : 1.000 **SALE PRICE :** \$0 **QUALIFIED SALE (Y/N) :** N
LAND VALUE : \$145,560 **IMPVMTS VALUE :** \$0 **TOTAL VALUE :** \$145,560

LAND-USE TYPE : VACANT **BUILDING TYPE :** COMMERCIAL
YEAR BUILT : 0 **SQUARE FEET :** 0 **STYLE CODE :**
BEDROOMS : 0 **BATHROOMS :** 0 **RESTROOMS :** 0 **BASEMENT :** N **GARAGE :** N
EXTERIOR TYPE : **QUALITY GRADE :** 0 **IMPVMT. VALUE :** \$0
A/C : **FIREPLACE :**

Record No.: 60 **BUILDING KEY NUMBER :** 08117646 001
PARCEL-ID : 08117646 **NEIGHBORHOOD CODE :** 08105 **ZONING CLASS :** B2
OWNER'S NAME : DIAMADUROS PANOS P
MAILING ADDRESS : 3552 NANCY CREEK RD
CITY : CHARLOTTE **STATE :** NC **ZIP CODE :** 28270

PROPERTY LOCATION : 1516 CENTRAL AV
LEGAL DESC. : PTL4&5B1M230 248&9 1516 CENTRA **DEED BK,PG & DATE :** 01859 /595 1975-01-01
ACREAGE : 0.000 **SALE PRICE :** \$0 **QUALIFIED SALE (Y/N) :** N
LAND VALUE : \$19,920 **IMPVMTS VALUE :** \$63,290 **TOTAL VALUE :** \$83,210

LAND-USE TYPE : COMMERCIAL **BUILDING TYPE :** COMMERCIAL
YEAR BUILT : 1,930 **SQUARE FEET :** 2,800 **STYLE CODE :** 2.0 STORIES
BEDROOMS : 0 **BATHROOMS :** 0 **RESTROOMS :** 0 **BASEMENT :** N **GARAGE :** N
EXTERIOR TYPE : FACE BRICK **QUALITY GRADE :** 2 **IMPVMT. VALUE :** \$63,290
A/C : CENTRAL **FIREPLACE :** NONE



MECKLENBURG COUNTY, NC

DATE PRINTED 2/22/02

GIS PUBLIC ACCESS SYSTEM REPORT

Note : Records are sorted in Parcel Number order.

PAGE : 21

Record No.: 61 **BUILDING KEY NUMBER :** 08117647 001
PARCEL-ID : 08117647 **NEIGHBORHOOD CODE :** 08105 **ZONING CLASS :** B2
OWNER'S NAME : CRADDOCK WILLIAM F &WF PATSY D
MAILING ADDRESS : 3418 SHADOW LAKE LN
CITY : MATTHEWS **STATE :** NC **ZIP CODE :** 28105

PROPERTY LOCATION : 1514 CENTRAL AV
LEGAL DESC. : P4 B1 M230 248 & 9 **DEED BK,PG & DATE :** 04614 /029 1983-01-10
ACREAGE : 0.000 **SALE PRICE :** \$0 **QUALIFIED SALE (Y/N) :** N
LAND VALUE : \$9,860 **IMPVMTS VALUE :** \$20,260 **TOTAL VALUE :** \$30,120

LAND-USE TYPE : COMMERCIAL **BUILDING TYPE :** COMMERCIAL
YEAR BUILT : 1,930 **SQUARE FEET :** 1,560 **STYLE CODE :** 1.0 STORY
BEDROOMS : 0 **BATHROOMS :** 0 **RESTROOMS :** 0 **BASEMENT :** N **GARAGE :** N
EXTERIOR TYPE : FACE BRICK **QUALITY GRADE :** 2 **IMPVMT. VALUE :** \$20,260
A/C : NONE **FIREPLACE :** NONE

Record No.: 62 **BUILDING KEY NUMBER :** 08117648 001
PARCEL-ID : 08117648 **NEIGHBORHOOD CODE :** 08105 **ZONING CLASS :** B2
OWNER'S NAME : DIMOS VOULA RETSIUO MRS P
MAILING ADDRESS : 2016 E 8TH ST
CITY : CHARLOTTE **STATE :** NC **ZIP CODE :** 28204

PROPERTY LOCATION : 1508 CENTRAL AV
LEGAL DESC. : PTL3 B1 M230 248 1508 CENTRAL **DEED BK,PG & DATE :** 01748 /129 1975-01-01
ACREAGE : 0.000 **SALE PRICE :** \$0 **QUALIFIED SALE (Y/N) :** N
LAND VALUE : \$45,470 **IMPVMTS VALUE :** \$97,950 **TOTAL VALUE :** \$143,420

LAND-USE TYPE : COMMERCIAL **BUILDING TYPE :** COMMERCIAL
YEAR BUILT : 1,930 **SQUARE FEET :** 6,890 **STYLE CODE :** 1.0 STORY
BEDROOMS : 0 **BATHROOMS :** 0 **RESTROOMS :** 0 **BASEMENT :** N **GARAGE :** N
EXTERIOR TYPE : FACE BRICK **QUALITY GRADE :** 2 **IMPVMT. VALUE :** \$97,950
A/C : CENTRAL **FIREPLACE :** NONE

Record No.: 63 **BUILDING KEY NUMBER :** 08117649 001
PARCEL-ID : 08117649 **NEIGHBORHOOD CODE :** 08105 **ZONING CLASS :** B2
OWNER'S NAME : ARROBA JORGE HUMBERTO &WF YOLANDA INES
MAILING ADDRESS : 1506 CENTRAL AVE
CITY : CHARLOTTE **STATE :** NC **ZIP CODE :** 28205

PROPERTY LOCATION : 1506 CENTRAL AV
LEGAL DESC. : LC B1 M838-575 1506 CENTRAL AV **DEED BK,PG & DATE :** 04297 /552 1980-04-14
ACREAGE : 0.000 **SALE PRICE :** \$0 **QUALIFIED SALE (Y/N) :** N
LAND VALUE : \$13,750 **IMPVMTS VALUE :** \$60,930 **TOTAL VALUE :** \$74,680

LAND-USE TYPE : COMMERCIAL **BUILDING TYPE :** COMMERCIAL
YEAR BUILT : 1,930 **SQUARE FEET :** 1,875 **STYLE CODE :** 2.0 STORIES
BEDROOMS : 0 **BATHROOMS :** 0 **RESTROOMS :** 0 **BASEMENT :** N **GARAGE :** N
EXTERIOR TYPE : FACE BRICK **QUALITY GRADE :** 2 **IMPVMT. VALUE :** \$59,270
A/C : NONE **FIREPLACE :** NONE

NOTE: This data is prepared for the purposes of revaluation, assessing & determining ownership of real property & is compiled from recorded deeds, plats, tax maps & other public records & data. Users of this data are hereby notified that the aforementioned public information sources should be consulted for verification. Mecklenburg County assumes no legal responsibility for the information herein.



MECKLENBURG COUNTY, NC

DATE PRINTED 2/22/02

GIS PUBLIC ACCESS SYSTEM REPORT

Note : Records are sorted in Parcel Number order.

PAGE : 22

Record No.: 64 **BUILDING KEY NUMBER:** 08117650 001
PARCEL-ID: 08117650 **NEIGHBORHOOD CODE:** 08105 **ZONING CLASS:** B2
OWNER'S NAME: EMPHASIS ADS INC
MAILING ADDRESS: 1700 N GRAHAM ST
CITY: CHARLOTTE **STATE:** NC **ZIP CODE:** 282063026

PROPERTY LOCATION: 1504 CENTRAL AV
LEGAL DESC.: LB B1 M838-575 **DEED BK,PG & DATE:** 10191 /286 1999-01-19
ACREAGE: 0.000 **SALE PRICE:** \$135,000 **QUALIFIED SALE (Y/N):** N
LAND VALUE: \$13,750 **IMPVMTS VALUE:** \$32,710 **TOTAL VALUE:** \$46,460

LAND-USE TYPE: COMMERCIAL **BUILDING TYPE:** COMMERCIAL
YEAR BUILT: 1,940 **SQUARE FEET:** 1,357 **STYLE CODE:** 1.0 STORY
BEDROOMS: 0 **BATHROOMS:** 0 **RESTROOMS:** 0 **BASEMENT:** N **GARAGE:** N
EXTERIOR TYPE: FACE BRICK **QUALITY GRADE:** 2 **IMPVMT. VALUE:** \$32,660
A/C: NONE **FIREPLACE:** NONE

Record No.: 65 **BUILDING KEY NUMBER:** 08117651 001
PARCEL-ID: 08117651 **NEIGHBORHOOD CODE:** 08105 **ZONING CLASS:** B2
OWNER'S NAME: MULTI-VIDEO INC
MAILING ADDRESS: 15128 BIRLING RD
CITY: CHARLOTTE **STATE:** NC **ZIP CODE:** 28278

PROPERTY LOCATION: 1500 CENTRAL AV
LEGAL DESC.: LA M838-575 **DEED BK,PG & DATE:** 07250 /930 1993-04-05
ACREAGE: 0.000 **SALE PRICE:** \$160,000 **QUALIFIED SALE (Y/N):** Y
LAND VALUE: \$21,860 **IMPVMTS VALUE:** \$114,330 **TOTAL VALUE:** \$136,190

LAND-USE TYPE: COMMERCIAL **BUILDING TYPE:** COMMERCIAL
YEAR BUILT: 1,932 **SQUARE FEET:** 4,394 **STYLE CODE:** 2.0 STORIES
BEDROOMS: 0 **BATHROOMS:** 0 **RESTROOMS:** 0 **BASEMENT:** N **GARAGE:** N
EXTERIOR TYPE: FACE BRICK **QUALITY GRADE:** 2 **IMPVMT. VALUE:** \$114,330
A/C: CENTRAL **FIREPLACE:** NONE

Record No.: 66 **BUILDING KEY NUMBER:** 08117652 001
PARCEL-ID: 08117652 **NEIGHBORHOOD CODE:** 08105 **ZONING CLASS:** B2
OWNER'S NAME: AUGHTRY JUANITA S
MAILING ADDRESS: PO BOX 9035
CITY: CHARLOTTE **STATE:** NC **ZIP CODE:** 282999035

PROPERTY LOCATION: 1228 GORDON ST
LEGAL DESC.: LD B1 M838 575 1228 GORDON ST **DEED BK,PG & DATE:** 05478 /170 1987-04-14
ACREAGE: 0.000 **SALE PRICE:** \$85,000 **QUALIFIED SALE (Y/N):** Y
LAND VALUE: \$27,300 **IMPVMTS VALUE:** \$35,290 **TOTAL VALUE:** \$62,590

LAND-USE TYPE: COMMERCIAL **BUILDING TYPE:** COMMERCIAL
YEAR BUILT: 1,940 **SQUARE FEET:** 2,014 **STYLE CODE:** 1.0 STORY
BEDROOMS: 0 **BATHROOMS:** 0 **RESTROOMS:** 0 **BASEMENT:** N **GARAGE:** N
EXTERIOR TYPE: CONCRETE BLOCK **QUALITY GRADE:** 2 **IMPVMT. VALUE:** \$34,290
A/C: CENTRAL **FIREPLACE:** NONE

NOTE: This data is prepared for the purposes of revaluation, assessing & determining ownership of real property & is compiled from recorded deeds, plats, tax maps & other public records & data. Users of this data are hereby notified that the aforementioned public information sources should be consulted for verification. Mecklenburg County assumes no legal responsibility for the information herein.



MECKLENBURG COUNTY, NC

DATE PRINTED 2/22/02

GIS PUBLIC ACCESS SYSTEM REPORT

Note : Records are sorted in Parcel Number order.

PAGE : 23

Record No.: 67 **BUILDING KEY NUMBER :** 08117653 001
PARCEL-ID : 08117653 **NEIGHBORHOOD CODE :** 08105 **ZONING CLASS :** B2
OWNER'S NAME : DURON INC
MAILING ADDRESS : 10406 TUCKER ST
CITY : BELTSVILLE **STATE :** MI **ZIP CODE :** 20705

PROPERTY LOCATION : 1218 GORDON ST
LEGAL DESC. : L7-9 B1 M230-248 **DEED BK,PG & DATE :** 04231 /372 1979-09-11
ACREAGE : 1.000 **SALE PRICE :** \$0 **QUALIFIED SALE (Y/N) :** N
LAND VALUE : \$112,500 **IMPVMTS VALUE :** \$155,760 **TOTAL VALUE :** \$268,260

LAND-USE TYPE : COMMERCIAL **BUILDING TYPE :** COMMERCIAL
YEAR BUILT : 1,945 **SQUARE FEET :** 8,450 **STYLE CODE :** 1.0 STORY
BEDROOMS : 0 **BATHROOMS :** 0 **RESTROOMS :** 0 **BASEMENT :** N **GARAGE :** N
EXTERIOR TYPE : **QUALITY GRADE :** 3 **IMPVMT. VALUE :** \$153,540
A/C : CENTRAL **FIREPLACE :** NONE

Record No.: 68 **BUILDING KEY NUMBER :** 08117654 001
PARCEL-ID : 08117654 **NEIGHBORHOOD CODE :** 08105 **ZONING CLASS :** B2
OWNER'S NAME : WILLMANN JAMES RUDOLPH & WF BONNIE CREED
MAILING ADDRESS : 1212 GORDON ST
CITY : CHARLOTTE **STATE :** NC **ZIP CODE :** 28205

PROPERTY LOCATION : 1212 GORDON ST
LEGAL DESC. : L10B1M230 248 1212 GORDON ST **DEED BK,PG & DATE :** 06338 /736 1990-07-31
ACREAGE : 0.000 **SALE PRICE :** \$74,000 **QUALIFIED SALE (Y/N) :** N
LAND VALUE : \$37,500 **IMPVMTS VALUE :** \$49,970 **TOTAL VALUE :** \$87,470

LAND-USE TYPE : COMMERCIAL **BUILDING TYPE :** COMMERCIAL
YEAR BUILT : 1,946 **SQUARE FEET :** 1,728 **STYLE CODE :** 1.0 STORY
BEDROOMS : 0 **BATHROOMS :** 0 **RESTROOMS :** 0 **BASEMENT :** N **GARAGE :** N
EXTERIOR TYPE : SIDING AVERAGE **QUALITY GRADE :** 1 **IMPVMT. VALUE :** \$48,400
A/C : CENTRAL **FIREPLACE :** NONE

Record No.: 69 **BUILDING KEY NUMBER :** 08117655 001
PARCEL-ID : 08117655 **NEIGHBORHOOD CODE :** 08105 **ZONING CLASS :** B2
OWNER'S NAME : DEMERT KENNETH D & WF MARY J
MAILING ADDRESS : 1512 CENTRAL AVE
CITY : CHARLOTTE **STATE :** NC **ZIP CODE :** 28205

PROPERTY LOCATION : 1512 CENTRAL AV
LEGAL DESC. : P4B1M230-348&9 1512 CENTRAL AV **DEED BK,PG & DATE :** 04534 /686 1982-05-07
ACREAGE : 0.000 **SALE PRICE :** \$0 **QUALIFIED SALE (Y/N) :** N
LAND VALUE : \$9,860 **IMPVMTS VALUE :** \$22,720 **TOTAL VALUE :** \$32,580

LAND-USE TYPE : COMMERCIAL **BUILDING TYPE :** COMMERCIAL
YEAR BUILT : 1,930 **SQUARE FEET :** 1,560 **STYLE CODE :** 1.0 STORY
BEDROOMS : 0 **BATHROOMS :** 0 **RESTROOMS :** 0 **BASEMENT :** N **GARAGE :** N
EXTERIOR TYPE : FACE BRICK **QUALITY GRADE :** 2 **IMPVMT. VALUE :** \$22,720
A/C : CENTRAL **FIREPLACE :** NONE

NOTE: This data is prepared for the purposes of revaluation, assessing & determining ownership of real property & is compiled from recorded deeds, plats, tax maps & other public records & data. Users of this data are hereby notified that the aforementioned public information sources should be consulted for verification. Mecklenburg County assumes no legal responsibility for the information herein.



MECKLENBURG COUNTY, NC

DATE PRINTED 2/22/02

GIS PUBLIC ACCESS SYSTEM REPORT

Note : Records are sorted in Parcel Number order.

PAGE : 24

Record No.: 70 **BUILDING KEY NUMBER:** 08117722 001
PARCEL-ID: 08117722 **NEIGHBORHOOD CODE:** 08105 **ZONING CLASS:** I2
OWNER'S NAME: PLAZA INDUSTRIES INC
MAILING ADDRESS: 1318 CENTRAL AVE STE F
CITY: CHARLOTTE **STATE:** NC **ZIP CODE:** 282055052

PROPERTY LOCATION: 1318 CENTRAL AV
LEGAL DESC.: 1318-A CENTRAL AVE **DEED BK,PG & DATE:** /
ACREAGE: 1.000 **SALE PRICE:** \$0 **QUALIFIED SALE (Y/N):**
LAND VALUE: \$117,260 **IMPVMTS VALUE:** \$548,900 **TOTAL VALUE:** \$666,160

LAND-USE TYPE: WAREHOUSE/INDUSTRIAL **BUILDING TYPE:** WAREHOUSE
YEAR BUILT: 1,912 **SQUARE FEET:** 22,425 **STYLE CODE:** 2.0 STORIES
BEDROOMS: 0 **BATHROOMS:** 0 **RESTROOMS:** 0 **BASEMENT:** N **GARAGE:** N
EXTERIOR TYPE: COMMON BRICK **QUALITY GRADE:** 1 **IMPVMT. VALUE:** \$261,780
A/C: CENTRAL **FIREPLACE:** NONE

Record No.: 71 **BUILDING KEY NUMBER:** 08117722 002
PARCEL-ID: 08117722 **NEIGHBORHOOD CODE:** 08105 **ZONING CLASS:** I2
OWNER'S NAME: PLAZA INDUSTRIES INC
MAILING ADDRESS: 1318 CENTRAL AVE STE F
CITY: CHARLOTTE **STATE:** NC **ZIP CODE:** 282055052

PROPERTY LOCATION: 1318 CENTRAL AVE
LEGAL DESC.: 1318-A CENTRAL AVE **DEED BK,PG & DATE:** /
ACREAGE: 1.000 **SALE PRICE:** \$0 **QUALIFIED SALE (Y/N):**
LAND VALUE: \$117,260 **IMPVMTS VALUE:** \$548,900 **TOTAL VALUE:** \$666,160

LAND-USE TYPE: WAREHOUSE/INDUSTRIAL **BUILDING TYPE:** WAREHOUSE
YEAR BUILT: 1,912 **SQUARE FEET:** 13,200 **STYLE CODE:** 2.0 STORIES
BEDROOMS: 0 **BATHROOMS:** 0 **RESTROOMS:** 0 **BASEMENT:** N **GARAGE:** N
EXTERIOR TYPE: FACE BRICK **QUALITY GRADE:** 2 **IMPVMT. VALUE:** \$173,750
A/C: CENTRAL **FIREPLACE:** NONE

Record No.: 72 **BUILDING KEY NUMBER:** 08117722 003
PARCEL-ID: 08117722 **NEIGHBORHOOD CODE:** 08105 **ZONING CLASS:** I2
OWNER'S NAME: PLAZA INDUSTRIES INC
MAILING ADDRESS: 1318 CENTRAL AVE STE F
CITY: CHARLOTTE **STATE:** NC **ZIP CODE:** 282055052

PROPERTY LOCATION: 1318 CENTRAL AVE
LEGAL DESC.: 1318-A CENTRAL AVE **DEED BK,PG & DATE:** /
ACREAGE: 1.000 **SALE PRICE:** \$0 **QUALIFIED SALE (Y/N):**
LAND VALUE: \$117,260 **IMPVMTS VALUE:** \$548,900 **TOTAL VALUE:** \$666,160

LAND-USE TYPE: WAREHOUSE/INDUSTRIAL **BUILDING TYPE:** WAREHOUSE
YEAR BUILT: 1,963 **SQUARE FEET:** 11,408 **STYLE CODE:** 1.0 STORY
BEDROOMS: 0 **BATHROOMS:** 0 **RESTROOMS:** 0 **BASEMENT:** N **GARAGE:** N
EXTERIOR TYPE: COMMON BRICK **QUALITY GRADE:** 2 **IMPVMT. VALUE:** \$103,850
A/C: NONE **FIREPLACE:** NONE

NOTE: This data is prepared for the purposes of revaluation, assessing & determining ownership of real property & is compiled from recorded deeds, plats, tax maps & other public records & data. Users of this data are hereby notified that the aforementioned public information sources should be consulted for verification. Mecklenburg County assumes no legal responsibility for the information herein.



MECKLENBURG COUNTY, NC

DATE PRINTED 2/22/02

GIS PUBLIC ACCESS SYSTEM REPORT

Note : Records are sorted in Parcel Number order.

PAGE : 25

Record No.: 73 **BUILDING KEY NUMBER :** 08117723 001
PARCEL-ID : 08117723 **NEIGHBORHOOD CODE :** 08105 **ZONING CLASS :** B2
OWNER'S NAME : COLE PROPERTIES INC
MAILING ADDRESS : 1318 CENTRAL AVE STE F
CITY : CHARLOTTE **STATE :** NC **ZIP CODE :** 282055052

PROPERTY LOCATION : 1322 CENTRAL AV
LEGAL DESC. : L1 M31-415 **DEED BK,PG & DATE :** 01851 /559 1975-01-01
ACREAGE : 6.000 **SALE PRICE :** \$0 **QUALIFIED SALE (Y/N) :** N
LAND VALUE : \$892,500 **IMPVMTS VALUE :** \$916,170 **TOTAL VALUE :** \$1,808,670

LAND-USE TYPE : COMMERCIAL **BUILDING TYPE :** SHOPPING CENTER-STRIP
YEAR BUILT : 1,959 **SQUARE FEET :** 42,250 **STYLE CODE :** 1.0 STORY
BEDROOMS : 0 **BATHROOMS :** 0 **RESTROOMS :** 0 **BASEMENT :** N **GARAGE :** N
EXTERIOR TYPE : FACE BRICK **QUALITY GRADE :** 2 **IMPVMT. VALUE :** \$589,560
A/C : CENTRAL **FIREPLACE :** NONE

Record No.: 74 **BUILDING KEY NUMBER :** 08117723 002
PARCEL-ID : 08117723 **NEIGHBORHOOD CODE :** 08105 **ZONING CLASS :** B2
OWNER'S NAME : COLE PROPERTIES INC
MAILING ADDRESS : 1318 CENTRAL AVE STE F
CITY : CHARLOTTE **STATE :** NC **ZIP CODE :** 282055052

PROPERTY LOCATION : 1400 CENTRAL
LEGAL DESC. : L1 M31-415 **DEED BK,PG & DATE :** 01851 /559 1975-01-01
ACREAGE : 6.000 **SALE PRICE :** \$0 **QUALIFIED SALE (Y/N) :** N
LAND VALUE : \$892,500 **IMPVMTS VALUE :** \$916,170 **TOTAL VALUE :** \$1,808,670

LAND-USE TYPE : COMMERCIAL **BUILDING TYPE :** COMMERCIAL
YEAR BUILT : 1,966 **SQUARE FEET :** 2,134 **STYLE CODE :** 1.0 STORY
BEDROOMS : 0 **BATHROOMS :** 0 **RESTROOMS :** 0 **BASEMENT :** N **GARAGE :** N
EXTERIOR TYPE : COMMON BRICK **QUALITY GRADE :** 2 **IMPVMT. VALUE :** \$54,590
A/C : CENTRAL **FIREPLACE :** NONE

Record No.: 75 **BUILDING KEY NUMBER :** 08117723 003
PARCEL-ID : 08117723 **NEIGHBORHOOD CODE :** 08105 **ZONING CLASS :** B2
OWNER'S NAME : COLE PROPERTIES INC
MAILING ADDRESS : 1318 CENTRAL AVE STE F
CITY : CHARLOTTE **STATE :** NC **ZIP CODE :** 282055052

PROPERTY LOCATION : 1117 PECAN AV
LEGAL DESC. : L1 M31-415 **DEED BK,PG & DATE :** 01851 /559 1975-01-01
ACREAGE : 6.000 **SALE PRICE :** \$0 **QUALIFIED SALE (Y/N) :** N
LAND VALUE : \$892,500 **IMPVMTS VALUE :** \$916,170 **TOTAL VALUE :** \$1,808,670

LAND-USE TYPE : WAREHOUSE/INDUSTRIAL **BUILDING TYPE :** WAREHOUSE
YEAR BUILT : 1,966 **SQUARE FEET :** 10,003 **STYLE CODE :** 1.0 STORY
BEDROOMS : 0 **BATHROOMS :** 0 **RESTROOMS :** 0 **BASEMENT :** N **GARAGE :** N
EXTERIOR TYPE : COMMON BRICK **QUALITY GRADE :** 2 **IMPVMT. VALUE :** \$140,150
A/C : NONE **FIREPLACE :** NONE

NOTE: This data is prepared for the purposes of revaluation, assessing & determining ownership of real property & is compiled from recorded deeds, plats, tax maps & other public records & data. Users of this data are hereby notified that the aforementioned public information sources should be consulted for verification. Mecklenburg County assumes no legal responsibility for the information herein.



MECKLENBURG COUNTY, NC

DATE PRINTED 2/22/02

GIS PUBLIC ACCESS SYSTEM REPORT

Note : Records are sorted in Parcel Number order.

PAGE : 26

Record No.: 76 BUILDING KEY NUMBER : 08117723 004
PARCEL-ID: 08117723 NEIGHBORHOOD CODE : 08105 ZONING CLASS : B2
OWNER'S NAME : COLE PROPERTIES INC
MAILING ADDRESS : 1318 CENTRAL AVE STE F
CITY : CHARLOTTE STATE : NC ZIP CODE : 282055052

PROPERTY LOCATION : 1113 PECAN AV
LEGAL DESC. : L1 M31-415 DEED BK,PG & DATE : 01851 /559 1975-01-01
ACREAGE : 6.000 **SALE PRICE :** \$0 **QUALIFIED SALE (Y/N) :** N
LAND VALUE : \$892,500 **IMPVMTS VALUE:** \$916,170 **TOTAL VALUE :** \$1,808,670

LAND-USE TYPE : COMMERCIAL **BUILDING TYPE :** RESTAURANTS
YEAR BUILT : 1,960 **SQUARE FEET :** 1,922 **STYLE CODE :** 1.0 STORY
BEDROOMS : 0 **BATHROOMS :** 0 **RESTROOMS :** 0 **BASEMENT :** N **GARAGE :** N
EXTERIOR TYPE : COMMON BRICK **QUALITY GRADE :** 2 **IMPVMT. VALUE :** \$37,860
A/C : CENTRAL **FIREPLACE :** NONE

Record No.: 77 BUILDING KEY NUMBER : 08117723 005
PARCEL-ID: 08117723 NEIGHBORHOOD CODE : 08105 ZONING CLASS : B2
OWNER'S NAME : COLE PROPERTIES INC
MAILING ADDRESS : 1318 CENTRAL AVE STE F
CITY : CHARLOTTE STATE : NC ZIP CODE : 282055052

PROPERTY LOCATION : 1111 PECAN AV
LEGAL DESC. : L1 M31-415 DEED BK,PG & DATE : 01851 /559 1975-01-01
ACREAGE : 6.000 **SALE PRICE :** \$0 **QUALIFIED SALE (Y/N) :** N
LAND VALUE : \$892,500 **IMPVMTS VALUE:** \$916,170 **TOTAL VALUE :** \$1,808,670

LAND-USE TYPE : COMMERCIAL **BUILDING TYPE :** SERVICE STATION
YEAR BUILT : 1,959 **SQUARE FEET :** 1,647 **STYLE CODE :** 1.0 STORY
BEDROOMS : 0 **BATHROOMS :** 0 **RESTROOMS :** 0 **BASEMENT :** N **GARAGE :** N
EXTERIOR TYPE : CONCRETE BLOCK **QUALITY GRADE :** 2 **IMPVMT. VALUE :** \$21,350
A/C : NONE **FIREPLACE :** NONE

Record No.: 78 BUILDING KEY NUMBER : 08117724 001
PARCEL-ID: 08117724 NEIGHBORHOOD CODE : 08105 ZONING CLASS : B2
OWNER'S NAME : COLE PROPERTIES INC
MAILING ADDRESS : 1318 CENTRAL AVE STE F
CITY : CHARLOTTE STATE : NC ZIP CODE : 282055052

PROPERTY LOCATION : PECAN AV
LEGAL DESC. : L2 M31-415 DEED BK,PG & DATE : 01851 /559 1975-01-01
ACREAGE : 1.000 **SALE PRICE :** \$0 **QUALIFIED SALE (Y/N) :** N
LAND VALUE : \$274,320 **IMPVMTS VALUE:** \$616,860 **TOTAL VALUE :** \$891,180

LAND-USE TYPE : COMMERCIAL **BUILDING TYPE :** COMMERCIAL
YEAR BUILT : 2,000 **SQUARE FEET :** 11,625 **STYLE CODE :** 1.0 STORY
BEDROOMS : 0 **BATHROOMS :** 0 **RESTROOMS :** 0 **BASEMENT :** N **GARAGE :** N
EXTERIOR TYPE : FACE BRICK **QUALITY GRADE :** 4 **IMPVMT. VALUE :** \$611,670
A/C : CENTRAL **FIREPLACE :** NONE

NOTE: This data is prepared for the purposes of revaluation, assessing & determining ownership of real property & is compiled from recorded deeds, plats, tax maps & other public records & data. Users of this data are hereby notified that the aforementioned public information sources should be consulted for verification. Mecklenburg County assumes no legal responsibility for the information herein.



MECKLENBURG COUNTY, NC

DATE PRINTED 2/22/02

GIS PUBLIC ACCESS SYSTEM REPORT

Note : Records are sorted in Parcel Number order.

PAGE : 27

Record No.: 79 **BUILDING KEY NUMBER :** 08117724 002
PARCEL-ID : 08117724 **NEIGHBORHOOD CODE :** 08105 **ZONING CLASS :** B2
OWNER'S NAME : COLE PROPERTIES INC
MAILING ADDRESS : 1318 CENTRAL AVE STE F
CITY : CHARLOTTE **STATE :** NC **ZIP CODE :** 282055052

PROPERTY LOCATION : 1231 E INDEPENDENCE BLV
LEGAL DESC. : L2 M31-415 **DEED BK,PG & DATE :** 01851 /559 1975-01-01
ACREAGE : 1.000 **SALE PRICE :** \$0 **QUALIFIED SALE (Y/N) :** N
LAND VALUE : \$274,320 **IMPVMTS VALUE :** \$616,860 **TOTAL VALUE :** \$891,180

LAND-USE TYPE : VACANT **BUILDING TYPE :** SERVICE GARAGE
YEAR BUILT : 0 **SQUARE FEET :** 0 **STYLE CODE :**
BEDROOMS : 0 **BATHROOMS :** 0 **RESTROOMS :** 0 **BASEMENT :** N **GARAGE :** N
EXTERIOR TYPE : **QUALITY GRADE :** 0 **IMPVMT. VALUE :** \$0
A/C : **FIREPLACE :**

Record No.: 80 **BUILDING KEY NUMBER :** 12701606 001
PARCEL-ID : 12701606 **NEIGHBORHOOD CODE :** 12711 **ZONING CLASS :** R5
OWNER'S NAME : DEPT OF TRANSPORTATION
MAILING ADDRESS : 716 W MAIN ST
CITY : ALBEMARLE **STATE :** NC **ZIP CODE :** 280014626

PROPERTY LOCATION : 701 PECAN AV
LEGAL DESC. : 701 PECAN AVE **DEED BK,PG & DATE :** 07687 /051 1994-03-01
ACREAGE : 1.000 **SALE PRICE :** \$55,000 **QUALIFIED SALE (Y/N) :** N
LAND VALUE : \$4,800 **IMPVMTS VALUE :** \$0 **TOTAL VALUE :** \$4,800

LAND-USE TYPE : VACANT **BUILDING TYPE :** SINGLE FAMILY RESIDENTIAL
YEAR BUILT : 0 **SQUARE FEET :** 0 **STYLE CODE :**
BEDROOMS : 0 **BATHROOMS :** 0 **RESTROOMS :** 0 **BASEMENT :** N **GARAGE :** N
EXTERIOR TYPE : **QUALITY GRADE :** 0 **IMPVMT. VALUE :** \$0
A/C : **FIREPLACE :**

Record No.: 81 **BUILDING KEY NUMBER :** 12701607 001
PARCEL-ID : 12701607 **NEIGHBORHOOD CODE :** 12701 **ZONING CLASS :** I2
OWNER'S NAME : COLE PROPERTIES INC
MAILING ADDRESS : 1318 CENTRAL AVE STE F
CITY : CHARLOTTE **STATE :** NC **ZIP CODE :** 282055052

PROPERTY LOCATION : PECAN AV
LEGAL DESC. : NA **DEED BK,PG & DATE :** 01851 /559 1975-01-01
ACREAGE : 1.000 **SALE PRICE :** \$0 **QUALIFIED SALE (Y/N) :** N
LAND VALUE : \$78,410 **IMPVMTS VALUE :** \$95,870 **TOTAL VALUE :** \$174,280

LAND-USE TYPE : COMMERCIAL **BUILDING TYPE :** COMMERCIAL
YEAR BUILT : 1,998 **SQUARE FEET :** 1,590 **STYLE CODE :** 1.0 STORY
BEDROOMS : 0 **BATHROOMS :** 0 **RESTROOMS :** 0 **BASEMENT :** N **GARAGE :** N
EXTERIOR TYPE : FACE BRICK **QUALITY GRADE :** 2 **IMPVMT. VALUE :** \$79,340
A/C : CENTRAL **FIREPLACE :** NONE

NOTE: This data is prepared for the purposes of revaluation, assessing & determining ownership of real property & is compiled from recorded deeds, plats, tax maps & other public records & data. Users of this data are hereby notified that the aforementioned public information sources should be consulted for verification. Mecklenburg County assumes no legal responsibility for the information herein.



MECKLENBURG COUNTY, NC

DATE PRINTED 2/22/02

GIS PUBLIC ACCESS SYSTEM REPORT

Note : Records are sorted in Parcel Number order.

PAGE : 28

Record No.: 82 BUILDING KEY NUMBER : 12701607 002
PARCEL-ID : 12701607 NEIGHBORHOOD CODE : 12701 ZONING CLASS : I2
OWNER'S NAME : COLE PROPERTIES INC
MAILING ADDRESS : 1318 CENTRAL AVE STE F
CITY : CHARLOTTE STATE : NC ZIP CODE : 282055052

PROPERTY LOCATION : 913 PECAN AVE
LEGAL DESC. : NA DEED BK,PG & DATE : 01851 /559 1975-01-01
ACREAGE : 1.000 **SALE PRICE :** \$0 **QUALIFIED SALE (Y/N) :** N
LAND VALUE : \$78,410 **IMPVMTS VALUE :** \$95,870 **TOTAL VALUE :** \$174,280

LAND-USE TYPE : OFFICE **BUILDING TYPE :** OFFICE
YEAR BUILT : 1,954 **SQUARE FEET :** 480 **STYLE CODE :** 1.0 STORY
BEDROOMS : 0 **BATHROOMS :** 0 **RESTROOMS :** 0 **BASEMENT :** N **GARAGE :** N
EXTERIOR TYPE : CONCRETE BLOCK **QUALITY GRADE :** 1 **IMPVMT. VALUE :** \$9,610
A/C : NONE **FIREPLACE :** NONE

Record No.: 83 BUILDING KEY NUMBER : 12701607 003
PARCEL-ID : 12701607 NEIGHBORHOOD CODE : 12701 ZONING CLASS : I2
OWNER'S NAME : COLE PROPERTIES INC
MAILING ADDRESS : 1318 CENTRAL AVE STE F
CITY : CHARLOTTE STATE : NC ZIP CODE : 282055052

PROPERTY LOCATION : PECAN AV
LEGAL DESC. : NA DEED BK,PG & DATE : 01851 /559 1975-01-01
ACREAGE : 1.000 **SALE PRICE :** \$0 **QUALIFIED SALE (Y/N) :** N
LAND VALUE : \$78,410 **IMPVMTS VALUE :** \$95,870 **TOTAL VALUE :** \$174,280

LAND-USE TYPE : WAREHOUSE/INDUSTRIAL **BUILDING TYPE :** WAREHOUSE
YEAR BUILT : 1,954 **SQUARE FEET :** 896 **STYLE CODE :** 1.0 STORY
BEDROOMS : 0 **BATHROOMS :** 0 **RESTROOMS :** 0 **BASEMENT :** N **GARAGE :** N
EXTERIOR TYPE : CONCRETE BLOCK **QUALITY GRADE :** 1 **IMPVMT. VALUE :** \$6,920
A/C : NONE **FIREPLACE :** NONE

Record No.: 84 BUILDING KEY NUMBER : 12701608 001
PARCEL-ID : 12701608 NEIGHBORHOOD CODE : 12701 ZONING CLASS : I2
OWNER'S NAME : DEPT OF TRANSPORTATION
MAILING ADDRESS : 716 W MAIN ST
CITY : ALBEMARLE STATE : NC ZIP CODE : 28001

PROPERTY LOCATION : 801 PECAN AV
LEGAL DESC. : 801 PECAN AVE DEED BK,PG & DATE : 06809 /330 1992-03-19
ACREAGE : 0.000 **SALE PRICE :** \$680,000 **QUALIFIED SALE (Y/N) :** N
LAND VALUE : \$26,140 **IMPVMTS VALUE :** \$0 **TOTAL VALUE :** \$26,140

LAND-USE TYPE : VACANT **BUILDING TYPE :** INDUSTRIAL
YEAR BUILT : 0 **SQUARE FEET :** 0 **STYLE CODE :**
BEDROOMS : 0 **BATHROOMS :** 0 **RESTROOMS :** 0 **BASEMENT :** N **GARAGE :** N
EXTERIOR TYPE : **QUALITY GRADE :** 0 **IMPVMT. VALUE :** \$0
A/C : **FIREPLACE :**

NOTE: This data is prepared for the purposes of revaluation, assessing & determining ownership of real property & is compiled from recorded deeds, plats, tax maps & other public records & data. Users of this data are hereby notified that the aforementioned public information sources should be consulted for verification. Mecklenburg County assumes no legal responsibility for the information herein.



MECKLENBURG COUNTY, NC

DATE PRINTED 2/22/02

GIS PUBLIC ACCESS SYSTEM REPORT

Note : Records are sorted in Parcel Number order.

PAGE : 29

Record No.: 85 **BUILDING KEY NUMBER :** 12701609 001
PARCEL-ID : 12701609 **NEIGHBORHOOD CODE :** 12701 **ZONING CLASS :** I2
OWNER'S NAME : DEPT OF TRANSPORTATION
MAILING ADDRESS : 716 W MAIN ST
CITY : ALBEMARLE **STATE :** NC **ZIP CODE :** 280014626

PROPERTY LOCATION : 754 CLEMENT AV
LEGAL DESC. : NA **DEED BK,PG & DATE :** 07687 /051 1994-03-01
ACREAGE : 0.000 **SALE PRICE :** \$55,000 **QUALIFIED SALE (Y/N) :** N
LAND VALUE : \$650 **IMPVMTS VALUE :** \$0 **TOTAL VALUE :** \$650

LAND-USE TYPE : VACANT **BUILDING TYPE :** INDUSTRIAL
YEAR BUILT : 0 **SQUARE FEET :** 0 **STYLE CODE :**
BEDROOMS : 0 **BATHROOMS :** 0 **RESTROOMS :** 0 **BASEMENT :** N **GARAGE :** N
EXTERIOR TYPE : **QUALITY GRADE :** 0 **IMPVMT. VALUE :** \$0
A/C : **FIREPLACE :**

Record No.: 86 **BUILDING KEY NUMBER :** 12701610 001
PARCEL-ID : 12701610 **NEIGHBORHOOD CODE :** 12711 **ZONING CLASS :** R5
OWNER'S NAME : MILLER LESTER EUGENE &WF JANIE FRYE
MAILING ADDRESS : 7311 PLOTT RD
CITY : CHARLOTTE **STATE :** NC **ZIP CODE :** 28215

PROPERTY LOCATION : 734 CLEMENT AV
LEGAL DESC. : L5 &STR B11 M3-2 **DEED BK,PG & DATE :** 03759 /901 1975-05-30
ACREAGE : 0.000 **SALE PRICE :** \$0 **QUALIFIED SALE (Y/N) :** N
LAND VALUE : \$110,000 **IMPVMTS VALUE :** \$63,470 **TOTAL VALUE :** \$173,470

LAND-USE TYPE : SINGLE FAMILY **BUILDING TYPE :** SINGLE FAMILY RESIDENTIAL
YEAR BUILT : 1,990 **SQUARE FEET :** 1,008 **STYLE CODE :** 1.0 STORY
BEDROOMS : 3 **BATHROOMS :** 2 **RESTROOMS :** 0 **BASEMENT :** N **GARAGE :** N
EXTERIOR TYPE : ALUMINUM/VINYL SIDING **QUALITY GRADE :** 2 **IMPVMT. VALUE :** \$63,330
A/C : CENTRAL **FIREPLACE :** NONE

Record No.: 87 **BUILDING KEY NUMBER :** 12701611 001
PARCEL-ID : 12701611 **NEIGHBORHOOD CODE :** 12711 **ZONING CLASS :** R5
OWNER'S NAME : GILMORE SUSAN J & MATTHEW A AIKEN
MAILING ADDRESS : 728 CLEMENT AVE
CITY : CHARLOTTE **STATE :** NC **ZIP CODE :** 282042310

PROPERTY LOCATION : 728 CLEMENT AV
LEGAL DESC. : L6 B11 M3-2 **DEED BK,PG & DATE :** 09715 /252 1998-06-03
ACREAGE : 0.000 **SALE PRICE :** \$185,000 **QUALIFIED SALE (Y/N) :** Y
LAND VALUE : \$85,000 **IMPVMTS VALUE :** \$86,220 **TOTAL VALUE :** \$171,220

LAND-USE TYPE : SINGLE FAMILY **BUILDING TYPE :** SINGLE FAMILY RESIDENTIAL
YEAR BUILT : 1,935 **SQUARE FEET :** 1,596 **STYLE CODE :** 2.0 STORIES
BEDROOMS : 3 **BATHROOMS :** 2 **RESTROOMS :** 0 **BASEMENT :** N **GARAGE :** N
EXTERIOR TYPE : FACE BRICK **QUALITY GRADE :** 2 **IMPVMT. VALUE :** \$86,220
A/C : CENTRAL **FIREPLACE :** 1 STY SINGLE

NOTE: This data is prepared for the purposes of revaluation, assessing & determining ownership of real property & is compiled from recorded deeds, plats, tax maps & other public records & data. Users of this data are hereby notified that the aforementioned public information sources should be consulted for verification. Mecklenburg County assumes no legal responsibility for the information herein.



MECKLENBURG COUNTY, NC

DATE PRINTED 2/22/02

GIS PUBLIC ACCESS SYSTEM REPORT

Note : Records are sorted in Parcel Number order.

PAGE : 30

Record No.: 88 **BUILDING KEY NUMBER :** 12701612 001
PARCEL-ID : 12701612 **NEIGHBORHOOD CODE :** 12711 **ZONING CLASS :** R5
OWNER'S NAME : WATSON LYNN S &HSB MICHAEL A
MAILING ADDRESS : 724 CLEMENT AVE
CITY : CHARLOTTE **STATE :** NC **ZIP CODE :** 28204

PROPERTY LOCATION : 724 CLEMENT AV
LEGAL DESC. : L7 B11 M195-28 **DEED BK,PG & DATE :** 07778 /011 1994-05-16
ACREAGE : 0.000 **SALE PRICE :** \$0 **QUALIFIED SALE (Y/N) :** N
LAND VALUE : \$85,000 **IMPVMTS VALUE :** \$93,660 **TOTAL VALUE :** \$178,660

LAND-USE TYPE : SINGLE FAMILY **BUILDING TYPE :** SINGLE FAMILY RESIDENTIAL
YEAR BUILT : 1,926 **SQUARE FEET :** 1,826 **STYLE CODE :** 2.0 STORIES
BEDROOMS : 3 **BATHROOMS :** 1 **RESTROOMS :** 0 **BASEMENT :** N **GARAGE :** N
EXTERIOR TYPE : WOOD ON SHEATHING OR PLYWO **QUALITY GRADE :** 3 **IMPVMT. VALUE :** \$90,660
A/C : CENTRAL **FIREPLACE :** 2 OR MORE

Record No.: 89 **BUILDING KEY NUMBER :** 12701613 001
PARCEL-ID : 12701613 **NEIGHBORHOOD CODE :** 12711 **ZONING CLASS :** R5
OWNER'S NAME : DANIELS EDWARD A J JR KRISTEN J DANIELS (H/W)
MAILING ADDRESS : 716 CLEMENT AVE
CITY : CHARLOTTE **STATE :** NC **ZIP CODE :** 28204

PROPERTY LOCATION : 720 CLEMENT AV
LEGAL DESC. : L8 B11 M195-28 **DEED BK,PG & DATE :** 12673 /424 2001-09-20
ACREAGE : 0.000 **SALE PRICE :** \$0 **QUALIFIED SALE (Y/N) :** N
LAND VALUE : \$85,000 **IMPVMTS VALUE :** \$85,350 **TOTAL VALUE :** \$170,350

LAND-USE TYPE : SINGLE FAMILY **BUILDING TYPE :** SINGLE FAMILY RESIDENTIAL
YEAR BUILT : 1,926 **SQUARE FEET :** 1,722 **STYLE CODE :** 2.0 STORIES
BEDROOMS : 3 **BATHROOMS :** 1 **RESTROOMS :** 0 **BASEMENT :** N **GARAGE :** N
EXTERIOR TYPE : WOOD ON SHEATHING OR PLYWO **QUALITY GRADE :** 3 **IMPVMT. VALUE :** \$82,020
A/C : NONE **FIREPLACE :** 1 STY SINGLE

Record No.: 90 **BUILDING KEY NUMBER :** 12701620 001
PARCEL-ID : 12701620 **NEIGHBORHOOD CODE :** 12711 **ZONING CLASS :** I2
OWNER'S NAME : DEPT OF TRANSPORTATION
MAILING ADDRESS : 716 W MAIN ST
CITY : ALBEMARLE **STATE :** NC **ZIP CODE :** 280014626

PROPERTY LOCATION : CLEMENT AV
LEGAL DESC. : NA **DEED BK,PG & DATE :** 08844 /475 1996-12-04
ACREAGE : 0.000 **SALE PRICE :** \$0 **QUALIFIED SALE (Y/N) :** N
LAND VALUE : \$56,630 **IMPVMTS VALUE :** \$0 **TOTAL VALUE :** \$56,630

LAND-USE TYPE : VACANT **BUILDING TYPE :** INDUSTRIAL
YEAR BUILT : 0 **SQUARE FEET :** 0 **STYLE CODE :**
BEDROOMS : 0 **BATHROOMS :** 0 **RESTROOMS :** 0 **BASEMENT :** N **GARAGE :** N
EXTERIOR TYPE : **QUALITY GRADE :** 0 **IMPVMT. VALUE :** \$0
A/C : **FIREPLACE :**

NOTE: This data is prepared for the purposes of revaluation, assessing & determining ownership of real property & is compiled from recorded deeds, plats, tax maps & other public records & data. Users of this data are hereby notified that the aforementioned public information sources should be consulted for verification. Mecklenburg County assumes no legal responsibility for the information herein.



MECKLENBURG COUNTY, NC

DATE PRINTED 2/22/02

GIS PUBLIC ACCESS SYSTEM REPORT

Note : Records are sorted in Parcel Number order.

PAGE : 31

Record No.: 91 **BUILDING KEY NUMBER :** 12701707 001
PARCEL-ID : 12701707 **NEIGHBORHOOD CODE :** 12711 **ZONING CLASS :** R5
OWNER'S NAME : MINOR HARDIN M &WF LINDA D
MAILING ADDRESS : 721 CLEMENT AVE
CITY : CHARLOTTE **STATE :** NC **ZIP CODE :** 28204

PROPERTY LOCATION : 721 CLEMENT AV
LEGAL DESC. : L18 & 19 B12 M195-28 **DEED BK,PG & DATE :** 06732 /413 1992-01-08
ACREAGE : 0.000 **SALE PRICE :** \$186,500 **QUALIFIED SALE (Y/N) :** Y
LAND VALUE : \$90,000 **IMPVMTS VALUE :** \$132,780 **TOTAL VALUE :** \$222,780

LAND-USE TYPE : SINGLE FAMILY **BUILDING TYPE :** SINGLE FAMILY RESIDENTIAL
YEAR BUILT : 1,916 **SQUARE FEET :** 2,376 **STYLE CODE :** 2.0 STORIES
BEDROOMS : 3 **BATHROOMS :** 2 **RESTROOMS :** 0 **BASEMENT :** Y **GARAGE :** N
EXTERIOR TYPE : MASONITE ON SHEATHING **QUALITY GRADE :** 3 **IMPVMT. VALUE :** \$131,090
A/C : CENTRAL **FIREPLACE :** 1 STY SINGLE

Record No.: 92 **BUILDING KEY NUMBER :** 12701708 001
PARCEL-ID : 12701708 **NEIGHBORHOOD CODE :** 12711 **ZONING CLASS :** R5
OWNER'S NAME : EMADI-PARAMKOUHI BONITA
MAILING ADDRESS : 725 CLEMENT AVE
CITY : CHARLOTTE **STATE :** NC **ZIP CODE :** 282042309

PROPERTY LOCATION : 725 CLEMENT AV
LEGAL DESC. : L19 B12 M230-151 **DEED BK,PG & DATE :** 08555 /537 1996-04-30
ACREAGE : 0.000 **SALE PRICE :** \$90,000 **QUALIFIED SALE (Y/N) :** N
LAND VALUE : \$85,000 **IMPVMTS VALUE :** \$101,370 **TOTAL VALUE :** \$186,370

LAND-USE TYPE : SINGLE FAMILY **BUILDING TYPE :** SINGLE FAMILY RESIDENTIAL
YEAR BUILT : 1,927 **SQUARE FEET :** 1,955 **STYLE CODE :** 1.5 STORIES
BEDROOMS : 3 **BATHROOMS :** 2 **RESTROOMS :** 0 **BASEMENT :** Y **GARAGE :** N
EXTERIOR TYPE : WOOD SHINGLE/LOG **QUALITY GRADE :** 3 **IMPVMT. VALUE :** \$100,080
A/C : CENTRAL **FIREPLACE :** 1 STY SINGLE

Record No.: 93 **BUILDING KEY NUMBER :** 12701709 001
PARCEL-ID : 12701709 **NEIGHBORHOOD CODE :** 12711 **ZONING CLASS :** R5
OWNER'S NAME : PARSONS SUSANNE MITCHELL
MAILING ADDRESS : 729 CLEMENT AVE
CITY : CHARLOTTE **STATE :** NC **ZIP CODE :** 282042309

PROPERTY LOCATION : 729 CLEMENT AV
LEGAL DESC. : L18 B12 M230-151 **DEED BK,PG & DATE :** 11081 /055 2000-02-11
ACREAGE : 0.000 **SALE PRICE :** \$0 **QUALIFIED SALE (Y/N) :** Y
LAND VALUE : \$85,000 **IMPVMTS VALUE :** \$59,460 **TOTAL VALUE :** \$144,460

LAND-USE TYPE : SINGLE FAMILY **BUILDING TYPE :** SINGLE FAMILY RESIDENTIAL
YEAR BUILT : 1,935 **SQUARE FEET :** 1,185 **STYLE CODE :** 1.0 STORY
BEDROOMS : 3 **BATHROOMS :** 1 **RESTROOMS :** 0 **BASEMENT :** Y **GARAGE :** N
EXTERIOR TYPE : ALUMINUM/VINYL SIDING **QUALITY GRADE :** 2 **IMPVMT. VALUE :** \$59,460
A/C : NONE **FIREPLACE :** 1 STY SINGLE

NOTE: This data is prepared for the purposes of revaluation, assessing & determining ownership of real property & is compiled from recorded deeds, plats, tax maps & other public records & data. Users of this data are hereby notified that the aforementioned public information sources should be consulted for verification. Mecklenburg County assumes no legal responsibility for the information herein.



MECKLENBURG COUNTY, NC

DATE PRINTED 2/22/02

GIS PUBLIC ACCESS SYSTEM REPORT

Note : Records are sorted in Parcel Number order.

PAGE : 32

Record No.: 94 **BUILDING KEY NUMBER :** 12701711 001
PARCEL-ID : 12701711 **NEIGHBORHOOD CODE :** 12711 **ZONING CLASS :** B1
OWNER'S NAME : DOWD JOHN E JR
MAILING ADDRESS : 741 CLEMENT AVE
CITY : CHARLOTTE **STATE :** NC **ZIP CODE :** 282042309

PROPERTY LOCATION : 741 CLEMENT AV
LEGAL DESC. : L16 & P17 B12 M230-151 **DEED BK,PG & DATE :** 09741 /396 1998-06-18
ACREAGE : 0.000 **SALE PRICE :** \$169,000 **QUALIFIED SALE (Y/N) :** N
LAND VALUE : \$48,090 **IMPVMTS VALUE :** \$44,880 **TOTAL VALUE :** \$92,970

LAND-USE TYPE : SINGLE FAMILY **BUILDING TYPE :** SINGLE FAMILY RESIDENTIAL
YEAR BUILT : 1,925 **SQUARE FEET :** 1,734 **STYLE CODE :** 2.0 STORIES
BEDROOMS : 3 **BATHROOMS :** 2 **RESTROOMS :** 0 **BASEMENT :** Y **GARAGE :** N
EXTERIOR TYPE : WOOD SHINGLE/LOG **QUALITY GRADE :** 2 **IMPVMT. VALUE :** \$42,350
A/C : CENTRAL **FIREPLACE :** 1 STY SINGLE

Record No.: 95 **BUILDING KEY NUMBER :** 12701712 001
PARCEL-ID : 12701712 **NEIGHBORHOOD CODE :** 12701 **ZONING CLASS :** B1
OWNER'S NAME : DEPT OF TRANSPORTATION
MAILING ADDRESS : 716 W MAIN ST
CITY : ALBEMARLE **STATE :** NC **ZIP CODE :** 280014626

PROPERTY LOCATION : 757 CLEMENT AV
LEGAL DESC. : L14 & P15 P13 B12 M230-151 **DEED BK,PG & DATE :** 07251 /653 1993-04-05
ACREAGE : 0.000 **SALE PRICE :** \$386,000 **QUALIFIED SALE (Y/N) :** N
LAND VALUE : \$13,720 **IMPVMTS VALUE :** \$0 **TOTAL VALUE :** \$13,720

LAND-USE TYPE : VACANT **BUILDING TYPE :** COMMERCIAL
YEAR BUILT : 0 **SQUARE FEET :** 0 **STYLE CODE :**
BEDROOMS : 0 **BATHROOMS :** 0 **RESTROOMS :** 0 **BASEMENT :** N **GARAGE :** N
EXTERIOR TYPE : **QUALITY GRADE :** 0 **IMPVMT. VALUE :** \$0
A/C : **FIREPLACE :**

Record No.: 96 **BUILDING KEY NUMBER :** 12701724 001
PARCEL-ID : 12701724 **NEIGHBORHOOD CODE :** 12711 **ZONING CLASS :** R5
OWNER'S NAME : COCKRUM VICKIE DIANE
MAILING ADDRESS : 733 CLEMENT AV
CITY : CHARLOTTE **STATE :** NC **ZIP CODE :** 28204

PROPERTY LOCATION : 733 CLEMENT AV
LEGAL DESC. : UNIT A U/F 540-1 **DEED BK,PG & DATE :** 11566 /404 2000-09-12
ACREAGE : 0.000 **SALE PRICE :** \$182,500 **QUALIFIED SALE (Y/N) :** Y
LAND VALUE : \$70,000 **IMPVMTS VALUE :** \$98,520 **TOTAL VALUE :** \$168,520

LAND-USE TYPE : CONDOMINIUM **BUILDING TYPE :** CONDO
YEAR BUILT : 1,935 **SQUARE FEET :** 1,728 **STYLE CODE :** 2.0 STORIES
BEDROOMS : 2 **BATHROOMS :** 2 **RESTROOMS :** 0 **BASEMENT :** N **GARAGE :** N
EXTERIOR TYPE : STUCCO ON TILE OR WOOD FRAM **QUALITY GRADE :** 3 **IMPVMT. VALUE :** \$96,210
A/C : CENTRAL **FIREPLACE :** 2 STY SINGLE/1 DBL

NOTE: This data is prepared for the purposes of revaluation, assessing & determining ownership of real property & is compiled from recorded deeds, plats, tax maps & other public records & data. Users of this data are hereby notified that the aforementioned public information sources should be consulted for verification. Mecklenburg County assumes no legal responsibility for the information herein.



MECKLENBURG COUNTY, NC

DATE PRINTED 2/22/02

GIS PUBLIC ACCESS SYSTEM REPORT

Note : Records are sorted in Parcel Number order.

PAGE : 33

Record No.: 97 **BUILDING KEY NUMBER :** 12701725 001
PARCEL-ID : 12701725 **NEIGHBORHOOD CODE :** 12711 **ZONING CLASS :** R5
OWNER'S NAME : KOTOUCH PAUL RICHARD CHRISTINE A KOTOUCH (H/W)ET-AL
MAILING ADDRESS : 8000 RITTER DR
CITY : CHARLOTTE **STATE :** NC **ZIP CODE :** 28270

PROPERTY LOCATION : 735 CLEMENT AV
LEGAL DESC. : UNIT B U/F 540-1 **DEED BK,PG & DATE :** 09590 /533 1998-03-31
ACREAGE : 0.000 **SALE PRICE :** \$0 **QUALIFIED SALE (Y/N) :** Y
LAND VALUE : \$70,000 **IMPVMTS VALUE :** \$94,400 **TOTAL VALUE :** \$164,400

LAND-USE TYPE : CONDOMINIUM **BUILDING TYPE :** CONDO
YEAR BUILT : 1,935 **SQUARE FEET :** 1,728 **STYLE CODE :** 2.0 STORIES
BEDROOMS : 2 **BATHROOMS :** 2 **RESTROOMS :** 0 **BASEMENT :** N **GARAGE :** N
EXTERIOR TYPE : STUCCO ON TILE OR WOOD FRAM **QUALITY GRADE :** 3 **IMPVMT. VALUE :** \$92,090
A/C : CENTRAL **FIREPLACE :** 2 STY SINGLE/1 DBL

Record No.: 98 **BUILDING KEY NUMBER :** 12702401 001
PARCEL-ID : 12702401 **NEIGHBORHOOD CODE :** 12710 **ZONING CLASS :** R5
OWNER'S NAME : EL-KHOURI CATHERINE
MAILING ADDRESS : 2100 SHENANDOAH AVE
CITY : CHARLOTTE **STATE :** NC **ZIP CODE :** 28205

PROPERTY LOCATION : 2100 SHENANDOAH AV
LEGAL DESC. : L1P2B27M230-248 2100 SHENANDO **DEED BK,PG & DATE :** 10634 /363 1999-07-23
ACREAGE : 0.000 **SALE PRICE :** \$200,000 **QUALIFIED SALE (Y/N) :** Y
LAND VALUE : \$75,000 **IMPVMTS VALUE :** \$79,480 **TOTAL VALUE :** \$154,480

LAND-USE TYPE : SINGLE FAMILY **BUILDING TYPE :** SINGLE FAMILY RESIDENTIAL
YEAR BUILT : 1,938 **SQUARE FEET :** 1,616 **STYLE CODE :** 1.0 STORY
BEDROOMS : 3 **BATHROOMS :** 1 **RESTROOMS :** 0 **BASEMENT :** N **GARAGE :** N
EXTERIOR TYPE : FACE BRICK **QUALITY GRADE :** 2 **IMPVMT. VALUE :** \$75,970
A/C : NONE **FIREPLACE :** 1 STY SINGLE

Record No.: 99 **BUILDING KEY NUMBER :** 12702605 001
PARCEL-ID : 12702605 **NEIGHBORHOOD CODE :** 12710 **ZONING CLASS :** R5
OWNER'S NAME : DEPT OF TRANSPORTATION
MAILING ADDRESS : 716 W MAIN ST
CITY : ALBEMARLE **STATE :** NC **ZIP CODE :** 28001

PROPERTY LOCATION : 2023 SHENANDOAH AV
LEGAL DESC. : P21-23B18M230-248&9 SHENANDOAH **DEED BK,PG & DATE :** 07459 /773 1993-09-16
ACREAGE : 0.000 **SALE PRICE :** \$60,500 **QUALIFIED SALE (Y/N) :** N
LAND VALUE : \$25,000 **IMPVMTS VALUE :** \$0 **TOTAL VALUE :** \$25,000

LAND-USE TYPE : VACANT **BUILDING TYPE :** SINGLE FAMILY RESIDENTIAL
YEAR BUILT : 0 **SQUARE FEET :** 0 **STYLE CODE :**
BEDROOMS : 0 **BATHROOMS :** 0 **RESTROOMS :** 0 **BASEMENT :** N **GARAGE :** N
EXTERIOR TYPE : **QUALITY GRADE :** 0 **IMPVMT. VALUE :** \$0
A/C : **FIREPLACE :**



MECKLENBURG COUNTY, NC

DATE PRINTED 2/22/02

GIS PUBLIC ACCESS SYSTEM REPORT

Note : Records are sorted in Parcel Number order.

PAGE : 34

Record No.: 100 **BUILDING KEY NUMBER :** 12702607 001
PARCEL-ID : 12702607 **NEIGHBORHOOD CODE :** 12710 **ZONING CLASS :** R5
OWNER'S NAME : CARROLL WILLIAM G II
MAILING ADDRESS : 2033 SHENANDOAH AVE
CITY : CHARLOTTE **STATE :** NC **ZIP CODE :** 282055007

PROPERTY LOCATION : 2033 SHENANDOAH AV
LEGAL DESC. : P24 B18 M230-248 **DEED BK,PG & DATE :** 11463 /199 2000-07-31
ACREAGE : 0.000 **SALE PRICE :** \$125,500 **QUALIFIED SALE (Y/N) :** Y
LAND VALUE : \$50,000 **IMPVMTS VALUE :** \$54,360 **TOTAL VALUE :** \$104,360

LAND-USE TYPE : SINGLE FAMILY **BUILDING TYPE :** SINGLE FAMILY RESIDENTIAL
YEAR BUILT : 1,943 **SQUARE FEET :** 1,098 **STYLE CODE :** 1.0 STORY
BEDROOMS : 2 **BATHROOMS :** 1 **RESTROOMS :** 0 **BASEMENT :** N **GARAGE :** N
EXTERIOR TYPE : FACE BRICK **QUALITY GRADE :** 2 **IMPVMT. VALUE :** \$54,170
A/C : NONE **FIREPLACE :** 1 STY SINGLE

Record No.: 101 **BUILDING KEY NUMBER :** 12702608 001
PARCEL-ID : 12702608 **NEIGHBORHOOD CODE :** 12710 **ZONING CLASS :** R5
OWNER'S NAME : CRAVOTTA JEFF
MAILING ADDRESS : 2035 SHENANDOAH AVE
CITY : CHARLOTTE **STATE :** NC **ZIP CODE :** 28205

PROPERTY LOCATION : 2035 SHENANDOAH AV
LEGAL DESC. : P25B18M230-248&9 2035 SHENANDO **DEED BK,PG & DATE :** 06116 /204 1989-09-15
ACREAGE : 0.000 **SALE PRICE :** \$0 **QUALIFIED SALE (Y/N) :** N
LAND VALUE : \$50,000 **IMPVMTS VALUE :** \$60,760 **TOTAL VALUE :** \$110,760

LAND-USE TYPE : SINGLE FAMILY **BUILDING TYPE :** SINGLE FAMILY RESIDENTIAL
YEAR BUILT : 1,938 **SQUARE FEET :** 1,236 **STYLE CODE :** 1.0 STORY
BEDROOMS : 3 **BATHROOMS :** 1 **RESTROOMS :** 0 **BASEMENT :** N **GARAGE :** N
EXTERIOR TYPE : SIDING AVERAGE **QUALITY GRADE :** 2 **IMPVMT. VALUE :** \$60,760
A/C : NONE **FIREPLACE :** 1 STY SINGLE

Record No.: 102 **BUILDING KEY NUMBER :** 12702609 001
PARCEL-ID : 12702609 **NEIGHBORHOOD CODE :** 12710 **ZONING CLASS :** R5
OWNER'S NAME : MCNATT HEATHER L %FIRST AMERICAN TAX SERVICE
MAILING ADDRESS : 8435 STEMMONS FREEWAY
CITY : DALLAS **STATE :** TX **ZIP CODE :** 75847

PROPERTY LOCATION : 2039 SHENANDOAH AV
LEGAL DESC. : P26 B18 M230-248 & 249 **DEED BK,PG & DATE :** 12910 /235 2001-11-20
ACREAGE : 0.000 **SALE PRICE :** \$140,000 **QUALIFIED SALE (Y/N) :** Y
LAND VALUE : \$50,000 **IMPVMTS VALUE :** \$53,880 **TOTAL VALUE :** \$103,880

LAND-USE TYPE : SINGLE FAMILY **BUILDING TYPE :** SINGLE FAMILY RESIDENTIAL
YEAR BUILT : 1,944 **SQUARE FEET :** 1,030 **STYLE CODE :** 1.0 STORY
BEDROOMS : 3 **BATHROOMS :** 1 **RESTROOMS :** 0 **BASEMENT :** N **GARAGE :** N
EXTERIOR TYPE : WOOD ON SHEATHING OR PLYWO **QUALITY GRADE :** 2 **IMPVMT. VALUE :** \$53,880
A/C : CENTRAL **FIREPLACE :** 1 STY SINGLE

NOTE: This data is prepared for the purposes of revaluation, assessing & determining ownership of real property & is compiled from recorded deeds, plats, tax maps & other public records & data. Users of this data are hereby notified that the aforementioned public information sources should be consulted for verification. Mecklenburg County assumes no legal responsibility for the information herein.



MECKLENBURG COUNTY, NC

DATE PRINTED 2/22/02

GIS PUBLIC ACCESS SYSTEM REPORT

Note : Records are sorted in Parcel Number order.

PAGE : 35

Record No.: 103 **BUILDING KEY NUMBER :** 12702610 001
PARCEL-ID : 12702610 **NEIGHBORHOOD CODE :** 12710 **ZONING CLASS :** R5
OWNER'S NAME : HELMS HENRY RUSSELL
MAILING ADDRESS : 3009 GRIFFITH ST
CITY : CHARLOTTE **STATE :** NC **ZIP CODE :** 28203

PROPERTY LOCATION : 2043 SHENANDOAH AV
LEGAL DESC. : L27 B18 M230 248&9 2043 SHENAN **DEED BK,PG & DATE :** 06206 /913 1990-02-13
ACREAGE : 0.000 **SALE PRICE :** \$6,500 **QUALIFIED SALE (Y/N) :** Y
LAND VALUE : \$50,000 **IMPVMTS VALUE :** \$0 **TOTAL VALUE :** \$50,000

LAND-USE TYPE : VACANT **BUILDING TYPE :** SINGLE FAMILY RESIDENTIAL
YEAR BUILT : 0 **SQUARE FEET :** 0 **STYLE CODE :**
BEDROOMS : 0 **BATHROOMS :** 0 **RESTROOMS :** 0 **BASEMENT :** N **GARAGE :** N
EXTERIOR TYPE : **QUALITY GRADE :** 0 **IMPVMT. VALUE :** \$0
A/C : **FIREPLACE :**

Record No.: 104 **BUILDING KEY NUMBER :** 12702611 001
PARCEL-ID : 12702611 **NEIGHBORHOOD CODE :** 12710 **ZONING CLASS :** R5
OWNER'S NAME : HELMS HENRY R
MAILING ADDRESS : 3009 GRIFFITH ST
CITY : CHARLOTTE **STATE :** NC **ZIP CODE :** 28203

PROPERTY LOCATION : 2047 SHENANDOAH AV
LEGAL DESC. : L28 B18 M230 248 2047 SHENANDO **DEED BK,PG & DATE :** 04804 /612 1984-03-19
ACREAGE : 0.000 **SALE PRICE :** \$31,000 **QUALIFIED SALE (Y/N) :** Y
LAND VALUE : \$50,000 **IMPVMTS VALUE :** \$43,450 **TOTAL VALUE :** \$93,450

LAND-USE TYPE : SINGLE FAMILY **BUILDING TYPE :** SINGLE FAMILY RESIDENTIAL
YEAR BUILT : 1,944 **SQUARE FEET :** 928 **STYLE CODE :** 1.0 STORY
BEDROOMS : 2 **BATHROOMS :** 1 **RESTROOMS :** 0 **BASEMENT :** N **GARAGE :** N
EXTERIOR TYPE : ASBESTOS SHINGLE **QUALITY GRADE :** 2 **IMPVMT. VALUE :** \$43,370
A/C : NONE **FIREPLACE :** 1 STY SINGLE

Record No.: 105 **BUILDING KEY NUMBER :** 12702612 001
PARCEL-ID : 12702612 **NEIGHBORHOOD CODE :** 12710 **ZONING CLASS :** R5
OWNER'S NAME : DAY JEFFREY ALAN
MAILING ADDRESS : 2051 SHENANDOAH AVE
CITY : CHARLOTTE **STATE :** NC **ZIP CODE :** 282055007

PROPERTY LOCATION : 2051 SHENANDOAH AV
LEGAL DESC. : L29 B18 M230-248 **DEED BK,PG & DATE :** 09237 /689 1997-09-03
ACREAGE : 0.000 **SALE PRICE :** \$6,000 **QUALIFIED SALE (Y/N) :** N
LAND VALUE : \$50,000 **IMPVMTS VALUE :** \$54,530 **TOTAL VALUE :** \$104,530

LAND-USE TYPE : SINGLE FAMILY **BUILDING TYPE :** SINGLE FAMILY RESIDENTIAL
YEAR BUILT : 1,996 **SQUARE FEET :** 924 **STYLE CODE :** 1.0 STORY
BEDROOMS : 3 **BATHROOMS :** 2 **RESTROOMS :** 0 **BASEMENT :** N **GARAGE :** N
EXTERIOR TYPE : ALUMINUM/VINYL SIDING **QUALITY GRADE :** 2 **IMPVMT. VALUE :** \$54,230
A/C : CENTRAL **FIREPLACE :** NONE



MECKLENBURG COUNTY, NC

DATE PRINTED 2/22/02

GIS PUBLIC ACCESS SYSTEM REPORT

Note : Records are sorted in Parcel Number order.

PAGE : 36

Record No.: 106 **BUILDING KEY NUMBER :** 12702613 001
PARCEL-ID : 12702613 **NEIGHBORHOOD CODE :** 12710 **ZONING CLASS :** R5
OWNER'S NAME : HELMS HENRY R
MAILING ADDRESS : 3009 GRIFFITH ST
CITY : CHARLOTTE **STATE :** NC **ZIP CODE :** 28203

PROPERTY LOCATION : 2055 SHENANDOAH AV
LEGAL DESC. : L30 B18 M230 248 2055 SHENAND **DEED BK,PG & DATE :** 04804 /614 1984-03-19
ACREAGE : 0.000 **SALE PRICE :** \$33,000 **QUALIFIED SALE (Y/N) :** Y
LAND VALUE : \$50,000 **IMPVMTS VALUE :** \$80,590 **TOTAL VALUE :** \$130,590

LAND-USE TYPE : SINGLE FAMILY **BUILDING TYPE :** SINGLE FAMILY RESIDENTIAL
YEAR BUILT : 1,928 **SQUARE FEET :** 1,530 **STYLE CODE :** 1.0 STORY
BEDROOMS : 3 **BATHROOMS :** 1 **RESTROOMS :** 0 **BASEMENT :** Y **GARAGE :** N
EXTERIOR TYPE : FACE BRICK **QUALITY GRADE :** 2 **IMPVMT. VALUE :** \$77,440
A/C : NONE **FIREPLACE :** 1 STY SINGLE

Record No.: 107 **BUILDING KEY NUMBER :** 12702701 001
PARCEL-ID : 12702701 **NEIGHBORHOOD CODE :** 12701 **ZONING CLASS :** B1
OWNER'S NAME : SQUIRES REALTY INC % BILL SQUIRES
MAILING ADDRESS : PO BOX 9038
CITY : CHARLOTTE **STATE :** NC **ZIP CODE :** 282999038

PROPERTY LOCATION : 908 PECAN AV
LEGAL DESC. : L1-4&7ETC B26 908 PECAN AVE **DEED BK,PG & DATE :** 02489 /377 1975-01-01
ACREAGE : 1.000 **SALE PRICE :** \$0 **QUALIFIED SALE (Y/N) :** N
LAND VALUE : \$180,780 **IMPVMTS VALUE :** \$660,550 **TOTAL VALUE :** \$841,330

LAND-USE TYPE : OFFICE **BUILDING TYPE :** OFFICE
YEAR BUILT : 1,967 **SQUARE FEET :** 19,323 **STYLE CODE :** 2.5 STORIES OR MORE
BEDROOMS : 0 **BATHROOMS :** 0 **RESTROOMS :** 0 **BASEMENT :** N **GARAGE :** N
EXTERIOR TYPE : FACE BRICK **QUALITY GRADE :** 2 **IMPVMT. VALUE :** \$643,380
A/C : CENTRAL **FIREPLACE :** NONE

Record No.: 108 **BUILDING KEY NUMBER :** 12702703 001
PARCEL-ID : 12702703 **NEIGHBORHOOD CODE :** 12701 **ZONING CLASS :** B1
OWNER'S NAME : MEADE ALLAN S &WF FRANCES M
MAILING ADDRESS : 2415 MECKLENBURG AVE
CITY : CHARLOTTE **STATE :** NC **ZIP CODE :** 282053147

PROPERTY LOCATION : 900 PECAN AV
LEGAL DESC. : L5 & 6 B26 M230-248 **DEED BK,PG & DATE :** 04909 /409 1984-08-06
ACREAGE : 0.000 **SALE PRICE :** \$0 **QUALIFIED SALE (Y/N) :** N
LAND VALUE : \$67,690 **IMPVMTS VALUE :** \$70,480 **TOTAL VALUE :** \$138,170

LAND-USE TYPE : OFFICE **BUILDING TYPE :** OFFICE
YEAR BUILT : 1,940 **SQUARE FEET :** 2,865 **STYLE CODE :** 1.0 STORY
BEDROOMS : 0 **BATHROOMS :** 0 **RESTROOMS :** 0 **BASEMENT :** N **GARAGE :** N
EXTERIOR TYPE : MASONITE ON SHEATHING **QUALITY GRADE :** 2 **IMPVMT. VALUE :** \$69,130
A/C : CENTRAL **FIREPLACE :** NONE

NOTE: This data is prepared for the purposes of reevaluation, assessing & determining ownership of real property & is compiled from recorded deeds, plats, tax maps & other public records & data. Users of this data are hereby notified that the aforementioned public information sources should be consulted for verification. Mecklenburg County assumes no legal responsibility for the information herein.



MECKLENBURG COUNTY, NC

DATE PRINTED 2/22/02

GIS PUBLIC ACCESS SYSTEM REPORT

Note : Records are sorted in Parcel Number order.

PAGE : 37

Record No.: 109 **BUILDING KEY NUMBER:** 12702713 001
PARCEL-ID: 12702713 **NEIGHBORHOOD CODE:** 12710 **ZONING CLASS:** R5
OWNER'S NAME: TOWNS ROXIE W
MAILING ADDRESS: 1511 E 8TH ST
CITY: CHARLOTTE **STATE:** NC **ZIP CODE:** 28204

PROPERTY LOCATION: 2052 SHENANDOAH AV
LEGAL DESC.: L16 B26 M230-248 **DEED BK,PG & DATE:** 08819 /108 1996-11-14
ACREAGE: 0.000 **SALE PRICE:** \$106,500 **QUALIFIED SALE (Y/N):** Y
LAND VALUE: \$50,000 **IMPVMTS VALUE:** \$56,140 **TOTAL VALUE:** \$106,140

LAND-USE TYPE: SINGLE FAMILY **BUILDING TYPE:** DUPLEX/TRIPLEX
YEAR BUILT: 1,940 **SQUARE FEET:** 1,611 **STYLE CODE:** 1.0 STORY
BEDROOMS: 0 **BATHROOMS:** 2 **RESTROOMS:** 0 **BASEMENT:** N **GARAGE:** N
EXTERIOR TYPE: FACE BRICK **QUALITY GRADE:** 2 **IMPVMT. VALUE:** \$54,250
A/C: NONE **FIREPLACE:** NONE

Record No.: 110 **BUILDING KEY NUMBER:** 12702714 001
PARCEL-ID: 12702714 **NEIGHBORHOOD CODE:** 12710 **ZONING CLASS:** R5
OWNER'S NAME: BRANAM DONNA J
MAILING ADDRESS: 2050 SHENANDOAH AVE
CITY: CHARLOTTE **STATE:** NC **ZIP CODE:** 28205

PROPERTY LOCATION: 2050 SHENANDOAH AV
LEGAL DESC.: L15P14B26M230-248 2050 SHENAND **DEED BK,PG & DATE:** 07544 /774 1993-11-16
ACREAGE: 0.000 **SALE PRICE:** \$93,000 **QUALIFIED SALE (Y/N):** Y
LAND VALUE: \$50,000 **IMPVMTS VALUE:** \$86,740 **TOTAL VALUE:** \$136,740

LAND-USE TYPE: SINGLE FAMILY **BUILDING TYPE:** SINGLE FAMILY RESIDENTIAL
YEAR BUILT: 1,938 **SQUARE FEET:** 1,823 **STYLE CODE:** 1.5 STORIES
BEDROOMS: 3 **BATHROOMS:** 2 **RESTROOMS:** 0 **BASEMENT:** Y **GARAGE:** N
EXTERIOR TYPE: WOOD ON SHEATHING OR PLYWO **QUALITY GRADE:** 2 **IMPVMT. VALUE:** \$86,740
A/C: NONE **FIREPLACE:** 1 STY SINGLE

Record No.: 111 **BUILDING KEY NUMBER:** 12702715 001
PARCEL-ID: 12702715 **NEIGHBORHOOD CODE:** 12710 **ZONING CLASS:** R5
OWNER'S NAME: DULL ROBERT A JR &WF VIVIAN B
MAILING ADDRESS: 2042 SHENANDOAH AVE
CITY: CHARLOTTE **STATE:** NC **ZIP CODE:** 282055008

PROPERTY LOCATION: 2042 SHENANDOAH AV
LEGAL DESC.: L13 P14 B26 M230-248 **DEED BK,PG & DATE:** 08498 /535 1996-03-18
ACREAGE: 0.000 **SALE PRICE:** \$25,000 **QUALIFIED SALE (Y/N):** N
LAND VALUE: \$50,000 **IMPVMTS VALUE:** \$74,760 **TOTAL VALUE:** \$124,760

LAND-USE TYPE: SINGLE FAMILY **BUILDING TYPE:** SINGLE FAMILY RESIDENTIAL
YEAR BUILT: 1,940 **SQUARE FEET:** 1,523 **STYLE CODE:** 1.5 STORIES
BEDROOMS: 3 **BATHROOMS:** 1 **RESTROOMS:** 0 **BASEMENT:** Y **GARAGE:** N
EXTERIOR TYPE: FACE BRICK **QUALITY GRADE:** 2 **IMPVMT. VALUE:** \$74,260
A/C: NONE **FIREPLACE:** 1 STY SINGLE

NOTE: This data is prepared for the purposes of revaluation, assessing & determining ownership of real property & is compiled from recorded deeds, plats, tax maps & other public records & data. Users of this data are hereby notified that the aforementioned public information sources should be consulted for verification. Mecklenburg County assumes no legal responsibility for the information herein.



MECKLENBURG COUNTY, NC

DATE PRINTED 2/22/02

GIS PUBLIC ACCESS SYSTEM REPORT

Note : Records are sorted in Parcel Number order.

PAGE : 38

Record No.: 112 **BUILDING KEY NUMBER :** 12702716 001
PARCEL-ID : 12702716 **NEIGHBORHOOD CODE :** 12710 **ZONING CLASS :** R5
OWNER'S NAME : HENDERSON WILLIAM WALTER &WF ELIZABETH BOWLES
MAILING ADDRESS : 2038 SHENANDOAH AVE
CITY : CHARLOTTE **STATE :** NC **ZIP CODE :** 282055008

PROPERTY LOCATION : 2036 SHENANDOAH AV
LEGAL DESC. : L12B26M230 248 **DEED BK,PG & DATE :** 05926 /810 1988-12-21
ACREAGE : 0.000 **SALE PRICE :** \$0 **QUALIFIED SALE (Y/N) :** N
LAND VALUE : \$50,000 **IMPVMTS VALUE :** \$33,670 **TOTAL VALUE :** \$83,670

LAND-USE TYPE : SINGLE FAMILY **BUILDING TYPE :** SINGLE FAMILY RESIDENTIAL
YEAR BUILT : 1,944 **SQUARE FEET :** 1,428 **STYLE CODE :** 1.5 STORIES
BEDROOMS : 4 **BATHROOMS :** 2 **RESTROOMS :** 0 **BASEMENT :** Y **GARAGE :** N
EXTERIOR TYPE : FACE BRICK **QUALITY GRADE :** 2 **IMPVMT. VALUE :** \$33,670
A/C : NONE **FIREPLACE :** 1 STY SINGLE

Record No.: 113 **BUILDING KEY NUMBER :** 12702717 001
PARCEL-ID : 12702717 **NEIGHBORHOOD CODE :** 12710 **ZONING CLASS :** R5
OWNER'S NAME : HENDERSON OPHIE (B/E) & V HENDERSON (ET-AL)
MAILING ADDRESS : 7722 BRIARDALE DR
CITY : CHARLOTTE **STATE :** NC **ZIP CODE :** 28212

PROPERTY LOCATION : 2030 SHENANDOAH AV
LEGAL DESC. : L10 B26 M230-248 **DEED BK,PG & DATE :** /
ACREAGE : 0.000 **SALE PRICE :** \$0 **QUALIFIED SALE (Y/N) :**
LAND VALUE : \$35,000 **IMPVMTS VALUE :** \$0 **TOTAL VALUE :** \$35,000

LAND-USE TYPE : VACANT **BUILDING TYPE :** SINGLE FAMILY RESIDENTIAL
YEAR BUILT : 0 **SQUARE FEET :** 0 **STYLE CODE :**
BEDROOMS : 0 **BATHROOMS :** 0 **RESTROOMS :** 0 **BASEMENT :** N **GARAGE :** N
EXTERIOR TYPE : **QUALITY GRADE :** 0 **IMPVMT. VALUE :** \$0
A/C : **FIREPLACE :**

Record No.: 114 **BUILDING KEY NUMBER :** 12702718 001
PARCEL-ID : 12702718 **NEIGHBORHOOD CODE :** 12710 **ZONING CLASS :** R5
OWNER'S NAME : VERA JOHNNY E
MAILING ADDRESS : 2024 SHENANDOAH AVE
CITY : CHARLOTTE **STATE :** NC **ZIP CODE :** 28205

PROPERTY LOCATION : 2024 SHENANDOAH AV
LEGAL DESC. : L9 B26 M230-248&9 **DEED BK,PG & DATE :** 11471 /910 2000-08-01
ACREAGE : 0.000 **SALE PRICE :** \$155,000 **QUALIFIED SALE (Y/N) :** Y
LAND VALUE : \$50,000 **IMPVMTS VALUE :** \$61,220 **TOTAL VALUE :** \$111,220

LAND-USE TYPE : SINGLE FAMILY **BUILDING TYPE :** SINGLE FAMILY RESIDENTIAL
YEAR BUILT : 1,945 **SQUARE FEET :** 1,352 **STYLE CODE :** 1.0 STORY
BEDROOMS : 3 **BATHROOMS :** 1 **RESTROOMS :** 0 **BASEMENT :** N **GARAGE :** N
EXTERIOR TYPE : WOOD ON SHEATHING OR PLYWO **QUALITY GRADE :** 2 **IMPVMT. VALUE :** \$59,720
A/C : NONE **FIREPLACE :** 1 STY SINGLE

NOTE: This data is prepared for the purposes of revaluation, assessing & determining ownership of real property & is compiled from recorded deeds, plats, tax maps & other public records & data. Users of this data are hereby notified that the aforementioned public information sources should be consulted for verification. Mecklenburg County assumes no legal responsibility for the information herein.



MECKLENBURG COUNTY, NC

DATE PRINTED 2/22/02

GIS PUBLIC ACCESS SYSTEM REPORT

Note : Records are sorted in Parcel Number order.

PAGE : 39

Record No.: 115 **BUILDING KEY NUMBER :** 12702719 001
PARCEL-ID : 12702719 **NEIGHBORHOOD CODE :** 12710 **ZONING CLASS :** R5
OWNER'S NAME : MCSPADDEN MARSHA L
MAILING ADDRESS : 2020 SHENANDOAH AVE
CITY : CHARLOTTE **STATE :** NC **ZIP CODE :** 282055008

PROPERTY LOCATION : 2020 SHENANDOAH AV
LEGAL DESC. : L8 B26 M230-248 **DEED BK,PG & DATE :** 11493 /968 2000-08-11
ACREAGE : 0.000 **SALE PRICE :** \$133,500 **QUALIFIED SALE (Y/N) :** Y
LAND VALUE : \$50,000 **IMPVMTS VALUE :** \$49,590 **TOTAL VALUE :** \$99,590

LAND-USE TYPE : SINGLE FAMILY **BUILDING TYPE :** SINGLE FAMILY RESIDENTIAL
YEAR BUILT : 1,944 **SQUARE FEET :** 1,248 **STYLE CODE :** 1.0 STORY
BEDROOMS : 3 **BATHROOMS :** 1 **RESTROOMS :** 0 **BASEMENT :** N **GARAGE :** N
EXTERIOR TYPE : WOOD ON SHEATHING OR PLYWO **QUALITY GRADE :** 2 **IMPVMT. VALUE :** \$48,760
A/C : CENTRAL **FIREPLACE :** 1 STY SINGLE

Record No.: 116 **BUILDING KEY NUMBER :** 12702720 001
PARCEL-ID : 12702720 **NEIGHBORHOOD CODE :** 12710 **ZONING CLASS :** R5
OWNER'S NAME : LEONHARDT GARY ANDREW
MAILING ADDRESS : 2034 SHENANDOAH AVE
CITY : CHARLOTTE **STATE :** NC **ZIP CODE :** 282055008

PROPERTY LOCATION : 2034 SHENANDOAH AV
LEGAL DESC. : L11 B26 M230-248 **DEED BK,PG & DATE :** 11974 /570 2001-02-28
ACREAGE : 0.000 **SALE PRICE :** \$207,000 **QUALIFIED SALE (Y/N) :** Y
LAND VALUE : \$50,000 **IMPVMTS VALUE :** \$74,530 **TOTAL VALUE :** \$124,530

LAND-USE TYPE : SINGLE FAMILY **BUILDING TYPE :** SINGLE FAMILY RESIDENTIAL
YEAR BUILT : 1,944 **SQUARE FEET :** 1,519 **STYLE CODE :** 1.5 STORIES
BEDROOMS : 2 **BATHROOMS :** 2 **RESTROOMS :** 0 **BASEMENT :** N **GARAGE :** N
EXTERIOR TYPE : ALUMINUM/VINYL SIDING **QUALITY GRADE :** 2 **IMPVMT. VALUE :** \$74,200
A/C : NONE **FIREPLACE :** 1 STY SINGLE