

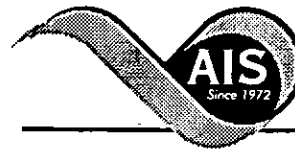

\* 0 0 B R E A K 0 0 \*



**ADVANCED  
IMAGING  
SYSTEMS**

www.aisimc.com

An Information  
Management Company

# City of Charlotte – Planning Dept. Scanning Rezoning Files

Petition # \_\_\_\_\_

## Document type:

- Applications
- Correspondence
- Department Comments
- Land Use Consistency
  - Mail Info
  - Mapping
  - Other
- Site Plans



\* 0 0 B R E A K 0 0 \*

Petition #: 2002-61

Pettitioner: Charlotte-Mecklenburg Historic Landmarks Commission

Hearing Date: June 17, 2002

Zoning Classification (Existing): B-1(CD)

Zoning Classification (Requested): R-3 (CD)

Acreage & Location Approximately 0.71 acres located on the south side of Rea Road, east of Colony Road Extension.

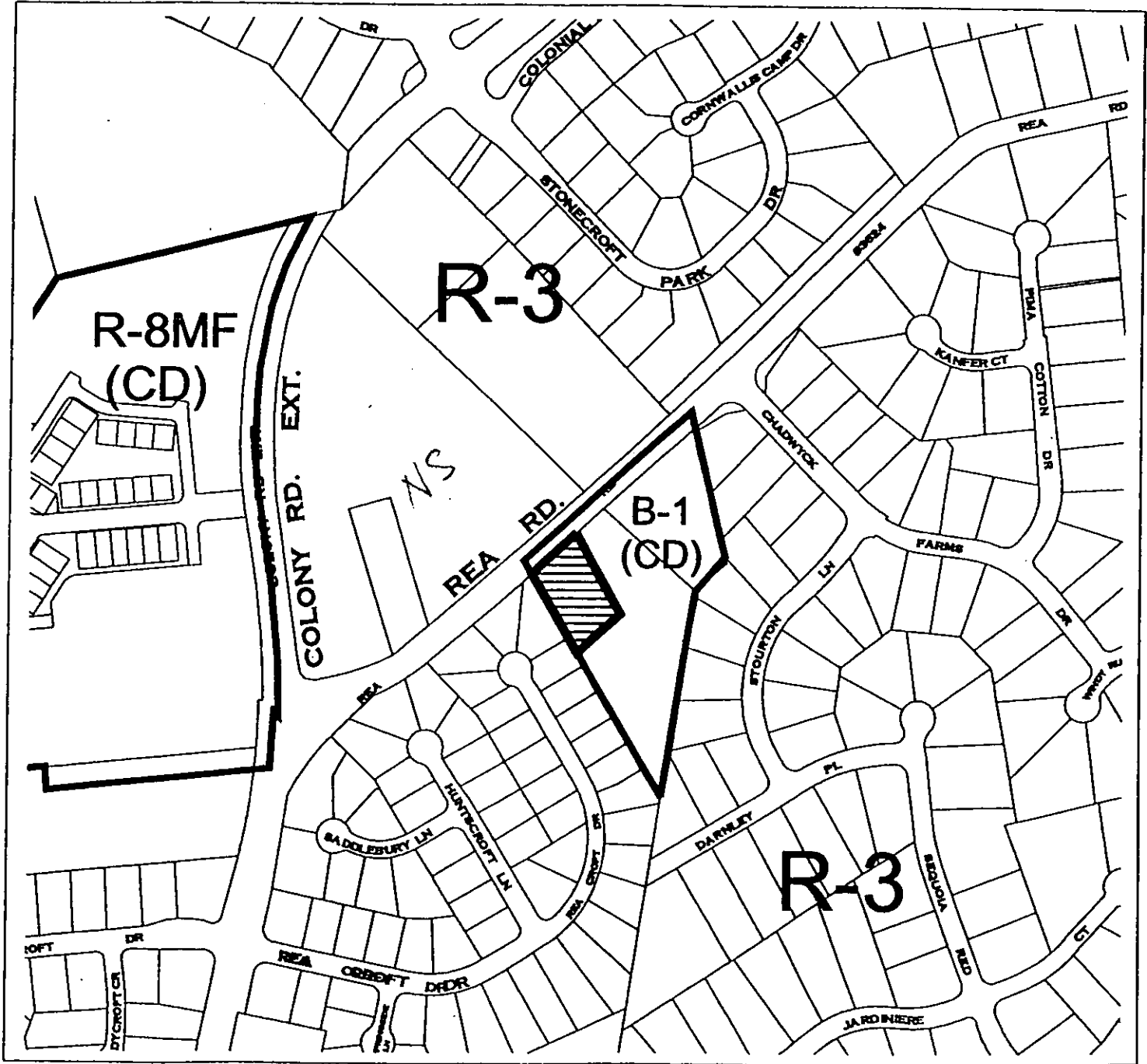

Zoning Map #(s); 159

**Map Legend**

	ED		Precedence
	Attractivity		County Line
	Wetland		City (Unincorp)
	Historic District		

OFFICIAL REZONING APPLICATION  
CITY OF CHARLOTTE

Amended 05-13-02 (proposed zoning)

Petition #: 2002-61  
Date Filed: 3/22/02  
Received By: [Signature]

OWNERSHIP INFORMATION:

Property Owner: See attached sheets J.R. Clute, M.R. Kiser, T.H. Rea  
Owner's Address: Rockhill City, State, Zip: SC 29732-9353  
Date Property Acquired: 1987 Utilities Provided; (Water) CMUD (Sewer) CMUD  
(CMUD, Private, Other) (CMUD, Private, Other)

LOCATION OF PROPERTY (Address or Description): 4245 Rea Rd.

Tax Parcel Number(s): Portion of 211-593-15 Size (Sq.Ft. or Acres): Approx. 0.71 Acres

Current Land Use: Vacant portion of Nursery site.

ZONING REQUEST:

Existing Zoning: B-1 (CD) Proposed Zoning: R-3 (CD) <sup>WF</sup>

Purpose of Zoning Change: *(Include the maximum # of residential units or non-residential square footages):*

To develop for single-family use.

Walter G. Fields, III  
Name of Agent  
831 E. Morehead St., Suite 655  
Agent's Address  
Charlotte, NC 28202  
City, State, Zip  
704-372-7855 704-372-7856  
Telephone Number Fax Number  
walter@walterfieldsgroup.com  
E-Mail Address

Charlotte-Mecklenburg Historic Landmarks Commission  
Name of Petitioner(s)  
2100 Randolph Rd.  
Address of Petitioner(s)  
Charlotte, NC 28207  
City, State, Zip  
704-376-9115 704-372-4584  
Telephone Number Fax Number  
dmorrill@cmhpf.org  
E-Mail Address

Signature of Property Owner if other than Petitioner

Signature [Signature]

# MECKLENBURG COUNTY, NC GIS PUBLIC ACCESS SYSTEM

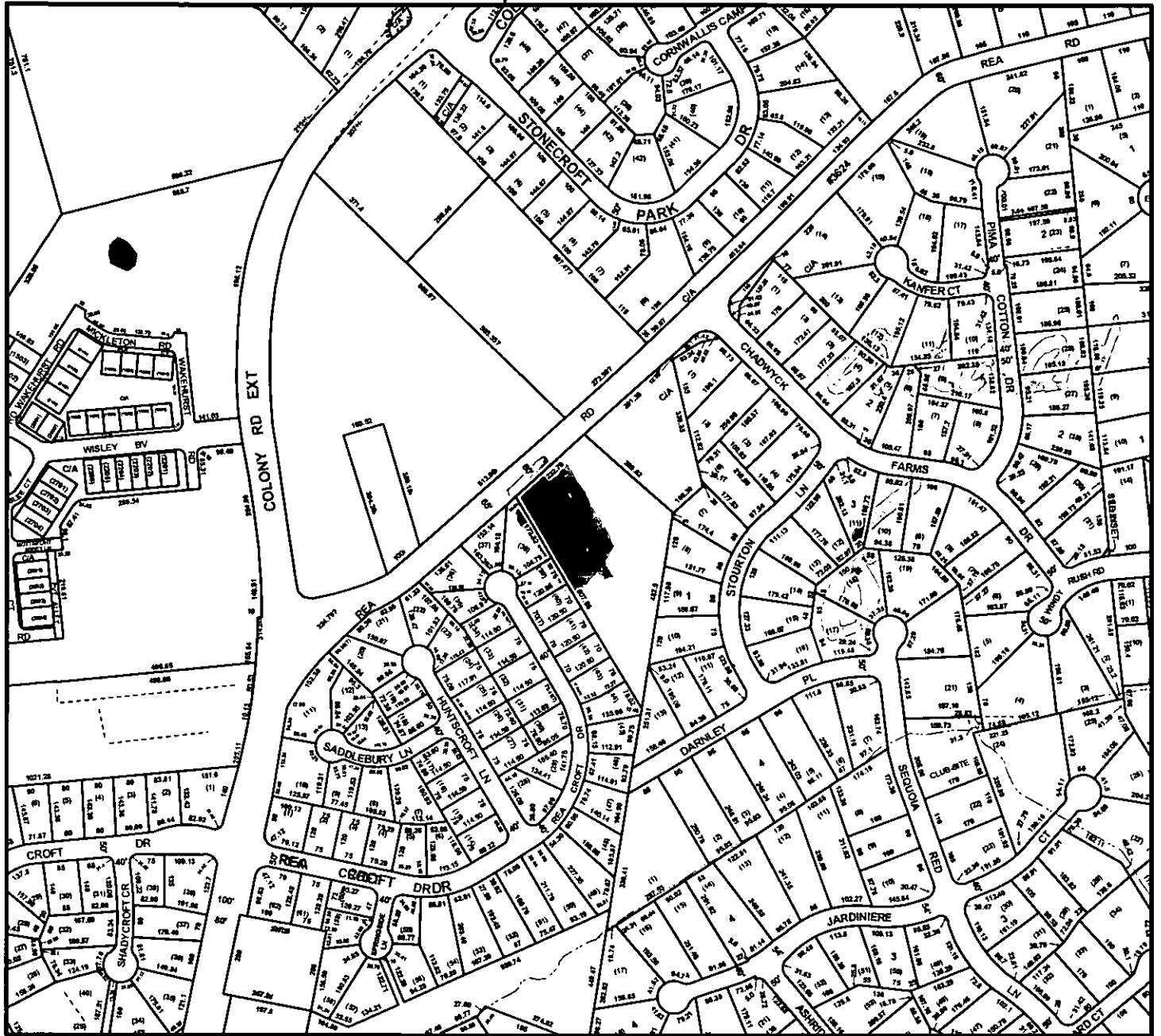

Tax Parcel-Id#s Selected: See Tax Information Report for List of Parcel-Id#s

Tax Book & Page Selected: N/A

**LEGEND**

- County Boundary
- Rivers/Creeks/Streams
- Railroad ROW
- Water Bodies



02-01

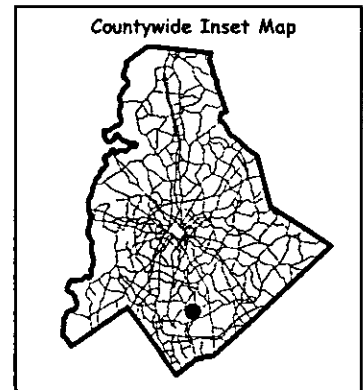

Scale : 1 Inch = 400 Feet  
 Map Created on Monday, April 1, 2002 12:15 PM

This map is prepared for the inventory of real property within Mecklenburg County and is compiled from recorded deeds, plats, tax maps, surveys, planimetric maps, and other public records and data. Users of this map are hereby notified that the aforementioned public primary information sources should be consulted for verification. Mecklenburg County and its mapping contractors assume no legal responsibility for the information contained herein.



# MECKLENBURG COUNTY, NC

DATE PRINTED 4/1/02

## GIS PUBLIC ACCESS SYSTEM REPORT

Note : Records are sorted in Parcel Number order.

PAGE : 1

**Record No.:** 1      **BUILDING KEY NUMBER :** 21124105 001  
**PARCEL-ID :** 21124105      **NEIGHBORHOOD CODE :** 21101      **ZONING CLASS :** R3  
**OWNER'S NAME :** REA T LEON  
**MAILING ADDRESS :** 4683 CHANNING PKWY  
**CITY :** ROCK HILL      **STATE :** SC      **ZIP CODE :** 29732

**PROPERTY LOCATION :** 4334      REA      RC  
**LEGAL DESC. :** PM332-97      **DEED BK,PG & DATE :** 02840 /477 1975-01-01  
**ACREAGE :** 10.000      **SALE PRICE :** \$0      **QUALIFIED SALE (Y/N) :** N  
**LAND VALUE :** \$288,400      **IMPVMTS VALUE :** \$48,030      **TOTAL VALUE :** \$336,430

**LAND-USE TYPE :** SINGLE FAMILY      **BUILDING TYPE :** SINGLE FAMILY RESIDENTIAL  
**YEAR BUILT :** 1,900      **SQUARE FEET :** 3,020      **STYLE CODE :** 2.0 STORIES  
**BEDROOMS :** 5      **BATHROOMS :** 1      **RESTROOMS :** 0      **BASEMENT :** N      **GARAGE :** N  
**EXTERIOR TYPE :** WOOD ON SHEATHING OR PLYWO      **QUALITY GRADE :** 1      **IMPVMT. VALUE :** \$39,540  
**A/C :** NONE      **FIREPLACE :** NONE

**Record No.:** 2      **BUILDING KEY NUMBER :** 21124105 002  
**PARCEL-ID :** 21124105      **NEIGHBORHOOD CODE :** 21101      **ZONING CLASS :** R3  
**OWNER'S NAME :** REA T LEON  
**MAILING ADDRESS :** 4683 CHANNING PKWY  
**CITY :** ROCK HILL      **STATE :** SC      **ZIP CODE :** 29732

**PROPERTY LOCATION :**      REA RD  
**LEGAL DESC. :** PM332-97      **DEED BK,PG & DATE :** 02840 /477 1975-01-01  
**ACREAGE :** 10.000      **SALE PRICE :** \$0      **QUALIFIED SALE (Y/N) :** N  
**LAND VALUE :** \$288,400      **IMPVMTS VALUE :** \$48,030      **TOTAL VALUE :** \$336,430

**LAND-USE TYPE :** VACANT      **BUILDING TYPE :** SINGLE FAMILY RESIDENTIAL  
**YEAR BUILT :** 0      **SQUARE FEET :** 0      **STYLE CODE :**  
**BEDROOMS :** 0      **BATHROOMS :** 0      **RESTROOMS :** 0      **BASEMENT :** N      **GARAGE :** N  
**EXTERIOR TYPE :**      **QUALITY GRADE :** 0      **IMPVMT. VALUE :** \$0  
**A/C :**      **FIREPLACE :**

**Record No.:** 3      **BUILDING KEY NUMBER :** 21124106 001  
**PARCEL-ID :** 21124106      **NEIGHBORHOOD CODE :** 21101      **ZONING CLASS :** R3  
**OWNER'S NAME :** JACOBS ROBERT A  
**MAILING ADDRESS :** 4240 REA RD  
**CITY :** CHARLOTTE      **STATE :** NC      **ZIP CODE :** 28226

**PROPERTY LOCATION :** 4240      REA      RC  
**LEGAL DESC. :** NA      **DEED BK,PG & DATE :** 08211 /679 1995-07-12  
**ACREAGE :** 4.000      **SALE PRICE :** \$0      **QUALIFIED SALE (Y/N) :** N  
**LAND VALUE :** \$155,000      **IMPVMTS VALUE :** \$135,800      **TOTAL VALUE :** \$290,800

**LAND-USE TYPE :** SINGLE FAMILY      **BUILDING TYPE :** SINGLE FAMILY RESIDENTIAL  
**YEAR BUILT :** 1,973      **SQUARE FEET :** 2,050      **STYLE CODE :** 2.0 STORIES  
**BEDROOMS :** 4      **BATHROOMS :** 2      **RESTROOMS :** 0      **BASEMENT :** N      **GARAGE :** N  
**EXTERIOR TYPE :** MASONITE ON SHEATHING      **QUALITY GRADE :** 3      **IMPVMT. VALUE :** \$135,380  
**A/C :** CENTRAL      **FIREPLACE :** 2 STY SINGLE/1 DBL



# MECKLENBURG COUNTY, NC

DATE PRINTED 4/1/02

## GIS PUBLIC ACCESS SYSTEM REPORT

Note : Records are sorted in Parcel Number order.

PAGE : 2

**Record No.:** 4      **BUILDING KEY NUMBER :** 21124119 001  
**PARCEL-ID :** 21124119      **NEIGHBORHOOD CODE :** 21101      **ZONING CLASS :** R3  
**OWNER'S NAME :** REA T LEON      (BY ENTIRETY)  
**MAILING ADDRESS :** 4683 CHANNING PKWY  
**CITY :** ROCK HILL      **STATE :** SC      **ZIP CODE :** 29732

**PROPERTY LOCATION :** 4330 REA RC  
**LEGAL DESC. :** NA      **DEED BK,PG & DATE :** 05627 /117 1987-10-15  
**ACREAGE :** 1.000      **SALE PRICE :** \$0      **QUALIFIED SALE (Y/N) :** N  
**LAND VALUE :** \$35,000      **IMPVMTS VALUE :** \$79,910      **TOTAL VALUE :** \$114,910

**LAND-USE TYPE :** SINGLE FAMILY      **BUILDING TYPE :** SINGLE FAMILY RESIDENTIAL  
**YEAR BUILT :** 1,988      **SQUARE FEET :** 1,537      **STYLE CODE :** 1.0 STORY  
**BEDROOMS :** 3      **BATHROOMS :** 2      **RESTROOMS :** 0      **BASEMENT :** N      **GARAGE :** N  
**EXTERIOR TYPE :** FACE BRICK      **QUALITY GRADE :** 2      **IMPVMT. VALUE :** \$76,950  
**A/C :** CENTRAL      **FIREPLACE :** NONE

**Record No.:** 5      **BUILDING KEY NUMBER :** 21124347  
**PARCEL-ID :** 21124347      **NEIGHBORHOOD CODE :** 21101      **ZONING CLASS :** R3  
**OWNER'S NAME :** COLONY ROAD PARTNERS LLC  
**MAILING ADDRESS :** 10100 PARK CEDAR DR #178  
**CITY :** CHARLOTTE      **STATE :** NC      **ZIP CODE :** 28210

**PROPERTY LOCATION :**  
**LEGAL DESC. :** L8 M34-855      **DEED BK,PG & DATE :** 11021 /964 2000-01-10  
**ACREAGE :** 1.000      **SALE PRICE :** \$0      **QUALIFIED SALE (Y/N) :** Y  
**LAND VALUE :** \$0      **IMPVMTS VALUE :** \$0      **TOTAL VALUE :** \$0

**LAND-USE TYPE :**      **BUILDING TYPE :**  
**YEAR BUILT :** 0      **SQUARE FEET :** 0      **STYLE CODE :**  
**BEDROOMS :** 0      **BATHROOMS :** 0      **RESTROOMS :** 0      **BASEMENT :**      **GARAGE :**  
**EXTERIOR TYPE :**      **QUALITY GRADE :** 0      **IMPVMT. VALUE :** \$0  
**A/C :**      **FIREPLACE :**

**Record No.:** 6      **BUILDING KEY NUMBER :** 21124348  
**PARCEL-ID :** 21124348      **NEIGHBORHOOD CODE :** 21101      **ZONING CLASS :** R3  
**OWNER'S NAME :** SIMONINI BUILDERS INC  
**MAILING ADDRESS :** 817 E MOREHEAD ST #100  
**CITY :** CHARLOTTE      **STATE :** NC      **ZIP CODE :** 28202

**PROPERTY LOCATION :**  
**LEGAL DESC. :** L7 M34-855      **DEED BK,PG & DATE :** 12651 /190 2001-09-12  
**ACREAGE :** 0.000      **SALE PRICE :** \$0      **QUALIFIED SALE (Y/N) :** Y  
**LAND VALUE :** \$0      **IMPVMTS VALUE :** \$0      **TOTAL VALUE :** \$0

**LAND-USE TYPE :**      **BUILDING TYPE :**  
**YEAR BUILT :** 0      **SQUARE FEET :** 0      **STYLE CODE :**  
**BEDROOMS :** 0      **BATHROOMS :** 0      **RESTROOMS :** 0      **BASEMENT :**      **GARAGE :**  
**EXTERIOR TYPE :**      **QUALITY GRADE :** 0      **IMPVMT. VALUE :** \$0  
**A/C :**      **FIREPLACE :**

NOTE: This data is prepared for the purposes of revaluation, assessing & determining ownership of real property & is compiled from recorded deeds, plats, tax maps & other public records & data. Users of this data are hereby notified that the aforementioned public information sources should be consulted for verification. Mecklenburg County assumes no legal responsibility for the information herein.



# MECKLENBURG COUNTY, NC

DATE PRINTED 4/1/02

## GIS PUBLIC ACCESS SYSTEM REPORT

Note : Records are sorted in Parcel Number order.

PAGE : 3

**Record No.:** 7      **BUILDING KEY NUMBER :** 21124349  
**PARCEL-ID :** 21124349      **NEIGHBORHOOD CODE :** 21101      **ZONING CLASS :** R3  
**OWNER'S NAME :** COLONY ROAD PARTNERS LLC  
**MAILING ADDRESS :** 10100 PARK CEDAR DR #178  
**CITY :** CHARLOTTE      **STATE :** NC      **ZIP CODE :** 28210

**PROPERTY LOCATION :**  
**LEGAL DESC. :** L6 M34-855      **DEED BK,PG & DATE :** 11021 /964 2000-01-10  
**ACREAGE :** 0.000      **SALE PRICE :** \$0      **QUALIFIED SALE (Y/N) :** Y  
**LAND VALUE :** \$0      **IMPVMTS VALUE :** \$0      **TOTAL VALUE :** \$0

**LAND-USE TYPE :**      **BUILDING TYPE :**  
**YEAR BUILT :** 0      **SQUARE FEET :** 0      **STYLE CODE :**  
**BEDROOMS :** 0      **BATHROOMS :** 0      **RESTROOMS :** 0      **BASEMENT :**      **GARAGE :**  
**EXTERIOR TYPE :**      **QUALITY GRADE :** 0      **IMPVMT. VALUE :** \$0  
**A/C :**      **FIREPLACE :**

**Record No.:** 8      **BUILDING KEY NUMBER :** 21124350  
**PARCEL-ID :** 21124350      **NEIGHBORHOOD CODE :** 21101      **ZONING CLASS :** R3  
**OWNER'S NAME :** ARCADIA HOMES INC  
**MAILING ADDRESS :** PO BOX 471941  
**CITY :** CHARLOTTE      **STATE :** NC      **ZIP CODE :** 28247

**PROPERTY LOCATION :**  
**LEGAL DESC. :** L5 M34-855      **DEED BK,PG & DATE :** 12593 /833 2001-08-27  
**ACREAGE :** 0.000      **SALE PRICE :** \$0      **QUALIFIED SALE (Y/N) :** Y  
**LAND VALUE :** \$0      **IMPVMTS VALUE :** \$0      **TOTAL VALUE :** \$0

**LAND-USE TYPE :**      **BUILDING TYPE :**  
**YEAR BUILT :** 0      **SQUARE FEET :** 0      **STYLE CODE :**  
**BEDROOMS :** 0      **BATHROOMS :** 0      **RESTROOMS :** 0      **BASEMENT :**      **GARAGE :**  
**EXTERIOR TYPE :**      **QUALITY GRADE :** 0      **IMPVMT. VALUE :** \$0  
**A/C :**      **FIREPLACE :**

**Record No.:** 9      **BUILDING KEY NUMBER :** 21124356  
**PARCEL-ID :** 21124356      **NEIGHBORHOOD CODE :** 21101      **ZONING CLASS :** R3  
**OWNER'S NAME :** COLONY ROAD PARTNERS LLC  
**MAILING ADDRESS :** 10100 PARK CEDAR DR #178  
**CITY :** CHARLOTTE      **STATE :** NC      **ZIP CODE :** 28210

**PROPERTY LOCATION :**  
**LEGAL DESC. :** C/A M34-855      **DEED BK,PG & DATE :** 11021 /964 2000-01-10  
**ACREAGE :** 1.000      **SALE PRICE :** \$0      **QUALIFIED SALE (Y/N) :** Y  
**LAND VALUE :** \$0      **IMPVMTS VALUE :** \$0      **TOTAL VALUE :** \$0

**LAND-USE TYPE :**      **BUILDING TYPE :**  
**YEAR BUILT :** 0      **SQUARE FEET :** 0      **STYLE CODE :**  
**BEDROOMS :** 0      **BATHROOMS :** 0      **RESTROOMS :** 0      **BASEMENT :**      **GARAGE :**  
**EXTERIOR TYPE :**      **QUALITY GRADE :** 0      **IMPVMT. VALUE :** \$0  
**A/C :**      **FIREPLACE :**

NOTE: This data is prepared for the purposes of revaluation, assessing & determining ownership of real property & is compiled from recorded deeds, plats, tax maps & other public records & data. Users of this data are hereby notified that the aforementioned public information sources should be consulted for verification. Mecklenburg County assumes no legal responsibility for the information herein.



# MECKLENBURG COUNTY, NC

DATE PRINTED 4/1/02

## GIS PUBLIC ACCESS SYSTEM REPORT

Note : Records are sorted in Parcel Number order.

PAGE : 4

**Record No.:** 10      **BUILDING KEY NUMBER :** 21159211 001  
**PARCEL-ID :** 21159211      **NEIGHBORHOOD CODE :** 21129      **ZONING CLASS :** R3  
**OWNER'S NAME :** OTSTOTT MURRAY M III      M JOSEPHINE OTSTOTT (H/W)  
**MAILING ADDRESS :** 4201 STOURTON LN  
**CITY :** CHARLOTTE      **STATE :** NC      **ZIP CODE :** 28226

**PROPERTY LOCATION :** 4201      STOURTON      LN  
**LEGAL DESC. :** L11 B3 M24-95      **DEED BK,PG & DATE :** 11459 /965 2000-07-28  
**ACREAGE :** 0.000      **SALE PRICE :** \$326,500      **QUALIFIED SALE (Y/N) :** Y  
**LAND VALUE :** \$50,000      **IMPVMTS VALUE :** \$247,870      **TOTAL VALUE :** \$297,870

**LAND-USE TYPE :** SINGLE FAMILY      **BUILDING TYPE :** SINGLE FAMILY RESIDENTIAL  
**YEAR BUILT :** 1,991      **SQUARE FEET :** 3,344      **STYLE CODE :** 1.5 STORIES  
**BEDROOMS :** 4      **BATHROOMS :** 3      **RESTROOMS :** 0      **BASEMENT :** N      **GARAGE :** Y  
**EXTERIOR TYPE :** FACE BRICK      **QUALITY GRADE :** 3      **IMPVMT. VALUE :** \$247,870  
**A/C :** CENTRAL      **FIREPLACE :** 1 STY SINGLE

**Record No.:** 11      **BUILDING KEY NUMBER :** 21159212 001  
**PARCEL-ID :** 21159212      **NEIGHBORHOOD CODE :** 21129      **ZONING CLASS :** R3  
**OWNER'S NAME :** BROWN EDGAR D      &WF PAMELA C  
**MAILING ADDRESS :** 4209 STOURTON LN  
**CITY :** CHARLOTTE      **STATE :** NC      **ZIP CODE :** 28226

**PROPERTY LOCATION :** 4209      STOURTON      LN  
**LEGAL DESC. :** L12 B3 M24-95      **DEED BK,PG & DATE :** 08243 /057 1995-08-07  
**ACREAGE :** 0.000      **SALE PRICE :** \$306,000      **QUALIFIED SALE (Y/N) :** N  
**LAND VALUE :** \$50,000      **IMPVMTS VALUE :** \$249,390      **TOTAL VALUE :** \$299,390

**LAND-USE TYPE :** SINGLE FAMILY      **BUILDING TYPE :** SINGLE FAMILY RESIDENTIAL  
**YEAR BUILT :** 1,995      **SQUARE FEET :** 3,500      **STYLE CODE :** 2.0 STORIES  
**BEDROOMS :** 4      **BATHROOMS :** 2      **RESTROOMS :** 0      **BASEMENT :** N      **GARAGE :** Y  
**EXTERIOR TYPE :** STUCCO ON TILE OR WOOD FRAM      **QUALITY GRADE :** 3      **IMPVMT. VALUE :** \$247,300  
**A/C :** CENTRAL      **FIREPLACE :** 2 STY SINGLE/1 DBL

**Record No.:** 12      **BUILDING KEY NUMBER :** 21159213 001  
**PARCEL-ID :** 21159213      **NEIGHBORHOOD CODE :** 21129      **ZONING CLASS :** R3  
**OWNER'S NAME :** BRANCH NORMA CROWLEY  
**MAILING ADDRESS :** 4217 STOURTON LN  
**CITY :** CHARLOTTE      **STATE :** NC      **ZIP CODE :** 282262611

**PROPERTY LOCATION :** 4217      STOURTON      LN  
**LEGAL DESC. :** L13B3M23-910 4217 STOURTON LN      **DEED BK,PG & DATE :** 06578 /874 1991-07-09  
**ACREAGE :** 0.000      **SALE PRICE :** \$209,000      **QUALIFIED SALE (Y/N) :** Y  
**LAND VALUE :** \$50,000      **IMPVMTS VALUE :** \$227,900      **TOTAL VALUE :** \$277,900

**LAND-USE TYPE :** SINGLE FAMILY      **BUILDING TYPE :** SINGLE FAMILY RESIDENTIAL  
**YEAR BUILT :** 1,991      **SQUARE FEET :** 3,016      **STYLE CODE :** 1.0 STORY  
**BEDROOMS :** 4      **BATHROOMS :** 2      **RESTROOMS :** 0      **BASEMENT :** N      **GARAGE :** Y  
**EXTERIOR TYPE :** FACE BRICK      **QUALITY GRADE :** 3      **IMPVMT. VALUE :** \$225,130  
**A/C :** CENTRAL      **FIREPLACE :** 1 STY SINGLE

NOTE: This data is prepared for the purposes of revaluation, assessing & determining ownership of real property & is compiled from recorded deeds, plats, tax maps & other public records & data. Users of this data are hereby notified that the aforementioned public information sources should be consulted for verification. Mecklenburg County assumes no legal responsibility for the information herein.





**MECKLENBURG COUNTY, NC**  
**GIS PUBLIC ACCESS SYSTEM REPORT**

DATE PRINTED 4/1/02

Note : Records are sorted in Parcel Number order.

PAGE : 5

**Record No.:** 13      **BUILDING KEY NUMBER :** 21159214 001  
**PARCEL-ID :** 21159214      **NEIGHBORHOOD CODE :** 21129      **ZONING CLASS :** R3  
**OWNER'S NAME :** ABELN ROBERT RICHARD      &WF SARA ANN  
**MAILING ADDRESS :** 4301 STOURTON LN  
**CITY :** CHARLOTTE      **STATE :** NC      **ZIP CODE :** 28226

**PROPERTY LOCATION :** 4301      STOURTON      LN  
**LEGAL DESC. :** L14 B3 M24-95      **DEED BK,PG & DATE :** 06852 /588 1992-04-22  
**ACREAGE :** 0.000      **SALE PRICE :** \$193,500      **QUALIFIED SALE (Y/N) :** Y  
**LAND VALUE :** \$50,000      **IMPVMTS VALUE :** \$214,330      **TOTAL VALUE :** \$264,330

**LAND-USE TYPE :** SINGLE FAMILY      **BUILDING TYPE :** SINGLE FAMILY RESIDENTIAL  
**YEAR BUILT :** 1,991      **SQUARE FEET :** 3,062      **STYLE CODE :** 2.0 STORIES  
**BEDROOMS :** 4      **BATHROOMS :** 2      **RESTROOMS :** 0      **BASEMENT :** N      **GARAGE :** Y  
**EXTERIOR TYPE :** FACE BRICK      **QUALITY GRADE :** 3      **IMPVMT. VALUE :** \$214,330  
**A/C :** CENTRAL      **FIREPLACE :** 2 STY SINGLE/1 DBL

**Record No.:** 14      **BUILDING KEY NUMBER :** 21159215 001  
**PARCEL-ID :** 21159215      **NEIGHBORHOOD CODE :** 21129      **ZONING CLASS :** R3  
**OWNER'S NAME :** KOSKORES WILLIAM T      &WF KAREN S  
**MAILING ADDRESS :** 4311 STOURTON LN  
**CITY :** CHARLOTTE      **STATE :** NC      **ZIP CODE :** 28226

**PROPERTY LOCATION :** 4311      STOURTON      LN  
**LEGAL DESC. :** L15 B3 M24-95      **DEED BK,PG & DATE :** 08227 /620 1995-07-27  
**ACREAGE :** 0.000      **SALE PRICE :** \$314,000      **QUALIFIED SALE (Y/N) :** Y  
**LAND VALUE :** \$50,000      **IMPVMTS VALUE :** \$274,360      **TOTAL VALUE :** \$324,360

**LAND-USE TYPE :** SINGLE FAMILY      **BUILDING TYPE :** SINGLE FAMILY RESIDENTIAL  
**YEAR BUILT :** 1,992      **SQUARE FEET :** 4,136      **STYLE CODE :** 2.0 STORIES  
**BEDROOMS :** 5      **BATHROOMS :** 4      **RESTROOMS :** 0      **BASEMENT :** N      **GARAGE :** Y  
**EXTERIOR TYPE :** FACE BRICK      **QUALITY GRADE :** 3      **IMPVMT. VALUE :** \$272,880  
**A/C :** CENTRAL      **FIREPLACE :** 2 STY SINGLE/1 DBL

**Record No.:** 15      **BUILDING KEY NUMBER :** 21159216 001  
**PARCEL-ID :** 21159216      **NEIGHBORHOOD CODE :** 21129      **ZONING CLASS :** R3  
**OWNER'S NAME :** SATTERFIELD JAMISON J      & WF SHARON C  
**MAILING ADDRESS :** 4317 STOURTON LN  
**CITY :** CHARLOTTE      **STATE :** NC      **ZIP CODE :** 282262610

**PROPERTY LOCATION :** 4317      STOURTON      LN  
**LEGAL DESC. :** L16B3M24-95 4317 STOURTON LN      **DEED BK,PG & DATE :** 06853 /041 1992-04-22  
**ACREAGE :** 0.000      **SALE PRICE :** \$219,060      **QUALIFIED SALE (Y/N) :** Y  
**LAND VALUE :** \$50,000      **IMPVMTS VALUE :** \$213,800      **TOTAL VALUE :** \$263,800

**LAND-USE TYPE :** SINGLE FAMILY      **BUILDING TYPE :** SINGLE FAMILY RESIDENTIAL  
**YEAR BUILT :** 1,991      **SQUARE FEET :** 3,196      **STYLE CODE :** 2.0 STORIES  
**BEDROOMS :** 4      **BATHROOMS :** 2      **RESTROOMS :** 0      **BASEMENT :** N      **GARAGE :** Y  
**EXTERIOR TYPE :** FACE BRICK      **QUALITY GRADE :** 3      **IMPVMT. VALUE :** \$212,130  
**A/C :** CENTRAL      **FIREPLACE :** 2 STY SINGLE/1 DBL

NOTE: This data is prepared for the purposes of revaluation, assessing & determining ownership of real property & is compiled from recorded deeds, plats, tax maps & other public records & data. Users of this data are hereby notified that the aforementioned public information sources should be consulted for verification. Mecklenburg County assumes no legal responsibility for the information herein.



# MECKLENBURG COUNTY, NC

DATE PRINTED 4/1/02

## GIS PUBLIC ACCESS SYSTEM REPORT

Note : Records are sorted in Parcel Number order.

PAGE : 6

**Record No.:** 16      **BUILDING KEY NUMBER :** 21159301 001  
**PARCEL-ID :** 21159301      **NEIGHBORHOOD CODE :** 21129      **ZONING CLASS :** R3  
**OWNER'S NAME :** DHAMANKAR SUNIL Y      &WF JAYA  
**MAILING ADDRESS :** 7006 DARNLEY PL  
**CITY :** CHARLOTTE      **STATE :** NC      **ZIP CODE :** 28226

**PROPERTY LOCATION :** 7006      DARNLEY      PL  
**LEGAL DESC. :** L13 B1 M24-95      **DEED BK,PG & DATE :** 09460 /884 1998-01-23  
**ACREAGE :** 0.000      **SALE PRICE :** \$0      **QUALIFIED SALE (Y/N) :** N  
**LAND VALUE :** \$25,000      **IMPVMTS VALUE :** \$0      **TOTAL VALUE :** \$25,000

**LAND-USE TYPE :** VACANT      **BUILDING TYPE :** SINGLE FAMILY RESIDENTIAL  
**YEAR BUILT :** 0      **SQUARE FEET :** 0      **STYLE CODE :**  
**BEDROOMS :** 0      **BATHROOMS :** 0      **RESTROOMS :** 0      **BASEMENT :** N      **GARAGE :** N  
**EXTERIOR TYPE :**      **QUALITY GRADE :** 0      **IMPVMT. VALUE :** \$0  
**A/C :**      **FIREPLACE :**

**Record No.:** 17      **BUILDING KEY NUMBER :** 21159302 001  
**PARCEL-ID :** 21159302      **NEIGHBORHOOD CODE :** 21129      **ZONING CLASS :** R3  
**OWNER'S NAME :** DHAMANKAR SUNIL Y      &WF JAYA  
**MAILING ADDRESS :** 7006 DARNLEY PL  
**CITY :** CHARLOTTE      **STATE :** NC      **ZIP CODE :** 28226

**PROPERTY LOCATION :** 7006      DARNLEY      PL  
**LEGAL DESC. :** L12 B1 M24-95      **DEED BK,PG & DATE :** 09460 /884 1998-01-23  
**ACREAGE :** 0.000      **SALE PRICE :** \$295,000      **QUALIFIED SALE (Y/N) :** Y  
**LAND VALUE :** \$50,000      **IMPVMTS VALUE :** \$233,830      **TOTAL VALUE :** \$283,830

**LAND-USE TYPE :** SINGLE FAMILY      **BUILDING TYPE :** SINGLE FAMILY RESIDENTIAL  
**YEAR BUILT :** 1,993      **SQUARE FEET :** 3,371      **STYLE CODE :** 2.0 STORIES  
**BEDROOMS :** 4      **BATHROOMS :** 3      **RESTROOMS :** 0      **BASEMENT :** N      **GARAGE :** Y  
**EXTERIOR TYPE :** FACE BRICK      **QUALITY GRADE :** 3      **IMPVMT. VALUE :** \$232,270  
**A/C :** CENTRAL      **FIREPLACE :** 1 STY SINGLE

**Record No.:** 18      **BUILDING KEY NUMBER :** 21159303 001  
**PARCEL-ID :** 21159303      **NEIGHBORHOOD CODE :** 21129      **ZONING CLASS :** R3  
**OWNER'S NAME :** KITTERMAN KURTIS R      LISA B KITTERMAN (H/W)  
**MAILING ADDRESS :** 7016 DARNLEY PL  
**CITY :** CHARLOTTE      **STATE :** NC      **ZIP CODE :** 28226

**PROPERTY LOCATION :** 7016      DARNLEY      PL  
**LEGAL DESC. :** L11 B1 M24-95      **DEED BK,PG & DATE :** 12846 /678 2001-11-02  
**ACREAGE :** 0.000      **SALE PRICE :** \$312,500      **QUALIFIED SALE (Y/N) :** Y  
**LAND VALUE :** \$50,000      **IMPVMTS VALUE :** \$204,770      **TOTAL VALUE :** \$254,770

**LAND-USE TYPE :** SINGLE FAMILY      **BUILDING TYPE :** SINGLE FAMILY RESIDENTIAL  
**YEAR BUILT :** 1,992      **SQUARE FEET :** 2,952      **STYLE CODE :** 2.0 STORIES  
**BEDROOMS :** 4      **BATHROOMS :** 2      **RESTROOMS :** 0      **BASEMENT :** N      **GARAGE :** Y  
**EXTERIOR TYPE :** FACE BRICK      **QUALITY GRADE :** 3      **IMPVMT. VALUE :** \$202,900  
**A/C :** CENTRAL      **FIREPLACE :** 2 STY SINGLE/1 DBL

NOTE: This data is prepared for the purposes of revaluation, assessing & determining ownership of real property & is compiled from recorded deeds, plats, tax maps & other public records & data. Users of this data are hereby notified that the aforementioned public information sources should be consulted for verification. Mecklenburg County assumes no legal responsibility for the information herein.



**MECKLENBURG COUNTY, NC**  
**GIS PUBLIC ACCESS SYSTEM REPORT**

DATE PRINTED 4/1/02

Note : Records are sorted in Parcel Number order.

PAGE : 7

**Record No.:** 19      **BUILDING KEY NUMBER :** 21159304 001  
**PARCEL-ID :** 21159304      **NEIGHBORHOOD CODE :** 21129      **ZONING CLASS :** R3  
**OWNER'S NAME :** HALTER PAUL V H III      & WF TONI C  
**MAILING ADDRESS :** 4312 STOURTON LN  
**CITY :** CHARLOTTE      **STATE :** NC      **ZIP CODE :** 28226

**PROPERTY LOCATION :** 4312      STOURTON      LN  
**LEGAL DESC. :** L10B1M24-95 4312 STOURTON LN      **DEED BK,PG & DATE :** 06898 /178 1992-06-02  
**ACREAGE :** 0.000      **SALE PRICE :** \$205,700      **QUALIFIED SALE (Y/N) :** Y  
**LAND VALUE :** \$50,000      **IMPVMTS VALUE :** \$191,570      **TOTAL VALUE :** \$241,570

**LAND-USE TYPE :** SINGLE FAMILY      **BUILDING TYPE :** SINGLE FAMILY RESIDENTIAL  
**YEAR BUILT :** 1,991      **SQUARE FEET :** 2,610      **STYLE CODE :** 1.5 STORIES  
**BEDROOMS :** 4      **BATHROOMS :** 2      **RESTROOMS :** 0      **BASEMENT :** N      **GARAGE :** Y  
**EXTERIOR TYPE :** FACE BRICK      **QUALITY GRADE :** 3      **IMPVMT. VALUE :** \$189,770  
**A/C :** CENTRAL      **FIREPLACE :** 1 STY SINGLE

**Record No.:** 20      **BUILDING KEY NUMBER :** 21159305 001  
**PARCEL-ID :** 21159305      **NEIGHBORHOOD CODE :** 21129      **ZONING CLASS :** R3  
**OWNER'S NAME :** NELSON PETER L      &WF PAIGE K  
**MAILING ADDRESS :** 4306 STOURTON LN  
**CITY :** CHARLOTTE      **STATE :** NC      **ZIP CODE :** 28226

**PROPERTY LOCATION :** 4306      STOURTON      LN  
**LEGAL DESC. :** L9 B1 M24-95      **DEED BK,PG & DATE :** 11308 /680 2000-05-26  
**ACREAGE :** 0.000      **SALE PRICE :** \$326,000      **QUALIFIED SALE (Y/N) :** Y  
**LAND VALUE :** \$50,000      **IMPVMTS VALUE :** \$243,640      **TOTAL VALUE :** \$293,640

**LAND-USE TYPE :** SINGLE FAMILY      **BUILDING TYPE :** SINGLE FAMILY RESIDENTIAL  
**YEAR BUILT :** 1,991      **SQUARE FEET :** 3,504      **STYLE CODE :** 2.0 STORIES  
**BEDROOMS :** 5      **BATHROOMS :** 3      **RESTROOMS :** 0      **BASEMENT :** N      **GARAGE :** Y  
**EXTERIOR TYPE :** FACE BRICK      **QUALITY GRADE :** 3      **IMPVMT. VALUE :** \$235,670  
**A/C :** CENTRAL      **FIREPLACE :** 2 STY SINGLE/1 DBL

**Record No.:** 21      **BUILDING KEY NUMBER :** 21159306 001  
**PARCEL-ID :** 21159306      **NEIGHBORHOOD CODE :** 21129      **ZONING CLASS :** R3  
**OWNER'S NAME :** BARNETT JAMES H      &WF OLLIE MAE T  
**MAILING ADDRESS :** 4300 STOURTON LN  
**CITY :** CHARLOTTE      **STATE :** NC      **ZIP CODE :** 28226

**PROPERTY LOCATION :** 4300      STOURTON      LN  
**LEGAL DESC. :** L8 B1 M24-95      **DEED BK,PG & DATE :** 07649 /965 1994-01-31  
**ACREAGE :** 0.000      **SALE PRICE :** \$230,500      **QUALIFIED SALE (Y/N) :** Y  
**LAND VALUE :** \$50,000      **IMPVMTS VALUE :** \$236,960      **TOTAL VALUE :** \$286,960

**LAND-USE TYPE :** SINGLE FAMILY      **BUILDING TYPE :** SINGLE FAMILY RESIDENTIAL  
**YEAR BUILT :** 1,993      **SQUARE FEET :** 3,290      **STYLE CODE :** 2.0 STORIES  
**BEDROOMS :** 4      **BATHROOMS :** 2      **RESTROOMS :** 0      **BASEMENT :** N      **GARAGE :** Y  
**EXTERIOR TYPE :** FACE BRICK      **QUALITY GRADE :** 3      **IMPVMT. VALUE :** \$234,960  
**A/C :** CENTRAL      **FIREPLACE :** 2 STY SINGLE/1 DBL

NOTE: This data is prepared for the purposes of revaluation, assessing & determining ownership of real property & is compiled from recorded deeds, plats, tax maps & other public records & data. Users of this data are hereby notified that the aforementioned public information sources should be consulted for verification. Mecklenburg County assumes no legal responsibility for the information herein.



# MECKLENBURG COUNTY, NC

DATE PRINTED 4/1/02

## GIS PUBLIC ACCESS SYSTEM REPORT

Note : Records are sorted in Parcel Number order.

PAGE : 8

**Record No.:** 22      **BUILDING KEY NUMBER :** 21159307 001  
**PARCEL-ID :** 21159307      **NEIGHBORHOOD CODE :** 21129      **ZONING CLASS :** R3  
**OWNER'S NAME :** CHIU MICHAEL      & WF LISA FUNG-YEE  
**MAILING ADDRESS :** 4220 STOURTON LN  
**CITY :** CHARLOTTE      **STATE :** NC      **ZIP CODE :** 28226

**PROPERTY LOCATION :** 4220      STOURTON      LN  
**LEGAL DESC. :** L7B1M24-95 4220 STOURTON LN      **DEED BK,PG & DATE :** 07454 /083 1993-09-10  
**ACREAGE :** 0.000      **SALE PRICE :** \$260,000      **QUALIFIED SALE (Y/N) :** Y  
**LAND VALUE :** \$50,000      **IMPVMTS VALUE :** \$284,460      **TOTAL VALUE :** \$334,460

**LAND-USE TYPE :** SINGLE FAMILY      **BUILDING TYPE :** SINGLE FAMILY RESIDENTIAL  
**YEAR BUILT :** 1,993      **SQUARE FEET :** 4,327      **STYLE CODE :** 2.0 STORIES  
**BEDROOMS :** 5      **BATHROOMS :** 4      **RESTROOMS :** 0      **BASEMENT :** N      **GARAGE :** Y  
**EXTERIOR TYPE :** FACE BRICK      **QUALITY GRADE :** 3      **IMPVMT. VALUE :** \$282,960  
**A/C :** CENTRAL      **FIREPLACE :** 2 STY SINGLE/1 DBL

**Record No.:** 23      **BUILDING KEY NUMBER :** 21159308 001  
**PARCEL-ID :** 21159308      **NEIGHBORHOOD CODE :** 21129      **ZONING CLASS :** R3  
**OWNER'S NAME :** LE XUAN HUONG  
**MAILING ADDRESS :** 4214 STOURTON LN  
**CITY :** CHARLOTTE      **STATE :** NC      **ZIP CODE :** 28226

**PROPERTY LOCATION :** 4214      STOURTON      LN  
**LEGAL DESC. :** L6 B1 M27-841      **DEED BK,PG & DATE :** 09196 /837 1997-08-11  
**ACREAGE :** 0.000      **SALE PRICE :** \$319,000      **QUALIFIED SALE (Y/N) :** Y  
**LAND VALUE :** \$50,000      **IMPVMTS VALUE :** \$266,480      **TOTAL VALUE :** \$316,480

**LAND-USE TYPE :** SINGLE FAMILY      **BUILDING TYPE :** SINGLE FAMILY RESIDENTIAL  
**YEAR BUILT :** 1,997      **SQUARE FEET :** 3,799      **STYLE CODE :** 2.0 STORIES  
**BEDROOMS :** 4      **BATHROOMS :** 4      **RESTROOMS :** 0      **BASEMENT :** N      **GARAGE :** Y  
**EXTERIOR TYPE :** FACE BRICK      **QUALITY GRADE :** 3      **IMPVMT. VALUE :** \$264,140  
**A/C :** CENTRAL      **FIREPLACE :** 2 STY SINGLE/1 DBL

**Record No.:** 24      **BUILDING KEY NUMBER :** 21159310 001  
**PARCEL-ID :** 21159310      **NEIGHBORHOOD CODE :** 21129      **ZONING CLASS :** R3  
**OWNER'S NAME :** WILKERSON D SCOTT  
**MAILING ADDRESS :** 7018 CHADWYCK FARMS DR  
**CITY :** CHARLOTTE      **STATE :** NC      **ZIP CODE :** 282262612

**PROPERTY LOCATION :** 7018      CHADWYCK FARMS      DR  
**LEGAL DESC. :** L4 B1 M27-900      **DEED BK,PG & DATE :** 08736 /810 1996-09-12  
**ACREAGE :** 0.000      **SALE PRICE :** \$0      **QUALIFIED SALE (Y/N) :** N  
**LAND VALUE :** \$50,000      **IMPVMTS VALUE :** \$310,140      **TOTAL VALUE :** \$360,140

**LAND-USE TYPE :** SINGLE FAMILY      **BUILDING TYPE :** SINGLE FAMILY RESIDENTIAL  
**YEAR BUILT :** 1,996      **SQUARE FEET :** 4,285      **STYLE CODE :** 2.0 STORIES  
**BEDROOMS :** 5      **BATHROOMS :** 4      **RESTROOMS :** 0      **BASEMENT :** N      **GARAGE :** Y  
**EXTERIOR TYPE :** FACE BRICK      **QUALITY GRADE :** 3      **IMPVMT. VALUE :** \$294,480  
**A/C :** CENTRAL      **FIREPLACE :** 2 STY SINGLE/1 DBL



# MECKLENBURG COUNTY, NC

DATE PRINTED 4/1/02

## GIS PUBLIC ACCESS SYSTEM REPORT

Note : Records are sorted in Parcel Number order.

PAGE : 9

**Record No.:** 25      **BUILDING KEY NUMBER:** 21159311 001  
**PARCEL-ID:** 21159311      **NEIGHBORHOOD CODE:** 21129      **ZONING CLASS:** R3  
**OWNER'S NAME:** SHAPIRO EDWARD I  
**MAILING ADDRESS:** 7012 CHADWYCK FARMS DR  
**CITY:** CHARLOTTE      **STATE:** NC      **ZIP CODE:** 28226

**PROPERTY LOCATION:** 7012 CHADWYCK FARMS DR  
**LEGAL DESC.:** L3 B1 M27-841      **DEED BK,PG & DATE:** 11295 /781 2000-05-19  
**ACREAGE:** 0.000      **SALE PRICE:** \$368,500      **QUALIFIED SALE (Y/N):** Y  
**LAND VALUE:** \$50,000      **IMPVMTS VALUE:** \$292,790      **TOTAL VALUE:** \$342,790

**LAND-USE TYPE:** SINGLE FAMILY      **BUILDING TYPE:** SINGLE FAMILY RESIDENTIAL  
**YEAR BUILT:** 2,000      **SQUARE FEET:** 4,034      **STYLE CODE:** 2.0 STORIES  
**BEDROOMS:** 4      **BATHROOMS:** 3      **RESTROOMS:** 0      **BASEMENT:** N      **GARAGE:** Y  
**EXTERIOR TYPE:** FACE BRICK      **QUALITY GRADE:** 3      **IMPVMT. VALUE:** \$290,630  
**A/C:** CENTRAL      **FIREPLACE:** 1 STY SINGLE

**Record No.:** 26      **BUILDING KEY NUMBER:** 21159312 001  
**PARCEL-ID:** 21159312      **NEIGHBORHOOD CODE:** 21129      **ZONING CLASS:** R3  
**OWNER'S NAME:** SMITH BRIAN S      &WF MARGARET L  
**MAILING ADDRESS:** 7006 CHADWYCK FARMS DR  
**CITY:** CHARLOTTE      **STATE:** NC      **ZIP CODE:** 28226

**PROPERTY LOCATION:** 7006 CHADWYCK FARMS DR  
**LEGAL DESC.:** L2 B1 M27-841      **DEED BK,PG & DATE:** 10369 /550 1999-04-01  
**ACREAGE:** 0.000      **SALE PRICE:** \$303,000      **QUALIFIED SALE (Y/N):** Y  
**LAND VALUE:** \$50,000      **IMPVMTS VALUE:** \$245,750      **TOTAL VALUE:** \$295,750

**LAND-USE TYPE:** SINGLE FAMILY      **BUILDING TYPE:** SINGLE FAMILY RESIDENTIAL  
**YEAR BUILT:** 1,992      **SQUARE FEET:** 3,564      **STYLE CODE:** 2.0 STORIES  
**BEDROOMS:** 4      **BATHROOMS:** 2      **RESTROOMS:** 0      **BASEMENT:** N      **GARAGE:** Y  
**EXTERIOR TYPE:** FACE BRICK      **QUALITY GRADE:** 3      **IMPVMT. VALUE:** \$244,180  
**A/C:** CENTRAL      **FIREPLACE:** 2 STY SINGLE/1 DBL

**Record No.:** 27      **BUILDING KEY NUMBER:** 21159313 001  
**PARCEL-ID:** 21159313      **NEIGHBORHOOD CODE:** 21129      **ZONING CLASS:** R3  
**OWNER'S NAME:** NAJJAR SAKIB M      &WF BUSHRA A  
**MAILING ADDRESS:** 7000 CHADWYCK FARMS DR  
**CITY:** CHARLOTTE      **STATE:** NC      **ZIP CODE:** 28226

**PROPERTY LOCATION:** 7000 CHADWYCK FARMS DR  
**LEGAL DESC.:** L1 B1 M27-841      **DEED BK,PG & DATE:** 09587 /054 1998-03-30  
**ACREAGE:** 0.000      **SALE PRICE:** \$274,000      **QUALIFIED SALE (Y/N):** Y  
**LAND VALUE:** \$50,000      **IMPVMTS VALUE:** \$233,260      **TOTAL VALUE:** \$283,260

**LAND-USE TYPE:** SINGLE FAMILY      **BUILDING TYPE:** SINGLE FAMILY RESIDENTIAL  
**YEAR BUILT:** 1,997      **SQUARE FEET:** 3,268      **STYLE CODE:** 2.0 STORIES  
**BEDROOMS:** 4      **BATHROOMS:** 2      **RESTROOMS:** 0      **BASEMENT:** N      **GARAGE:** Y  
**EXTERIOR TYPE:** FACE BRICK      **QUALITY GRADE:** 3      **IMPVMT. VALUE:** \$230,650  
**A/C:** CENTRAL      **FIREPLACE:** 2 STY SINGLE/1 DBL

NOTE: This data is prepared for the purposes of revaluation, assessing & determining ownership of real property & is compiled from recorded deeds, plats, tax maps & other public records & data. Users of this data are hereby notified that the aforementioned public information sources should be consulted for verification. Mecklenburg County assumes no legal responsibility for the information herein.



# MECKLENBURG COUNTY, NC

DATE PRINTED 4/1/02

## GIS PUBLIC ACCESS SYSTEM REPORT

Note : Records are sorted in Parcel Number order.

PAGE : 10

**Record No.:** 28                      **BUILDING KEY NUMBER :** 21159314 001  
**PARCEL-ID :** 21159314            **NEIGHBORHOOD CODE :** 21101            **ZONING CLASS :** B1CD  
**OWNER'S NAME :** HARKEY JEAN M  
**MAILING ADDRESS :** 839 JUPITER RD  
**CITY :** WEAVERVILLE            **STATE :** NC                      **ZIP CODE :** 28787

**PROPERTY LOCATION :** 4237            REA                                      RC  
**LEGAL DESC. :** M23-34 4237 REA RD                      **DEED BK,PG & DATE :** 05266 /396 1986-07-10  
**ACREAGE :** 1.000            **SALE PRICE :** \$0            **QUALIFIED SALE (Y/N) :** N  
**LAND VALUE :** \$83,640            **IMPVMTS VALUE :** \$121,330            **TOTAL VALUE :** \$204,970

**LAND-USE TYPE :** SINGLE FAMILY                      **BUILDING TYPE :** OFFICE  
**YEAR BUILT :** 1,940            **SQUARE FEET :** 1,414            **STYLE CODE :** 2.0 STORIES  
**BEDROOMS :** 0            **BATHROOMS :** 2            **RESTROOMS :** 0            **BASEMENT :** N            **GARAGE :** N  
**EXTERIOR TYPE :** WOOD ON SHEATHING OR PLYWO            **QUALITY GRADE :** 2            **IMPVMT. VALUE :** \$33,450  
**A/C :** NONE                                      **FIREPLACE :** NONE

**Record No.:** 29                      **BUILDING KEY NUMBER :** 21159314 002  
**PARCEL-ID :** 21159314            **NEIGHBORHOOD CODE :** 21101            **ZONING CLASS :** B1CD  
**OWNER'S NAME :** HARKEY JEAN M  
**MAILING ADDRESS :** 839 JUPITER RD  
**CITY :** WEAVERVILLE            **STATE :** NC                      **ZIP CODE :** 28787

**PROPERTY LOCATION :**                      REA RD  
**LEGAL DESC. :** M23-34 4237 REA RD                      **DEED BK,PG & DATE :** 05266 /396 1986-07-10  
**ACREAGE :** 1.000            **SALE PRICE :** \$0            **QUALIFIED SALE (Y/N) :** N  
**LAND VALUE :** \$83,640            **IMPVMTS VALUE :** \$121,330            **TOTAL VALUE :** \$204,970

**LAND-USE TYPE :** COMMERCIAL                      **BUILDING TYPE :** COMMERCIAL  
**YEAR BUILT :** 1,989            **SQUARE FEET :** 1,260            **STYLE CODE :** 1.0 STORY  
**BEDROOMS :** 0            **BATHROOMS :** 0            **RESTROOMS :** 0            **BASEMENT :** N            **GARAGE :** N  
**EXTERIOR TYPE :** SIDING AVERAGE                      **QUALITY GRADE :** 2            **IMPVMT. VALUE :** \$65,010  
**A/C :** CENTRAL                                      **FIREPLACE :** NONE

**Record No.:** 30                      **BUILDING KEY NUMBER :** 21159315 001  
**PARCEL-ID :** 21159315            **NEIGHBORHOOD CODE :** 21101            **ZONING CLASS :** B1CD  
**OWNER'S NAME :** CLUTE JANE REA & MARY REA                      KISER & THOMAS HAZEL REA  
**MAILING ADDRESS :** 4683 CHANNING PKWY  
**CITY :** ROCK HILL                      **STATE :** SC                      **ZIP CODE :** 297329353

**PROPERTY LOCATION :** 4245            REA                                      RC  
**LEGAL DESC. :** M23-34 REA RD                      **DEED BK,PG & DATE :** 05562 /243 1987-07-28  
**ACREAGE :** 3.000            **SALE PRICE :** \$0            **QUALIFIED SALE (Y/N) :** N  
**LAND VALUE :** \$190,140            **IMPVMTS VALUE :** \$41,260            **TOTAL VALUE :** \$231,400

**LAND-USE TYPE :** VACANT                                      **BUILDING TYPE :** COMMERCIAL  
**YEAR BUILT :** 0            **SQUARE FEET :** 0            **STYLE CODE :**  
**BEDROOMS :** 0            **BATHROOMS :** 0            **RESTROOMS :** 0            **BASEMENT :** N            **GARAGE :** N  
**EXTERIOR TYPE :**                                      **QUALITY GRADE :** 0            **IMPVMT. VALUE :** \$0  
**A/C :**    **FIREPLACE :**

NOTE: This data is prepared for the purposes of revaluation, assessing & determining ownership of real property & is compiled from recorded deeds, plats, tax maps & other public records & data. Users of this data are hereby notified that the aforementioned public information sources should be consulted for verification. Mecklenburg County assumes no legal responsibility for the information herein.

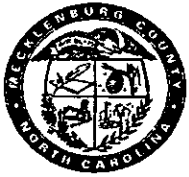

# MECKLENBURG COUNTY, NC

DATE PRINTED 4/1/02

## GIS PUBLIC ACCESS SYSTEM REPORT

Note : Records are sorted in Parcel Number order.

PAGE : 11

**Record No.:** 31                      BUILDING KEY NUMBER : 21159399 001  
**PARCEL-ID :** 21159399            NEIGHBORHOOD CODE : 21129            ZONING CLASS : R3  
**OWNER'S NAME :** CENTEX INTERNATIONAL INC  
**MAILING ADDRESS :** PO BOX 11231  
**CITY :** CHARLOTTE                      STATE : NC                      ZIP CODE : 28235

**PROPERTY LOCATION :** CHADWYCK FARMS                      DR  
**LEGAL DESC. :** C/A B1 M24-796                      DEED BK,PG & DATE : 08736 /810 1996-09-12  
**ACREAGE :** 0.000    **SALE PRICE :** \$0    **QUALIFIED SALE (Y/N) :** N  
**LAND VALUE :** \$100    **IMPVMTS VALUE :** \$0    **TOTAL VALUE :** \$100

**LAND-USE TYPE :** VACANT                      **BUILDING TYPE :** SINGLE FAMILY RESIDENTIAL  
**YEAR BUILT :** 0    **SQUARE FEET :** 0    **STYLE CODE :**  
**BEDROOMS :** 0    **BATHROOMS :** 0    **RESTROOMS :** 0    **BASEMENT :** N    **GARAGE :** N  
**EXTERIOR TYPE :**                      **QUALITY GRADE :** 0    **IMPVMT. VALUE :** \$0  
**A/C :**                      **FIREPLACE :**

**Record No.:** 32                      BUILDING KEY NUMBER : 21159418 001  
**PARCEL-ID :** 21159418            NEIGHBORHOOD CODE : 21129            ZONING CLASS : R3  
**OWNER'S NAME :** SCOTT BARTTON B                      &WF DIANA D  
**MAILING ADDRESS :** 7115 DARNLEY PL  
**CITY :** CHARLOTTE                      STATE : NC                      ZIP CODE : 282262605

**PROPERTY LOCATION :** 7115                      DARNLEY                      PL  
**LEGAL DESC. :** L7 B4 M25-386                      DEED BK,PG & DATE : 10591 /129 1999-07-01  
**ACREAGE :** 0.000    **SALE PRICE :** \$360,000    **QUALIFIED SALE (Y/N) :** Y  
**LAND VALUE :** \$50,000    **IMPVMTS VALUE :** \$253,710    **TOTAL VALUE :** \$303,710

**LAND-USE TYPE :** SINGLE FAMILY                      **BUILDING TYPE :** SINGLE FAMILY RESIDENTIAL  
**YEAR BUILT :** 1,994    **SQUARE FEET :** 3,696    **STYLE CODE :** 2.0 STORIES  
**BEDROOMS :** 4    **BATHROOMS :** 4    **RESTROOMS :** 0    **BASEMENT :** N    **GARAGE :** Y  
**EXTERIOR TYPE :** FACE BRICK                      **QUALITY GRADE :** 3    **IMPVMT. VALUE :** \$251,760  
**A/C :** CENTRAL                      **FIREPLACE :** 2 STY SINGLE/1 DBL

**Record No.:** 33                      BUILDING KEY NUMBER : 21159419 001  
**PARCEL-ID :** 21159419            NEIGHBORHOOD CODE : 21129            ZONING CLASS : R3  
**OWNER'S NAME :** WEBSTER JONATHAN L                      &WF JANTHI F  
**MAILING ADDRESS :** 7109 DARNLEY PL  
**CITY :** CHARLOTTE                      STATE : NC                      ZIP CODE : 28226

**PROPERTY LOCATION :** 7109                      DARNLEY                      PL  
**LEGAL DESC. :** L6 B4 M24-95                      DEED BK,PG & DATE : 10085 /565 1998-12-02  
**ACREAGE :** 0.000    **SALE PRICE :** \$305,000    **QUALIFIED SALE (Y/N) :** Y  
**LAND VALUE :** \$50,000    **IMPVMTS VALUE :** \$247,020    **TOTAL VALUE :** \$297,020

**LAND-USE TYPE :** SINGLE FAMILY                      **BUILDING TYPE :** SINGLE FAMILY RESIDENTIAL  
**YEAR BUILT :** 1,994    **SQUARE FEET :** 3,579    **STYLE CODE :** 2.0 STORIES  
**BEDROOMS :** 5    **BATHROOMS :** 3    **RESTROOMS :** 0    **BASEMENT :** N    **GARAGE :** Y  
**EXTERIOR TYPE :** FACE BRICK                      **QUALITY GRADE :** 3    **IMPVMT. VALUE :** \$244,800  
**A/C :** CENTRAL                      **FIREPLACE :** 2 STY SINGLE/1 DBL

NOTE: This data is prepared for the purposes of revaluation, assessing & determining ownership of real property & is compiled from recorded deeds, plats, tax maps & other public records & data. Users of this data are hereby notified that the aforementioned public information sources should be consulted for verification. Mecklenburg County assumes no legal responsibility for the information herein.



# MECKLENBURG COUNTY, NC

DATE PRINTED 4/1/02

## GIS PUBLIC ACCESS SYSTEM REPORT

Note : Records are sorted in Parcel Number order.

PAGE : 12

**Record No.:** 34      **BUILDING KEY NUMBER:** 21159420 001  
**PARCEL-ID:** 21159420      **NEIGHBORHOOD CODE:** 21129      **ZONING CLASS:** R3  
**OWNER'S NAME:** GILLIS BEN L      & WF PATRICIA B  
**MAILING ADDRESS:** 7101 DARNLEY PL  
**CITY:** CHARLOTTE      **STATE:** NC      **ZIP CODE:** 282262605

**PROPERTY LOCATION:** 7101 DARNLEY PL  
**LEGAL DESC.:** L5B4M24-95 7101 DARNLEY PL      **DEED BK,PG & DATE:** 07116 /099 1992-11-25  
**ACREAGE:** 1.000      **SALE PRICE:** \$214,000      **QUALIFIED SALE (Y/N):** Y  
**LAND VALUE:** \$50,000      **IMPVMTS VALUE:** \$229,140      **TOTAL VALUE:** \$279,140

**LAND-USE TYPE:** SINGLE FAMILY      **BUILDING TYPE:** SINGLE FAMILY RESIDENTIAL  
**YEAR BUILT:** 1,992      **SQUARE FEET:** 3,282      **STYLE CODE:** 2.0 STORIES  
**BEDROOMS:** 4      **BATHROOMS:** 2      **RESTROOMS:** 0      **BASEMENT:** N      **GARAGE:** Y  
**EXTERIOR TYPE:** FACE BRICK      **QUALITY GRADE:** 3      **IMPVMT. VALUE:** \$228,430  
**A/C:** CENTRAL      **FIREPLACE:** 2 STY SINGLE/1 DBL

**Record No.:** 35      **BUILDING KEY NUMBER:** 21159421 001  
**PARCEL-ID:** 21159421      **NEIGHBORHOOD CODE:** 21129      **ZONING CLASS:** R3  
**OWNER'S NAME:** ORMAN PATRICK W III      & WF JUDY P  
**MAILING ADDRESS:** 7019 DARNLEY PL  
**CITY:** CHARLOTTE      **STATE:** NC      **ZIP CODE:** 28226

**PROPERTY LOCATION:** 7019 DARNLEY PL  
**LEGAL DESC.:** L4B4M24-95 7019 DARNLEY PL      **DEED BK,PG & DATE:** 06745 /533 1992-01-24  
**ACREAGE:** 1.000      **SALE PRICE:** \$244,000      **QUALIFIED SALE (Y/N):** Y  
**LAND VALUE:** \$50,000      **IMPVMTS VALUE:** \$272,250      **TOTAL VALUE:** \$322,250

**LAND-USE TYPE:** SINGLE FAMILY      **BUILDING TYPE:** SINGLE FAMILY RESIDENTIAL  
**YEAR BUILT:** 1,991      **SQUARE FEET:** 4,136      **STYLE CODE:** 2.0 STORIES  
**BEDROOMS:** 5      **BATHROOMS:** 4      **RESTROOMS:** 0      **BASEMENT:** N      **GARAGE:** Y  
**EXTERIOR TYPE:** FACE BRICK      **QUALITY GRADE:** 3      **IMPVMT. VALUE:** \$272,250  
**A/C:** CENTRAL      **FIREPLACE:** 2 STY SINGLE/1 DBL

**Record No.:** 36      **BUILDING KEY NUMBER:** 21159422 001  
**PARCEL-ID:** 21159422      **NEIGHBORHOOD CODE:** 21129      **ZONING CLASS:** R3  
**OWNER'S NAME:** STEM RICHARD THAYER      & WF GAIL MCCARTY  
**MAILING ADDRESS:** 7013 DARNLEY PL  
**CITY:** CHARLOTTE      **STATE:** NC      **ZIP CODE:** 282262604

**PROPERTY LOCATION:** 7013 DARNLEY PL  
**LEGAL DESC.:** L3B4M25-95 7013 DARNLEY PL      **DEED BK,PG & DATE:** 06978 /552 1992-08-19  
**ACREAGE:** 1.000      **SALE PRICE:** \$195,000      **QUALIFIED SALE (Y/N):** Y  
**LAND VALUE:** \$50,000      **IMPVMTS VALUE:** \$209,950      **TOTAL VALUE:** \$259,950

**LAND-USE TYPE:** SINGLE FAMILY      **BUILDING TYPE:** SINGLE FAMILY RESIDENTIAL  
**YEAR BUILT:** 1,992      **SQUARE FEET:** 3,062      **STYLE CODE:** 2.0 STORIES  
**BEDROOMS:** 4      **BATHROOMS:** 2      **RESTROOMS:** 0      **BASEMENT:** N      **GARAGE:** Y  
**EXTERIOR TYPE:** FACE BRICK      **QUALITY GRADE:** 3      **IMPVMT. VALUE:** \$207,360  
**A/C:** CENTRAL      **FIREPLACE:** 2 STY SINGLE/1 DBL

NOTE: This data is prepared for the purposes of revaluation, assessing & determining ownership of real property & is compiled from recorded deeds, plats, tax maps & other public records & data. Users of this data are hereby notified that the aforementioned public information sources should be consulted for verification. Mecklenburg County assumes no legal responsibility for the information herein.





# MECKLENBURG COUNTY, NC

DATE PRINTED 4/1/02

## GIS PUBLIC ACCESS SYSTEM REPORT

Note : Records are sorted in Parcel Number order.

PAGE : 13

**Record No.:** 37                      **BUILDING KEY NUMBER :** 21159423 001  
**PARCEL-ID :** 21159423      **NEIGHBORHOOD CODE :** 21129      **ZONING CLASS :** R3  
**OWNER'S NAME :** SHPORER FRED                      & WF LISA RAY  
**MAILING ADDRESS :** 7007 DARNLEY PL  
**CITY :** CHARLOTTE                      **STATE :** NC                      **ZIP CODE :** 282262604

**PROPERTY LOCATION :** 7007                      DARNLEY                      PL  
**LEGAL DESC. :** L2B4M23-910 7007 DARNELEY PL                      **DEED BK,PG & DATE :** 06892 /600 1992-05-29  
**ACREAGE :** 1.000      **SALE PRICE :** \$256,500      **QUALIFIED SALE (Y/N) :** Y  
**LAND VALUE :** \$50,000      **IMPVMTS VALUE :** \$261,310      **TOTAL VALUE :** \$311,310

**LAND-USE TYPE :** SINGLE FAMILY                      **BUILDING TYPE :** SINGLE FAMILY RESIDENTIAL  
**YEAR BUILT :** 1,992      **SQUARE FEET :** 3,657      **STYLE CODE :** 1.5 STORIES  
**BEDROOMS :** 4      **BATHROOMS :** 3      **RESTROOMS :** 0      **BASEMENT :** N      **GARAGE :** Y  
**EXTERIOR TYPE :** STUCCO ON TILE OR WOOD FRAM      **QUALITY GRADE :** 3      **IMPVMT. VALUE :** \$258,910  
**A/C :** CENTRAL                      **FIREPLACE :** 1 STY SINGLE

**Record No.:** 38                      **BUILDING KEY NUMBER :** 21159424 001  
**PARCEL-ID :** 21159424      **NEIGHBORHOOD CODE :** 21129      **ZONING CLASS :** R3  
**OWNER'S NAME :** BAKER WILLIAM S III                      & WF ANY L  
**MAILING ADDRESS :** 7001 DARNLEY PL  
**CITY :** CHARLOTTE                      **STATE :** NC                      **ZIP CODE :** 282262604

**PROPERTY LOCATION :** 7001                      DARNLEY                      PL  
**LEGAL DESC. :** L1B4 M24-95 7001 DARNELEY PL                      **DEED BK,PG & DATE :** 06956 /250 1992-07-30  
**ACREAGE :** 1.000      **SALE PRICE :** \$228,500      **QUALIFIED SALE (Y/N) :** Y  
**LAND VALUE :** \$50,000      **IMPVMTS VALUE :** \$216,820      **TOTAL VALUE :** \$266,820

**LAND-USE TYPE :** SINGLE FAMILY                      **BUILDING TYPE :** SINGLE FAMILY RESIDENTIAL  
**YEAR BUILT :** 1,992      **SQUARE FEET :** 3,196      **STYLE CODE :** 2.0 STORIES  
**BEDROOMS :** 4      **BATHROOMS :** 2      **RESTROOMS :** 0      **BASEMENT :** N      **GARAGE :** Y  
**EXTERIOR TYPE :** FACE BRICK                      **QUALITY GRADE :** 3      **IMPVMT. VALUE :** \$214,360  
**A/C :** CENTRAL                      **FIREPLACE :** 2 STY SINGLE/1 DBL

**Record No.:** 39                      **BUILDING KEY NUMBER :** 21159451 001  
**PARCEL-ID :** 21159451      **NEIGHBORHOOD CODE :** 21129      **ZONING CLASS :** R3  
**OWNER'S NAME :** KEMMY MICHAEL J                      & WF DEBRA C  
**MAILING ADDRESS :** 4409 HUNTSCROFT LN  
**CITY :** CHARLOTTE                      **STATE :** NC                      **ZIP CODE :** 28226

**PROPERTY LOCATION :** 4409                      HUNTSCROFT                      LN  
**LEGAL DESC. :** L22 M31-319                      **DEED BK,PG & DATE :** 10588 /226 1999-07-01  
**ACREAGE :** 0.000      **SALE PRICE :** \$286,000      **QUALIFIED SALE (Y/N) :** Y  
**LAND VALUE :** \$40,000      **IMPVMTS VALUE :** \$202,680      **TOTAL VALUE :** \$242,680

**LAND-USE TYPE :** SINGLE FAMILY                      **BUILDING TYPE :** SINGLE FAMILY RESIDENTIAL  
**YEAR BUILT :** 1,999      **SQUARE FEET :** 3,346      **STYLE CODE :** 2.0 STORIES  
**BEDROOMS :** 4      **BATHROOMS :** 2      **RESTROOMS :** 0      **BASEMENT :** N      **GARAGE :** Y  
**EXTERIOR TYPE :** FACE BRICK                      **QUALITY GRADE :** 2      **IMPVMT. VALUE :** \$200,570  
**A/C :** CENTRAL                      **FIREPLACE :** PREFAB

NOTE: This data is prepared for the purposes of revaluation, assessing & determining ownership of real property & is compiled from recorded deeds, plats, tax maps & other public records & data. Users of this data are hereby notified that the aforementioned public information sources should be consulted for verification. Mecklenburg County assumes no legal responsibility for the information herein.



# MECKLENBURG COUNTY, NC

DATE PRINTED 4/1/02

## GIS PUBLIC ACCESS SYSTEM REPORT

Note : Records are sorted in Parcel Number order.

PAGE : 14

**Record No.:** 40      **BUILDING KEY NUMBER :** 21159452 001  
**PARCEL-ID :** 21159452      **NEIGHBORHOOD CODE :** 21129      **ZONING CLASS :** R3  
**OWNER'S NAME :** JURNEY ANTIONETTE  
**MAILING ADDRESS :** 4415 HUNTS CROFT LN  
**CITY :** CHARLOTTE      **STATE :** NC      **ZIP CODE :** 28226

**PROPERTY LOCATION :** 4415      HUNTS CROFT      LN  
**LEGAL DESC. :** L23 M31-319      **DEED BK,PG & DATE :** 12185 /772 2001-05-02  
**ACREAGE :** 0.000      **SALE PRICE :** \$255,000      **QUALIFIED SALE (Y/N) :** Y  
**LAND VALUE :** \$40,000      **IMPVMTS VALUE :** \$0      **TOTAL VALUE :** \$40,000

**LAND-USE TYPE :** VACANT      **BUILDING TYPE :** SINGLE FAMILY RESIDENTIAL  
**YEAR BUILT :** 0      **SQUARE FEET :** 0      **STYLE CODE :**  
**BEDROOMS :** 0      **BATHROOMS :** 0      **RESTROOMS :** 0      **BASEMENT :** N      **GARAGE :** N  
**EXTERIOR TYPE :**      **QUALITY GRADE :** 0      **IMPVMT. VALUE :** \$0  
**A/C :**      **FIREPLACE :**

**Record No.:** 41      **BUILDING KEY NUMBER :** 21159453 001  
**PARCEL-ID :** 21159453      **NEIGHBORHOOD CODE :** 21129      **ZONING CLASS :** R3  
**OWNER'S NAME :** SCHOLDER GARY R      EVELYN C SCHOLDER (H/W)  
**MAILING ADDRESS :** 4419 HUNTS CROFT LN  
**CITY :** CHARLOTTE      **STATE :** NC      **ZIP CODE :** 28226

**PROPERTY LOCATION :** 4419      HUNTS CROFT      LN  
**LEGAL DESC. :** L24 M31-319      **DEED BK,PG & DATE :** 11685 /525 2000-10-31  
**ACREAGE :** 0.000      **SALE PRICE :** \$280,000      **QUALIFIED SALE (Y/N) :** Y  
**LAND VALUE :** \$40,000      **IMPVMTS VALUE :** \$190,990      **TOTAL VALUE :** \$230,990

**LAND-USE TYPE :** SINGLE FAMILY      **BUILDING TYPE :** SINGLE FAMILY RESIDENTIAL  
**YEAR BUILT :** 2,000      **SQUARE FEET :** 3,049      **STYLE CODE :** 2.0 STORIES  
**BEDROOMS :** 4      **BATHROOMS :** 3      **RESTROOMS :** 0      **BASEMENT :** N      **GARAGE :** Y  
**EXTERIOR TYPE :** ALUMINUM/VINYL SIDING      **QUALITY GRADE :** 2      **IMPVMT. VALUE :** \$188,640  
**A/C :** CENTRAL      **FIREPLACE :** PREFAB

**Record No.:** 42      **BUILDING KEY NUMBER :** 21159454 001  
**PARCEL-ID :** 21159454      **NEIGHBORHOOD CODE :** 21129      **ZONING CLASS :** R3  
**OWNER'S NAME :** GILLIAM FRANK B      ANNE-MARIE GILLIAM (H/W)  
**MAILING ADDRESS :** 4425 HUNTS CROFT LN  
**CITY :** CHARLOTTE      **STATE :** NC      **ZIP CODE :** 28226

**PROPERTY LOCATION :** 4425      HUNTS CROFT      LN  
**LEGAL DESC. :** L25 M31-319      **DEED BK,PG & DATE :** 12300 /709 2001-06-01  
**ACREAGE :** 0.000      **SALE PRICE :** \$351,000      **QUALIFIED SALE (Y/N) :** Y  
**LAND VALUE :** \$40,000      **IMPVMTS VALUE :** \$0      **TOTAL VALUE :** \$40,000

**LAND-USE TYPE :** VACANT      **BUILDING TYPE :** NEW PARCEL  
**YEAR BUILT :** 0      **SQUARE FEET :** 0      **STYLE CODE :**  
**BEDROOMS :** 0      **BATHROOMS :** 0      **RESTROOMS :** 0      **BASEMENT :** N      **GARAGE :** N  
**EXTERIOR TYPE :**      **QUALITY GRADE :** 0      **IMPVMT. VALUE :** \$0  
**A/C :**      **FIREPLACE :**

NOTE: This data is prepared for the purposes of revaluation, assessing & determining ownership of real property & is compiled from recorded deeds, plats, tax maps & other public records & data. Users of this data are hereby notified that the aforementioned public information sources should be consulted for verification. Mecklenburg County assumes no legal responsibility for the information herein.



# MECKLENBURG COUNTY, NC

DATE PRINTED 4/1/02

## GIS PUBLIC ACCESS SYSTEM REPORT

Note : Records are sorted in Parcel Number order.

PAGE : 15

**Record No.:** 43      **BUILDING KEY NUMBER :** 21159455 001  
**PARCEL-ID :** 21159455      **NEIGHBORHOOD CODE :** 21129      **ZONING CLASS :** R3  
**OWNER'S NAME :** SANDLER ROBERT M      &WF SUSAN R  
**MAILING ADDRESS :** 4431 HUNTSCROFT LN  
**CITY :** CHARLOTTE      **STATE :** NC      **ZIP CODE :** 28226

**PROPERTY LOCATION :** 4431      HUNTSCROFT      LN  
**LEGAL DESC. :** L26 M31-319      **DEED BK,PG & DATE :** 11239 /437 2000-04-26  
**ACREAGE :** 0.000      **SALE PRICE :** \$0      **QUALIFIED SALE (Y/N) :**  
**LAND VALUE :** \$40,000      **IMPVMTS VALUE :** \$176,410      **TOTAL VALUE :** \$216,410

**LAND-USE TYPE :** SINGLE FAMILY      **BUILDING TYPE :** SINGLE FAMILY RESIDENTIAL  
**YEAR BUILT :** 2,000      **SQUARE FEET :** 2,681      **STYLE CODE :** 1.5 STORIES  
**BEDROOMS :** 3      **BATHROOMS :** 2      **RESTROOMS :** 0      **BASEMENT :** N      **GARAGE :** Y  
**EXTERIOR TYPE :** FACE BRICK      **QUALITY GRADE :** 2      **IMPVMT. VALUE :** \$174,830  
**A/C :** CENTRAL      **FIREPLACE :** PREFAB

**Record No.:** 44      **BUILDING KEY NUMBER :** 21159456 001  
**PARCEL-ID :** 21159456      **NEIGHBORHOOD CODE :** 21129      **ZONING CLASS :** R3  
**OWNER'S NAME :** REYNOLDS JOHN  
**MAILING ADDRESS :** 4437 HUNTSCROFT LN  
**CITY :** CHARLOTTE      **STATE :** NC      **ZIP CODE :** 28226

**PROPERTY LOCATION :** 4437      HUNTSCROFT      LN  
**LEGAL DESC. :** L27 M31-317      **DEED BK,PG & DATE :** 11190 /946 2000-04-03  
**ACREAGE :** 0.000      **SALE PRICE :** \$0      **QUALIFIED SALE (Y/N) :**  
**LAND VALUE :** \$40,000      **IMPVMTS VALUE :** \$161,170      **TOTAL VALUE :** \$201,170

**LAND-USE TYPE :** SINGLE FAMILY      **BUILDING TYPE :** SINGLE FAMILY RESIDENTIAL  
**YEAR BUILT :** 2,000      **SQUARE FEET :** 2,552      **STYLE CODE :** 2.0 STORIES  
**BEDROOMS :** 3      **BATHROOMS :** 2      **RESTROOMS :** 0      **BASEMENT :** N      **GARAGE :** Y  
**EXTERIOR TYPE :** ALUMINUM/VINYL SIDING      **QUALITY GRADE :** 2      **IMPVMT. VALUE :** \$159,610  
**A/C :** CENTRAL      **FIREPLACE :** PREFAB

**Record No.:** 45      **BUILDING KEY NUMBER :** 21159457 001  
**PARCEL-ID :** 21159457      **NEIGHBORHOOD CODE :** 21129      **ZONING CLASS :** R3  
**OWNER'S NAME :** KELLEY PATRICIA MCLEOD      &HSB HERBERT S MCLEOD JR  
**MAILING ADDRESS :** 71111 REA CROFT DR  
**CITY :** CHARLOTTE      **STATE :** NC      **ZIP CODE :** 28226

**PROPERTY LOCATION :** 7111      REA CROFT      DR  
**LEGAL DESC. :** L28 M31-317      **DEED BK,PG & DATE :** 10946 /553 1999-12-03  
**ACREAGE :** 0.000      **SALE PRICE :** \$269,500      **QUALIFIED SALE (Y/N) :** Y  
**LAND VALUE :** \$40,000      **IMPVMTS VALUE :** \$191,280      **TOTAL VALUE :** \$231,280

**LAND-USE TYPE :** SINGLE FAMILY      **BUILDING TYPE :** SINGLE FAMILY RESIDENTIAL  
**YEAR BUILT :** 1,999      **SQUARE FEET :** 2,950      **STYLE CODE :** 1.5 STORIES  
**BEDROOMS :** 3      **BATHROOMS :** 3      **RESTROOMS :** 0      **BASEMENT :** N      **GARAGE :** Y  
**EXTERIOR TYPE :** FACE BRICK      **QUALITY GRADE :** 2      **IMPVMT. VALUE :** \$190,560  
**A/C :** CENTRAL      **FIREPLACE :** PREFAB

NOTE: This data is prepared for the purposes of revaluation, assessing & determining ownership of real property & is compiled from recorded deeds, plats, tax maps & other public records & data. Users of this data are hereby notified that the aforementioned public information sources should be consulted for verification. Mecklenburg County assumes no legal responsibility for the information herein.



# MECKLENBURG COUNTY, NC

DATE PRINTED 4/1/02

## GIS PUBLIC ACCESS SYSTEM REPORT

Note : Records are sorted in Parcel Number order.

PAGE : 16

**Record No.:** 46      **BUILDING KEY NUMBER :** 21159458 001  
**PARCEL-ID :** 21159458      **NEIGHBORHOOD CODE :** 21129      **ZONING CLASS :** R3  
**OWNER'S NAME :** KELLEY KEVIN      SUSAN KELLEY (H/W)  
**MAILING ADDRESS :** 7127 REA CROFT DR  
**CITY :** CHARLOTTE      **STATE :** NC      **ZIP CODE :** 28226

**PROPERTY LOCATION :** 7127      REA CROFT      DR  
**LEGAL DESC. :** L29 M31-317      **DEED BK,PG & DATE :** 12515 /317 2001-08-01  
**ACREAGE :** 0.000      **SALE PRICE :** \$293,500      **QUALIFIED SALE (Y/N) :** Y  
**LAND VALUE :** \$40,000      **IMPVMTS VALUE :** \$0      **TOTAL VALUE :** \$40,000

**LAND-USE TYPE :** VACANT      **BUILDING TYPE :** NEW PARCEL  
**YEAR BUILT :** 0      **SQUARE FEET :** 0      **STYLE CODE :**  
**BEDROOMS :** 0      **BATHROOMS :** 0      **RESTROOMS :** 0      **BASEMENT :** N      **GARAGE :** N  
**EXTERIOR TYPE :**      **QUALITY GRADE :** 0      **IMPVMT. VALUE :** \$0  
**A/C :**      **FIREPLACE :**

**Record No.:** 47      **BUILDING KEY NUMBER :** 21159459 001  
**PARCEL-ID :** 21159459      **NEIGHBORHOOD CODE :** 21129      **ZONING CLASS :** R3  
**OWNER'S NAME :** CROSBY JOHN P      NANCY H CROSBY (H/W)  
**MAILING ADDRESS :** 7203 REA CROFT DR  
**CITY :** CHARLOTTE      **STATE :** NC      **ZIP CODE :** 28226

**PROPERTY LOCATION :** 7203      REA CROFT      DR  
**LEGAL DESC. :** L30 M31-317      **DEED BK,PG & DATE :** 12300 /411 2001-06-01  
**ACREAGE :** 0.000      **SALE PRICE :** \$302,500      **QUALIFIED SALE (Y/N) :** Y  
**LAND VALUE :** \$40,000      **IMPVMTS VALUE :** \$0      **TOTAL VALUE :** \$40,000

**LAND-USE TYPE :** VACANT      **BUILDING TYPE :** NEW PARCEL  
**YEAR BUILT :** 0      **SQUARE FEET :** 0      **STYLE CODE :**  
**BEDROOMS :** 0      **BATHROOMS :** 0      **RESTROOMS :** 0      **BASEMENT :** N      **GARAGE :** N  
**EXTERIOR TYPE :**      **QUALITY GRADE :** 0      **IMPVMT. VALUE :** \$0  
**A/C :**      **FIREPLACE :**

**Record No.:** 48      **BUILDING KEY NUMBER :** 21159460 001  
**PARCEL-ID :** 21159460      **NEIGHBORHOOD CODE :** 21129      **ZONING CLASS :** R3  
**OWNER'S NAME :** CRAIG GORDON H      GINGER K CRAIG (H/W)  
**MAILING ADDRESS :** 7211 REA CROFT DR  
**CITY :** CHARLOTTE      **STATE :** NC      **ZIP CODE :** 28226

**PROPERTY LOCATION :** 7211      REA CROFT      DR  
**LEGAL DESC. :** L31 M31-319      **DEED BK,PG & DATE :** 11727 /601 2000-11-20  
**ACREAGE :** 0.000      **SALE PRICE :** \$301,000      **QUALIFIED SALE (Y/N) :** Y  
**LAND VALUE :** \$40,000      **IMPVMTS VALUE :** \$198,960      **TOTAL VALUE :** \$238,960

**LAND-USE TYPE :** SINGLE FAMILY      **BUILDING TYPE :** SINGLE FAMILY RESIDENTIAL  
**YEAR BUILT :** 2,000      **SQUARE FEET :** 3,301      **STYLE CODE :** 2.0 STORIES  
**BEDROOMS :** 4      **BATHROOMS :** 2      **RESTROOMS :** 0      **BASEMENT :** N      **GARAGE :** Y  
**EXTERIOR TYPE :** FACE BRICK      **QUALITY GRADE :** 2      **IMPVMT. VALUE :** \$197,640  
**A/C :** CENTRAL      **FIREPLACE :** PREFAB



# MECKLENBURG COUNTY, NC

DATE PRINTED 4/1/02

## GIS PUBLIC ACCESS SYSTEM REPORT

Note : Records are sorted in Parcel Number order.

PAGE : 17

**Record No.:** 49      **BUILDING KEY NUMBER :** 21159461 001  
**PARCEL-ID :** 21159461      **NEIGHBORHOOD CODE :** 21129      **ZONING CLASS :** R3  
**OWNER'S NAME :** MAHER SEAN M      MELVIN MAHER (H/W)  
**MAILING ADDRESS :** 7219 REA CROFT DR  
**CITY :** CHARLOTTE      **STATE :** NC      **ZIP CODE :** 28226

**PROPERTY LOCATION :** 7219      REA CROFT      DR  
**LEGAL DESC. :** L32 M31-319      **DEED BK,PG & DATE :** 12406 /934 2001-07-02  
**ACREAGE :** 0.000      **SALE PRICE :** \$309,000      **QUALIFIED SALE (Y/N) :** Y  
**LAND VALUE :** \$40,000      **IMPVMTS VALUE :** \$0      **TOTAL VALUE :** \$40,000

**LAND-USE TYPE :** VACANT      **BUILDING TYPE :** NEW PARCEL  
**YEAR BUILT :** 0      **SQUARE FEET :** 0      **STYLE CODE :**  
**BEDROOMS :** 0      **BATHROOMS :** 0      **RESTROOMS :** 0      **BASEMENT :** N      **GARAGE :** N  
**EXTERIOR TYPE :**      **QUALITY GRADE :** 0      **IMPVMT. VALUE :** \$0  
**A/C :**      **FIREPLACE :**

**Record No.:** 50      **BUILDING KEY NUMBER :** 21159462 001  
**PARCEL-ID :** 21159462      **NEIGHBORHOOD CODE :** 21129      **ZONING CLASS :** R3  
**OWNER'S NAME :** CRASTO VALERIAN      CLARISSA A CRASTO (H/W)  
**MAILING ADDRESS :** 7225 REA CROFT DR  
**CITY :** CHARLOTTE      **STATE :** NC      **ZIP CODE :** 28226

**PROPERTY LOCATION :** 7225      REA CROFT      DR  
**LEGAL DESC. :** L33 M31-319      **DEED BK,PG & DATE :** 12393 /249 2001-06-29  
**ACREAGE :** 0.000      **SALE PRICE :** \$289,000      **QUALIFIED SALE (Y/N) :** Y  
**LAND VALUE :** \$40,000      **IMPVMTS VALUE :** \$0      **TOTAL VALUE :** \$40,000

**LAND-USE TYPE :** VACANT      **BUILDING TYPE :** NEW PARCEL  
**YEAR BUILT :** 0      **SQUARE FEET :** 0      **STYLE CODE :**  
**BEDROOMS :** 0      **BATHROOMS :** 0      **RESTROOMS :** 0      **BASEMENT :** N      **GARAGE :** N  
**EXTERIOR TYPE :**      **QUALITY GRADE :** 0      **IMPVMT. VALUE :** \$0  
**A/C :**      **FIREPLACE :**

**Record No.:** 51      **BUILDING KEY NUMBER :** 21159463 001  
**PARCEL-ID :** 21159463      **NEIGHBORHOOD CODE :** 21129      **ZONING CLASS :** R3  
**OWNER'S NAME :** KNIGHT RICHARD A      NICOLE L THOMPKINS  
**MAILING ADDRESS :** 7231 REA CROFT DR  
**CITY :** CHARLOTTE      **STATE :** NC      **ZIP CODE :** 28226

**PROPERTY LOCATION :** 7231      REA CROFT      DR  
**LEGAL DESC. :** L34 M31-319      **DEED BK,PG & DATE :** 12374 /545 2001-06-26  
**ACREAGE :** 0.000      **SALE PRICE :** \$283,000      **QUALIFIED SALE (Y/N) :** Y  
**LAND VALUE :** \$40,000      **IMPVMTS VALUE :** \$0      **TOTAL VALUE :** \$40,000

**LAND-USE TYPE :** VACANT      **BUILDING TYPE :** NEW PARCEL  
**YEAR BUILT :** 0      **SQUARE FEET :** 0      **STYLE CODE :**  
**BEDROOMS :** 0      **BATHROOMS :** 0      **RESTROOMS :** 0      **BASEMENT :** N      **GARAGE :** N  
**EXTERIOR TYPE :**      **QUALITY GRADE :** 0      **IMPVMT. VALUE :** \$0  
**A/C :**      **FIREPLACE :**

NOTE: This data is prepared for the purposes of revaluation, assessing & determining ownership of real property & is compiled from recorded deeds, plats, tax maps & other public records & data. Users of this data are hereby notified that the aforementioned public information sources should be consulted for verification. Mecklenburg County assumes no legal responsibility for the information herein.



# MECKLENBURG COUNTY, NC

DATE PRINTED 4/1/02

## GIS PUBLIC ACCESS SYSTEM REPORT

Note : Records are sorted in Parcel Number order.

PAGE : 18

**Record No.:** 52      **BUILDING KEY NUMBER :** 21159464 001  
**PARCEL-ID :** 21159464      **NEIGHBORHOOD CODE :** 21129      **ZONING CLASS :** R3  
**OWNER'S NAME :** LOSELLE ERIC      MARGARET LOSELLE (H/W)  
**MAILING ADDRESS :** 7235 REA CROFT DR  
**CITY :** CHARLOTTE      **STATE :** NC      **ZIP CODE :** 28226

**PROPERTY LOCATION :** 7235      REA CROFT      DR  
**LEGAL DESC. :** L35 M31-319      **DEED BK,PG & DATE :** 12630 /787 2001-09-04  
**ACREAGE :** 0.000      **SALE PRICE :** \$299,500      **QUALIFIED SALE (Y/N) :** Y  
**LAND VALUE :** \$40,000      **IMPVMTS VALUE :** \$0      **TOTAL VALUE :** \$40,000

**LAND-USE TYPE :** VACANT      **BUILDING TYPE :** NEW PARCEL  
**YEAR BUILT :** 0      **SQUARE FEET :** 0      **STYLE CODE :**  
**BEDROOMS :** 0      **BATHROOMS :** 0      **RESTROOMS :** 0      **BASEMENT :** N      **GARAGE :** N  
**EXTERIOR TYPE :**      **QUALITY GRADE :** 0      **IMPVMT. VALUE :** \$0  
**A/C :**      **FIREPLACE :**

**Record No.:** 53      **BUILDING KEY NUMBER :** 21159465 001  
**PARCEL-ID :** 21159465      **NEIGHBORHOOD CODE :** 21129      **ZONING CLASS :** R3  
**OWNER'S NAME :** M/I SCHOTTENSTEIN INC  
**MAILING ADDRESS :** 3 EASTON OVAL STE 500  
**CITY :** COLUMBUS      **STATE :** OF      **ZIP CODE :** 432196011

**PROPERTY LOCATION :** 7239      REA CROFT      DR  
**LEGAL DESC. :** L36 M31-319      **DEED BK,PG & DATE :** 09479 /497 1998-02-02  
**ACREAGE :** 0.000      **SALE PRICE :** \$0      **QUALIFIED SALE (Y/N) :** N  
**LAND VALUE :** \$36,000      **IMPVMTS VALUE :** \$0      **TOTAL VALUE :** \$36,000

**LAND-USE TYPE :** VACANT      **BUILDING TYPE :** NEW PARCEL  
**YEAR BUILT :** 0      **SQUARE FEET :** 0      **STYLE CODE :**  
**BEDROOMS :** 0      **BATHROOMS :** 0      **RESTROOMS :** 0      **BASEMENT :** N      **GARAGE :** N  
**EXTERIOR TYPE :**      **QUALITY GRADE :** 0      **IMPVMT. VALUE :** \$0  
**A/C :**      **FIREPLACE :**

**Record No.:** 54      **BUILDING KEY NUMBER :** 21159466 001  
**PARCEL-ID :** 21159466      **NEIGHBORHOOD CODE :** 21129      **ZONING CLASS :** R3  
**OWNER'S NAME :** M/I SCHOTTENSTEIN INC  
**MAILING ADDRESS :** 3 EASTON OVAL STE 500  
**CITY :** COLUMBUS      **STATE :** OF      **ZIP CODE :** 432196011

**PROPERTY LOCATION :** 7240      REA CROFT      DR  
**LEGAL DESC. :** L37 M31-319      **DEED BK,PG & DATE :** 09479 /497 1998-02-02  
**ACREAGE :** 0.000      **SALE PRICE :** \$0      **QUALIFIED SALE (Y/N) :** N  
**LAND VALUE :** \$36,000      **IMPVMTS VALUE :** \$0      **TOTAL VALUE :** \$36,000

**LAND-USE TYPE :** VACANT      **BUILDING TYPE :** NEW PARCEL  
**YEAR BUILT :** 0      **SQUARE FEET :** 0      **STYLE CODE :**  
**BEDROOMS :** 0      **BATHROOMS :** 0      **RESTROOMS :** 0      **BASEMENT :** N      **GARAGE :** N  
**EXTERIOR TYPE :**      **QUALITY GRADE :** 0      **IMPVMT. VALUE :** \$0  
**A/C :**      **FIREPLACE :**

NOTE: This data is prepared for the purposes of revaluation, assessing & determining ownership of real property & is compiled from recorded deeds, plats, tax maps & other public records & data. Users of this data are hereby notified that the aforementioned public information sources should be consulted for verification. Mecklenburg County assumes no legal responsibility for the information herein.



# MECKLENBURG COUNTY, NC

DATE PRINTED 4/1/02

## GIS PUBLIC ACCESS SYSTEM REPORT

Note : Records are sorted in Parcel Number order.

PAGE : 19

**Record No.:** 55      **BUILDING KEY NUMBER:** 21159467 001  
**PARCEL-ID:** 21159467      **NEIGHBORHOOD CODE:** 21129      **ZONING CLASS:** R3  
**OWNER'S NAME:** TYCH BRIAN J  
**MAILING ADDRESS:** 7236 RES CROFT DR  
**CITY:** CHARLOTTE      **STATE:** NC      **ZIP CODE:** 28226

**PROPERTY LOCATION:** 7236 REA CROFT DR  
**LEGAL DESC.:** L38 M31-319      **DEED BK,PG & DATE:** 11524 /715 2000-08-25  
**ACREAGE:** 0.000      **SALE PRICE:** \$266,000      **QUALIFIED SALE (Y/N):** Y  
**LAND VALUE:** \$40,000      **IMPVMTS VALUE:** \$164,540      **TOTAL VALUE:** \$204,540

**LAND-USE TYPE:** SINGLE FAMILY      **BUILDING TYPE:** SINGLE FAMILY RESIDENTIAL  
**YEAR BUILT:** 2,000      **SQUARE FEET:** 2,552      **STYLE CODE:** 2.0 STORIES  
**BEDROOMS:** 3      **BATHROOMS:** 2      **RESTROOMS:** 0      **BASEMENT:** N      **GARAGE:** Y  
**EXTERIOR TYPE:** FACE BRICK      **QUALITY GRADE:** 2      **IMPVMT. VALUE:** \$162,980  
**A/C:** CENTRAL      **FIREPLACE:** PREFAB

**Record No.:** 56      **BUILDING KEY NUMBER:** 21159468 001  
**PARCEL-ID:** 21159468      **NEIGHBORHOOD CODE:** 21129      **ZONING CLASS:** R3  
**OWNER'S NAME:** SMITH RANDY M JR      NATALIE B SMITH (H/W)  
**MAILING ADDRESS:** 7232 REA CROFT DR  
**CITY:** CHARLOTTE      **STATE:** NC      **ZIP CODE:** 28226

**PROPERTY LOCATION:** 7232 REA CROFT DR  
**LEGAL DESC.:** L39 M31-319      **DEED BK,PG & DATE:** 11743 /661 2000-11-28  
**ACREAGE:** 0.000      **SALE PRICE:** \$266,500      **QUALIFIED SALE (Y/N):** Y  
**LAND VALUE:** \$40,000      **IMPVMTS VALUE:** \$166,570      **TOTAL VALUE:** \$206,570

**LAND-USE TYPE:** SINGLE FAMILY      **BUILDING TYPE:** SINGLE FAMILY RESIDENTIAL  
**YEAR BUILT:** 2,000      **SQUARE FEET:** 2,560      **STYLE CODE:** 2.0 STORIES  
**BEDROOMS:** 3      **BATHROOMS:** 2      **RESTROOMS:** 0      **BASEMENT:** N      **GARAGE:** Y  
**EXTERIOR TYPE:** FACE BRICK      **QUALITY GRADE:** 2      **IMPVMT. VALUE:** \$164,460  
**A/C:** CENTRAL      **FIREPLACE:** PREFAB

**Record No.:** 57      **BUILDING KEY NUMBER:** 21159469 001  
**PARCEL-ID:** 21159469      **NEIGHBORHOOD CODE:** 21129      **ZONING CLASS:** R3  
**OWNER'S NAME:** TUCHI MATTHEW P      ALLISON L TUCHI (H/W)  
**MAILING ADDRESS:** 7226 REA CROFT DR  
**CITY:** CHARLOTTE      **STATE:** NC      **ZIP CODE:** 28226

**PROPERTY LOCATION:** 7226 REA CROFT DR  
**LEGAL DESC.:** L40 M31-319      **DEED BK,PG & DATE:** 11566 /838 2000-09-12  
**ACREAGE:** 0.000      **SALE PRICE:** \$282,500      **QUALIFIED SALE (Y/N):** Y  
**LAND VALUE:** \$40,000      **IMPVMTS VALUE:** \$182,240      **TOTAL VALUE:** \$222,240

**LAND-USE TYPE:** SINGLE FAMILY      **BUILDING TYPE:** SINGLE FAMILY RESIDENTIAL  
**YEAR BUILT:** 2,000      **SQUARE FEET:** 3,006      **STYLE CODE:** 2.0 STORIES  
**BEDROOMS:** 3      **BATHROOMS:** 2      **RESTROOMS:** 0      **BASEMENT:** N      **GARAGE:** Y  
**EXTERIOR TYPE:** FACE BRICK      **QUALITY GRADE:** 2      **IMPVMT. VALUE:** \$180,510  
**A/C:** CENTRAL      **FIREPLACE:** PREFAB

NOTE: This data is prepared for the purposes of revaluation, assessing & determining ownership of real property & is compiled from recorded deeds, plats, tax maps & other public records & data. Users of this data are hereby notified that the aforementioned public information sources should be consulted for verification. Mecklenburg County assumes no legal responsibility for the information herein.



# MECKLENBURG COUNTY, NC

DATE PRINTED 4/1/02

## GIS PUBLIC ACCESS SYSTEM REPORT

Note : Records are sorted in Parcel Number order.

PAGE : 20

**Record No.:** 58 BUILDING KEY NUMBER : 21159470 001  
**PARCEL-ID :** 21159470 NEIGHBORHOOD CODE : 21129 ZONING CLASS : R3  
**OWNER'S NAME :** MORAN AMANDA L CLARENCE J CHILDERS  
**MAILING ADDRESS :** 7220 REA CROFT DR  
**CITY :** CHARLOTTE **STATE :** NC **ZIP CODE :** 28226

**PROPERTY LOCATION :** 7220 REA CROFT DR  
**LEGAL DESC. :** L41 M31-319 **DEED BK,PG & DATE :** 12297 /962 2001-06-01  
**ACREAGE :** 0.000 **SALE PRICE :** \$273,000 **QUALIFIED SALE (Y/N) :** Y  
**LAND VALUE :** \$40,000 **IMPVMTS VALUE :** \$0 **TOTAL VALUE :** \$40,000

**LAND-USE TYPE :** VACANT **BUILDING TYPE :** NEW PARCEL  
**YEAR BUILT :** 0 **SQUARE FEET :** 0 **STYLE CODE :**  
**BEDROOMS :** 0 **BATHROOMS :** 0 **RESTROOMS :** 0 **BASEMENT :** N **GARAGE :** N  
**EXTERIOR TYPE :** **QUALITY GRADE :** 0 **IMPVMT. VALUE :** \$0  
**A/C :** **FIREPLACE :**

**Record No.:** 59 BUILDING KEY NUMBER : 21159471 001  
**PARCEL-ID :** 21159471 NEIGHBORHOOD CODE : 21129 ZONING CLASS : R3  
**OWNER'S NAME :** ACKEN ALLEN A JR KAREN D ACKEN (H/W)  
**MAILING ADDRESS :** 7212 REA CROFT DR  
**CITY :** CHARLOTTE **STATE :** NC **ZIP CODE :** 28226

**PROPERTY LOCATION :** 7212 REA CROFT DR  
**LEGAL DESC. :** L42 M31-319 **DEED BK,PG & DATE :** 12611 /211 2001-08-30  
**ACREAGE :** 0.000 **SALE PRICE :** \$321,500 **QUALIFIED SALE (Y/N) :** Y  
**LAND VALUE :** \$40,000 **IMPVMTS VALUE :** \$0 **TOTAL VALUE :** \$40,000

**LAND-USE TYPE :** VACANT **BUILDING TYPE :** NEW PARCEL  
**YEAR BUILT :** 0 **SQUARE FEET :** 0 **STYLE CODE :**  
**BEDROOMS :** 0 **BATHROOMS :** 0 **RESTROOMS :** 0 **BASEMENT :** N **GARAGE :** N  
**EXTERIOR TYPE :** **QUALITY GRADE :** 0 **IMPVMT. VALUE :** \$0  
**A/C :** **FIREPLACE :**

**Record No.:** 60 BUILDING KEY NUMBER : 21159472 001  
**PARCEL-ID :** 21159472 NEIGHBORHOOD CODE : 21129 ZONING CLASS : R3  
**OWNER'S NAME :** ELLER SCOTT D ANDREA HOLLADAY ELLER (H/W)  
**MAILING ADDRESS :** 7206 REA CROFT DR  
**CITY :** CHARLOTTE **STATE :** NC **ZIP CODE :** 28226

**PROPERTY LOCATION :** 7206 REA CROFT DR  
**LEGAL DESC. :** L43 M31-319 **DEED BK,PG & DATE :** 12515 /124 2001-08-01  
**ACREAGE :** 0.000 **SALE PRICE :** \$288,000 **QUALIFIED SALE (Y/N) :** Y  
**LAND VALUE :** \$40,000 **IMPVMTS VALUE :** \$0 **TOTAL VALUE :** \$40,000

**LAND-USE TYPE :** VACANT **BUILDING TYPE :** NEW PARCEL  
**YEAR BUILT :** 0 **SQUARE FEET :** 0 **STYLE CODE :**  
**BEDROOMS :** 0 **BATHROOMS :** 0 **RESTROOMS :** 0 **BASEMENT :** N **GARAGE :** N  
**EXTERIOR TYPE :** **QUALITY GRADE :** 0 **IMPVMT. VALUE :** \$0  
**A/C :** **FIREPLACE :**

NOTE: This data is prepared for the purposes of revaluation, assessing & determining ownership of real property & is compiled from recorded deeds, plats, tax maps & other public records & data. Users of this data are hereby notified that the aforementioned public information sources should be consulted for verification. Mecklenburg County assumes no legal responsibility for the information herein.





# MECKLENBURG COUNTY, NC

DATE PRINTED 4/1/02

## GIS PUBLIC ACCESS SYSTEM REPORT

Note : Records are sorted in Parcel Number order.

PAGE : 21

<b>Record No.:</b>	<b>61</b>	<b>BUILDING KEY NUMBER :</b>	21159473 001
<b>PARCEL-ID :</b>	21159473	<b>NEIGHBORHOOD CODE :</b>	21129
<b>OWNER'S NAME :</b>	CONGLETON THOMAS R	<b>ZONING CLASS :</b>	R3
<b>MAILING ADDRESS :</b>	7136 REA CROFT DR		
<b>CITY :</b>	CHARLOTTE	<b>STATE :</b>	NC
		<b>ZIP CODE :</b>	28226
<b>PROPERTY LOCATION :</b>	7136 REA CROFT		DR
<b>LEGAL DESC. :</b>	L44 M31-319	<b>DEED BK,PG &amp; DATE :</b>	11726 /493 2000-11-17
<b>ACREAGE :</b>	0.000	<b>SALE PRICE :</b>	\$293,000
		<b>QUALIFIED SALE (Y/N) :</b>	Y
<b>LAND VALUE :</b>	\$40,000	<b>IMPVMTS VALUE :</b>	\$189,750
		<b>TOTAL VALUE :</b>	\$229,750
<b>LAND-USE TYPE :</b>	SINGLE FAMILY	<b>BUILDING TYPE :</b>	SINGLE FAMILY RESIDENTIAL
<b>YEAR BUILT :</b>	2,000	<b>SQUARE FEET :</b>	3,066
		<b>STYLE CODE :</b>	2.0 STORIES
<b>BEDROOMS :</b>	3	<b>BATHROOMS :</b>	2
		<b>RESTROOMS :</b>	0
		<b>BASEMENT :</b>	N
		<b>GARAGE :</b>	Y
<b>EXTERIOR TYPE :</b>	FACE BRICK	<b>QUALITY GRADE :</b>	2
		<b>IMPVMT. VALUE :</b>	\$187,640
<b>A/C :</b>	CENTRAL	<b>FIREPLACE :</b>	PREFAB
<b>Record No.:</b>	<b>62</b>	<b>BUILDING KEY NUMBER :</b>	21159474 001
<b>PARCEL-ID :</b>	21159474	<b>NEIGHBORHOOD CODE :</b>	21129
<b>OWNER'S NAME :</b>	SMITH H B	<b>ZONING CLASS :</b>	R3
<b>MAILING ADDRESS :</b>	7130 REA CROFT DR		
<b>CITY :</b>	CHARLOTTE	<b>STATE :</b>	NC
		<b>ZIP CODE :</b>	28226
<b>PROPERTY LOCATION :</b>	7130 REA CROFT		DR
<b>LEGAL DESC. :</b>	L45 M31-317	<b>DEED BK,PG &amp; DATE :</b>	11073 /715 2000-02-08
<b>ACREAGE :</b>	0.000	<b>SALE PRICE :</b>	\$0
		<b>QUALIFIED SALE (Y/N) :</b>	
<b>LAND VALUE :</b>	\$40,000	<b>IMPVMTS VALUE :</b>	\$203,720
		<b>TOTAL VALUE :</b>	\$243,720
<b>LAND-USE TYPE :</b>	SINGLE FAMILY	<b>BUILDING TYPE :</b>	SINGLE FAMILY RESIDENTIAL
<b>YEAR BUILT :</b>	2,000	<b>SQUARE FEET :</b>	3,361
		<b>STYLE CODE :</b>	2.0 STORIES
<b>BEDROOMS :</b>	4	<b>BATHROOMS :</b>	2
		<b>RESTROOMS :</b>	0
		<b>BASEMENT :</b>	N
		<b>GARAGE :</b>	Y
<b>EXTERIOR TYPE :</b>	FACE BRICK	<b>QUALITY GRADE :</b>	2
		<b>IMPVMT. VALUE :</b>	\$201,610
<b>A/C :</b>	CENTRAL	<b>FIREPLACE :</b>	PREFAB
<b>Record No.:</b>	<b>63</b>	<b>BUILDING KEY NUMBER :</b>	21159475 001
<b>PARCEL-ID :</b>	21159475	<b>NEIGHBORHOOD CODE :</b>	21129
<b>OWNER'S NAME :</b>	EVERETT MICHAEL G	<b>ZONING CLASS :</b>	R3
<b>MAILING ADDRESS :</b>	7124 REA CROFT DR		
<b>CITY :</b>	CHARLOTTE	<b>STATE :</b>	NC
		<b>ZIP CODE :</b>	28226
<b>PROPERTY LOCATION :</b>	7124 REA CROFT		DR
<b>LEGAL DESC. :</b>	L46 M31-317	<b>DEED BK,PG &amp; DATE :</b>	11803 /279 2000-12-20
<b>ACREAGE :</b>	0.000	<b>SALE PRICE :</b>	\$270,500
		<b>QUALIFIED SALE (Y/N) :</b>	Y
<b>LAND VALUE :</b>	\$40,000	<b>IMPVMTS VALUE :</b>	\$169,710
		<b>TOTAL VALUE :</b>	\$209,710
<b>LAND-USE TYPE :</b>	SINGLE FAMILY	<b>BUILDING TYPE :</b>	SINGLE FAMILY RESIDENTIAL
<b>YEAR BUILT :</b>	2,000	<b>SQUARE FEET :</b>	2,577
		<b>STYLE CODE :</b>	2.0 STORIES
<b>BEDROOMS :</b>	3	<b>BATHROOMS :</b>	2
		<b>RESTROOMS :</b>	0
		<b>BASEMENT :</b>	N
		<b>GARAGE :</b>	Y
<b>EXTERIOR TYPE :</b>	FACE BRICK	<b>QUALITY GRADE :</b>	2
		<b>IMPVMT. VALUE :</b>	\$168,390
<b>A/C :</b>	CENTRAL	<b>FIREPLACE :</b>	PREFAB

NOTE: This data is prepared for the purposes of revaluation, assessing & determining ownership of real property & is compiled from recorded deeds, plats, tax maps & other public records & data. Users of this data are hereby notified that the aforementioned public information sources should be consulted for verification. Mecklenburg County assumes no legal responsibility for the information herein.



# MECKLENBURG COUNTY, NC

DATE PRINTED 4/1/02

## GIS PUBLIC ACCESS SYSTEM REPORT

Note : Records are sorted in Parcel Number order.

PAGE : 22

<b>Record No.:</b> 64	<b>BUILDING KEY NUMBER :</b> 21159476 001		
<b>PARCEL-ID :</b> 21159476	<b>NEIGHBORHOOD CODE :</b> 21129	<b>ZONING CLASS :</b> R3	
<b>OWNER'S NAME :</b> SULLIVAN DAVID MATTHEW		<b>&amp;WF SHARON BIRD</b>	
<b>MAILING ADDRESS :</b> 7120 REA CROFT DR			
<b>CITY :</b> CHARLOTTE	<b>STATE :</b> NC	<b>ZIP CODE :</b> 28226	
<b>PROPERTY LOCATION :</b> 7120 REA CROFT		<b>DR</b>	
<b>LEGAL DESC. :</b> L47 M31-317	<b>DEED BK,PG &amp; DATE :</b> 11036 /396 2000-01-19		
<b>ACREAGE :</b> 0.000	<b>SALE PRICE :</b> \$0	<b>QUALIFIED SALE (Y/N) :</b>	
<b>LAND VALUE :</b> \$40,000	<b>IMPVMTS VALUE:</b> \$191,090	<b>TOTAL VALUE :</b> \$231,090	
<b>LAND-USE TYPE :</b> SINGLE FAMILY	<b>BUILDING TYPE :</b> SINGLE FAMILY RESIDENTIAL		
<b>YEAR BUILT :</b> 1,999	<b>SQUARE FEET :</b> 3,078	<b>STYLE CODE :</b> 2.0 STORIES	
<b>BEDROOMS :</b> 3	<b>BATHROOMS :</b> 2	<b>RESTROOMS :</b> 0	<b>BASEMENT :</b> N <b>GARAGE :</b> Y
<b>EXTERIOR TYPE :</b> FACE BRICK	<b>QUALITY GRADE :</b> 2	<b>IMPVMT. VALUE :</b> \$188,980	
<b>A/C :</b> CENTRAL	<b>FIREPLACE :</b> PREFAB		
<b>Record No.:</b> 65	<b>BUILDING KEY NUMBER :</b> 21159477 001		
<b>PARCEL-ID :</b> 21159477	<b>NEIGHBORHOOD CODE :</b> 21129	<b>ZONING CLASS :</b> R3	
<b>OWNER'S NAME :</b> KIMBALL RAYMOND F III		<b>CAROL B KIMBALL (H/W)</b>	
<b>MAILING ADDRESS :</b> 7114 REA CROFT RD			
<b>CITY :</b> CHARLOTTE	<b>STATE :</b> NC	<b>ZIP CODE :</b> 28226	
<b>PROPERTY LOCATION :</b> 7114 REA CROFT		<b>DR</b>	
<b>LEGAL DESC. :</b> L48 M31-317	<b>DEED BK,PG &amp; DATE :</b> 10587 /483 1999-12-01		
<b>ACREAGE :</b> 0.000	<b>SALE PRICE :</b> \$0	<b>QUALIFIED SALE (Y/N) :</b>	
<b>LAND VALUE :</b> \$40,000	<b>IMPVMTS VALUE:</b> \$163,490	<b>TOTAL VALUE :</b> \$203,490	
<b>LAND-USE TYPE :</b> SINGLE FAMILY	<b>BUILDING TYPE :</b> SINGLE FAMILY RESIDENTIAL		
<b>YEAR BUILT :</b> 1,999	<b>SQUARE FEET :</b> 2,543	<b>STYLE CODE :</b> 2.0 STORIES	
<b>BEDROOMS :</b> 3	<b>BATHROOMS :</b> 2	<b>RESTROOMS :</b> 0	<b>BASEMENT :</b> N <b>GARAGE :</b> Y
<b>EXTERIOR TYPE :</b> FACE BRICK	<b>QUALITY GRADE :</b> 2	<b>IMPVMT. VALUE :</b> \$161,490	
<b>A/C :</b> CENTRAL	<b>FIREPLACE :</b> PREFAB		

NOTE: This data is prepared for the purposes of revaluation, assessing & determining ownership of real property & is compiled from recorded deeds, plats, tax maps & other public records & data. Users of this data are hereby notified that the aforementioned public information sources should be consulted for verification. Mecklenburg County assumes no legal responsibility for the information herein.