



* 0 0 B R E A K 0 0 *



**ADVANCED
IMAGING
SYSTEMS**

www.aisimc.com

An Information
Management Company

City of Charlotte – Planning Dept. Scanning Rezoning Files

Petition # _____

Document type:

- Applications
- Correspondence
- Department Comments
- Land Use Consistency
 - Mail Info
 - Mapping
 - Other
- Site Plans



* 0 0 B R E A K 0 0 *



GIS Real Estate System

Mecklenburg County, NC Geographic Information Systems

[Tax Parcel & Map Sheet Search](#) [Road Name & Intersection Search](#) [Market Analysis Search Menu](#)
[Return to Full Map Extent](#) [How to Use the System](#) [Return to GIS Homepage](#)

Click on Map to Perform Operation

Refresh Map
 Pan
 Zoom In
 Zoom Out
 Zoom Factor
 Identify
 Surveyor's Report

Adjoining Owner's Report within
 Measure
 Label Parcels by:

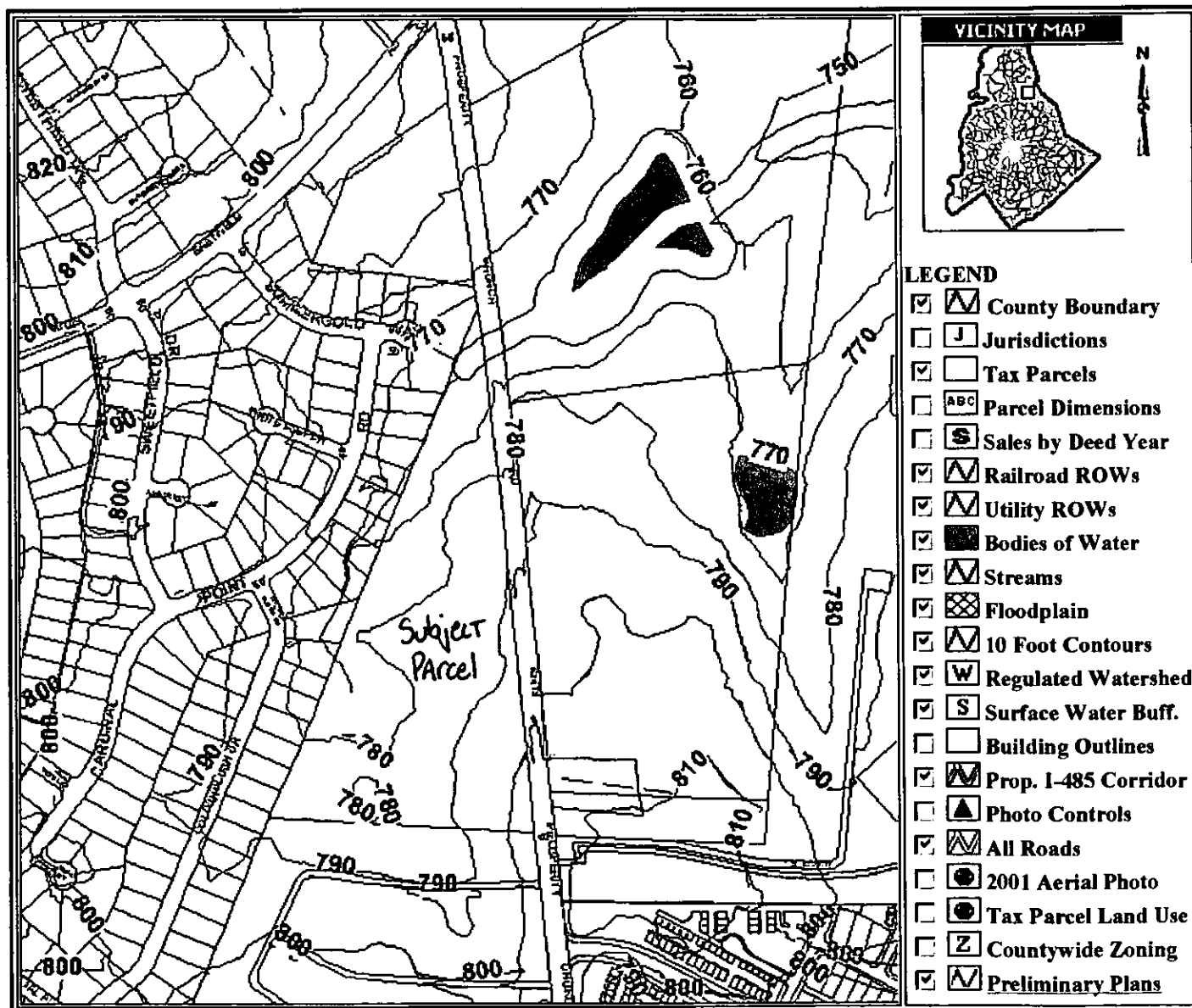

- LEGEND**
- County Boundary
 - Jurisdictions
 - Tax Parcels
 - Parcel Dimensions
 - Sales by Deed Year
 - Railroad ROWs
 - Utility ROWs
 - Bodies of Water
 - Streams
 - Floodplain
 - 10 Foot Contours
 - Regulated Watershed
 - Surface Water Buff.
 - Building Outlines
 - Prop. I-485 Corridor
 - Photo Controls
 - All Roads
 - 2001 Aerial Photo
 - Tax Parcel Land Use
 - Countywide Zoning
 - Preliminary Plans

[Click here to submit questions or comments about the information shown on this page.](#)

Additional Tax Information (Tax Bills, Real and Personal Property, etc.) is available through the:

MECKLENBURG COUNTY, NC GIS PUBLIC ACCESS SYSTEM



Tax Parcel-Id#s Selected: See Tax Information Report for List of Parcel-Id#s

Tax Book & Page Selected: N/A

LEGEND

- County Boundary
- Rivers/Creeks/Streams
- Railroad ROW
- Water Bodies
- Jurisdictions
- County
- Charlotte
- Cornellus
- Davidson
- Huntersville
- Matthews
- Mint Hill
- Pineville

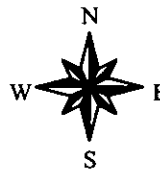

Countywide Inset Map

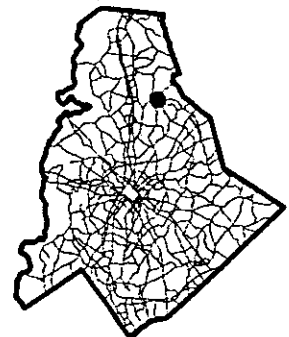

Scale : 1 Inch = 750 Feet

Map Created on Thursday, May 9, 2002 04:02 PM

This map is prepared for the inventory of real property within Mecklenburg County and is compiled from recorded deeds, plats, tax maps, surveys, planimetric maps, and other public records and data. Users of this map are hereby notified that the aforementioned public primary information sources should be consulted for verification. Mecklenburg County and its mapping contractors assume no legal responsibility for the information contained herein.



MECKLENBURG COUNTY, NC

GIS PUBLIC ACCESS SYSTEM REPORT

DATE PRINTED 5/9/02

Note : Records are sorted in Parcel Number order.

PAGE : 1

Record No.: 1 **BUILDING KEY NUMBER:** 02708312 001
PARCEL-ID: 02708312 **NEIGHBORHOOD CODE:** 02734 **ZONING CLASS:** R3
OWNER'S NAME: HUNT MICHAEL L &WF JEANINE E
MAILING ADDRESS: 12529 CARDINAL POINT RD
CITY: CHARLOTTE **STATE:** NC **ZIP CODE:** 28269

PROPERTY LOCATION: 12529 CARDINAL POINT RC
LEGAL DESC.: L12 M28-249 **DEED BK,PG & DATE:** 10421 /446 1999-04-26
ACREAGE: 0.000 **SALE PRICE:** \$144,500 **QUALIFIED SALE (Y/N):** Y
LAND VALUE: \$25,000 **IMPVMTS VALUE:** \$116,540 **TOTAL VALUE:** \$141,540

LAND-USE TYPE: SINGLE FAMILY **BUILDING TYPE:** SINGLE FAMILY RESIDENTIAL
YEAR BUILT: 1,998 **SQUARE FEET:** 1,930 **STYLE CODE:** 1.0 STORY
BEDROOMS: 3 **BATHROOMS:** 2 **RESTROOMS:** 0 **BASEMENT:** N **GARAGE:** Y
EXTERIOR TYPE: ALUMINUM/VINYL SIDING **QUALITY GRADE:** 2 **IMPVMT. VALUE:** \$114,330
A/C: CENTRAL **FIREPLACE:** PREFAB

Record No.: 2 **BUILDING KEY NUMBER:** 02708313 001
PARCEL-ID: 02708313 **NEIGHBORHOOD CODE:** 02734 **ZONING CLASS:** R3
OWNER'S NAME: BRAUNGART CHRISTOPHER A &WF GINA M
MAILING ADDRESS: 12537 CARDINAL POINT RD
CITY: CHARLOTTE **STATE:** NC **ZIP CODE:** 28269

PROPERTY LOCATION: 12537 CARDINAL POINT RC
LEGAL DESC.: L13 M28-249 **DEED BK,PG & DATE:** 10005 /919 1998-10-30
ACREAGE: 0.000 **SALE PRICE:** \$128,500 **QUALIFIED SALE (Y/N):** Y
LAND VALUE: \$25,000 **IMPVMTS VALUE:** \$101,400 **TOTAL VALUE:** \$126,400

LAND-USE TYPE: SINGLE FAMILY **BUILDING TYPE:** SINGLE FAMILY RESIDENTIAL
YEAR BUILT: 1,998 **SQUARE FEET:** 1,615 **STYLE CODE:** 1.0 STORY
BEDROOMS: 3 **BATHROOMS:** 2 **RESTROOMS:** 0 **BASEMENT:** N **GARAGE:** Y
EXTERIOR TYPE: ALUMINUM/VINYL SIDING **QUALITY GRADE:** 2 **IMPVMT. VALUE:** \$101,100
A/C: CENTRAL **FIREPLACE:** PREFAB

Record No.: 3 **BUILDING KEY NUMBER:** 02708314 001
PARCEL-ID: 02708314 **NEIGHBORHOOD CODE:** 02734 **ZONING CLASS:** R3
OWNER'S NAME: WILLIAMSON AARON H &WF JENNIFER S
MAILING ADDRESS: 12601 CARDINAL POINT RD
CITY: CHARLOTTE **STATE:** NC **ZIP CODE:** 28269

PROPERTY LOCATION: 12601 CARDINAL POINT RC
LEGAL DESC.: L14 M28-249 **DEED BK,PG & DATE:** 09745 /090 1998-06-19
ACREAGE: 0.000 **SALE PRICE:** \$121,000 **QUALIFIED SALE (Y/N):** Y
LAND VALUE: \$25,000 **IMPVMTS VALUE:** \$98,510 **TOTAL VALUE:** \$123,510

LAND-USE TYPE: SINGLE FAMILY **BUILDING TYPE:** SINGLE FAMILY RESIDENTIAL
YEAR BUILT: 1,998 **SQUARE FEET:** 1,480 **STYLE CODE:** 1.0 STORY
BEDROOMS: 3 **BATHROOMS:** 2 **RESTROOMS:** 0 **BASEMENT:** N **GARAGE:** Y
EXTERIOR TYPE: ALUMINUM/VINYL SIDING **QUALITY GRADE:** 2 **IMPVMT. VALUE:** \$97,970
A/C: CENTRAL **FIREPLACE:** 1 STY SINGLE

NOTE: This data is prepared for the purposes of revaluation, assessing & determining ownership of real property & is compiled from recorded deeds, plats, tax maps & other public records & data. Users of this data are hereby notified that the aforementioned public information sources should be consulted for verification. Mecklenburg County assumes no legal responsibility for the information herein.



MECKLENBURG COUNTY, NC

DATE PRINTED 5/9/02

GIS PUBLIC ACCESS SYSTEM REPORT

Note : Records are sorted in Parcel Number order.

PAGE : 2

Record No.: 4 **BUILDING KEY NUMBER :** 02708315 001
PARCEL-ID : 02708315 **NEIGHBORHOOD CODE :** 02734 **ZONING CLASS :** R3
OWNER'S NAME : TOWNSEND TODD M &WF CHRISTINE Y
MAILING ADDRESS : 12607 CARDINAL POINT RD
CITY : CHARLOTTE **STATE :** NC **ZIP CODE :** 28269

PROPERTY LOCATION : 12607 **CARDINAL POINT** **RC**
LEGAL DESC. : L15 M28-249 **DEED BK,PG & DATE :** 10861 /017 1999-10-28
ACREAGE : 0.000 **SALE PRICE :** \$145,000 **QUALIFIED SALE (Y/N) :** Y
LAND VALUE : \$25,000 **IMPVMTS VALUE :** \$113,200 **TOTAL VALUE :** \$138,200

LAND-USE TYPE : SINGLE FAMILY **BUILDING TYPE :** SINGLE FAMILY RESIDENTIAL
YEAR BUILT : 1,997 **SQUARE FEET :** 1,944 **STYLE CODE :** 1.0 STORY
BEDROOMS : 3 **BATHROOMS :** 2 **RESTROOMS :** 0 **BASEMENT :** N **GARAGE :** Y
EXTERIOR TYPE : ALUMINUM/VINYL SIDING **QUALITY GRADE :** 2 **IMPVMT. VALUE :** \$112,730
A/C : CENTRAL **FIREPLACE :** PREFAB

Record No.: 5 **BUILDING KEY NUMBER :** 02708316 001
PARCEL-ID : 02708316 **NEIGHBORHOOD CODE :** 02734 **ZONING CLASS :** R3
OWNER'S NAME : TRECO JASON &WF VALERIE L
MAILING ADDRESS : 12615 CARDINAL POINT RD
CITY : CHARLOTTE **STATE :** NC **ZIP CODE :** 28269

PROPERTY LOCATION : 12615 **CARDINAL POINT** **RC**
LEGAL DESC. : L16 M28-249 **DEED BK,PG & DATE :** 09310 /910 1997-10-22
ACREAGE : 0.000 **SALE PRICE :** \$145,500 **QUALIFIED SALE (Y/N) :** Y
LAND VALUE : \$25,000 **IMPVMTS VALUE :** \$111,460 **TOTAL VALUE :** \$136,460

LAND-USE TYPE : SINGLE FAMILY **BUILDING TYPE :** SINGLE FAMILY RESIDENTIAL
YEAR BUILT : 1,997 **SQUARE FEET :** 2,029 **STYLE CODE :** 1.5 STORIES
BEDROOMS : 3 **BATHROOMS :** 2 **RESTROOMS :** 0 **BASEMENT :** N **GARAGE :** Y
EXTERIOR TYPE : ALUMINUM/VINYL SIDING **QUALITY GRADE :** 2 **IMPVMT. VALUE :** \$110,940
A/C : CENTRAL **FIREPLACE :** PREFAB

Record No.: 6 **BUILDING KEY NUMBER :** 02708317 001
PARCEL-ID : 02708317 **NEIGHBORHOOD CODE :** 02734 **ZONING CLASS :** R3
OWNER'S NAME : WATSON ROGER E
MAILING ADDRESS : 12621 CARDINAL POINT RD
CITY : CHARLOTTE **STATE :** NC **ZIP CODE :** 28269

PROPERTY LOCATION : 12621 **CARDINAL POINT** **RC**
LEGAL DESC. : L17 M28-249 **DEED BK,PG & DATE :** 09699 /940 1998-05-28
ACREAGE : 0.000 **SALE PRICE :** \$143,500 **QUALIFIED SALE (Y/N) :** Y
LAND VALUE : \$25,000 **IMPVMTS VALUE :** \$114,900 **TOTAL VALUE :** \$139,900

LAND-USE TYPE : SINGLE FAMILY **BUILDING TYPE :** SINGLE FAMILY RESIDENTIAL
YEAR BUILT : 1,998 **SQUARE FEET :** 2,056 **STYLE CODE :** 2.0 STORIES
BEDROOMS : 3 **BATHROOMS :** 2 **RESTROOMS :** 0 **BASEMENT :** N **GARAGE :** Y
EXTERIOR TYPE : ALUMINUM/VINYL SIDING **QUALITY GRADE :** 2 **IMPVMT. VALUE :** \$114,900
A/C : CENTRAL **FIREPLACE :** PREFAB

NOTE: This data is prepared for the purposes of revaluation, assessing & determining ownership of real property & is compiled from recorded deeds, plats, tax maps & other public records & data. Users of this data are hereby notified that the aforementioned public information sources should be consulted for verification. Mecklenburg County assumes no legal responsibility for the information herein.



MECKLENBURG COUNTY, NC

GIS PUBLIC ACCESS SYSTEM REPORT

DATE PRINTED 5/9/02

Note : Records are sorted in Parcel Number order.

PAGE : 3

Record No.:	<u>7</u>	BUILDING KEY NUMBER :	02708318 001
PARCEL-ID :	02708318	NEIGHBORHOOD CODE :	02734
OWNER'S NAME :	WATTS ANGELIA F	ZONING CLASS :	R3
MAILING ADDRESS :	6601 WHITE MIST LN	&HSB WILLIAM M	
CITY :	CHARLOTTE	STATE :	NC
		ZIP CODE :	28269
PROPERTY LOCATION :	6601 WHITE MIST LN		
LEGAL DESC. :	L18 M28-249	DEED BK,PG & DATE :	09945 /022 1998-09-30
ACREAGE :	0.000	SALE PRICE :	\$136,500
		QUALIFIED SALE (Y/N) :	Y
LAND VALUE :	\$25,000	IMPVMTS VALUE :	\$107,300
		TOTAL VALUE :	\$132,300
LAND-USE TYPE :	SINGLE FAMILY	BUILDING TYPE :	SINGLE FAMILY RESIDENTIAL
YEAR BUILT :	1,998	SQUARE FEET :	1,823
		STYLE CODE :	2.0 STORIES
BEDROOMS :	3	BATHROOMS :	2
		RESTROOMS :	0
		BASEMENT :	N
		GARAGE :	Y
EXTERIOR TYPE :	ALUMINUM/VINYL SIDING	QUALITY GRADE :	2
		IMPVMT. VALUE :	\$105,500
A/C :	CENTRAL	FIREPLACE :	PREFAB
Record No.:	<u>8</u>	BUILDING KEY NUMBER :	02708319 001
PARCEL-ID :	02708319	NEIGHBORHOOD CODE :	02734
OWNER'S NAME :	PERROTT JOHN F	ZONING CLASS :	R3
MAILING ADDRESS :	6607 WHITE MIST LN	&WF SANDRA M	
CITY :	CHARLOTTE	STATE :	NC
		ZIP CODE :	28227
PROPERTY LOCATION :	6607 WHITE MIST LN		
LEGAL DESC. :	L19 M28-249	DEED BK,PG & DATE :	11119 /083 2000-03-01
ACREAGE :	0.000	SALE PRICE :	\$133,000
		QUALIFIED SALE (Y/N) :	Y
LAND VALUE :	\$25,000	IMPVMTS VALUE :	\$92,350
		TOTAL VALUE :	\$117,350
LAND-USE TYPE :	SINGLE FAMILY	BUILDING TYPE :	SINGLE FAMILY RESIDENTIAL
YEAR BUILT :	1,997	SQUARE FEET :	1,556
		STYLE CODE :	2.0 STORIES
BEDROOMS :	4	BATHROOMS :	2
		RESTROOMS :	0
		BASEMENT :	N
		GARAGE :	Y
EXTERIOR TYPE :	ALUMINUM/VINYL SIDING	QUALITY GRADE :	2
		IMPVMT. VALUE :	\$91,100
A/C :	CENTRAL	FIREPLACE :	PREFAB
Record No.:	<u>9</u>	BUILDING KEY NUMBER :	02708320 001
PARCEL-ID :	02708320	NEIGHBORHOOD CODE :	02734
OWNER'S NAME :	ACKERMAN GARY D	ZONING CLASS :	R3
MAILING ADDRESS :	6611 WHITE MIST LN	&WF KATHY C	
CITY :	CHARLOTTE	STATE :	NC
		ZIP CODE :	28269
PROPERTY LOCATION :	6611 WHITE MIST LN		
LEGAL DESC. :	L20 M28-249	DEED BK,PG & DATE :	09657 /348 1998-05-04
ACREAGE :	0.000	SALE PRICE :	\$154,000
		QUALIFIED SALE (Y/N) :	Y
LAND VALUE :	\$25,000	IMPVMTS VALUE :	\$118,520
		TOTAL VALUE :	\$143,520
LAND-USE TYPE :	SINGLE FAMILY	BUILDING TYPE :	SINGLE FAMILY RESIDENTIAL
YEAR BUILT :	1,997	SQUARE FEET :	2,242
		STYLE CODE :	2.0 STORIES
BEDROOMS :	3	BATHROOMS :	2
		RESTROOMS :	0
		BASEMENT :	N
		GARAGE :	Y
EXTERIOR TYPE :	ALUMINUM/VINYL SIDING	QUALITY GRADE :	2
		IMPVMT. VALUE :	\$118,230
A/C :	CENTRAL	FIREPLACE :	PREFAB



MECKLENBURG COUNTY, NC

DATE PRINTED 5/9/02

GIS PUBLIC ACCESS SYSTEM REPORT

Note : Records are sorted in Parcel Number order.

PAGE : 4

Record No.: 10 **BUILDING KEY NUMBER :** 02708325 001
PARCEL-ID : 02708325 **NEIGHBORHOOD CODE :** 02734 **ZONING CLASS :** R3
OWNER'S NAME : GWYN ARTHUR J & TONIA L COOK
MAILING ADDRESS : 6610 WHITE MIST LN
CITY : CHARLOTTE **STATE :** NC **ZIP CODE :** 28269

PROPERTY LOCATION : 6610 WHITE MIST LN
LEGAL DESC. : L25 M28-249 **DEED BK,PG & DATE :** 11130 /809 2000-03-06
ACREAGE : 0.000 **SALE PRICE :** \$154,000 **QUALIFIED SALE (Y/N) :** Y
LAND VALUE : \$25,000 **IMPVMTS VALUE :** \$112,030 **TOTAL VALUE :** \$137,030

LAND-USE TYPE : SINGLE FAMILY **BUILDING TYPE :** SINGLE FAMILY RESIDENTIAL
YEAR BUILT : 1,997 **SQUARE FEET :** 1,989 **STYLE CODE :** 1.5 STORIES
BEDROOMS : 3 **BATHROOMS :** 2 **RESTROOMS :** 0 **BASEMENT :** N **GARAGE :** Y
EXTERIOR TYPE : ALUMINUM/VINYL SIDING **QUALITY GRADE :** 2 **IMPVMT. VALUE :** \$110,230
A/C : CENTRAL **FIREPLACE :** PREFAB

Record No.: 11 **BUILDING KEY NUMBER :** 02708326 001
PARCEL-ID : 02708326 **NEIGHBORHOOD CODE :** 02734 **ZONING CLASS :** R3
OWNER'S NAME : SAWYER CHARLES M
MAILING ADDRESS : 12705 CARDINAL POINT RD
CITY : CHARLOTTE **STATE :** NC **ZIP CODE :** 28269

PROPERTY LOCATION : 12705 CARDINAL POINT RC
LEGAL DESC. : L26 M28-249 **DEED BK,PG & DATE :** 09281 /033 1997-09-30
ACREAGE : 0.000 **SALE PRICE :** \$131,000 **QUALIFIED SALE (Y/N) :** Y
LAND VALUE : \$25,000 **IMPVMTS VALUE :** \$97,360 **TOTAL VALUE :** \$122,360

LAND-USE TYPE : SINGLE FAMILY **BUILDING TYPE :** SINGLE FAMILY RESIDENTIAL
YEAR BUILT : 1,997 **SQUARE FEET :** 1,580 **STYLE CODE :** 1.0 STORY
BEDROOMS : 3 **BATHROOMS :** 2 **RESTROOMS :** 0 **BASEMENT :** N **GARAGE :** Y
EXTERIOR TYPE : ALUMINUM/VINYL SIDING **QUALITY GRADE :** 2 **IMPVMT. VALUE :** \$96,800
A/C : CENTRAL **FIREPLACE :** PREFAB

Record No.: 12 **BUILDING KEY NUMBER :** 02708327 001
PARCEL-ID : 02708327 **NEIGHBORHOOD CODE :** 02734 **ZONING CLASS :** R3
OWNER'S NAME : HALE SHAWN K & WF PAULA F
MAILING ADDRESS : 12711 CARDINAL POINT RD
CITY : CHARLOTTE **STATE :** NC **ZIP CODE :** 28269

PROPERTY LOCATION : 12711 CARDINAL POINT RC
LEGAL DESC. : L27 B2 M28-34 **DEED BK,PG & DATE :** 09355 /748 1997-11-17
ACREAGE : 0.000 **SALE PRICE :** \$123,000 **QUALIFIED SALE (Y/N) :** Y
LAND VALUE : \$25,000 **IMPVMTS VALUE :** \$91,280 **TOTAL VALUE :** \$116,280

LAND-USE TYPE : SINGLE FAMILY **BUILDING TYPE :** SINGLE FAMILY RESIDENTIAL
YEAR BUILT : 1,997 **SQUARE FEET :** 1,532 **STYLE CODE :** 2.0 STORIES
BEDROOMS : 3 **BATHROOMS :** 2 **RESTROOMS :** 0 **BASEMENT :** N **GARAGE :** Y
EXTERIOR TYPE : ALUMINUM/VINYL SIDING **QUALITY GRADE :** 2 **IMPVMT. VALUE :** \$90,990
A/C : CENTRAL **FIREPLACE :** PREFAB

NOTE: This data is prepared for the purposes of revaluation, assessing & determining ownership of real property & is compiled from recorded deeds, plats, tax maps & other public records & data. Users of this data are hereby notified that the aforementioned public information sources should be consulted for verification. Mecklenburg County assumes no legal responsibility for the information herein.



MECKLENBURG COUNTY, NC

DATE PRINTED 5/9/02

GIS PUBLIC ACCESS SYSTEM REPORT

Note : Records are sorted in Parcel Number order.

PAGE : 5

Record No.: 13 **BUILDING KEY NUMBER :** 02708328 001
PARCEL-ID : 02708328 **NEIGHBORHOOD CODE :** 02734 **ZONING CLASS :** R3
OWNER'S NAME : BEST EQUITY VENTURES ORGANIZATION II LLC
MAILING ADDRESS : 100 N TRYON ST # 4150
CITY : CHARLOTTE **STATE :** NC **ZIP CODE :** 282024000

PROPERTY LOCATION : 12717 **CARDINAL POINT** **RE**
LEGAL DESC. : L28 B2 M28-34 **DEED BK,PG & DATE :** 08435 /326 1996-01-22
ACREAGE : 0.000 **SALE PRICE :** \$0 **QUALIFIED SALE (Y/N) :** N
LAND VALUE : \$25,000 **IMPVMTS VALUE :** \$94,580 **TOTAL VALUE :** \$119,580

LAND-USE TYPE : SINGLE FAMILY **BUILDING TYPE :** SINGLE FAMILY RESIDENTIAL
YEAR BUILT : 1,998 **SQUARE FEET :** 1,560 **STYLE CODE :** 2.0 STORIES
BEDROOMS : 3 **BATHROOMS :** 2 **RESTROOMS :** 0 **BASEMENT :** N **GARAGE :** Y
EXTERIOR TYPE : ALUMINUM/VINYL SIDING **QUALITY GRADE :** 2 **IMPVMT. VALUE :** \$94,180
A/C : CENTRAL **FIREPLACE :** PREFAB

Record No.: 14 **BUILDING KEY NUMBER :** 02708329 001
PARCEL-ID : 02708329 **NEIGHBORHOOD CODE :** 02734 **ZONING CLASS :** R3
OWNER'S NAME : KEBLISH MELISSA A
MAILING ADDRESS : 12723 CARDINAL POINT RD
CITY : CHARLOTTE **STATE :** NC **ZIP CODE :** 28269

PROPERTY LOCATION : 12723 **CARDINAL POINT** **RE**
LEGAL DESC. : L29 B2 M28-34 **DEED BK,PG & DATE :** 09900 /204 1998-09-02
ACREAGE : 0.000 **SALE PRICE :** \$126,000 **QUALIFIED SALE (Y/N) :** Y
LAND VALUE : \$25,000 **IMPVMTS VALUE :** \$106,520 **TOTAL VALUE :** \$131,520

LAND-USE TYPE : SINGLE FAMILY **BUILDING TYPE :** SINGLE FAMILY RESIDENTIAL
YEAR BUILT : 1,998 **SQUARE FEET :** 1,736 **STYLE CODE :** 2.0 STORIES
BEDROOMS : 3 **BATHROOMS :** 2 **RESTROOMS :** 0 **BASEMENT :** N **GARAGE :** Y
EXTERIOR TYPE : ALUMINUM/VINYL SIDING **QUALITY GRADE :** 2 **IMPVMT. VALUE :** \$102,560
A/C : CENTRAL **FIREPLACE :** PREFAB

Record No.: 15 **BUILDING KEY NUMBER :** 02708330 001
PARCEL-ID : 02708330 **NEIGHBORHOOD CODE :** 02734 **ZONING CLASS :** R3
OWNER'S NAME : WILSON DEWEY W &WF VIRGINIA R
MAILING ADDRESS : 6731 SUMMERGOLD WAY
CITY : CHARLOTTE **STATE :** NC **ZIP CODE :** 282693197

PROPERTY LOCATION : 6731 **SUMMERGOLD** **W**
LEGAL DESC. : L30 B3 M28-919 **DEED BK,PG & DATE :** 09659 /392 1998-05-04
ACREAGE : 0.000 **SALE PRICE :** \$141,000 **QUALIFIED SALE (Y/N) :** Y
LAND VALUE : \$25,000 **IMPVMTS VALUE :** \$117,170 **TOTAL VALUE :** \$142,170

LAND-USE TYPE : SINGLE FAMILY **BUILDING TYPE :** SINGLE FAMILY RESIDENTIAL
YEAR BUILT : 1,998 **SQUARE FEET :** 1,944 **STYLE CODE :** 1.0 STORY
BEDROOMS : 3 **BATHROOMS :** 2 **RESTROOMS :** 0 **BASEMENT :** N **GARAGE :** Y
EXTERIOR TYPE : ALUMINUM/VINYL SIDING **QUALITY GRADE :** 2 **IMPVMT. VALUE :** \$115,100
A/C : CENTRAL **FIREPLACE :** PREFAB

NOTE: This data is prepared for the purposes of revaluation, assessing & determining ownership of real property & is compiled from recorded deeds, plats, tax maps & other public records & data. Users of this data are hereby notified that the aforementioned public information sources should be consulted for verification. Mecklenburg County assumes no legal responsibility for the information herein.



MECKLENBURG COUNTY, NC
GIS PUBLIC ACCESS SYSTEM REPORT

DATE PRINTED 5/9/02

Note : Records are sorted in Parcel Number order.

PAGE : 6

Record No.: 16 **BUILDING KEY NUMBER:** 02708401 001
PARCEL-ID: 02708401 **NEIGHBORHOOD CODE:** 02734 **ZONING CLASS:** R3
OWNER'S NAME: MCDONALD JAMES R &WF MARGARET B
MAILING ADDRESS: 6621 PROSPERITY CHURCH RD
CITY: CHARLOTTE **STATE:** NC **ZIP CODE:** 28269

PROPERTY LOCATION: 6621 PROSPERITY CHURCH RC
LEGAL DESC.: 6621 PROSPERITY CHURCH **DEED BK,PG & DATE:** 05208 /060 1986-04-18
ACREAGE: 3.000 **SALE PRICE:** \$114,000 **QUALIFIED SALE (Y/N):** Y
LAND VALUE: \$48,480 **IMPVMTS VALUE:** \$184,540 **TOTAL VALUE:** \$233,020

LAND-USE TYPE: SINGLE FAMILY **BUILDING TYPE:** SINGLE FAMILY RESIDENTIAL
YEAR BUILT: 1,936 **SQUARE FEET:** 2,876 **STYLE CODE:** 2.5 STORIES OR MORE
BEDROOMS: 4 **BATHROOMS:** 2 **RESTROOMS:** 0 **BASEMENT:** Y **GARAGE:** Y
EXTERIOR TYPE: ALUMINUM/VINYL SIDING **QUALITY GRADE:** 2 **IMPVMT. VALUE:** \$131,940
A/C: CENTRAL **FIREPLACE:** 1 STY SINGLE

Record No.: 17 **BUILDING KEY NUMBER:** 02708408 001
PARCEL-ID: 02708408 **NEIGHBORHOOD CODE:** 02734 **ZONING CLASS:** R3
OWNER'S NAME: DENNIS MARK A
MAILING ADDRESS: 6724 SUMMERGOLD WAY
CITY: CHARLOTTE **STATE:** NC **ZIP CODE:** 282693197

PROPERTY LOCATION: 6724 SUMMERGOLD W:
LEGAL DESC.: L39 B3 M28-34 **DEED BK,PG & DATE:** 09861 /383 1998-08-14
ACREAGE: 0.000 **SALE PRICE:** \$125,500 **QUALIFIED SALE (Y/N):** Y
LAND VALUE: \$25,000 **IMPVMTS VALUE:** \$99,500 **TOTAL VALUE:** \$124,500

LAND-USE TYPE: SINGLE FAMILY **BUILDING TYPE:** SINGLE FAMILY RESIDENTIAL
YEAR BUILT: 1,998 **SQUARE FEET:** 1,530 **STYLE CODE:** 1.0 STORY
BEDROOMS: 3 **BATHROOMS:** 2 **RESTROOMS:** 0 **BASEMENT:** N **GARAGE:** Y
EXTERIOR TYPE: ALUMINUM/VINYL SIDING **QUALITY GRADE:** 2 **IMPVMT. VALUE:** \$99,200
A/C: CENTRAL **FIREPLACE:** PREFAB

Record No.: 18 **BUILDING KEY NUMBER:** 02708409 001
PARCEL-ID: 02708409 **NEIGHBORHOOD CODE:** 02734 **ZONING CLASS:** R3
OWNER'S NAME: CATHEY DENISE D
MAILING ADDRESS: 6716 SUMMERGOLD WAY
CITY: CHARLOTTE **STATE:** NC **ZIP CODE:** 28269

PROPERTY LOCATION: 6716 SUMMERGOLD W:
LEGAL DESC.: L40 B3 M28-34 **DEED BK,PG & DATE:** 10357 /755 1999-03-30
ACREAGE: 0.000 **SALE PRICE:** \$155,000 **QUALIFIED SALE (Y/N):** Y
LAND VALUE: \$25,000 **IMPVMTS VALUE:** \$125,520 **TOTAL VALUE:** \$150,520

LAND-USE TYPE: SINGLE FAMILY **BUILDING TYPE:** SINGLE FAMILY RESIDENTIAL
YEAR BUILT: 1,998 **SQUARE FEET:** 2,186 **STYLE CODE:** 1.5 STORIES
BEDROOMS: 3 **BATHROOMS:** 2 **RESTROOMS:** 0 **BASEMENT:** N **GARAGE:** Y
EXTERIOR TYPE: ALUMINUM/VINYL SIDING **QUALITY GRADE:** 2 **IMPVMT. VALUE:** \$124,950
A/C: CENTRAL **FIREPLACE:** PREFAB

NOTE: This data is prepared for the purposes of revaluation, assessing & determining ownership of real property & is compiled from recorded deeds, plats, tax maps & other public records & data. Users of this data are hereby notified that the aforementioned public information sources should be consulted for verification. Mecklenburg County assumes no legal responsibility for the information herein.



MECKLENBURG COUNTY, NC

DATE PRINTED 5/9/02

GIS PUBLIC ACCESS SYSTEM REPORT

Note : Records are sorted in Parcel Number order.

PAGE : 7

Record No.: 19 **BUILDING KEY NUMBER :** 02708410 001
PARCEL-ID : 02708410 **NEIGHBORHOOD CODE :** 02734 **ZONING CLASS :** R3
OWNER'S NAME : COOK JOSEPH T &WF BARBARA J
MAILING ADDRESS : 6710 SUMMERGOLD WAY
CITY : CHARLOTTE **STATE :** NC **ZIP CODE :** 282693197

PROPERTY LOCATION : 6710 SUMMERGOLD W:
LEGAL DESC. : L41 B3 M28-34 **DEED BK,PG & DATE :** 09888 /865 1998-08-28
ACREAGE : 0.000 **SALE PRICE :** \$138,500 **QUALIFIED SALE (Y/N) :** Y
LAND VALUE : \$25,000 **IMPVMTS VALUE :** \$110,710 **TOTAL VALUE :** \$135,710

LAND-USE TYPE : SINGLE FAMILY **BUILDING TYPE :** SINGLE FAMILY RESIDENTIAL
YEAR BUILT : 1,998 **SQUARE FEET :** 1,844 **STYLE CODE :** 2.0 STORIES
BEDROOMS : 3 **BATHROOMS :** 2 **RESTROOMS :** 0 **BASEMENT :** N **GARAGE :** Y
EXTERIOR TYPE : ALUMINUM/VINYL SIDING **QUALITY GRADE :** 2 **IMPVMT. VALUE :** \$110,070
A/C : CENTRAL **FIREPLACE :** PREFAB

Record No.: 20 **BUILDING KEY NUMBER :** 02708411 001
PARCEL-ID : 02708411 **NEIGHBORHOOD CODE :** 02734 **ZONING CLASS :** R3
OWNER'S NAME : ROGERS ERIC R &WF KAYE J
MAILING ADDRESS : 6704 SUMMERGOLD WAY
CITY : CHARLOTTE **STATE :** NC **ZIP CODE :** 282693197

PROPERTY LOCATION : 6704 SUMMERGOLD W:
LEGAL DESC. : L42 B3 M28-34 **DEED BK,PG & DATE :** 09851 /756 1998-08-10
ACREAGE : 0.000 **SALE PRICE :** \$132,500 **QUALIFIED SALE (Y/N) :** Y
LAND VALUE : \$25,000 **IMPVMTS VALUE :** \$102,900 **TOTAL VALUE :** \$127,900

LAND-USE TYPE : SINGLE FAMILY **BUILDING TYPE :** SINGLE FAMILY RESIDENTIAL
YEAR BUILT : 1,998 **SQUARE FEET :** 1,615 **STYLE CODE :** 1.0 STORY
BEDROOMS : 3 **BATHROOMS :** 2 **RESTROOMS :** 0 **BASEMENT :** N **GARAGE :** Y
EXTERIOR TYPE : ALUMINUM/VINYL SIDING **QUALITY GRADE :** 2 **IMPVMT. VALUE :** \$101,100
A/C : CENTRAL **FIREPLACE :** PREFAB

Record No.: 21 **BUILDING KEY NUMBER :** 02708412 001
PARCEL-ID : 02708412 **NEIGHBORHOOD CODE :** 02734 **ZONING CLASS :** R3
OWNER'S NAME : GRAMS CARY R &WF ALISON R
MAILING ADDRESS : 6701 SUMMERGOLD WAY
CITY : CHARLOTTE **STATE :** NC **ZIP CODE :** 282693197

PROPERTY LOCATION : 6701 SUMMERGOLD W:
LEGAL DESC. : L43 B3 M28-34 **DEED BK,PG & DATE :** 09866 /675 1998-08-18
ACREAGE : 0.000 **SALE PRICE :** \$134,000 **QUALIFIED SALE (Y/N) :** Y
LAND VALUE : \$25,000 **IMPVMTS VALUE :** \$101,210 **TOTAL VALUE :** \$126,210

LAND-USE TYPE : SINGLE FAMILY **BUILDING TYPE :** SINGLE FAMILY RESIDENTIAL
YEAR BUILT : 1,998 **SQUARE FEET :** 1,722 **STYLE CODE :** 2.0 STORIES
BEDROOMS : 3 **BATHROOMS :** 2 **RESTROOMS :** 0 **BASEMENT :** N **GARAGE :** Y
EXTERIOR TYPE : ALUMINUM/VINYL SIDING **QUALITY GRADE :** 2 **IMPVMT. VALUE :** \$100,910
A/C : CENTRAL **FIREPLACE :** PREFAB

NOTE: This data is prepared for the purposes of revaluation, assessing & determining ownership of real property & is compiled from recorded deeds, plats, tax maps & other public records & data. Users of this data are hereby notified that the aforementioned public information sources should be consulted for verification. Mecklenburg County assumes no legal responsibility for the information herein.



MECKLENBURG COUNTY, NC

GIS PUBLIC ACCESS SYSTEM REPORT

DATE PRINTED 5/9/02

Note : Records are sorted in Parcel Number order.

PAGE : 8

Record No.: 22 **BUILDING KEY NUMBER :** 02708413 001
PARCEL-ID : 02708413 **NEIGHBORHOOD CODE :** 02734 **ZONING CLASS :** R3
OWNER'S NAME : FESSTTE FRANK ANDREW & DAWN LOUISE ZADAREKY
MAILING ADDRESS : 6705 SUMMERGOLD WAY
CITY : CHARLOTTE **STATE :** NC **ZIP CODE :** 282693197

PROPERTY LOCATION : 6705 SUMMERGOLD W
LEGAL DESC. : L44 B3 M28-34 **DEED BK,PG & DATE :** 09927 /543 1998-09-21
ACREAGE : 0.000 **SALE PRICE :** \$141,000 **QUALIFIED SALE (Y/N) :** Y
LAND VALUE : \$25,000 **IMPVMTS VALUE :** \$114,330 **TOTAL VALUE :** \$139,330

LAND-USE TYPE : SINGLE FAMILY **BUILDING TYPE :** SINGLE FAMILY RESIDENTIAL
YEAR BUILT : 1,998 **SQUARE FEET :** 1,990 **STYLE CODE :** 2.0 STORIES
BEDROOMS : 3 **BATHROOMS :** 2 **RESTROOMS :** 0 **BASEMENT :** N **GARAGE :** Y
EXTERIOR TYPE : ALUMINUM/VINYL SIDING **QUALITY GRADE :** 2 **IMPVMT. VALUE :** \$112,830
A/C : CENTRAL **FIREPLACE :** PREFAB

Record No.: 23 **BUILDING KEY NUMBER :** 02708414 001
PARCEL-ID : 02708414 **NEIGHBORHOOD CODE :** 02734 **ZONING CLASS :** R3
OWNER'S NAME : GREEN JEROME C & WF VIOLA B
MAILING ADDRESS : 6711 SUMMERGOLD WAY
CITY : CHARLOTTE **STATE :** NC **ZIP CODE :** 282693197

PROPERTY LOCATION : 6711 SUMMERGOLD W
LEGAL DESC. : L45 B3 M28-34 **DEED BK,PG & DATE :** 09965 /751 1998-10-08
ACREAGE : 0.000 **SALE PRICE :** \$143,500 **QUALIFIED SALE (Y/N) :** Y
LAND VALUE : \$25,000 **IMPVMTS VALUE :** \$116,740 **TOTAL VALUE :** \$141,740

LAND-USE TYPE : SINGLE FAMILY **BUILDING TYPE :** SINGLE FAMILY RESIDENTIAL
YEAR BUILT : 1,998 **SQUARE FEET :** 1,866 **STYLE CODE :** 1.0 STORY
BEDROOMS : 3 **BATHROOMS :** 2 **RESTROOMS :** 0 **BASEMENT :** N **GARAGE :** Y
EXTERIOR TYPE : ALUMINUM/VINYL SIDING **QUALITY GRADE :** 2 **IMPVMT. VALUE :** \$114,900
A/C : CENTRAL **FIREPLACE :** PREFAB

Record No.: 24 **BUILDING KEY NUMBER :** 02708415 001
PARCEL-ID : 02708415 **NEIGHBORHOOD CODE :** 02734 **ZONING CLASS :** R3
OWNER'S NAME : DUNN ROBERT L & FRANCINE E TAYLOR
MAILING ADDRESS : 12716 CARDINAL POINT RD
CITY : CHARLOTTE **STATE :** NC **ZIP CODE :** 28269

PROPERTY LOCATION : 12716 CARDINAL POINT RE
LEGAL DESC. : L46 B3 M28-34 **DEED BK,PG & DATE :** 09297 /629 1997-10-13
ACREAGE : 0.000 **SALE PRICE :** \$139,500 **QUALIFIED SALE (Y/N) :** Y
LAND VALUE : \$25,000 **IMPVMTS VALUE :** \$111,460 **TOTAL VALUE :** \$136,460

LAND-USE TYPE : SINGLE FAMILY **BUILDING TYPE :** SINGLE FAMILY RESIDENTIAL
YEAR BUILT : 1,997 **SQUARE FEET :** 2,029 **STYLE CODE :** 1.5 STORIES
BEDROOMS : 3 **BATHROOMS :** 2 **RESTROOMS :** 0 **BASEMENT :** N **GARAGE :** Y
EXTERIOR TYPE : ALUMINUM/VINYL SIDING **QUALITY GRADE :** 2 **IMPVMT. VALUE :** \$110,940
A/C : CENTRAL **FIREPLACE :** PREFAB



MECKLENBURG COUNTY, NC

GIS PUBLIC ACCESS SYSTEM REPORT

DATE PRINTED 5/9/02

Note : Records are sorted in Parcel Number order.

PAGE : 9

Record No.: 25 **BUILDING KEY NUMBER :** 02708416 001
PARCEL-ID : 02708416 **NEIGHBORHOOD CODE :** 02734 **ZONING CLASS :** R3
OWNER'S NAME : CARR MONALITA M
MAILING ADDRESS : 12710 CARDINAL POINT RD
CITY : CHARLOTTE **STATE :** NC **ZIP CODE :** 28269

PROPERTY LOCATION : 12710 **CARDINAL POINT** **RE**
LEGAL DESC. : L47 B3 M28-34 **DEED BK,PG & DATE :** 10102 /913 1998-12-10
ACREAGE : 0.000 **SALE PRICE :** \$140,000 **QUALIFIED SALE (Y/N) :** Y
LAND VALUE : \$25,000 **IMPVMTS VALUE :** \$115,670 **TOTAL VALUE :** \$140,670

LAND-USE TYPE : SINGLE FAMILY **BUILDING TYPE :** SINGLE FAMILY RESIDENTIAL
YEAR BUILT : 1,998 **SQUARE FEET :** 1,944 **STYLE CODE :** 1.0 STORY
BEDROOMS : 3 **BATHROOMS :** 2 **RESTROOMS :** 0 **BASEMENT :** N **GARAGE :** Y
EXTERIOR TYPE : ALUMINUM/VINYL SIDING **QUALITY GRADE :** 2 **IMPVMT. VALUE :** \$115,100
A/C : CENTRAL **FIREPLACE :** PREFAB

Record No.: 26 **BUILDING KEY NUMBER :** 02708417 001
PARCEL-ID : 02708417 **NEIGHBORHOOD CODE :** 02734 **ZONING CLASS :** R3
OWNER'S NAME : ADKINS TAMMY E
MAILING ADDRESS : 12704 CARDINAL POINT RD
CITY : CHARLOTTE **STATE :** NC **ZIP CODE :** 28269

PROPERTY LOCATION : 12704 **CARDINAL POINT** **RE**
LEGAL DESC. : L48 M28-249 **DEED BK,PG & DATE :** 11163 /637 2000-03-23
ACREAGE : 0.000 **SALE PRICE :** \$131,500 **QUALIFIED SALE (Y/N) :** Y
LAND VALUE : \$25,000 **IMPVMTS VALUE :** \$93,100 **TOTAL VALUE :** \$118,100

LAND-USE TYPE : SINGLE FAMILY **BUILDING TYPE :** SINGLE FAMILY RESIDENTIAL
YEAR BUILT : 1,997 **SQUARE FEET :** 1,591 **STYLE CODE :** 2.0 STORIES
BEDROOMS : 3 **BATHROOMS :** 2 **RESTROOMS :** 0 **BASEMENT :** N **GARAGE :** Y
EXTERIOR TYPE : ALUMINUM/VINYL SIDING **QUALITY GRADE :** 2 **IMPVMT. VALUE :** \$92,810
A/C : CENTRAL **FIREPLACE :** PREFAB

Record No.: 27 **BUILDING KEY NUMBER :** 02708418 001
PARCEL-ID : 02708418 **NEIGHBORHOOD CODE :** 02734 **ZONING CLASS :** R3
OWNER'S NAME : MCINTOSH DAVID M &WF ANNA M
MAILING ADDRESS : 12640 CARDINAL POINT RD
CITY : CHARLOTTE **STATE :** NC **ZIP CODE :** 28269

PROPERTY LOCATION : 12640 **CARDINAL POINT** **RE**
LEGAL DESC. : L49 M28-249 **DEED BK,PG & DATE :** 10938 /482 1999-12-01
ACREAGE : 0.000 **SALE PRICE :** \$130,500 **QUALIFIED SALE (Y/N) :** Y
LAND VALUE : \$25,000 **IMPVMTS VALUE :** \$102,850 **TOTAL VALUE :** \$127,850

LAND-USE TYPE : SINGLE FAMILY **BUILDING TYPE :** SINGLE FAMILY RESIDENTIAL
YEAR BUILT : 1,999 **SQUARE FEET :** 1,659 **STYLE CODE :** 2.0 STORIES
BEDROOMS : 3 **BATHROOMS :** 2 **RESTROOMS :** 0 **BASEMENT :** N **GARAGE :** Y
EXTERIOR TYPE : ALUMINUM/VINYL SIDING **QUALITY GRADE :** 2 **IMPVMT. VALUE :** \$101,270
A/C : CENTRAL **FIREPLACE :** PREFAB

NOTE: This data is prepared for the purposes of revaluation, assessing & determining ownership of real property & is compiled from recorded deeds, plats, tax maps & other public records & data. Users of this data are hereby notified that the aforementioned public information sources should be consulted for verification. Mecklenburg County assumes no legal responsibility for the information herein.



MECKLENBURG COUNTY, NC

DATE PRINTED 5/9/02

GIS PUBLIC ACCESS SYSTEM REPORT

Note : Records are sorted in Parcel Number order.

PAGE : 10

Record No.: 28 **BUILDING KEY NUMBER:** 02708419 001
PARCEL-ID: 02708419 **NEIGHBORHOOD CODE:** 02734 **ZONING CLASS:** R3
OWNER'S NAME: MCMILLEN JENNIFER D & KHRISTA K MESSINGER
MAILING ADDRESS: 12634 CARDINAL POINT RD
CITY: CHARLOTTE **STATE:** NC **ZIP CODE:** 28269

PROPERTY LOCATION: 12634 CARDINAL POINT RC
LEGAL DESC.: L50 M28-249 **DEED BK,PG & DATE:** 10745 /334 1999-09-07
ACREAGE: 0.000 **SALE PRICE:** \$0 **QUALIFIED SALE (Y/N):** N
LAND VALUE: \$25,000 **IMPVMTS VALUE:** \$99,740 **TOTAL VALUE:** \$124,740

LAND-USE TYPE: SINGLE FAMILY **BUILDING TYPE:** SINGLE FAMILY RESIDENTIAL
YEAR BUILT: 1,999 **SQUARE FEET:** 1,606 **STYLE CODE:** 2.0 STORIES
BEDROOMS: 3 **BATHROOMS:** 2 **RESTROOMS:** 0 **BASEMENT:** N **GARAGE:** Y
EXTERIOR TYPE: ALUMINUM/VINYL SIDING **QUALITY GRADE:** 2 **IMPVMT. VALUE:** \$98,420
A/C: CENTRAL **FIREPLACE:** PREFAB

Record No.: 29 **BUILDING KEY NUMBER:** 02708420 001
PARCEL-ID: 02708420 **NEIGHBORHOOD CODE:** 02734 **ZONING CLASS:** R3
OWNER'S NAME: JONES WESLEY A & WF CYNTHIA L
MAILING ADDRESS: 12626 CARDINAL POINT RD
CITY: CHARLOTTE **STATE:** NC **ZIP CODE:** 28269

PROPERTY LOCATION: 12626 CARDINAL POINT RC
LEGAL DESC.: L51 M28-249 **DEED BK,PG & DATE:** 10423 /461 1999-04-27
ACREAGE: 0.000 **SALE PRICE:** \$131,500 **QUALIFIED SALE (Y/N):** Y
LAND VALUE: \$25,000 **IMPVMTS VALUE:** \$102,490 **TOTAL VALUE:** \$127,490

LAND-USE TYPE: SINGLE FAMILY **BUILDING TYPE:** SINGLE FAMILY RESIDENTIAL
YEAR BUILT: 1,999 **SQUARE FEET:** 1,647 **STYLE CODE:** 2.0 STORIES
BEDROOMS: 3 **BATHROOMS:** 2 **RESTROOMS:** 0 **BASEMENT:** N **GARAGE:** Y
EXTERIOR TYPE: ALUMINUM/VINYL SIDING **QUALITY GRADE:** 2 **IMPVMT. VALUE:** \$100,910
A/C: CENTRAL **FIREPLACE:** PREFAB

Record No.: 30 **BUILDING KEY NUMBER:** 02708421 001
PARCEL-ID: 02708421 **NEIGHBORHOOD CODE:** 02734 **ZONING CLASS:** R3
OWNER'S NAME: TOMPKINS KATHRYN
MAILING ADDRESS: 12620 CARDINAL POINT RD
CITY: CHARLOTTE **STATE:** NC **ZIP CODE:** 282695111

PROPERTY LOCATION: 12620 CARDINAL POINT RC
LEGAL DESC.: L52 M28-249 **DEED BK,PG & DATE:** 12121 /664 2001-04-17
ACREAGE: 0.000 **SALE PRICE:** \$134,000 **QUALIFIED SALE (Y/N):** Y
LAND VALUE: \$25,000 **IMPVMTS VALUE:** \$102,780 **TOTAL VALUE:** \$127,780

LAND-USE TYPE: SINGLE FAMILY **BUILDING TYPE:** SINGLE FAMILY RESIDENTIAL
YEAR BUILT: 1,998 **SQUARE FEET:** 1,530 **STYLE CODE:** 1.0 STORY
BEDROOMS: 3 **BATHROOMS:** 2 **RESTROOMS:** 0 **BASEMENT:** N **GARAGE:** Y
EXTERIOR TYPE: ALUMINUM/VINYL SIDING **QUALITY GRADE:** 2 **IMPVMT. VALUE:** \$102,480
A/C: CENTRAL **FIREPLACE:** PREFAB

NOTE: This data is prepared for the purposes of revaluation, assessing & determining ownership of real property & is compiled from recorded deeds, plats, tax maps & other public records & data. Users of this data are hereby notified that the aforementioned public information sources should be consulted for verification. Mecklenburg County assumes no legal responsibility for the information herein.



MECKLENBURG COUNTY, NC

GIS PUBLIC ACCESS SYSTEM REPORT

DATE PRINTED 5/9/02

Note : Records are sorted in Parcel Number order.

PAGE : 11

Record No.: 31 **BUILDING KEY NUMBER :** 02708422 001
PARCEL-ID : 02708422 **NEIGHBORHOOD CODE :** 02734 **ZONING CLASS :** R3
OWNER'S NAME : ADAMS THOMAS PRESTON &WF SUSAN ANNETTE
MAILING ADDRESS : 12616 CARDINAL POINT RD
CITY : CHARLOTTE **STATE :** NC **ZIP CODE :** 28269

PROPERTY LOCATION : 12616 **CARDINAL POINT** **RC**
LEGAL DESC. : L53 M28-249 **DEED BK,PG & DATE :** 09635 /871 1998-04-24
ACREAGE : 0.000 **SALE PRICE :** \$124,000 **QUALIFIED SALE (Y/N) :** Y
LAND VALUE : \$25,000 **IMPVMTS VALUE :** \$98,240 **TOTAL VALUE :** \$123,240

LAND-USE TYPE : SINGLE FAMILY **BUILDING TYPE :** SINGLE FAMILY RESIDENTIAL
YEAR BUILT : 1,998 **SQUARE FEET :** 1,530 **STYLE CODE :** 1.0 STORY
BEDROOMS : 3 **BATHROOMS :** 2 **RESTROOMS :** 0 **BASEMENT :** N **GARAGE :** Y
EXTERIOR TYPE : ALUMINUM/VINYL SIDING **QUALITY GRADE :** 2 **IMPVMT. VALUE :** \$97,940
A/C : CENTRAL **FIREPLACE :** PREFAB

Record No.: 32 **BUILDING KEY NUMBER :** 02708423 001
PARCEL-ID : 02708423 **NEIGHBORHOOD CODE :** 02734 **ZONING CLASS :** R3
OWNER'S NAME : BEATS CHARLES D &WF KELLY M
MAILING ADDRESS : 12608 CARDINAL POINT RD
CITY : CHARLOTTE **STATE :** NC **ZIP CODE :** 28269

PROPERTY LOCATION : 12608 **CARDINAL POINT** **RC**
LEGAL DESC. : L54 M28-249 **DEED BK,PG & DATE :** 09299 /007 1997-10-14
ACREAGE : 0.000 **SALE PRICE :** \$140,500 **QUALIFIED SALE (Y/N) :** Y
LAND VALUE : \$25,000 **IMPVMTS VALUE :** \$111,460 **TOTAL VALUE :** \$136,460

LAND-USE TYPE : SINGLE FAMILY **BUILDING TYPE :** SINGLE FAMILY RESIDENTIAL
YEAR BUILT : 1,997 **SQUARE FEET :** 2,029 **STYLE CODE :** 1.5 STORIES
BEDROOMS : 3 **BATHROOMS :** 2 **RESTROOMS :** 0 **BASEMENT :** N **GARAGE :** Y
EXTERIOR TYPE : ALUMINUM/VINYL SIDING **QUALITY GRADE :** 2 **IMPVMT. VALUE :** \$110,940
A/C : CENTRAL **FIREPLACE :** PREFAB

Record No.: 33 **BUILDING KEY NUMBER :** 02708424 001
PARCEL-ID : 02708424 **NEIGHBORHOOD CODE :** 02734 **ZONING CLASS :** R3
OWNER'S NAME : MCCOY JAMES JR
MAILING ADDRESS : 12604 CARDINAL POINT RD
CITY : CHARLOTTE **STATE :** NC **ZIP CODE :** 28269

PROPERTY LOCATION : 12604 **CARDINAL POINT** **RC**
LEGAL DESC. : L55 M28-249 **DEED BK,PG & DATE :** 12777 /537 2001-10-18
ACREAGE : 0.000 **SALE PRICE :** \$0 **QUALIFIED SALE (Y/N) :** Y
LAND VALUE : \$25,000 **IMPVMTS VALUE :** \$90,140 **TOTAL VALUE :** \$115,140

LAND-USE TYPE : SINGLE FAMILY **BUILDING TYPE :** SINGLE FAMILY RESIDENTIAL
YEAR BUILT : 1,997 **SQUARE FEET :** 1,556 **STYLE CODE :** 2.0 STORIES
BEDROOMS : 3 **BATHROOMS :** 2 **RESTROOMS :** 0 **BASEMENT :** N **GARAGE :** Y
EXTERIOR TYPE : ALUMINUM/VINYL SIDING **QUALITY GRADE :** 2 **IMPVMT. VALUE :** \$89,850
A/C : CENTRAL **FIREPLACE :** PREFAB

NOTE: This data is prepared for the purposes of revaluation, assessing & determining ownership of real property & is compiled from recorded deeds, plats, tax maps & other public records & data. Users of this data are hereby notified that the aforementioned public information sources should be consulted for verification. Mecklenburg County assumes no legal responsibility for the information herein.



MECKLENBURG COUNTY, NC

DATE PRINTED 5/9/02

GIS PUBLIC ACCESS SYSTEM REPORT

Note : Records are sorted in Parcel Number order.

PAGE : 12

Record No.: 34 **BUILDING KEY NUMBER :** 02708425 001
PARCEL-ID : 02708425 **NEIGHBORHOOD CODE :** 02734 **ZONING CLASS :** R3
OWNER'S NAME : GOODS VINCENT A &WF KATONIA H
MAILING ADDRESS : 6526 GOLDENBLUSH CIR
CITY : CHARLOTTE **STATE :** NC **ZIP CODE :** 282695102

PROPERTY LOCATION : 6526 GOLDENBLUSH CR
LEGAL DESC. : L1 M30-243 **DEED BK,PG & DATE :** 10938 /504 1999-12-01
ACREAGE : 0.000 **SALE PRICE :** \$147,000 **QUALIFIED SALE (Y/N) :** Y
LAND VALUE : \$25,000 **IMPVMTS VALUE :** \$112,550 **TOTAL VALUE :** \$137,550

LAND-USE TYPE : SINGLE FAMILY **BUILDING TYPE :** SINGLE FAMILY RESIDENTIAL
YEAR BUILT : 1,999 **SQUARE FEET :** 1,943 **STYLE CODE :** 2.0 STORIES
BEDROOMS : 3 **BATHROOMS :** 2 **RESTROOMS :** 0 **BASEMENT :** N **GARAGE :** Y
EXTERIOR TYPE : ALUMINUM/VINYL SIDING **QUALITY GRADE :** 2 **IMPVMT. VALUE :** \$111,230
A/C : CENTRAL **FIREPLACE :** PREFAB

Record No.: 35 **BUILDING KEY NUMBER :** 02708426 001
PARCEL-ID : 02708426 **NEIGHBORHOOD CODE :** 02734 **ZONING CLASS :** R3
OWNER'S NAME : STRICKER MARTIN THOMAS
MAILING ADDRESS : 11833 MOURNING DOVE LN
CITY : CHARLOTTE **STATE :** NC **ZIP CODE :** 282690675

PROPERTY LOCATION : 6522 GOLDENBLUSH CR
LEGAL DESC. : L2 M30-243 **DEED BK,PG & DATE :** 11008 /288 1999-12-31
ACREAGE : 0.000 **SALE PRICE :** \$122,500 **QUALIFIED SALE (Y/N) :** Y
LAND VALUE : \$25,000 **IMPVMTS VALUE :** \$88,900 **TOTAL VALUE :** \$113,900

LAND-USE TYPE : SINGLE FAMILY **BUILDING TYPE :** SINGLE FAMILY RESIDENTIAL
YEAR BUILT : 1,999 **SQUARE FEET :** 1,357 **STYLE CODE :** 2.0 STORIES
BEDROOMS : 3 **BATHROOMS :** 2 **RESTROOMS :** 0 **BASEMENT :** N **GARAGE :** Y
EXTERIOR TYPE : ALUMINUM/VINYL SIDING **QUALITY GRADE :** 2 **IMPVMT. VALUE :** \$88,900
A/C : CENTRAL **FIREPLACE :** PREFAB

Record No.: 36 **BUILDING KEY NUMBER :** 02708427 001
PARCEL-ID : 02708427 **NEIGHBORHOOD CODE :** 02734 **ZONING CLASS :** R3
OWNER'S NAME : PFEIFFER ROBERT W &WF SUSAN V
MAILING ADDRESS : 6518 GOLDENBLUSH CIR
CITY : CHARLOTTE **STATE :** NC **ZIP CODE :** 282695102

PROPERTY LOCATION : 6518 GOLDENBLUSH CR
LEGAL DESC. : L3 M30-243 **DEED BK,PG & DATE :** 10592 /053 1999-07-01
ACREAGE : 0.000 **SALE PRICE :** \$146,000 **QUALIFIED SALE (Y/N) :** Y
LAND VALUE : \$25,000 **IMPVMTS VALUE :** \$103,710 **TOTAL VALUE :** \$128,710

LAND-USE TYPE : SINGLE FAMILY **BUILDING TYPE :** SINGLE FAMILY RESIDENTIAL
YEAR BUILT : 1,999 **SQUARE FEET :** 1,836 **STYLE CODE :** 2.0 STORIES
BEDROOMS : 3 **BATHROOMS :** 2 **RESTROOMS :** 0 **BASEMENT :** N **GARAGE :** Y
EXTERIOR TYPE : ALUMINUM/VINYL SIDING **QUALITY GRADE :** 2 **IMPVMT. VALUE :** \$103,410
A/C : CENTRAL **FIREPLACE :** PREFAB



MECKLENBURG COUNTY, NC
GIS PUBLIC ACCESS SYSTEM REPORT

DATE PRINTED 5/9/02

Note : Records are sorted in Parcel Number order.

PAGE : 13

Record No.: 37 **BUILDING KEY NUMBER :** 02708428 001
PARCEL-ID : 02708428 **NEIGHBORHOOD CODE :** 02734 **ZONING CLASS :** R3
OWNER'S NAME : SHINN ROBIN
MAILING ADDRESS : 6512 GOLDENBLUSH CIR
CITY : CHARLOTTE **STATE :** NC **ZIP CODE :** 282695102

PROPERTY LOCATION : 6512 GOLDENBLUSH CR
LEGAL DESC. : L4 M30-243 **DEED BK,PG & DATE :** 10922 /258 1999-11-23
ACREAGE : 0.000 **SALE PRICE :** \$161,000 **QUALIFIED SALE (Y/N) :** Y
LAND VALUE : \$25,000 **IMPVMTS VALUE :** \$114,900 **TOTAL VALUE :** \$139,900

LAND-USE TYPE : SINGLE FAMILY **BUILDING TYPE :** SINGLE FAMILY RESIDENTIAL
YEAR BUILT : 1,999 **SQUARE FEET :** 1,924 **STYLE CODE :** 1.0 STORY
BEDROOMS : 3 **BATHROOMS :** 2 **RESTROOMS :** 0 **BASEMENT :** N **GARAGE :** Y
EXTERIOR TYPE : ALUMINUM/VINYL SIDING **QUALITY GRADE :** 2 **IMPVMT. VALUE :** \$114,330
A/C : CENTRAL **FIREPLACE :** PREFAB

Record No.: 38 **BUILDING KEY NUMBER :** 02708429 001
PARCEL-ID : 02708429 **NEIGHBORHOOD CODE :** 02734 **ZONING CLASS :** R3
OWNER'S NAME : JONES MONA
MAILING ADDRESS : 6506 GOLDENBUSH CR
CITY : CHARLOTTE **STATE :** NC **ZIP CODE :** 28269

PROPERTY LOCATION : 6506 GOLDENBLUSH CR
LEGAL DESC. : L5 M30-243 **DEED BK,PG & DATE :** 11579 /067 2000-09-18
ACREAGE : 0.000 **SALE PRICE :** \$162,500 **QUALIFIED SALE (Y/N) :** Y
LAND VALUE : \$25,000 **IMPVMTS VALUE :** \$120,360 **TOTAL VALUE :** \$145,360

LAND-USE TYPE : SINGLE FAMILY **BUILDING TYPE :** SINGLE FAMILY RESIDENTIAL
YEAR BUILT : 2,000 **SQUARE FEET :** 2,226 **STYLE CODE :** 2.0 STORIES
BEDROOMS : 4 **BATHROOMS :** 2 **RESTROOMS :** 0 **BASEMENT :** N **GARAGE :** Y
EXTERIOR TYPE : ALUMINUM/VINYL SIDING **QUALITY GRADE :** 2 **IMPVMT. VALUE :** \$120,360
A/C : CENTRAL **FIREPLACE :** PREFAB

Record No.: 39 **BUILDING KEY NUMBER :** 02708430 001
PARCEL-ID : 02708430 **NEIGHBORHOOD CODE :** 02734 **ZONING CLASS :** R3
OWNER'S NAME : MALLETT JOHN L & WF ROSA J
MAILING ADDRESS : 6500 GOLDENBLUSH CIR
CITY : CHARLOTTE **STATE :** NC **ZIP CODE :** 282695102

PROPERTY LOCATION : 6500 GOLDENBLUSH CR
LEGAL DESC. : L6 M30-243 **DEED BK,PG & DATE :** 11258 /140 2000-05-01
ACREAGE : 0.000 **SALE PRICE :** \$158,000 **QUALIFIED SALE (Y/N) :** Y
LAND VALUE : \$25,000 **IMPVMTS VALUE :** \$113,980 **TOTAL VALUE :** \$138,980

LAND-USE TYPE : SINGLE FAMILY **BUILDING TYPE :** SINGLE FAMILY RESIDENTIAL
YEAR BUILT : 2,000 **SQUARE FEET :** 1,887 **STYLE CODE :** 1.0 STORY
BEDROOMS : 3 **BATHROOMS :** 2 **RESTROOMS :** 0 **BASEMENT :** N **GARAGE :** Y
EXTERIOR TYPE : ALUMINUM/VINYL SIDING **QUALITY GRADE :** 2 **IMPVMT. VALUE :** \$113,410
A/C : CENTRAL **FIREPLACE :** PREFAB

NOTE: This data is prepared for the purposes of revaluation, assessing & determining ownership of real property & is compiled from recorded deeds, plats, tax maps & other public records & data. Users of this data are hereby notified that the aforementioned public information sources should be consulted for verification. Mecklenburg County assumes no legal responsibility for the information herein.



MECKLENBURG COUNTY, NC
GIS PUBLIC ACCESS SYSTEM REPORT

DATE PRINTED 5/9/02

Note : Records are sorted in Parcel Number order.

PAGE : 14

Record No.: 40 **BUILDING KEY NUMBER :** 02708431 001
PARCEL-ID : 02708431 **NEIGHBORHOOD CODE :** 02734 **ZONING CLASS :** R3
OWNER'S NAME : BALLEEN NAKISHA
MAILING ADDRESS : 6438 GOLDENBLUSH CIR
CITY : CHARLOTTE **STATE :** NC **ZIP CODE :** 282695101
PROPERTY LOCATION : 6438 GOLDENBLUSH CR
LEGAL DESC. : L7 M30-243 **DEED BK,PG & DATE :** 11153 /216 2000-03-17
ACREAGE : 0.000 **SALE PRICE :** \$152,000 **QUALIFIED SALE (Y/N) :** Y
LAND VALUE : \$25,000 **IMPVMTS VALUE :** \$107,210 **TOTAL VALUE :** \$132,210

LAND-USE TYPE : SINGLE FAMILY **BUILDING TYPE :** SINGLE FAMILY RESIDENTIAL
YEAR BUILT : 1,999 **SQUARE FEET :** 1,877 **STYLE CODE :** 2.0 STORIES
BEDROOMS : 3 **BATHROOMS :** 2 **RESTROOMS :** 0 **BASEMENT :** N **GARAGE :** Y
EXTERIOR TYPE : ALUMINUM/VINYL SIDING **QUALITY GRADE :** 2 **IMPVMT. VALUE :** \$106,910
A/C : CENTRAL **FIREPLACE :** PREFAB

Record No.: 41 **BUILDING KEY NUMBER :** 02708432 001
PARCEL-ID : 02708432 **NEIGHBORHOOD CODE :** 02734 **ZONING CLASS :** R3
OWNER'S NAME : BASS ZERITHA W
MAILING ADDRESS : 6432 GOLDENBLUSH CIR
CITY : CHARLOTTE **STATE :** NC **ZIP CODE :** 282695101
PROPERTY LOCATION : 6432 GOLDENBLUSH CR
LEGAL DESC. : L8 M30-243 **DEED BK,PG & DATE :** 11116 /842 2000-02-29
ACREAGE : 0.000 **SALE PRICE :** \$135,500 **QUALIFIED SALE (Y/N) :** Y
LAND VALUE : \$25,000 **IMPVMTS VALUE :** \$105,840 **TOTAL VALUE :** \$130,840

LAND-USE TYPE : SINGLE FAMILY **BUILDING TYPE :** SINGLE FAMILY RESIDENTIAL
YEAR BUILT : 1,999 **SQUARE FEET :** 1,856 **STYLE CODE :** 2.0 STORIES
BEDROOMS : 3 **BATHROOMS :** 2 **RESTROOMS :** 0 **BASEMENT :** N **GARAGE :** Y
EXTERIOR TYPE : ALUMINUM/VINYL SIDING **QUALITY GRADE :** 2 **IMPVMT. VALUE :** \$105,840
A/C : CENTRAL **FIREPLACE :** PREFAB

Record No.: 42 **BUILDING KEY NUMBER :** 02708433 001
PARCEL-ID : 02708433 **NEIGHBORHOOD CODE :** 02734 **ZONING CLASS :** R3
OWNER'S NAME : CURRY JEFFREY & WF CYNTHIA R
MAILING ADDRESS : 6426 GOLDENBLUSH CIR
CITY : CHARLOTTE **STATE :** NC **ZIP CODE :** 282695101
PROPERTY LOCATION : 6426 GOLDENBLUSH CR
LEGAL DESC. : L9 M30-243 **DEED BK,PG & DATE :** 11092 /332 2000-02-17
ACREAGE : 0.000 **SALE PRICE :** \$136,000 **QUALIFIED SALE (Y/N) :** Y
LAND VALUE : \$25,000 **IMPVMTS VALUE :** \$96,290 **TOTAL VALUE :** \$121,290

LAND-USE TYPE : SINGLE FAMILY **BUILDING TYPE :** SINGLE FAMILY RESIDENTIAL
YEAR BUILT : 1,999 **SQUARE FEET :** 1,514 **STYLE CODE :** 1.0 STORY
BEDROOMS : 3 **BATHROOMS :** 2 **RESTROOMS :** 0 **BASEMENT :** N **GARAGE :** Y
EXTERIOR TYPE : ALUMINUM/VINYL SIDING **QUALITY GRADE :** 2 **IMPVMT. VALUE :** \$96,290
A/C : CENTRAL **FIREPLACE :** PREFAB

NOTE: This data is prepared for the purposes of revaluation, assessing & determining ownership of real property & is compiled from recorded deeds, plats, tax maps & other public records & data. Users of this data are hereby notified that the aforementioned public information sources should be consulted for verification. Mecklenburg County assumes no legal responsibility for the information herein.



MECKLENBURG COUNTY, NC

DATE PRINTED 5/9/02

GIS PUBLIC ACCESS SYSTEM REPORT

Note : Records are sorted in Parcel Number order.

PAGE : 15

Record No.: 43 **BUILDING KEY NUMBER :** 02708434 001
PARCEL-ID : 02708434 **NEIGHBORHOOD CODE :** 02734 **ZONING CLASS :** R3
OWNER'S NAME : FORTE CHAD &WF MACHON
MAILING ADDRESS : 6420 GOLDENBLUSH CIR
CITY : CHARLOTTE **STATE :** NC **ZIP CODE :** 282695101

PROPERTY LOCATION : 6420 GOLDENBLUSH CR
LEGAL DESC. : L10 M30-243 **DEED BK,PG & DATE :** 11329 /098 2000-06-01
ACREAGE : 0.000 **SALE PRICE :** \$131,000 **QUALIFIED SALE (Y/N) :** Y
LAND VALUE : \$25,000 **IMPVMTS VALUE :** \$98,630 **TOTAL VALUE :** \$123,630

LAND-USE TYPE : SINGLE FAMILY **BUILDING TYPE :** SINGLE FAMILY RESIDENTIAL
YEAR BUILT : 2,000 **SQUARE FEET :** 1,671 **STYLE CODE :** 2.0 STORIES
BEDROOMS : 3 **BATHROOMS :** 2 **RESTROOMS :** 0 **BASEMENT :** N **GARAGE :** Y
EXTERIOR TYPE : ALUMINUM/VINYL SIDING **QUALITY GRADE :** 2 **IMPVMT. VALUE :** \$98,330
A/C : CENTRAL **FIREPLACE :** PREFAB

Record No.: 44 **BUILDING KEY NUMBER :** 02708435 001
PARCEL-ID : 02708435 **NEIGHBORHOOD CODE :** 02734 **ZONING CLASS :** R3
OWNER'S NAME : CHAU HUNG HOANG & HUYNH HOA
MAILING ADDRESS : 6414 GOLDENBLUSH CIR
CITY : CHARLOTTE **STATE :** NC **ZIP CODE :** 282695101

PROPERTY LOCATION : 6414 GOLDENBLUSH CR
LEGAL DESC. : L11 M30-243 **DEED BK,PG & DATE :** 11010 /081 1999-12-31
ACREAGE : 0.000 **SALE PRICE :** \$149,000 **QUALIFIED SALE (Y/N) :** Y
LAND VALUE : \$25,000 **IMPVMTS VALUE :** \$114,330 **TOTAL VALUE :** \$139,330

LAND-USE TYPE : SINGLE FAMILY **BUILDING TYPE :** SINGLE FAMILY RESIDENTIAL
YEAR BUILT : 1,999 **SQUARE FEET :** 1,920 **STYLE CODE :** 1.0 STORY
BEDROOMS : 3 **BATHROOMS :** 2 **RESTROOMS :** 0 **BASEMENT :** N **GARAGE :** Y
EXTERIOR TYPE : ALUMINUM/VINYL SIDING **QUALITY GRADE :** 2 **IMPVMT. VALUE :** \$114,060
A/C : CENTRAL **FIREPLACE :** PREFAB

Record No.: 45 **BUILDING KEY NUMBER :** 02708436 001
PARCEL-ID : 02708436 **NEIGHBORHOOD CODE :** 02734 **ZONING CLASS :** R3
OWNER'S NAME : PARKER MICHAEL RYAN &WF KIMBERLY ANN
MAILING ADDRESS : 6408 GOLDENBLUSH CIR
CITY : CHARLOTTE **STATE :** NC **ZIP CODE :** 282695101

PROPERTY LOCATION : 6408 GOLDENBLUSH CR
LEGAL DESC. : L12 M30-243 **DEED BK,PG & DATE :** 11008 /225 1999-12-31
ACREAGE : 0.000 **SALE PRICE :** \$147,000 **QUALIFIED SALE (Y/N) :** Y
LAND VALUE : \$25,000 **IMPVMTS VALUE :** \$97,730 **TOTAL VALUE :** \$122,730

LAND-USE TYPE : SINGLE FAMILY **BUILDING TYPE :** SINGLE FAMILY RESIDENTIAL
YEAR BUILT : 1,999 **SQUARE FEET :** 1,702 **STYLE CODE :** 2.0 STORIES
BEDROOMS : 3 **BATHROOMS :** 2 **RESTROOMS :** 0 **BASEMENT :** N **GARAGE :** Y
EXTERIOR TYPE : ALUMINUM/VINYL SIDING **QUALITY GRADE :** 2 **IMPVMT. VALUE :** \$97,430
A/C : CENTRAL **FIREPLACE :** PREFAB

NOTE: This data is prepared for the purposes of revaluation, assessing & determining ownership of real property & is compiled from recorded deeds, plats, tax maps & other public records & data. Users of this data are hereby notified that the aforementioned public information sources should be consulted for verification. Mecklenburg County assumes no legal responsibility for the information herein.



MECKLENBURG COUNTY, NC

DATE PRINTED 5/9/02

GIS PUBLIC ACCESS SYSTEM REPORT

Note : Records are sorted in Parcel Number order.

PAGE : 16

Record No.: 46 **BUILDING KEY NUMBER :** 02708437 001
PARCEL-ID : 02708437 **NEIGHBORHOOD CODE :** 02734 **ZONING CLASS :** R3
OWNER'S NAME : DAVIS WILLIAM B BURNICE W DAVIS
MAILING ADDRESS : 6402 GOLDENBLUSH CR
CITY : CHARLOTTE **STATE :** NC **ZIP CODE :** 28269

PROPERTY LOCATION : 6402 GOLDENBLUSH CR
LEGAL DESC. : L13 M30-243 **DEED BK,PG & DATE :** 11714 /792 2000-11-13
ACREAGE : 0.000 **SALE PRICE :** \$134,500 **QUALIFIED SALE (Y/N) :** Y
LAND VALUE : \$25,000 **IMPVMTS VALUE :** \$106,030 **TOTAL VALUE :** \$131,030

LAND-USE TYPE : SINGLE FAMILY **BUILDING TYPE :** SINGLE FAMILY RESIDENTIAL
YEAR BUILT : 2,000 **SQUARE FEET :** 1,856 **STYLE CODE :** 2.0 STORIES
BEDROOMS : 3 **BATHROOMS :** 2 **RESTROOMS :** 0 **BASEMENT :** N **GARAGE :** Y
EXTERIOR TYPE : ALUMINUM/VINYL SIDING **QUALITY GRADE :** 2 **IMPVMT. VALUE :** \$105,730
A/C : CENTRAL **FIREPLACE :** PREFAB

Record No.: 47 **BUILDING KEY NUMBER :** 02708498 001
PARCEL-ID : 02708498 **NEIGHBORHOOD CODE :** 02701 **ZONING CLASS :** R3
OWNER'S NAME : KOONKOLONIE LTD PTNRSP
MAILING ADDRESS : 20229 RIVERCHASE DR
CITY : CORNELIUS **STATE :** NC **ZIP CODE :** 28031

PROPERTY LOCATION : PROSPERITY CHURCH RC
LEGAL DESC. : NA/LD ONLY/NOT ANNEX UNTIL NOT DEF **DEED BK,PG & DATE :** 08011 /799 1994-12-27
ACREAGE : 15.000 **SALE PRICE :** \$0 **QUALIFIED SALE (Y/N) :** N
LAND VALUE : \$181,680 **IMPVMTS VALUE :** \$0 **TOTAL VALUE :** \$181,680

LAND-USE TYPE : VACANT **BUILDING TYPE :** SINGLE FAMILY RESIDENTIAL
YEAR BUILT : 0 **SQUARE FEET :** 0 **STYLE CODE :**
BEDROOMS : 0 **BATHROOMS :** 0 **RESTROOMS :** 0 **BASEMENT :** N **GARAGE :** N
EXTERIOR TYPE : **QUALITY GRADE :** 0 **IMPVMT. VALUE :** \$0
A/C : **FIREPLACE :**

Record No.: 48 **BUILDING KEY NUMBER :** 02708501 001
PARCEL-ID : 02708501 **NEIGHBORHOOD CODE :** 02734 **ZONING CLASS :** R3
OWNER'S NAME : BYRD JAMES E JR & GLORIA K WYNN
MAILING ADDRESS : 12536 CARDINAL POINT RD
CITY : CHARLOTTE **STATE :** NC **ZIP CODE :** 28269

PROPERTY LOCATION : 12536 CARDINAL POINT RC
LEGAL DESC. : L56 M28-249 **DEED BK,PG & DATE :** 09526 /429 1998-02-27
ACREAGE : 0.000 **SALE PRICE :** \$147,000 **QUALIFIED SALE (Y/N) :** Y
LAND VALUE : \$25,000 **IMPVMTS VALUE :** \$118,900 **TOTAL VALUE :** \$143,900

LAND-USE TYPE : SINGLE FAMILY **BUILDING TYPE :** SINGLE FAMILY RESIDENTIAL
YEAR BUILT : 1,998 **SQUARE FEET :** 2,196 **STYLE CODE :** 2.0 STORIES
BEDROOMS : 4 **BATHROOMS :** 2 **RESTROOMS :** 0 **BASEMENT :** N **GARAGE :** Y
EXTERIOR TYPE : ALUMINUM/VINYL SIDING **QUALITY GRADE :** 2 **IMPVMT. VALUE :** \$118,600
A/C : CENTRAL **FIREPLACE :** PREFAB

NOTE: This data is prepared for the purposes of revaluation, assessing & determining ownership of real property & is compiled from recorded deeds, plats, tax maps & other public records & data. Users of this data are hereby notified that the aforementioned public information sources should be consulted for verification. Mecklenburg County assumes no legal responsibility for the information herein.



MECKLENBURG COUNTY, NC
GIS PUBLIC ACCESS SYSTEM REPORT

DATE PRINTED 5/9/02

Note : Records are sorted in Parcel Number order.

PAGE : 17

Record No.: 49 **BUILDING KEY NUMBER :** 02708502 001
PARCEL-ID : 02708502 **NEIGHBORHOOD CODE :** 02734 **ZONING CLASS :** R3
OWNER'S NAME : SCHWEITZER BRYAN J &WF STACY L
MAILING ADDRESS : 12528 CARDINAL POINT RD
CITY : CHARLOTTE **STATE :** NC **ZIP CODE :** 28269

PROPERTY LOCATION : 12528 **CARDINAL POINT** **RC**
LEGAL DESC. : L57 M28-249 **DEED BK,PG & DATE :** 09367 /407 1997-11-24
ACREAGE : 0.000 **SALE PRICE :** \$136,500 **QUALIFIED SALE (Y/N) :** Y
LAND VALUE : \$25,000 **IMPVMTS VALUE :** \$110,750 **TOTAL VALUE :** \$135,750

LAND-USE TYPE : SINGLE FAMILY **BUILDING TYPE :** SINGLE FAMILY RESIDENTIAL
YEAR BUILT : 1,997 **SQUARE FEET :** 1,989 **STYLE CODE :** 1.5 STORIES
BEDROOMS : 3 **BATHROOMS :** 2 **RESTROOMS :** 0 **BASEMENT :** N **GARAGE :** Y
EXTERIOR TYPE : ALUMINUM/VINYL SIDING **QUALITY GRADE :** 2 **IMPVMT. VALUE :** \$110,230
A/C : CENTRAL **FIREPLACE :** PREFAB

Record No.: 50 **BUILDING KEY NUMBER :** 02708503 001
PARCEL-ID : 02708503 **NEIGHBORHOOD CODE :** 02734 **ZONING CLASS :** R3
OWNER'S NAME : BROWN DAVID B DIANE BROWN (H/W)
MAILING ADDRESS : 12522 CARDINAL POINT RD
CITY : CHARLOTTE **STATE :** NC **ZIP CODE :** 28269

PROPERTY LOCATION : 12522 **CARDINAL POINT** **RC**
LEGAL DESC. : L58 M28-249 **DEED BK,PG & DATE :** 11760 /302 2000-12-01
ACREAGE : 0.000 **SALE PRICE :** \$146,000 **QUALIFIED SALE (Y/N) :** Y
LAND VALUE : \$25,000 **IMPVMTS VALUE :** \$96,680 **TOTAL VALUE :** \$121,680

LAND-USE TYPE : SINGLE FAMILY **BUILDING TYPE :** SINGLE FAMILY RESIDENTIAL
YEAR BUILT : 1,997 **SQUARE FEET :** 1,407 **STYLE CODE :** 1.0 STORY
BEDROOMS : 4 **BATHROOMS :** 2 **RESTROOMS :** 0 **BASEMENT :** N **GARAGE :** Y
EXTERIOR TYPE : ALUMINUM/VINYL SIDING **QUALITY GRADE :** 2 **IMPVMT. VALUE :** \$96,390
A/C : CENTRAL **FIREPLACE :** 1 STY SINGLE

Record No.: 51 **BUILDING KEY NUMBER :** 02708504 001
PARCEL-ID : 02708504 **NEIGHBORHOOD CODE :** 02734 **ZONING CLASS :** R3
OWNER'S NAME : JARRATT THEODORE V
MAILING ADDRESS : 12516 CARDINAL POINT RD
CITY : CHARLOTTE **STATE :** NC **ZIP CODE :** 28269

PROPERTY LOCATION : 12516 **CARDINAL POINT** **RC**
LEGAL DESC. : L59 M28-249 **DEED BK,PG & DATE :** 09356 /140 1997-11-17
ACREAGE : 0.000 **SALE PRICE :** \$132,500 **QUALIFIED SALE (Y/N) :** Y
LAND VALUE : \$25,000 **IMPVMTS VALUE :** \$99,490 **TOTAL VALUE :** \$124,490

LAND-USE TYPE : SINGLE FAMILY **BUILDING TYPE :** SINGLE FAMILY RESIDENTIAL
YEAR BUILT : 1,997 **SQUARE FEET :** 1,406 **STYLE CODE :** 1.0 STORY
BEDROOMS : 3 **BATHROOMS :** 2 **RESTROOMS :** 0 **BASEMENT :** N **GARAGE :** Y
EXTERIOR TYPE : ALUMINUM/VINYL SIDING **QUALITY GRADE :** 2 **IMPVMT. VALUE :** \$99,200
A/C : CENTRAL **FIREPLACE :** 1 STY SINGLE

NOTE: This data is prepared for the purposes of revaluation, assessing & determining ownership of real property & is compiled from recorded deeds, plats, tax maps & other public records & data. Users of this data are hereby notified that the aforementioned public information sources should be consulted for verification. Mecklenburg County assumes no legal responsibility for the information herein.



MECKLENBURG COUNTY, NC

DATE PRINTED 5/9/02

GIS PUBLIC ACCESS SYSTEM REPORT

Note : Records are sorted in Parcel Number order.

PAGE : 18

Record No.: 52 **BUILDING KEY NUMBER :** 02708505 001
PARCEL-ID : 02708505 **NEIGHBORHOOD CODE :** 02734 **ZONING CLASS :** R3
OWNER'S NAME : WOLBERG LORI M
MAILING ADDRESS : 12508 CARDINAL POINT RD
CITY : CHARLOTTE **STATE :** NC **ZIP CODE :** 28269

PROPERTY LOCATION : 12508 **CARDINAL POINT** **RC**
LEGAL DESC. : L60 M28-249 **DEED BK,PG & DATE :** 09534 /758 1998-03-03
ACREAGE : 0.000 **SALE PRICE :** \$129,500 **QUALIFIED SALE (Y/N) :** Y
LAND VALUE : \$25,000 **IMPVMTS VALUE :** \$106,040 **TOTAL VALUE :** \$131,040

LAND-USE TYPE : SINGLE FAMILY **BUILDING TYPE :** SINGLE FAMILY RESIDENTIAL
YEAR BUILT : 1,998 **SQUARE FEET :** 1,644 **STYLE CODE :** 2.0 STORIES
BEDROOMS : 3 **BATHROOMS :** 2 **RESTROOMS :** 0 **BASEMENT :** N **GARAGE :** Y
EXTERIOR TYPE : ALUMINUM/VINYL SIDING **QUALITY GRADE :** 2 **IMPVMT. VALUE :** \$101,440
A/C : CENTRAL **FIREPLACE :** 2 STY SINGLE/1 DBL

Record No.: 53 **BUILDING KEY NUMBER :** 02708506 001
PARCEL-ID : 02708506 **NEIGHBORHOOD CODE :** 02734 **ZONING CLASS :** R3
OWNER'S NAME : LAND DAVID A & LOURDES LAND
MAILING ADDRESS : 12500 CARDINAL POINT RD
CITY : CHARLOTTE **STATE :** NC **ZIP CODE :** 28269

PROPERTY LOCATION : 12500 **CARDINAL POINT** **RC**
LEGAL DESC. : L61 M28-249 **DEED BK,PG & DATE :** 09276 /180 1997-09-29
ACREAGE : 0.000 **SALE PRICE :** \$136,000 **QUALIFIED SALE (Y/N) :** Y
LAND VALUE : \$25,000 **IMPVMTS VALUE :** \$107,050 **TOTAL VALUE :** \$132,050

LAND-USE TYPE : SINGLE FAMILY **BUILDING TYPE :** SINGLE FAMILY RESIDENTIAL
YEAR BUILT : 1,997 **SQUARE FEET :** 1,633 **STYLE CODE :** 1.0 STORY
BEDROOMS : 3 **BATHROOMS :** 2 **RESTROOMS :** 0 **BASEMENT :** N **GARAGE :** Y
EXTERIOR TYPE : ALUMINUM/VINYL SIDING **QUALITY GRADE :** 2 **IMPVMT. VALUE :** \$104,330
A/C : CENTRAL **FIREPLACE :** 1 STY SINGLE

Record No.: 54 **BUILDING KEY NUMBER :** 02708507 001
PARCEL-ID : 02708507 **NEIGHBORHOOD CODE :** 02734 **ZONING CLASS :** R3
OWNER'S NAME : HOLST LINDA B & KAREN A HOLST
MAILING ADDRESS : 12444 CARDINAL POINT RD
CITY : CHARLOTTE **STATE :** NC **ZIP CODE :** 28269

PROPERTY LOCATION : 12444 **CARDINAL POINT** **RC**
LEGAL DESC. : L62 M28-249 **DEED BK,PG & DATE :** 09899 /430 1998-09-02
ACREAGE : 0.000 **SALE PRICE :** \$128,000 **QUALIFIED SALE (Y/N) :** Y
LAND VALUE : \$25,000 **IMPVMTS VALUE :** \$98,480 **TOTAL VALUE :** \$123,480

LAND-USE TYPE : SINGLE FAMILY **BUILDING TYPE :** SINGLE FAMILY RESIDENTIAL
YEAR BUILT : 1,998 **SQUARE FEET :** 1,427 **STYLE CODE :** 1.0 STORY
BEDROOMS : 3 **BATHROOMS :** 2 **RESTROOMS :** 0 **BASEMENT :** N **GARAGE :** Y
EXTERIOR TYPE : ALUMINUM/VINYL SIDING **QUALITY GRADE :** 2 **IMPVMT. VALUE :** \$94,980
A/C : CENTRAL **FIREPLACE :** 1 STY SINGLE

NOTE: This data is prepared for the purposes of revaluation, assessing & determining ownership of real property & is compiled from recorded deeds, plats, tax maps & other public records & data. Users of this data are hereby notified that the aforementioned public information sources should be consulted for verification. Mecklenburg County assumes no legal responsibility for the information herein.



MECKLENBURG COUNTY, NC

DATE PRINTED 5/9/02

GIS PUBLIC ACCESS SYSTEM REPORT

Note : Records are sorted in Parcel Number order.

PAGE : 19

Record No.: 55 **BUILDING KEY NUMBER :** 02708508 001
PARCEL-ID : 02708508 **NEIGHBORHOOD CODE :** 02734 **ZONING CLASS :** R3
OWNER'S NAME : MCDONALD EDWARD D II & CHRISTINE E MCDONALD
MAILING ADDRESS : 12438 CARDINAL POINT RD
CITY : CHARLOTTE **STATE :** NC **ZIP CODE :** 28269

PROPERTY LOCATION : 12438 CARDINAL POINT RC
LEGAL DESC. : L63 M28-249 **DEED BK,PG & DATE :** 10014 /648 1998-11-03
ACREAGE : 0.000 **SALE PRICE :** \$135,500 **QUALIFIED SALE (Y/N) :** Y
LAND VALUE : \$25,000 **IMPVMTS VALUE :** \$99,840 **TOTAL VALUE :** \$124,840

LAND-USE TYPE : SINGLE FAMILY **BUILDING TYPE :** SINGLE FAMILY RESIDENTIAL
YEAR BUILT : 1,998 **SQUARE FEET :** 1,530 **STYLE CODE :** 1.0 STORY
BEDROOMS : 3 **BATHROOMS :** 2 **RESTROOMS :** 0 **BASEMENT :** N **GARAGE :** Y
EXTERIOR TYPE : ALUMINUM/VINYL SIDING **QUALITY GRADE :** 2 **IMPVMT. VALUE :** \$99,540
A/C : CENTRAL **FIREPLACE :** PREFAB

Record No.: 56 **BUILDING KEY NUMBER :** 02708509 001
PARCEL-ID : 02708509 **NEIGHBORHOOD CODE :** 02734 **ZONING CLASS :** R3
OWNER'S NAME : PURYEAR KARL
MAILING ADDRESS : 3025 SADBURY RD
CITY : CHARLOTTE **STATE :** NC **ZIP CODE :** 28205

PROPERTY LOCATION : 12434 CARDINAL POINT RE
LEGAL DESC. : L64 M28-249 **DEED BK,PG & DATE :** 11986 /034 2001-03-02
ACREAGE : 0.000 **SALE PRICE :** \$108,000 **QUALIFIED SALE (Y/N) :** Y
LAND VALUE : \$25,000 **IMPVMTS VALUE :** \$94,370 **TOTAL VALUE :** \$119,370

LAND-USE TYPE : SINGLE FAMILY **BUILDING TYPE :** SINGLE FAMILY RESIDENTIAL
YEAR BUILT : 1,998 **SQUARE FEET :** 1,427 **STYLE CODE :** 1.0 STORY
BEDROOMS : 3 **BATHROOMS :** 2 **RESTROOMS :** 0 **BASEMENT :** N **GARAGE :** Y
EXTERIOR TYPE : ALUMINUM/VINYL SIDING **QUALITY GRADE :** 2 **IMPVMT. VALUE :** \$94,290
A/C : CENTRAL **FIREPLACE :** 1 STY SINGLE

Record No.: 57 **BUILDING KEY NUMBER :** 02708510 001
PARCEL-ID : 02708510 **NEIGHBORHOOD CODE :** 02734 **ZONING CLASS :** R3
OWNER'S NAME : FRANCIS BRIAN D & BROOKE A BONNEVILLE
MAILING ADDRESS : 12428 CARDINAL POINT RD
CITY : CHARLOTTE **STATE :** NC **ZIP CODE :** 28269

PROPERTY LOCATION : 12428 CARDINAL POINT RC
LEGAL DESC. : L65 &P66 M28-249 **DEED BK,PG & DATE :** 09517 /667 1998-02-25
ACREAGE : 0.000 **SALE PRICE :** \$139,500 **QUALIFIED SALE (Y/N) :** Y
LAND VALUE : \$25,000 **IMPVMTS VALUE :** \$99,380 **TOTAL VALUE :** \$124,380

LAND-USE TYPE : SINGLE FAMILY **BUILDING TYPE :** SINGLE FAMILY RESIDENTIAL
YEAR BUILT : 1,998 **SQUARE FEET :** 1,394 **STYLE CODE :** 1.0 STORY
BEDROOMS : 4 **BATHROOMS :** 2 **RESTROOMS :** 0 **BASEMENT :** N **GARAGE :** Y
EXTERIOR TYPE : ALUMINUM/VINYL SIDING **QUALITY GRADE :** 2 **IMPVMT. VALUE :** \$98,280
A/C : CENTRAL **FIREPLACE :** 2 STY SINGLE/1 DBL

NOTE: This data is prepared for the purposes of revaluation, assessing & determining ownership of real property & is compiled from recorded deeds, plats, tax maps & other public records & data. Users of this data are hereby notified that the aforementioned public information sources should be consulted for verification. Mecklenburg County assumes no legal responsibility for the information herein.



MECKLENBURG COUNTY, NC
GIS PUBLIC ACCESS SYSTEM REPORT

DATE PRINTED 5/9/02

Note : Records are sorted in Parcel Number order.

PAGE : 20

Record No.: 58 **BUILDING KEY NUMBER :** 02708511 001
PARCEL-ID : 02708511 **NEIGHBORHOOD CODE :** 02734 **ZONING CLASS :** R3
OWNER'S NAME : MURTAGH JAMES B STEPHANIE J MURTAGH
MAILING ADDRESS : 12422 CARDINAL POINT RD
CITY : CHARLOTTE **STATE :** NC **ZIP CODE :** 28269

PROPERTY LOCATION : 12422 CARDINAL POINT RC
LEGAL DESC. : P66 M28-249 **DEED BK,PG & DATE :** 12908 /540 2001-11-20
ACREAGE : 0.000 **SALE PRICE :** \$0 **QUALIFIED SALE (Y/N) :** Y
LAND VALUE : \$25,000 **IMPVMTS VALUE :** \$109,660 **TOTAL VALUE :** \$134,660

LAND-USE TYPE : SINGLE FAMILY **BUILDING TYPE :** SINGLE FAMILY RESIDENTIAL
YEAR BUILT : 1,998 **SQUARE FEET :** 1,924 **STYLE CODE :** 2.0 STORIES
BEDROOMS : 4 **BATHROOMS :** 2 **RESTROOMS :** 0 **BASEMENT :** N **GARAGE :** Y
EXTERIOR TYPE : ALUMINUM/VINYL SIDING **QUALITY GRADE :** 2 **IMPVMT. VALUE :** \$109,360
A/C : CENTRAL **FIREPLACE :** 1 STY SINGLE

Record No.: 59 **BUILDING KEY NUMBER :** 02708512 001
PARCEL-ID : 02708512 **NEIGHBORHOOD CODE :** 02734 **ZONING CLASS :** R3
OWNER'S NAME : CARTER WILLIAM B
MAILING ADDRESS : 12416 CARDINAL POINT RD
CITY : CHARLOTTE **STATE :** NC **ZIP CODE :** 28269

PROPERTY LOCATION : 12416 CARDINAL POINT RC
LEGAL DESC. : L67 M28-249 **DEED BK,PG & DATE :** 09534 /790 1998-03-03
ACREAGE : 0.000 **SALE PRICE :** \$137,000 **QUALIFIED SALE (Y/N) :** Y
LAND VALUE : \$25,000 **IMPVMTS VALUE :** \$108,540 **TOTAL VALUE :** \$133,540

LAND-USE TYPE : SINGLE FAMILY **BUILDING TYPE :** SINGLE FAMILY RESIDENTIAL
YEAR BUILT : 1,998 **SQUARE FEET :** 1,644 **STYLE CODE :** 1.0 STORY
BEDROOMS : 3 **BATHROOMS :** 2 **RESTROOMS :** 0 **BASEMENT :** N **GARAGE :** Y
EXTERIOR TYPE : ALUMINUM/VINYL SIDING **QUALITY GRADE :** 2 **IMPVMT. VALUE :** \$104,740
A/C : CENTRAL **FIREPLACE :** 1 STY SINGLE

Record No.: 60 **BUILDING KEY NUMBER :** 02708514 001
PARCEL-ID : 02708514 **NEIGHBORHOOD CODE :** 02734 **ZONING CLASS :** R3
OWNER'S NAME : CONKLIN LISA D & ROBERT E COLLINS
MAILING ADDRESS : 6307 GOLD DUST CT
CITY : CHARLOTTE **STATE :** NC **ZIP CODE :** 28269

PROPERTY LOCATION : 6307 GOLD DUST CT
LEGAL DESC. : L69 M28-249 **DEED BK,PG & DATE :** 09585 /513 1998-03-30
ACREAGE : 0.000 **SALE PRICE :** \$127,000 **QUALIFIED SALE (Y/N) :** Y
LAND VALUE : \$25,000 **IMPVMTS VALUE :** \$98,860 **TOTAL VALUE :** \$123,860

LAND-USE TYPE : SINGLE FAMILY **BUILDING TYPE :** SINGLE FAMILY RESIDENTIAL
YEAR BUILT : 1,998 **SQUARE FEET :** 1,583 **STYLE CODE :** 2.0 STORIES
BEDROOMS : 3 **BATHROOMS :** 2 **RESTROOMS :** 0 **BASEMENT :** N **GARAGE :** Y
EXTERIOR TYPE : ALUMINUM/VINYL SIDING **QUALITY GRADE :** 2 **IMPVMT. VALUE :** \$98,560
A/C : CENTRAL **FIREPLACE :** 2 STY SINGLE/1 DBL

NOTE: This data is prepared for the purposes of revaluation, assessing & determining ownership of real property & is compiled from recorded deeds, plats, tax maps & other public records & data. Users of this data are hereby notified that the aforementioned public information sources should be consulted for verification. Mecklenburg County assumes no legal responsibility for the information herein.



MECKLENBURG COUNTY, NC
GIS PUBLIC ACCESS SYSTEM REPORT

DATE PRINTED 5/9/02

Note : Records are sorted in Parcel Number order.

PAGE : 21

Record No.: 61 **BUILDING KEY NUMBER :** 02708515 001
PARCEL-ID : 02708515 **NEIGHBORHOOD CODE :** 02734 **ZONING CLASS :** R3
OWNER'S NAME : BUFF ROBERT W JR HELEN M BUFF (H/W)
MAILING ADDRESS : 6311 GOLD DUST CT
CITY : CHARLOTTE **STATE :** NC **ZIP CODE :** 28269

PROPERTY LOCATION : 6311 GOLD DUST CT
LEGAL DESC. : L70 M28-249 **DEED BK,PG & DATE :** 12052 /263 2001-03-27
ACREAGE : 0.000 **SALE PRICE :** \$0 **QUALIFIED SALE (Y/N) :** N
LAND VALUE : \$25,000 **IMPVMTS VALUE :** \$108,710 **TOTAL VALUE :** \$133,710

LAND-USE TYPE : SINGLE FAMILY **BUILDING TYPE :** SINGLE FAMILY RESIDENTIAL
YEAR BUILT : 1,997 **SQUARE FEET :** 1,677 **STYLE CODE :** 1.0 STORY
BEDROOMS : 3 **BATHROOMS :** 2 **RESTROOMS :** 0 **BASEMENT :** N **GARAGE :** Y
EXTERIOR TYPE : ALUMINUM/VINYL SIDING **QUALITY GRADE :** 2 **IMPVMT. VALUE :** \$107,240
A/C : CENTRAL **FIREPLACE :** 1 STY SINGLE

Record No.: 62 **BUILDING KEY NUMBER :** 02708526 001
PARCEL-ID : 02708526 **NEIGHBORHOOD CODE :** 02725 **ZONING CLASS :** R3
OWNER'S NAME : HINES DENNIS &WF CONSTANCE V BROOKS-HINES
MAILING ADDRESS : 6333 GOLDENBLUSH CIR
CITY : CHARLOTTE **STATE :** NC **ZIP CODE :** 282695100

PROPERTY LOCATION : 6333 GOLDENBLUSH CR
LEGAL DESC. : L78 M30-243 **DEED BK,PG & DATE :** 11010 /111 1999-12-31
ACREAGE : 0.000 **SALE PRICE :** \$144,500 **QUALIFIED SALE (Y/N) :** Y
LAND VALUE : \$25,000 **IMPVMTS VALUE :** \$102,280 **TOTAL VALUE :** \$127,280

LAND-USE TYPE : SINGLE FAMILY **BUILDING TYPE :** SINGLE FAMILY RESIDENTIAL
YEAR BUILT : 1,999 **SQUARE FEET :** 1,810 **STYLE CODE :** 2.0 STORIES
BEDROOMS : 3 **BATHROOMS :** 2 **RESTROOMS :** 0 **BASEMENT :** N **GARAGE :** Y
EXTERIOR TYPE : ALUMINUM/VINYL SIDING **QUALITY GRADE :** 2 **IMPVMT. VALUE :** \$102,280
A/C : CENTRAL **FIREPLACE :** PREFAB

Record No.: 63 **BUILDING KEY NUMBER :** 02708527 001
PARCEL-ID : 02708527 **NEIGHBORHOOD CODE :** 02725 **ZONING CLASS :** R3
OWNER'S NAME : KENLEY JEFFERY S &WF LAURA L
MAILING ADDRESS : 6401 GOLDENBLUSH CIR
CITY : CHARLOTTE **STATE :** NC **ZIP CODE :** 282695101

PROPERTY LOCATION : 6401 GOLDENBLUSH CR
LEGAL DESC. : L79 M30-243 **DEED BK,PG & DATE :** 10860 /432 1999-10-27
ACREAGE : 0.000 **SALE PRICE :** \$146,000 **QUALIFIED SALE (Y/N) :** Y
LAND VALUE : \$25,000 **IMPVMTS VALUE :** \$99,610 **TOTAL VALUE :** \$124,610

LAND-USE TYPE : SINGLE FAMILY **BUILDING TYPE :** SINGLE FAMILY RESIDENTIAL
YEAR BUILT : 1,999 **SQUARE FEET :** 1,580 **STYLE CODE :** 1.0 STORY
BEDROOMS : 3 **BATHROOMS :** 2 **RESTROOMS :** 0 **BASEMENT :** N **GARAGE :** Y
EXTERIOR TYPE : ALUMINUM/VINYL SIDING **QUALITY GRADE :** 2 **IMPVMT. VALUE :** \$99,310
A/C : CENTRAL **FIREPLACE :** PREFAB

NOTE: This data is prepared for the purposes of revaluation, assessing & determining ownership of real property & is compiled from recorded deeds, plats, tax maps & other public records & data. Users of this data are hereby notified that the aforementioned public information sources should be consulted for verification. Mecklenburg County assumes no legal responsibility for the information herein.



MECKLENBURG COUNTY, NC

GIS PUBLIC ACCESS SYSTEM REPORT

DATE PRINTED 5/9/02

Note : Records are sorted in Parcel Number order.

PAGE : 22

Record No.: 64 **BUILDING KEY NUMBER :** 02708528 001
PARCEL-ID : 02708528 **NEIGHBORHOOD CODE :** 02725 **ZONING CLASS :** R3
OWNER'S NAME : WAKEFIELD DOUGLAS C &WF JENNIFER E
MAILING ADDRESS : 6407 GOLDENBLUSH CIR
CITY : CHARLOTTE **STATE :** NC **ZIP CODE :** 28269

PROPERTY LOCATION : 6407 GOLDENBLUSH CR
LEGAL DESC. : L80 M30-243 **DEED BK,PG & DATE :** 10532 /629 1999-06-09
ACREAGE : 0.000 **SALE PRICE :** \$162,500 **QUALIFIED SALE (Y/N) :** Y
LAND VALUE : \$25,000 **IMPVMTS VALUE :** \$119,490 **TOTAL VALUE :** \$144,490

LAND-USE TYPE : SINGLE FAMILY **BUILDING TYPE :** SINGLE FAMILY RESIDENTIAL
YEAR BUILT : 1,999 **SQUARE FEET :** 2,234 **STYLE CODE :** 2.0 STORIES
BEDROOMS : 4 **BATHROOMS :** 2 **RESTROOMS :** 0 **BASEMENT :** N **GARAGE :** Y
EXTERIOR TYPE : ALUMINUM/VINYL SIDING **QUALITY GRADE :** 2 **IMPVMT. VALUE :** \$119,490
A/C : CENTRAL **FIREPLACE :** PREFAB

Record No.: 65 **BUILDING KEY NUMBER :** 02708529 001
PARCEL-ID : 02708529 **NEIGHBORHOOD CODE :** 02725 **ZONING CLASS :** R3
OWNER'S NAME : SCHILLING CHAD T &WF CYNTHIA R
MAILING ADDRESS : 6415 GOLDENBLUSH CIR
CITY : CHARLOTTE **STATE :** NC **ZIP CODE :** 282695101

PROPERTY LOCATION : 6415 GOLDENBLUSH CR
LEGAL DESC. : L81 M30-243 **DEED BK,PG & DATE :** 10874 /580 1999-11-01
ACREAGE : 0.000 **SALE PRICE :** \$139,000 **QUALIFIED SALE (Y/N) :** Y
LAND VALUE : \$25,000 **IMPVMTS VALUE :** \$95,640 **TOTAL VALUE :** \$120,640

LAND-USE TYPE : SINGLE FAMILY **BUILDING TYPE :** SINGLE FAMILY RESIDENTIAL
YEAR BUILT : 1,999 **SQUARE FEET :** 1,580 **STYLE CODE :** 2.0 STORIES
BEDROOMS : 3 **BATHROOMS :** 2 **RESTROOMS :** 0 **BASEMENT :** N **GARAGE :** Y
EXTERIOR TYPE : ALUMINUM/VINYL SIDING **QUALITY GRADE :** 2 **IMPVMT. VALUE :** \$95,340
A/C : CENTRAL **FIREPLACE :** PREFAB

Record No.: 66 **BUILDING KEY NUMBER :** 02708530 001
PARCEL-ID : 02708530 **NEIGHBORHOOD CODE :** 02725 **ZONING CLASS :** R3
OWNER'S NAME : PRINCE LOWELL &WF SUSAN
MAILING ADDRESS : 6421 GOLDENBLUSH CIR
CITY : CHARLOTTE **STATE :** NC **ZIP CODE :** 282695101

PROPERTY LOCATION : 6421 GOLDENBLUSH CR
LEGAL DESC. : L82 M30-243 **DEED BK,PG & DATE :** 10696 /564 1999-08-17
ACREAGE : 0.000 **SALE PRICE :** \$154,000 **QUALIFIED SALE (Y/N) :** Y
LAND VALUE : \$25,000 **IMPVMTS VALUE :** \$119,890 **TOTAL VALUE :** \$144,890

LAND-USE TYPE : SINGLE FAMILY **BUILDING TYPE :** SINGLE FAMILY RESIDENTIAL
YEAR BUILT : 1,999 **SQUARE FEET :** 2,036 **STYLE CODE :** 1.0 STORY
BEDROOMS : 3 **BATHROOMS :** 2 **RESTROOMS :** 0 **BASEMENT :** N **GARAGE :** Y
EXTERIOR TYPE : ALUMINUM/VINYL SIDING **QUALITY GRADE :** 2 **IMPVMT. VALUE :** \$119,220
A/C : CENTRAL **FIREPLACE :** PREFAB

NOTE: This data is prepared for the purposes of revaluation, assessing & determining ownership of real property & is compiled from recorded deeds, plats, tax maps & other public records & data. Users of this data are hereby notified that the aforementioned public information sources should be consulted for verification. Mecklenburg County assumes no legal responsibility for the information herein.



MECKLENBURG COUNTY, NC
GIS PUBLIC ACCESS SYSTEM REPORT

DATE PRINTED 5/9/02

Note : Records are sorted in Parcel Number order.

PAGE : 23

Record No.: 67 **BUILDING KEY NUMBER :** 02708531 001
PARCEL-ID : 02708531 **NEIGHBORHOOD CODE :** 02725 **ZONING CLASS :** R3
OWNER'S NAME : POURJAILVAND KHASHAYAR & MEHRNOOSH OLSON
MAILING ADDRESS : 1214 ROBINHOOD CIR
CITY : CHARLOTTE **STATE :** NC **ZIP CODE :** 28227

PROPERTY LOCATION : 6427 GOLDENBLUSH CR
LEGAL DESC. : L83 M30-243 **DEED BK,PG & DATE :** 11137 /783 2000-03-09
ACREAGE : 0.000 **SALE PRICE :** \$144,000 **QUALIFIED SALE (Y/N) :** Y
LAND VALUE : \$25,000 **IMPVMTS VALUE :** \$99,880 **TOTAL VALUE :** \$124,880

LAND-USE TYPE : SINGLE FAMILY **BUILDING TYPE :** SINGLE FAMILY RESIDENTIAL
YEAR BUILT : 1,999 **SQUARE FEET :** 1,615 **STYLE CODE :** 1.0 STORY
BEDROOMS : 3 **BATHROOMS :** 2 **RESTROOMS :** 0 **BASEMENT :** N **GARAGE :** Y
EXTERIOR TYPE : ALUMINUM/VINYL SIDING **QUALITY GRADE :** 2 **IMPVMT. VALUE :** \$99,410
A/C : CENTRAL **FIREPLACE :** PREFAB

Record No.: 68 **BUILDING KEY NUMBER :** 02708532 001
PARCEL-ID : 02708532 **NEIGHBORHOOD CODE :** 02725 **ZONING CLASS :** R3
OWNER'S NAME : WATERS WEBSTER A & DONALD MCCULLOUGH (R/S)
MAILING ADDRESS : 6433 GOLDENBLUSH CIR
CITY : CHARLOTTE **STATE :** NC **ZIP CODE :** 282695101

PROPERTY LOCATION : 6433 GOLDENBLUSH CR
LEGAL DESC. : L84 M30-243 **DEED BK,PG & DATE :** 10910 /831 1999-11-18
ACREAGE : 0.000 **SALE PRICE :** \$153,000 **QUALIFIED SALE (Y/N) :** Y
LAND VALUE : \$25,000 **IMPVMTS VALUE :** \$114,810 **TOTAL VALUE :** \$139,810

LAND-USE TYPE : SINGLE FAMILY **BUILDING TYPE :** SINGLE FAMILY RESIDENTIAL
YEAR BUILT : 1,999 **SQUARE FEET :** 1,924 **STYLE CODE :** 1.0 STORY
BEDROOMS : 3 **BATHROOMS :** 2 **RESTROOMS :** 0 **BASEMENT :** N **GARAGE :** Y
EXTERIOR TYPE : ALUMINUM/VINYL SIDING **QUALITY GRADE :** 2 **IMPVMT. VALUE :** \$114,330
A/C : CENTRAL **FIREPLACE :** PREFAB

Record No.: 69 **BUILDING KEY NUMBER :** 02708533 001
PARCEL-ID : 02708533 **NEIGHBORHOOD CODE :** 02725 **ZONING CLASS :** R3
OWNER'S NAME : HUYNH LINH Q & WF THU-TAM THI NGUYEN
MAILING ADDRESS : 6439 GOLDENBLUSH CIR
CITY : CHARLOTTE **STATE :** NC **ZIP CODE :** 282695101

PROPERTY LOCATION : 6439 GOLDENBLUSH CR
LEGAL DESC. : L85 M30-243 **DEED BK,PG & DATE :** 10922 /193 1999-11-23
ACREAGE : 0.000 **SALE PRICE :** \$138,000 **QUALIFIED SALE (Y/N) :** Y
LAND VALUE : \$25,000 **IMPVMTS VALUE :** \$99,700 **TOTAL VALUE :** \$124,700

LAND-USE TYPE : SINGLE FAMILY **BUILDING TYPE :** SINGLE FAMILY RESIDENTIAL
YEAR BUILT : 1,999 **SQUARE FEET :** 1,592 **STYLE CODE :** 1.0 STORY
BEDROOMS : 3 **BATHROOMS :** 2 **RESTROOMS :** 0 **BASEMENT :** N **GARAGE :** Y
EXTERIOR TYPE : ALUMINUM/VINYL SIDING **QUALITY GRADE :** 2 **IMPVMT. VALUE :** \$99,200
A/C : CENTRAL **FIREPLACE :** PREFAB

NOTE: This data is prepared for the purposes of revaluation, assessing & determining ownership of real property & is compiled from recorded deeds, plats, tax maps & other public records & data. Users of this data are hereby notified that the aforementioned public information sources should be consulted for verification. Mecklenburg County assumes no legal responsibility for the information herein.



MECKLENBURG COUNTY, NC
GIS PUBLIC ACCESS SYSTEM REPORT

DATE PRINTED 5/9/02

Note : Records are sorted in Parcel Number order.

PAGE : 24

Record No.: 70 **BUILDING KEY NUMBER :** 02708534 001
PARCEL-ID : 02708534 **NEIGHBORHOOD CODE :** 02725 **ZONING CLASS :** R3
OWNER'S NAME : MILLS VINCENT JAMES & WF TONYA SAWYER
MAILING ADDRESS : 6501 GOLDENBLUSH CIR
CITY : CHARLOTTE **STATE :** NC **ZIP CODE :** 282695102
PROPERTY LOCATION : 6501 GOLDENBLUSH CR
LEGAL DESC. : L86 M30-243 **DEED BK,PG & DATE :** 10788 /275 1999-09-27
ACREAGE : 0.000 **SALE PRICE :** \$164,000 **QUALIFIED SALE (Y/N) :** Y
LAND VALUE : \$25,000 **IMPVMTS VALUE :** \$127,820 **TOTAL VALUE :** \$152,820

LAND-USE TYPE : SINGLE FAMILY **BUILDING TYPE :** SINGLE FAMILY RESIDENTIAL
YEAR BUILT : 1,999 **SQUARE FEET :** 2,316 **STYLE CODE :** 1.0 STORY
BEDROOMS : 3 **BATHROOMS :** 2 **RESTROOMS :** 0 **BASEMENT :** N **GARAGE :** Y
EXTERIOR TYPE : ALUMINUM/VINYL SIDING **QUALITY GRADE :** 2 **IMPVMT. VALUE :** \$127,250
A/C : CENTRAL **FIREPLACE :** PREFAB

Record No.: 71 **BUILDING KEY NUMBER :** 02708535 001
PARCEL-ID : 02708535 **NEIGHBORHOOD CODE :** 02725 **ZONING CLASS :** R3
OWNER'S NAME : KARSHE OMAR & WF MUNA ABRAHAM
MAILING ADDRESS : 6507 GOLDENBLUSH CIR
CITY : CHARLOTTE **STATE :** NC **ZIP CODE :** 282695102
PROPERTY LOCATION : 6507 GOLDENBLUSH CR
LEGAL DESC. : L87 M30-243 **DEED BK,PG & DATE :** 10696 /696 1999-08-17
ACREAGE : 0.000 **SALE PRICE :** \$146,500 **QUALIFIED SALE (Y/N) :** Y
LAND VALUE : \$25,000 **IMPVMTS VALUE :** \$99,610 **TOTAL VALUE :** \$124,610

LAND-USE TYPE : SINGLE FAMILY **BUILDING TYPE :** SINGLE FAMILY RESIDENTIAL
YEAR BUILT : 1,999 **SQUARE FEET :** 1,580 **STYLE CODE :** 1.0 STORY
BEDROOMS : 3 **BATHROOMS :** 2 **RESTROOMS :** 0 **BASEMENT :** N **GARAGE :** Y
EXTERIOR TYPE : ALUMINUM/VINYL SIDING **QUALITY GRADE :** 2 **IMPVMT. VALUE :** \$99,310
A/C : CENTRAL **FIREPLACE :** PREFAB

Record No.: 72 **BUILDING KEY NUMBER :** 02708536 001
PARCEL-ID : 02708536 **NEIGHBORHOOD CODE :** 02725 **ZONING CLASS :** R3
OWNER'S NAME : BEST KIMBERLISA
MAILING ADDRESS : 6515 GOLDENBLUSH CIR
CITY : CHARLOTTE **STATE :** NC **ZIP CODE :** 282695102
PROPERTY LOCATION : 6515 GOLDENBLUSH CR
LEGAL DESC. : L88 M30-243 **DEED BK,PG & DATE :** 10908 /088 1999-11-17
ACREAGE : 0.000 **SALE PRICE :** \$152,000 **QUALIFIED SALE (Y/N) :** Y
LAND VALUE : \$25,000 **IMPVMTS VALUE :** \$112,790 **TOTAL VALUE :** \$137,790

LAND-USE TYPE : SINGLE FAMILY **BUILDING TYPE :** SINGLE FAMILY RESIDENTIAL
YEAR BUILT : 1,999 **SQUARE FEET :** 1,989 **STYLE CODE :** 2.0 STORIES
BEDROOMS : 3 **BATHROOMS :** 2 **RESTROOMS :** 0 **BASEMENT :** N **GARAGE :** Y
EXTERIOR TYPE : ALUMINUM/VINYL SIDING **QUALITY GRADE :** 2 **IMPVMT. VALUE :** \$112,490
A/C : CENTRAL **FIREPLACE :** PREFAB

NOTE: This data is prepared for the purposes of revaluation, assessing & determining ownership of real property & is compiled from recorded deeds, plats, tax maps & other public records & data. Users of this data are hereby notified that the aforementioned public information sources should be consulted for verification. Mecklenburg County assumes no legal responsibility for the information herein.



MECKLENBURG COUNTY, NC
GIS PUBLIC ACCESS SYSTEM REPORT

DATE PRINTED 5/9/02

Note : Records are sorted in Parcel Number order.

PAGE : 25

Record No.: 73 **BUILDING KEY NUMBER :** 02708537 001
PARCEL-ID : 02708537 **NEIGHBORHOOD CODE :** 02725 **ZONING CLASS :** R3
OWNER'S NAME : AGUALLO JONATHAN G &WF ELIZABETH E
MAILING ADDRESS : 6521 GOLDENBLUSH CIR
CITY : CHARLOTTE **STATE :** NC **ZIP CODE :** 282695102

PROPERTY LOCATION : 6521 GOLDENBLUSH CR
LEGAL DESC. : L89 M30-243 **DEED BK,PG & DATE :** 10550 /615 1999-06-17
ACREAGE : 0.000 **SALE PRICE :** \$138,000 **QUALIFIED SALE (Y/N) :** Y
LAND VALUE : \$25,000 **IMPVMTS VALUE :** \$98,230 **TOTAL VALUE :** \$123,230

LAND-USE TYPE : SINGLE FAMILY **BUILDING TYPE :** SINGLE FAMILY RESIDENTIAL
YEAR BUILT : 1,999 **SQUARE FEET :** 1,669 **STYLE CODE :** 2.0 STORIES
BEDROOMS : 3 **BATHROOMS :** 2 **RESTROOMS :** 0 **BASEMENT :** N **GARAGE :** Y
EXTERIOR TYPE : ALUMINUM/VINYL SIDING **QUALITY GRADE :** 2 **IMPVMT. VALUE :** \$97,930
A/C : CENTRAL **FIREPLACE :** PREFAB

Record No.: 74 **BUILDING KEY NUMBER :** 02756108A001
PARCEL-ID : 02756108 **NEIGHBORHOOD CODE :** 02701 **ZONING CLASS :** R3
OWNER'S NAME : NISBET E P COMPANY
MAILING ADDRESS : PO BOX 35367
CITY : CHARLOTTE **STATE :** NC **ZIP CODE :** 28235

PROPERTY LOCATION : 6101 PROSPERITY CHURCH RE
LEGAL DESC. : L1 M3-551 **DEED BK,PG & DATE :** 02779 /294 1975-01-01
ACREAGE : 22.000 **SALE PRICE :** \$0 **QUALIFIED SALE (Y/N) :** N
LAND VALUE : \$335,280 **IMPVMTS VALUE :** \$271,900 **TOTAL VALUE :** \$607,180

LAND-USE TYPE : COMMERCIAL **BUILDING TYPE :** COMMERCIAL
YEAR BUILT : 1,966 **SQUARE FEET :** 1,440 **STYLE CODE :** 1.0 STORY
BEDROOMS : 0 **BATHROOMS :** 0 **RESTROOMS :** 0 **BASEMENT :** N **GARAGE :** N
EXTERIOR TYPE : CORRUGATED METAL(LIGHT) **QUALITY GRADE :** 1 **IMPVMT. VALUE :** \$15,240
A/C : NONE **FIREPLACE :** NONE

Record No.: 75 **BUILDING KEY NUMBER :** 02756108B001
PARCEL-ID : 02756108 **NEIGHBORHOOD CODE :** 02701 **ZONING CLASS :**
OWNER'S NAME : HUNT LAURA LYNNE
MAILING ADDRESS : 6101-LOT 89 PROSPERITY CH
CITY : CHARLOTTE **STATE :** NC **ZIP CODE :** 28269

PROPERTY LOCATION : 6101 PROSPERITY CHURCH RE
LEGAL DESC. : IMP ONLY **DEED BK,PG & DATE :** 00000 /000 2000-01-12
ACREAGE : 0.000 **SALE PRICE :** \$0 **QUALIFIED SALE (Y/N) :** Y
LAND VALUE : \$0 **IMPVMTS VALUE :** \$37,560 **TOTAL VALUE :** \$37,560

LAND-USE TYPE : MANUFACTURED HOME **BUILDING TYPE :** MANUFACTURED HOME
YEAR BUILT : 1,984 **SQUARE FEET :** 1,568 **STYLE CODE :** 1.0 STORY
BEDROOMS : 3 **BATHROOMS :** 2 **RESTROOMS :** 0 **BASEMENT :** N **GARAGE :** N
EXTERIOR TYPE : **QUALITY GRADE :** 2 **IMPVMT. VALUE :** \$34,410
A/C : CENTRAL **FIREPLACE :** NONE

NOTE: This data is prepared for the purposes of revaluation, assessing & determining ownership of real property & is compiled from recorded deeds, plats, tax maps & other public records & data. Users of this data are hereby notified that the aforementioned public information sources should be consulted for verification. Mecklenburg County assumes no legal responsibility for the information herein.



MECKLENBURG COUNTY, NC
GIS PUBLIC ACCESS SYSTEM REPORT

DATE PRINTED 5/9/02

Note : Records are sorted in Parcel Number order.

PAGE : 26

Record No.: 76 **BUILDING KEY NUMBER :** 02929109 001
PARCEL-ID : 02929109 **NEIGHBORHOOD CODE :** 02901 **ZONING CLASS :** R3
OWNER'S NAME : KOONKOLONIE LTD PARTNERSHIP
MAILING ADDRESS : 20229 RIVERCHASE DR
CITY : CORNELIUS **STATE :** NC **ZIP CODE :** 28031

PROPERTY LOCATION : 6632 **PROSPERITY CHURCH** **RC**
LEGAL DESC. : NA/LD ONLY/NOT ANNEXABLE UNTIL NOT I **DEED BK,PG & DATE :** 08011 /799 1994-12-27
ACREAGE : 27.000 **SALE PRICE :** \$0 **QUALIFIED SALE (Y/N) :** N
LAND VALUE : \$270,610 **IMPVMTS VALUE :** \$0 **TOTAL VALUE :** \$270,610

LAND-USE TYPE : VACANT **BUILDING TYPE :** SINGLE FAMILY RESIDENTIAL
YEAR BUILT : 0 **SQUARE FEET :** 0 **STYLE CODE :**
BEDROOMS : 0 **BATHROOMS :** 0 **RESTROOMS :** 0 **BASEMENT :** N **GARAGE :** N
EXTERIOR TYPE : **QUALITY GRADE :** 0 **IMPVMT. VALUE :** \$0
A/C : **FIREPLACE :**

Record No.: 77 **BUILDING KEY NUMBER :** 02929119 001
PARCEL-ID : 02929119 **NEIGHBORHOOD CODE :** 02901 **ZONING CLASS :** R3
OWNER'S NAME : KLEIN SHAWN L
MAILING ADDRESS : 6300 PROSPERITY CHURCH RD
CITY : CHARLOTTE **STATE :** NC **ZIP CODE :** 28213

PROPERTY LOCATION : 6300 **PROSPERITY CHURCH** **RC**
LEGAL DESC. : 6300 PROSPERITY CHURCH RD **DEED BK,PG & DATE :** 07752 /452 1994-04-26
ACREAGE : 1.000 **SALE PRICE :** \$0 **QUALIFIED SALE (Y/N) :** N
LAND VALUE : \$17,000 **IMPVMTS VALUE :** \$37,390 **TOTAL VALUE :** \$54,390

LAND-USE TYPE : SINGLE FAMILY **BUILDING TYPE :** SINGLE FAMILY RESIDENTIAL
YEAR BUILT : 1,945 **SQUARE FEET :** 961 **STYLE CODE :** 1.0 STORY
BEDROOMS : 2 **BATHROOMS :** 1 **RESTROOMS :** 0 **BASEMENT :** N **GARAGE :** N
EXTERIOR TYPE : WOOD ON SHEATHING OR PLYWO **QUALITY GRADE :** 2 **IMPVMT. VALUE :** \$37,390
A/C : NONE **FIREPLACE :** 1 STY SINGLE

Record No.: 78 **BUILDING KEY NUMBER :** 02929120 001
PARCEL-ID : 02929120 **NEIGHBORHOOD CODE :** 02901 **ZONING CLASS :** INSTCD
OWNER'S NAME : ABUNDANT LIFE COMMUNITY CHURC
MAILING ADDRESS : 6400 PROSPERITY CHURCH RD
CITY : CHARLOTTE **STATE :** NC **ZIP CODE :** 28269

PROPERTY LOCATION : 6400 **PROSPERITY CHURCH** **RC**
LEGAL DESC. : NA **DEED BK,PG & DATE :** 09350 /733 1997-11-13
ACREAGE : 21.000 **SALE PRICE :** \$664,500 **QUALIFIED SALE (Y/N) :** N
LAND VALUE : \$269,850 **IMPVMTS VALUE :** \$255,370 **TOTAL VALUE :** \$525,220

LAND-USE TYPE : OFFICE **BUILDING TYPE :** OFFICE
YEAR BUILT : 1,945 **SQUARE FEET :** 2,008 **STYLE CODE :** 1.0 STORY
BEDROOMS : 0 **BATHROOMS :** 0 **RESTROOMS :** 2 **BASEMENT :** N **GARAGE :** N
EXTERIOR TYPE : WOOD ON SHEATHING OR PLYWO **QUALITY GRADE :** 2 **IMPVMT. VALUE :** \$109,760
A/C : CENTRAL **FIREPLACE :** 1 STY SINGLE



MECKLENBURG COUNTY, NC
GIS PUBLIC ACCESS SYSTEM REPORT

DATE PRINTED 5/9/02

Note : Records are sorted in Parcel Number order.

PAGE : 27

Record No.: 79 **BUILDING KEY NUMBER :** 02929120 002
PARCEL-ID : 02929120 **NEIGHBORHOOD CODE :** 02901 **ZONING CLASS :** INSTCD
OWNER'S NAME : ABUNDANT LIFE COMMUNITY CHURC
MAILING ADDRESS : 6400 PROSPERITY CHURCH RD
CITY : CHARLOTTE **STATE :** NC **ZIP CODE :** 28269

PROPERTY LOCATION : 6400 PROSPERITY CHURCH RC
LEGAL DESC. : NA **DEED BK,PG & DATE :** 09350 /733 1997-11-13
ACREAGE : 21.000 **SALE PRICE :** \$664,500 **QUALIFIED SALE (Y/N) :** N
LAND VALUE : \$269,850 **IMPVMTS VALUE :** \$255,370 **TOTAL VALUE :** \$525,220

LAND-USE TYPE : OFFICE **BUILDING TYPE :** OFFICE
YEAR BUILT : 1,999 **SQUARE FEET :** 1,700 **STYLE CODE :** 1.0 STORY
BEDROOMS : 0 **BATHROOMS :** 0 **RESTROOMS :** 2 **BASEMENT :** N **GARAGE :** N
EXTERIOR TYPE : WOOD ON SHEATHING OR PLYWO **QUALITY GRADE :** 2 **IMPVMT. VALUE :** \$127,990
A/C : CENTRAL **FIREPLACE :** NONE

Record No.: 80 **BUILDING KEY NUMBER :** 02941105 001
PARCEL-ID : 02941105 **NEIGHBORHOOD CODE :** 02901 **ZONING CLASS :** R3
OWNER'S NAME : WILEY CHARLENE Y
MAILING ADDRESS : 6232 PROSPERITY CHURCH RD
CITY : CHARLOTTE **STATE :** NC **ZIP CODE :** 28269

PROPERTY LOCATION : 6232 PROSPERITY CHURCH RC
LEGAL DESC. : 6232 PROSPERITY CH RD **DEED BK,PG & DATE :** 06543 /145 1991-05-03
ACREAGE : 2.000 **SALE PRICE :** \$0 **QUALIFIED SALE (Y/N) :** N
LAND VALUE : \$32,490 **IMPVMTS VALUE :** \$8,860 **TOTAL VALUE :** \$41,350

LAND-USE TYPE : SINGLE FAMILY **BUILDING TYPE :** SINGLE FAMILY RESIDENTIAL
YEAR BUILT : 1,950 **SQUARE FEET :** 1,020 **STYLE CODE :** 1.0 STORY
BEDROOMS : 3 **BATHROOMS :** 1 **RESTROOMS :** 0 **BASEMENT :** N **GARAGE :** N
EXTERIOR TYPE : WOOD ON SHEATHING OR PLYWO **QUALITY GRADE :** 1 **IMPVMT. VALUE :** \$8,570
A/C : NONE **FIREPLACE :** NONE

Record No.: 81 **BUILDING KEY NUMBER :** 02941107 001
PARCEL-ID : 02941107 **NEIGHBORHOOD CODE :** 02901 **ZONING CLASS :** MX2
OWNER'S NAME : PROSPERITY RIDGE LLC
MAILING ADDRESS : 1518 E MOREHEAD ST
CITY : CHARLOTTE **STATE :** NC **ZIP CODE :** 28204

PROPERTY LOCATION : 6200 PROSPERITY CHURCH RC
LEGAL DESC. : P4 &5 M3-551 **DEED BK,PG & DATE :** 12333 /931 2001-06-13
ACREAGE : 15.000 **SALE PRICE :** \$700,500 **QUALIFIED SALE (Y/N) :** Y
LAND VALUE : \$338,570 **IMPVMTS VALUE :** \$45,850 **TOTAL VALUE :** \$384,420

LAND-USE TYPE : SINGLE FAMILY **BUILDING TYPE :** SINGLE FAMILY RESIDENTIAL
YEAR BUILT : 1,982 **SQUARE FEET :** 1,536 **STYLE CODE :** 1.0 STORY
BEDROOMS : 3 **BATHROOMS :** 2 **RESTROOMS :** 0 **BASEMENT :** Y **GARAGE :** N
EXTERIOR TYPE : WOOD ON SHEATHING OR PLYWO **QUALITY GRADE :** 2 **IMPVMT. VALUE :** \$44,650
A/C : CENTRAL **FIREPLACE :** 1 STY SINGLE

NOTE: This data is prepared for the purposes of revaluation, assessing & determining ownership of real property & is compiled from recorded deeds, plats, tax maps & other public records & data. Users of this data are hereby notified that the aforementioned public information sources should be consulted for verification. Mecklenburg County assumes no legal responsibility for the information herein.



MECKLENBURG COUNTY, NC

GIS PUBLIC ACCESS SYSTEM REPORT

DATE PRINTED 5/9/02

Note : Records are sorted in Parcel Number order.

PAGE : 28

Record No.: 82 **BUILDING KEY NUMBER:** 02941111 001
PARCEL-ID: 02941111 **NEIGHBORHOOD CODE:** 02901 **ZONING CLASS:** R3
OWNER'S NAME: WILEY CHARLENE Y
MAILING ADDRESS: 6232 PROSPERITY CHURCH RD
CITY: CHARLOTTE **STATE:** NC **ZIP CODE:** 28269

PROPERTY LOCATION: 6238 PROSPERITY CHURCH RC
LEGAL DESC.: 6238 PROSPERITY CH RD **DEED BK,PG & DATE:** 06543 /147 1991-05-03
ACREAGE: 0.000 **SALE PRICE:** \$0 **QUALIFIED SALE (Y/N):** N
LAND VALUE: \$9,500 **IMPVMTS VALUE:** \$0 **TOTAL VALUE:** \$9,500

LAND-USE TYPE: VACANT **BUILDING TYPE:** SINGLE FAMILY RESIDENTIAL
YEAR BUILT: 0 **SQUARE FEET:** 0 **STYLE CODE:**
BEDROOMS: 0 **BATHROOMS:** 0 **RESTROOMS:** 0 **BASEMENT:** N **GARAGE:** N
EXTERIOR TYPE: **QUALITY GRADE:** 0 **IMPVMT. VALUE:** \$0
A/C: **FIREPLACE:**

Record No.: 83 **BUILDING KEY NUMBER:** 02941113A001
PARCEL-ID: 02941113 **NEIGHBORHOOD CODE:** 02901 **ZONING CLASS:** R3
OWNER'S NAME: FERRELL PARTNERS L P
MAILING ADDRESS: 6228 PROSPERITY CHURCH RD
CITY: CHARLOTTE **STATE:** NC **ZIP CODE:** 28269

PROPERTY LOCATION: PROSPERITY CHURCH RC
LEGAL DESC.: P2 U/M **DEED BK,PG & DATE:** 09157 /205 1997-07-16
ACREAGE: 50.000 **SALE PRICE:** \$0 **QUALIFIED SALE (Y/N):** N
LAND VALUE: \$456,900 **IMPVMTS VALUE:** \$0 **TOTAL VALUE:** \$456,900

LAND-USE TYPE: VACANT **BUILDING TYPE:** SINGLE FAMILY RESIDENTIAL
YEAR BUILT: 0 **SQUARE FEET:** 0 **STYLE CODE:**
BEDROOMS: 0 **BATHROOMS:** 0 **RESTROOMS:** 0 **BASEMENT:** N **GARAGE:** N
EXTERIOR TYPE: **QUALITY GRADE:** 0 **IMPVMT. VALUE:** \$0
A/C: **FIREPLACE:**

Record No.: 84 **BUILDING KEY NUMBER:** 02941113B001
PARCEL-ID: 02941113 **NEIGHBORHOOD CODE:** 02901 **ZONING CLASS:** R3
OWNER'S NAME: BELLSOUTH CAROLINAS PCS LP % MS. ANGIE PYE
MAILING ADDRESS: 1100 PEACH TREE ST
CITY: ATLANTA **STATE:** GA **ZIP CODE:** 30309

PROPERTY LOCATION: PROSPERITY CHURCH RC
LEGAL DESC.: LEASED LAND **DEED BK,PG & DATE:** 09157 /205 1997-07-16
ACREAGE: 1.000 **SALE PRICE:** \$0 **QUALIFIED SALE (Y/N):** Y
LAND VALUE: \$9,540 **IMPVMTS VALUE:** \$8,080 **TOTAL VALUE:** \$17,620

LAND-USE TYPE: OFFICE **BUILDING TYPE:** UTILITY
YEAR BUILT: 1,998 **SQUARE FEET:** 96 **STYLE CODE:** 1.0 STORY
BEDROOMS: 0 **BATHROOMS:** 0 **RESTROOMS:** 0 **BASEMENT:** N **GARAGE:** N
EXTERIOR TYPE: **QUALITY GRADE:** 5 **IMPVMT. VALUE:** \$8,080
A/C: WALL UNIT **FIREPLACE:** NONE

NOTE: This data is prepared for the purposes of revaluation, assessing & determining ownership of real property & is compiled from recorded deeds, plats, tax maps & other public records & data. Users of this data are hereby notified that the aforementioned public information sources should be consulted for verification. Mecklenburg County assumes no legal responsibility for the information herein.

Petition #: **2002-86**

Petitioner: Donna H. Cochrane

Hearing Date: July 15, 2002

Zoning Classification (Existing): R-3

Zoning Classification (Requested): R-8MF(CD)

Acresage & Location: Approximately 14.6 acres located on the the west side of Prosperity Church Road, south of Eastfield Road.

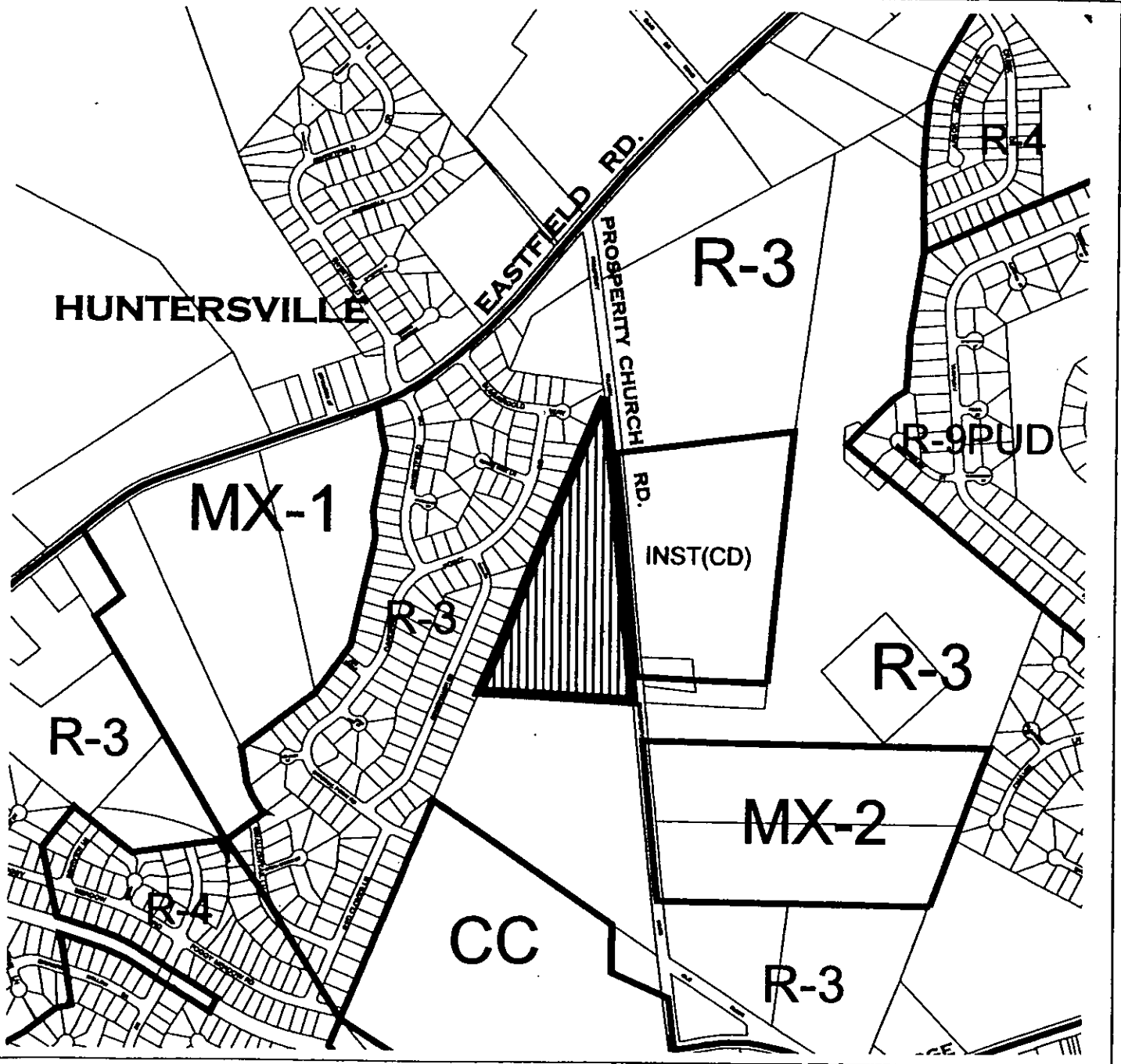

Zoning Map #(s):

38

Map Legend

- | | |
|-------------------|---------------------|
| RTD | Neighboring |
| Attraction | County Line |
| Watershed | City Unincorporated |
| Historic District | |

OFFICIAL REZONING APPLICATION
CITY OF CHARLOTTE

Amended 05-21-02 (agent)

FY2002
Petition #: 2002-86
Date Filed: 04-22-02
Received By: MS

OWNERSHIP INFORMATION:

Property Owner: Donna H Cochrane

Owner's Address: 5990 Island View Dr. City, State, Zip: Buford, GA 30518

Date Property Acquired: 12/27/94 Utilities Provided: (Water) CMUD (Sewer) CMUD
(CMUD, Private, Other) (CMUD, Private, Other)

LOCATION OF PROPERTY (Address or Description): Prosperity Church Road
Charlotte, North Carolina

Tax Parcel Number(s): 027-084-98

Current Land Use: Vacant

Size (Sq.Ft. or Acres): 14.6 +/-

ZONING REQUEST:

Existing Zoning: R-3 Proposed Zoning: R-8MF(CD)

Purpose of Zoning Change: (Include the maximum # of residential units or non-residential square footages):

To allow the development of townhomes at a maximum density of
8 units per acre.

Robert G. Young
Name of Agent
1300 S. Mint St. Suite 300
Agent's Address
Charlotte, NC 28203
City, State, Zip
704 334-9157 704 333-2905
Telephone Number Fax Number

Donna H Cochrane
Name of Petitioner(s)
5990 Island View Dr.
Address of Petitioner(s)
Buford, GA 30518
City, State, Zip
770-614-6128
Telephone Number Fax Number

E-Mail Address

Signature of Property Owner if other than Petitioner
Robert G. Young - THE McAlpine Group
(SEE ATTACHED)

E-Mail Address

Signature
See file

TAMMIE