



* 0 0 B R E A K 0 0 *



**ADVANCED
IMAGING
SYSTEMS**

www.aisimc.com

An Information
Management Company

City of Charlotte – Planning Dept. Scanning Rezoning Files

Petition # _____

Document type:

- Applications
- Correspondence
- Department Comments
- Land Use Consistency
 - Mail Info
 - Mapping
 - Other
 - Site Plans



* 0 0 B R E A K 0 0 *

MECKLENBURG COUNTY, NC GIS PUBLIC ACCESS SYSTEM

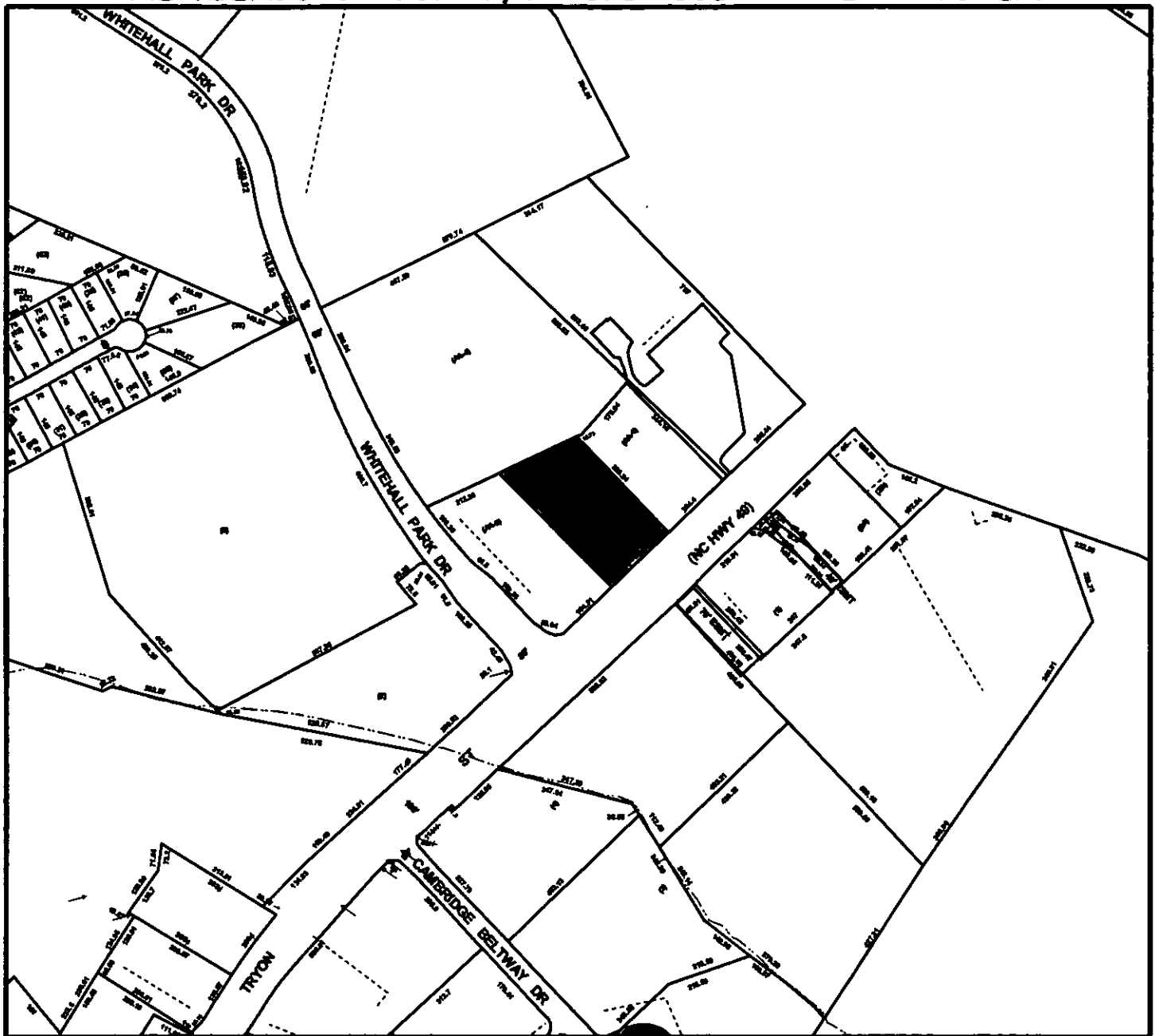

Tax Parcel-Id's Selected: 20103114, 20103128, 20103201, 20103222, 20103223, 20103224, 20103225, 20309103, 20309117, 20309130, 20309138 Tax Book & Page Selected: N/A

LEGEND

- County Boundary
- Rivers/Creeks/Streams
- Railroad ROW
- Water Bodies



02-118

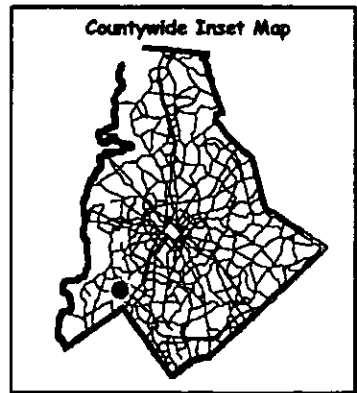

Scale : 1 Inch = 100 Feet
 Map Created on Friday, August 2, 2002 03:28 PM

This map is prepared for the inventory of real property within Mecklenburg County and is compiled from recorded deeds, plats, tax maps, surveys, planimetric maps, and other public records and data. Users of this map are hereby notified that the aforementioned public primary information sources should be consulted for verification. Mecklenburg County and its mapping contractors assume no legal responsibility for the information contained herein.

Petition #: 2002-118

Petitioner: Provonial Holdings, LLC

Hearing Date: October 23, 2002

Zoning Classification (Existing): I-1(CD)

Zoning Classification (Requested): I-1(CD) Site Plan Amendment

Acreeage & Location Approximately 1.67 acres located on the north side of South Tryon Street (NC Hwy 49) east of Whitehall Park Drive

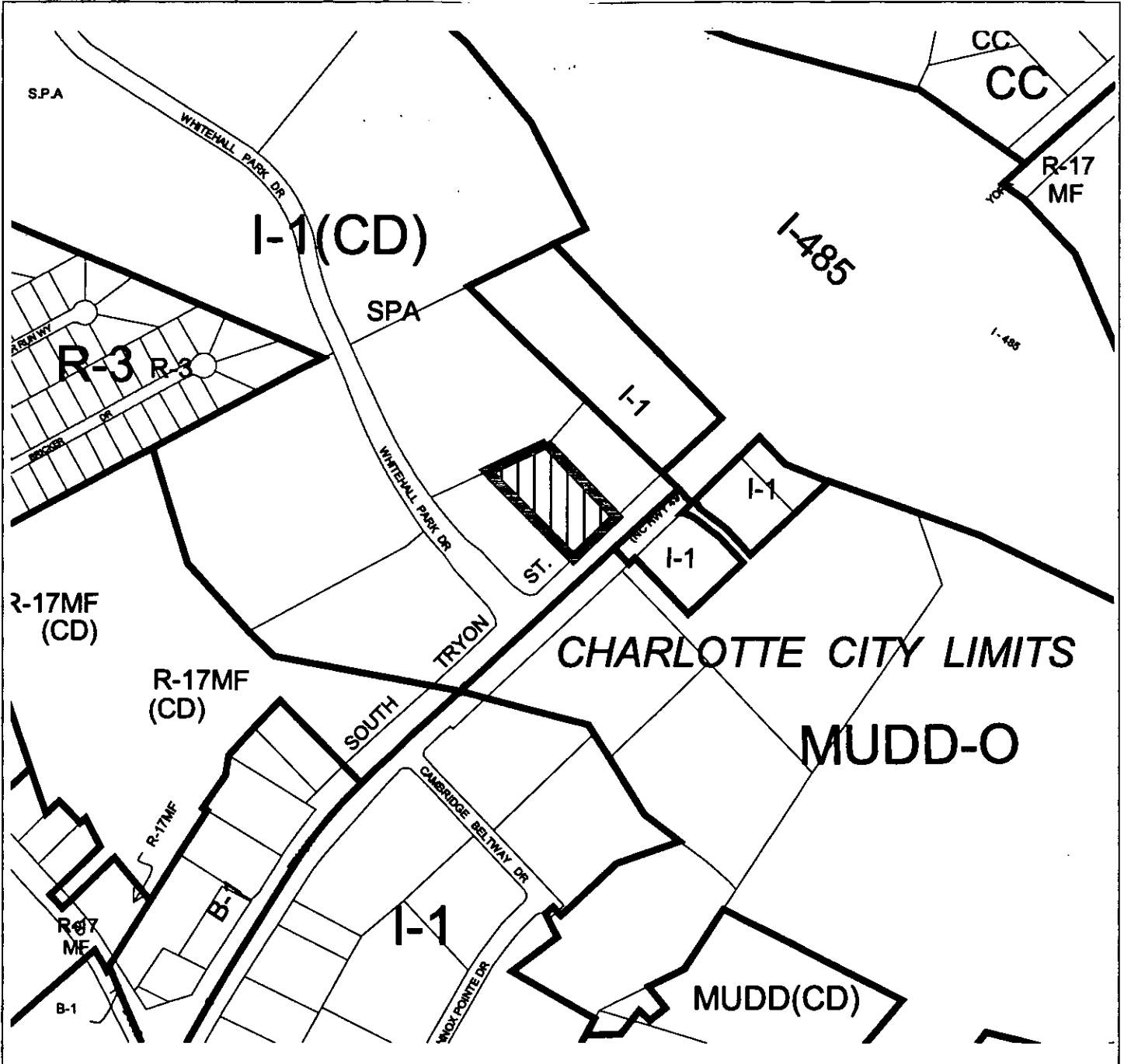

Zoning Map #(s); 149

Map Legend

	ETJ		Floodplain/Map
	Administrative		County Line
	Watershed		City Limit/Map
	Historic District		

MECKLENBURG COUNTY, NC GIS PUBLIC ACCESS SYSTEM



Tax Parcel-Ids Selected: 20103114, 20103128, 20103201, 20103222, 20103223, 20103224, 20103225, 20309103, 20309117, 20309130, 20309138 Tax Book & Page Selected: N/A

LEGEND

- County Boundary
- Rivers/Creeks/Streams
- Railroad ROW
- Water Bodies



02-118

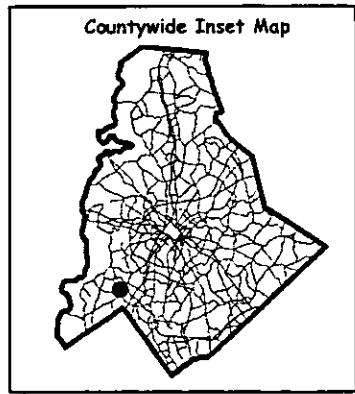
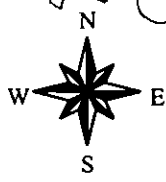

Scale : 1 Inch = 200 Feet
 Map Created on Monday, September 30, 2002 02:30 PM

This map is prepared for the inventory of real property within Mecklenburg County and is compiled from recorded deeds, plats, tax maps, surveys, planimetric maps, and other public records and data. Users of this map are hereby notified that the aforementioned public primary information sources should be consulted for verification. Mecklenburg County and its mapping contractors assume no legal responsibility for the information contained herein.