



* 0 0 B R E A K 0 0 *



**ADVANCED
IMAGING
SYSTEMS**

www.aisimc.com

An Information
Management Company

City of Charlotte – Planning Dept. Scanning Rezoning Files

Petition # _____

Document type:

- Applications
- Correspondence
- Department Comments
- Land Use Consistency
 - Mail Info
 - Mapping
 - Other
- Site Plans



* 0 0 B R E A K 0 0 *



GIS Real Estate System

Mecklenburg County, NC Geographic Information Systems

[Tax Parcel & Map Sheet Search](#)
[Return to Full Map Extent](#)

[Road Name & Intersection Search](#)
[How to Use the System](#)

[Market Analysis Search Menu](#)
[Return to GIS Homepage](#)

Click on Map to Perform Operation

Refresh Map Pan Zoom In Zoom Out Zoom Factor Identify Surveyor's Report
 Adjoining Owner's Report within Measure Label parcels by:

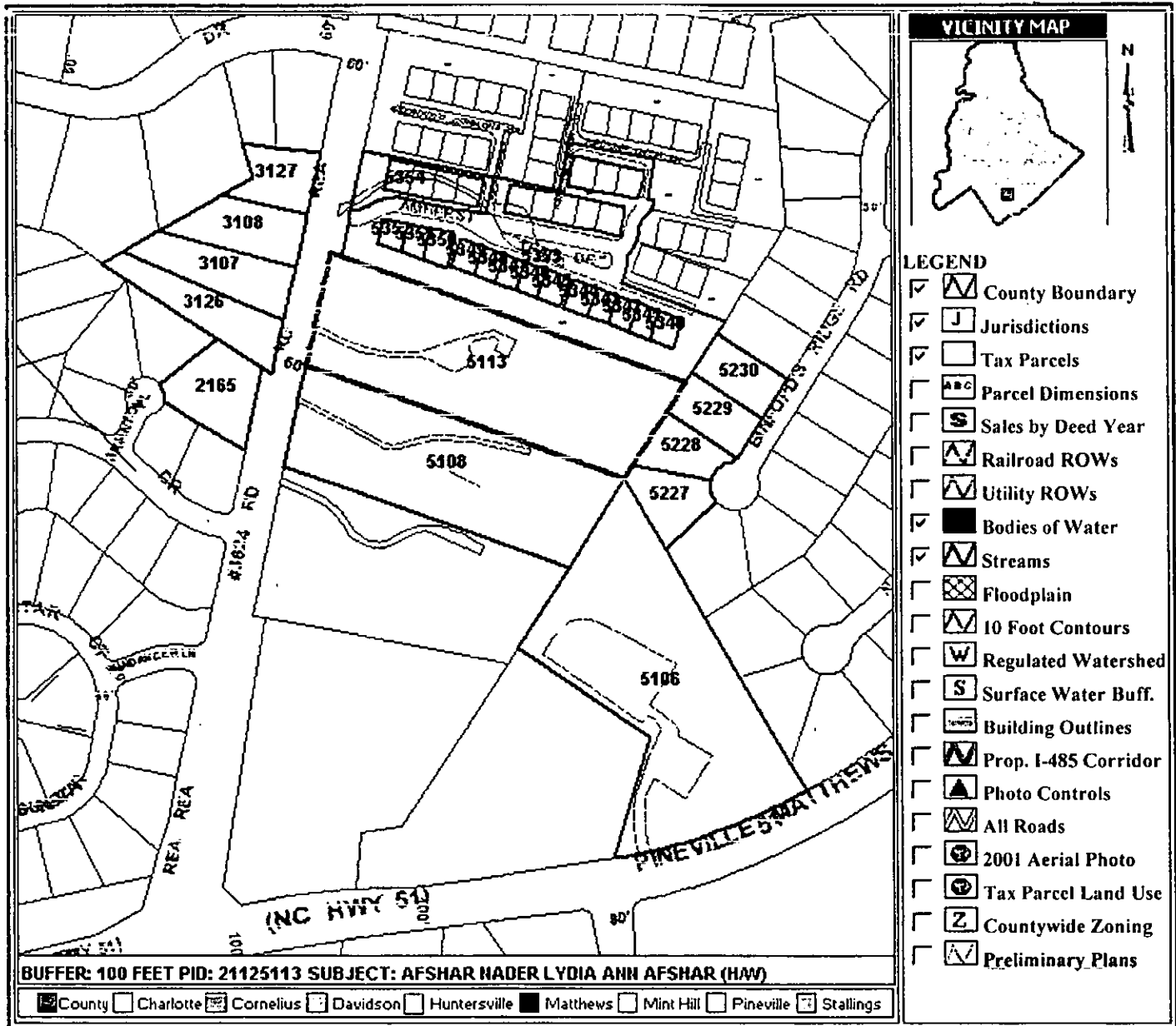

[Click here to submit questions or comments about the information shown on this page.](#)
Additional Tax Information (Tax Bills, Real and Personal Property, etc.) is available through the:
[Tax Information System](#)

Map Scale: 1 Inch = 320 Feet

This map is prepared for the inventory of real property within Mecklenburg County and is compiled from recorded deeds, plats, tax maps, surveys, planimetric maps, and other public records and data. Users of this map are hereby notified that the aforementioned public primary information sources should be consulted for verification. Mecklenburg

[Click Here to Open Owner's List \(Comma-Delimited\)](#)**ADJOINING OWNER'S REPORT**

Total Parcels Selected: 27

Total Tax Records Selected: 28

*** Images of real estate documents from the Register of Deeds are available from: 11/9/1998 to the present. ***

Record	MapId#	Parcel-Id#	Owner's Name	Mailing Address	Property Address	Deed Book/Page/Date	Acreege
1	3107	21123107	WIENER GLENN C HSB WIENER VIVIAN WF	5328 REA RD CHARLOTTE NC 28226	5328 REA RD	[GET DEED!] 13559/214 (5/3/2002)	0.608
2	3108	21123108	WILLIAMS MICHAEL J WILLIAMS SARAH L WF	5320 REA RD CHARLOTTE NC 28226	5320 REA RD	[GET DEED!] 10467/598 (5/12/1999)	0.594
3	3126	21123126	MILLER VALERIE L N/C	5940 LEAWOOD RUN CT CHARLOTTE NC 28269	5336 REA RD	[GET DEED!] 10507/198 (5/28/1999)	0.692
4	3127	21123127	DELLINGER HENRY S DELLINGER LINDA H WF	15341 BALLANTYNE COUNTRY CLUBDR CHARLOTTE NC 282772722	5312 REA RD	07920/628 (9/23/1994)	0.471
5	5106	21125106	ST MARGARETS EPISCOPAL CHURCH (TRUSTEES)	PO BOX 2013 CHARLOTTE NC 28211	5008 PINEVILLE- MATTHEWS RD	05110/444 (10/21/1985)	4.53
6	5106	21125106	ST MARGARETS EPISCOPAL CHURCH (TRUSTEES)	PO BOX 2013 CHARLOTTE NC 28211	5008 PINEVILLE- MATT RD	05110/444 (10/21/1985)	4.53
7	5108	21125108	LIU DAVID YUE-SI ALICE HAN WF	5415 REA RD CHARLOTTE NC 28226	5415 REA RD	03932/025 (4/1/1977)	3.18
8	5113	21125113	AFSHAR NADER LYDIA ANN AFSHAR (H/W)	5401 REA RD CHARLOTTE NC 28226	5401 REA RD	[GET DEED!] 11847/757 (1/8/2001)	4
9	5227	21125227	FORD LEONARD E TRACY A FORD (H/W)	4746 BINFORDS RIDGE RD CHARLOTTE NC 282264007	4746 BINFORD'S RIDGE RD	[GET DEED!] 12462/733 (7/20/2001)	0.368
10	5228	21125228	DONALDSON KIRRENE K DONALDSON PETER B HSB	4740 BINFORDS RIDGE RD CHARLOTTE NC 282264007	4740 BINFORD'S RIDGE RD	08866/068 (12/20/1996)	0.389
11	5229	21125229	SABA RONALD B CYNTHIA ANNE WF	4732 BINFORDS RIDGE RD CHARLOTTE NC 282264007	4732 BINFORD'S RIDGE RD	[GET DEED!] 10241/225 (2/8/1999)	0.371
12	5230	21125230	CLICK ORION MICHAEL JR CLICK BRENDA S WF	4726 BINFORDS RIDGE RD CHARLOTTE NC 282264007	4726 BINFORD'S RIDGE RD	08291/913 (9/18/1995)	0.371
13	5340	21125340	FINCK ROTHMAN DENISE	5220 AMHERST TRAIL DR CHARLOTTE NC 28226	5220 AMHERST TRAIL DR	[GET DEED!] 11764/696 (12/4/2000)	0.072
14	5341	21125341	PRICE ANN SLOAN	5216 AMHERST TRAIL DR CHARLOTTE NC 28226	5216 AMHERST TRAIL DR	[GET DEED!] 11748/394 (11/29/2000)	0.065
15	5342	21125342	CARRESE FRANCIS P CAROLYN T CARRESE (H/W)	5212 AMHERST TRAIL DR CHARLOTTE NC 28226	5212 AMHERST TRAIL DR	[GET DEED!] 11972/079 (2/28/2001)	0.065
16	5343	21125343	COHEN GARY EDWINA M COHEN (H/W)	5208 AMHERST TRAIL DR CHARLOTTE NC 28226	5208 AMHERST TRAIL DR	[GET DEED!] 11763/617 (12/1/2000)	0.065
17	5344	21125344	PULTE HOME CORPORATION	7422 CARMEL EXECUTIVE PARK DRSTE #300 CHARLOTTE NC 28226	5204 AMHERST TRAIL DR	[GET DEED!] 10999/418 (12/29/1999)	0.072
			MURRELL TERRANCE K	5134 AMHERST TRAIL DR	5134 AMHERST	[GET DEED!]	

18	5345	21125345	LINDA S MURRELL (H/W)	CHARLOTTE NC 28226	TRAIL DR	11762/734 (12/1/2000)	0.072
19	5346	21125346	BUCKMAN JOHN WILLIAM L/T LINDA BUCKMAN	5130 AMHERST TRAIL DR CHARLOTTE NC 28226	5130 AMHERST TRAIL DR	[GET DEED!] 11781/509 (12/12/2000)	0.065
20	5347	21125347	HICKS MARY T	5126 AMHERST TRAIL DR CHARLOTTE NC 28226	5126 AMHERST TRAIL DR	[GET DEED!] 11731/933 (11/21/2000)	0.065
21	5348	21125348	KOFF JOSEPH A LYNNE G KOFF (H/W)	5122 AMHERST TRAIL DR CHARLOTTE NC 28226	5122 AMHERST TRAIL DR	[GET DEED!] 11727/813 (11/20/2000)	0.065
22	5349	21125349	DRUMMOND PATRICIA C	5118 AMHERST TRAIL DR CHARLOTTE NC 28226	5118 AMHERST TRAIL DR	[GET DEED!] 11754/615 (11/30/2000)	0.072
23	5350	21125350	PULTE HOME CORPORATION	7422 CARMEL EXECUTIVE PARK DRSTE #300 CHARLOTTE NC 28226	5114 AMHERST TRAIL DR	[GET DEED!] 10999/418 (12/29/1999)	0.084
24	5351	21125351	SAYMAN ROBERT ERIC	5110 AMHERST TRAIL DR CHARLOTTE NC 28226	5110 AMHERST TRAIL DR	[GET DEED!] 13054/849 (12/20/2001)	0.068
25	5352	21125352	WIGGINS BETTY	5106 AMHERST TRAIL DR CHARLOTTE NC 28226	5106 AMHERST TRAIL DR	[GET DEED!] 11641/293 (9/12/2000)	0.067
26	5353	21125353	AMHERST GREEN TOWNHOME ASSOCIATION INC	7422 CARMEL EXECUTIVE PARK DRSTE #300 CHARLOTTE NC 28226	GREENFIELD COMMONS DR	[GET DEED!] 11703/051 (12/6/2000)	2.667
27	5354	21125354	AMHERST GREEN TOWNHOME ASSOCIATION INC	7422 CARMEL EXECUTIVE PARKSTE 300 CHARLOTTE NC 282260430	5331 REA RD	[GET DEED!] 12009/069 (3/12/2001)	0.28
28	2165	21152165	HALL FRED NEAL II	5405 BRIANTON PL CHARLOTTE NC 28226	5405 BRIANTON PL	[GET DEED!] 11087/098 (2/15/2000)	0.571

This site is powered by



MapObjects2 Internet Map Server



This site was developed by Mecklenburg County GIS and was last updated on 8/19/2002 5:14:32 PM

MECKLENBURG COUNTY, NC GIS PUBLIC ACCESS SYSTEM

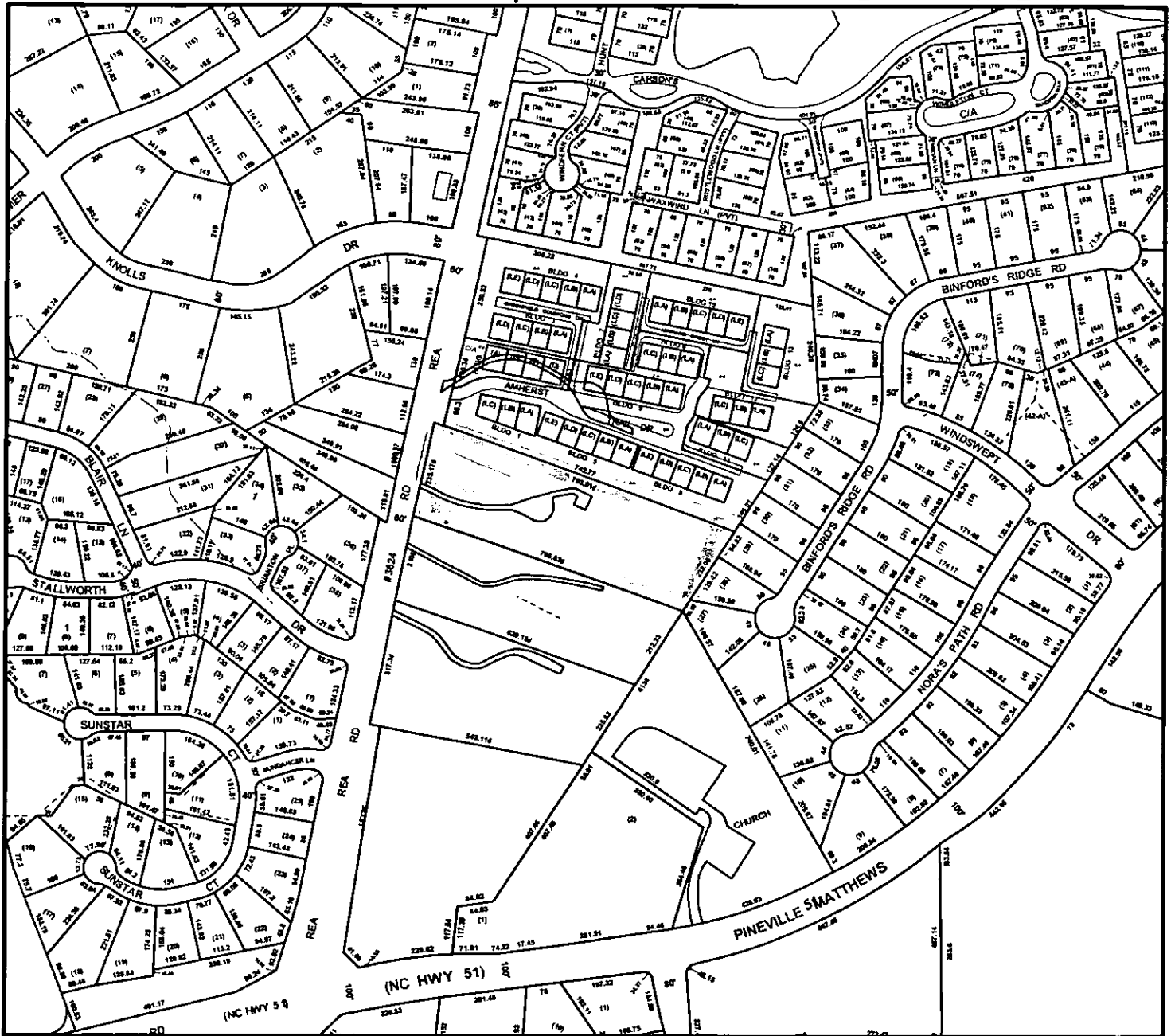

Tax Parcel-Id#s Selected: See Tax Information Report for List of Parcel-Id#s

Tax Book & Page Selected: N/A

LEGEND

- County Boundary
- Rivers/Creeks/Streams
- Railroad ROW
- Water Bodies



02-133

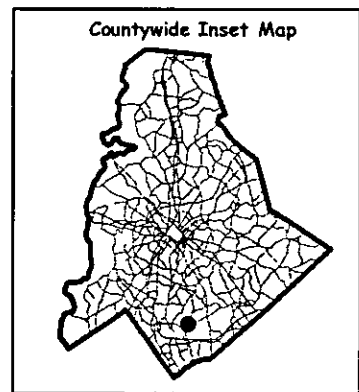

Scale : 1 Inch = 400 Feet

Map Created on Thursday, November 21, 2002 03:30 PM

This map is prepared for the inventory of real property within Mecklenburg County and is compiled from recorded deeds, plats, tax maps, surveys, planimetric maps, and other public records and data. Users of this map are hereby notified that the aforementioned public primary information sources should be consulted for verification. Mecklenburg County and its mapping contractors assume no legal responsibility for the information contained herein.

02 133

Zone	ODzone_area
117	1.726837
120	1.990777
121	2.427554
125	2.039851
126	1.438261
328	3.165763
331	1.642158
332	0.610010

Petition #: 2002-133

Petitioner: Afshar Nader

Hearing Date: December 16, 2002

Zoning Classification (Existing): R-3

Zoning Classification (Requested): R-8MF(CD)

Acresage & Location Approximately 4 acres located on the east side of Rea Road, north of Pineville-Matthews Road (NC Hwy 51)

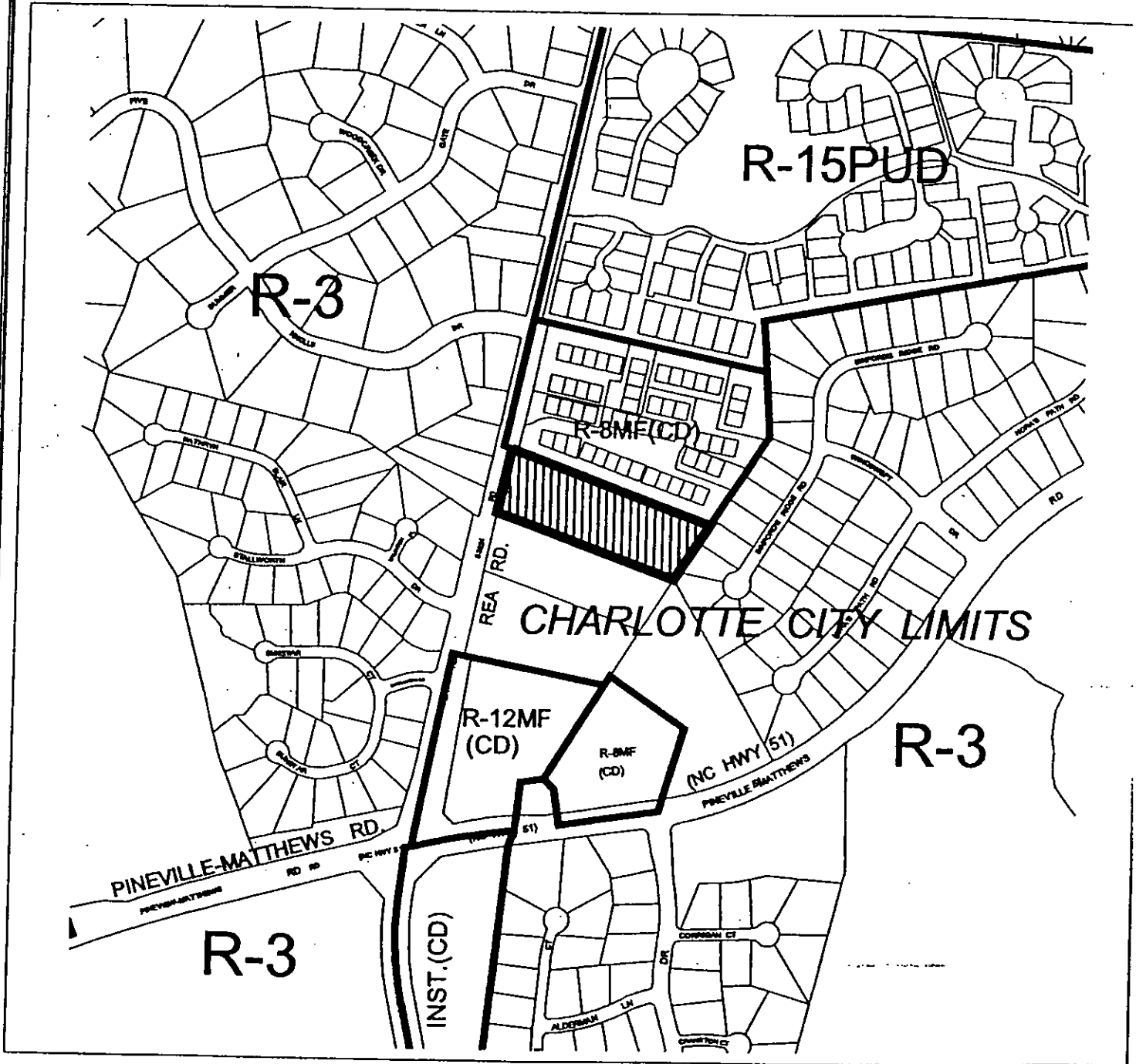

Zoning Map #(s);

166

Map Legend

	ETD		Neighborhood
	Arbitrarily		County Line
	Waterway		City Unincorporated
	Historic District		