



* 0 0 B R E A K 0 0 *



ADVANCED
IMAGING
SYSTEMS

An Information
Management Company

www.aisimc.com

City of Charlotte – Planning Dept. Scanning Rezoning Files

Petition # 2002-134

Document type:

- Applications
- Correspondence
- Department Comments
- Land Use Consistency
 - Mail Info
 - Mapping
 - Other
- Site Plans



* 0 0 B R E A K 0 0 *

Petition #: 2002-134

Petitioner: Capstone Property Group, Inc.

Hearing Date: November 18, 2002

Zoning Classification (Existing): UR-3

Zoning Classification (Requested): UMUD(CD)

Acresage & Location Approximately 1.53 acres located west of North Graham Street between West Seventh Street and West Sixth Street

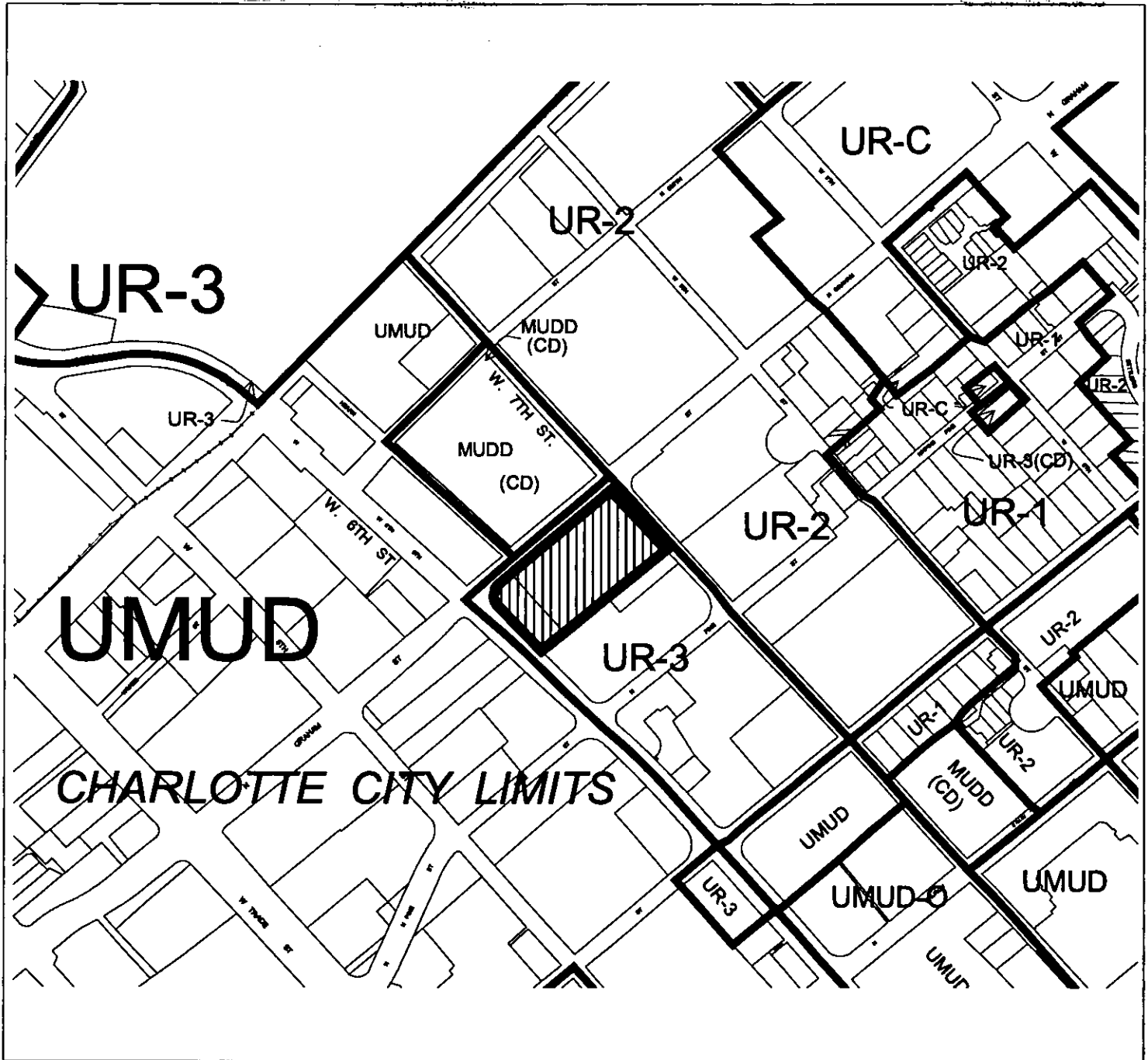

Zoning Map #(s):

102

Charlotte-Mecklenburg Planning Commission

Map Legend

	ITU		Floodplain/Map
	Atmosphere		County Line
	Watershed		City Limits/Map
	Historic District		

MECKLENBURG COUNTY, NC GIS PUBLIC ACCESS SYSTEM

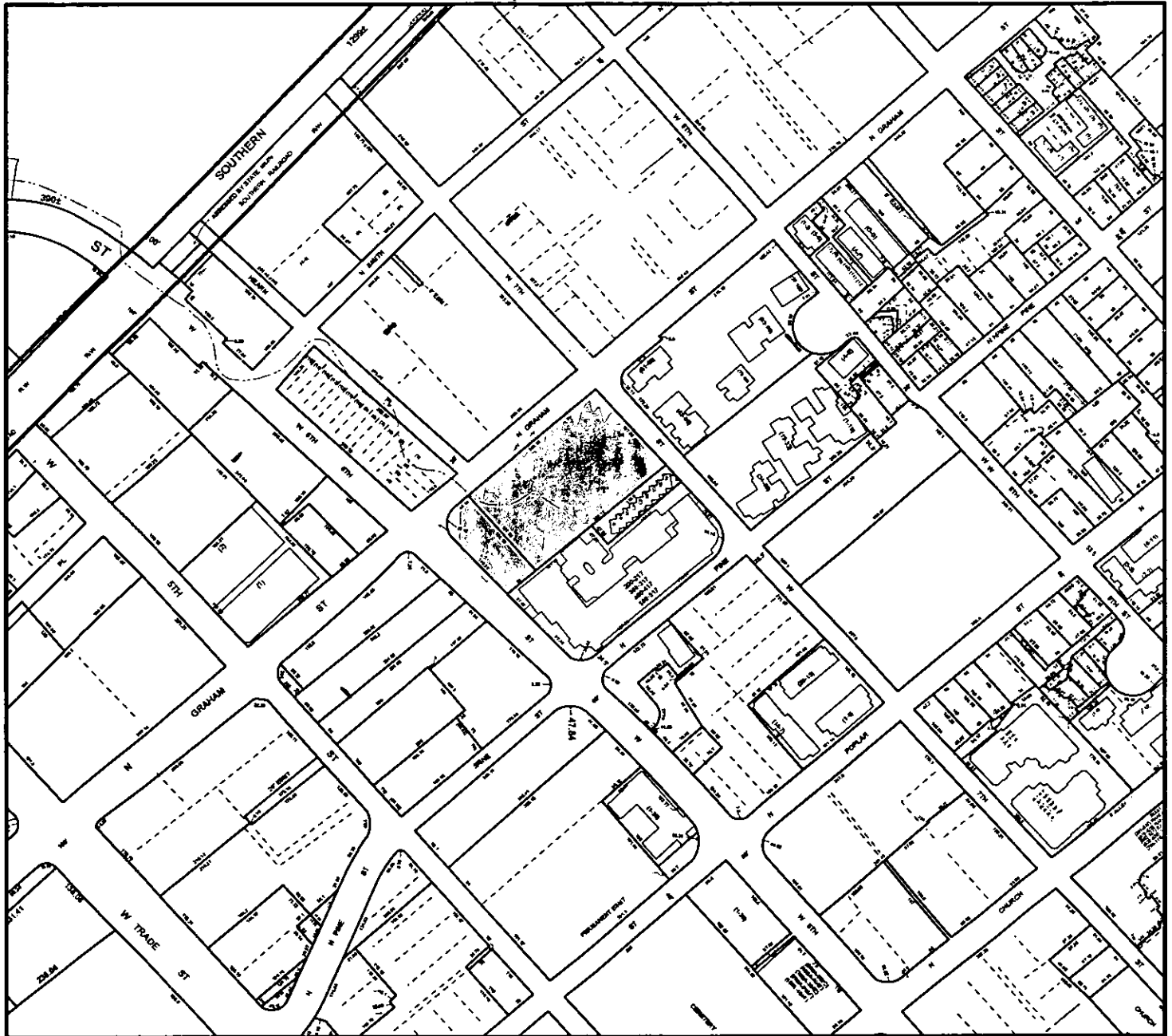

Tax Parcel-Id#s Selected: See Tax Information Report for List of Parcel-Id#s

Tax Book & Page Selected: N/A

02-134

LEGEND

- County Boundary
- Rivers/Creeks/Streams
- Railroad ROW
- Water Bodies
- Jurisdictions**
- County
- Charlotte
- Cornelius
- Davidson
- Huntersville
- Matthews
- Mint Hill
- Pineville

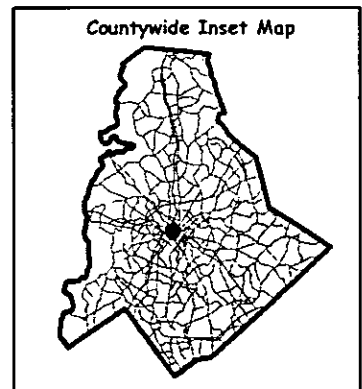

Scale : 1 Inch = 300 Feet

Map Created on Thursday, December 12, 2002 04:06 PM

This map is prepared for the inventory of real property within Mecklenburg County and is compiled from recorded deeds, plats, tax maps, surveys, planimetric maps, and other public records and data. Users of this map are hereby notified that the aforementioned public primary information sources should be consulted for verification. Mecklenburg County and its mapping contractors assume no legal responsibility for the information contained herein.

Zone	ODzone_area
1	0.021562
2	0.028560
3	0.044092
4	0.057789
5	0.061914
6	0.041668
7	0.020960
8	0.094302
9	0.079433
10	0.108199
11	0.074612
12	0.062949
13	0.051511
14	0.204910
15	0.311937
16	0.132046
17	0.160859
18	0.365655
19	0.209830
20	0.244424
21	0.157062
22	0.049594
23	0.090022
24	0.121539
25	0.210799
26	0.496561
28	0.142641
94	0.590257
182	0.507222
183	0.407781
184	0.242041
186	0.615251
205	0.222251
206	0.241956
209	0.358374
210	0.360726
214	0.397754
215	0.343661
216	0.220756
217	0.204563

02 134